

ORIGINAL SCALE IS IN INCHES
 Drawing name: C:\Civil\3D Projects\78703_Kyburz Drive\Sheet\DE-1.dwg Layout Tab: DE-1 Sep 26, 2017 - 9:57am SMC\ey
 FOR REDUCED PLANS

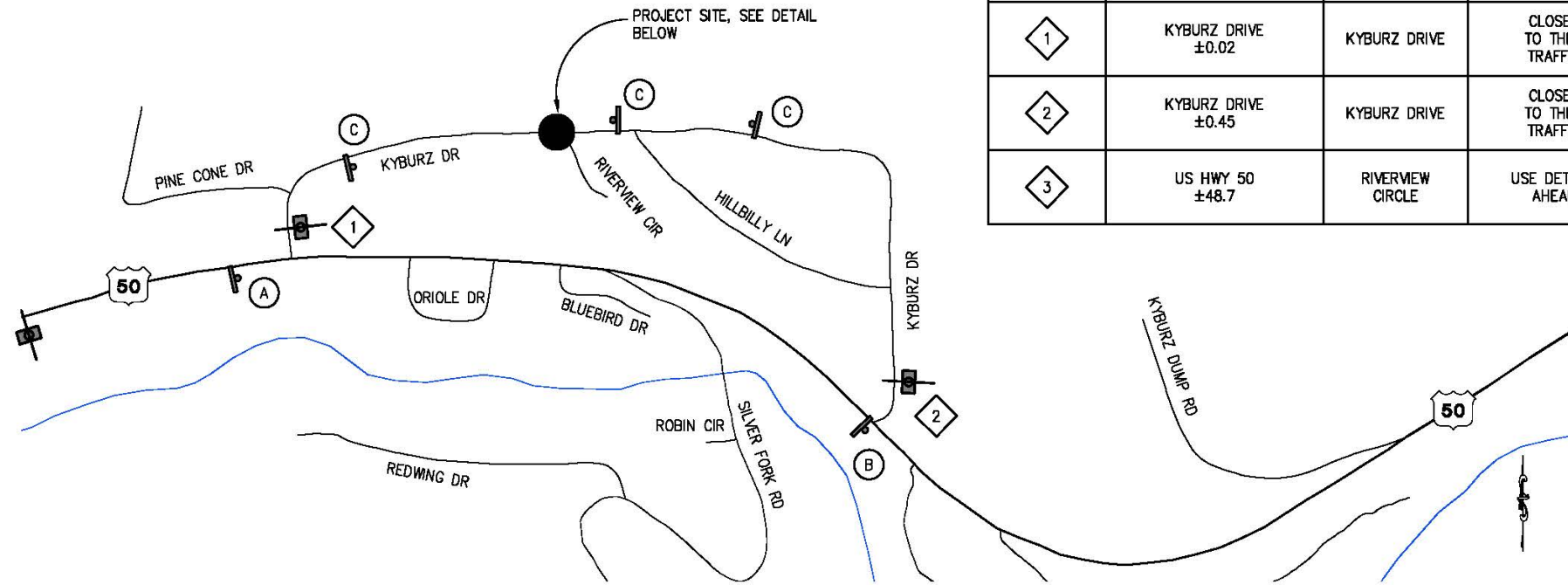

DETOUR PLAN
SCALE: 1"=200'

PORTABLE CHANGEABLE MESSAGE SIGN (PCMS) TABLE				
PCMS No.	POST MILE (PM)	FIRST FLASH	SECOND FLASH	THIRD FLASH
1	KYBURZ DRIVE ±0.02	KYBURZ DRIVE	CLOSED TO THRU TRAFFIC	(DATES CLOSED)
2	KYBURZ DRIVE ±0.45	KYBURZ DRIVE	CLOSED TO THRU TRAFFIC	(DATES CLOSED)
3	US HWY 50 ±48.7	RIVERVIEW CIRCLE	USE DETOUR AHEAD	

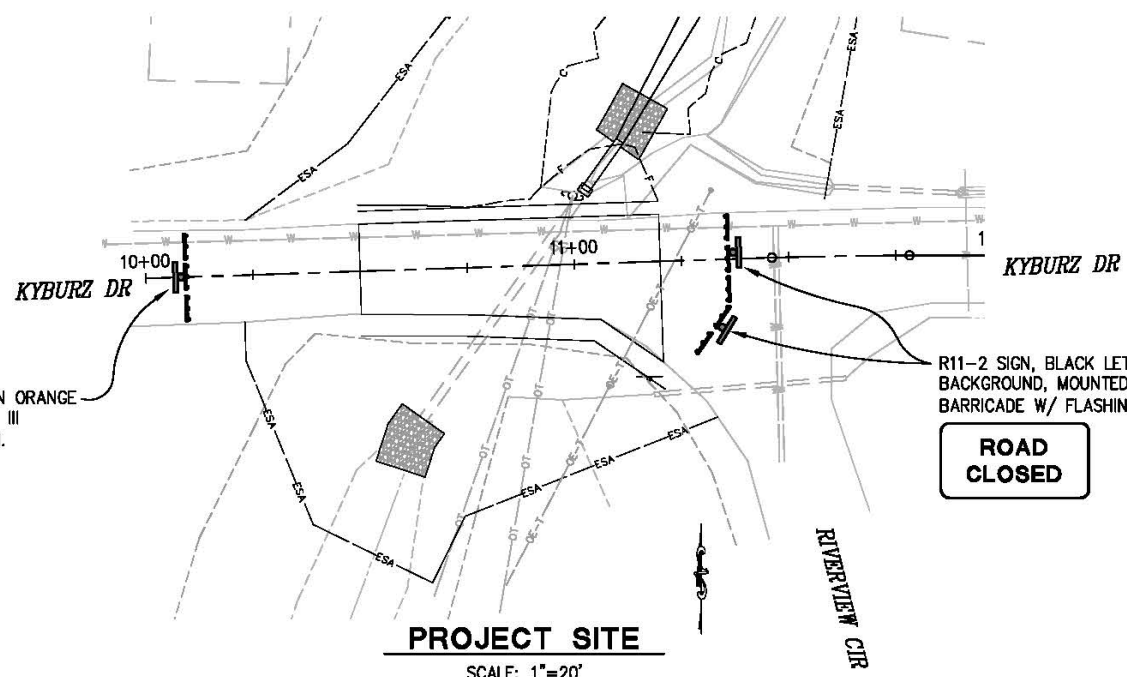

PROJECT SITE
SCALE: 1"=20'

LEGEND

- PCMS - PORTABLE CHANGEABLE MESSAGE SIGN
- TEMPORARY SIGN
- TYPE III BARRICADE(S) W/ FLASHING BEACON
- RIVERVIEW CIRCLE DETOUR** (ARROW FACING UP) — (A) M4-9 SIGN, BLACK LETTERING ON ORANGE BACKGROUND (ARROW FACING UP)
- RIVERVIEW CIRCLE DETOUR** (ARROW FACING LEFT) — (B) M4-9 SIGN, BLACK LETTERING ON ORANGE BACKGROUND (ARROW FACING LEFT)
- ROAD CLOSED AHEAD** — (C) W20-3 SIGN, BLACK LETTERING ON ORANGE BACKGROUND

GENERAL NOTES:

- ADVANCED WARNING SIGNS TO BE PLACED PER CALIFORNIA MANUAL ON TRAFFIC CONTROL DEVICES. EXACT LOCATION OF SIGNS AND BARRICADES TO BE DETERMINED BY THE ENGINEER.
- ALL SIGNS SHALL BE PLACED ON TEMPORARY WOOD POSTS, EXCEPT PCMS' AND SIGNS MOUNTED ON TYPE III BARRICADE.

DETOUR PLAN
SCALE: AS SHOWN

<table border="1" style="width: 100%; border-collapse: collapse;"> <thead> <tr> <th>REVISION</th> <th>NUMBER</th> <th>DATE</th> <th>DESCRIPTION</th> <th>BY</th> </tr> </thead> <tbody> <tr><td> </td><td> </td><td> </td><td> </td><td> </td></tr> <tr><td> </td><td> </td><td> </td><td> </td><td> </td></tr> <tr><td> </td><td> </td><td> </td><td> </td><td> </td></tr> </tbody> </table>	REVISION	NUMBER	DATE	DESCRIPTION	BY																	PREPARED UNDER THE SUPERVISION OF : REGISTERED CIVIL ENGINEER DATE:	DESIGNED: DA DRAWN: SGM CHECKED: CG DATE: 09/26/17 ROAD NUMBER: 2125		COUNTY OF EL DORADO DEPARTMENT OF TRANSPORTATION	KYBURZ DRIVE CULVERT REPAIR	SHEET DE-1 7 OF 7 W.O. No. 78703
REVISION	NUMBER	DATE	DESCRIPTION	BY																							