



GENERAL NOTES:

- PROJECT MUST COMPLY WITH TITLE 24, PARTS 1-9 AND 12 IN ACCORDANCE WITH TITLE 24, PART 1, 4-305.
- CONTRACTOR TO BE IN COMPLIANCE WITH CFC CH. 33 - FIRE SAFETY DURING CONSTRUCTION & DEMOLITION.
- TITLE 24, PARTS 1-5 MUST BE KEPT ON THE SITE DURING CONSTRUCTION.
- PROJECT INSPECTOR AND TESTING LAB MUST BE EMPLOYED BY OWNER AND APPROVED BY A/E OF RECORD
- PROJECT INSPECTOR SHALL HAVE AND MAINTAIN ON THE JOB AT ALL TIMES, THE EDITION OF TITLE 24, PARTS 1-8 REFERRED TO IN THE PLANS AND SPECIFICATIONS PER TITLE 24, PART 1, 4-342. (b)3.
- CONTRACTOR SHALL FIELD VERIFY ALL DIMENSIONS AND EXISTING CONDITIONS AT THE SITE AND SHALL REPORT ANY DISCREPANCIES IN WRITING TO THE CONSTRUCTION MANAGER BY THE MEANS OF A REQUEST FOR INFORMATION (RFI) OR AS PART OF THE APPLICABLE SHOP DRAWING / SUBMITTAL.
- CONTRACTOR IS RESPONSIBLE FOR INCIDENTAL WORK NECESSARY TO COMPLETE THE INSTALLATION OF NEW WORK. THIS INCLUDES, BUT IS NOT LIMITED TO, THE REMOVAL AND/OR REINSTALLATION OF ALL EXISTING ITEMS, OR PORTIONS OF THE EXISTING CONSTRUCTION WHETHER SHOWN OR NOT.
- ALL ITEMS NOT SPECIFICALLY SHOWN TO BE DEMOLISHED, REPLACED OR MODIFIED ARE TO REMAIN IN PLACE, UNDISTURBED IN WORKING CONDITION.
- CONTRACTOR TO RE-ESTABLISH ALL EXISTING UTILITY BOXES, MANHOLES, CLEANOUTS, ETC. IN AREAS OF WORK TO FINISH GRADE
- ALL WORK SHALL BE IN COMPLETE CONFORMANCE WITH MANUFACTURER'S SPECIFICATIONS AND RECOMMENDATIONS OR AS OTHERWISE OUTLINED IN THE SPECIFICATIONS.
- USE OF ANY MATERIALS CONTAINING LEAD OR ASBESTOS IS PROHIBITED.
- THE TERM "TYPICAL" OR "(TYP.)" SHALL BE CONSTRUED TO MEAN APPLYING TO ALL LIKE OR SIMILAR CONDITIONS UNLESS SPECIFICALLY NOTED OTHERWISE.

BIN AND CONTAINER STORAGE SCHEDULE

(XX) SYMBOL USED FOR SCHEDULE, TYP.

REQUIRED AREAS

- A-1 APPLIANCE PROCESSING 30'X50'
- A-2 HHW SUPPLY STORAGE AREA 20'X25'
- A-3 (FREE RECYCLE AREA) MATTRESS STORAGE AREA 8'X20'
- A-4 HHW USED OIL STORAGE PROCESSING

BINS AND CONTAINERS

- B-1 (FREE RECYCLE AREA) CLEAR TV BIN 8'X20', REQUIRES 5' CLEAR AT DOORS
- B-2 (FREE RECYCLE AREA) MIXED RECYCLE BINS (5) 5 YARD BINS 7'X40'
- B-3 (FREE RECYCLE AREA) E WASTE BINS (4) 4'X4'
- B-4 (\$\$\$) GREEN CARPET SHIPPING CONTAINER 8'X40'
- B-5 (\$\$\$) RECYCLED TIRE BIN 8'X25' X2
- B-6 (FREE RECYCLE AREA) CAR BATTERY BOX X2
- B-7 (FREE RECYCLE AREA) METAL RECYCLE BIN 20 YD
- B-8 HHW HAZMAT STORAGE BIN 8'X20'
- B-9 TOOL STORAGE SHED 8'X20'
- B-10 (FREE RECYCLE AREA) MATTRESS SEMI-TRAILER 8'X52'
- B-11 BUY BACK CENTER BINS 8'X20' X6
- B-12 HHW TEMPORARY CHEMICAL STORAGE AND PROCESSING MODULE (NEW) 11'-4"X33'-4"
- B-13 HHW TEMPORARY BARREL STORAGE MODULE (NEW) 9'-4"X25'-4"
- B-14 PORTABLE LOADING RAMP/DOCK (NEW) 7'X30'
- B-15 PORTABLE SPILL CONTAINMENT SYSTEM (NEW) 10'X10'
- B-16 TRANSFER TRAILER STAGING

EL DORADO DISPOSAL MATERIAL RECOVERY FACILITY RENOVATION
4100 THROWITA WAY
PLACERVILLE, CA 95667

WASTE CONNECTIONS INC.

PROJECT NUMBER: 2019-011.00

PHASE II
SITE PLAN

A1.1.3

20-0919 H 1 of 1

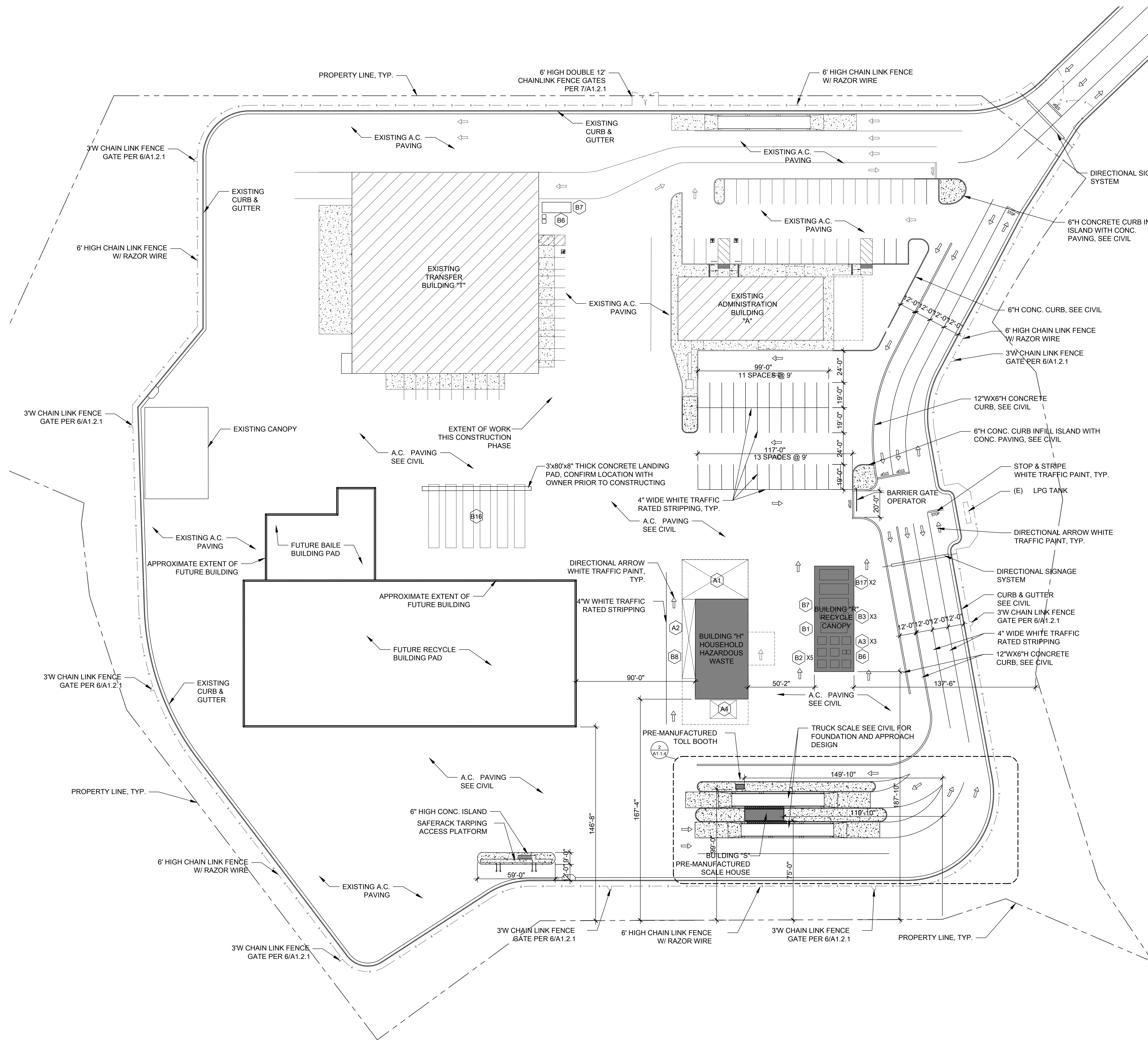

PATH OF TRAVEL

PATH OF TRAVEL (P.O.T.) AS INDICATED, IS A COMMON FREE ACCESS ROUTE WITHOUT ANY ABRUPT VERTICAL CHANGES EXCEEDING 1/2" BEVELED AT 1:2 MAXIMUM SLOPE, EXCEPT THAT LEVEL CHANGES DO NOT EXCEED 1/2" VERTICAL AND IS AT LEAST 48" WIDE. THE PATH SURFACE IS SLIP RESISTANT, STABLE, FIRM AND SMOOTH. PASSING SPACES (11B-403.5.3) AT LEAST 60"x60" ARE LOCATED NOT MORE THAN 200' APART. PARTS OF PATH OF TRAVEL WITH CONTIN. GRADIENTS HAVE 60" LEVEL AREAS (11B-403.7) NOT MORE THAN 400' APART. THE CROSS SLOPE DOES NOT EXCEED 2% AND SLOPE IN THE DIRECTION OF TRAVEL IS LESS THAN 5% UNLESS OTHERWISE INDICATED. P.O.T. SHALL BE MAINTAINED FREE OF OVERHANGING OBSTRUCTIONS TO 80" MINIMUM (11B-307.2) AND PROTRUDING OBJECTS GREATER THAN 4" PROJECTION FROM WALL AND ABOVE 27" AND LESS THAN 80" (11B-307.4)

P.O.T. HAS NO DROP-OFF OVER 4" AT THE EDGE OF WALKS OR LANDING.

SITE PLAN

SCALE: 1" = 30'-0"

