

ORIGINAL SCALE IS IN INCHES
 Drawing name: C:\Civil 3D Projects\72197 Intersection Sight Improvements\CADD Files\RW\RW and Easements Exhibit.dwg Layout Tab: EX-1 Jun 01, 2020 10:14am SMC\ey

LEGEND:

- EXISTING PROPERTY LINE (67,252 SF TOTAL)
 (60,878 SF REMAINING)

- PROPOSED FEE RIGHT-OF-WAY (R/W)
 597 SF (NEW)
 989 SF (PRESCRIPTIVE)
 1,586 SF (TOTAL)

- PROPOSED SLOPE AND DRAINAGE EASEMENT (SDE)
 4,788 SF (NEW)
 0 SF (PRESCRIPTIVE)
 4,788 SF (TOTAL)

- PROPOSED TEMPORARY CONSTRUCTION EASEMENT (TCE)
 30,730 SF (NEW)
 0 SF (PRESCRIPTIVE)
 30,730 SF (TOTAL)

- (RESCRIPTIVE/ENCUMBERED AREA
 (5' NON-EXCLUSIVE ROAD AND PUBLIC
 UTILITIES EASEMENT PER P.M. 18-74)

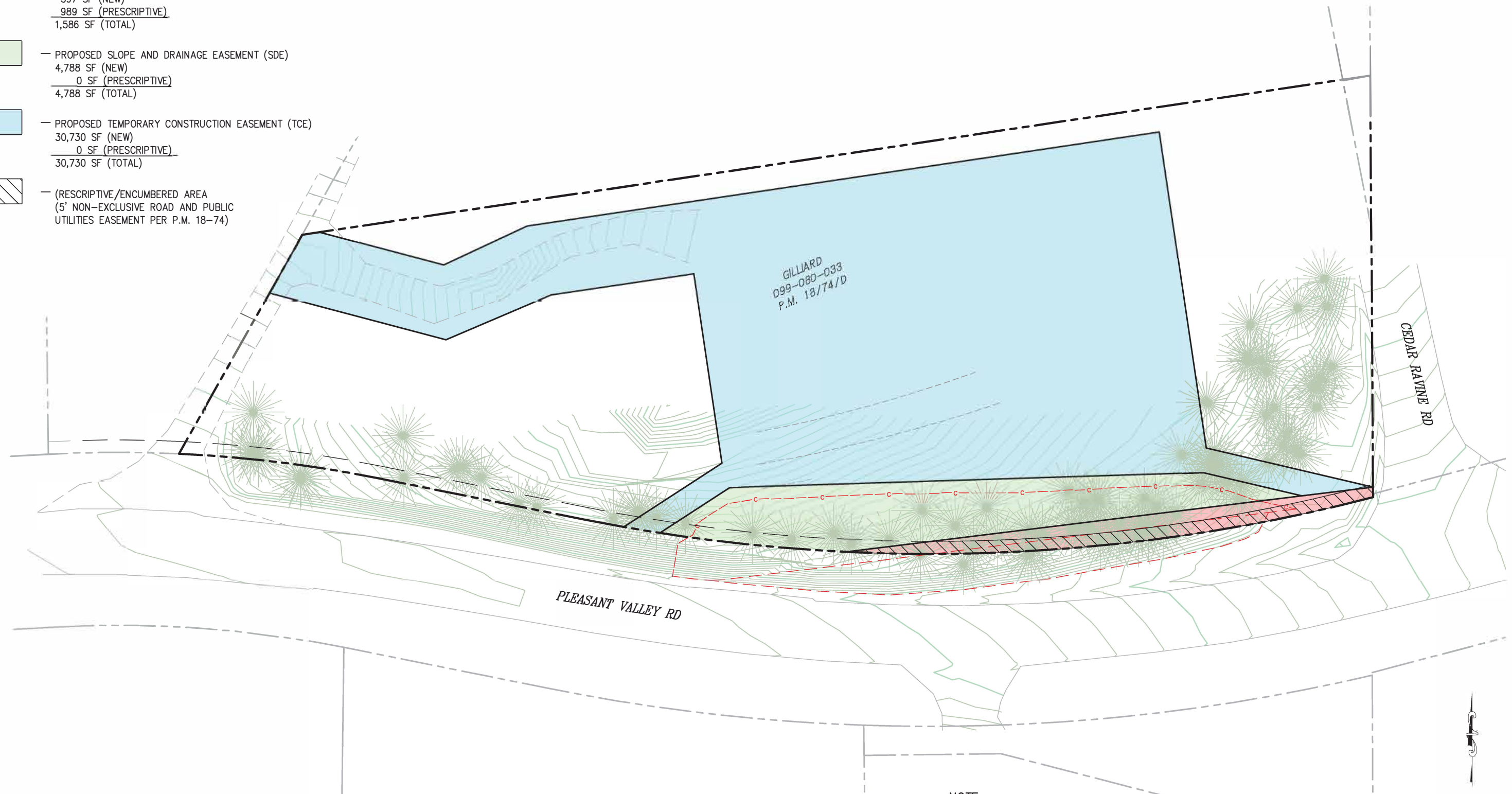

NOTE:
PROPOSED IMPROVEMENTS SHOWN IN RED

RIGHT-OF-WAY AND EASEMENTS EXHIBIT
SCALE : 1" = 20'

PRELIMINARY

REVISION	NUMBER	DATE	DESCRIPTION	BY

PREPARED UNDER THE SUPERVISION OF :

REGISTERED CIVIL ENGINEER

DATE: _____

DESIGNED: _____ DRAWN: SGM

CHECKED: _____ DATE: 05/01/20

ROAD NUMBER: 077/086



COUNTY OF EL DORADO
DEPARTMENT OF TRANSPORTATION

PLEASANT VALLEY RD/CEDAR RAVINE RD
INTERSECTION SIGHT IMPROVEMENTS

SHEET
EX-1

1 OF 1

W.O. No. **72197**