

- NOTES:
1. THIS SHEET IS ACCURATE FOR DETOUR LAYOUT ONLY.
 2. SIGN LOCATIONS SHOWN ARE APPROXIMATE. EXACT LOCATIONS TO BE DETERMINED BY THE ENGINEER.
 3. CONSTRUCTION AREA SIGNS ARE REQUIRED IN ADDITION TO THESE DETOUR SIGNS SHOWN.
 4. PCMS SIGNS ARE REQUIRED 7-DAYS PRIOR TO, AND DURING ANY ROAD CLOSURE. MESSAGE AS SHOWN OR AS DIRECTED BY THE ENGINEER.

PORTABLE CHANGEABLE MESSAGE SIGN (PCMS) TABLE			
PRIOR TO CONSTRUCTION			
LOCATION	FIRST FLASH	SECOND FLASH	THIRD FLASH
FACING N/B HWY 50 TRAFFIC	ELKS CLUB DR CLOSED	DATE TBD TO DATE TBD	
FACING S/B HWY 50 TRAFFIC	ELKS CLUB DR CLOSED	DATE TBD TO DATE TBD	
FACING W/B ELKS CLUB DR TRAFFIC	ELKS CLUB DR CLOSED	DATE TBD TO DATE TBD	
DURING CONSTRUCTION			
FACING N/B HWY 50 TRAFFIC	ELKS CLUB DR CLOSED	DETOUR MEADOWVALE	TO TAM O SHANTER
FACING S/B HWY 50 TRAFFIC	ELKS CLUB DR CLOSED	DETOUR MEADOWVALE	TO TAM O SHANTER
FACING W/B ELKS CLUB DR TRAFFIC	ELKS CLUB DR CLOSED	DETOUR TAM O SHANTER	TO MEADOWVALE

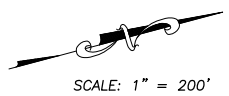
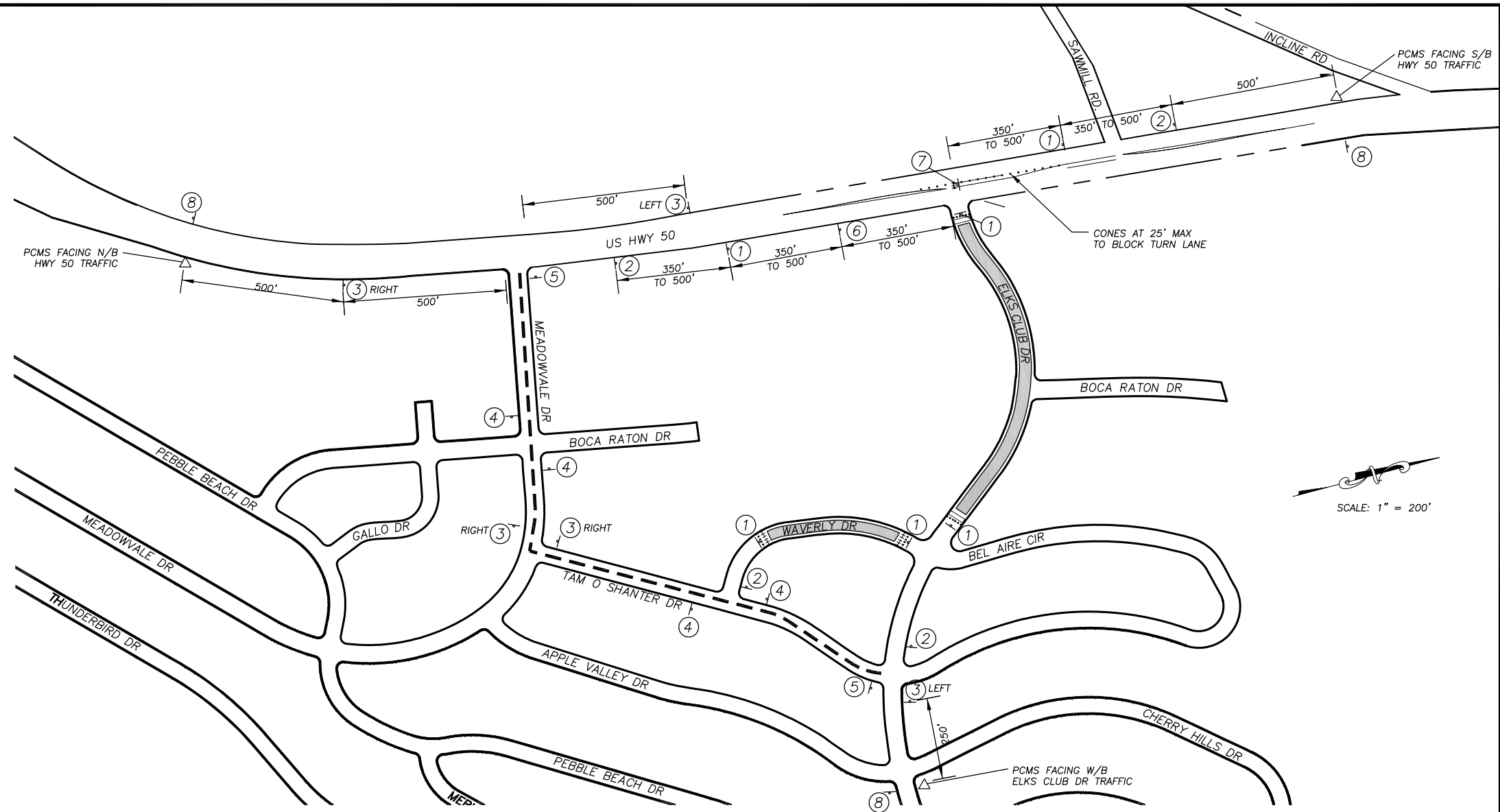

SCALE: 1" = 200'

**TRAFFIC CONTROL FOR ROAD CLOSURE
ELKS CLUB DRIVE AND HIGHWAY 50 INTERSECTION**
NTS

Legend for signs and symbols:

- DETOUR
- ▭ TEMPORARY ROAD CLOSURE LIMITS
- △ PORTABLE CHANGEABLE MESSAGE SIGN (PCMS)
- ▭ "K" RAIL BARRICADE
- HHH TRAFFIC BARRICADE
- ▲ APPROXIMATE SIGN LOCATION AND ORIENTATION
- ① ROAD CLOSED (C2 (CA))
- ② ROAD CLOSED AHEAD (W20-3)
- ③ DETOUR (M4-10) DIRECTION AS INDICATED
- ④ DETOUR (SC9 (CA))
- ⑤ END DETOUR (M4-8a)
- ⑥ R3-1 (No Right Turn)
- ⑦ R3-2 (No Left Turn)
- ⑧ END ROAD WORK (G20-2)

Drawing name: \\caddat51\44-st-engineering\civil_34_projects\78725-elks-engineering\PLAN\ELKS_DE-1_DETOUR_PLAN.dwg

FOR REDUCED PLANS ORIGINAL SCALE IS IN INCHES

REVISION

NUMBER	DATE	DESCRIPTION	BY



PREPARED UNDER THE SUPERVISION OF:

 REGISTERED CIVIL ENGINEER
JANUARY 22, 2018
 DATE:

DESIGNED: KIS
 DRAWN: KIS
 CHECKED: DWK
 DATE: 01/2018
 ROAD NUMBER: ---

COUNTY OF EL DORADO
 COMMUNITY DEVELOPMENT SERVICES
 DEPARTMENT OF TRANSPORTATION

**2018 ELKS CLUB DRIVE
 EMERGENCY ROAD REPAIR PROJECT
 DETOUR PLAN**

SHEET
DE-1
 13 OF 13
 CONTRACT NO.
PW 17-31191
 CIP No.
78725