

INDEX OF SHEETS

SHEET	PLAN SHEET	TITLE TITLE
1		TITLE SHEET
2	CD-1	SURVEY CONTROL DIAGRAM
3-4	X-1 TO X-2	TYPICAL SECTIONS
5	L-1	LAYOUT PLAN
6	C-1	CONSTRUCTION DETAIL
7	EC-1	EROSION CONTROL PLAN
8	D-1	DRAINAGE PLAN & PROFILE
9	D-2	DRAINAGE DETAILS
10	CS-1	CONSTRUCTION AREA SIGNS
11-13	SC-1 TO SC-3	STAGE CONSTRUCTION
14-15	SPD-1 TO SPD-2	SIGNING AND PAVEMENT DELINEATION

DEPARTMENT OF TRANSPORTATION
COUNTY OF EL DORADO, CA

PROJECT PLANS FOR THE CONSTRUCTION OF
**LATROBE ROAD NORTH OF
RYAN RANCH ROAD**

IN THE COUNTY OF EL DORADO, DISTRICT II
APPROXIMATELY 4.1 MILES SOUTH OF U.S. HWY 50 AND EL DORADO HILLS BLVD INTERCHANGE

To be supplemented with Standard Plans dated May 2006, of the
California Department of Transportation, unless otherwise noted.

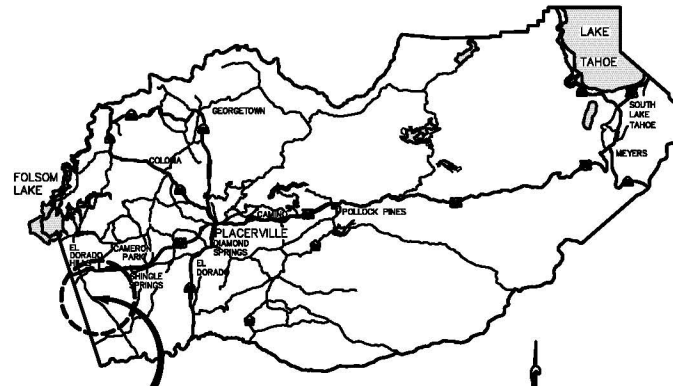

SITE LOCATION
VICINITY MAP
COUNTY OF EL DORADO

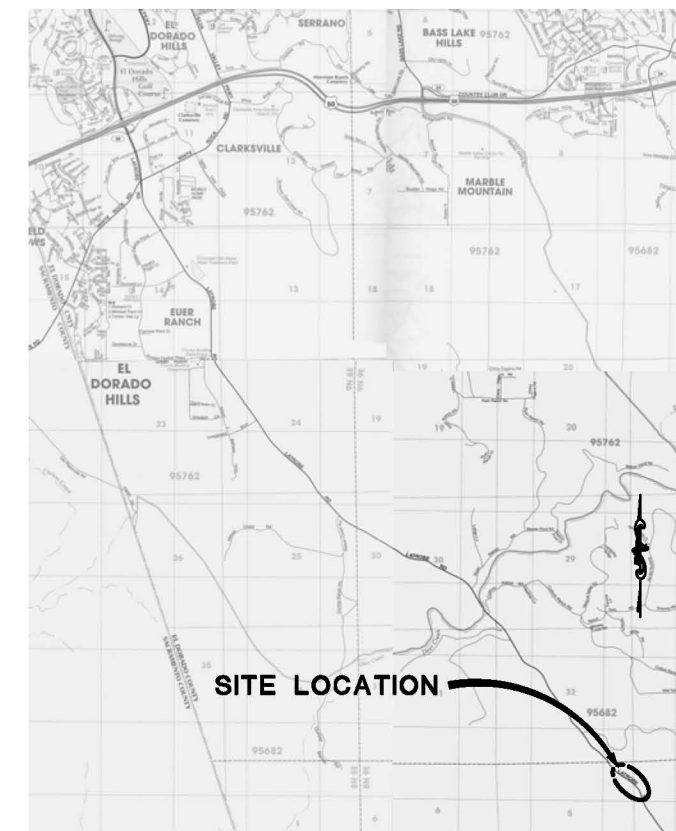

LOCATION MAP
NOT TO SCALE

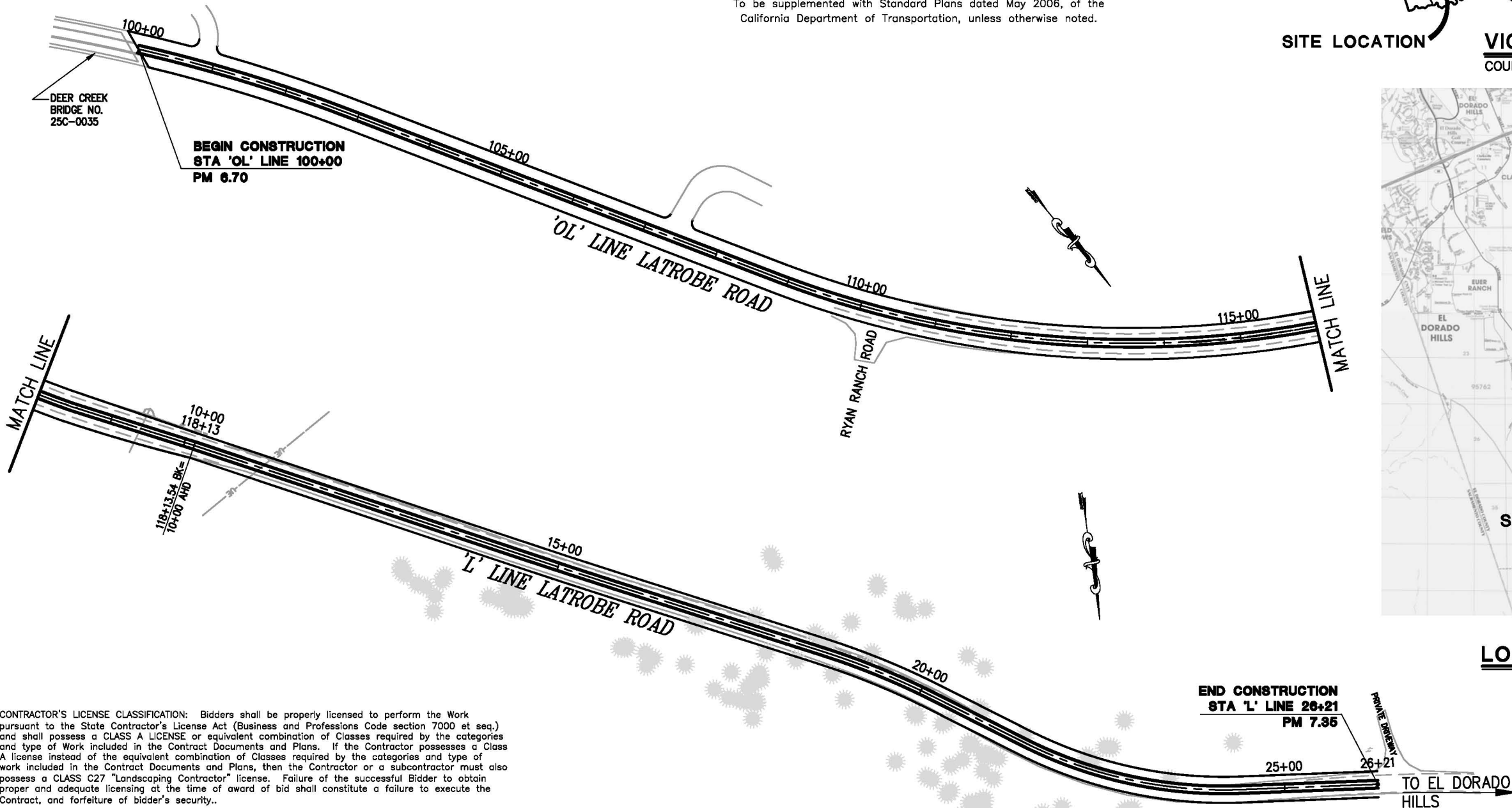

CONTRACTOR'S LICENSE CLASSIFICATION: Bidders shall be properly licensed to perform the Work pursuant to the State Contractor's License Act (Business and Professions Code section 7000 et seq.) and shall possess a CLASS A LICENSE or equivalent combination of Classes required by the categories and type of Work included in the Contract Documents and Plans. If the Contractor possesses a Class A license instead of the equivalent combination of Classes required by the categories and type of work included in the Contract Documents and Plans, then the Contractor or a subcontractor must also possess a CLASS C27 "Landscaping Contractor" license. Failure of the successful Bidder to obtain proper and adequate licensing at the time of award of bid shall constitute a failure to execute the Contract, and forfeiture of bidder's security..

REVISIONS		
MARK	DATE	BY



SITE PLAN
SCALE: 1" = 60'

SUBMITTED BY: MASOUD SAED
CIVIL ENGINEER
STATE OF CALIFORNIA NO. _____ DATE _____

BOARD OF SUPERVISORS

- I - RON MIKULACO
- II - RAYMOND J. NUTTING
- III - BRIAN VEERKAMP
- IV - RON V. BRIGGS
- V - NORMA SANTIAGO

**COUNTY OF EL DORADO
DEPARTMENT OF
TRANSPORTATION**

(530) 621-5900
2850 FAIRLANE CT
PLACERVILLE, CA
95667

ADOPTED AND APPROVED BY:

RON V. BRIGGS
CHAIR, EL DORADO COUNTY BOARD OF SUPERVISORS

APPROVED BY:

KIMBERLY A. KERR
INTERIM DIRECTOR, EL DORADO COUNTY DEPARTMENT OF TRANSPORTATION

MATTHEW D. SWIGLERS P.E. NO. 026839
DEPUTY DIRECTOR OF ENGINEERING, EL DORADO COUNTY DEPARTMENT OF TRANSPORTATION

DATE _____

FEDERAL AID PROJECT NO. HRRRL -5925(056)
PW NO. 09-30467 CONTRACT NO. 73359

**LATROBE ROAD NORTH OF
RYAN RANCH ROAD**

TITLE SHEET

SHEET 1 OF 15

ORIGINAL SCALE IS IN INCHES
 FOR REDUCED PLANS
 2
 1
 0
 Drawing name: C:\Civil 3D\Projects\73359 Latrobe Rd. So of Westel-Ovict\Drawings\Sheets\CD-1.dwg
 Layout Tab: CD-1 Mar 12, 2013 8:21am M.Saeed

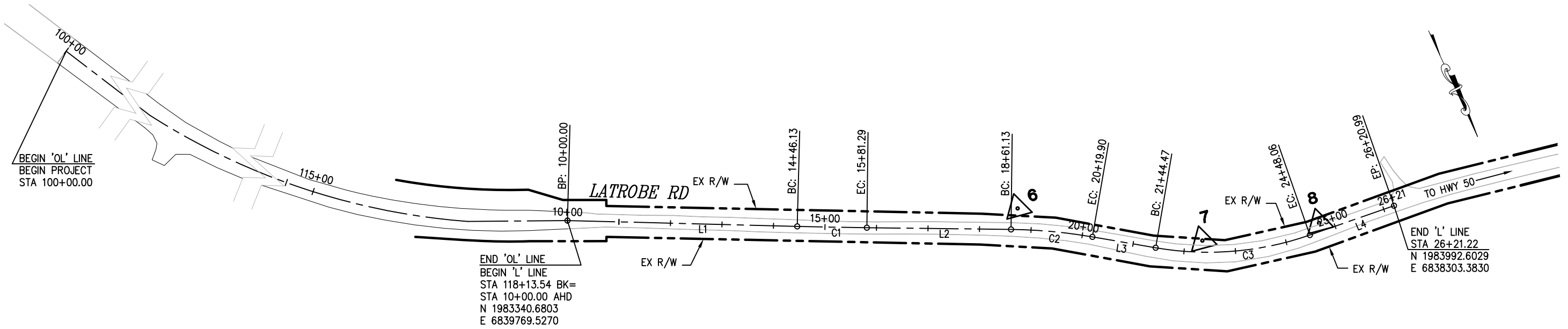

PLAN
SURVEY AND CONTROL POINT

NOTES:
 BEARINGS AND COORDINATES ARE SHOWN ON THE CALIFORNIA STATE COORDINATE SYSTEM, NAD 83 ZONE 2 (US FEET).
 DISTANCES SHOWN ARE GRID DISTANCES. DIVIDE DISTANCES SHOWN BY 0.999878 TO OBTAIN GROUND DISTANCES.

VERTICAL DATUM BASED ON NGVD 1929

X DENOTES CONTROL POINT AND NUMBER.

CONTROL TABLE				
CONTROL NUMBER	NORTHING	EASTING	ELEVATION	DESCRIPTION
6	1983688.5386	6838967.6120	620.28	10" SPIKE
7	1983896.8003	6838669.0888	644.13	10" SPIKE
8	1983961.5131	6838449.4236	644.90	10" SPIKE

ALIGNMENT LINE / CURVE DATA					
NUMBER	LENGTH	RADIUS	CHORD DIRECTION / BEARING	START POINT	END POINT
C1	135.16	10000	NORTH63° 55' 48.34" WEST	1983539.4438, 6839370.1205	1983598.8396, 6839248.7172
C2	158.76	1000	NORTH59° 46' 08.47" WEST	1983720.1216, 6838996.5171	1983799.9735, 6838859.4882
C3	303.59	600	NORTH69° 42' 57.95" WEST	1983871.0346, 6838757.1656	1983975.1616, 6838475.4305
L1	446.13		N63° 32' 34.45" W	1983340.6803, 6839769.5270	1983539.4438, 6839370.1205
L2	279.85		N64° 19' 02.23" W	1983598.8396, 6839248.7172	1983720.1216, 6838996.5171
L3	124.58		N55° 13' 14.71" W	1983799.9735, 6838859.4882	1983871.0346, 6838757.1656
L4	172.93		N84° 12' 41.20" W	1983975.1616, 6838475.4305	1983992.6029, 6838303.3830

SURVEY CONTROL DIAGRAM
SCALE : 1":100'

REVISION	NUMBER	DATE	DESCRIPTION	BY

PREPARED UNDER THE SUPERVISION OF :

 REGISTERED CIVIL ENGINEER
 DATE: _____

DESIGNED: MS
 DRAWN: MS
 CHECKED: LM
 DATE: 03/11/13
 ROAD NUMBER: 18

EL DORADO COUNTY
 DEPARTMENT OF TRANSPORTATION

LATROBE ROAD NORTH OF RYAN
RANCH ROAD

SHEET
CD-1
 2 OF 15
 W.O. No. **73359**

ORIGINAL SCALE IS IN INCHES
 Drawing name: C:\Civil 3D Projects\73359 Latrobe Rd. So of Westel-Oval\Drawings\Sheets\X-1.dwg Layout Tab Layout1 Apr 05, 2013 - 2:56pm msced
 FOR REDUCED PLANS
 2
 1
 0

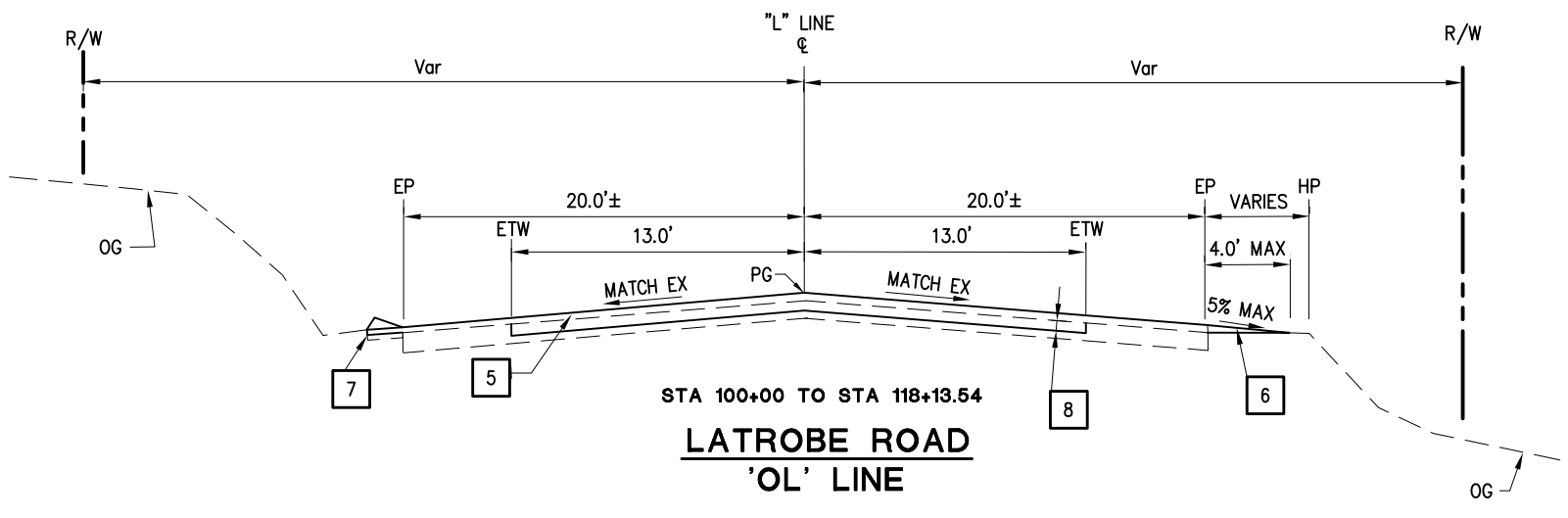
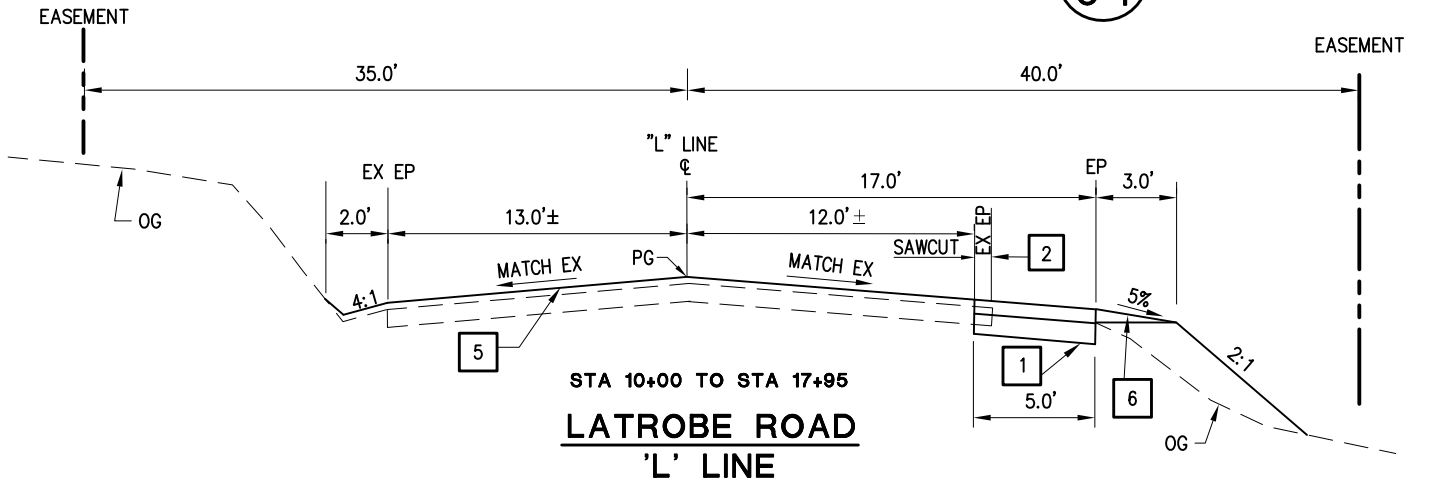
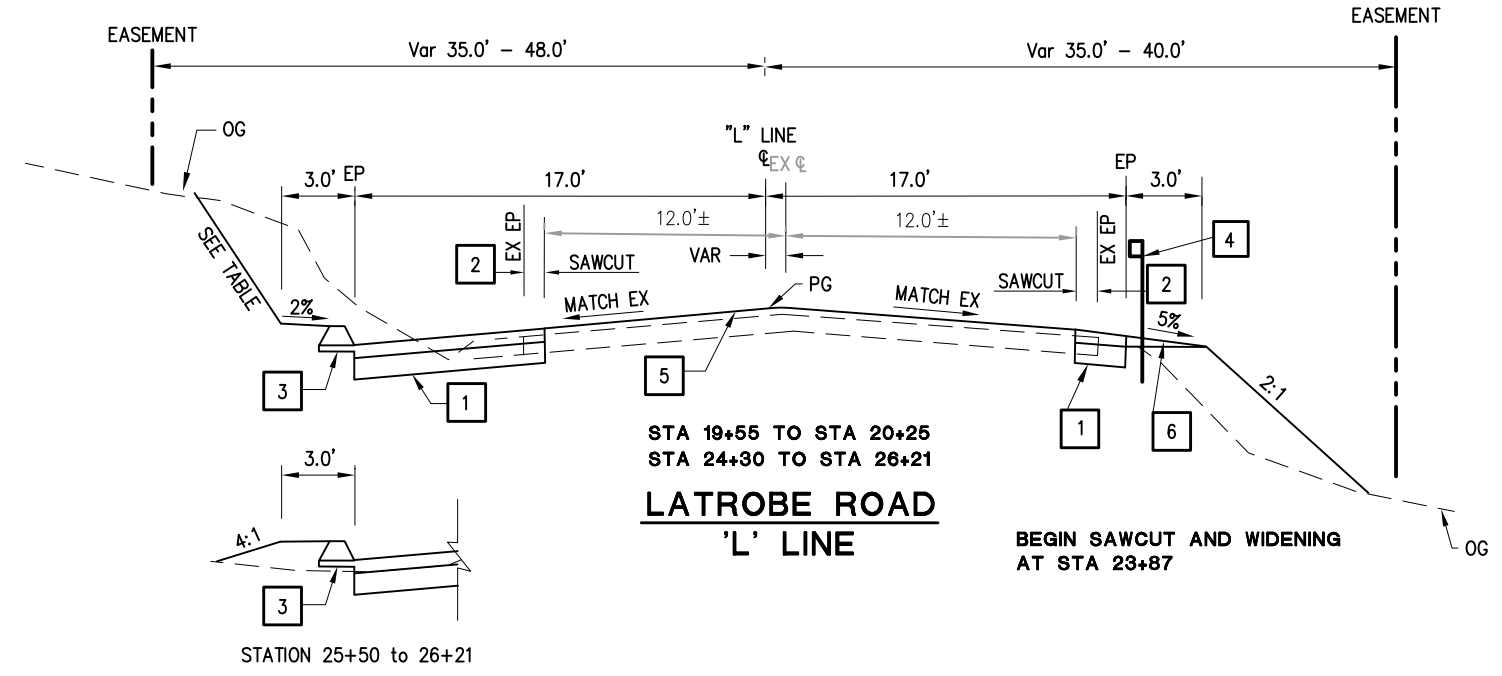
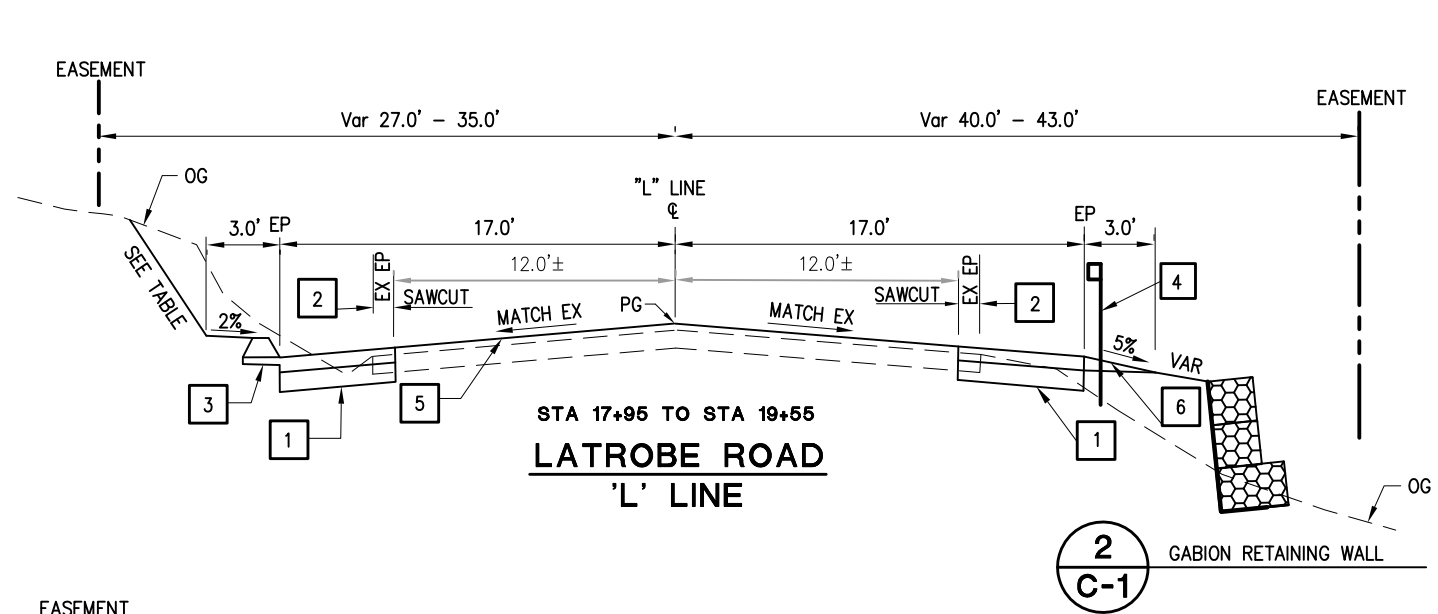

SIDE SLOPE TABLE

STATION	STATION	CUT SLOPE (LT)	FILL SLOPE (RT)
17+80	19+50	1:1	2:1 OR FLATTER
19+50	19+75	TRANSITION 1:1 TO 1.5:1	2:1 OR FLATTER
19+75	22+95	1.5:1	2:1 OR FLATTER
22+95	23+20	TRANSITION 1.5:1 TO 1:1	2:1 OR FLATTER
23+20	26+21	1:1	2:1 OR FLATTER

- 1 - 0.20' HMA (TYPE A) OVERLAY
0.20' HMA (TYPE A) FIRST LIFT
1.20' AB (CLASS 2)
WIDTH VARIES (1'-16')
MATCH EXISTING CROSS SLOPES
REFER TO LAYOUT SHEETS
- 2 - SAWCUT 1.0' TYPICAL FROM EXISTING
EP - REFER TO LAYOUT SHEETS
- 3 - HMA DIKE (TYPE A) REFER TO LAYOUT
SHEET FOR LIMITS - STANDARD
PLAN A87B
- 4 - TYPE 11D LAYOUT
METAL BEAM GUARD RAIL (MBGR)
REFER TO LAYOUT SHEET FOR
LIMITS (STANDARD PLAN A77E2)
INSTALL METAL BEAM GUARD RAIL
DELINEATOR @ 48' INTERVAL
- 5 - 0.2' HMA OVERLAY
- 6 - AT EXISTING SHOULDERS WITHOUT DIKE,
PLACE SHOULDER BACKING FLUSH
WITH HMA OVERLAY. WIDTH IS LESSER
OF TOP OF SLOPE OR 4'
- 7 - REPLACE EXISTING AC DIKE (TYPICAL
TYPE E) WHERE IT OCCURS,
(TYPICAL RIGHT AND LEFT SIDE
- RIGHT SIDE NOT SHOWN)
- 8 - COLD PLANE 0.25' EXISTING HMA
AND REPLACE WITH 0.25' HMA

NOTES:

1- FINAL LIFT OF HMA ON NEW SECTION OF ROADWAY SHALL BE PLACED CONCURRENTLY WITH 0.2' HMA OVERLAY AT THE END OF SC-2

2- NOTE NEW FENCE LOCATION ON LAYOUT SHEET

3- PAVING SHALL BE PERFORMED PRIOR TO MBGR POST INSTALLATION

TYPICAL SECTIONS
SCALE : NO SCALE

REVISION	NUMBER	DATE	DESCRIPTION	BY

PREPARED UNDER THE SUPERVISION OF :
 REGISTERED CIVIL ENGINEER
 DATE: _____

DESIGNED: MS
 CHECKED: RC
 ROAD NUMBER: 18

DRAWN: MS
 DATE: 03/22/13

EL DORADO COUNTY
 DEPARTMENT OF TRANSPORTATION

LATROBE ROAD NORTH OF RYAN
RANCH ROAD

SHEET
X-1
 3 OF 15
 W.O. No. **73359**

ORIGINAL SCALE IS IN INCHES
 Drawing name: C:\Civil 3D Projects\73359 Latrobe Rd. So of Westel-Ovial\Drawings\Sheets\X-2.dwg Layout Tab: Layout1 Apr 05,2013 - 2:53pm msted
 FOR REDUCED PLANS
 2
 1
 0

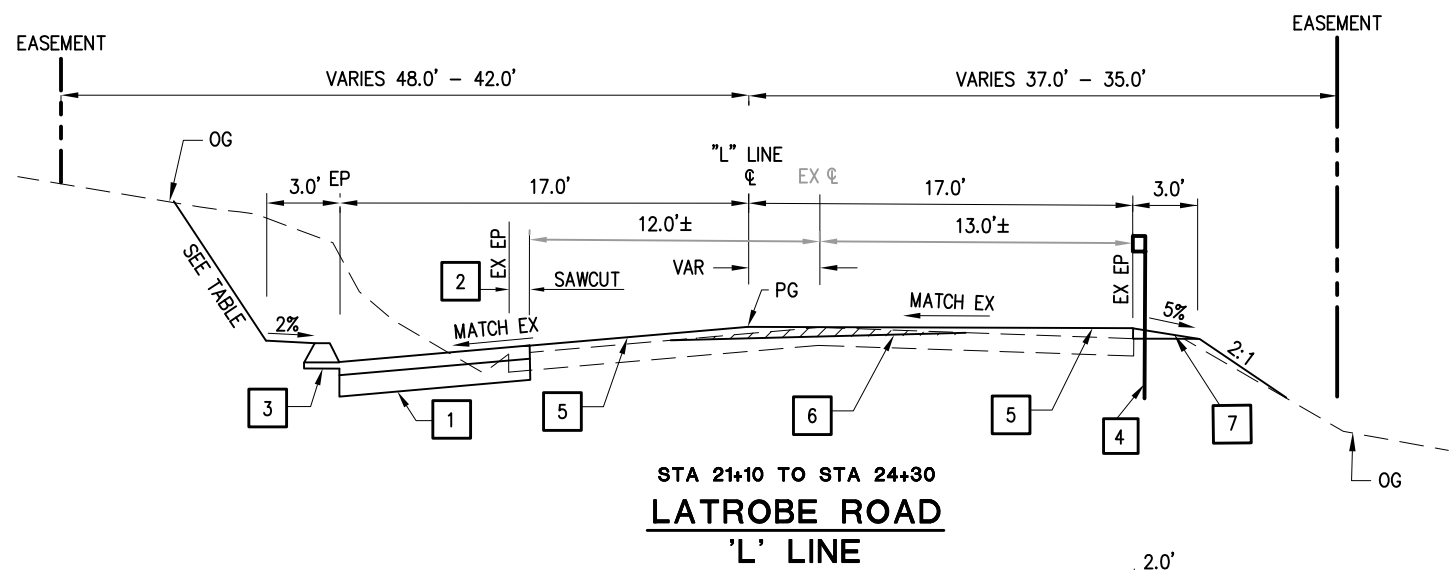

**STA 21+10 TO STA 24+30
LATROBE ROAD
'L' LINE**

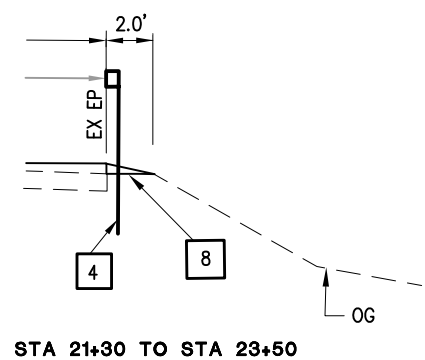

STA 21+30 TO STA 23+50

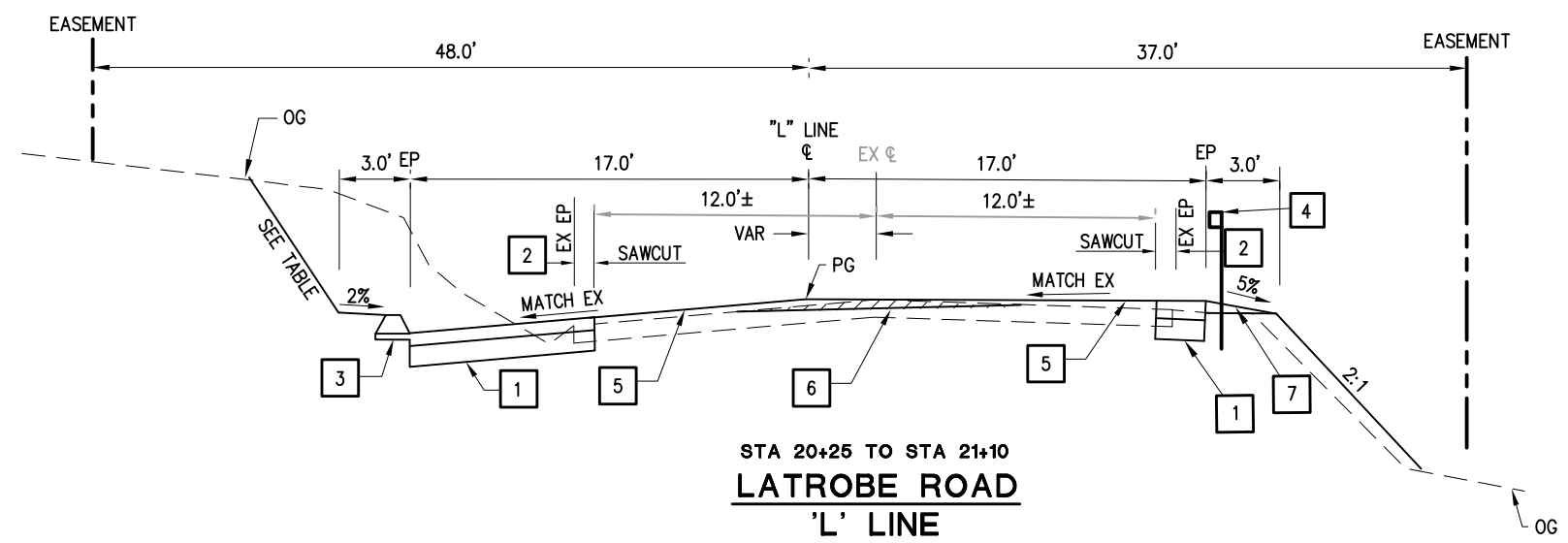

**STA 20+25 TO STA 21+10
LATROBE ROAD
'L' LINE**

SIDE SLOPE TABLE

STATION	STATION	CUT SLOPE (LT)	FILL SLOPE (RT)
17+80	19+50	1:1	2:1 OR FLATTER
19+50	19+75	TRANSITION 1:1 TO 1.5:1	2:1 OR FLATTER
19+75	22+95	1.5:1	2:1 OR FLATTER
22+95	23+20	TRANSITION 1.5:1 TO 1:1	2:1 OR FLATTER
23+20	26+21	1:1	2:1 OR FLATTER

NOTES:

- 1- FINAL LIFT OF HMA ON NEW SECTION OF ROADWAY SHALL BE PLACED CONCURRENTLY WITH 0.2' HMA OVERLAY AT THE END OF SC-2
- 2- NOTE NEW FENCE LOCATION ON LAYOUT SHEET
- 3- COLD PLANE
- 4- NO FILL SLOPE FROM STATION 21+30 TO STATION 23+50. REFER TO THE TYPICAL CROSS SECTION FOR DETAILS
- 5- PAVING SHALL BE PERFORMED PRIOR TO MBGR POST INSTALLATION

- 1 - 0.20' HMA (TYPE A) OVERLAY
0.2'0 HMA (TYPE A) FIRST LIFT
1.20' AB (CLASS 2)
WIDTH VARIES (1'-16')
MATCH EXISTING CROSS SLOPES
REFER TO LAYOUT SHEETS
- 2 - SAWCUT 1.0' TYPICAL FROM EXISTING EP - REFER TO LAYOUT SHEETS
- 3 - HMA DIKE (TYPE A) REFER TO LAYOUT SHEET FOR LIMITS - STANDARD PLAN A87B
- 4 - TYPE 11D LAYOUT
METAL BEAM GUARD RAIL (MBGR)
REFER TO LAYOUT SHEET FOR LIMITS (STANDARD PLAN A77E2)
INSTALL METAL BEAM GUARD RAIL DELINEATOR @ 48' INTERVAL
- 5 - 0.2' HMA OVERLAY
- 6 - REFER TO "L" AND "C" PLAN FOR DETAILS
- 7 - AT EXISTING SHOULDERS WITHOUT DIKE, PLACE SHOULDER BACKING FLUSH WITH HMA OVERLAY. WIDTH IS LESSER OF TOP OF SLOPE OR 4'
- 8 - PLACE HMA CONFORM TO EXISTING GRADE. USE STANDARD PLAN A77C3, DETAIL B

**TYPICAL SECTIONS
SCALE : NO SCALE**

REVISION	NUMBER	DATE	DESCRIPTION	BY

PREPARED UNDER THE SUPERVISION OF :

REGISTERED CIVIL ENGINEER

DATE: _____

DESIGNED: MS
DRAWN: MS
CHECKED: RC
DATE: 03/11/13
ROAD NUMBER: 18

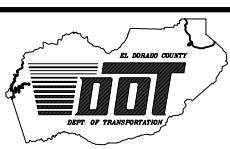

**EL DORADO COUNTY
DEPARTMENT OF TRANSPORTATION**

**LATROBE ROAD NORTH OF RYAN
RANCH ROAD**

SHEET
X-2
4 OF 15
W.O. No. **73359**

ORIGINAL SCALE IS IN INCHES
Drawing name: C:\civil\3d\Projects\73359_Latrobe Rd. So. of Westside\Drawings\Sheets\L-1.dwg Layout Tab: L-1 Apr 05, 2013 - 2:47pm mscsd
FOR REDUCED PLANS

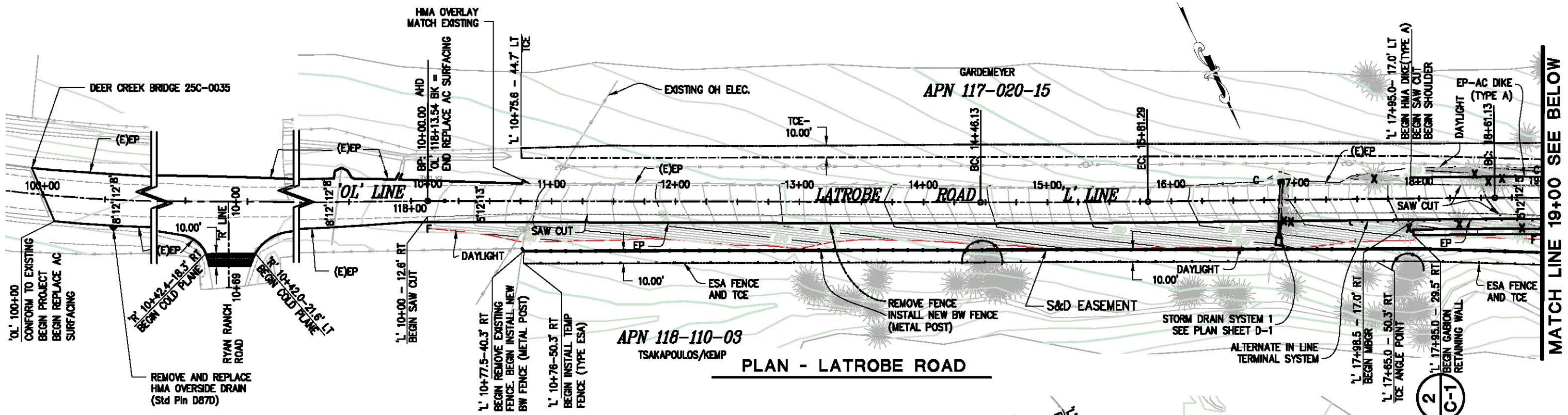

- NOTES:**
- 1- TCE: TEMPORARY CONSTRUCTION EASEMENT
 - 2- X TREE TO BE REMOVED
 - 3- REPLACE BW FENCE AS PER CT STANDARD PLAN A-86
 - 4- UTILITY POLES WITHIN THE PROJECT LIMIT SHALL BE PROTECTED FROM ANY DAMAGES
 - 5- FENCES REMOVED SHALL BE REPLACED AT THE SAME TIME (MAY USE TEMP FENCE AS NECESSARY TO PREVENT LIVE STOCK CROSSING)
 - 6- MBGR SHALL BE TYPE 11D LAYOUT TERMINAL SYSTEM ON BOTH ENDS (TYPE SKT - PER CT STANDARD PLANS)
 - 7- MBGR MAY REQUIRE INSTALLATION IN EXISTING PAVEMENT STRUCTURE
 - 8- INSTALL GUARD RAIL DELINEATION ON MBGR-AS DIRECTED BY THE ENGINEER - SEE X-1 AND X-2
 - 9- COLD PLANE AREA
 - 10- INSTALL TEMP FENCE, TYPE ESA AS SHOWN AND AS DIRECTED BY THE ENGINEER
 - 11- ROADWAY EMBANKMENT IS 1,230 CY. ROADWAY EMBANKMENT IS NOT A SEPARATE PAY QUANTITY. IT IS FOR INFORMATION ONLY
 - 12- HMA OVERSIDE DRAIN

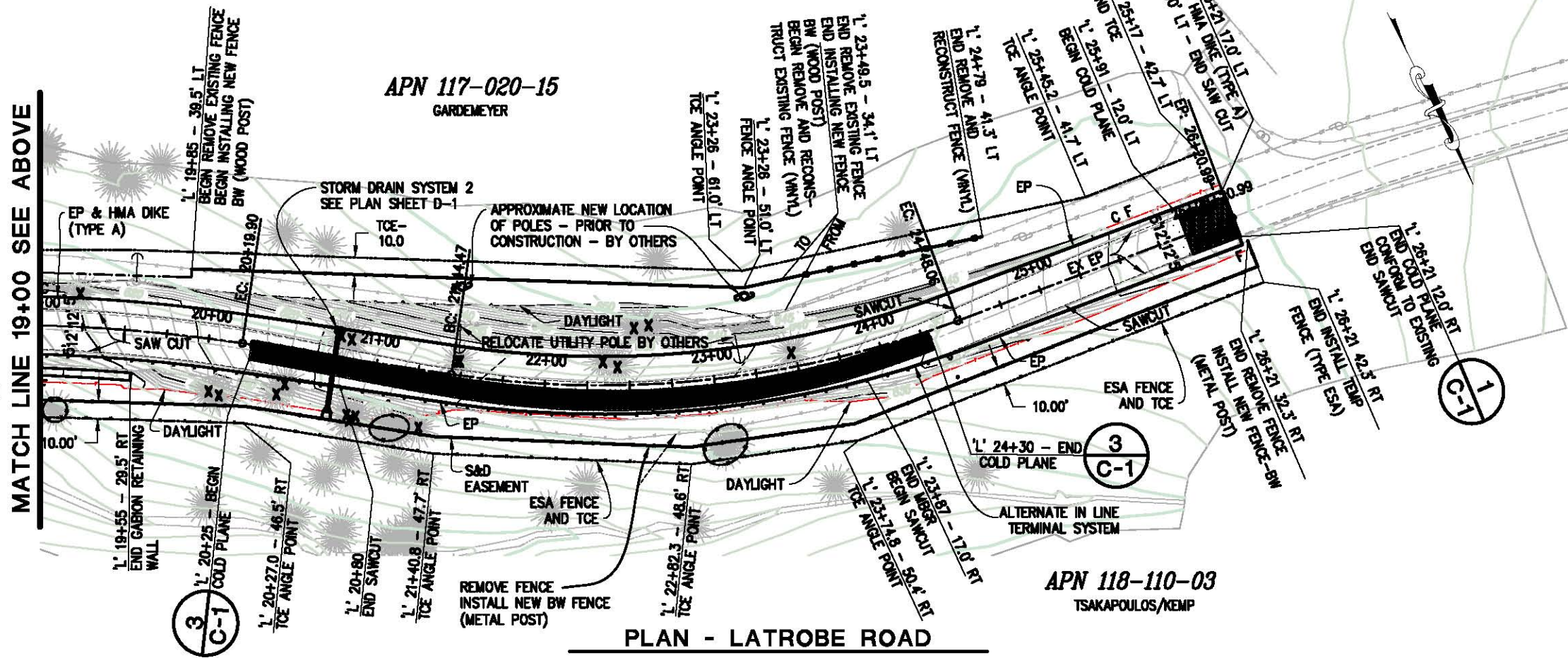

TREE REMOVAL

NO.	STA	TAG NO.	OFFSET(FT)	EA
1	16+91	11532	17.0 RT	1
2	16+97	11531	18.0 RT	1
3	17+64	11533	16.0 LT	1
4	17+92	12014	24.0 RT	1
5	18+33	11530	21.0 RT	1
6	18+44	11534	19.0 LT	1
7	18+55	11535	13.0 LT	1
8	18+66	11536	15.0 LT	1
9	18+75	12013	24.0 RT	1
10	19+22	11537	19.0 LT	1
11	20+03	12011	31.0 RT	1
12	20+09	12010	32.0 RT	1
13	20+45	12005	26.0 RT	1
14	20+48	11529	20.0 RT	1
15	20+77	11528	13.0 LT	1
16	20+84	11527	11.0 LT	1
17	20+86	12004	32.0 RT	1
18	20+89	12003	36.0 RT	1
19	20+92	12002	33.0 RT	1
20	21+29	11489	34.0 RT	1
21	21+48	11526	8.0 LT	2
22	22+34	11525	14.0 LT	1
23	22+43	11524	11.0 LT	1
24	22+53	11523	33.0 LT	1
25	22+60	11513	34.0 LT	1
26	23+48	11522	9.0 LT	1
TOTAL				27

REVISION	NUMBER	DATE	DESCRIPTION

PREPARED UNDER THE SUPERVISION OF:

REGISTERED CIVIL ENGINEER

DATE: _____

DESIGNED: MS
DRAWN: MS
CHECKED: RC
DATE: 03/22/13
ROAD NUMBER: 18

EL DORADO COUNTY
DEPARTMENT OF TRANSPORTATION

LATROBE ROAD NORTH OF RYAN RANCH ROAD

SHEET
L-1
5 OF 15
P.O. No. 73359

ORIGINAL SCALE IS IN INCHES
 Drawing name: C:\Civil 3D Projects\73359 Latrobe Rd. So of Westel-Ovial\Drawings\Sheets\C-1.dwg
 Layout Tab: Layout1
 Mar 21, 2013 - 4:53pm mssed
 FOR REDUCED PLANS

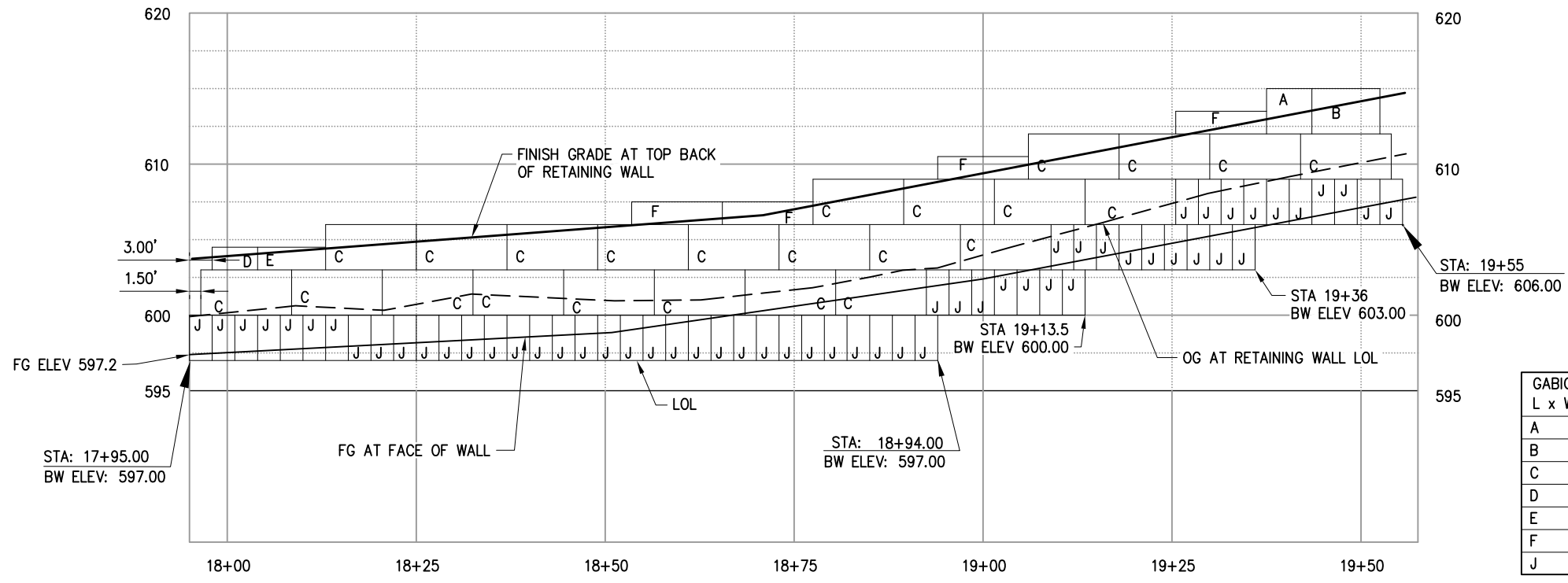

GABION SIZE	
L x W x H (FEET)	
A	6 x 3 x 3
B	9 x 3 x 3
C	12 x 3 x 3
D	6 x 3 x 1.5
E	9 x 3 x 1.5
F	12 x 3 x 1.5
J	3 x 4.5 x 3

CONTRACTOR MAY USE BASKETS OF A DIFFERENT SIZE WITH ENGINEER'S APPROVAL.

2
C-1
GABION RETAINING WALL ELEVATION
SCALE: 1:10 H - 1:5 V

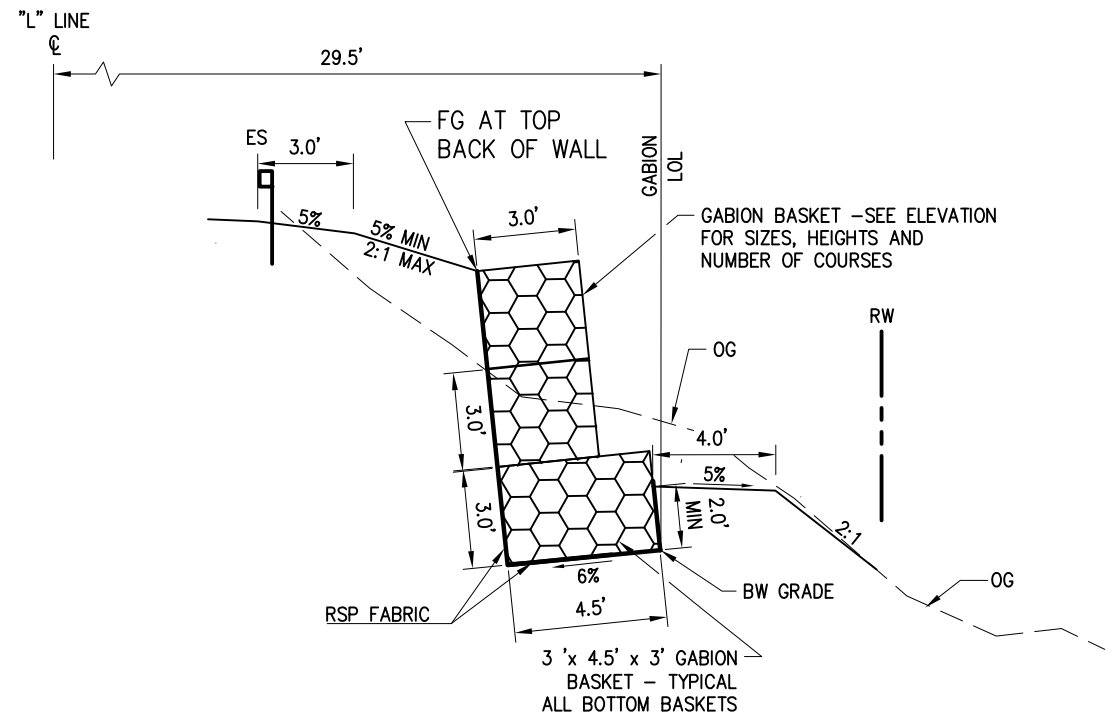

GABION RETAINING WALL SECTION (Typ)
SCALE: 1:30

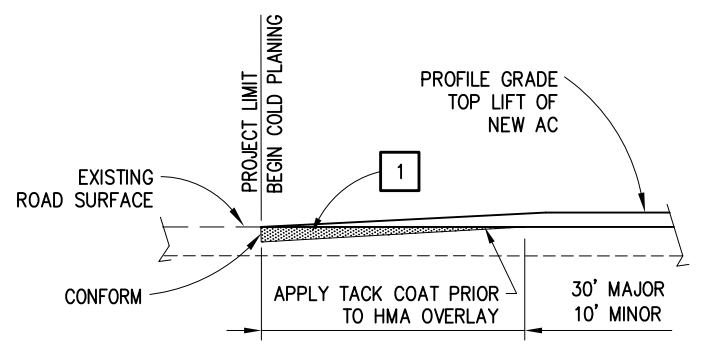
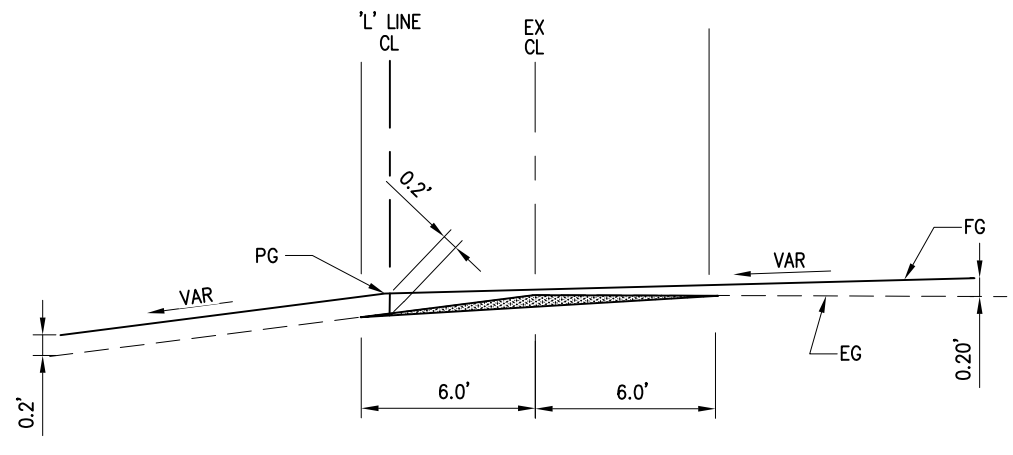

NOTES
1 - COLD PLANE AC 0.2' MAX

PREPARED UNDER THE SUPERVISION OF: REGISTERED CIVIL ENGINEER DATE:	DESIGNED: MS CHECKED: RC ROAD NUMBER: 18	DRAWN: MS DATE: 03/22/13	 EL DORADO COUNTY DEPARTMENT OF TRANSPORTATION	LATROBE ROAD NORTH OF RYAN RANCH ROAD	SHEET C-1 6 OF 15 W.O. No. 73359
--	--	-----------------------------	--	--	---

CONSTRUCTION DETAILS
SCALE: NO SCALE

ORIGINAL SCALE IS IN INCHES
 Drawing name: C:\Civil_3D\Projects\73359 Latrobe Rd. So of Westel-Ovick\Drawings\Sheets\EC-1.dwg Layout Tab: EC-1 Mar 22, 2013 - 7:47am MSeed

FOR REDUCED PLANS
 2
 1
 0

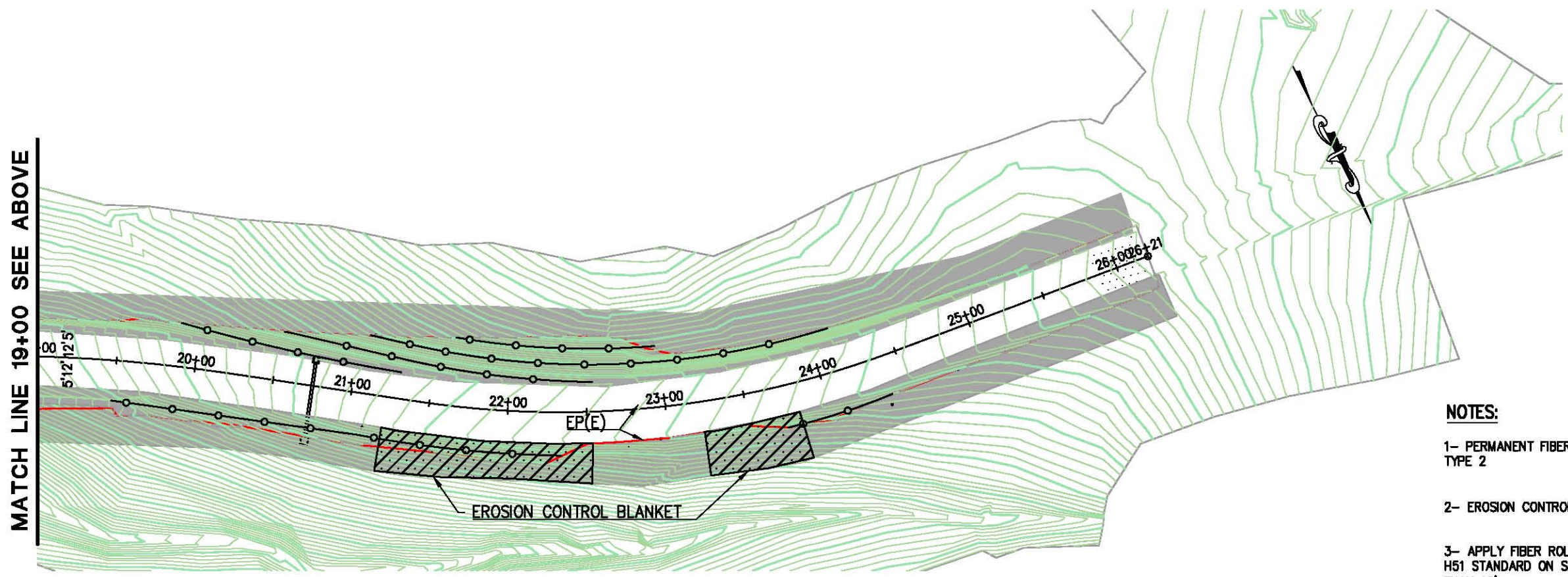
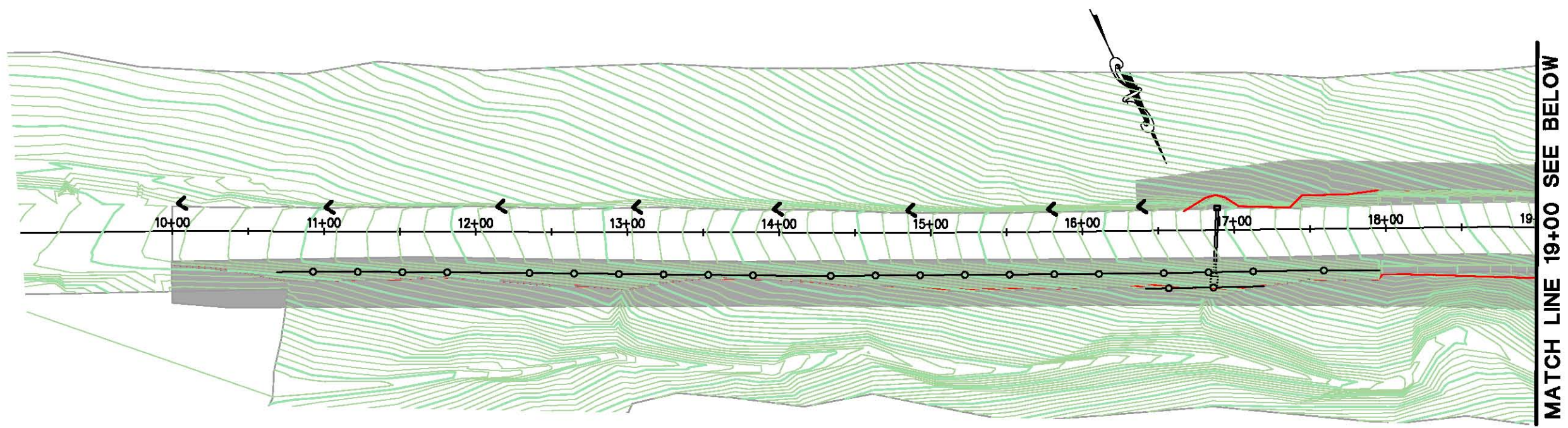

PLAN - LATROBE ROAD

NOTE:
 1- FIBER ROLLS TO BE INSTALLED LEVEL ON CONTOURS. LOCATIONS SHOWN ON THE PLAN ARE APPROXIMATE AND SHALL BE ADJUSTED AS NEEDED DURING CONSTRUCTION.

- NOTES:**
- 1- PERMANENT FIBER ROLL TYPE 2
 - 2- EROSION CONTROL (TYPE D)
 - 3- APPLY FIBER ROLL AS PER RNSP H51 STANDARD ON SLOPES LONGER THAN 10'
 - 4- PERMANENT EROSION CONTROL (TYPE D) SHALL BE APPLIED TO DISTURBED SOIL UP TO TEMPORARY CONSTRUCTION EASEMENT LIMIT

**EROSION CONTROL PLAN
 SCALE : 1" = 40'H**

REVISION	NUMBER	DATE	DESCRIPTION	BY

PREPARED UNDER THE SUPERVISION OF :	DESIGNED: MS	DRAWN: MS
REGISTERED CIVIL ENGINEER	CHECKED: RC	DATE: 03/22/13
DATE:	ROAD NUMBER: 18	



**EL DORADO COUNTY
 DEPARTMENT OF TRANSPORTATION**

**LATROBE ROAD NORTH OF RYAN
 RANCH ROAD**

SHEET	EC-1
7 of 15	
W.O. No.	73359

ORIGINAL SCALE IS IN INCHES
 Drawing name: C:\Civil 3D\Projects\73359 Latrobe Rd. So of Westel-Ovict\Drawings\Sheets\D-1.dwg Layout Tab: D-1 PnP Mar 12, 2013 -- 8:29am MSeed
 FOR REDUCED PLANS

REVISION
 2
 1
 0

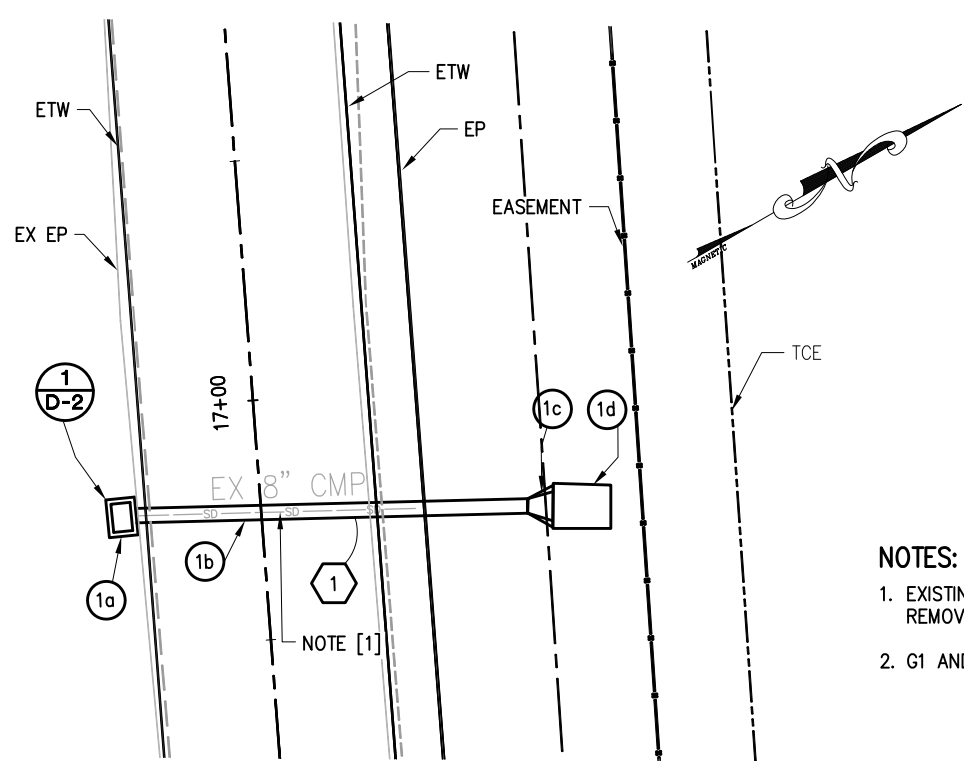

DRAINAGE SYSTEM 1 PLAN
SCALE: 1:10

- NOTES:**
- EXISTING 8" CMP CULVERT TO TO BE REMOVED
 - G1 AND G3 INLETS, PER CT STD PLAN D73

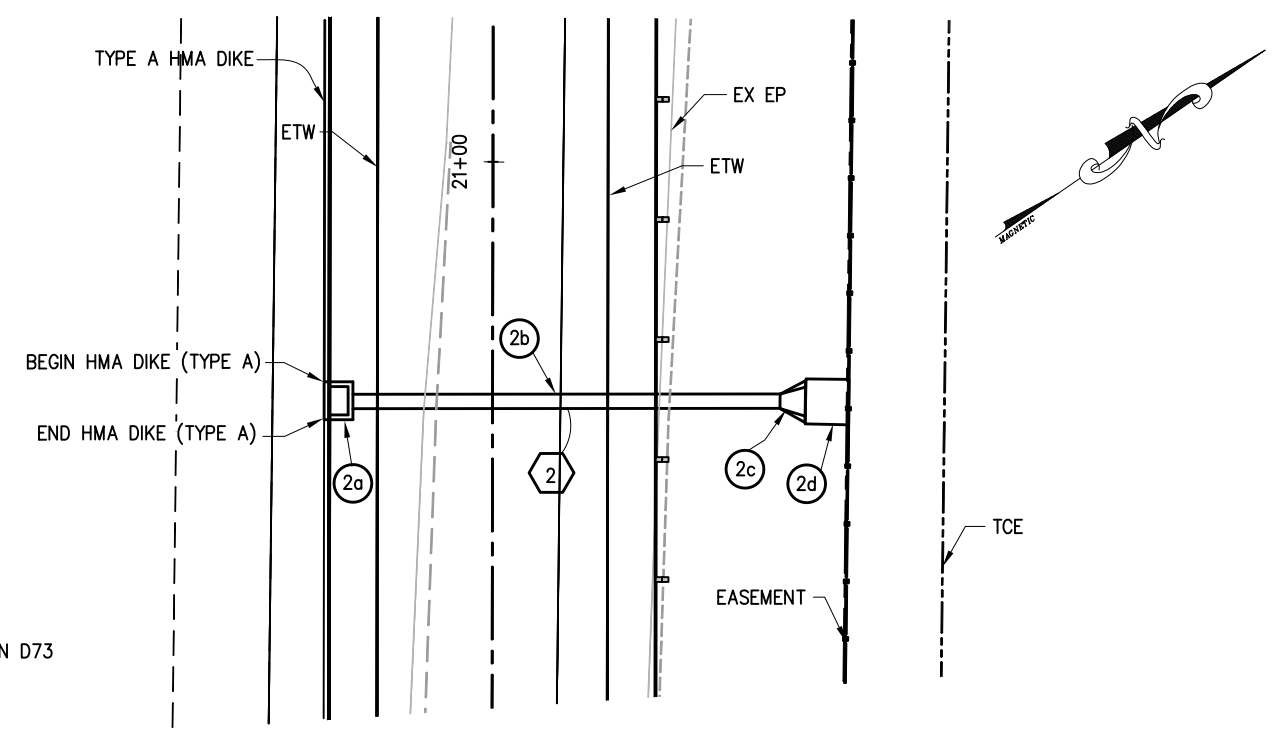

DRAINAGE SYSTEM 2 PLAN
SCALE: 1:10

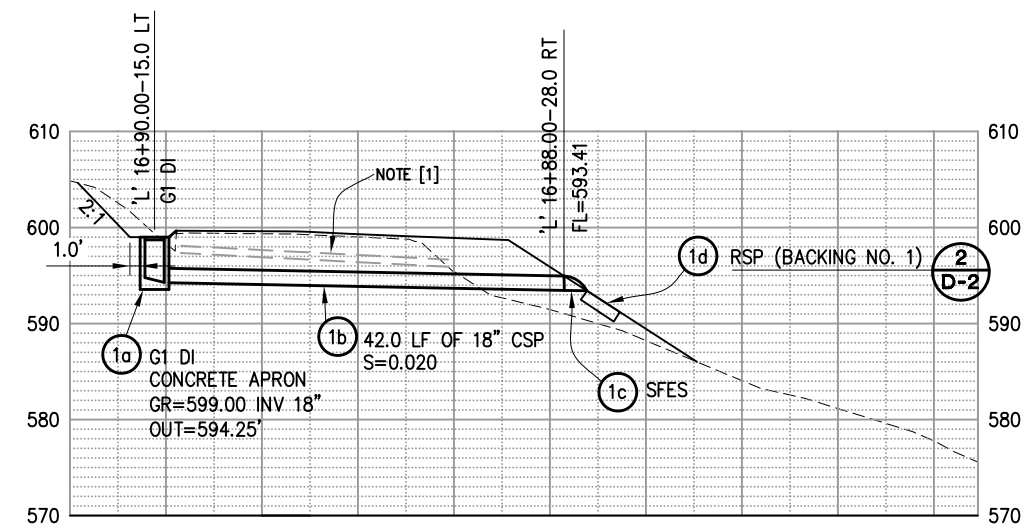

DRAINAGE SYSTEM 1 PROFILE

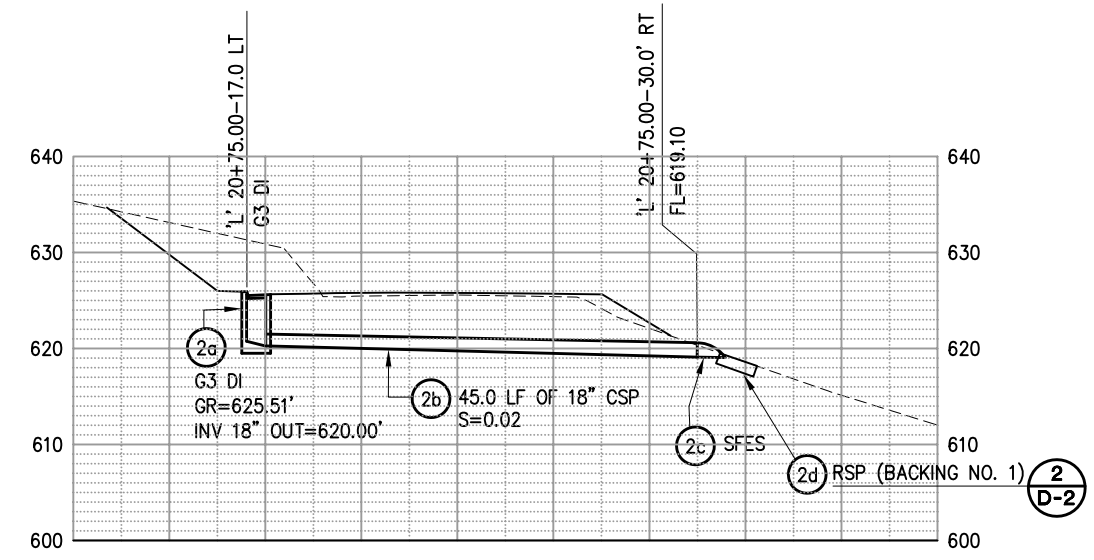

DRAINAGE SYSTEM 2 PROFILE

DRAINAGE PLAN & PROFILES

REVISION	NUMBER	DATE	DESCRIPTION	BY

PREPARED UNDER THE SUPERVISION OF : REGISTERED CIVIL ENGINEER DATE:	DESIGNED: JMW CHECKED: RC ROAD NUMBER: 18	DRAWN: JMW DATE: 03/11/13
---	--	--

EL DORADO COUNTY
 DEPARTMENT OF TRANSPORTATION

LATROBE ROAD NORTH OF RYAN RANCH ROAD

SHEET
D-1
 8 OF 15
 W.O. No. **73359**

ORIGINAL SCALE IS IN INCHES
 Drawing name: C:\Civil 3D\Projects\73359 Latrobe Rd. So of Westel-Ovict\Drawings\Sheets\D-2.dwg Layout Tab: D-2 Details Mar 12, 2013 - 8:30am MSaad
 FOR REDUCED PLANS
 REVISION

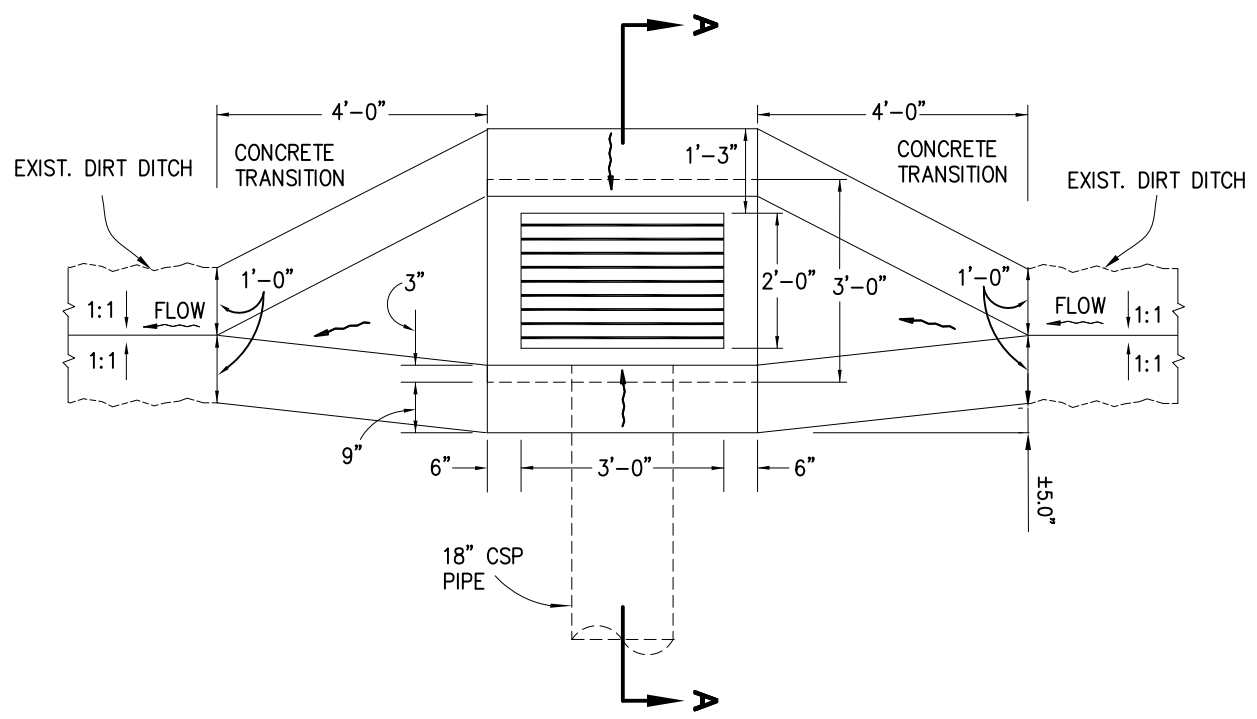

1 G1 INLET DEPRESSION DETAIL

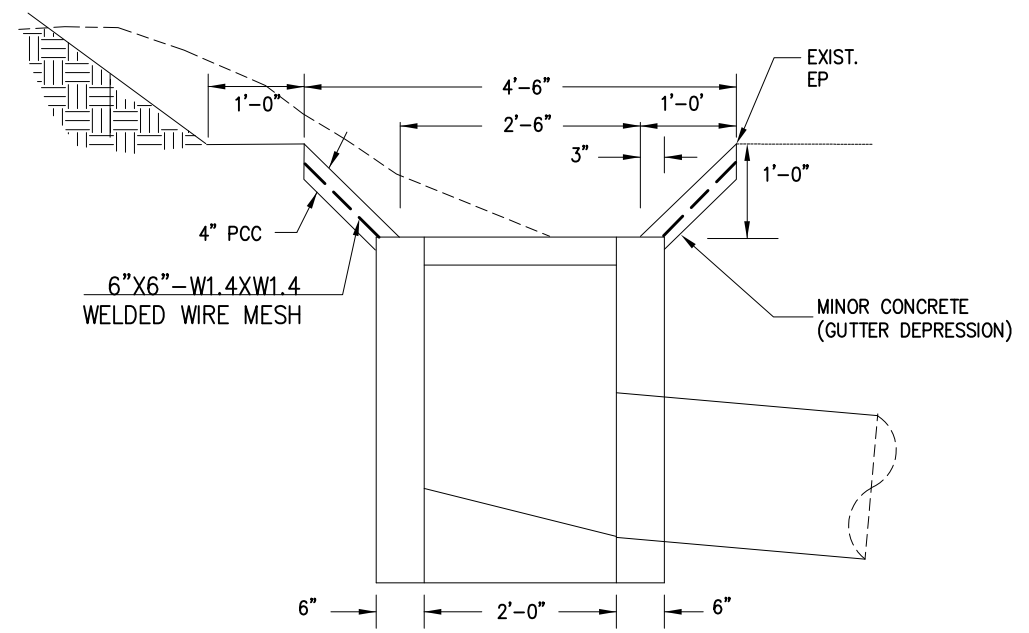

SECTION A-A

DRAINAGE PLAN SHEET NO.	DRAINAGE SYSTEM NO.	DRAINAGE UNIT	18" CSP (0.109" THICK)	TYPE G1 D.I.	TYPE G3 D.I.	STEEL FES	H INLET DEPTH [N]	RSP (BACKING NO. 1)	RSP FABRIC [N]	MINOR CONCRETE GUTTER DEPRESSION FRAME AND GRATE (TYPE 24-9) [N]	DESCRIPTION	STATION	DRAINAGE UNIT	DRAINAGE SYSTEM NO.	DRAINAGE PLAN SHEET NO.	
			FT	EA	EA	EA	FT	CY	FT2	CY						
D-1	1	a	42.0	1			4.75			0.5		'L' 16+90.00-15.0 LT	a	1	D-1	
		b										S=0.020	b			
		c							5.0	176			'L' 16+88.00-28.0 RT			c
		d									1		'L' 20+75.00-17.0 LT			d
	2	a	45.0		1		5.51					'L' 20+75.00-30.0 RT	a	2		
		b											S=0.020			b
		c							5.0	176						c
		d														d
TOTAL			87.0	1	1	2		10.0								

- 1- INLET DEPTH SHALL BE FROM FLOW LINE OF GRATE TO INVERT OUT.
- 2- [N] NOT A PAY QUANTITY, FOR INFORMATION ONLY.

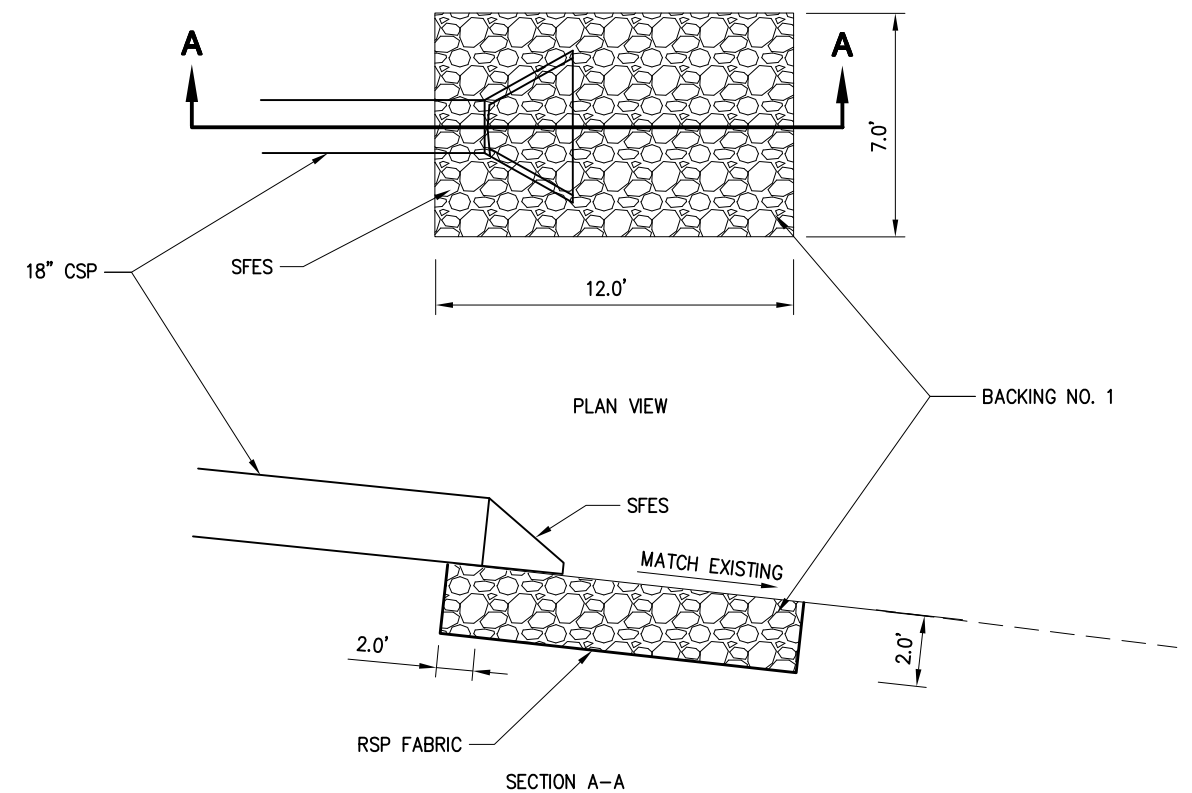

2 RSP-BACKING NO. 1

REFER TO STANDARD PLAN D94A AND STANDARD SPECIFICATIONS FOR DETAILS.

DRAINAGE DETAILS SCALE : NONE

NUMBER	DATE	DESCRIPTION	BY

PREPARED UNDER THE SUPERVISION OF :

REGISTERED CIVIL ENGINEER

DATE: _____

DESIGNED: MS
DRAWN: MS
CHECKED: RC
DATE: 03/11/13
ROAD NUMBER: 18

EL DORADO COUNTY
DEPARTMENT OF TRANSPORTATION

LATROBE ROAD NORTH OF RYAN RANCH ROAD

SHEET **D-2**
 9 OF 15
 W.O. No. **73359**

ORIGINAL SCALE IS IN INCHES
 Drawing name: C:\Civil 3D\Projects\73359 Latrobe Rd. So of Westel-Ovict\Drawings\Sheets\CS-1.dwg
 Layout Tab: CS-1 Mar 12, 2013 8:31am MSaed
 FOR REDUCED PLANS
 REVISION

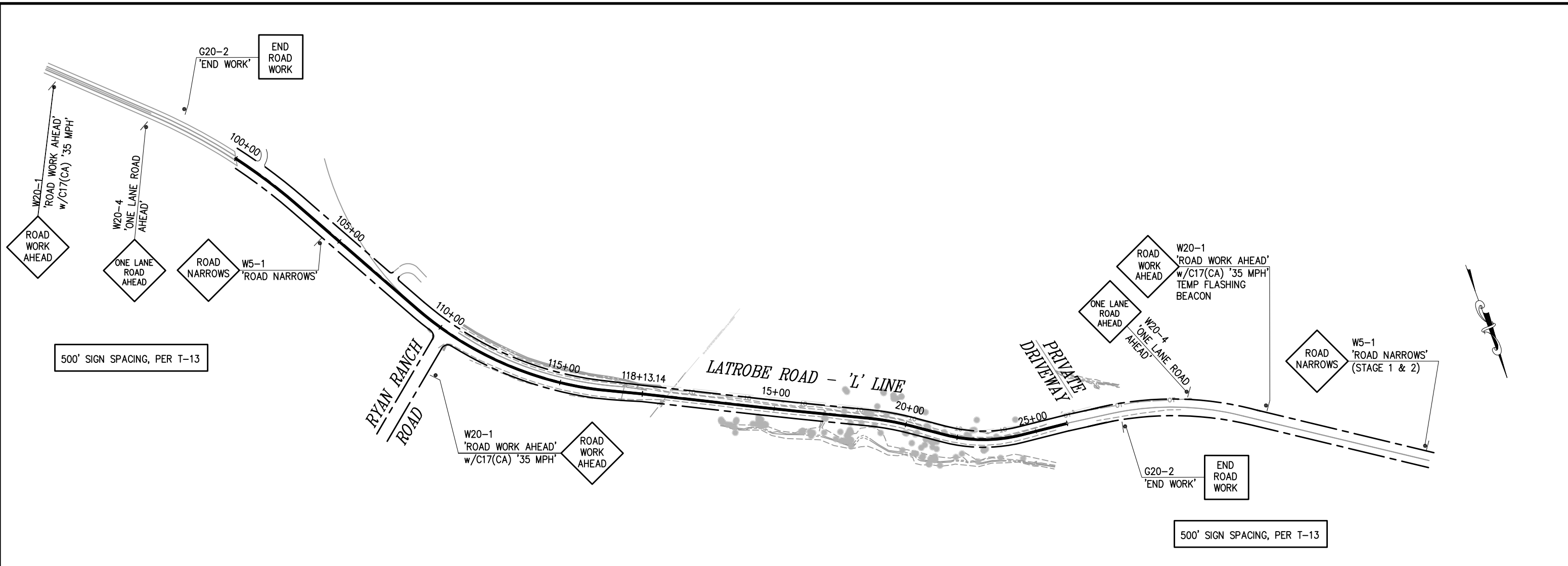

CONSTRUCTION AREA SIGNS					
SIGN	CODE	PANEL SIZE	POST SIZE & LENGTH	INSTALL EA.	STAGE OF CONSTRUCTION
ROAD WORK AHEAD 35 MPH	W20-1 W/ C17/(CA)	36 x 36 24 x 24	4" x 6"	3	ALL
ONE LANE ROAD AHEAD	W20-4	36 x 36	4" x 6"	2	ALL
END ROAD WORK	G20-2	48 x 18	4" x 4"	2	ALL
PCMS	PCMS			2	ALL
ROAD NARROWS	W5-1	36 X 36	4" x 4"	2	ALL

STAGE 1 & 2

NOTE: SIGN LOCATIONS SHOWN ARE APPROXIMATE ONLY.
 EXACT LOCATIONS TO BE DETERMINED BY THE ENGINEER.
 PCMS SIGN LOCATIONS, IN EACH DIRECTION OF TRAFFIC, SHALL BE DETERMINED BY THE ENGINEER.
 "ONE LANE ROAD AHEAD" SIGN SHALL BE COVERED AT ALL TIMES UNLESS THERE IS A REVERSIBLE LANE CLOSURE IN PROGRESS.

CONSTRUCTION AREA SIGNS
 SCALE : NO SCALE

NUMBER	DATE	DESCRIPTION	BY

PREPARED UNDER THE SUPERVISION OF :

 REGISTERED CIVIL ENGINEER
 DATE: _____

DESIGNED: MS
 DRAWN: MS
 CHECKED: RC
 DATE: 03/11/13
 ROAD NUMBER: 18

EL DORADO COUNTY
 DEPARTMENT OF TRANSPORTATION



LATROBE ROAD NORTH OF RYAN RANCH ROAD

SHEET
CS-1
 10 OF 15
 W.O. No. **73359**

ORIGINAL SCALE IS IN INCHES
 Drawing name: C:\Civil 3D\Projects\73359 Latrobe Rd. So of Westel-Ovict\Drawings\Sheets\SC-1.dwg Layout Tab: SC-1 Apr. 04, 2013 8:11am MSoed
 FOR REDUCED PLANS
 REVISION
 NUMBER DATE DESCRIPTION BY

THIS PLAN ACCURATE FOR STAGING AND TRAFFIC HANDLING ONLY. SEE STANDARD PLANS FOR LANE CLOSURE ON HIGHWAYS.

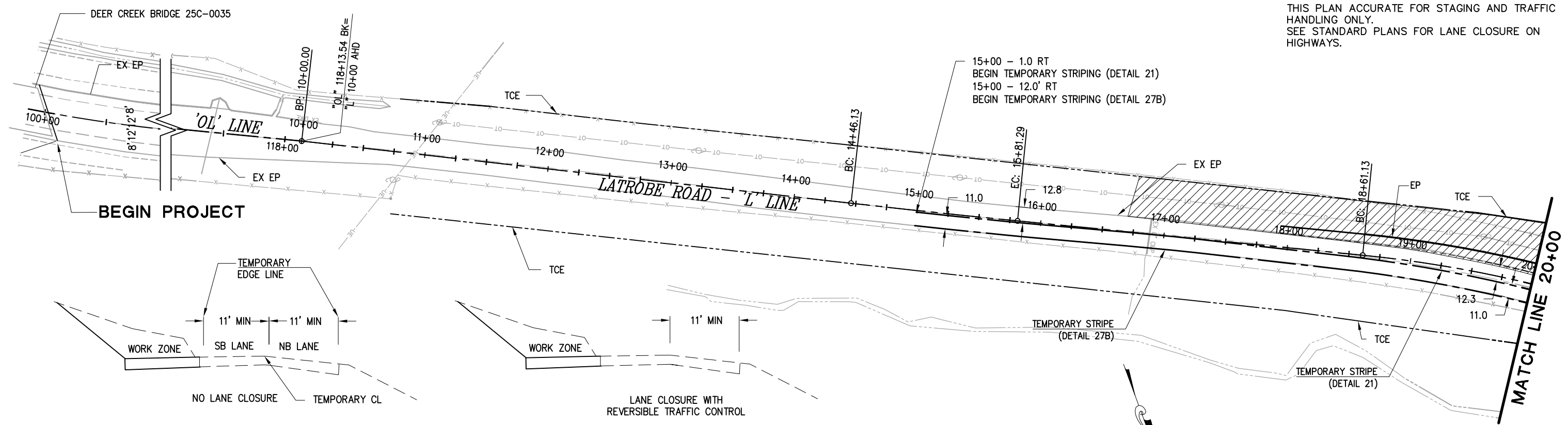

STAGE 1
TYPICAL LANE CONFIGURATION

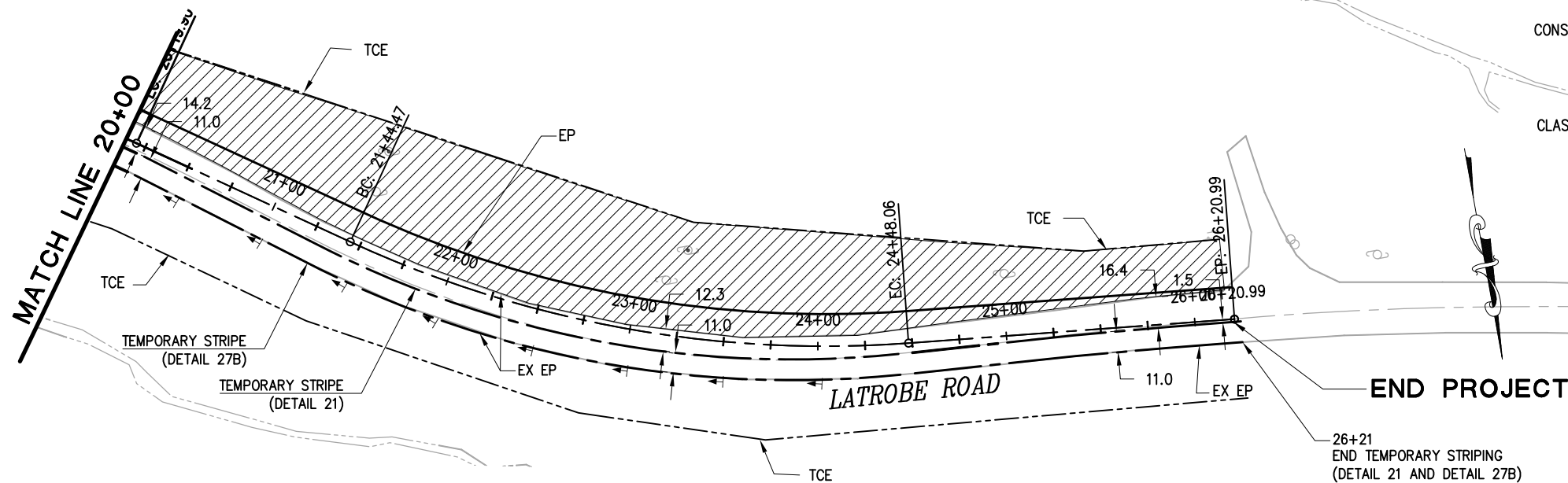

STAGE 1
SCALE: 1"=40'

LEGEND:

- CONSTRUCTION WORK ZONE
- CLASS I DELINEATOR (TYPE E)

NOTES:

- 1- LANE CLOSURE WITH REVERSIBLE TRAFFIC CONTROL PERMITTED DURING ACTIVE CONSTRUCTION OPERATIONS ONLY. MAINTAIN TWO 11' (MINIMUM) LANES AT ALL OTHER TIMES.
- 2- INSTALL TEMPORARY MARKER/ DELINEATOR (CL 1 TYPE E) AT OUTSIDE EP FROM STA 20+50 TO STA 24+00.
- 3- COMPLETELY REMOVE ALL EXISTING STRIPING, MARKING AND SIGNS THAT CONFLICT WITH TEMPORARY STRIPING TO SATISFACTION OF THE ENGINEER, PRIOR TO INSTALLING TEMPORARY STRIPING. TEMPORARY TRAFFIC STRIPE SHALL BE REMOVED AT THE END OF STAGE 1 CONSTRUCTION.
- 4- INSTALL A 4:1 OR FLATTER TEMPORARY TAPER IF A DIFFERENCE OF 0.15 FOOT EXISTS BETWEEN THE ELEVATION OF THE EXISTING PAVEMENT AND THE ELEVATION OF THE EXCAVATION AT THE END OF EACH WORKING DAY.

STAGE CONSTRUCTION
STAGE 1
SCALE : AS SHOWN

PREPARED UNDER THE SUPERVISION OF :	DESIGNED: MS	DRAWN: MS
REGISTERED CIVIL ENGINEER	CHECKED: RC	DATE: 03/11/13
DATE:	ROAD NUMBER: 18	

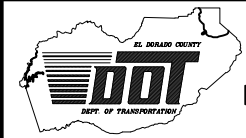

EL DORADO COUNTY
DEPARTMENT OF TRANSPORTATION

LATROBE ROAD NORTH OF RYAN
RANCH ROAD

SHEET
SC-1
11 OF 15
W.O. No. **73359**

THIS PLAN ACCURATE FOR STAGING AND TRAFFIC CONTROL HANDLING ONLY.
SEE STANDARD PLANS FOR LANE CLOSURE ON HIGHWAYS.

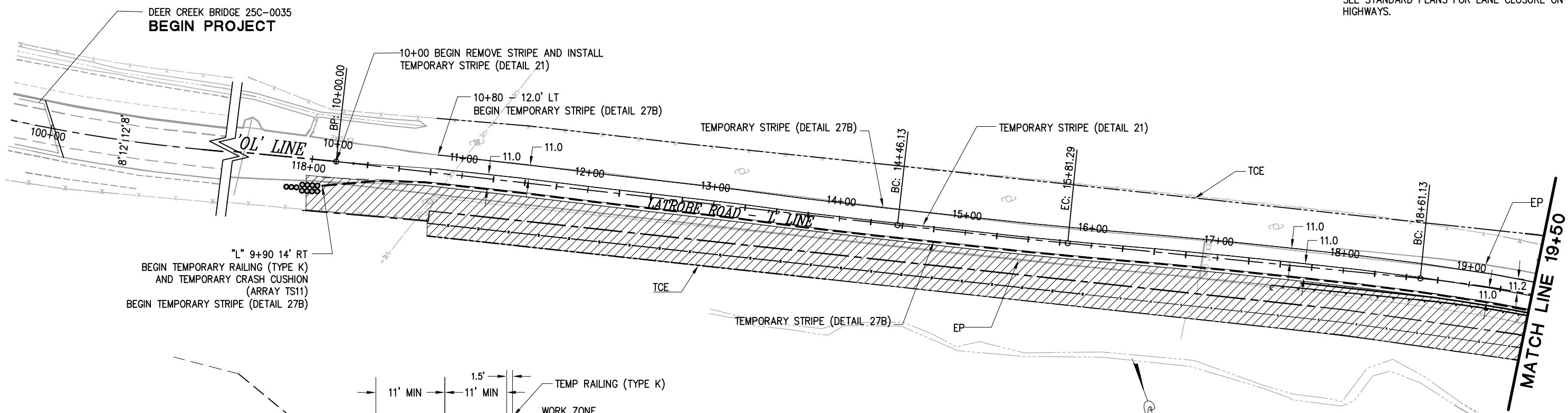

**STAGE 2
TYPICAL LANE CONFIGURATION**

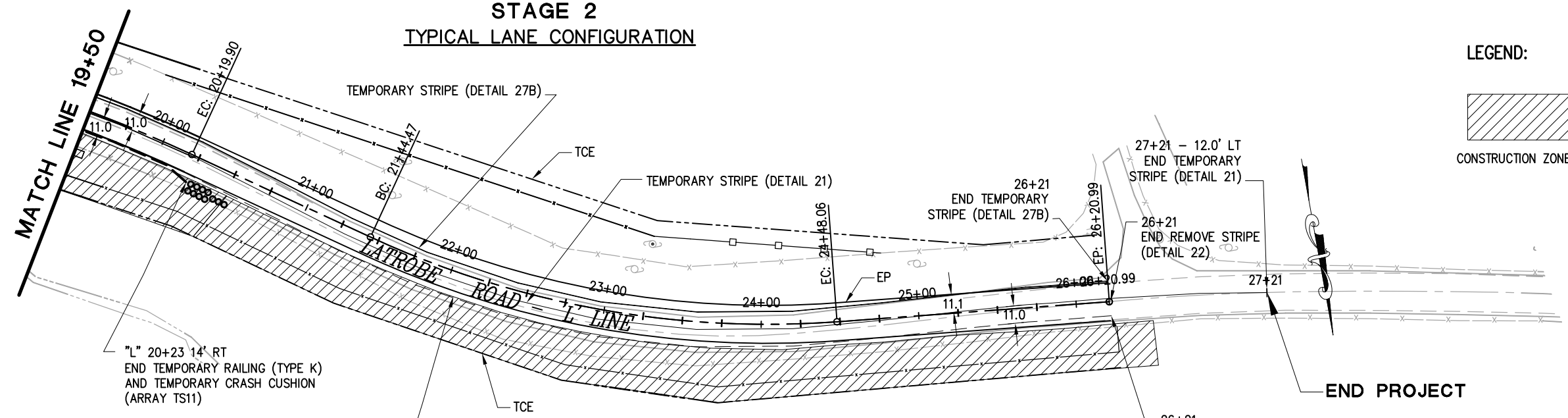
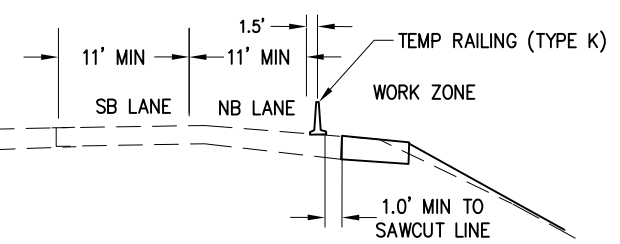

**STAGE 2
SCALE: 1"=40'**

LEGEND:

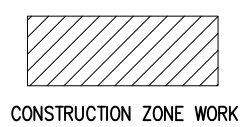

NOTES:

- 1- LANE CLOSURE WITH REVERSIBLE TRAFFIC CONTROL PERMITTED DURING ACTIVE CONSTRUCTION OPERATIONS ONLY. MAINTAIN TWO 11' (MINIMUM) LANES AT ALL OTHER TIMES.
- 2- TEMP CRASH CUSHION SHALL BE ARRAY "TS11"
- 3- TRAFFIC HANDLING FOR PAVING OPERATIONS NOT INCLUDED IN PLAN
- 4- ENTIRELY REMOVE ALL EXISTING STRIPING, MARKING AND SIGNS THAT CONFLICT WITH TEMPORARY STRIPING TO SATISFACTION OF THE ENGINEER, PRIOR TO INSTALLING TEMPORARY STRIPING. TEMPORARY TRAFFIC STRIPE SHALL BE REMOVED AT THE END OF STAGE 2 CONSTRUCTION

**STAGE CONSTRUCTION
STAGE 2
SCALE : AS SHOWN**

ORIGINAL SCALE IS IN INCHES
Drawing name: C:\Civil 3D\Projects\73359 Latrobe Rd. So of Westel-Ovict\Drawings\Sheets\SC-2.dwg Layout Tab: SC-2 Apr 04, 2013 8:20am MSced
FOR REDUCED PLANS

REVISION	NUMBER	DATE	DESCRIPTION	BY

PREPARED UNDER THE SUPERVISION OF :	DESIGNED: MS	DRAWN: MS
REGISTERED CIVIL ENGINEER	CHECKED: RC	DATE: 03/22/13
DATE:	ROAD NUMBER: 18	

EL DORADO COUNTY
DEPARTMENT OF TRANSPORTATION

**LATROBE ROAD NORTH OF RYAN
RANCH ROAD**

SHEET
SC-2
12 OF 15
W.O. No. **73359**

ORIGINAL SCALE IS IN INCHES
 Drawing name: C:\Civil 3D Projects\73359 Latrobe Rd. So of West-Ovict\Drawings\Sheets\SC-3.dwg Layout Tab: SC-3 Mar 12, 2013 9:13am msced
 FOR REDUCED PLANS
 REVISION
 NUMBER DATE DESCRIPTION BY



TEMPORARY TRAFFIC STRIPE (PAINT)				
LOCATION	'L' LINE	DETAIL NO. (STD PLANS)	LENGTH	DESCRIPTION
			FT	
LATROBE ROAD STA 15+00 - 26+21		21 - A20A	1,121	CENTERLINE 2 DIRECTION
LATROBE ROAD STA 15+00 - 26+21		27B - A20B	1,121	EDGE LINE 1 DIRECTION
LATROBE ROAD STA 10+00 - 27+21		21 - A20A	1,721	CENTERLINE 2 DIRECTION
LATROBE ROAD STA 10+00 - 26+21		27B - A20B	3,242	EDGE LINE 1 DIRECTION
TOTAL			7,205	

TEMPORARY DELINEATOR		
CLASS 1 TYPE E		
LOCATION	'L' LINE	EA
STA 20+50 - 24+00		8
TOTAL		8

TEMPORARY RAIL		
TYPE K SHALL INCLUDE TOP MOUNTED REFLECTORS		
LOCATION	'L' LINE	FT
STA 10+00 - 20+23		1,023
TOTAL		1,023

TEMPORARY CRASH CUSHIONS		
ARRAY TS11 PER STD PLAN - T2		
LOCATION	'L' LINE	MODULE (EA)
STA 10+00 - 11' RT		11
STA 20+00 - 11' RT		11
TOTAL		22

REMOVE TRAFFIC STRIPE		
THERMOPLASTIC		
LOCATION	'L' LINE	EA
STA 10+00 - 26+21		1,621
TOTAL		1,621

STAGE CONSTRUCTION
SCALE : NO SCALE

PREPARED UNDER THE SUPERVISION OF :

REGISTERED CIVIL ENGINEER

DATE:

DESIGNED: MS
DRAWN: MS
CHECKED: RC
DATE: 03/11/13
ROAD NUMBER: 18

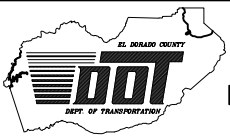

EL DORADO COUNTY
DEPARTMENT OF TRANSPORTATION

LATROBE ROAD NORTH OF RYAN
RANCH ROAD

SHEET
SC-3
13 OF 15
W.O. No. 73359

ORIGINAL SCALE IS IN INCHES
 Drawing name: C:\Civil 3D\Projects\73359 Latrobe Rd. So of Westel-Ovick\Drawings\Sheets\SPD-1.dwg Layout Tab: SPD-1 Mar 12, 2013 8:19am MSeed
 FOR REDUCED PLANS

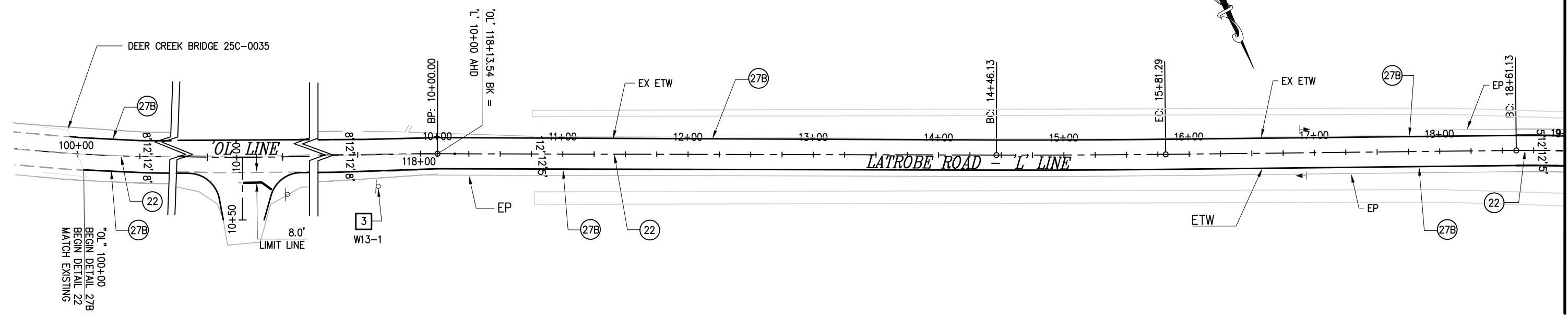

MATCH LINE 19+00 SEE BELOW

MATCH LINE 19+00 SEE ABOVE

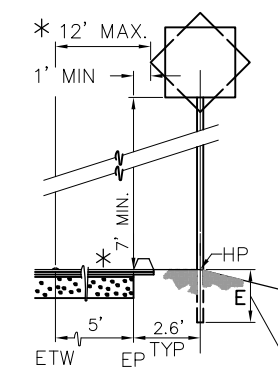
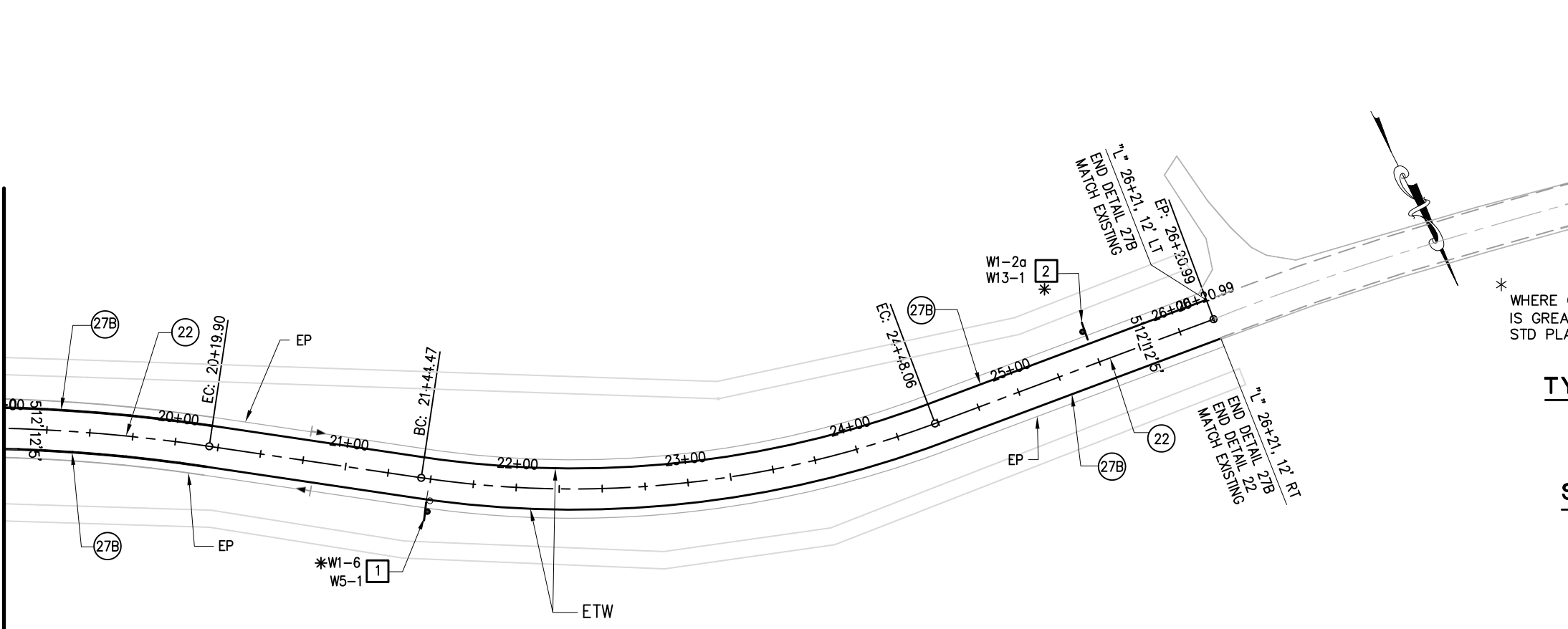

NOTE:
 WHERE HP OF EMBANKMENT SLOPE STEEPER THAN 4:1 (VERT: HORIZ) IS LESS THAN 2' FROM SIGN POST, "E" DISTANCE SHALL BE INCREASED BY 1/3

* WHERE CLEARANCE FROM ETW IS GREATER THAN 12', USE STD PLAN RS-1

TYPICAL SIGN LOCATION DETAIL

N.T.S.
 SEE ALSO STD PLAN RS-2

SIGNING AND STRIPING LEGEND

- (No) PAVEMENT DELINEATION DETAIL NO.
- [No] SIGN NUMBER
- EXIST. SIGN
- INSTALL SIGN
- ▬ INSTALL CULVERT MARKER
- *

SIGNING AND PAVEMENT DELINEATION
 SCALE : 1" = 40'H

REVISION	NUMBER	DATE	DESCRIPTION	BY

PREPARED UNDER THE SUPERVISION OF :	DESIGNED: MS	DRAWN: MS
REGISTERED CIVIL ENGINEER	CHECKED: RC	DATE: 03/11/13
DATE:	ROAD NUMBER: 18	



EL DORADO COUNTY
 DEPARTMENT OF TRANSPORTATION

LATROBE ROAD NORTH OF RYAN RANCH ROAD

SHEET	SPD-1
14 OF 15	
W.O. No.	73359

ORIGINAL SCALE IS IN INCHES
 Drawing name: C:\Civil 3D\Projects\73359 Latrobe Rd. So of West-Ovick\Drawings\Sheets\SPD-2.dwg Layout Tab: Layout1 Mar 12, 2013 -- 8:18am MSeed
 FOR REDUCED PLANS
 2
 1
 0

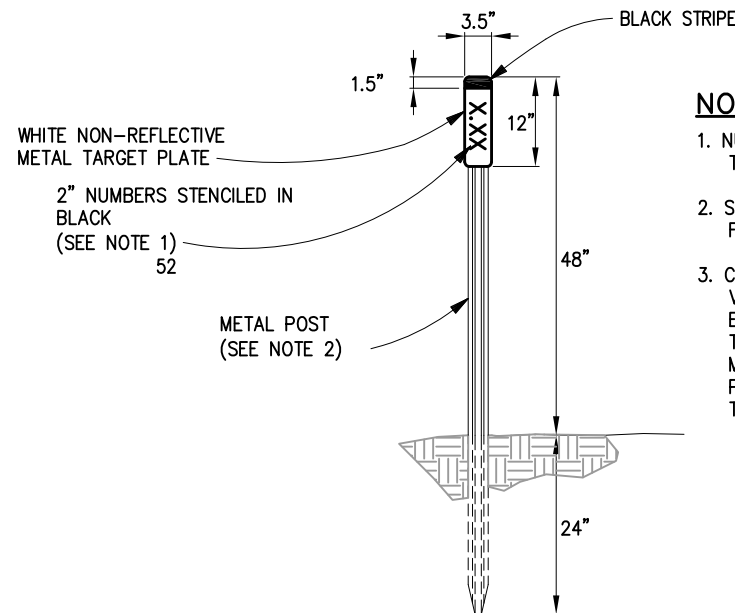
THERMOPLASTIC TRAFFIC STRIPE (SPRAYABLE)				THERMOPLASTIC PAVEMENT MARKING			
STATION	PAVEMENT MARKER (REFLECTIVE) EA		DETAIL NO. (STD PLANS)	DESCRIPTION	4"		12"
	TYPE D	TYPE G			WHITE (LF)	YELLOW (LF)	WHITE (SQFT)
'OL' 100+00 TO 118+13.5	154		22 - A20A	CENTERLINE		1,814	
'L' 10+00 TO 26+21	138		22 - A20A	CENTERLINE		1,621	
'R' 10+20				LIMIT LINE			20
'OL' 100+00 TO 118+13.5 LT & RT			27B - A20B	EDGE LANE	3,627		
'L' 10+00 TO 26+21 LT & RT			27B - A20B	EDGE LANE	3,242		
TOTAL	292				6,869	3,435	20



NOTES:

1. NUMBERS AS DESIGNATED BY THE ENGINEER.
2. SEE STANDARD PLAN A73B FOR METAL POST DETAILS.
3. CONTRACTOR SHALL FIELD VERIFY MILE POST WITH ENGINEERS APPROVAL PRIOR TO ORDERING AND PLACING METAL TARGET PLATES. MILE POST IS APPROXIMATE ON THESE PLANS.

OBJECT MARKER (CULVERT)

N.T.S.

ROADWAY SIGN SUMMARY							
SIGN NO.	SIGN MESSAGE	CALIFORNIA (CA) CODE	ROADSIDE SIGNS			EXISTING LOCATION	PROPOSED LOCATION
			PANEL SIZE (IN)	REMOVE (EA)	ONE POST (EA)		
1	ARROW	W1-6	24 X 12	1	1	21+50-14' RT	21+50-19.5' RT
1	ROAD NARROWS	W5-1	24 X 12		1	21+50-14' RT	21+50-19.5' RT
2	ARROW	W1-2a	30 X 30	1	1	25+50-18' LT	25+50-19.5' LT
2	40 MPH	W13-1	30 X 30	1	1	25+50-18' LT	25+50-19.5' LT
3 **	40 MPH	W13-1	30 X 30	1	1		
TOTAL				4	5		

** REMOVE AND SALVAGE, EXISTING 35 MPH SIGN PANEL. INSTALL NEW 40 MPH SIGN PANEL.

SIGNING AND PAVEMENT DELINEATION
SCALE : NO SCALE

REVISION	NUMBER	DATE	DESCRIPTION	BY

PREPARED UNDER THE SUPERVISION OF :

DESIGNED: MS DRAWN: MS
 CHECKED: RC DATE: 03/11/13
 ROAD NUMBER: 18

REGISTERED CIVIL ENGINEER

DATE:

EL DORADO COUNTY
 DEPARTMENT OF TRANSPORTATION



LATROBE ROAD NORTH OF RYAN
 RANCH ROAD

SHEET
 SPD-2
 15 OF 15
 W.O. No. 73359