

PFF:km  
BrownRez  
07/28/10



ORDINANCE NO. 4950

**THE BOARD OF SUPERVISORS OF THE COUNTY OF EL DORADO DOES  
ORDAIN AS FOLLOWS:**

**RELATED TO REZONING IN THE GRIZZLY FLAT AREA  
PETITIONED BY CHRISTINE BROWN**

Section 1. The Official Zoning Map for the Grizzly Flat Area is hereby amended to rezone the following described lands from Residential Agricultural-40 (RA-40) zone to Estate Residential Five-Acre (RE-5) and Estate Residential (RE-10) zone as shown on Exhibit A attached hereto:

Grizzly Flat Area

Assessor's Parcel No. 041-040-15, being described as Section 14,  
Township 9 North, Range 13 East, M.D.M., consisting of 75.7  
acres

Section 2. This ordinance shall take effect and shall become effective thirty (30) days following the adoption hereof.

PASSED AND ADOPTED by the Board of Supervisors of the County of El Dorado at a regular meeting of said Board, held on the 14 day of September, 2010, by the following vote of said Board:

Ayes: Raymond J. Nutting, Norma Santiago  
John Knight, James R. Sweeney, Ron Briggs

ATTEST  
SUZANNE ALLEN DE SANCHEZ  
Clerk of the Board of Supervisors

By *Suzanne Allen de Sanchez*  
Deputy Clerk

Noes: none  
Absent: none

*Norma Santiago*  
Chairman, Board of Supervisors  
Norma Santiago

I CERTIFY THAT:  
THE FOREGOING INSTRUMENT IS A CORRECT COPY OF THE ORIGINAL ON FILE IN THIS OFFICE

Date \_\_\_\_\_  
ATTEST: SUZANNE ALLEN DE SANCHEZ, Clerk of the Board of Supervisors  
of the County of El Dorado, State of California.

By \_\_\_\_\_  
Deputy Clerk

**EXHIBIT A**

**Breeden Estates**  
**File Nos. A10-0001/Z09-0003/TM09-1488**

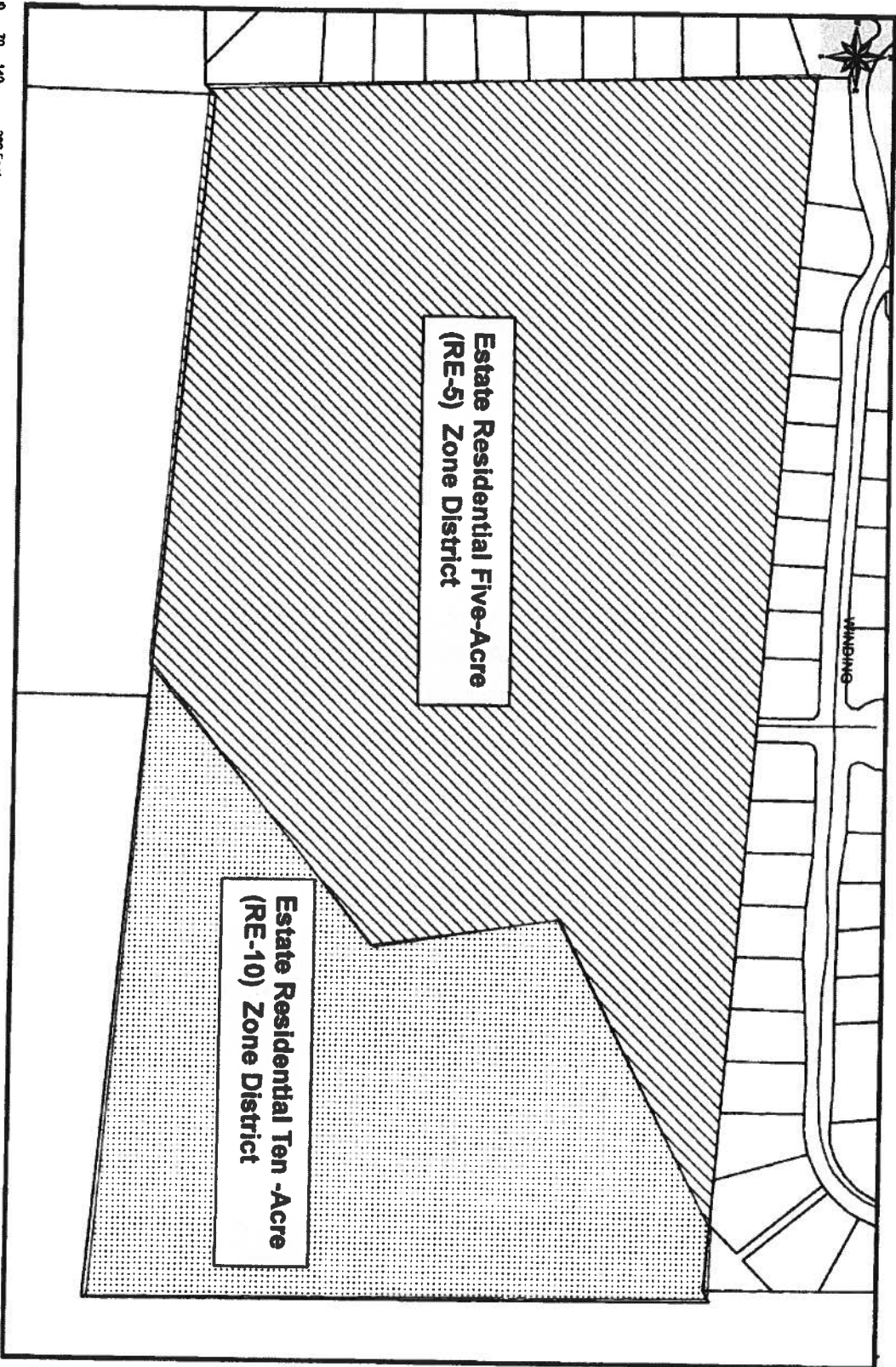

**Rezone Exhibit**