

PC 2/26/09
#10

John J. Fleischmann
APN 070-180-45
Feb. 17, 2009

El Dorado County Planning Services
2850 Fairlane Court
Placerville, CA 95667

SUBJECT: Comments on Rezone Z08-0026 and TM 08-1476 for Road Safety

I believe that the subject rezoning and parcel split should be approved since it is the only 5 acre parcel remaining on Sierrama Dr. and it is associated roads, where 95% of the parcels are less than 2 acres. However, it should be clear that adding 5 more houses will add to the traffic and to the problems that we already have on Sierrama Drive. Since the sub-dividers are asking for rezoning and also for waivers of ordinances, they should be willing to help solve the problems not just aggravate them. Please include the following Conditions of Approval in the proposed rezoning and parcel split:

- One of the problems is the present inadequate road shoulders on Sierrama Dr. between Vista Grande Drive and Meder Rd. Although, Sierrama Drive's width of 20 ft. is minimal, it is adequate and all that the residents of Sierrama Dr. and its Road Association can afford. We also do not need sidewalks. However, the road shoulders of about one foot width are unsafe and inadequate, with the curves and rock outcroppings to have adequate visibility around the curves, as marked on attachment 1. We believe that these curves should be re-graded to cut the excessive height of the shoulders down to a height where vehicles and pedestrians can safely see oncoming traffic. This would vastly improve the road safety. A minimum road shoulder of three feet is requested for pedestrians.
- It is also necessary to cut back the trees and brush to allow adequate visibility of pedestrians by on coming traffic. This clearing would also improve visibility for traffic at numerous driveways. It would also minimize the fire hazard during a firestorm if brush were cut back to eight ft. from the road pavement.

Attachment 1 – Drawing of Sierrama Dr. marked to show curves that require revisions to allow acceptable safety.

Sincerely,

John J. Fleischmann

Cc: County Planner Mr. Jonathon Fong

09 FEB 18 PM 12:00
RECEIVED
PLANNING DEPARTMENT

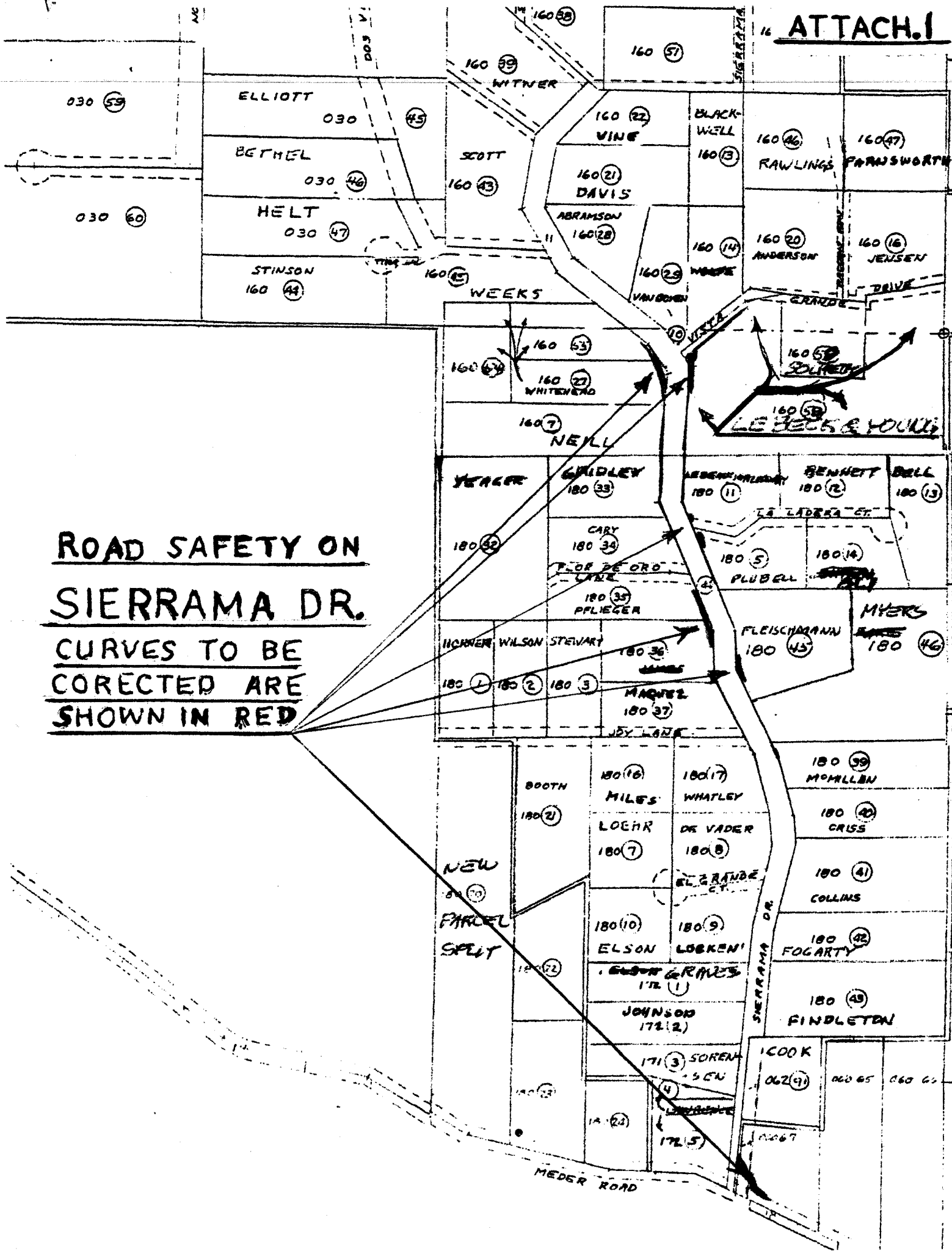

ROAD SAFETY ON
SIERRAMA DR.
CURVES TO BE
CORRECTED ARE
SHOWN IN RED