

PFF:km
BrownRez
07/28/10



ORDINANCE NO. _____

**THE BOARD OF SUPERVISORS OF THE COUNTY OF EL DORADO DOES
ORDAIN AS FOLLOWS:**

**RELATED TO REZONING IN THE GRIZZLY FLAT AREA
PETITIONED BY CHRISTINE BROWN**

Section 1. The Official Zoning Map for the Grizzly Flat Area is hereby amended to rezone the following described lands from Residential Agricultural-40 (RA-40) zone to Estate Residential Five-Acre (RE-5) and Estate Residential (RE-10) zone as shown on Exhibit A attached hereto:

Grizzly Flat Area

Assessor's Parcel No. 041-040-15, being described as Section 14,
Township 9 North, Range 13 East, M.D.M., consisting of 75.7
acres

Section 2. This ordinance shall take effect and shall become effective thirty (30) days following the adoption hereof.

PASSED AND ADOPTED by the Board of Supervisors of the County of El Dorado at a regular meeting of said Board, held on the ____ day of _____, 2010, by the following vote of said Board:

Ayes:

ATTEST
SUZANNE ALLEN DE SANCHEZ
Clerk of the Board of Supervisors

Noes:
Absent:

By _____
Deputy Clerk

Chairman, Board of Supervisors

I CERTIFY THAT:
THE FOREGOING INSTRUMENT IS A CORRECT COPY OF THE ORIGINAL ON FILE IN THIS OFFICE

Date _____
ATTEST: SUZANNE ALLEN DE SANCHEZ, Clerk of the Board of Supervisors
of the County of El Dorado, State of California.

By _____
Deputy Clerk

EXHIBIT A

**Breeden Estates
File Nos. A10-0001/Z09-0003/TM09-1488**

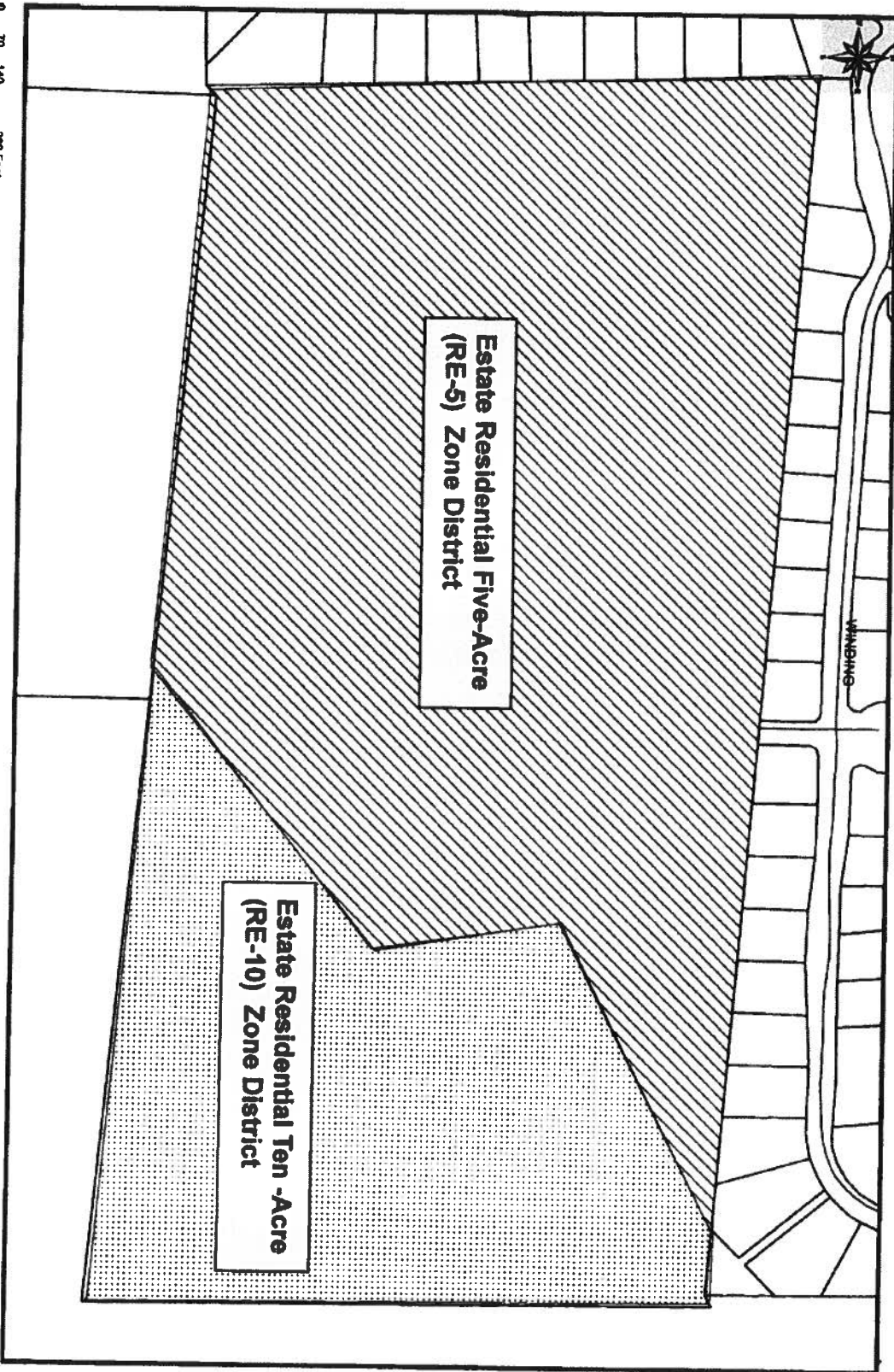

Rezone Exhibit