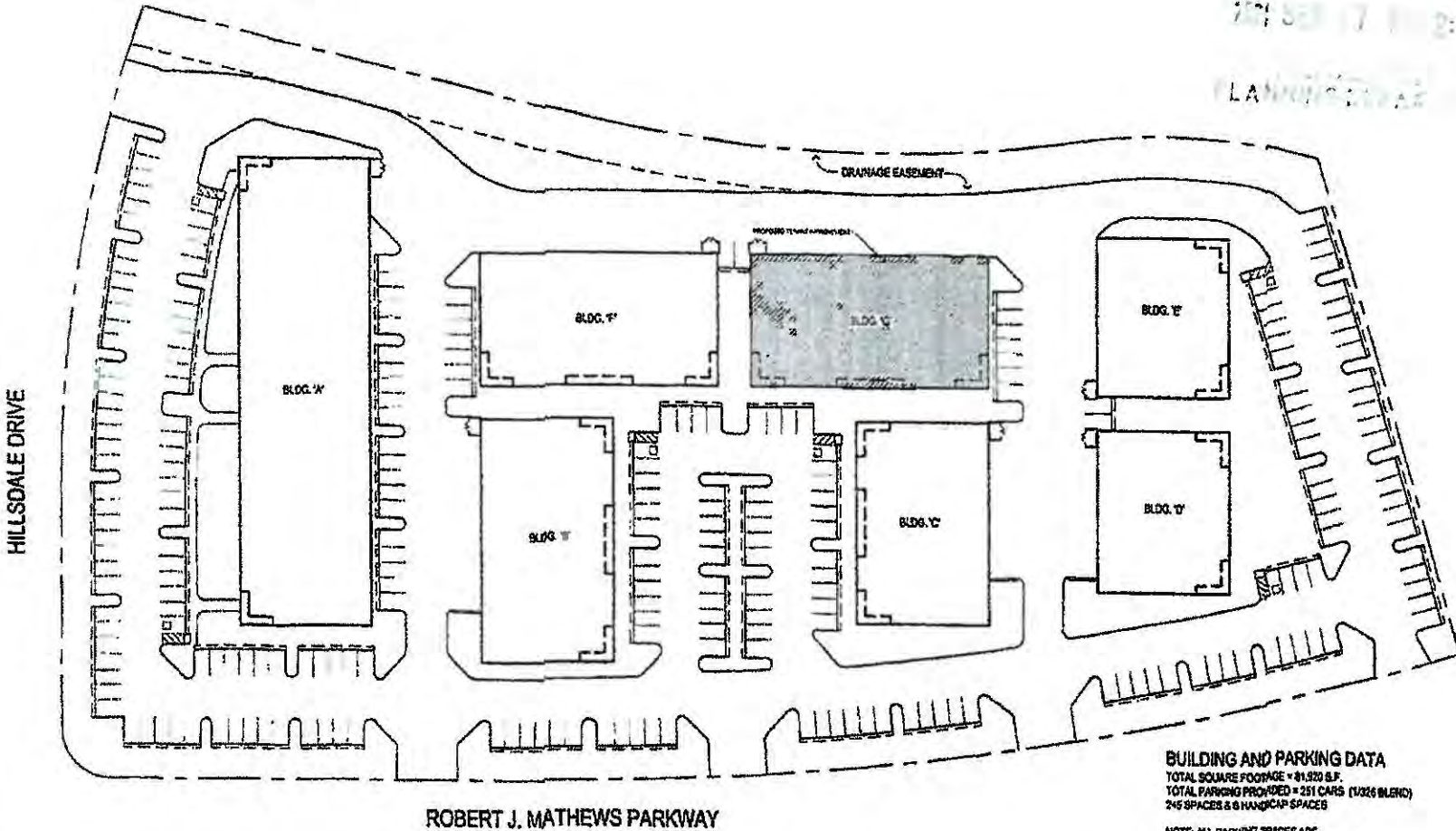

Exhibit H1: Site Plan/Floor Plan

CCUP21-0005/Norcanna Distribution and Delivery



BUILDING AND PARKING DATA
 TOTAL SQUARE FOOTAGE = 81,820 S.F.
 TOTAL PARKING PROVIDED = 251 CARS (1,026 BLK) /
 245 SPACES & 6 HANDICAP SPACES

NOTE: ALL PARKING SPACES ARE
 9'-0" WIDE x 18'-0" LONG w/ 2'-0" OVERHANG

APPLICANT:
 MATTHEWS PARKWAY, INC.
 PO BOX 8742
 INCLINE VILLAGE, NV 89751
 CONTACT: LAURA ROEBELEN 916-939-9759

OCCUPATION CLASSIFICATION: CHAPTER 3
 B OFFICE

THERE ARE NO PROPOSED SIGNS.

BUILDING PERIMETER IS 144FT BY 80FT.

1 EXISTING SITE PLAN
 SCALE: 1/8" = 1'-0"

APPROVED
 EL DORADO COUNTY
 PLANNING COMMISSION

DATE APRIL 13, 2023

BY KAREN L. GARNER / ds
 EXECUTIVE SECRETARY

sheehan
 van woert
 bigotti

over. Day & Curb
 Street Jobs

Construction and Storage shall not be used for any other purpose without the approval of the Planning Commission. The use of the site shall be limited to the use specified in the site plan and shall not be used for any other purpose without the approval of the Planning Commission.

LL CHRISTIAN CONSTRUCTION
 5070 ROBERT J. MATTHEWS PKWY
 el dorado hills, california

EXISTING SITE PLAN
 DATE: 04/13/2023

A1.1

CCUP21-0005

Exhibit H2: Site Plan/Floor Plan CCUP21-0005/Norcanna Distribution and Delivery

2021 SEP 17

PLANNING DEPT

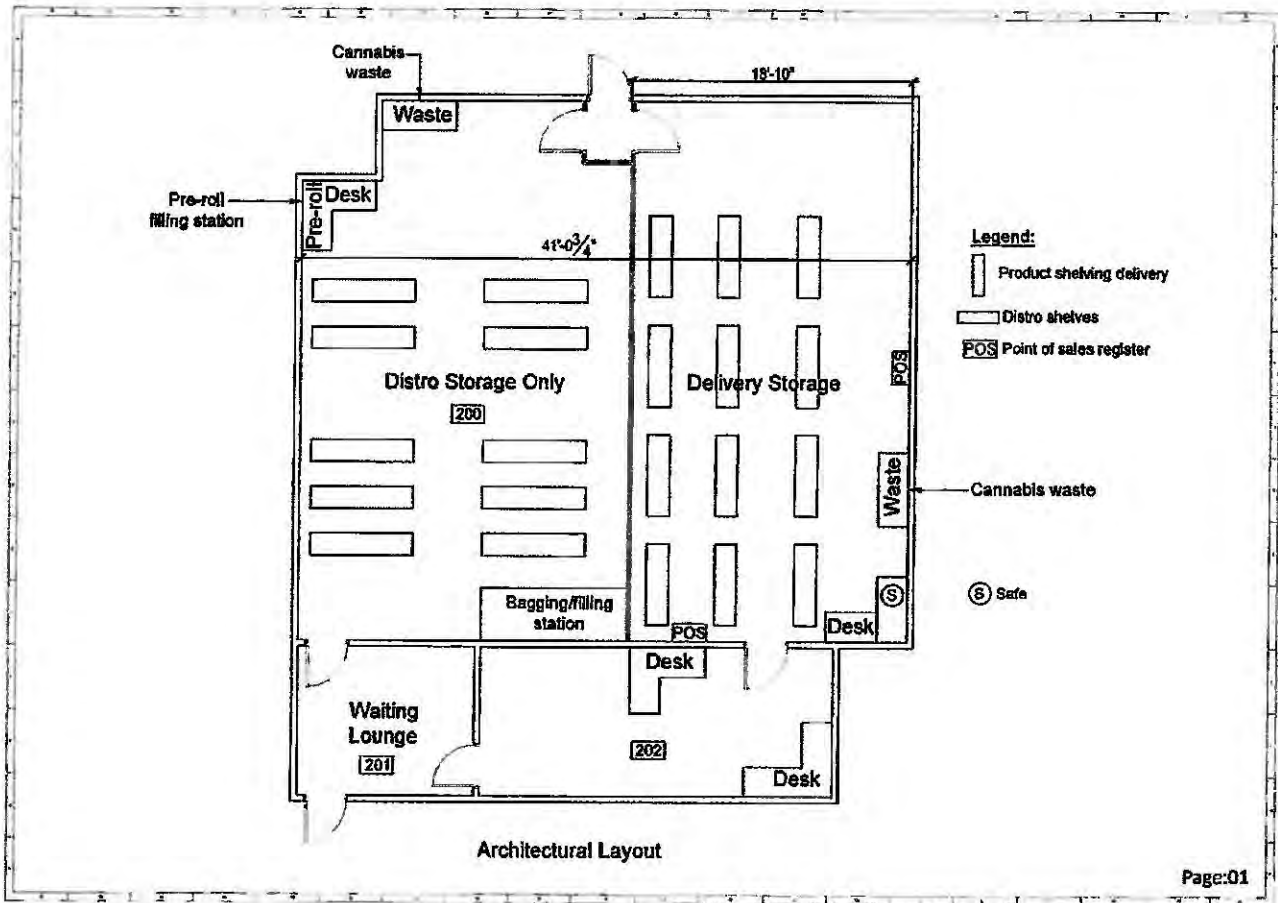

APPROVED
EL DORADO COUNTY
PLANNING COMMISSION

DATE APRIL 13, 2023

BY KAREN L. GARNER/djs
EXECUTIVE SECRETARY

CCUP21-0005

Exhibit K: Security Plan
CCUP21-0005/Norcanna Distribution and Delivery

130.41.100.4.F.13 The security plan for the operation that includes adequate lighting, security video cameras with a minimum camera resolution of 1080 pixels and 360 degree coverage, alarm systems, and secure area for cannabis storage. The security plan shall include a requirement that there be at least 90 calendar days of surveillance video (that captures both inside and outside images) stored on an ongoing basis and made available to the County upon request. The County may require real-time access of the surveillance video for the Sheriff's Office. The video system for the security cameras must be located in a locked, tamper-proof compartment. *The security plan shall remain confidential.*

APPROVED
EL DORADO COUNTY
PLANNING COMMISSION

DATE APRIL 13, 2023

BY KAREN L. GARNER/djs
EXECUTIVE SECRETARY