

ORIGINAL SCALE IS IN INCHES
 Drawing name: C:\Users\30\Projects\77135 Hanks Exchange Rd. at Squaw Hollow Creek Bridge\CADD Files\RW and Easements Exhibit.dwg Layout Tab: RW-1 Jul 05/2019 - 7:37am SMC\ky

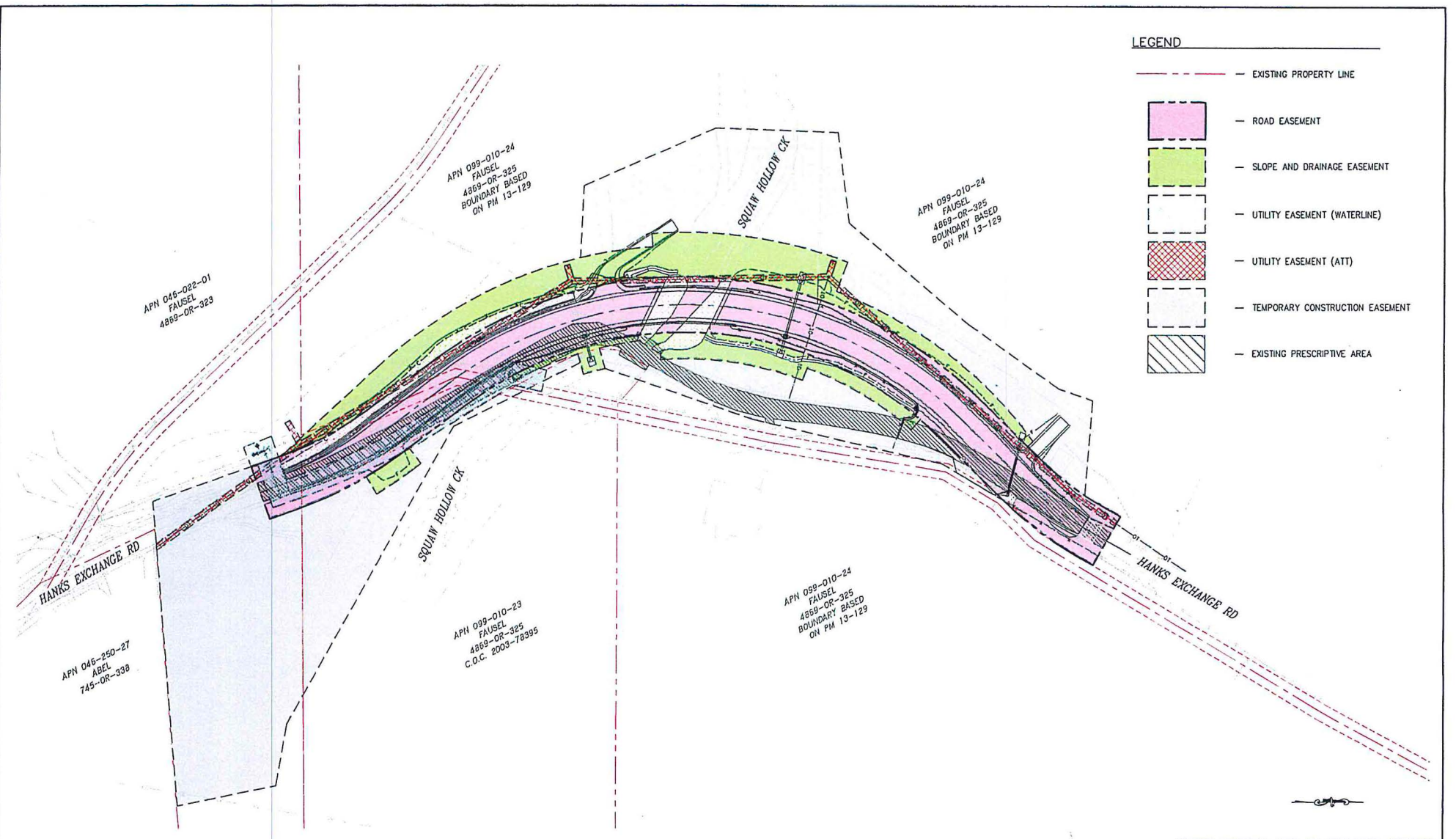

LEGEND

- EXISTING PROPERTY LINE
- ROAD EASEMENT
- SLOPE AND DRAINAGE EASEMENT
- UTILITY EASEMENT (WATERLINE)
- UTILITY EASEMENT (ATT)
- TEMPORARY CONSTRUCTION EASEMENT
- EXISTING PRESCRIPTIVE AREA

FOR REDUCED PLANS
 0 1 2

REVISION	NUMBER	DATE	DESCRIPTION	BY

PRELIMINARY

RIGHT-OF-WAY AND EASEMENTS EXHIBIT
 SCALE : 1" = 40'

PREPARED UNDER THE SUPERVISION OF: REGISTERED CIVIL ENGINEER DATE:	DESIGNED: SCM CHECKED: DATE: 07/05/19 ROAD NUMBER: 032	
--	--	--

COUNTY OF EL DORADO DEPARTMENT OF TRANSPORTATION	HANKS EXCHANGE RD AT SQUAW HOLLOW CREEK BRIDGE	SHEET RW-1 1 OF 2 P.O. NO. 77135
---	---	---

ORIGINAL SCALE IS IN INCHES
 Drawing name: C:\City 3D Projects\77135 Hanks Exchange Rd. at Squaw Hollow Creek Bridge\CADD Files\RW\RW and Easements Exhibit.dwg
 Layout Tab: RW-2 Jul 05, 2019 - 7:56am SuleVcy

FOR REDUCED PLANS
 2
 1
 0

A.P.N.	OWNER	TOTAL PARCEL ACRES	ROAD EASEMENT	SLOPE AND DRAINAGE EASEMENT	EL DORADO IRRIGATION DISTRICT (EID) EASEMENT	AT&T EASEMENT	TEMPORARY CONSTRUCTION EASEMENT	TOTAL PARCEL ACRES UNAFFECTED
046-022-01	FAUSEL	52.55	0.016 AC (677 SF) (P)	0.002 AC (92 SF) (N)	0.011 AC (492 SF) (P)	0.018 AC (803 SF) (O)	0.75 AC (32,652 SF) (N)	52.45
			0.030 AC (1,313 SF) (N)		0.013 AC (583 SF) (O)	0.002 AC (102 SF) (N)		
			0.046 AC (1,990 SF) (T)		0.012 AC (505 SF) (N)	0.020 AC (905 SF) (T)		
099-010-23	FAUSEL	4.94	0.027 AC (1,187 SF) (N)	0.028 AC (1,234 SF) (N)	0.036 AC (1,580 SF) (T)	-	0.28 AC (12,292 SF) (N)	4.86
			0.024 AC (1,040 SF) (O)		0.001 AC (62 SF) (N)			
			0.025 AC (1,102 SF) (T)					
099-010-24	FAUSEL	34.70	0.19 AC (8,122 SF) (P)	0.015 AC (657 SF) (P)	0.069 AC (2,988 SF) (P)	0.10 AC (4,419 SF) (N)(O)	0.12 AC (5,152 SF) (P)	33.03
			0.74 AC (32,448 SF) (N)	0.54 AC (23,473 SF) (N)	0.018 AC (796 SF) (N)		0.94 AC (40,845 SF) (N)	
			0.93 AC (40,570 SF) (T)	0.55 AC (24,130 SF) (T)	0.087 AC (3,784 SF) (T)		1.06 AC (45,997 SF) (T)	
TOTAL AREA			1.00 AC (43,747 SF)	0.58 AC (25,456 SF)	0.15 AC (6,466 SF)	0.12 AC (5,324 SF)	2.09 AC (90,941 SF)	

TABLE LEGEND:
 (P) = FALLING WITHIN EXISTING PRESCRIPTIVE AREA (ENCUMBERED)
 (O) = OVERLAP WITH OTHER EASEMENTS
 (N) = NEW AREA
 (T) = TOTAL AREA

PRELIMINARY

RIGHT-OF-WAY AND EASEMENTS EXHIBIT
 SCALE : NONE

REVISION	NUMBER	DATE	DESCRIPTION	BY

PREPARED UNDER THE SUPERVISION OF : REGISTERED CIVIL ENGINEER DATE:	DESIGNED : - DRAWN : - CHECKED : - DATE: 07/05/19 ROAD NUMBER: 032	 <p> COUNTY OF EL DORADO DEPARTMENT OF TRANSPORTATION </p>	HANKS EXCHANGE RD AT SQUAW HOLLOW CREEK BRIDGE	SHEET RW-2 2 OF 2 P.O. No. 77135
---	---	--	---	--