

TENTATIVE MAP

SIERRA SUNRISE

COUNTY OF EL DORADO

MAY, 2017

STATE OF CALIFORNIA

RECEIVED
PLANNING DEPARTMENT
MAY 22 AM 9:28

OWNERS OF RECORD

PACIFIC STATES DEVELOPMENT
991 GOVERNOR DRIVE, SUITE 106
EL DORADO HILLS, CA 95762

APPLICANT

PACIFIC STATES DEVELOPMENT
991 GOVERNOR DRIVE, SUITE 106
EL DORADO HILLS, CA 95762

ENGINEER

cta Engineering & Surveying
Civil Engineering • Land Surveying • Land Planning
3233 Monier Circle, Rancho Cordova, CA 95742
T (916) 638-0919 • F (916) 638-2478 • www.cta.net

LEGEND

- SUBDIVISION BOUNDARY
- LOT LINE
- - - (E) EASEMENT
- - - PROPOSED EASEMENT
- - - (E) LOT LINES
- - - (E) RW
- - - (E) PIPE
- (E) FIRE HYDRANT
- TREES

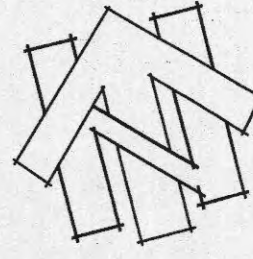

0 30' 60' 120'
SCALE: 1" = 60'

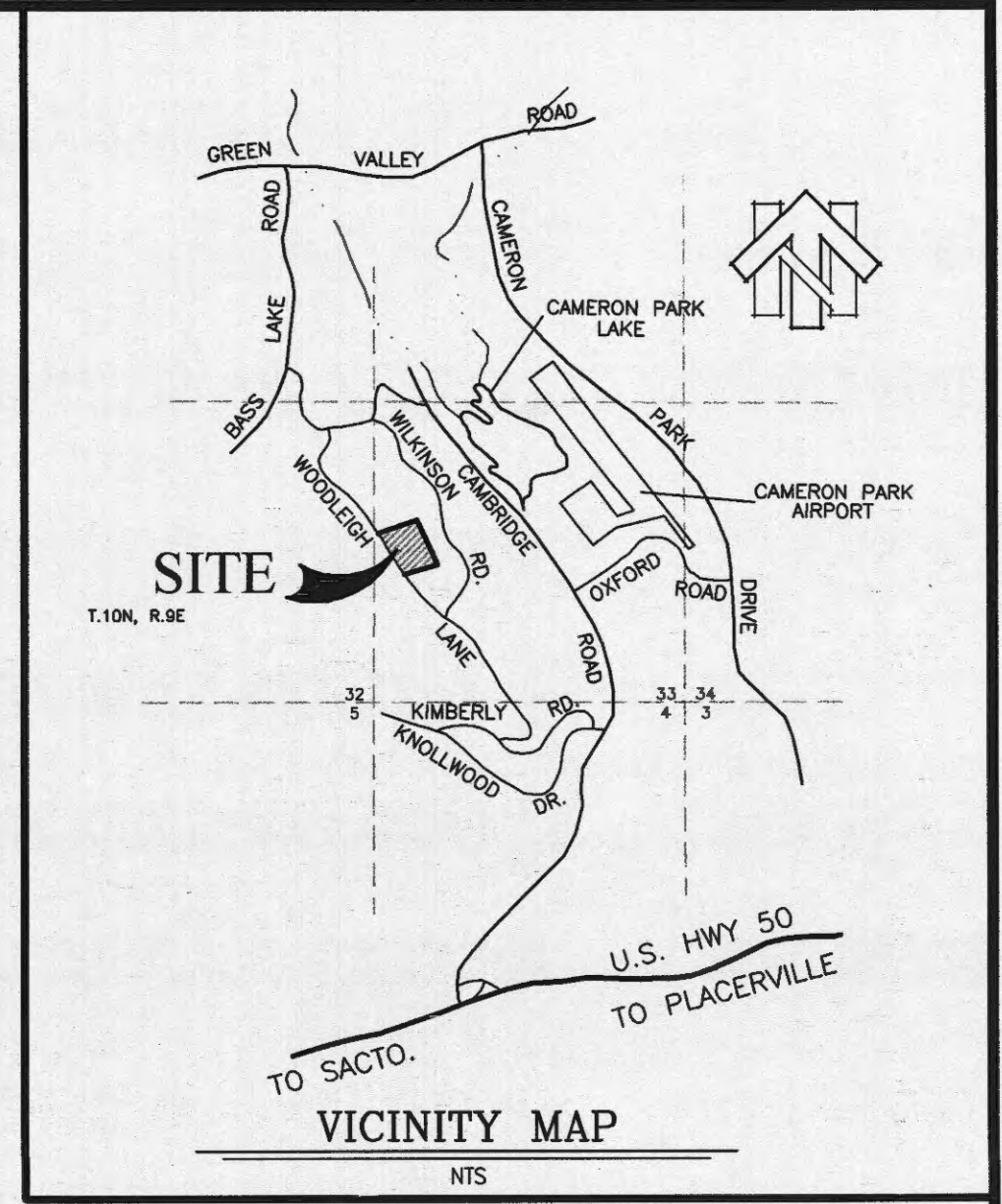

RECEIVED
PLANNING DEPARTMENT
MAY 22 AM 9:28

MAP SCALE

1" = 60'

CONTOUR INTERVAL

CONTOUR INTERVAL = 2 FEET

SOURCE OF TOPOGRAPHY

AERIAL PHOTOGRAPHY

SECTION, TOWNSHIP and RANGE

SECTIONS 32, T. 10 N., R. 9 E. M.D.M.

ASSESSOR'S PARCEL NUMBERS

116-030-028
116-030-030

PROPOSED ZONING

R1

PRESENT ZONING

R1

TOTAL AREA

10.00 ACRES

TOTAL NUMBER OF PARCELS

8 - RESIDENTIAL LOTS
1 - ROADWAY LOT
9 - LOTS TOTAL

MINIMUM LOT AREA

17,329 SQUARE FEET

WATER SUPPLY and SEWAGE DISPOSAL

EL DORADO IRRIGATION DISTRICT

PROPOSED STRUCTURAL FIRE PROTECTION

CAMERON PARK CSD (FIRE DEPARTMENT)

DATE OF PREPARATION

MAY, 2017

PHASING PLAN NOTICE

THE SUBDIVIDER MAY FILE MULTIPLE FINAL MAPS FOR THIS PROJECT. THE SUBDIVIDER SHALL NOT BE REQUIRED TO DEFINE THE NUMBER OR CONFIGURATION OF THE PROPOSED MULTIPLE FINAL MAPS. (PER THE SUBDIVISION MAP ACT, SECTION 66456.1)

ENGINEER'S CERTIFICATE

I HEREBY CERTIFY THAT TO THE BEST OF MY KNOWLEDGE THE LAND DEVELOPMENT KNOWN AS SIERRA SUNRISE HAS BEEN DESIGNED IN ACCORDANCE WITH THE SPECIFICATIONS AND GUIDELINES ESTABLISHED BY THE COUNTY OF EL DORADO.

ENGINEER'S NAME R.C.E. *3452*

DATE 5-16-17

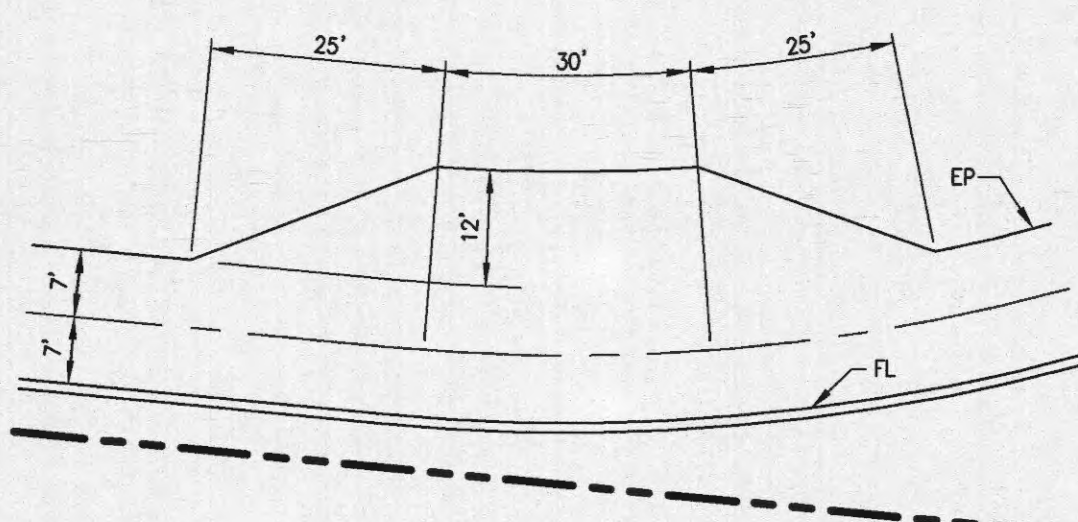
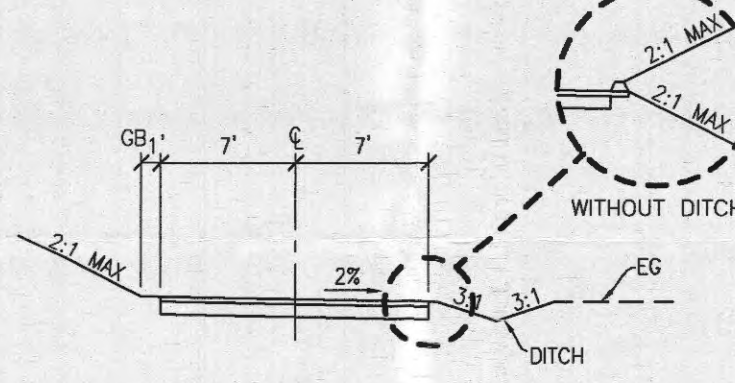
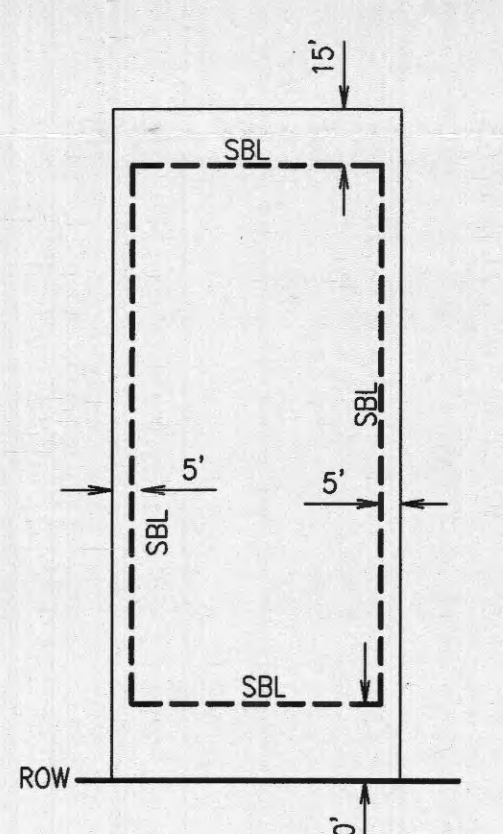
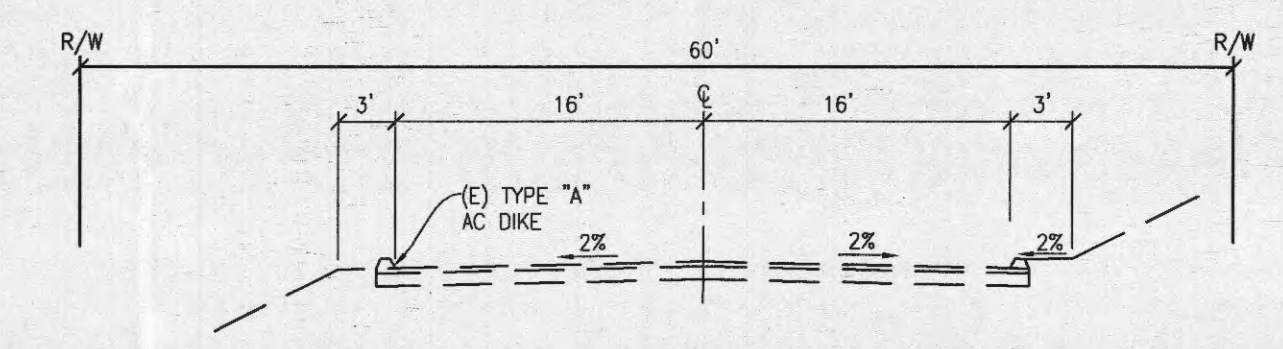
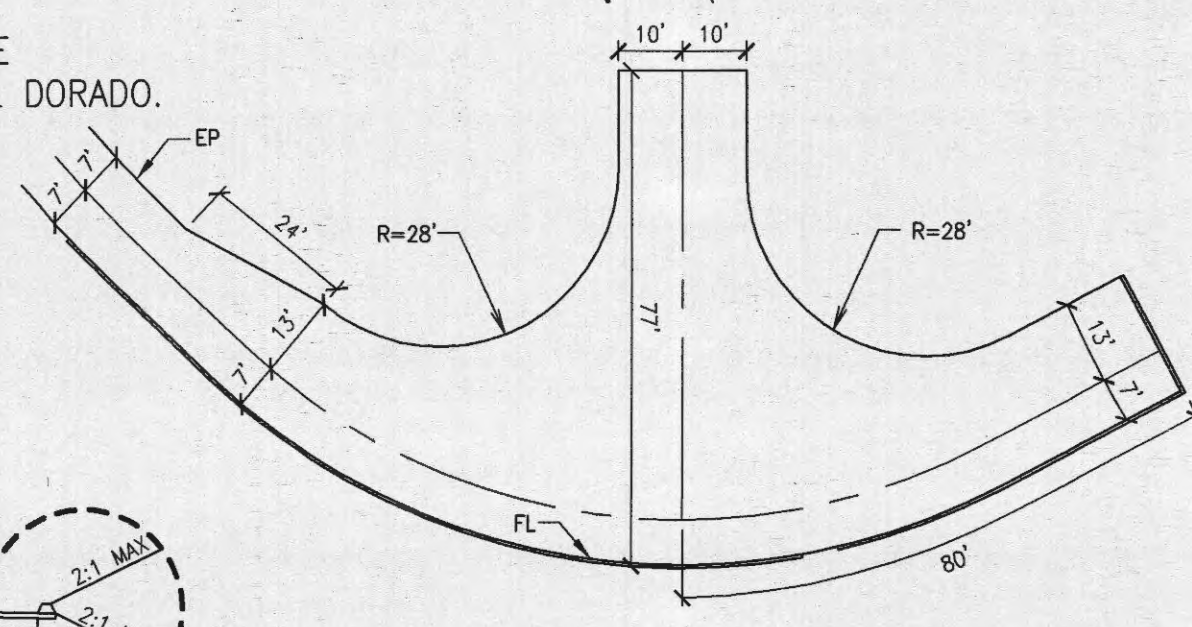

NOTE:
NO IMPROVEMENTS FOR THIS PROJECT NOT WITHSTANDING NECESSARY REPAIRS IN ACCORDANCE WITH EDC STANDARDS.

APPROVED
EL DORADO COUNTY
PLANNING COMMISSION
DATE July 25, 2017
BY *Jeffrey Schmidt*
EXECUTIVE SECRETARY

PLANNING COMMISSION: _____
APPROVAL/DENIAL DATE: _____