

SARATOGA RETAIL PHASE 2

DR-R18-0001

LOCATION

- El Dorado Hills (District I)
- Approximate Northwest Corner:
El Dorado Hills Boulevard and
Hwy 50 West Bound On-Ramp



GENERAL PLAN & ZONING

- Commercial (C)
- Commercial Community – Design Review Community Combining Zone (CC-DC)

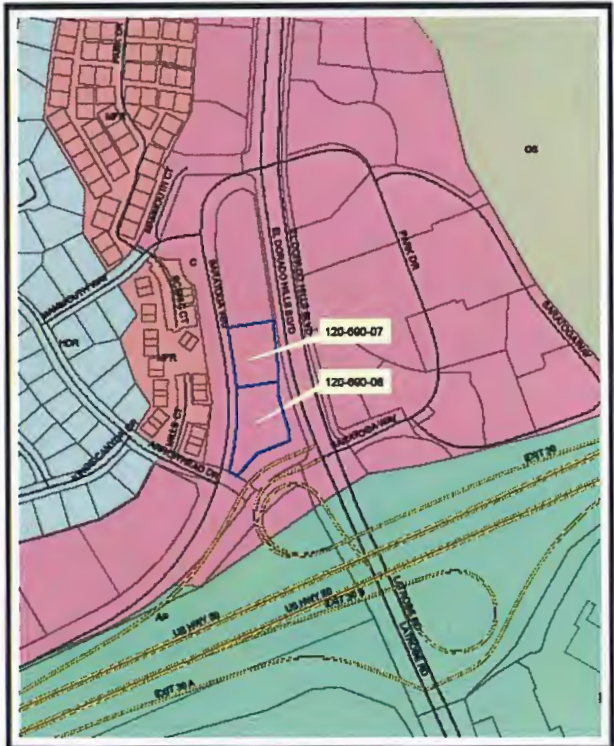

**Saratoga Retail Phase 2:
DR-R 18-0001 Exhibit C
General Plan Map**

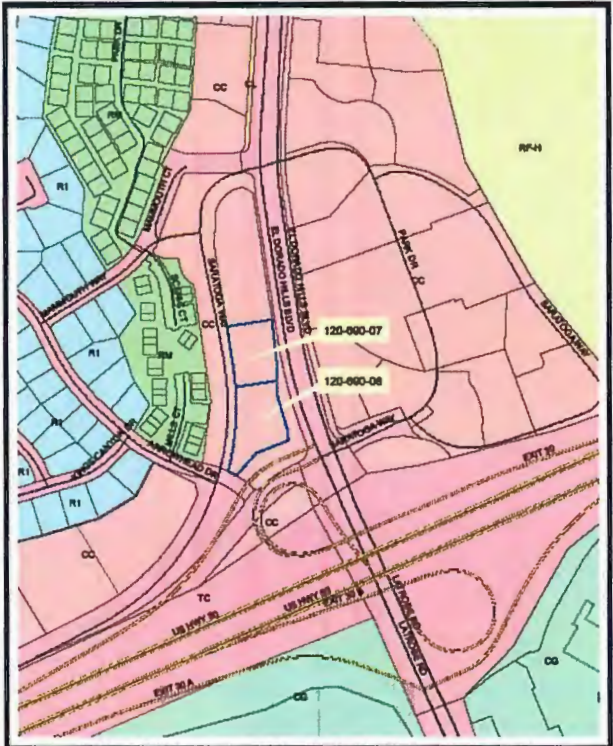

**Saratoga Retail Phase 2:
DR-R18-0001 Exhibit D
Zoning Map**

PROJECT SITE

- 1.71 Acres, 2 parcels
- Design Review Revision to reconfigure the site and revise building 3 to include a drive-thru aisle.
- DR08-0003/The Shops At EDH approved January 22, 2009 by Planning Commission.
- Public Sewer and Water (EID)
- Access from Saratoga Way (Public Road)

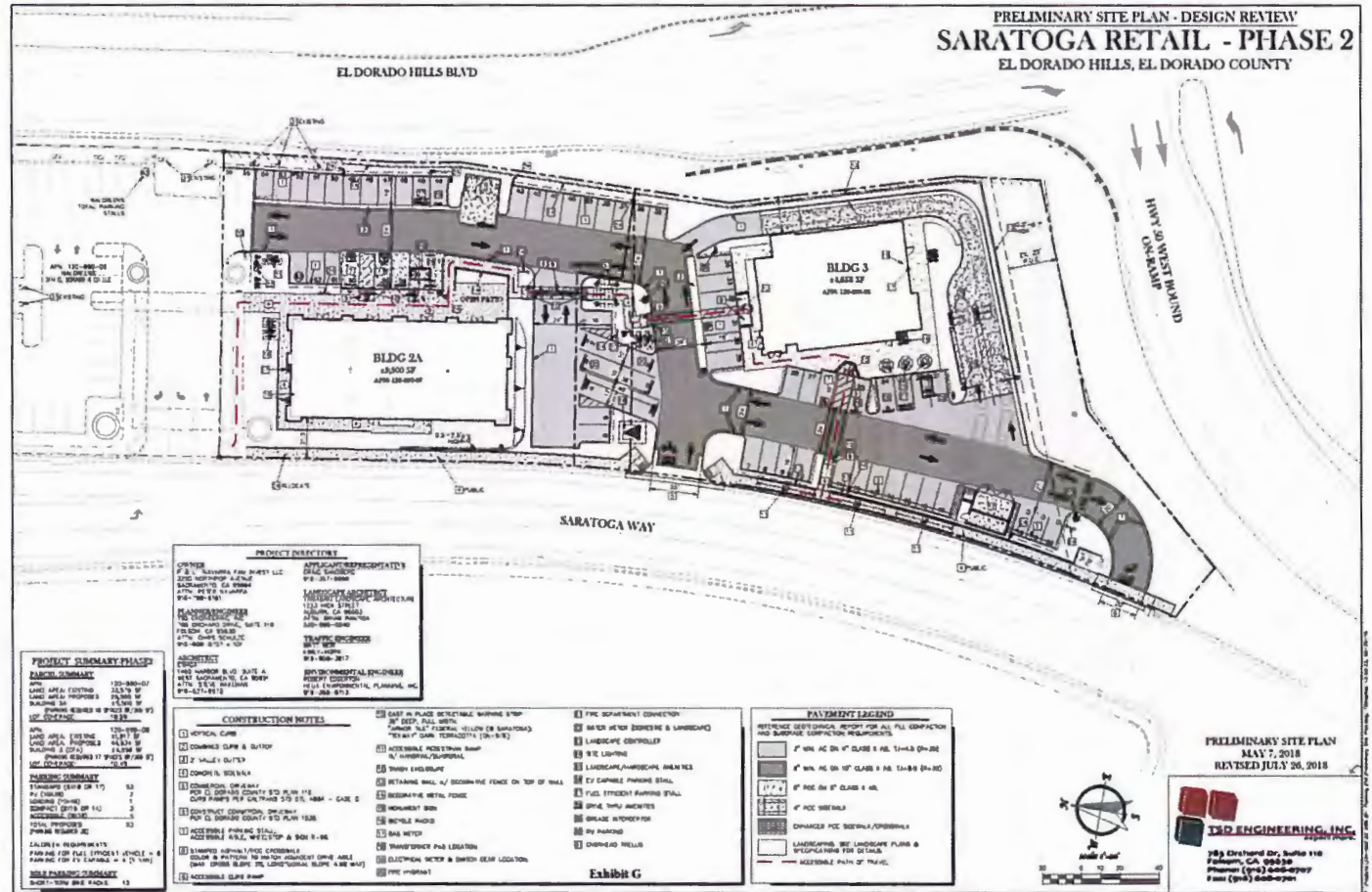

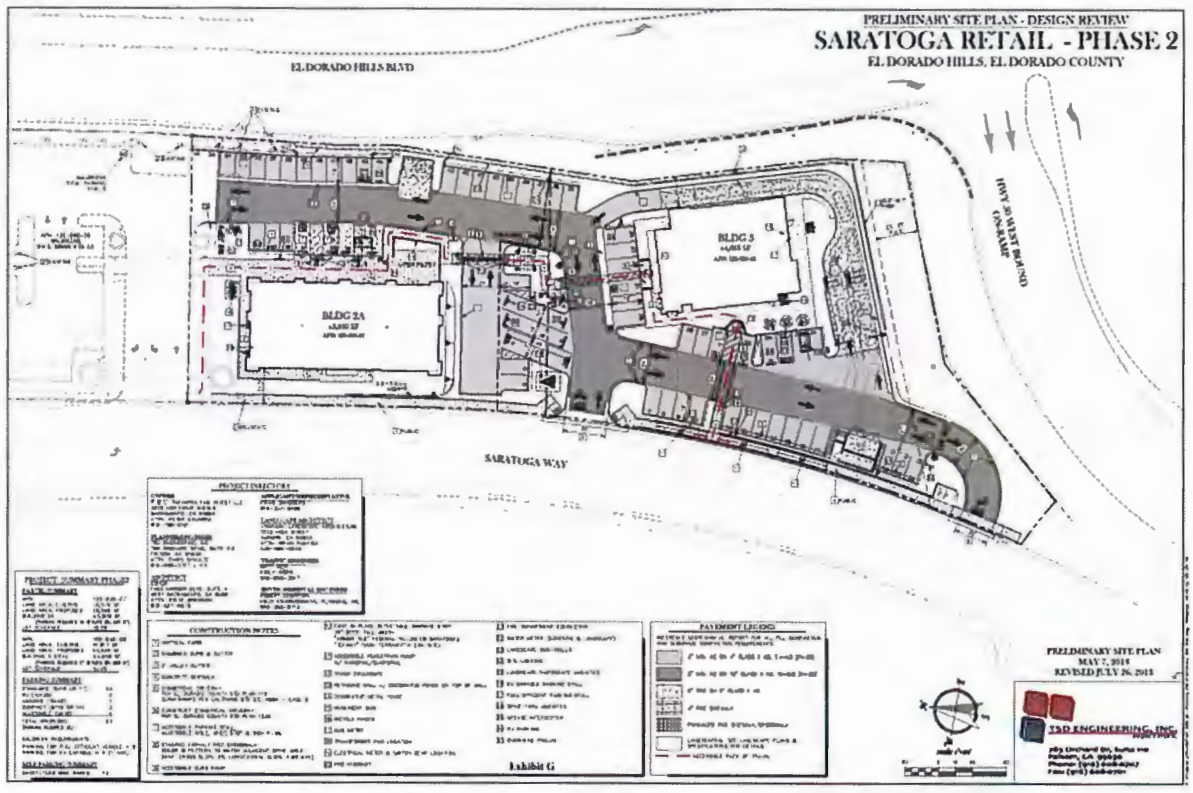
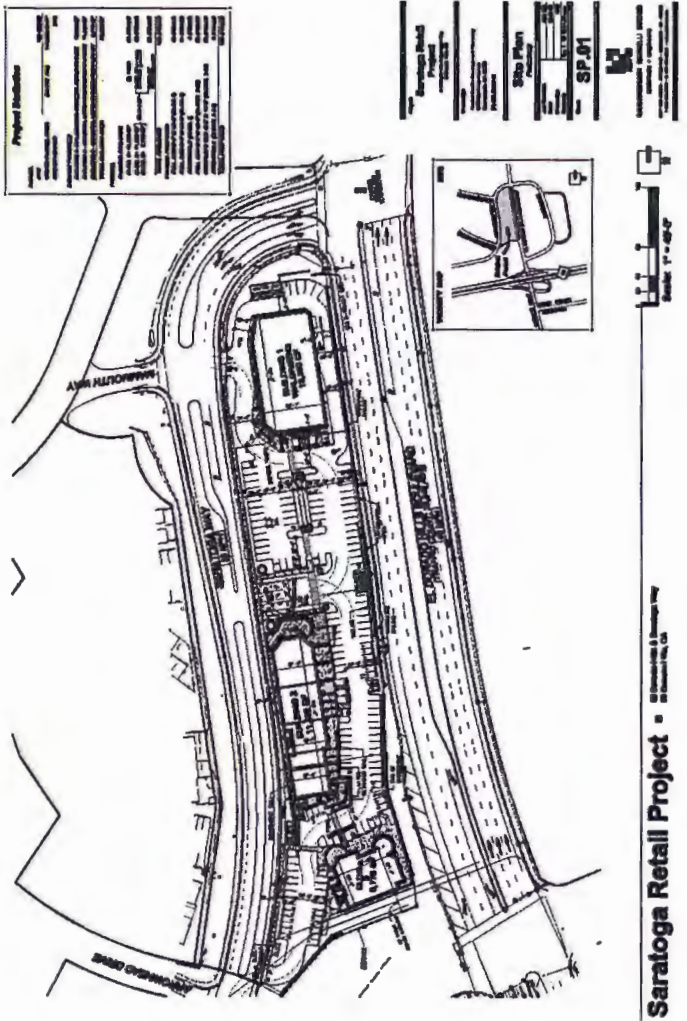

ENVIRONMENTAL REVIEW

- Mitigated Negative Declaration
- The project proposes a less than significant impact with mitigation measures:
 - Air Quality
 - Cultural Resources
 - Transportation/Traffic