

INDEX OF SHEETS

SHEET	PLAN SHEET	TITLE
1		TITLE SHEET
SITE 1		
2	L-1	SITE 1-LAYOUT AND CONTROL
3	EC-1	SITE 1-EROSION CONTROL
SITE 2		
4	L-2	SITE 2-LAYOUT AND CONTROL
5	L-3	SITE 2-PROFILE AND SUPERELEVATION
6-7	GR-1 THRU GR-2	SITE 2-GRADING PLAN
8	GR-3	SITE 2-GRADING DETAILS
9-11	D-1 THRU D-3	SITE 2-DRAINAGE
12	EC-2	SITE 2-EROSION CONTROL

COUNTY OF EL DORADO, CA DEPARTMENT OF TRANSPORTATION

PROJECT PLANS FOR THE CONSTRUCTION OF WHITE MEADOW RD AND PEAVINE RIDGE RD STORM DAMAGE REPAIR

IN THE COUNTY OF EL DORADO, DISTRICT 5

SITE 1 LOCATED ON PEAVINE RIDGE RD, APPROX 4.5 MILES FROM THE WHITE MEADOW RD/ICE HOUSE RD INTERSECTION
SITE 2 LOCATED ON WHITE MEADOW ROAD, APPROX 0.8 MILES FROM WHITE MEADOW RD/ICE HOUSE RD INTERSECTION

To be supplemented with Standard Plans and Specifications dated 2015, including the 2015 Revised Standard Specifications, of the California Department of Transportation, unless otherwise noted.

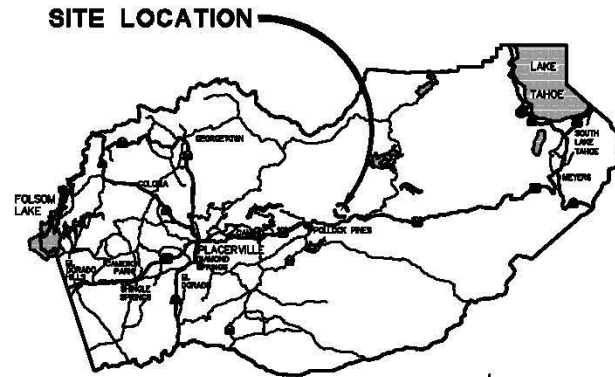

VICINITY MAP
COUNTY OF EL DORADO

BOARD OF SUPERVISORS

I	JOHN HIDAHL
II	SHIVA FRENTZEN
III	BRIAN VEERKAMP
IV	MICHAEL RANALLI
V	SUE NOVASEL

**COUNTY OF EL DORADO
DEPARTMENT OF TRANSPORTATION**

(530) 621-5900
2850 FAIRLANE CT
PLACERVILLE, CA 95667

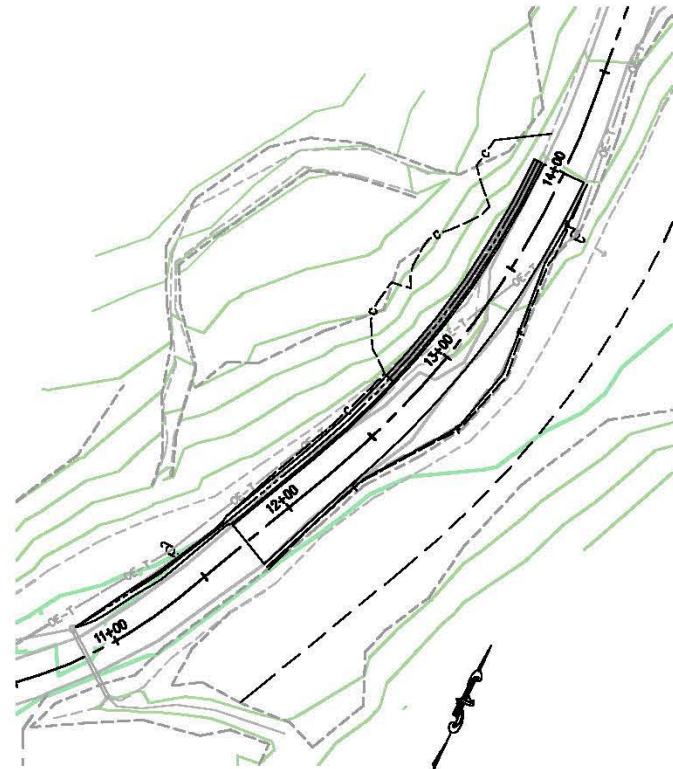

SITE 1
SCALE: 1"=40'

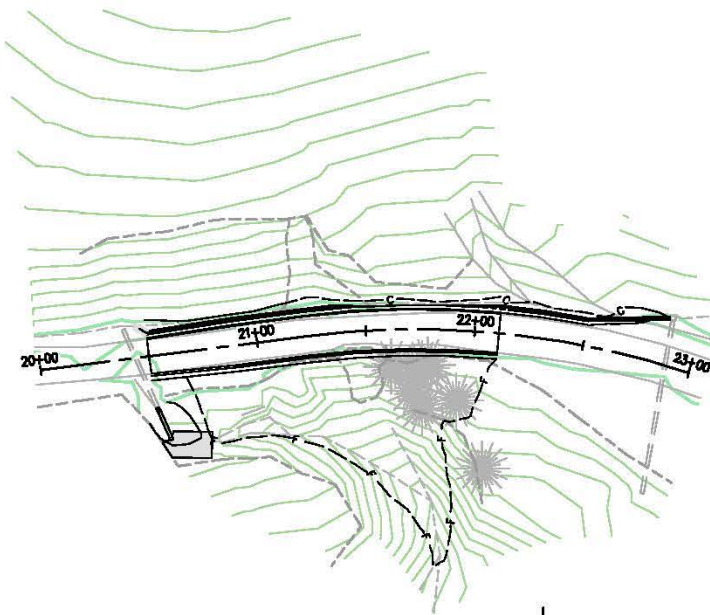

SITE 2
SCALE: 1"=40'

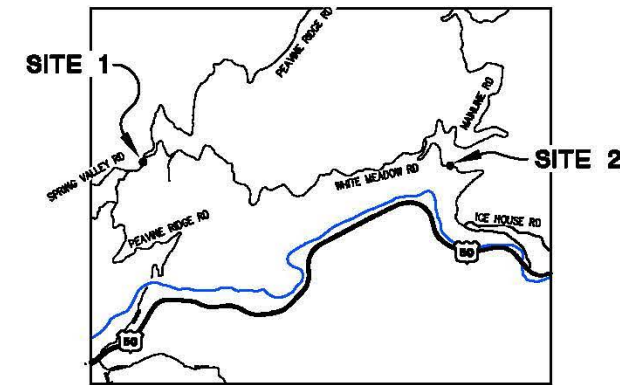

LOCATION MAP
NTS

FUNDING AGENCY
FEDERAL EMERGENCY
MANAGEMENT AGENCY (FEMA)

FEMA PROJECT NO.
EELC14

Dwight J. Anderson 05/23/18
SUBMITTED BY: CIVIL ENGINEER DATE
STATE OF CALIFORNIA NO.

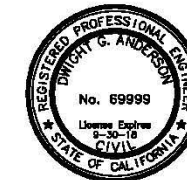

CONTRACTOR'S LICENSE CLASSIFICATION: Bidders shall be properly licensed to perform the Work pursuant to the State Contractor's License Act (Business and Professions Code section 7000 et seq.) and shall possess a CLASS A LICENSE or equivalent combination of Classes required by the categories and type of Work included in the Contract Documents and Plans. Failure of the successful Bidder to obtain proper and adequate licensing at the time bids are submitted shall constitute a failure to execute the Contract, and forfeiture as provided under that section.

REVISIONS

MARK	DATE	BY



PW NO. 17-31162 PROJECT NO. 78711

**WHITE MEADOW RD AND
PEAVINE RIDGE RD
STORM DAMAGE REPAIR**

TITLE SHEET

SHEET 1 OF 12

ORIGINAL SCALE IS IN INCHES
 Drawing name: C:\Civil 3D Projects\78711 White Meadows Rd Slopout\CADD Files\Sheets\L-1.dwg Layout Tab: L-1 Jun 19, 2018 - 8:24am SMC\evy
 FOR REDUCED PLANS

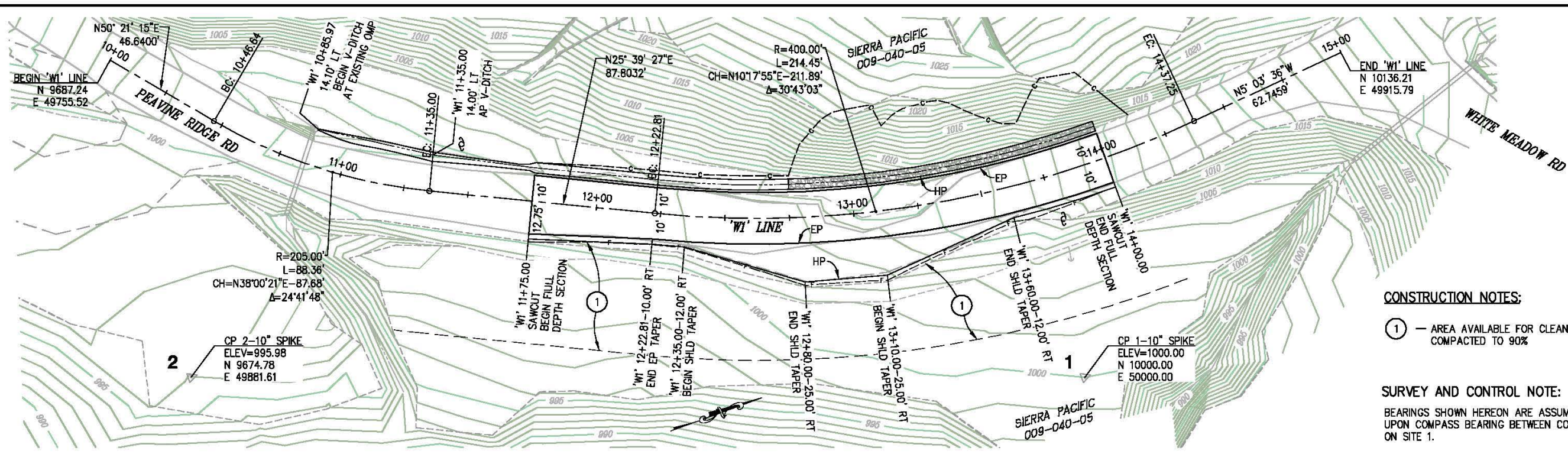

CONSTRUCTION NOTES:

① — AREA AVAILABLE FOR CLEAN FILL COMPACTED TO 90%

SURVEY AND CONTROL NOTE:
 BEARINGS SHOWN HEREON ARE ASSUMED BASED UPON COMPASS BEARING BETWEEN CONTROL POINTS ON SITE 1.
 COORDINATES ARE ASSUMED
 VERTICAL DATUM IS ASSUMED, CONTROL POINTS SHOWN HEREON ARE TBM'S

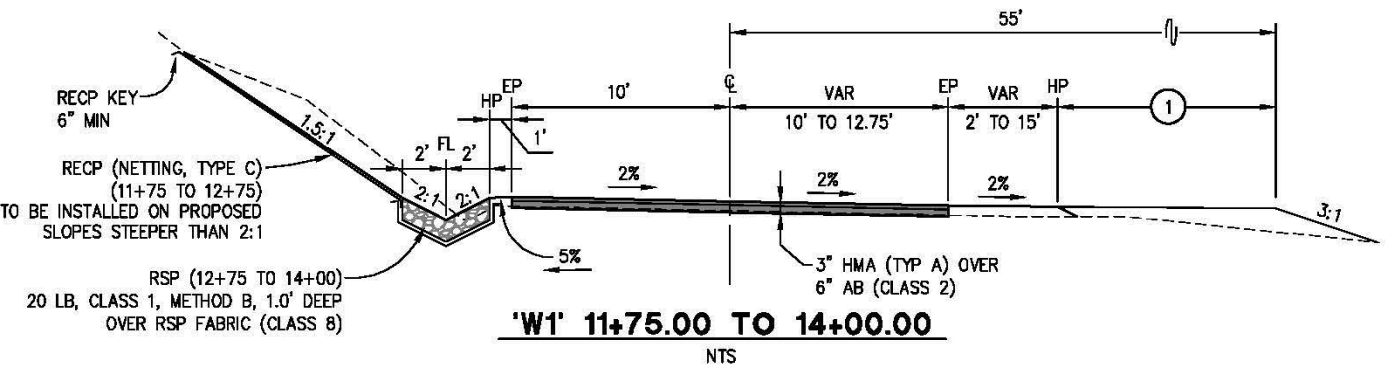
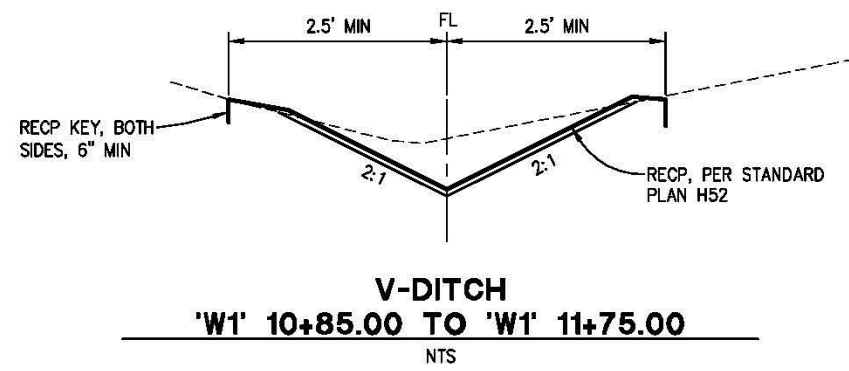
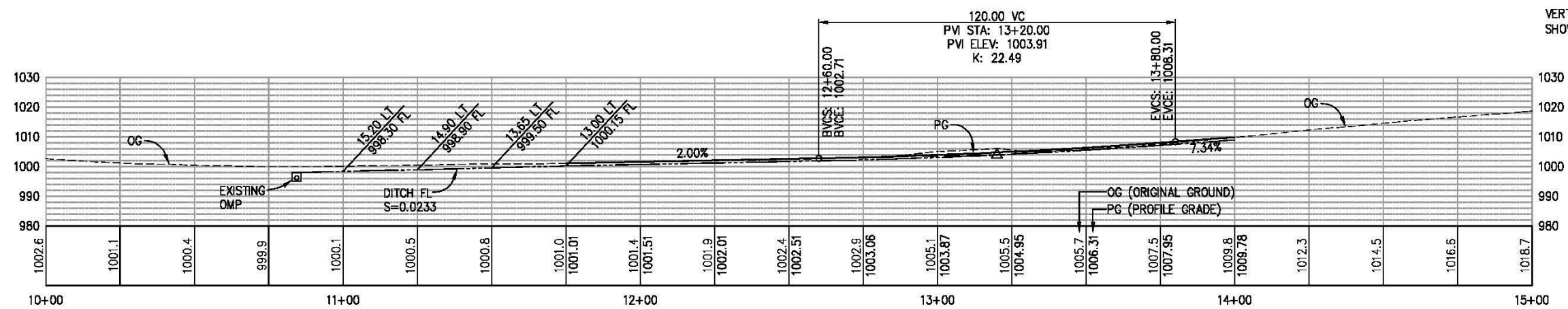

SITE 1-LAYOUT AND CONTROL SCALE: 1" = 20' H,V

REVISION NUMBER DATE DESCRIPTION BY			PREPARED UNDER THE SUPERVISION OF: <i>Dwight J. Anderson</i> REGISTERED CIVIL ENGINEER DATE: 05/23/18	DESIGNED: DA DRAWN: SGM CHECKED: CG DATE: 02/26/18 ROAD NUMBER: 1041		COUNTY OF EL DORADO DEPARTMENT OF TRANSPORTATION	WHITE MEADOW RD AND PEAVINE RIDGE RD STORM DAMAGE REPAIR	SHEET L-1 2 OF 12 R.O. No. 78711

ORIGINAL SCALE IS IN INCHES
 Drawing name: C:\Civil 3D Projects\78711 White Meadows Rd\Output\CADD Files\Sheets\EC-1.dwg Layout Tab: EC-1 Jun 18, 2018 - 8:25am SMC/ky
 FOR REDUCED PLANS
 2
 1
 0

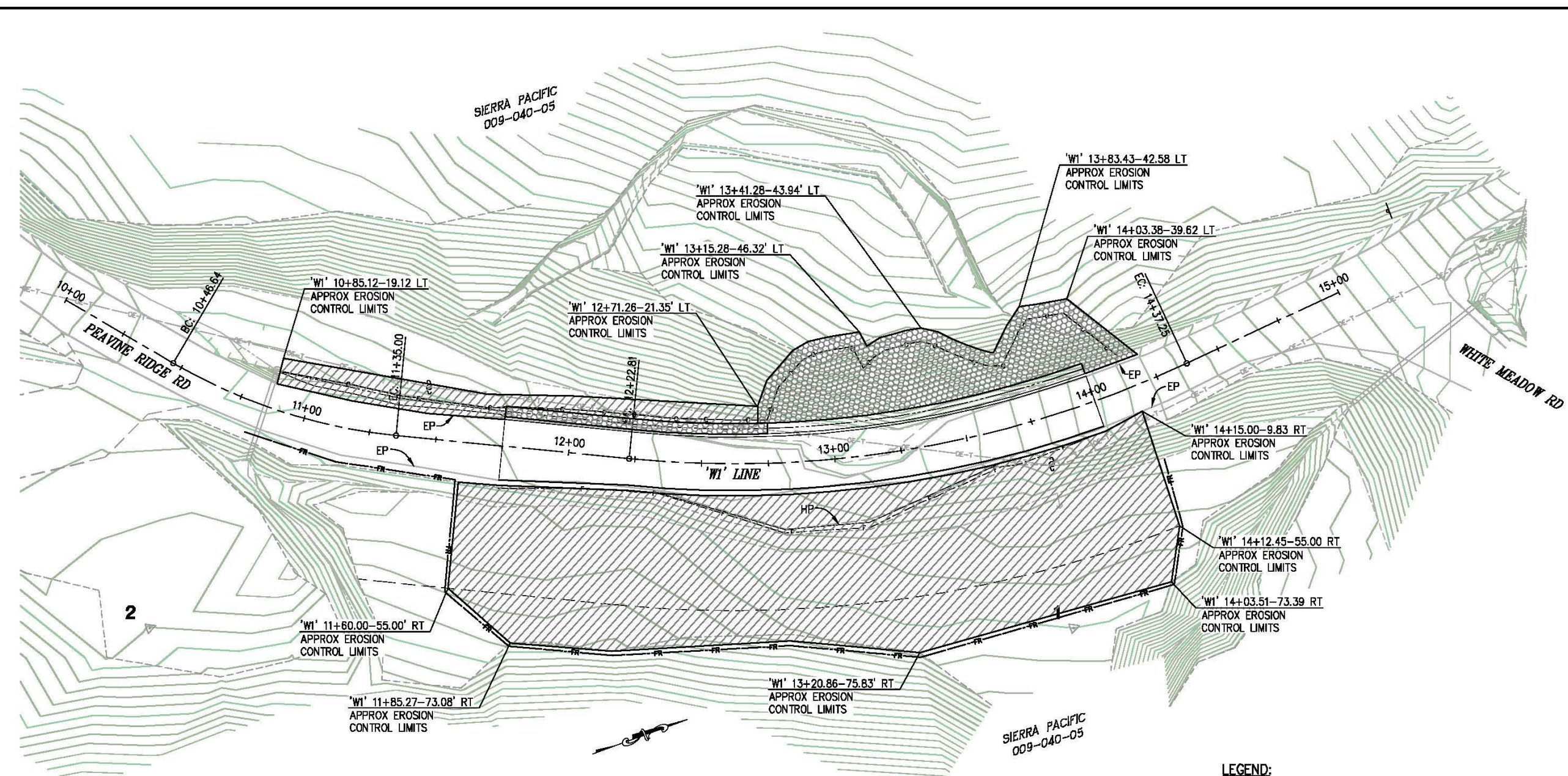

- LEGEND:**
- RECP WITH HYDROSEED
 - HYDROSEED
 - FIBER ROLLS

- GENERAL NOTES:**
1. RECP INSTALLED PER STD PLAN H52
 2. FIBER ROLLS INSTALLED PER STD PLAN H51

SITE 1-EROSION CONTROL
SCALE : 1" = 20'

<table border="1" style="width: 100%; border-collapse: collapse;"> <tr> <th style="text-align: left;">REVISION</th> <th style="text-align: left;">NUMBER</th> <th style="text-align: left;">DATE</th> <th style="text-align: left;">DESCRIPTION</th> <th style="text-align: left;">BY</th> </tr> <tr> <td> </td> <td> </td> <td> </td> <td> </td> <td> </td> </tr> </table>	REVISION	NUMBER	DATE	DESCRIPTION	BY						<p>PREPARED UNDER THE SUPERVISION OF: <i>Dwight G. Anderson</i> REGISTERED CIVIL ENGINEER DATE: 05/23/18</p>	<table border="1" style="width: 100%; border-collapse: collapse;"> <tr> <td>DESIGNED: DA</td> <td>DRAWN: SGM</td> </tr> <tr> <td>CHECKED: CG</td> <td>DATE: 02/26/18</td> </tr> <tr> <td>ROAD NUMBER: 1041</td> <td> </td> </tr> </table>	DESIGNED: DA	DRAWN: SGM	CHECKED: CG	DATE: 02/26/18	ROAD NUMBER: 1041		<p>COUNTY OF EL DORADO DEPARTMENT OF TRANSPORTATION</p>	<p>WHITE MEADOW RD AND PEAVINE RIDGE RD STORM DAMAGE REPAIR</p>	<p>SHEET EC-1 3 OF 12 W.D. No. 78711</p>
REVISION	NUMBER	DATE	DESCRIPTION	BY																	
DESIGNED: DA	DRAWN: SGM																				
CHECKED: CG	DATE: 02/26/18																				
ROAD NUMBER: 1041																					

ORIGINAL SCALE IS IN INCHES
 Drawing name: C:\Civil 3D Projects\78711 White Meadows Rd Stpout\CADD Files\Sheets\L-2.dwg Layout Tab: L-2 Jun 18, 2018 - 8:26am SMC/ky
 FOR REDUCED PLANS
 2
 1
 0

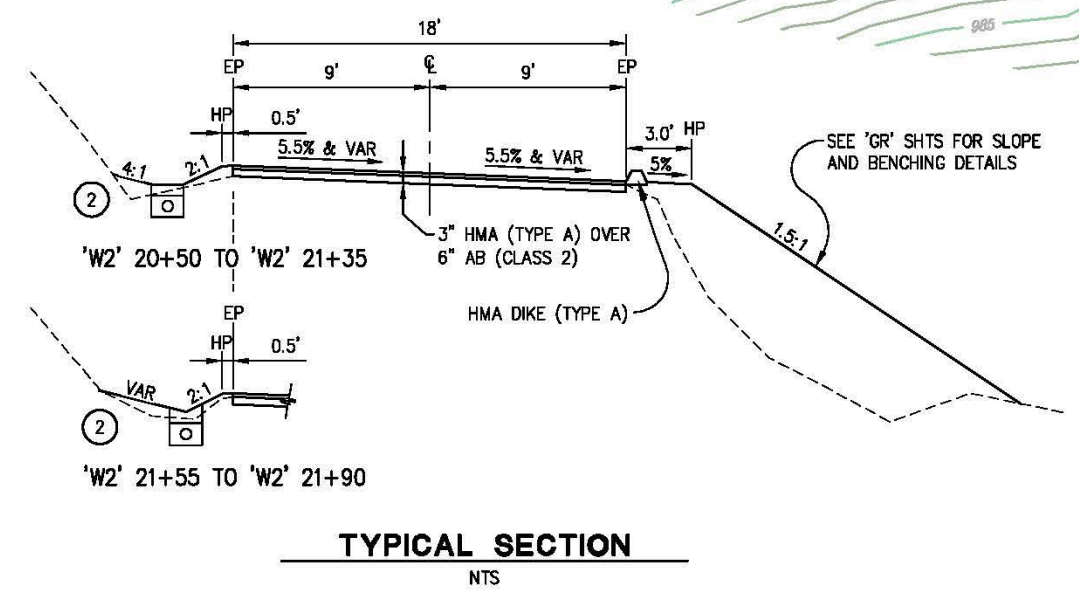
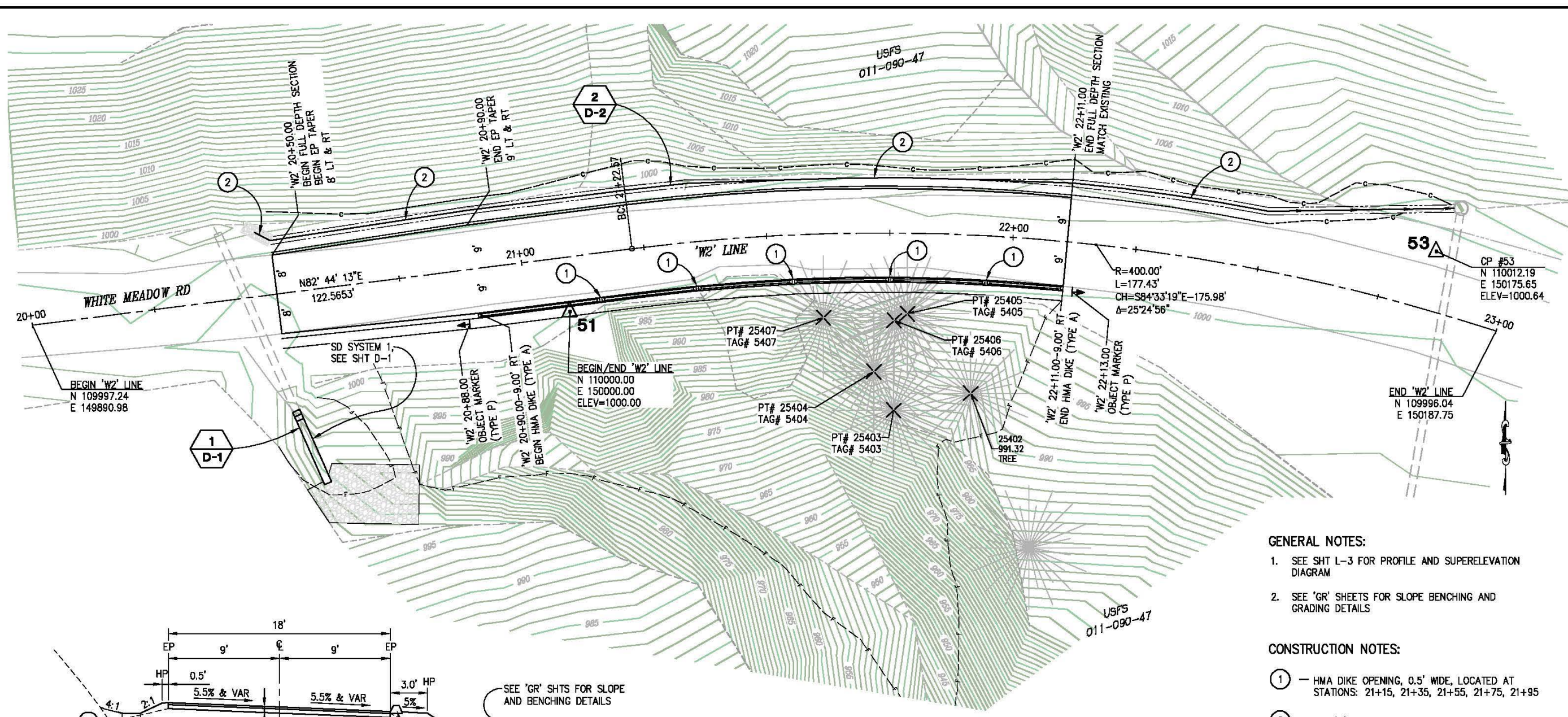

- GENERAL NOTES:**
- SEE SHT L-3 FOR PROFILE AND SUPERELEVATION DIAGRAM
 - SEE 'GR' SHEETS FOR SLOPE BENCHING AND GRADING DETAILS

- CONSTRUCTION NOTES:**
- HMA DIKE OPENING, 0.5' WIDE, LOCATED AT STATIONS: 21+15, 21+35, 21+55, 21+75, 21+95
 - SEE 'D' SHTS FOR DITCH AND UNDERDRAIN DETAILS

SURVEY AND CONTROL NOTE:
 BEARINGS SHOWN HEREON ARE ASSUMED BASED UPON COMPASS BEARING BETWEEN CONTROL POINTS ON SITE 2.
 COORDINATES ARE ASSUMED
 VERTICAL DATUM IS ASSUMED, CONTROL POINTS SHOWN HEREON ARE TBM'S

TREE REMOVAL TABLE					
POINT NUMBER	TAG NUMBER	'W2' LINE STATION	OFFSET	DESCRIPTION & DIA.	
25402	5402	21+95.95	32.09' RT	CEDAR-1.15#	
25403	5403	21+76.00	35.92' RT	PINE-1.88#	
25404	5404	21+71.61	28.09' RT	CEDAR-2.04#	
25405	5405	21+78.74	16.34' RT	PINE-1.08#	
25406	5406	21+75.98	17.73' LT	PINE-0.99#	
25407	5407	21+60.98	16.98' RT	CEDAR-1.05#	

SITE-2 LAYOUT AND CONTROL SCALE : 1" = 10' H,V

<table border="1" style="width: 100%; border-collapse: collapse;"> <tr> <th>REVISION</th> <th>NUMBER</th> <th>DATE</th> <th>DESCRIPTION</th> <th>BY</th> </tr> <tr> <td> </td> <td> </td> <td> </td> <td> </td> <td> </td> </tr> </table>	REVISION	NUMBER	DATE	DESCRIPTION	BY							PREPARED UNDER THE SUPERVISION OF: <i>Dwight G. Anderson</i> REGISTERED CIVIL ENGINEER DATE: 05/23/18	DESIGNED: DA DRAWN: SGM CHECKED: CG DATE: 02/26/18 ROAD NUMBER: 1041		COUNTY OF EL DORADO DEPARTMENT OF TRANSPORTATION	WHITE MEADOW RD AND PEAVINE RIDGE RD STORM DAMAGE REPAIR	SHEET L-2 4 OF 12 W.D. No. 78711
REVISION	NUMBER	DATE	DESCRIPTION	BY													

ORIGINAL SCALE IS IN INCHES
 Drawing name: C:\Civil 3D Projects\78711 White Meadows Rd Slopout\CADD Files\Sheets\L-2.dwg Layout Tab: L-3 Jun 18, 2018 - 8:27am ShMcVey
 FOR REDUCED PLANS
 0 1 2

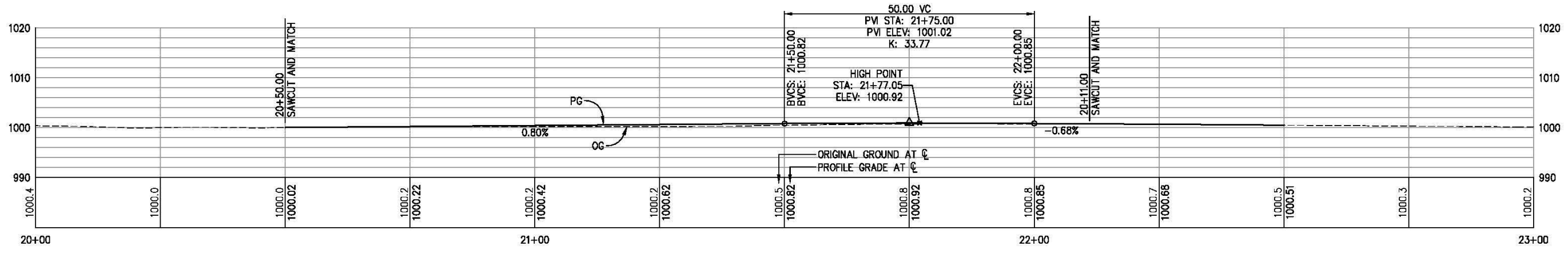

'W2' LINE - PROFILE
SCALE: 1"=10' H,V

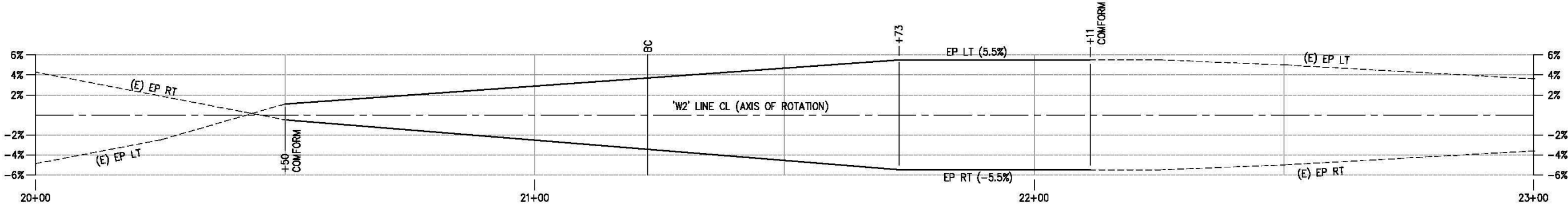

'W2' LINE - SUPERELEVATION

SITE-2 PROFILE AND SUPERELEVATION
SCALE : AS SHOWN

REVISION	NUMBER	DATE	DESCRIPTION	BY



PREPARED UNDER THE SUPERVISION OF :
Dwight G. Anderson
 REGISTERED CIVIL ENGINEER
 DATE: 05/23/18

DESIGNED: DA
 DRAWN: SGM
 CHECKED: CG
 DATE: 02/26/18
 ROAD NUMBER: 1041



COUNTY OF EL DORADO
DEPARTMENT OF TRANSPORTATION

WHITE MEADOW RD AND
PEAVINE RIDGE RD
STORM DAMAGE REPAIR

SHEET
L-3
 5 OF 12
 W.D. No. **78711**

ORIGINAL SCALE IS IN INCHES
 Drawing name: I:\Sacramento\Projects\710101\00\600_CADD\05_Official\Civil\Sheets\01-101-GR-1.dwg Layout Tab: GR-1 Mar 21, 2018 12:14pm dzurcher

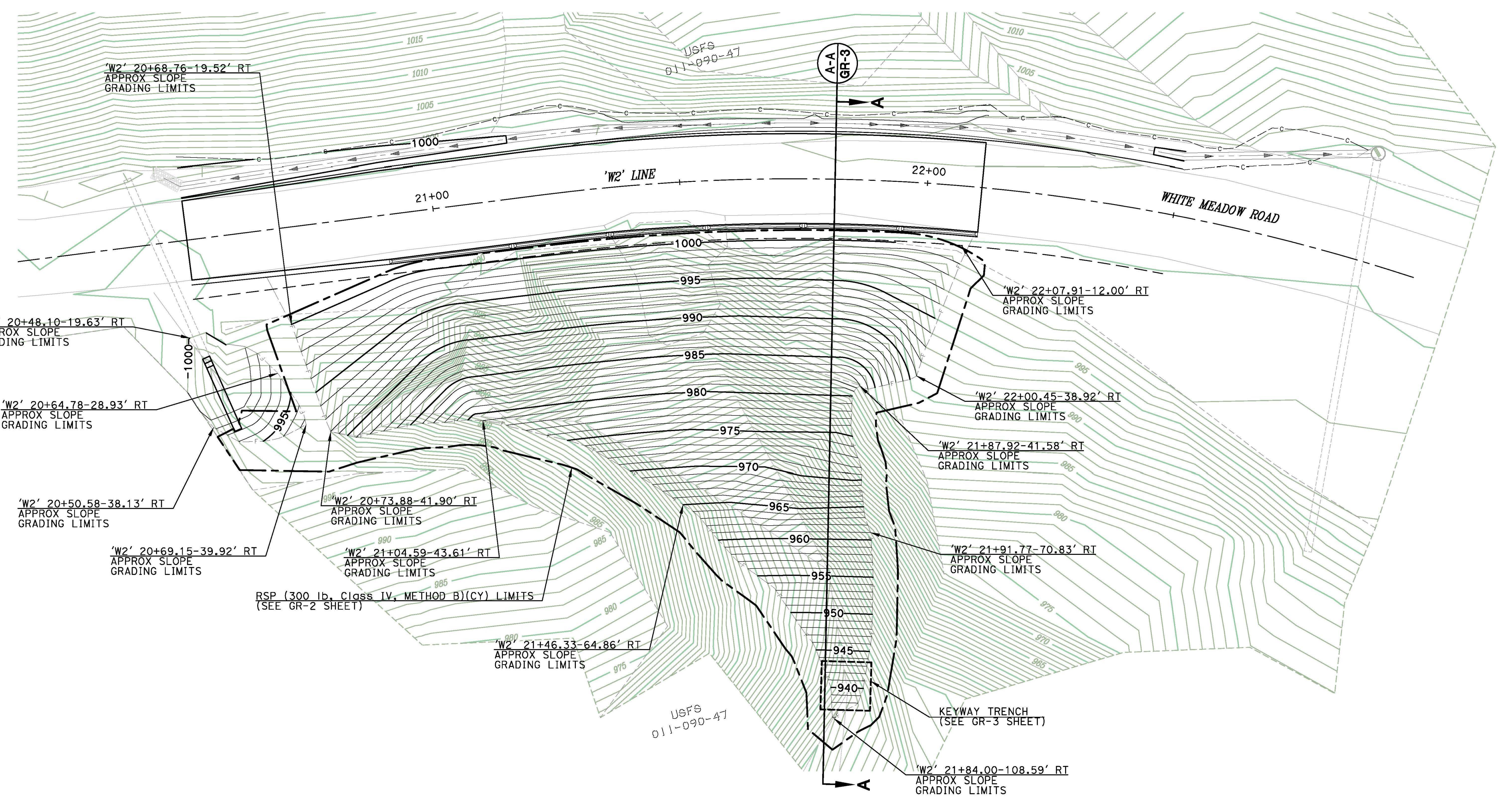

SITE 2-GRADING PLAN
SCALE : 1" = 10' H,V

REVISION	NUMBER	DATE	DESCRIPTION	BY

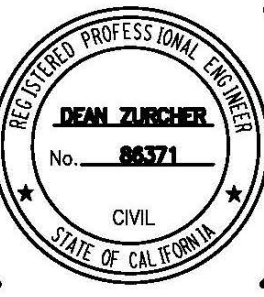

PREPARED UNDER THE SUPERVISION OF:
Dean Zurcher
 REGISTERED CIVIL ENGINEER
 DATE: 3/21/18

DESIGNED: DZ
 DRAWN: DZ
 CHECKED: BF
 DATE: 3/21/18
 ROAD NUMBER: 1041



COUNTY OF EL DORADO
COMMUNITY DEVELOPMENT AGENCY
TRANSPORTATION DIVISION

WHITE MEADOW RD AND
PEAVINE RIDGE RD
STORM DAMAGE REPAIR

SHEET
GR-1
 6 OF 12
 W.D. No. 78711

ORIGINAL SCALE IS IN INCHES
 Drawing name: I:\Sacramento\Projects\710101-00-600_CADD\05_Official\Civil\Sheets\02-101_GR-2.dwg Layout Tab: GR-2 Mar 21, 2018 12:15pm dZurcher

LEGEND:

- RSP (300 lb, Class IV, METHOD B)(CY)
- RSP (60 lb, Class II, METHOD B)(CY)

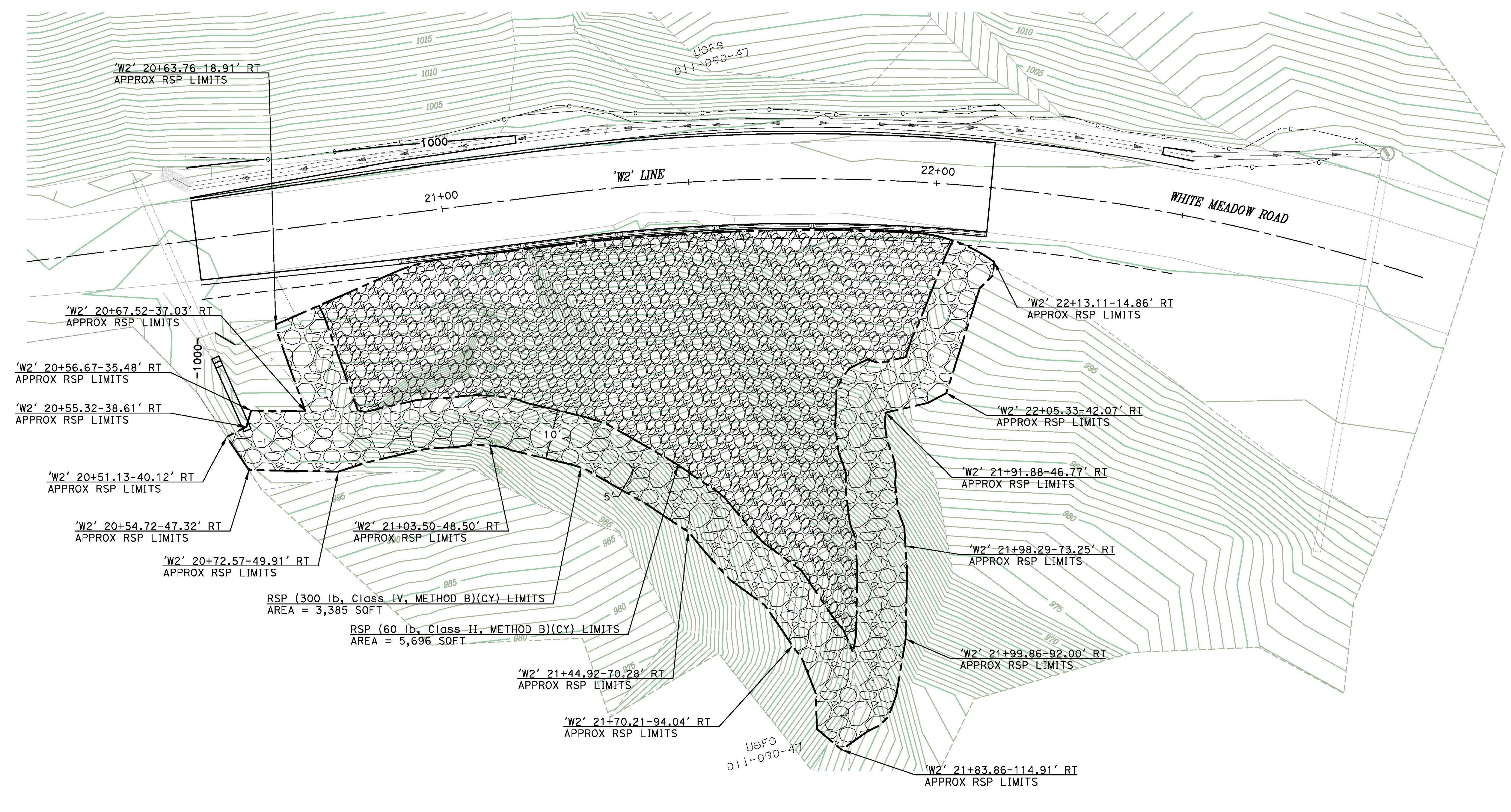

RSP (300 lb, Class IV, METHOD B)(CY) LIMITS
 AREA = 3,385 SQFT

RSP (60 lb, Class II, METHOD B)(CY) LIMITS
 AREA = 5,696 SQFT

SITE 2-GRADING PLAN
 SCALE : 1" = 10' H,V

REVISION	NUMBER	DATE	DESCRIPTION	BY

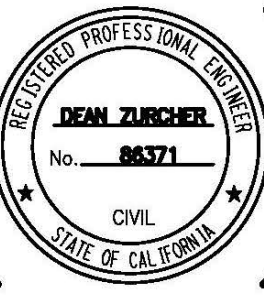

PREPARED UNDER THE SUPERVISION OF:
Dean Zurcher
 REGISTERED CIVIL ENGINEER
 DATE: 3/21/18

DESIGNED: DZ
 DRAWN: DZ
 CHECKED: BF
 DATE: 3/21/18
 ROAD NUMBER: 1041



COUNTY OF EL DORADO
COMMUNITY DEVELOPMENT AGENCY
TRANSPORTATION DIVISION

WHITE MEADOW RD AND
PEAVINE RIDGE RD
STORM DAMAGE REPAIR

SHEET
GR-2
 7 OF 12
 W.D. No. 78711

ORIGINAL SCALE IS IN INCHES
 Drawing name: I:\Sacramento\Projects\710101\00\600_CADD\05_Official\Civil\Sheets\03-101 GR-3.dwg
 Layout Tab: GR-2
 Mar 21, 2018 12:16pm
 deZurcher

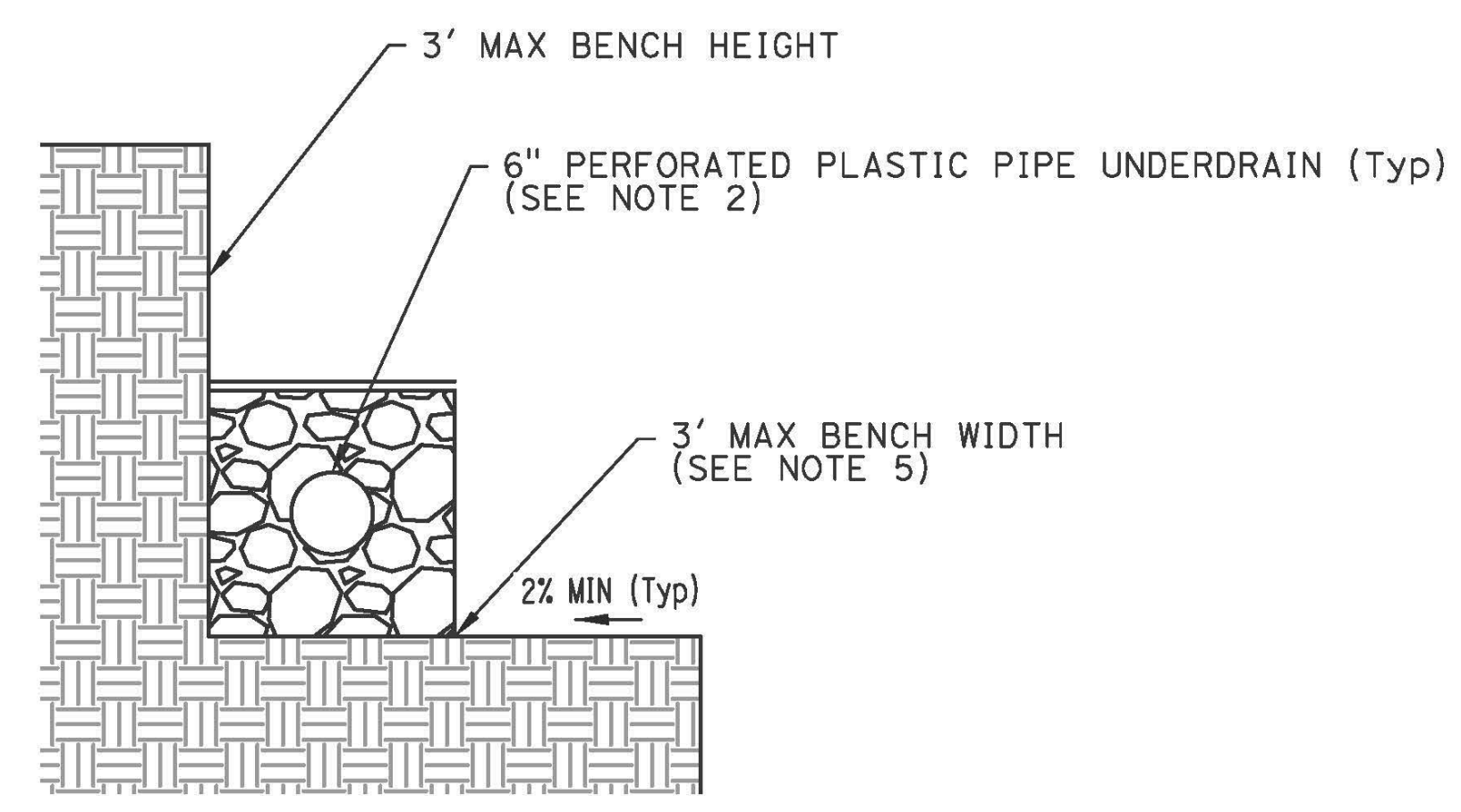

TYPICAL BENCHING DETAIL
NO SCALE

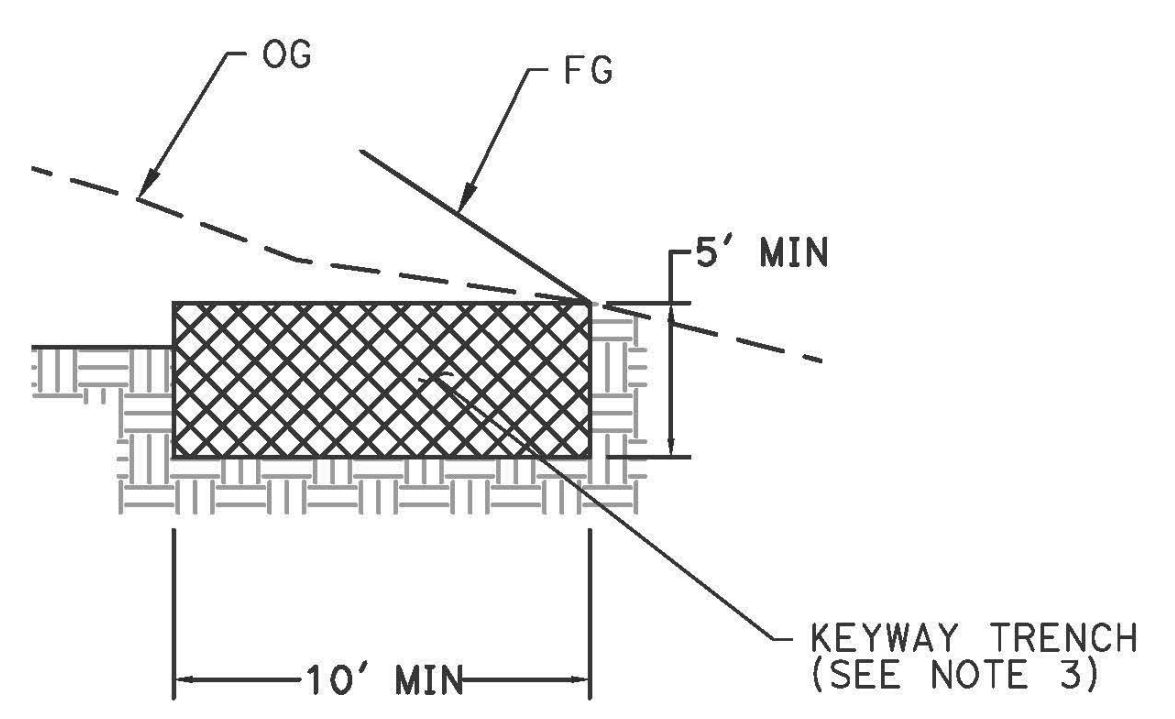

KEYWAY TRENCH DETAIL
NO SCALE

GENERAL NOTES:

1. RSP FABRIC (CLASS 8) TO BE EMBEDDED 0.5'.
2. SEE SHEET D-3 FOR SCHEMATIC UNDERDRAIN PLAN AND DETAIL.
3. KEYWAY TRENCH SHALL BE EXCAVATED TO A MINIMUM DEPTH OF 5' INTO FIRM, COMPETENT MATERIAL.
4. WHILE THE TOE OF EXCAVATION IS EXPOSED, THE ENGINEER MUST EXAMINE THE EXCAVATION PRIOR TO BACKFILLING. CONTRACTOR SHALL PROVIDE 24 HOURS ADVANCED NOTICE TO THE ENGINEER FOR SCHEDULING TOE EXAMINATION.
5. BENCHING WITHIN 12' OF THE KEYWAY TRENCH SHALL BE 2:1, UNLESS OTHERWISE SPECIFIED BY THE ENGINEER. ALL OTHER BENCHING SHALL BE 1:1 MAX.
6. BENCHING SHALL BE CUT INTO THE ORIGINAL SLOPE A MINIMUM OF 3' INTO FIRM, COMPETENT MATERIALS.

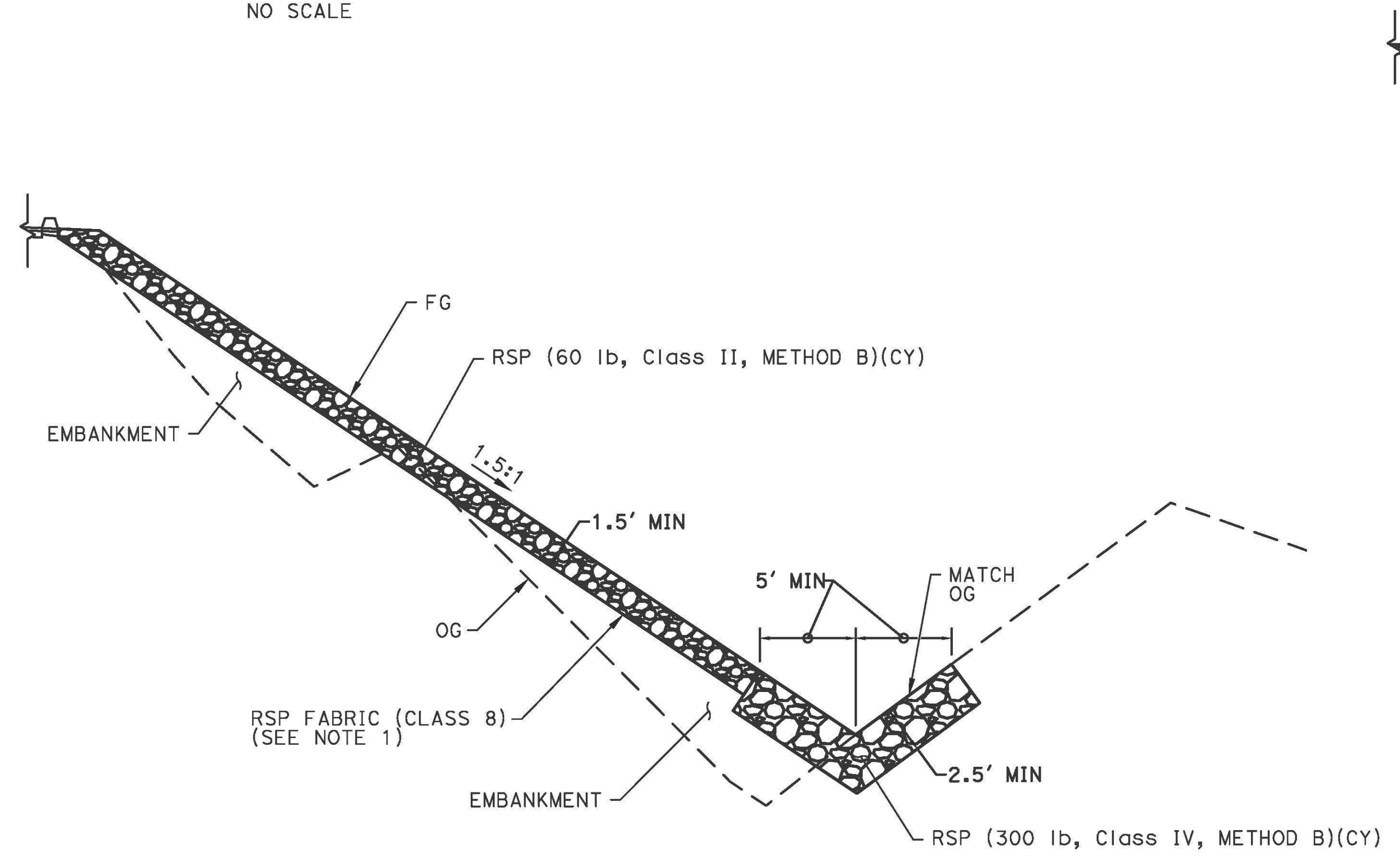

TYPICAL CROSS SECTION
NO SCALE

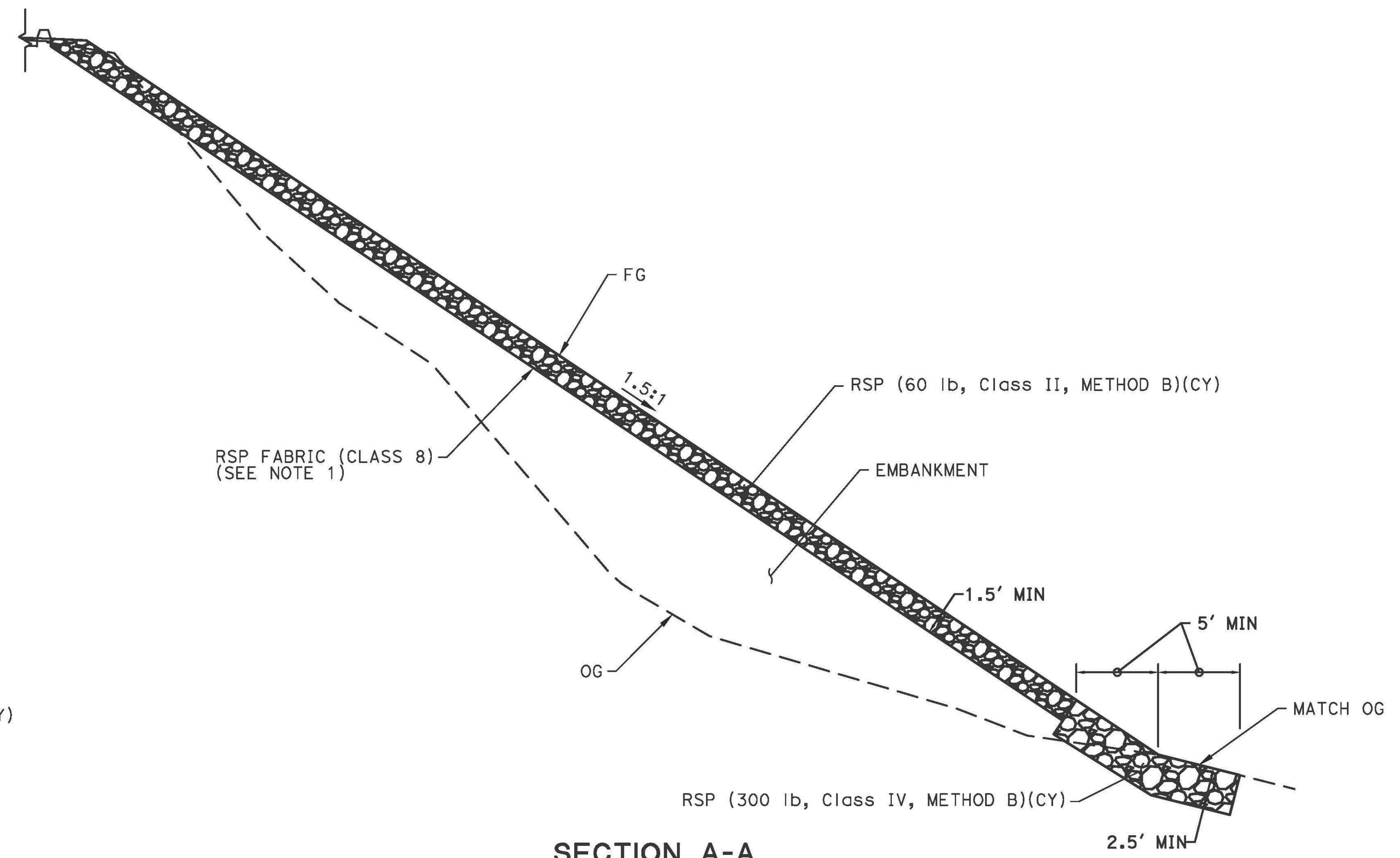

SECTION A-A
SCALE: 1"=5'

SITE 2-GRADING DETAILS
SCALE : 1" = 5' H,V

REVISION	NUMBER	DATE	DESCRIPTION	BY

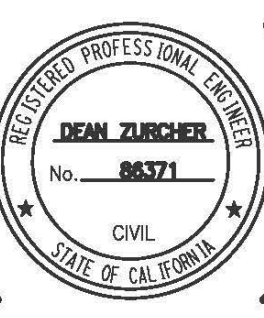

PREPARED UNDER THE SUPERVISION OF:
Dean Zurcher
 REGISTERED CIVIL ENGINEER
 DATE: 3/21/18

DESIGNED: DZ
 DRAWN: DZ
 CHECKED: BF
 DATE: 3/21/18
 ROAD NUMBER: 1041

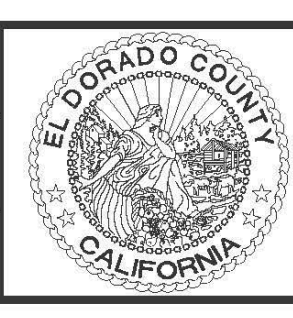

COUNTY OF EL DORADO
COMMUNITY DEVELOPMENT AGENCY
TRANSPORTATION DIVISION

WHITE MEADOW RD AND
PEAVINE RIDGE RD
STORM DAMAGE REPAIR

SHEET
GR-3
 8 OF 12
 W.O. No. 78711

ORIGINAL SCALE IS IN INCHES
 Drawing name: C:\Civil 3D Projects\78711 White Meadows Rd Slipout\CADD Files\Sheets\D-1.dwg Layout Tab: D-1 Jun 18, 2018 - 8:29am SMC/ky
 FOR REDUCED PLANS
 0 1 2

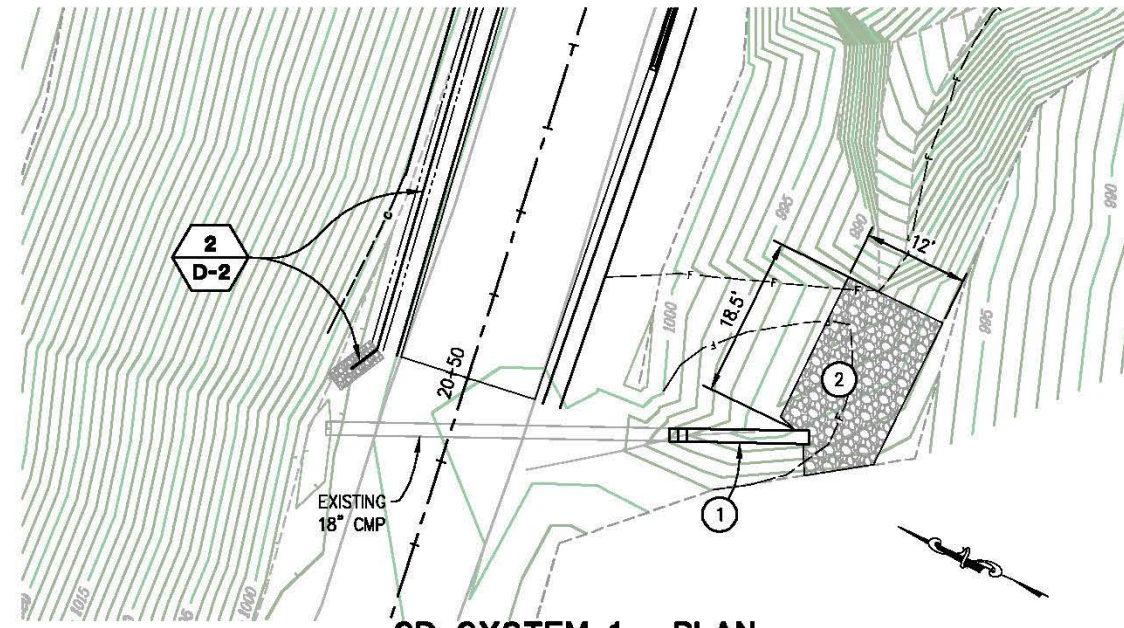

SD SYSTEM 1 - PLAN

SCALE: 1"=10'

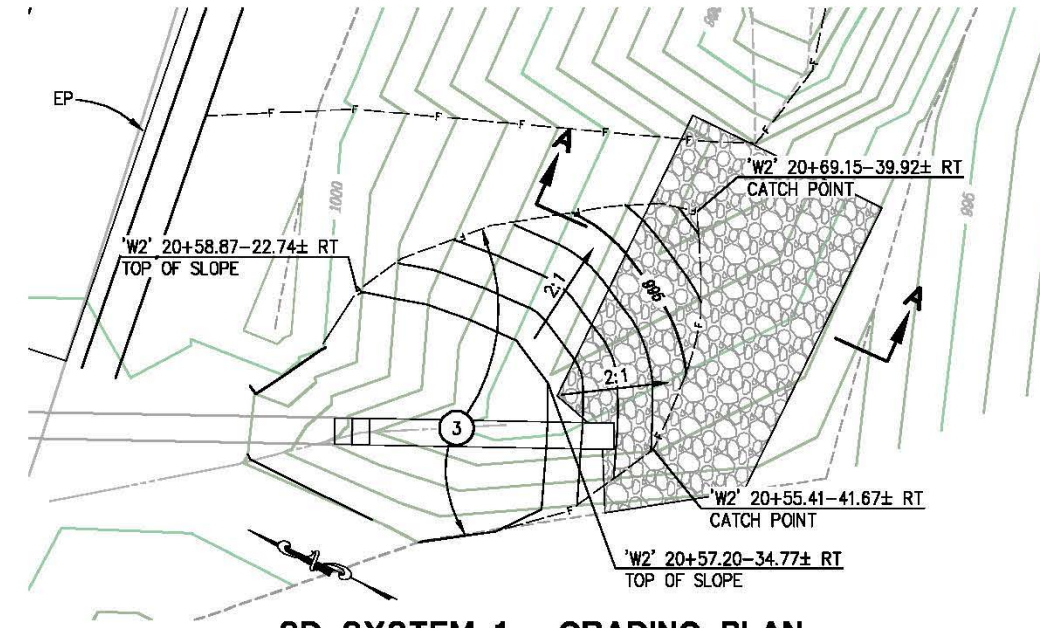

SD SYSTEM 1 - GRADING PLAN

SCALE: 1"=5'

CONSTRUCTION NOTES:

- ③ — 1' MIN COVER OVER 18" CMP,
2:1 SIDE SLOPES

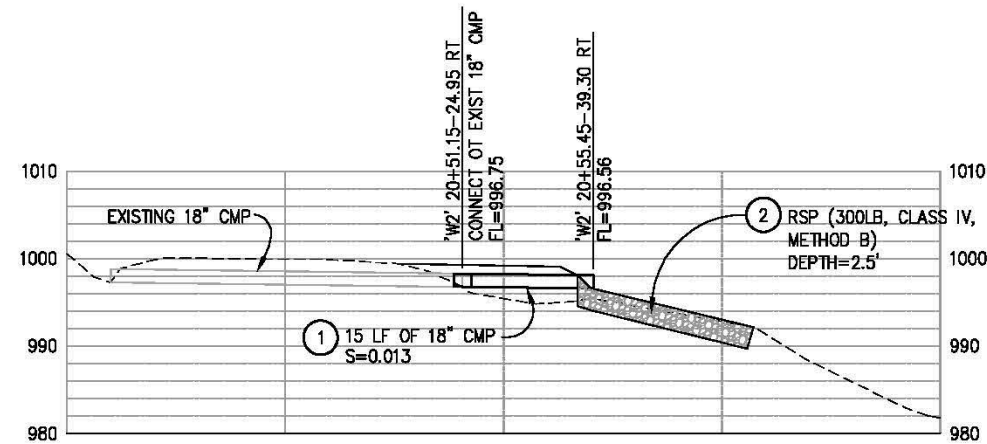

SD SYSTEM 1 - PROFILE

SCALE: 1"=10' H,V

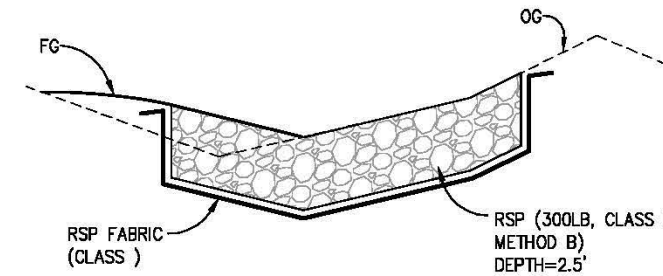

SECTION A-A

SCALE: 1"=5'

**SITE 2-DRAINAGE
SCALE : AS SHOWN**

REVISION	NUMBER	DATE	DESCRIPTION	BY



PREPARED UNDER THE SUPERVISION OF:
Dwight G. Anderson
 REGISTERED CIVIL ENGINEER
 DATE: 05/23/18

DESIGNED: DA DRAWN: SGM
 CHECKED: CG DATE: 02/26/18
 ROAD NUMBER: 1041



**COUNTY OF EL DORADO
DEPARTMENT OF TRANSPORTATION**

**WHITE MEADOW RD AND
PEAVINE RIDGE RD
STORM DAMAGE REPAIR**

SHEET
D-1
 9 OF 12
 W.D. No. **78711**

ORIGINAL SCALE IS IN INCHES
 Drawing name: C:\Civil 3D Projects\78711 White Meadows Rd Slopout\CADD Files\Sheets\D-1.dwg Layout Tab: D-2 Jun 18, 2018 - 8:28am Shiveley
 FOR REDUCED PLANS
 2
 1
 0

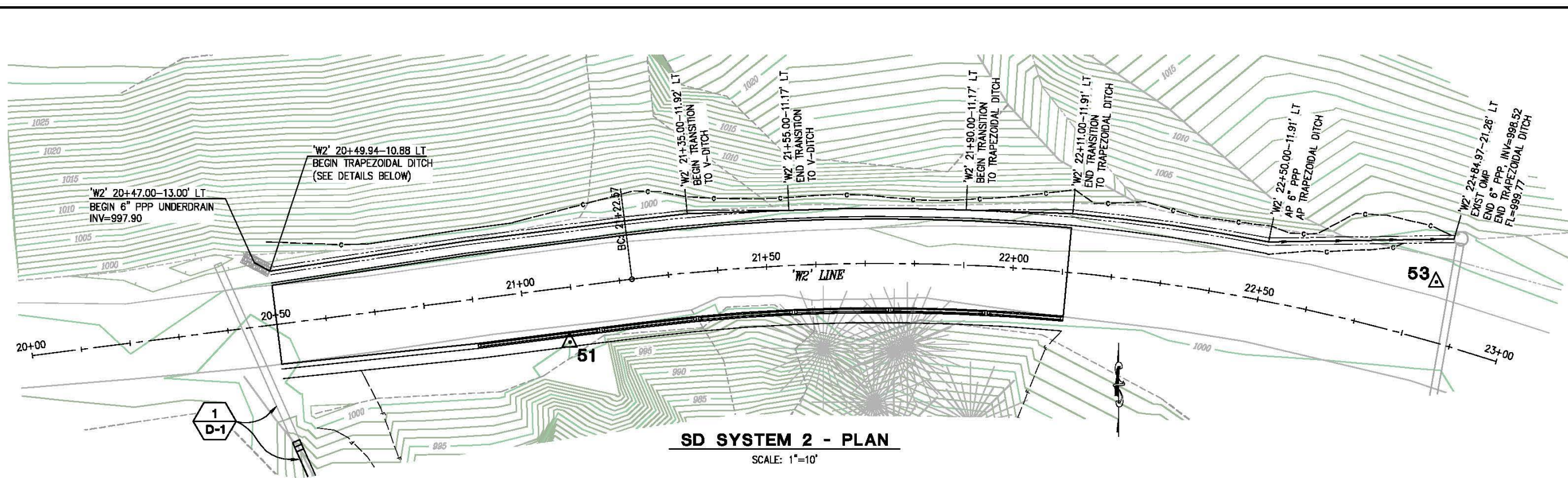

SD SYSTEM 2 - PLAN
SCALE: 1"=10'

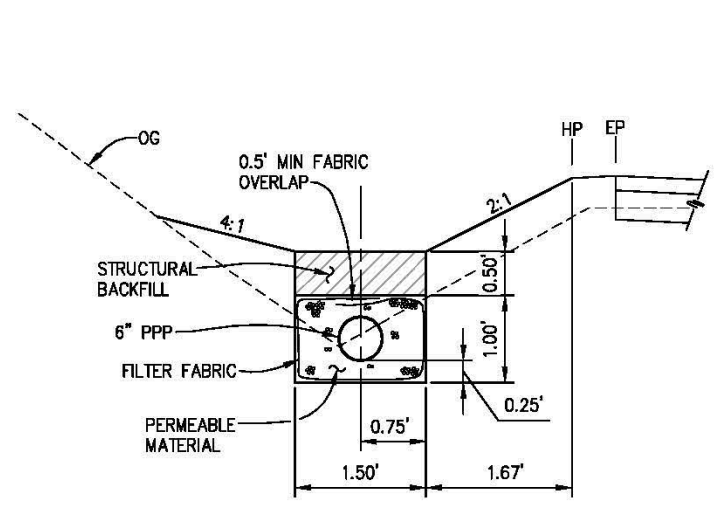

'W2' 20+50 TO 21+35
'W2' 22+11 TO 'W2' 22+50
TRAPEZOIDAL DITCH & UNDERDRAIN
NTS

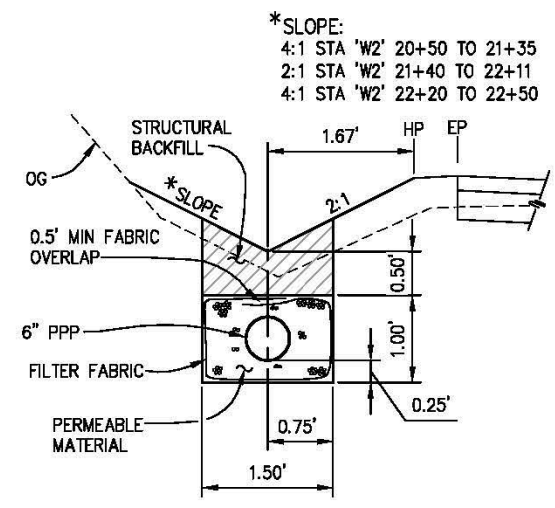

'W2' 21+55 TO 'W2' 21+90
V-DITCH & UNDERDRAIN
NTS

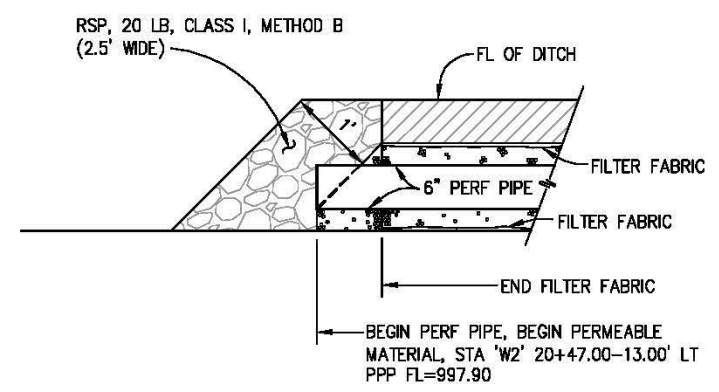

'W2' 21+55 TO 'W2' 21+90
V-DITCH & UNDERDRAIN
NTS

NOTE:
 TRANSITION TRAPEZOIDAL DITCH BOTTOM 1.5' TO 0' V-DITCH BOTTOM FROM STA 'W2' 21+35 TO 21+55
 TRANSITION V-DITCH BOTTOM 0' TO 1.5' TRAPEZOIDAL DITCH BOTTOM FROM STA 'W2' 21+90 TO 'W2' 22+11

SITE 2-DRAINAGE
SCALE : AS SHOWN

REVISION	NUMBER	DATE	DESCRIPTION	BY



PREPARED UNDER THE SUPERVISION OF:
Dwight G. Anderson
 REGISTERED CIVIL ENGINEER
 DATE: 05/23/18

DESIGNED: DA
 DRAWN: SGM
 CHECKED: CG
 DATE: 02/26/18
 ROAD NUMBER: 1041



COUNTY OF EL DORADO
DEPARTMENT OF TRANSPORTATION

WHITE MEADOW RD AND
PEAVINE RIDGE RD
STORM DAMAGE REPAIR

SHEET
D-2
10 OF 12
W.D. No. **78711**

ORIGINAL SCALE IS IN INCHES
 Drawing name: I:\Sacramento\Projects\710101-00\600_CADD\05_Official\Civil\Sheets\04-101_D-3.dwg Layout Tab: D-1 Mar 21, 2018 12:23pm dzurcheh
 FOR REDUCED PLANS
 2
 1
 0

GENERAL NOTES:

1. UNDERDRAINS SHALL HAVE A MINIMUM SLOPE OF 1% AND SHALL GRADE TO DRAIN.
 UNDERDRAINS SHALL SLOPE EAST TO WEST AND OUTLET ABOVE THE RSP.
 UNDERDRAINS SHALL BE INSTALLED FROM STATION "W2" 20+70 TO "W2" 22+00.
2. UNDERDRAINS SHALL HAVE A MINIMUM SLOPE OF 1% AND GRADE TO DRAIN.

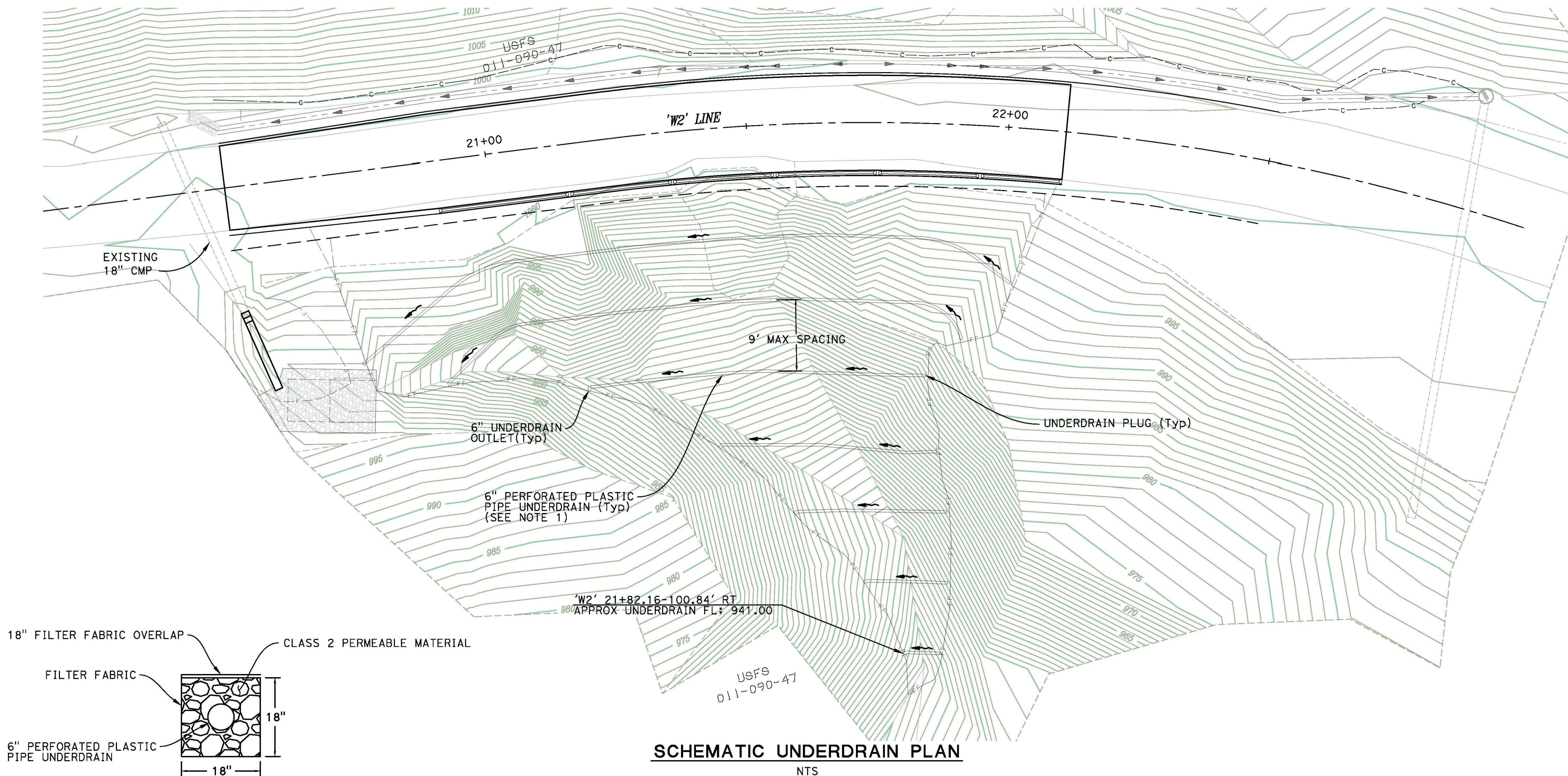

SITE 2-DRAINAGE PLAN
SCALE : AS SHOWN

REVISION	NUMBER	DATE	DESCRIPTION	BY



PREPARED UNDER THE SUPERVISION OF:
Dean Zurcher
 REGISTERED CIVIL ENGINEER
 DATE: 3/21/18

DESIGNED: DZ
 DRAWN: DZ
 CHECKED: BF
 DATE: 3/21/18
 ROAD NUMBER: 1041



COUNTY OF EL DORADO
COMMUNITY DEVELOPMENT AGENCY
TRANSPORTATION DIVISION

WHITE MEADOW RD AND
PEAVINE RIDGE RD
STORM DAMAGE REPAIR

SHEET
D-3
 11 OF 12
 W.D. No. **78711**

ORIGINAL SCALE IS IN INCHES
 Drawing name: I:\Sacramento\Projects\710101-00-600-CADD\05-Official\Civil\Sheets\05-101-EC-2.dwg
 Layout Tab: EC-2
 Mar 21, 2018 12:13pm dZurcher

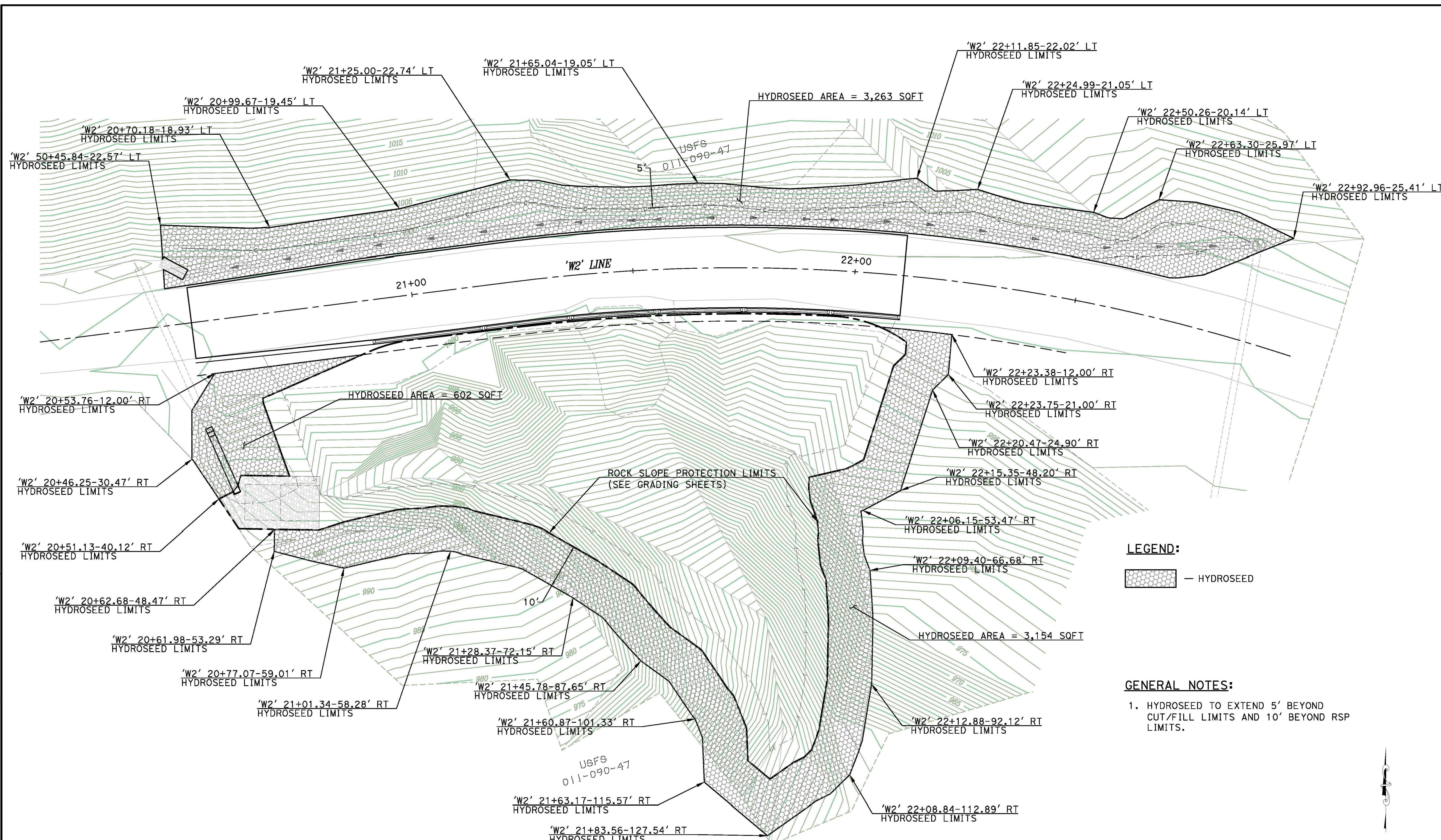

LEGEND:

— HYDROSEED

GENERAL NOTES:

1. HYDROSEED TO EXTEND 5' BEYOND CUT/FILL LIMITS AND 10' BEYOND RSP LIMITS.

SITE 2-EROSION CONTROL
 SCALE : 1" = 10'

REVISION	NUMBER	DATE	DESCRIPTION	BY

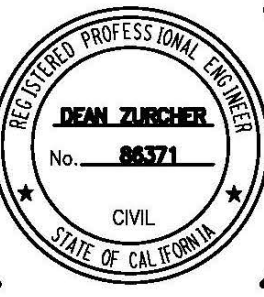

PREPARED UNDER THE SUPERVISION OF:
Dean Zurcher
 REGISTERED CIVIL ENGINEER
 DATE: 3/21/18

DESIGNED: DZ
 DRAWN: DZ
 CHECKED: BF
 DATE: 3/21/18
 ROAD NUMBER: 1041



COUNTY OF EL DORADO
COMMUNITY DEVELOPMENT AGENCY
TRANSPORTATION DIVISION

WHITE MEADOW RD AND
PEAVINE RIDGE RD
STORM DAMAGE REPAIR

SHEET
EC-2
 12 OF 12
 W.D. No. 78711