Mosquito Bridge Conversion Project Overview & Grant Opportunity

Parks and Recreation Commission

September 16, 2021



**El Dorado County
Department of Transportation**

State Parks Grant

Rural Recreation and Tourism Program (RRTP) Grant

- EDC Department of Transportation (DOT) anticipates submitting 3 applications:
 - Mosquito Conversion Project
 - El Dorado Trail/ Missouri Flat Road Bike/Pedestrian Overcrossing
 - Old Deport Park Playground & Multigenerational Exercise Circuit and Parking Lot

Mosquito Bridge Conversion Project

PROJECT HISTORY

- Mosquito Bridge Replacement Project
 - Conversion of Existing Bridge to Bicycle and Pedestrian Bridge



Mosquito Bridge Conversion Project

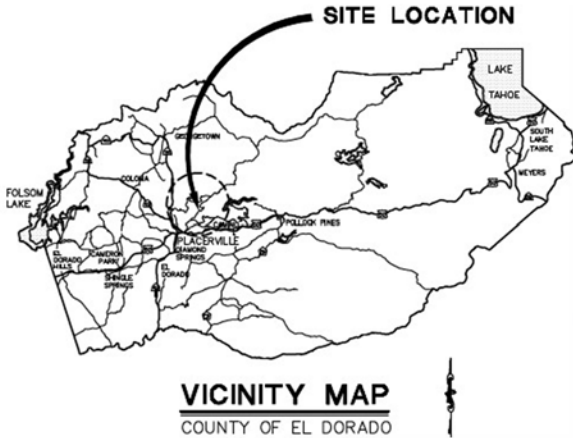

Mosquito Bridge Conversion Project



Mosquito Bridge Conversion Project

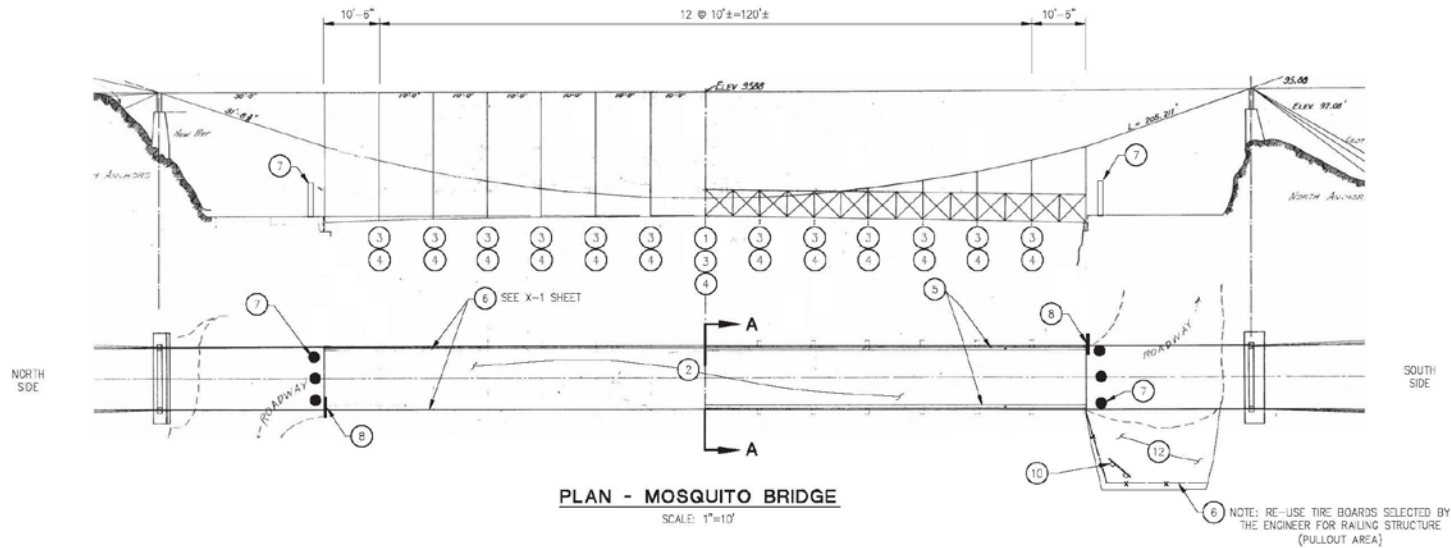

CONSTRUCTION NOTES:

- ① — REMOVE AND REPLACE ONE 10"x18", #7 TIMBER FLOORBEAM IDENTIFIED BY THE BRIDGE MAINTENANCE SUPERVISOR.
- ② — REMOVE AND REPLACE TREATED DECKING TIMBERS..
- ③ — EPOXY INJECT ALL EXISTING 10"x18" TIMBER FLOORBEAMS TO INCREASE LIFESPAN AND REDUCE MAINTENANCE.
- ④ — INSTALL FLASHING ON ALL EXISTING AND REPLACED 10"x18" TIMBER FLOORBEAMS TO INCREASE LIFESPAN AND REDUCE MAINTENANCE.
- ⑤ — REMOVE AND REPLACE TIRE BOARDS FOR KICK BOARDS THAT CONFORM TO PEDESTRIAN RAILING.
- ⑥ — UPGRADE AND INSTALL PEDESTRIAN CODE COMPLIANT RAILING USING 2"x4" WELDED WIRE MESH AND 1" STEEL STOCK CONNECTORS. PER 2011 CALIFORNIA BUILDING CODE, PEDESTRIAN RAIL HEIGHT MUST HAVE A MINIMUM 42" HEIGHT WITH SPACING THAT WILL NOT ALLOW A 4" SPHERE TO PASS.
- ⑦ — INSTALL REMOVABLE BOLLARDS AT BOTH ENDS OF BRIDGE.
- ⑧ — INSTALL ACCESS AND MAXIMUM LOADING SIGNAGE. (4 EACH)
- ⑨ — RELOCATE SOUTH GATE. SEE SHEET L-2.
- ⑩ — INSTALL INFORMATION AND HISTORY KIOSK, SEE DETAIL ON SHEET L-3.
- ⑪ — PAINT ENTIRE TIMBER BRIDGE ELEMENTS.
- ⑫ — RE-GRADE AND ROCK EXISTING PULLOUT AREA ADJACENT TO BRIDGE FOR EROSION CONTROL AND SAFETY. THE EXACT AREA TO BE DETERMINED IN THE FIELD BY THE ENGINEER.
- ⑬ — PATCH REPAIR AND RE-PAVE THE SOUTH PULLOUT/PARKING AREA. EXACT AREA TO BE DETERMINED IN THE FIELD BY THE ENGINEER.

NOTES:

- 1. NO NEW EXCAVATION OR CLEARING WILL BE PERFORMED OUTSIDE OF EXISTING IMPROVEMENTS.
- 2. ASSUME 1.5 MILES OF MOSQUITO ROAD BETWEEN GATES x 14' ROAD WIDTH AVERAGE=2.5 ACRES OWNED PARK SIZE.

PRELIMINARY 60%

LAYOUT SCALE : AS NOTED

REVISION	DATE	DESCRIPTION

PREPARED UNDER THE SUPERVISION OF :

REGISTERED CIVIL ENGINEER

DATE

DESIGNED BY: BF

DRAWN BY: RR

CHECKED BY: BF

DATE: 9/15/21

ROAD NUMBER: 60



COUNTY OF EL DORADO
DEPARTMENT OF TRANSPORTATION

MOSQUITO BRIDGE CONVERSION
at SOUTH FORK 21440A 01 of 2

SHEET L-2
4 of 5

Mosquito Bridge Conversion Project



Mosquito Bridge Conversion Project

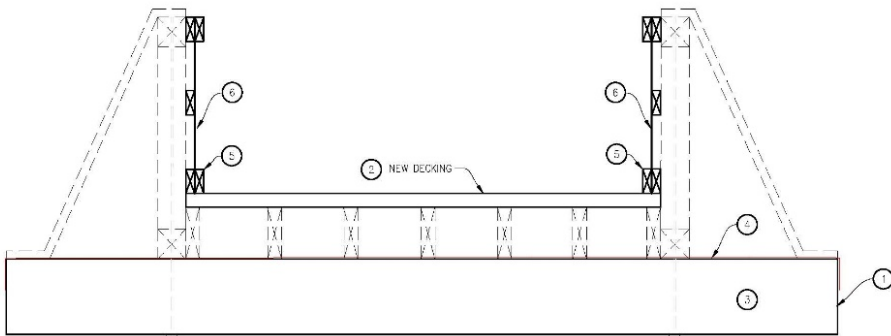
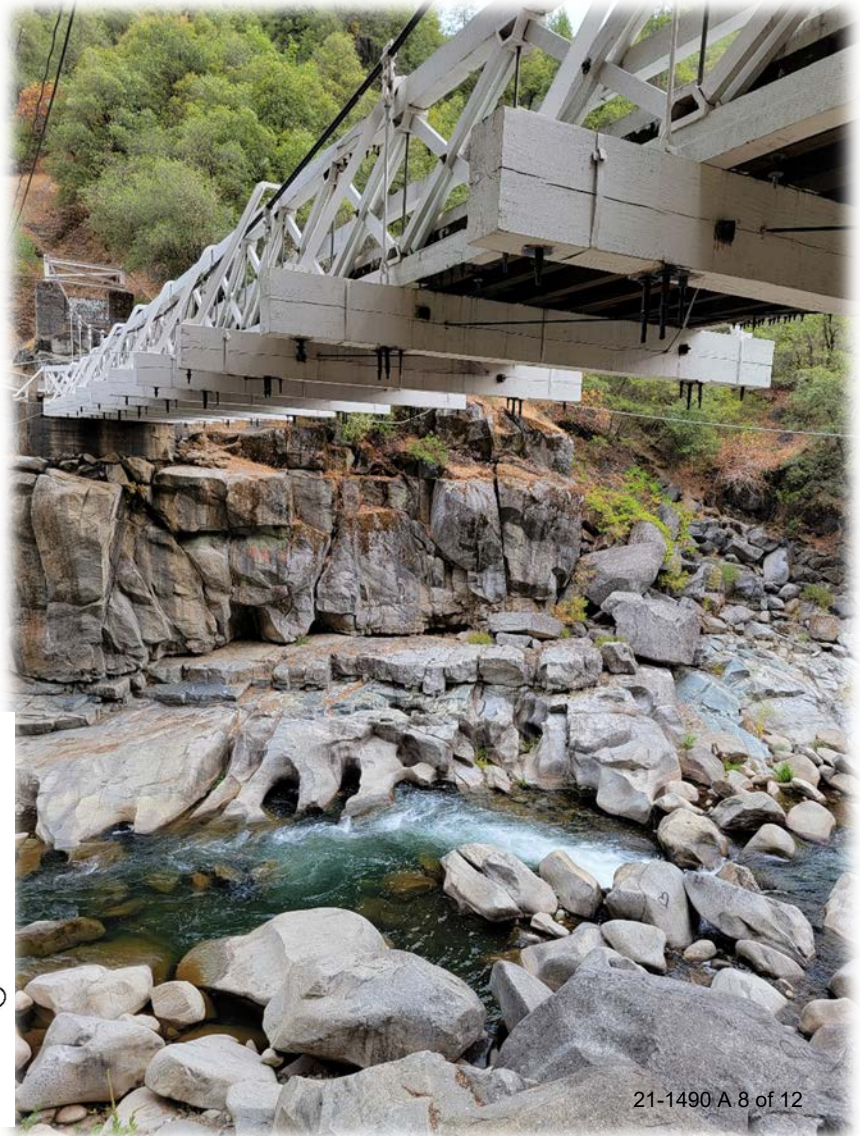

SECTION A-A PROPOSED
NTS

PRELIMINARY 60%

Mosquito Bridge Conversion Project

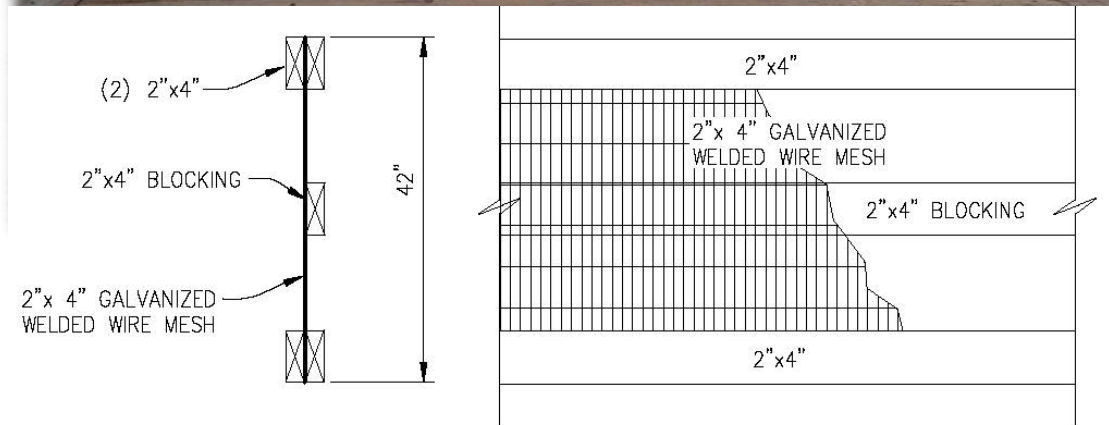

PEDESTRIAN RAILING

NTS

PRELIMINARY 60%

Mosquito Bridge Conversion Project

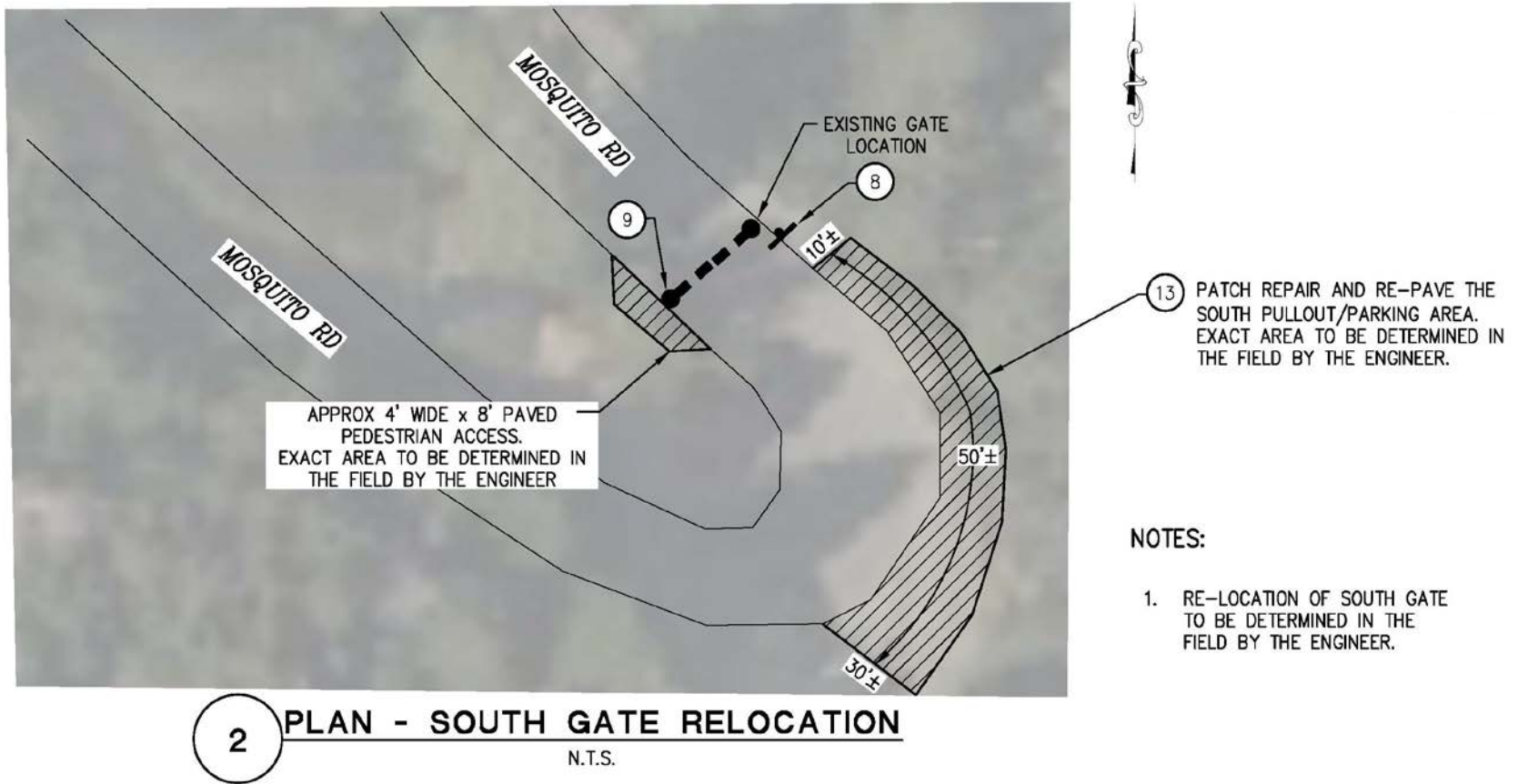

PRELIMINARY 60%

Next Steps

- October 21st: Follow-Up Public Workshop
- November 5th: Grant Submittal Deadline



Questions?

Staff Contact Info

Brian Franklin - Project Manager
Mosquito Bridge Conversion Project

brian.franklin@edcgov.us

(530) 621-5311