

***.**
***.ord
00/00/00



ORDINANCE NO. 5225

THE BOARD OF SUPERVISORS OF THE COUNTY OF EL DORADO DOES ORDAIN AS FOLLOWS:  
RELATED TO REZONING IN THE EL DORADO / DIAMOND SPRINGS AREA, (DIAMOND SPRINGS PARK):

Section 1. The Official Zoning Map is hereby amended to rezone the following described lands, as shown in Exhibit A:

Assessor's Parcel No. 331-400-002-000 being described as a portion of Section 36, T10N, R10E, M.D.M., consisting of 29.87 acres hereto.

The parcel is hereby amended:

From: One-Acre Residential (R1A)

To: Recreational Facilities, High-Intensity (RF-H);

Assessor's Parcel No. 331-301-019-000 being described as a portion of Section 36, T10N, R10E, M.D.M., consisting of 9.72 acres hereto.

The parcel is hereby amended:

From: Single-Unit Residential (R1)

To: Recreational Facilities, High-Intensity (RF-H);

Section 2. This ordinance shall take effect and shall become effective thirty (30) days following the adoption hereof.

PASSED AND ADOPTED by the Board of Supervisors of the County of El Dorado at a regular meeting of said Board, held on the 11th day of March, 2025, by the following vote of said Board:

ATTEST

**Kim Dawson**

Clerk of the Board of Supervisors

By

Deputy Clerk

Ayes: Turnboo, Laine, Ferrero, Veerkamp

Noes: Parlin

Absent: None

George Turnboo, Chair, Board of Supervisors

**APPROVED AS TO FORM**  
**Jefferson Billingsley**  
**Deputy County Counsel**

By:  (See) \_\_\_\_\_  
Title: \_\_\_\_\_

# Exhibit A

## Existing Zoning Designations

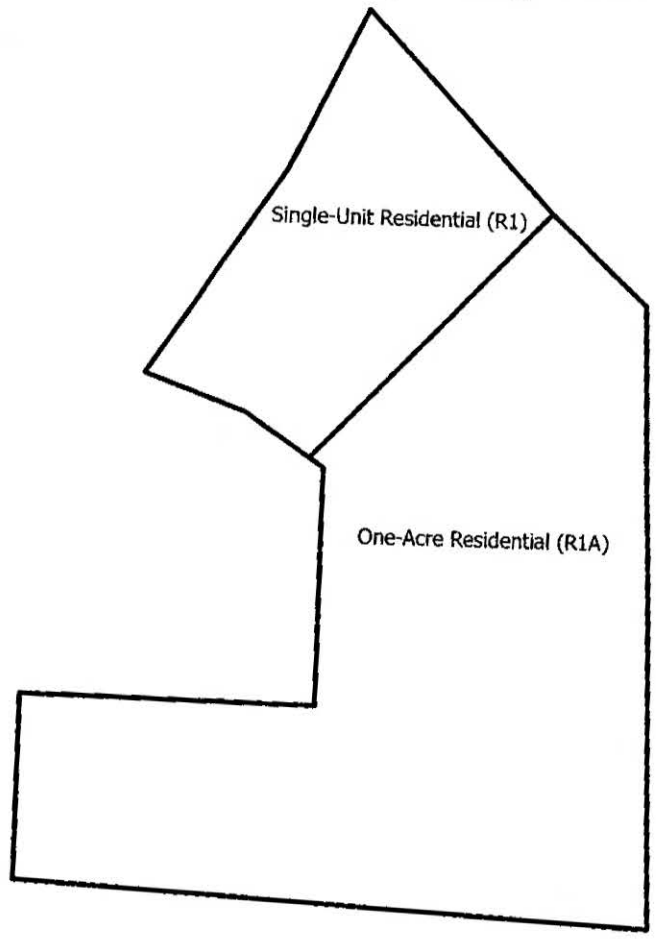

## Proposed Zoning Designations

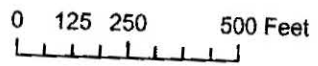
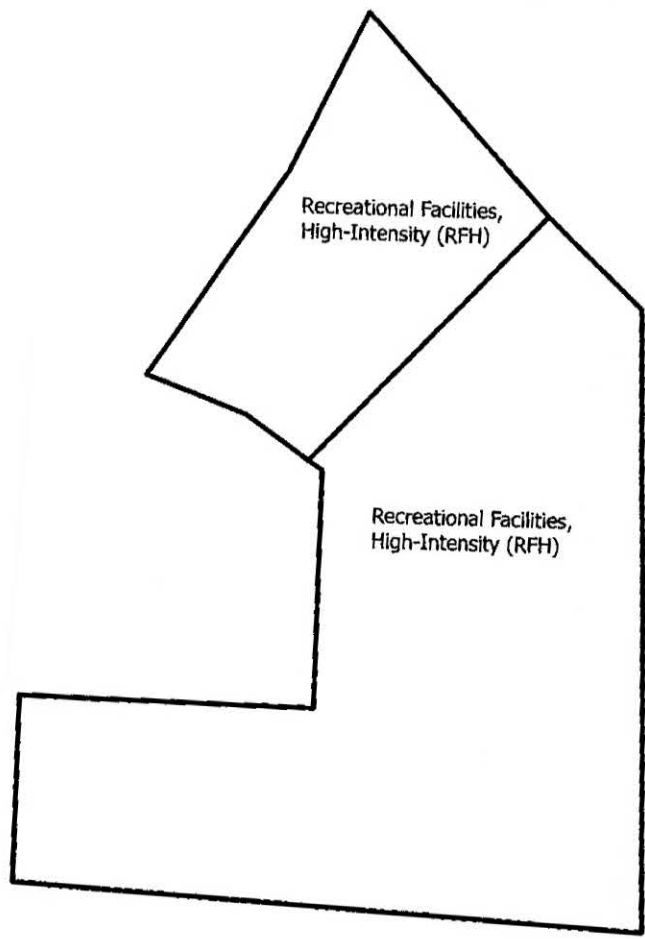

Map created December 17, 2024.