



El Dorado, County Recorder  
William Schultz Co Recorder Office  
**DOC- 2018-0028668-00**

Acct 200-VITALCHECK  
Wednesday, JUL 25, 2018 09:11:32  
Ttl Pd \$92.00 Rcpt # 0001950503  
MMP/C1/1-1

TYPE OF MAP: ASSESSMENT DISTRICT MAP

BOOK: 5 PAGE: 18

REQUESTED BY: BASS LAKE HILLS CFD

DESCRIPTION: MAP OF PROPOSED BOUNDARIES OF THE EL DORADO COUNTY COMMUNITY  
FACILITIES DISTRICT NO 2018-1 (BASS LAKE HILLS)

\_\_\_\_\_  
\_\_\_\_\_  
\_\_\_\_\_  
\_\_\_\_\_  
\_\_\_\_\_  
\_\_\_\_\_

APN # 119-020-50-100, 119-020-52-100  
115-040-16-100

NO. OF MAP PAGES 1

07/25/2018, 20180028668

5/18

**MAP OF PROPOSED BOUNDARIES  
OF THE EL DORADO COUNTY  
COMMUNITY FACILITIES DISTRICT NO. 2018-1  
(BASS LAKE HILLS)**

COUNTY OF EL DORADO  
STATE OF CALIFORNIA

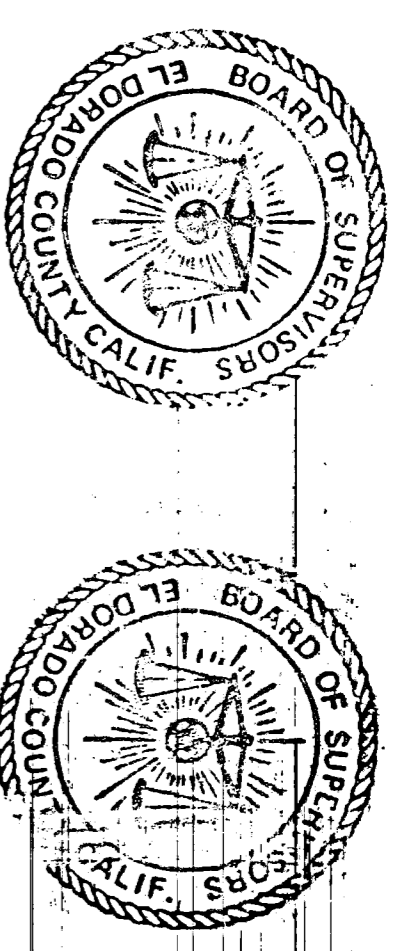
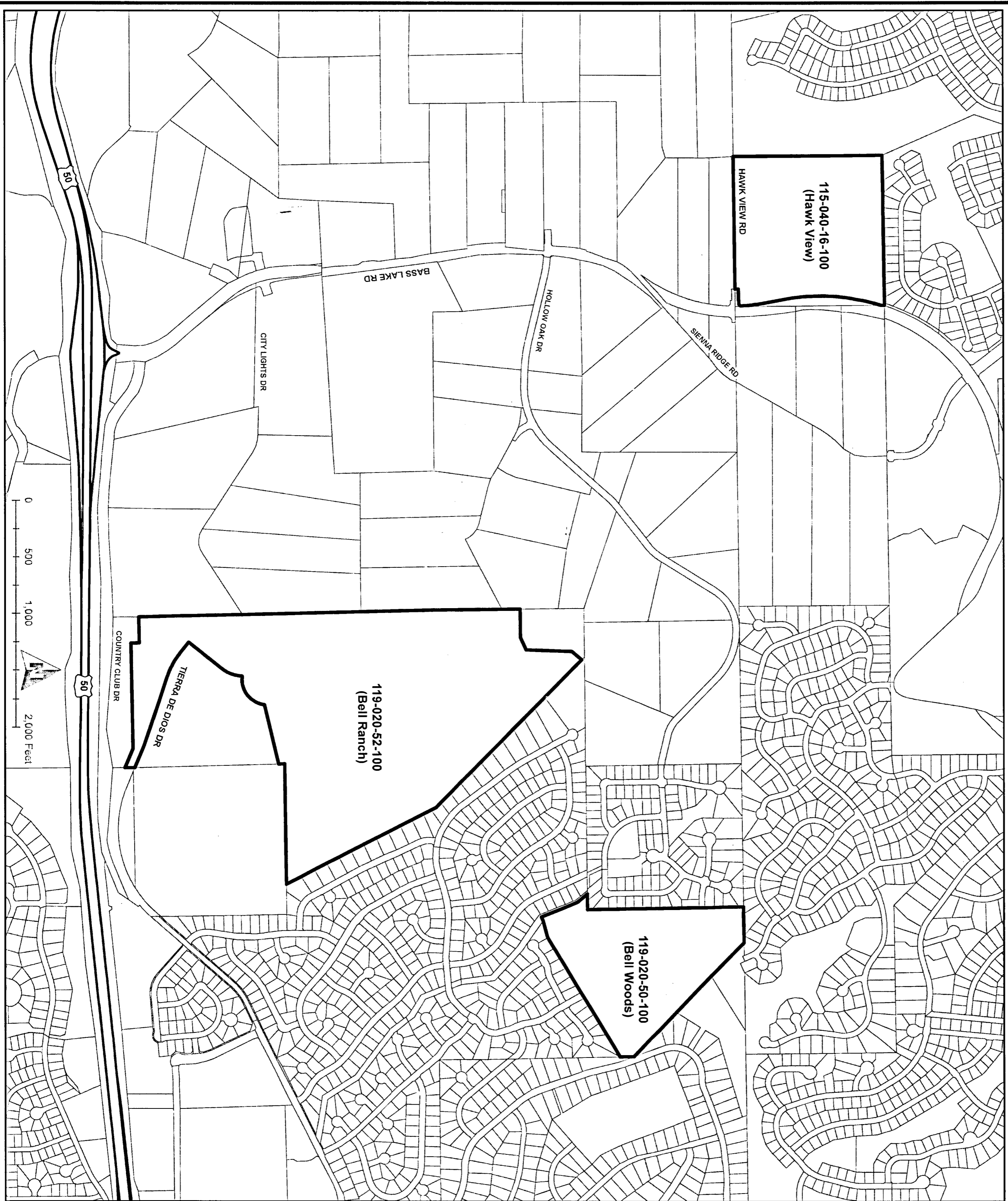

5/18

Sheet 1 of 1

FILED IN THE OFFICE OF THE CLERK OF THE BOARD OF THE COUNTY OF EL DORADO THIS 17 DAY OF JULY, 2018.

*James J. McKeown*  
CLERK OF THE BOARD

I HEREBY CERTIFY THAT THE WITHIN MAP SHOWING PROPOSED BOUNDARIES OF THE EL DORADO COUNTY COMMUNITY FACILITIES DISTRICT NO. 2018-1 (BASS LAKE HILLS) WAS APPROVED BY THE BOARD OF SUPERVISORS OF THE COUNTY OF EL DORADO, AT A MEETING THEREOF, HELD ON THE 17 DAY OF JULY, 2018, BY ITS RESOLUTION NO. 1977-2018

*James J. McKeown*  
CLERK OF THE BOARD

FILED THIS 25 DAY OF JULY, 2018, AT THE HOUR OF 9 O'CLOCK AM, IN BOOK 5 OF MAPS OF ASSESSMENT AND COMMUNITY FACILITIES DISTRICTS, AT PAGE 18 IN THE OFFICE OF THE COUNTY RECORDER IN THE COUNTY OF EL DORADO, STATE OF CALIFORNIA.

*William E. Schultz* by: *Michele Probst, Deputy*  
COUNTY RECORDER  
COUNTY OF EL DORADO

FOR PARTICULARS OF THE LINES AND DIMENSIONS OF ASSESSOR'S PARCELS, REFERENCE IS MADE TO THE MAPS OF THE ASSESSOR OF THE COUNTY OF EL DORADO, STATE OF CALIFORNIA.

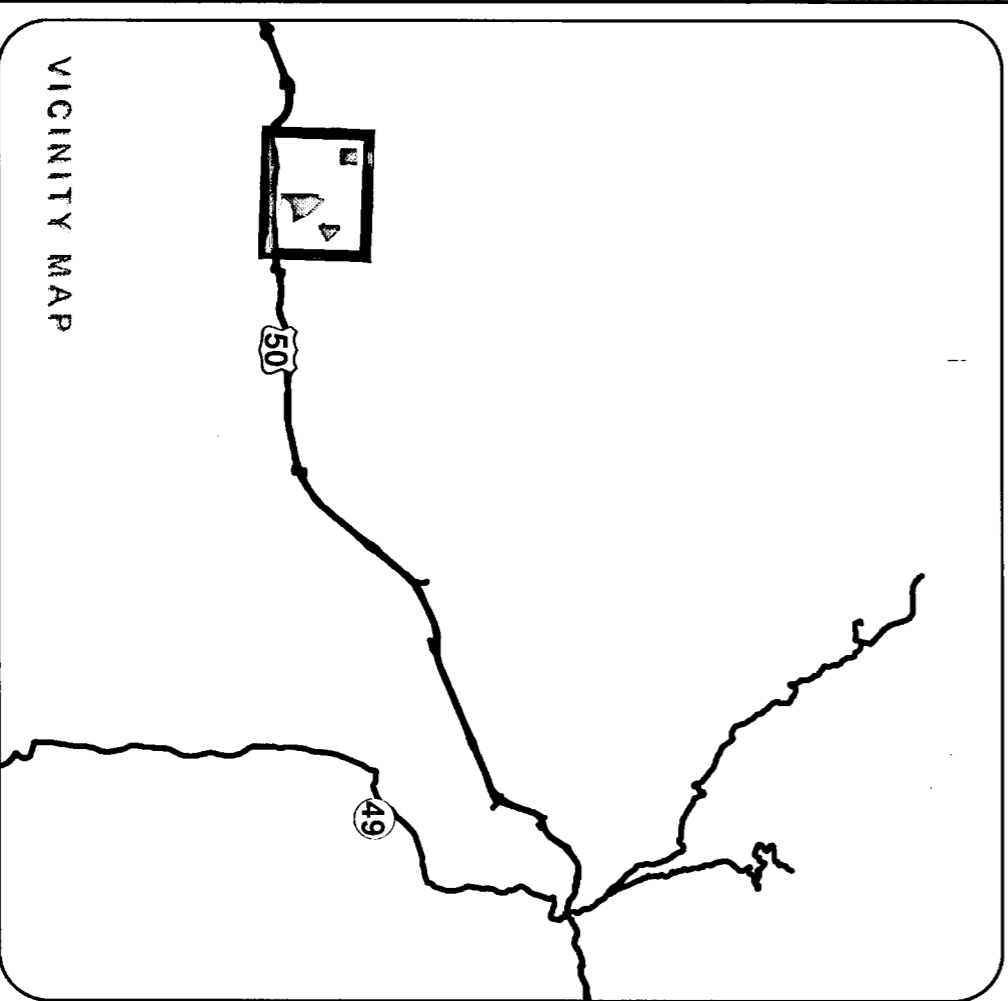

VICINITY MAP

Parcel Lines

CFD Boundaries

5/18

Source: El Dorado County GIS  
Geographic Coordinate Reference: GCS North American 1983  
Projection: NAD 1983 StatePlane California VI FIPS 0402 Feet

