

**ADDENDUM TO NEGATIVE DECLARATION  
MOTHER LODGE DRIVE TWO-WAY LEFT-TURN WIDENING PROJECT**

**El Dorado County Department of Transportation  
April 2007**

This Addendum is prepared in accordance with State CEQA Guidelines Section 15164, which provides that an Addendum to a previous negative declaration may be prepared if only minor changes or additions are necessary to make the prior document adequate for the current project.

**PROPOSED PROJECT**

The El Dorado County Department of Transportation is proposing the installation of a traffic signal, street lights as needed in the intersection, crosswalks, pedestrian-actuated crossing signals, and curb ramps at the intersection, as necessary at the intersection of Mother Lode Drive and French Creek Road as a minor addition to the Mother Lode Drive Two-Way Left-Turn Widening Project.

**PROJECT LOCATION:**

The proposed project is located in the community of Shingle Springs, in western El Dorado County (see Figure 1) just south of U.S. Highway 50 (U.S. 50) and just east of the Ponderosa Road/South Shingle Interchange. The project area extends from South Shingle Road to approximately 200 meters east of the intersection with North Star Road along Mother Lode Drive and within the existing roadway right-of-way. The full length of the project is approximately 0.7 miles. The roadway is crossed by the abandoned Southern Pacific railroad track just to the west of the roadway's intersection with French Creek Road. The project area is primarily commercially developed along Mother Lode Drive. French Creek Road leads southward from its inception at a "T" intersection with Mother Lode Drive to rural residential development in the southern areas of El Dorado County.

**EXISTING PROJECT DESCRIPTION:**

The objective of the Proposed Project is to improve traffic operations and safety along Mother Lode Drive from South Shingle Road to North Star Road. The original project description involves the installation of a two-way left-turn lane along Mother Lode Drive from South Shingle Road to approximately 200 meters east of the intersection with North Star Road. The roadway would be widened within the existing right-of-way to accommodate the proposed left-turn lane and would be restriped to delineate traffic through-lanes and the new median turn lane. Through lanes (eastbound and westbound) would be approximately 11-feet wide, the median turn lane would be approximately 12-feet wide. Paved road shoulders would be approximately 4-feet wide and would accommodate a Class II bike lane.

**MINOR MODIFICATION TO PROJECT DESCRIPTION:**

While the three-way intersection of Mother Lode Drive and French Creek Road is within the footprint of the original project, no signal was identified. This addendum is intended to include the installation of a traffic signal, street lights, crosswalks, pedestrian-actuated crossing signals, and curb ramps at the intersection, as necessary, compliant with current requirements of the Americans with Disabilities Act. No other changes or modifications are proposed.

### **PRIOR ENVIRONMENTAL DOCUMENT**

A Negative Declaration for the Mother Lode Drive Two-Way Left Turn Widening Project was adopted by the El Dorado County Board of Supervisors on April 4, 2006. No significant impacts were identified for this project and no mitigation measures were required.

### **CHANGES IN ENVIRONMENTAL CIRCUMSTANCES**

There have been no changes in existing environmental conditions since preparation and adoption of the Negative Declaration.

### **PROJECT IMPACT DISCUSSION**

No significant impacts were identified with the original project and no mitigation measures were required. The inclusion of a traffic signal, streetlights, crosswalks, pedestrian-actuated crossing signals, and curb ramps at the intersection, as necessary, does not add any additional impacts.

**Aesthetics:** No unique scenic resources, notable vistas or other notable visual attributes are present within the project area. This intersection is commercially developed. The project addendum would not introduce substantial new sources of light and glare, or adversely affect nighttime views in the project area. The proposed project would install traffic signal lights that would face east and west along Mother Lode Drive and north and south at French Creek Road. Additional street lighting would be installed at the intersection for safety reasons; however, light from street lighting and traffic signals are directional and shielded and would not appreciably increase light and glare sources beyond the roadways and would result in a less-than-significant impact.

**Agricultural Resources:** None present. No potential for impacts

**Air Quality:** The project would result in short-term air pollutant emissions from ground disturbance and vehicle operation, but would not be expected to exceed thresholds established by the El Dorado Air Quality Management District. All activities and equipment will comply with applicable rules and regulations for minimizing construction emissions. No additional impacts will occur as a result of the signal installation project.

**Biological Resources:** The project area is commercially developed along Mother Lode Drive as well as the intersection with French Creek Road. The Mother Lode Drive/French Creek Road intersection leads southward to rural residential development in the southern areas of El Dorado County. The intersection itself consists of disturbed ground and pavement. No wetlands or riparian areas, trees or sensitive vegetation are present. No biological impacts will occur as a result of the signal installation.

**Cultural Resources:** Based on the October 2000 Cultural Resources Assessment prepared for the El Dorado Irrigation District's Forcemain Replacement Project along Mother Lode Drive, no known historic resources are located within project area. However, the project would be subject to the provisions of the California Health and Safety Code Section 7050.5 and California Public Resources Code Section 5097.94 et seq., regarding the discovery and disturbance of human remains should any human remains be discovered during project construction. Therefore, potential impacts from the signal installation project are less than significant.

**Geology and Soils:** The project would require minimal earth moving and would not result substantial soil erosion or loss of topsoil. Potential impacts from the signal installation project are less than significant.

**Hazards and Hazardous Materials:** The signalization project would not result in the use of significant amounts of hazardous substances or materials and would not pose a reasonably foreseeable risk of upset or accident conditions. Potential impacts associated with Natural Occurring Asbestos (NOA) have been determined to be less than significant, as construction activities would comply with EDCAQMD rules which provide for the control of fugitive dust and NOA emissions during construction. Therefore, potential impacts from the signal installation project are less than significant.

**Hydrology and Water Quality:** The project would not result in the use or degradation of surface or groundwater supplies. Best management practices for controlling stormwater runoff from disturbed areas during construction would be utilized. Therefore, potential impacts from the signal installation project are less than significant.

**Land Use and Planning:** The installation of a traffic signal and crosswalks at Motherlode Drive and French Creek Road would not divide the existing community and is consistent with all applicable goals and policies of the 2004 General Plan for El Dorado County.

**Noise:** The installation of a traffic signal would not generate increased traffic through the project area. Project construction would result in short-term noise generation from equipment and vehicles which are not anticipated to adversely affect sensitive groups. Potential noise impacts from the signal installation project are less than significant.

**Population and Housing:** The project would not induce population growth and would not displace existing housing or people

**Public Services:** The project would require minimal increases in public services associated with the maintenance of traffic signals, equipment and other facilities to be installed by the project. This increased requirement would not be substantial and would be accommodated within the County Department of Transportation maintenance budget.

**Recreation:** The project would not adversely affect existing or planned recreational facilities.

**Transportation/Circulation:** Installation of a traffic signal would improve traffic operation and safety along the project area. The project would also improve pedestrian facilities by installing sidewalks and providing delineated crosswalks and pedestrian activated traffic signals.

#### **CEQA FINDING**

Based on the above review of the project, in accordance with State CEQA Guidelines Section 15164, no Subsequent Negative Declaration or Environmental Impact Report is required for the current project, because new information and changes in circumstances, project description, impacts and mitigations are not substantial and do not involve new significant impacts or a substantial increase in the severity of previously identified impacts.

This Addendum identifies the current project changes and minor changes to project impacts. This addendum, together with Negative Declaration adopted for the Mother Lode Drive Two-Way Left Turn Widening Project, adopted by the El Dorado County Board of Supervisors on April 4, 2006, constitute adequate environmental documentation in compliance with CEQA for the current project.

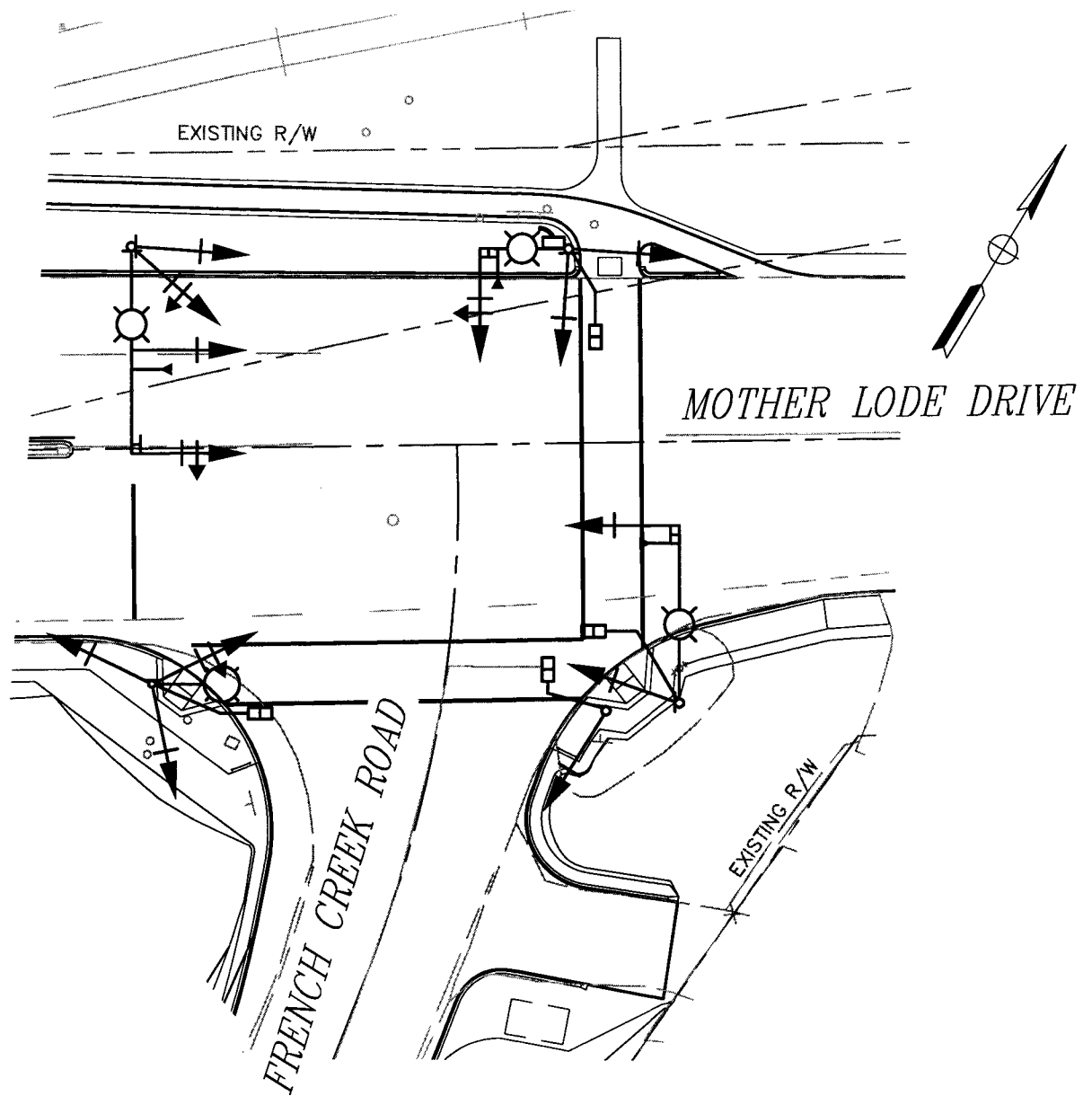

**MOTHER LODGE DRIVE TWO WAY LEFT TURN WIDENING  
TRAFFIC SIGNAL AND LIGHTING**

**FIGURE 3**