



RESOLUTION NO. 001-2012

OF THE BOARD OF SUPERVISORS OF THE COUNTY OF EL DORADO

**Resolution Accepting  
Irrevocable Offer of Dedication # 2011-0002  
Assessor's Parcel Number: 089-010-47  
Thomas R. Van Noord**

**WHEREAS**, the authority to invoke the process of dedicating an easement over, under and/or across property by the County is established under Section 7050 of the California Government Code and Section 66475 of the Subdivision Map Act; and

**WHEREAS**, the authority to accept right of way, road, slope, drainage and public utilities easements by the County, at its discretion, is established under Section 7050 of the California Government Code and Section 66477.1 of the Subdivision Map Act; and

**WHEREAS**, Thomas R. Van Noord, has executed an Irrevocable Offer of Dedication for road right-of-way, public utilities easement and slope easement to run 25' from the centerline of Thompson Hill Road; and

**WHEREAS**, said parcel is also identified as Assessor's Parcel Number 089-010-47; and

**WHEREAS**, said easement is described in Exhibit A and depicted on Exhibit B attached to said offer;

**WHEREAS**, said offer shall remain in effect and run with the land until such time the County of El Dorado Board of Supervisors accepts said offer by Resolution; and

**WHEREAS**, the County of El Dorado Board of Supervisors has determined that it is in the public's best interest to accept said offer at this time.

**NOW, THEREFORE, BE IT RESOLVED** that from and after the date this Resolution is recorded, said offer is hereby acknowledged and accepted at this time, by the County of El Dorado, Board of Supervisors.

PASSED AND ADOPTED by the Board of Supervisors of the County of El Dorado at a regular meeting of said Board, held the 10 day of January, 2012 by the following vote of said Board:

Ayes: Sweeney, Nutting, Knight, Briggs, Santiago  
Noes: none  
Absent: none

Attest:  
Suzanne Allen de Sanchez  
Clerk of the Board of Supervisors

By:   
Deputy Clerk

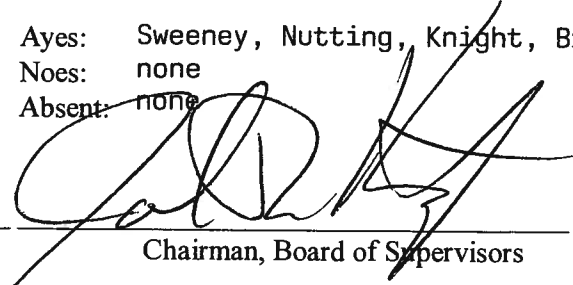
  
Chairman, Board of Supervisors

**John R. Knight**

RECORDING REQUESTED BY AND  
WHEN RECORDED MAIL TO:

County of El Dorado  
Board of Supervisors  
330 Fair Lane  
Placerville, CA 95667

APN 089-010-47

Mail Tax Statements to above.  
Exempt from Documentary Tax Transfer  
Per Revenue and Taxation Code 11922

Above section for Recorder's use

**IRREVOCABLE OFFER OF DEDICATION  
ROAD RIGHT OF WAY, PUBLIC UTILITIES, AND SLOPE  
EASEMENTS**

**Thomas R. Van Noord**, hereinafter called GRANTOR, owner of the real property herein described, does hereby irrevocably offer for dedication to the **COUNTY OF EL DORADO**, a political subdivision of the State of California, road right of way, public utilities, and slope easements for construction, and maintenance purposes, to points five feet beyond future top of cut slopes and toe of fill slopes, on, over, under and across those certain areas, situate in the unincorporated area of the County of El Dorado, State of California, as:

**Described in Exhibit A & depicted in Exhibit B, attached hereto and made a part hereof.**

It is understood that this offer of dedication shall remain in effect and run with the land until such time as the County of El Dorado Board of Supervisors makes a finding of necessity for public purposes and accepts said offer by resolution.

IN WITNESS WHEREOF, GRANTOR has hereunto subscribed his name this  
17<sup>th</sup> day of October, 2011.

  
\_\_\_\_\_  
**Thomas R. Van Noord**

~~CAILS: Signatures Must Be Notarized~~

STATE OF CALIFORNIA )  
 ) ss.  
COUNTY OF EL DORADO)

On October 17, 2011, before me, L.B. MARTINEZ, a Notary Public in and for said State, personally appeared THOMAS R. VAN NOORD, who proved to me on the basis of satisfactory evidence to be the person(s) whose name is subscribed to the within instrument and acknowledged to me that he/she/they executed the same in their authorized capacity(ies), and that by his/her/their signature(s) on the instrument the person(s), or the entity upon behalf of which the person(s) acted, executed the instrument.

I certify under PENALTY OF PERJURY under the laws of the State of California that the foregoing paragraph is true and correct.

WITNESS my hand and official seal.

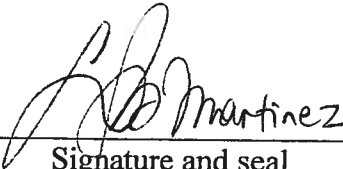
  
\_\_\_\_\_  
Signature and seal

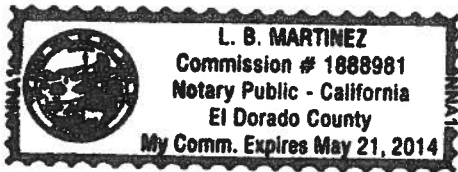

# EXHIBIT "A"

I.O.D. for COC-02-317

All that portion of the Northeast Quarter of the Southeast Quarter of Section 30, T 11 N R10 E M.D.M. more particularly described as follows:

An irrevocable offer of dedication of a road and public utilities easement the uniform width of 25.00 feet lying Southerly of adjacent to and contiguous with the following described line.

Beginning at a point in the center line of a road known as "Thompson Hill Road" from which the Southwest corner of the Northeast Quarter of the Southwest Quarter of said section bears South  $00^{\circ}-21'-24''$  West 769.85 feet thence along said centerline South  $58^{\circ}-38'-33''$  East 182.46 feet thence along the arc of a curve to the left having a radius of 225.00 feet said arc being subtended by a chord which bears South  $77^{\circ}-58'-03''$  East 149.01 feet to the terminus of this description. The sidelines of said easement shall be lengthened or shortened as necessary to terminate on the property lines.

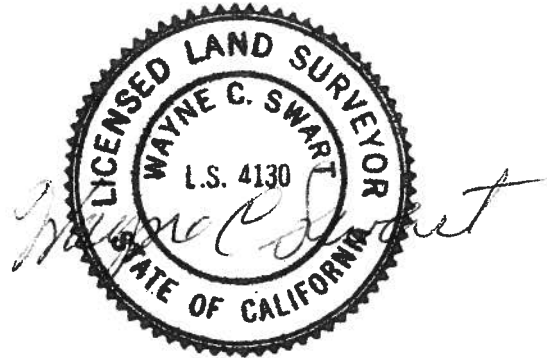

EXP. 6-30-2012

**RECEIVED**

DEC 13 2011

**EL DORADO COUNTY  
SURVEYOR**

C.O.C. 02-317  
5.9 ACRES +/-

N0°21'24"E  
769.85'

S77°58'03"E  
LC=149.01'  
R=225.00'  
A=151.88'  
T=78.96'  
D=38°40'31"

S38°38'33"E  
182.46'  
C/L THOMPSON  
HILL ROAD  
AREA OF 25' IRREVOCABLE  
OFFER OF DEDICATION

S49°05'00"W  
120.32'  
S13°46'00"E  
212.00'

S32°01'00"E  
94.70'

S47°33'00"E  
186.10'

N88°04'47"W  
836.32'

S64°33'00"E  
421.75'

SCALE 1" = 120 FEET

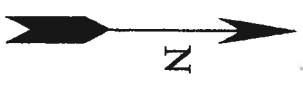

EXHIBIT  
B

**RECORDING REQUESTED BY:**

**01/11/2012, 20120001259**

**Board of Supervisors**

**WHEN RECORDED MAIL TO:**

**Board of Supervisors  
330 Fair Lane  
Placerville, CA 95667**

}  
}  
}  
}  
}  
}  
}  
}  
}  
}  
}  
}

\*\*\*\*\*

SPACE ABOVE THIS LINE RESERVED FOR  
RECORDER'S USE

**TITLE (S)**

Resolution No. 001-2012  
Resolution Accepting  
Irrevocable Offer of Dedication # 2011-0002  
Assessor's Parcel Number: 089-010-47  
Thomas R. Van Noord