

COUNTY OF EL DORADO, CA  
DEPARTMENT OF TRANSPORTATION

PROJECT PLANS FOR THE CONSTRUCTION OF  
**PONY EXPRESS TRAIL  
SLIPOUT**

IN THE COUNTY OF EL DORADO, DISTRICT 5  
LOCATED 3/4 MILE FROM THE INTERSECTION OF SLY PARK ROAD

To be supplemented with Standard Plans and Specifications dated 2015, including  
the amendments to the 2015 Standard Specifications, of the California  
Department of Transportation, unless otherwise noted.

INDEX OF SHEETS

SHEET	PLAN SHEET	TITLE
1		TITLE SHEET
2	CD-1	SURVEY AND CONTROL
3-6	L-1 TO L-4	LAYOUT SHEETS
7-8	D-1 TO D-2	DRAINAGE PLAN
9	TH-1	TRAFFIC HANDLING PLAN
10	TR-1	TREE REMOVAL PLAN

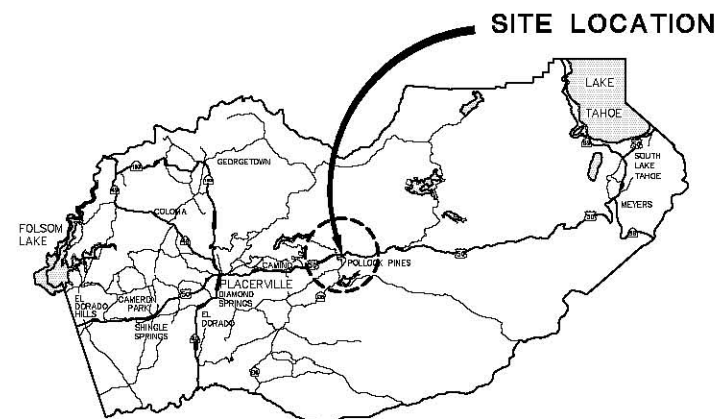

VICINITY MAP  
COUNTY OF EL DORADO

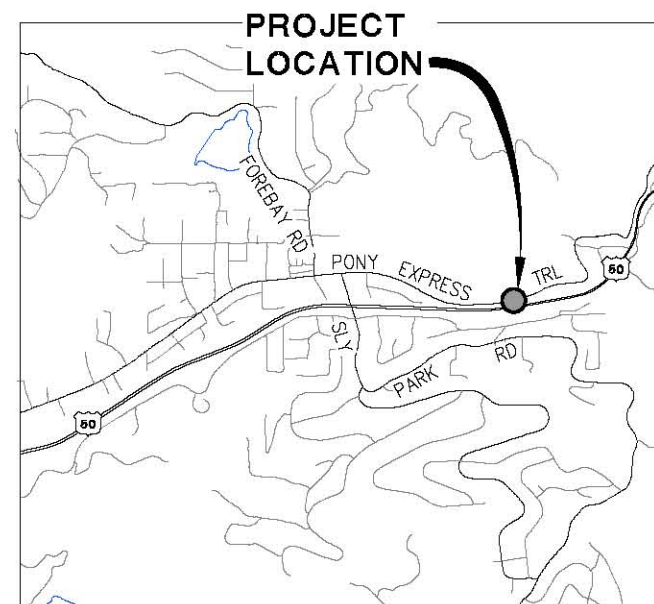

PROJECT LOCATION  
LOCATION MAP  
NTS

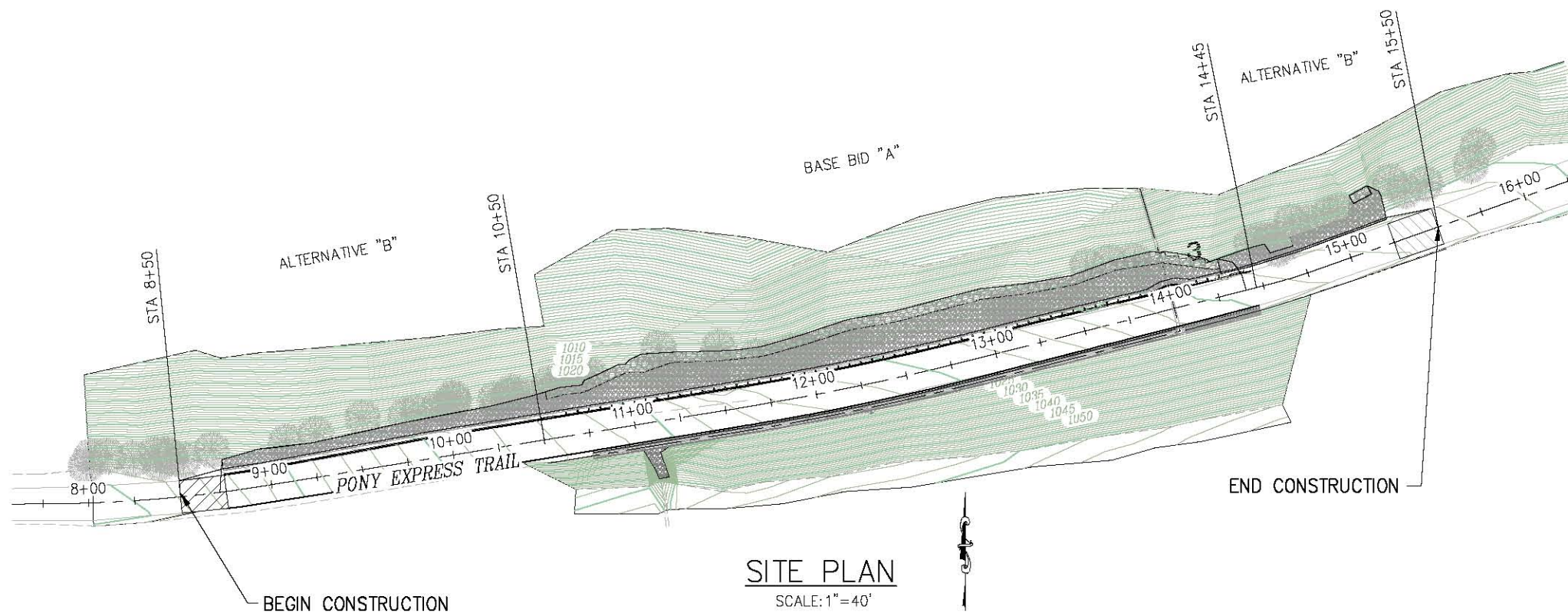

SITE PLAN  
SCALE: 1"=40'

CONTRACTOR'S LICENSE CLASSIFICATION: Bidders shall be properly licensed to perform the Work pursuant to the State Contractor's License Act (Business and Professions Code section 7000 et seq.) and shall possess a CLASS A LICENSE or equivalent combination of Classes required by the categories and type of Work included in the Contract Documents and Plans. Failure of the successful Bidder to obtain proper and adequate licensing at the time bids are submitted shall constitute a failure to execute the Contract, and forfeiture as provided under that section.

REVISIONS

MARK	DATE	BY

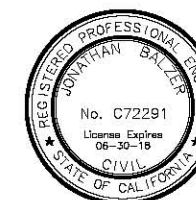

SUBMITTED BY: *[Signature]*  
CIVIL ENGINEER  
STATE OF CALIFORNIA NO. \_\_\_\_\_  
DATE: 5/10/18

**FUNDING AGENCY**  
FEDERAL EMERGENCY  
MANAGEMENT AGENCY (FEMA)

FEMA PROJECT No. ELELC11

**BOARD OF SUPERVISORS**

JOHN HIDAHL	I
SHIVA FRENTZEN	II
BRIAN VEERKAMP	III
MICHAEL RANALLI	IV
SUE NOVASEL	V

**COUNTY OF EL DORADO  
DEPARTMENT OF TRANSPORTATION**

(530) 621-5900  
2850 FAIRLAKE CT  
PLACERVILLE, CA 95667

ADOPTED AND APPROVED BY:

MICHAEL RANALLI  
CHAIR, EL DORADO COUNTY BOARD OF SUPERVISORS

APPROVED BY:

RAFAEL MARTINEZ, DIRECTOR  
DEPARTMENT OF TRANSPORTATION

MATTHEW D. SNEITZER P.E. NO. C56832  
DEPUTY DIRECTOR, ENGINEERING

PW NO. PW 18-31214 PROJECT NO. 78718

**PONY EXPRESS TRAIL SLIPOUT**

**TITLE SHEET**

SHEET 1 OF 10



ORIGINAL SCALE IS IN INCHES  
 Drawing name: C:\Civil 3D\Projects\78718 Pony Express Trail Slipout\CADD Files\Sheets\CD-1.dwg Layout Tab: CD-1 May 10, 2018 7:40am BRichards  
 FOR REDUCED PLANS

BISH  
 APN 009-051-06  
 DCC 2013-0046845

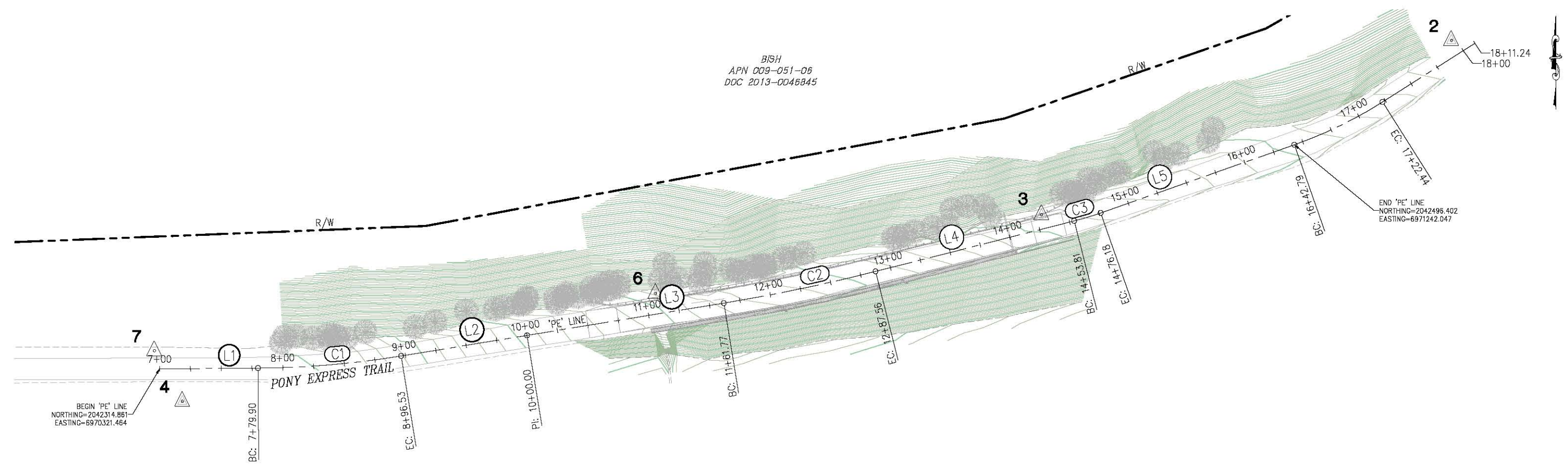

PE				
NUMBER	LENGTH	RADIUS	LINE / CHORD DIRECTION & LENGTH	DELTA
L1	79.90		N 89° 36' 24" E	
C1	116.63	750.00	N 85° 09' 06" E - 116.52	8° 54' 37"
L2	103.47		N 80° 41' 48" E	
L3	161.77		N 80° 41' 48" E	
C2	125.79	1460.00	N 78° 13' 42" E - 125.75	4° 56' 11"
L4	166.25		N 75° 45' 36" E	
C3	22.37	250.00	N 73° 11' 48" E - 22.36	5° 07' 37"
L5	166.61		N 70° 37' 59" E	

CONTROL TABLE				
CONTROL NUMBER	ELEVATION	NORTHING	EASTING	DESCRIPTION
1	1000.00	2042718.804	6971848.213	CP SPIKE
2	1009.04	2042580.960	6971369.522	CP SPIKE
3	1018.68	2042439.640	6971037.069	CP SPIKE
4	1047.22	2042288.572	6970340.068	CP SPIKE
5	1032.94	2042322.118	6969736.439	CP SPIKE
6	1028.93	2042375.922	6970723.901	CP SPIKE
7	1044.19	2042329.502	6970317.309	CP SPIKE

# DENOTES CONTROL POINT LOCATION

**NOTE:**  
 BEARINGS AND COORDINATES SHOWN HEREON  
 ARE ON AN ASSUMED DATUM.  
 VERTICAL DATUM IS ASSUMED, CONTROL POINTS  
 SHOWN HEREON ARE TBM'S

**SURVEY AND CONTROL DIAGRAM**  
 SCALE : 1" = 40'

REVISION	NUMBER	DATE	DESCRIPTION	BY



PREPARED UNDER THE SUPERVISION OF :  
*Joseph C. Neely*  
 PROFESSIONAL LAND SURVEYOR  
 DATE: 5/10/18

DESIGNED: JCN  
 DRAWN: RR  
 CHECKED: JCN  
 DATE: 5/10/18  
 ROAD NUMBER: 025



COUNTY OF EL DORADO  
 DEPARTMENT OF TRANSPORTATION

PONY EXPRESS TRAIL SLIPOUT

SHEET  
**CD-1**  
 2 OF 10  
 W.C. No. 78718





ORIGINAL SCALE IS IN INCHES  
 Drawing name: C:\Civil\_3D\Projects\78718 Pony Express Trail Slipout\CADD Files\Production drawings\Master - ORIGINAL WITH HOCOUT.dwg  
 Layout Tab: L-1 May 10, 2018 7:39am BRichards

**NOTE**

BID BASE "A"  
 STA 10+50 TO STA 14+45  
  
 ALTERNATIVE "B"  
 STA 8+50 TO STA 10+50  
 STA 14+45 TO 15+50

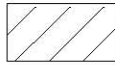
**LEGEND:**

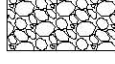
-  COLD PLANE AREA, 25' (TYP)
-  ENBANKMENT RSP CLASS IV, METHOD B
-  ENBANKMENT RSP CLASS III METHOD B

**CONSTRUCTION NOTES:**

- ① — COLD PLANE & PAVE 0.15' AVERAGE & VARIES, OVERLAY 0.20' REFER TO PAVEMENT DETAIL BELOW
- ② — 0.35' HMA OVER 0.67' CLASS II AB
- ③ — FILL ERODED OUTFALL OF PIPE WITH ROCK SLOPE PROTECTION, SEE SHT D-2
- ④ — GUARDRAIL, NARROW ROADWAY INSTALLATION (2.5' MIN SHOULDER TO HP)
- ⑤ — SUBDRAIN AND CONCRETE LINED DITCH, SEE SHT D-1, D-2
- ⑥ — RSP SLOPE PROTECTION, SEE TYPICAL RSP SECTION
- ⑦ — AC DIKE, TYPE F, PER A87B
- ⑧ — SUBDRAIN CLEAN OUT, SEE DETAIL SHEET D-2
- ⑨ — SHOULDER BACKING (CLASS II AB)
- ⑩ — RECONSTRUCT SLOPE TO ELEVATION AS SHOWN. ADDITIONAL BENCHING AND COMPACTION MAY BE REQUIRED TO ENSURE PROPER SUBGRADES AND PLACEMENT OF RSP. REFER TO PROJECT SPECIFICATIONS FOR DETAILS.

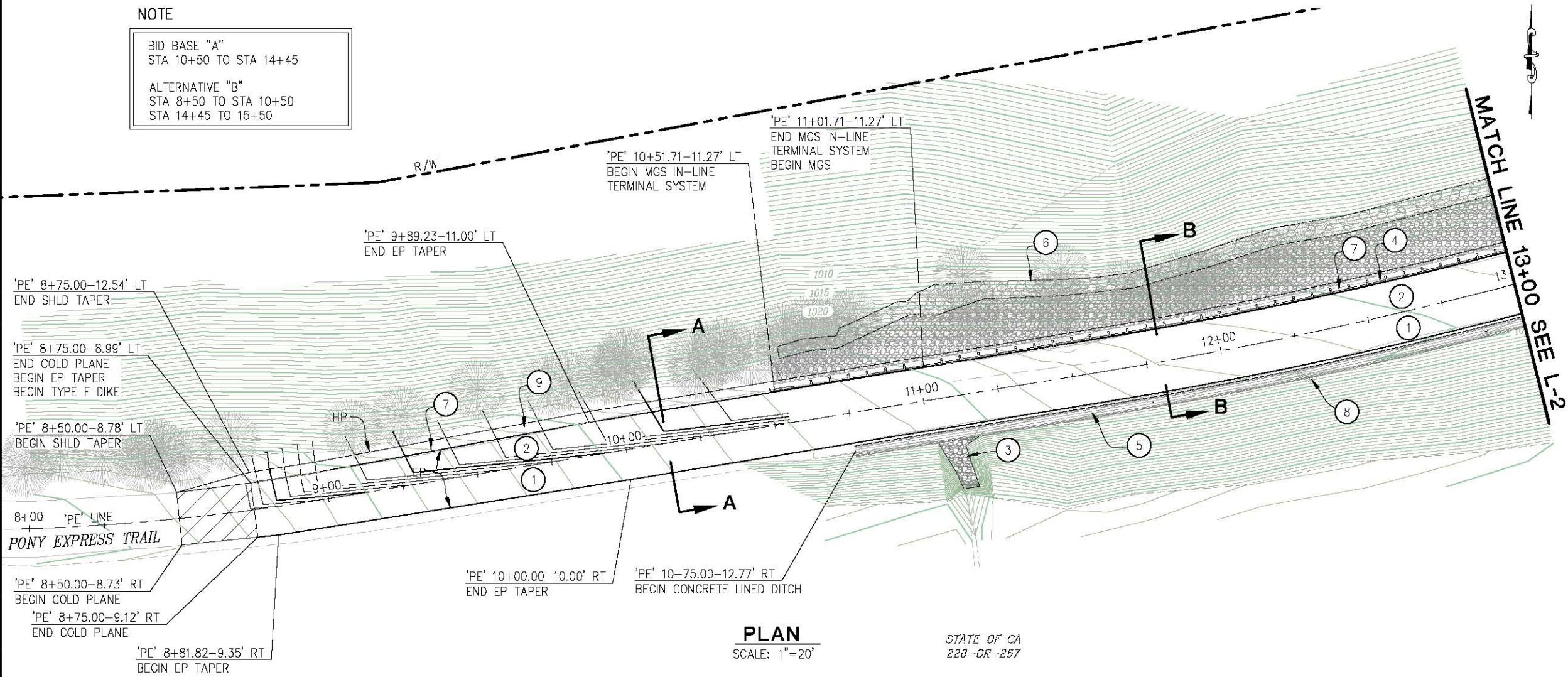

**PLAN**  
SCALE: 1"=20'  
STATE OF CA  
228-DR-267

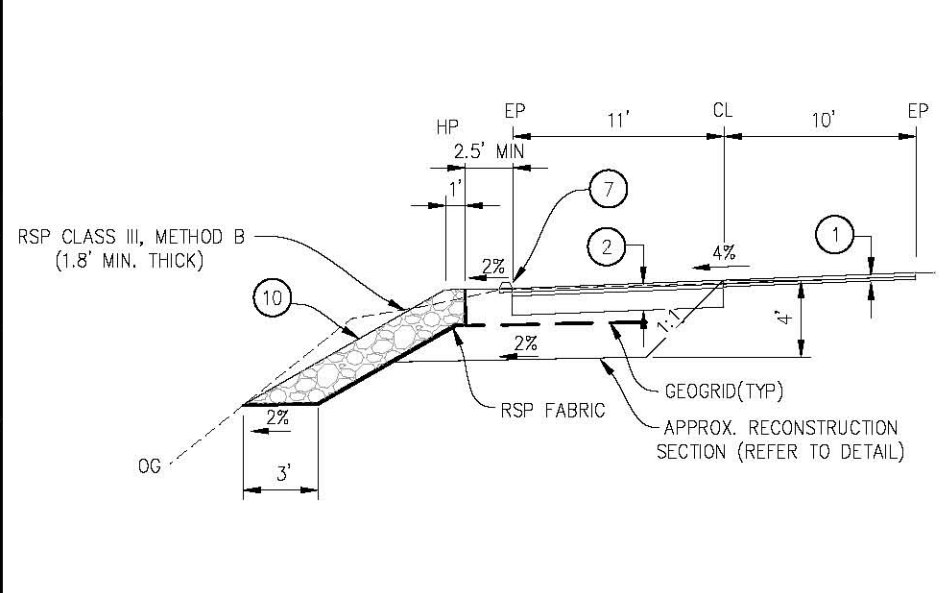

**TYPICAL RECONSTRUCTION SECTION A-A**  
SCALE: 1"=5'  
(APPROX STA 8+75 TO 10+50)

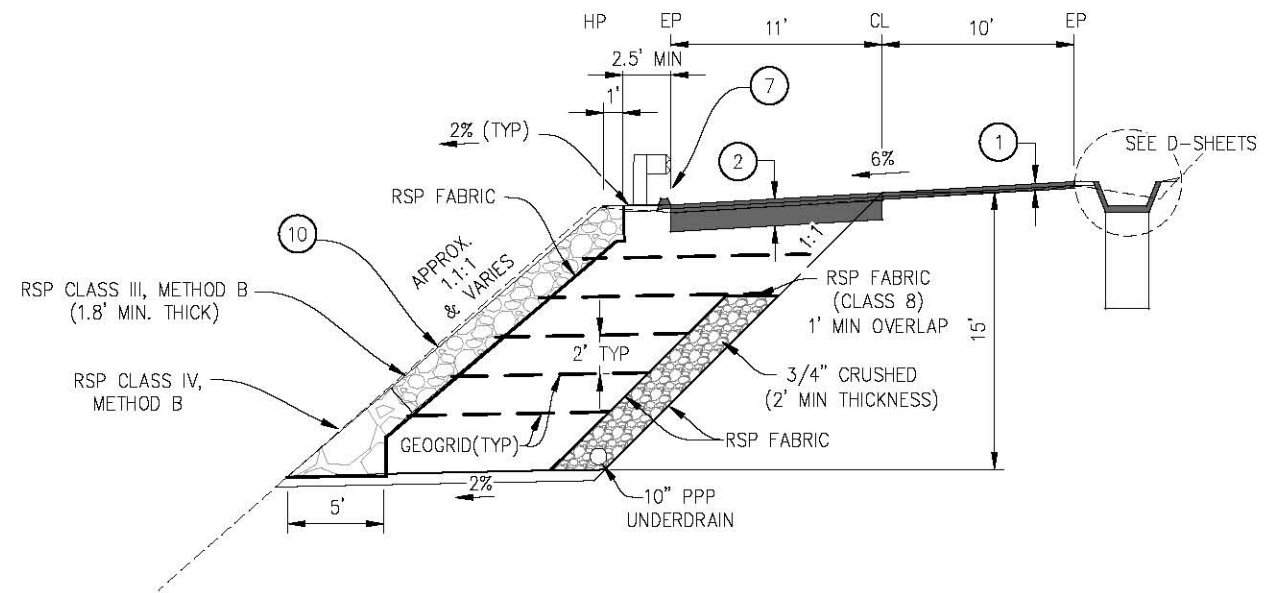

**TYPICAL RECONSTRUCTION SECTION B-B**  
SCALE: 1"=5'  
(APPROX STA 10+50 TO 14+45)

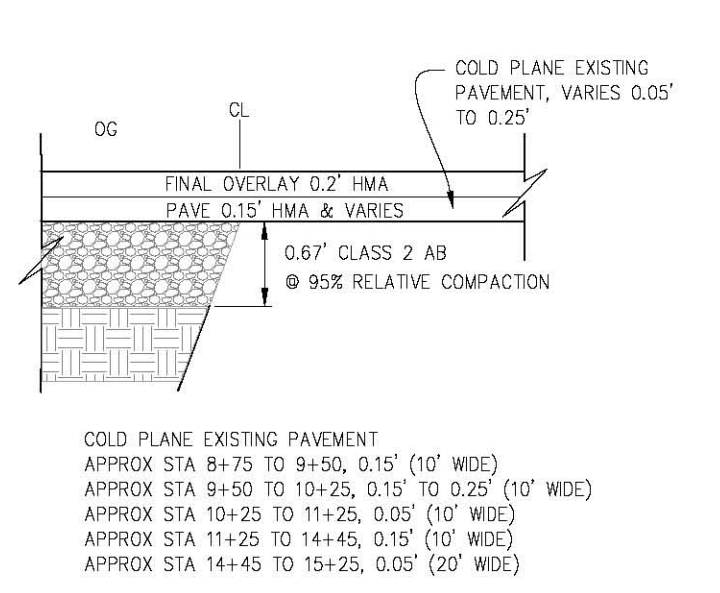

**TYPICAL PAVEMENT DETAIL**  
NTS

**SLIPOUT REPAIRS**  
SCALE : AS NOTED

REVISION	NUMBER	DATE	DESCRIPTION	BY



PREPARED UNDER THE SUPERVISION OF :  
 [Signature]  
 REGISTERED CIVIL ENGINEER  
 DATE: 5/10/18

DESIGNED: JIB RR  
 DRAWN: JIB RR  
 CHECKED: JIB RR  
 DATE: 5/10/18  
 ROAD NUMBER: 025



**COUNTY OF EL DORADO**  
**DEPARTMENT OF TRANSPORTATION**

**PONY EXPRESS TRAIL SLIPOUT**

SHEET  
**L-1**  
 3 OF 10  
 W.G. No. 78718



ORIGINAL SCALE IS IN INCHES  
 Drawing name: C:\Civil 3D\Projects\78718 Pony Express Trail Slipout\CADD Files\Production drawings\Master - ORIGINAL WITH HOCOUT.dwg Layout Tab: L-2 May 10, 2018 7:45am BRichards

BISH  
 APN 009-051-06  
 DOC 2013-0046845

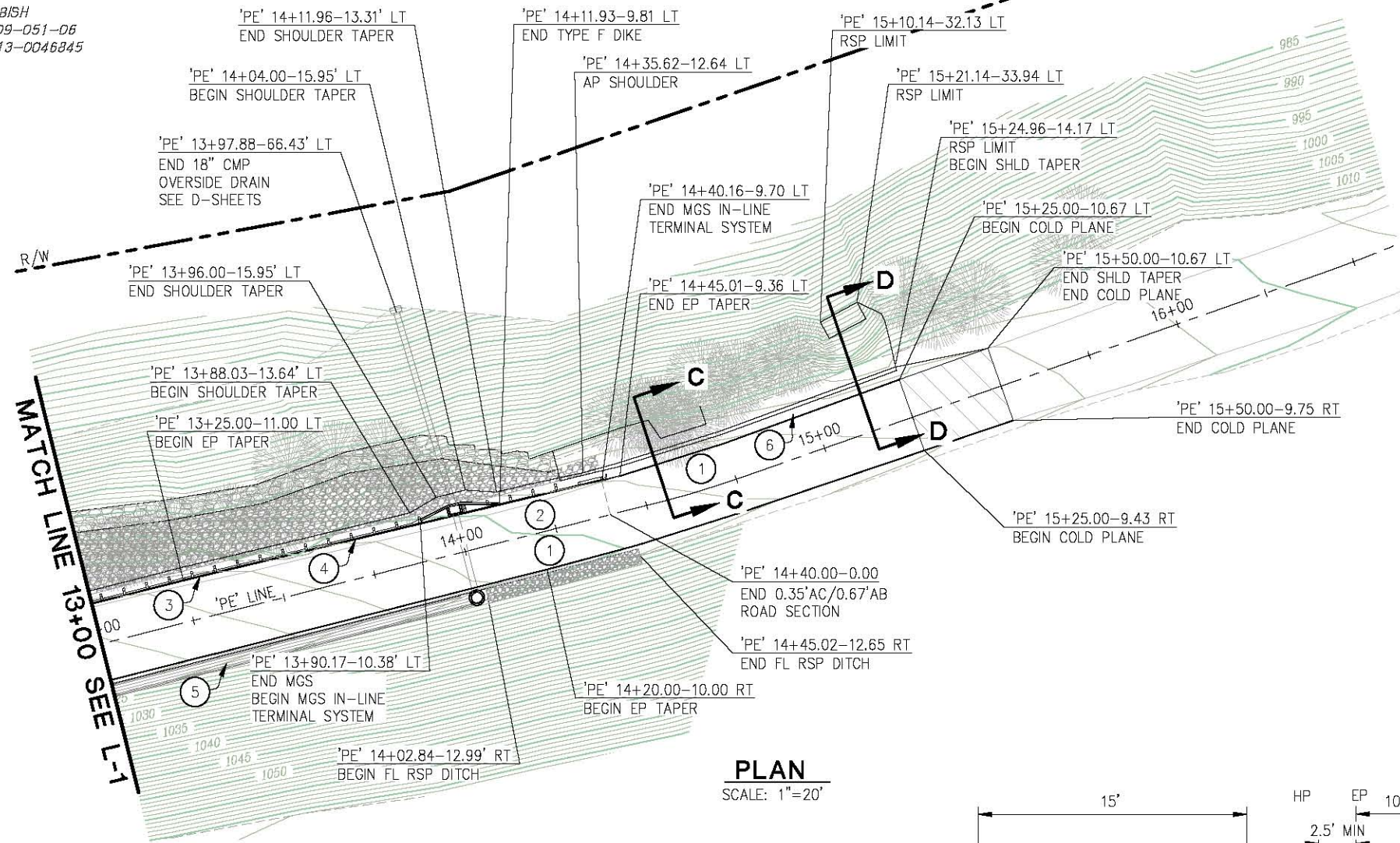

- LEGEND:**
- COLD PLANE AREA, 25' (TYP)
  - ENBANKMENT RSP CLASS IV, METHOD B
  - ENBANKMENT RSP CLASS III, METHOD B (1.8' MIN THICKNESS)

- CONSTRUCTION NOTES:**
- 1 - COLD PLANE & PAVE 0.15', & VARIES 0.10 TO 0.20
  - 2 - 0.35'HMA OVER 0.67' CLASS II AB
  - 3 - AC DIKE, TYPE F, PER A87B
  - 4 - GUARDRAIL, NARROW ROADWAY INSTALLATION (2.5' MIN SHOULDER TO HP)
  - 5 - SUBDRAIN AND CONCRETE LINED DITCH, SEE SHT D-1, D-2
  - 6 - SHOULDER BACKING (CLASS II AB)
  - 7 - RECONSTRUCT SLOPE TO ELEVATION AS SHOWN. ADDITIONAL BENCHING AND COMPACTION MAY BE REQUIRED TO ENSURE PROPER SUBGRADES AND PLACEMENT OF RSP. REFER TO PROJECT SPECIFICATIONS FOR DETAILS.

**PLAN**  
 SCALE: 1"=20'

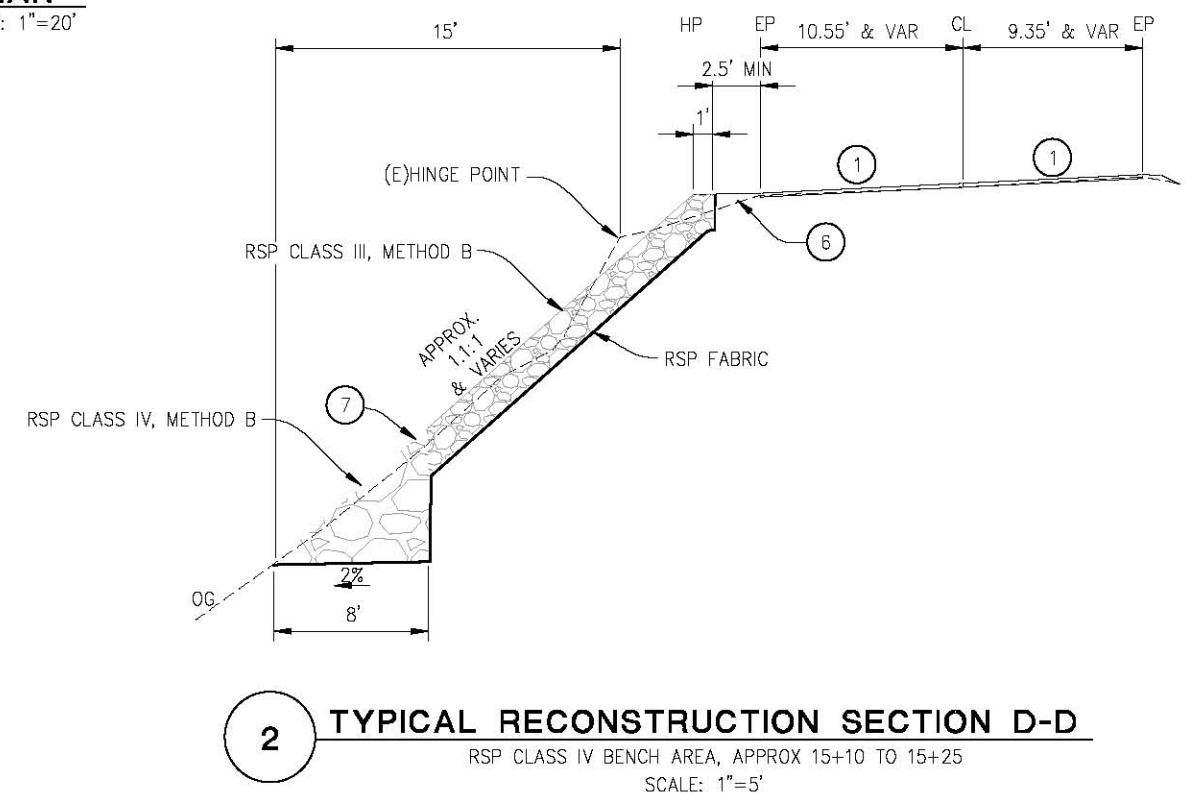
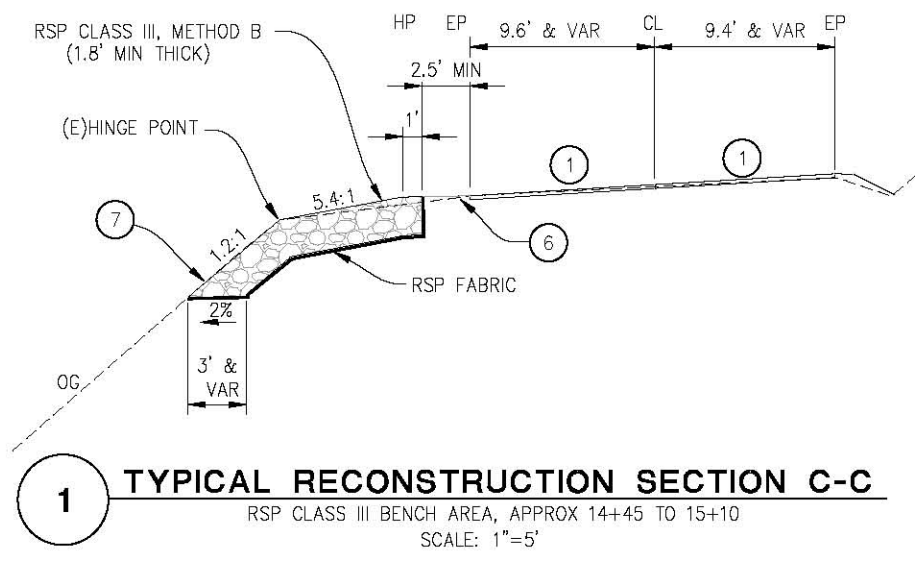

PREPARED UNDER THE SUPERVISION OF:  
 REGISTERED CIVIL ENGINEER  
 DATE: 5/10/18

DESIGNED: JIB RR  
 DRAWN: RR  
 CHECKED: JIB DATE: 5/10/18  
 ROAD NUMBER: 025



COUNTY OF EL DORADO  
 DEPARTMENT OF TRANSPORTATION

PONY EXPRESS TRAIL SLIPOUT

SLIPOUT REPAIRS  
 SCALE : AS NOTED

REVISION	NUMBER	DATE	DESCRIPTION	BY

SHEET  
**L-2**  
 4 OF 10  
 W.G. No. **78718**



ORIGINAL SCALE IS IN INCHES  
 Drawing name: C:\Civil 3D\Projects\78718 Pony Express Trail Slipout\CADD Files\Production drawings\Master - ORIGINAL WITH HOCOUT.dwg Layout Tab: L-3 May 10, 2018 - 7:52am BRichards  
 FOR REDUCED PLANS  
 2  
 1  
 0

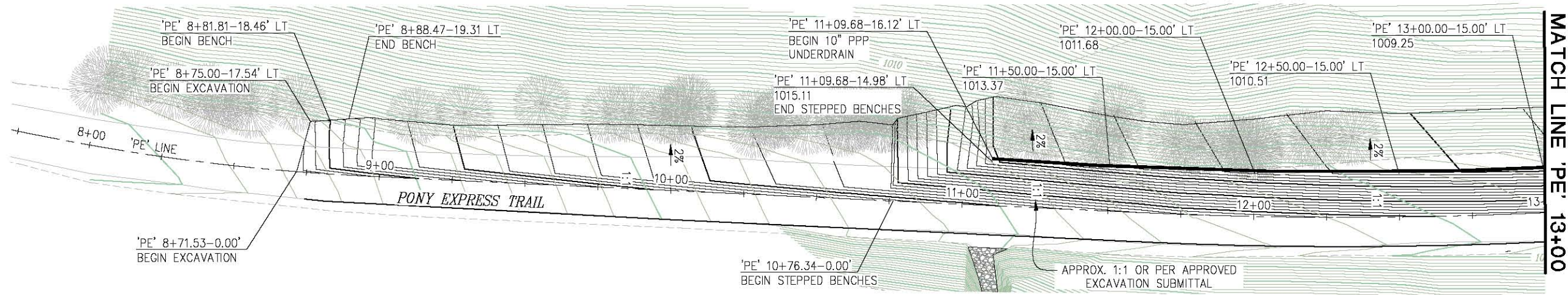

**PLAN**  
SCALE: 1"=20'H,V

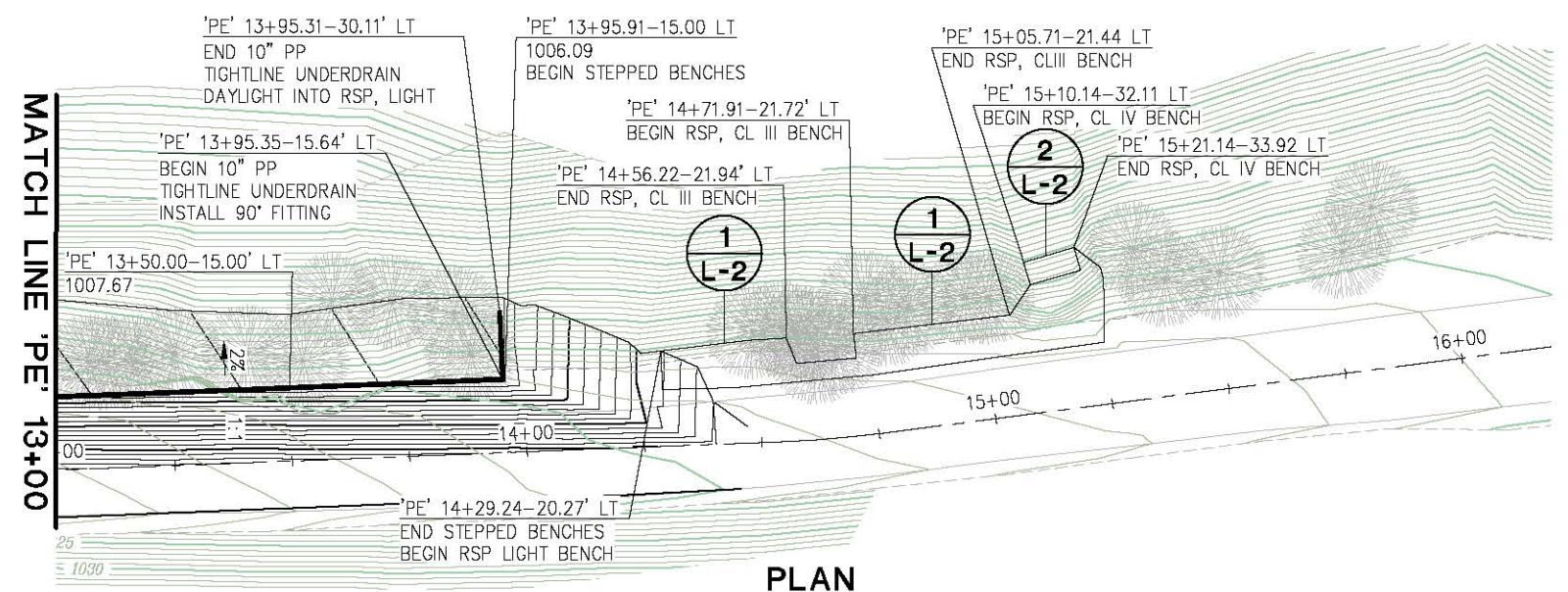
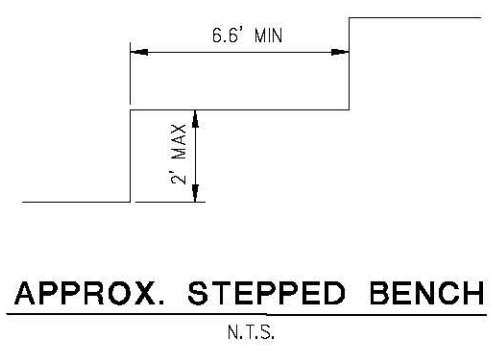

**PLAN**  
SCALE: 1"=20'H,V

MATCH LINE 'PE' 13+00

NOTES:  
STATION/OFFSET DATA PER 'PE' ALIGN  
SEE TREE REMOVE PLAN, SHEET TR-1

**ROADWAY EXCAVATION**  
SCALE : AS NOTED

REVISION	NUMBER	DATE	DESCRIPTION	BY



PREPARED UNDER THE SUPERVISION OF :  
  
 REGISTERED CIVIL ENGINEER  
 DATE: 5/10/18

DESIGNED: JIB RR  
 DRAWN: RR  
 CHECKED: JIB DATE: 5/10/18  
 ROAD NUMBER: 025



**COUNTY OF EL DORADO**  
**DEPARTMENT OF TRANSPORTATION**

**PONY EXPRESS TRAIL SLIPOUT**

SHEET  
**L-3**  
5 OF 10  
W.G. No. **78718**

ORIGINAL SCALE IS IN INCHES  
 Drawing name: C:\Civil 3D\Projects\78718\_Pony Express Trail\_Slipout\CADD\_Files\Production Drawings\Master - ORIGINAL WITH HOCOUT.dwg Layout Tab: L-4 May 10, 2018 7:54am BRichards  
 FOR REDUCED PLANS  
 2  
 1  
 0

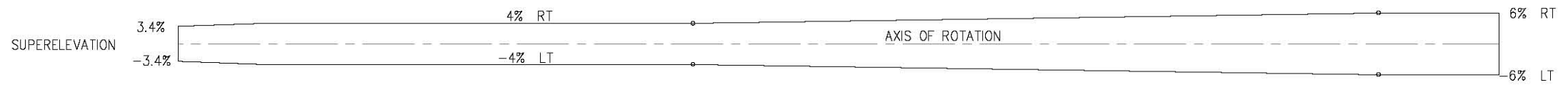
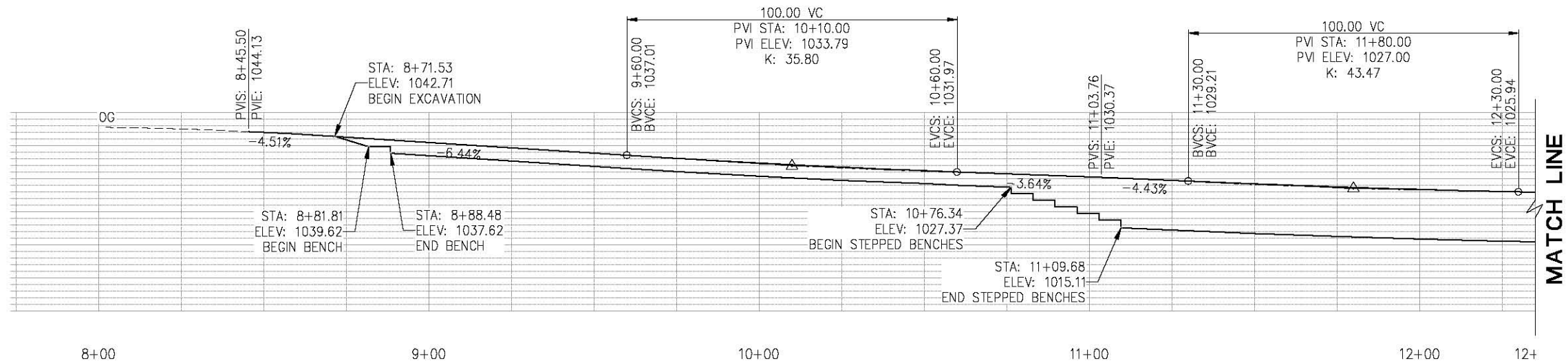

**PROFILE**

SCALE: 1"=20'H,V

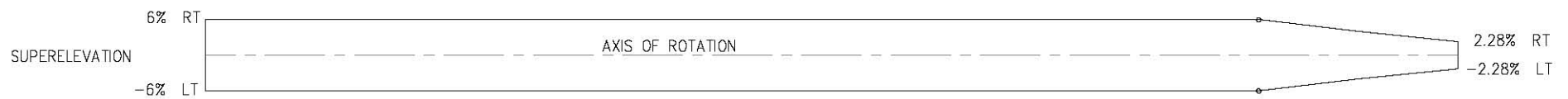
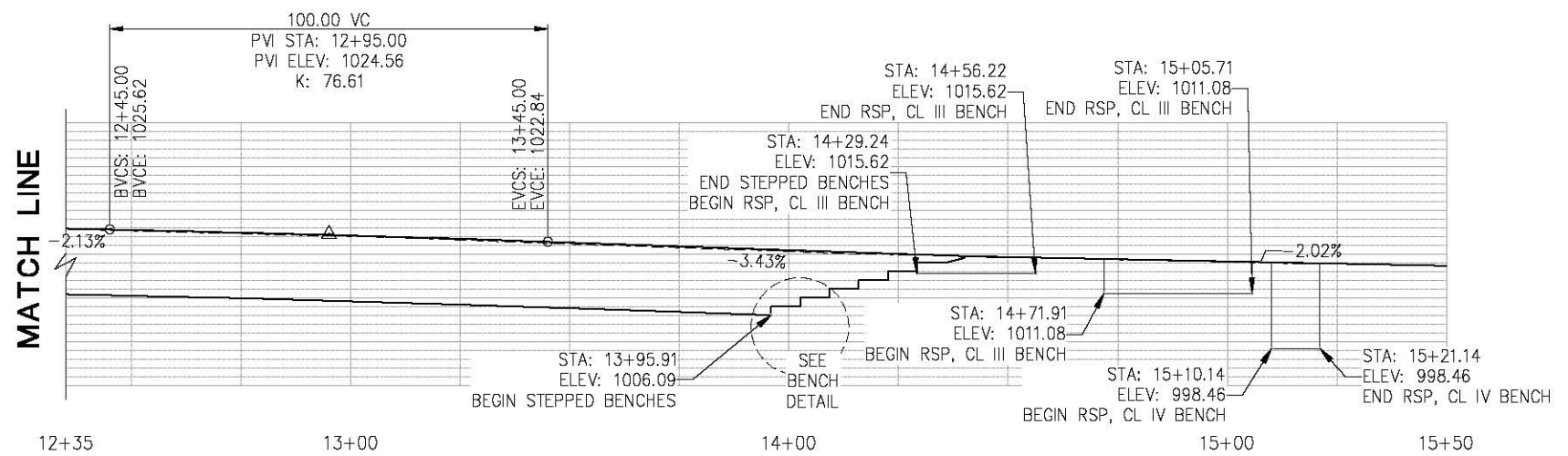
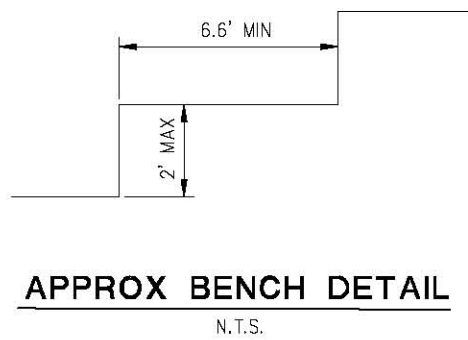

**PROFILE**

SCALE: 1"=20'H,V

**ROADWAY EXCAVATION**  
SCALE : AS NOTED



PREPARED UNDER THE SUPERVISION OF :  
 [Signature]  
 REGISTERED CIVIL ENGINEER  
 DATE: 5/10/18

DESIGNED: JIB RR  
 DRAWN: JIB RR  
 CHECKED: JIB RR  
 DATE: 5/10/18  
 ROAD NUMBER: 025



**COUNTY OF EL DORADO**  
**DEPARTMENT OF TRANSPORTATION**

**PONY EXPRESS TRAIL SLIPOUT**

SHEET  
**L-4**  
6 OF 10  
W.G. No. **78718**

REVISION	NUMBER	DATE	DESCRIPTION	BY



ORIGINAL SCALE IS IN INCHES  
 Drawing name: C:\Civil 3D Projects\78718 Pony Express Trail Slipout\CADD Files\Sheets\D-1.dwg Layout Tab: D-1 May 10, 2018 8:16am BRichards  
 FOR REDUCED PLANS  
 REVISION

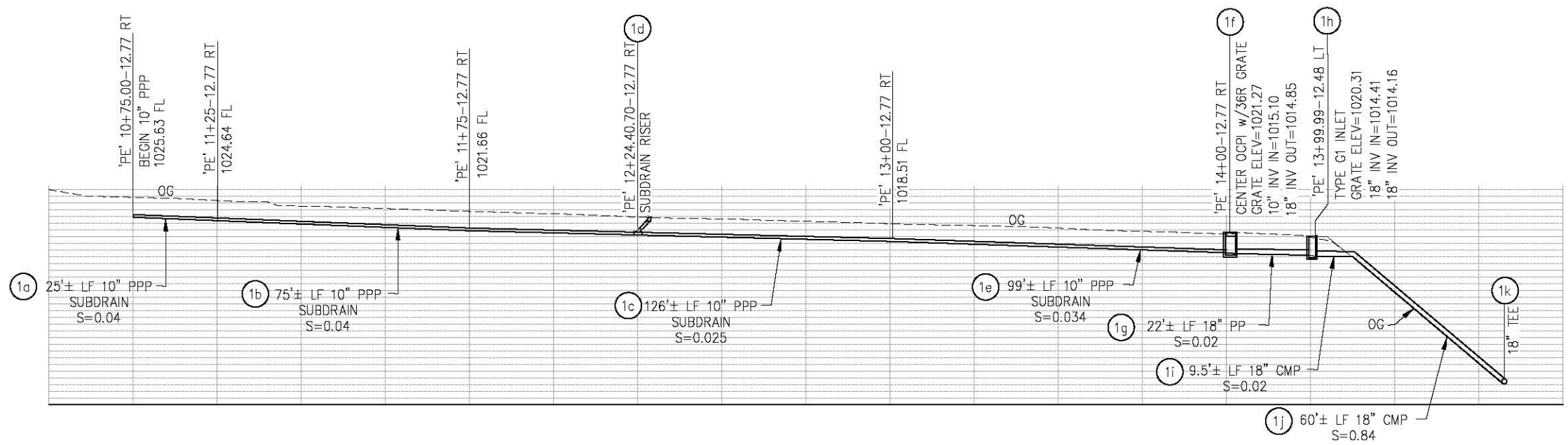
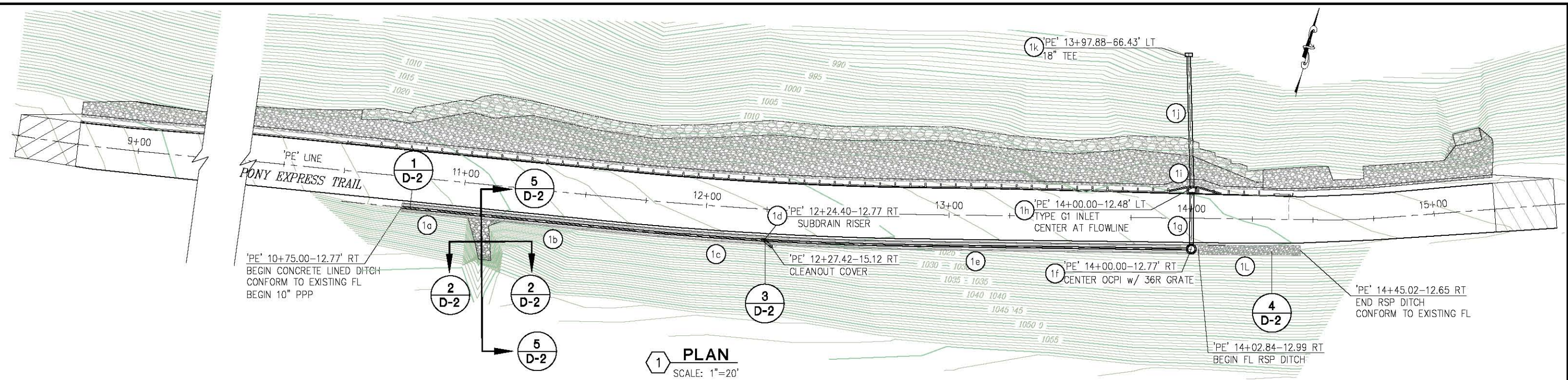

- CONSTRUCTION NOTES:**
- STATION OFFSET DATA PER 'PE' ALIGNMENT
  - CLEANOUTS PER STD PLAN D102
  - 1** DRAINAGE SYSTEM
  - 1a** DRAINAGE ITEM. SEE D-2 FOR DRAINAGE QUANTITIES

**DRAINAGE SYSTEM 1**  
SCALE : AS NOTED

REVISION	NUMBER	DATE	DESCRIPTION	BY



PREPARED UNDER THE SUPERVISION OF :  
 [Signature]  
 REGISTERED CIVIL ENGINEER  
 DATE: 5/10/18

DESIGNED: JB  
 DRAWN: RR  
 CHECKED: JB  
 DATE: 5/10/18  
 ROAD NUMBER: 025



**COUNTY OF EL DORADO**  
**DEPARTMENT OF TRANSPORTATION**

**PONY EXPRESS TRAIL SLIPOUT**

SHEET  
**D-1**  
7 OF 10  
W.O. No. **78718**



Drawing name: C:\Civil 3D\Projects\18\18\_Pony Express Trail\_Slipout\Drawings\Sheets\U-1.dwg Layout: Job: D-2 May 10/2018 8:11 am bhichard

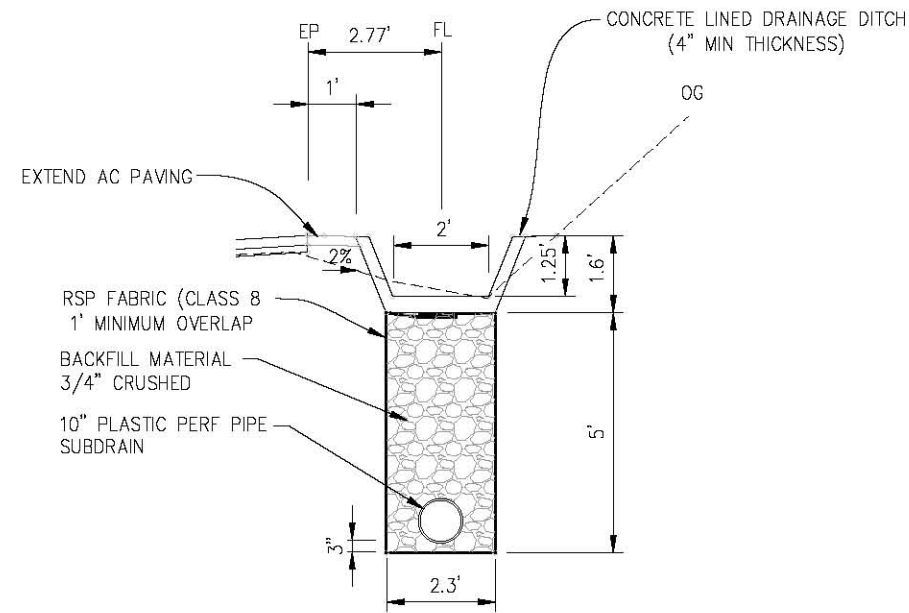

**1 DITCH/SUBDRAIN DETAIL**  
STA 10+75 TO 14+00  
NTS

PLAN SHEET NO.	SYSTEM NO.	DRAINAGE UNIT	10" PPP (PLASTIC PERF PIPE)	18" HDPE	18" CMP	18" CMP TEE [N]	45° WYE(10") [N]	45° ANGLE(10") [N]	TYPE OCPI INLET	TYPE G1 INLET	BACKFILL MATERIAL 3/4" CRUSHED[N]	RSP CLASS III, METHOD B (OUTFALL)	RSP CLASS II (DITCH)	RSP FABRIC (CLASS 8)	MINDR CONCRETE, DRAINAGE DITCH	CALTRANS STANDARD PLAN OR DETAIL REFERENCES	SLOPE	STATION	DRAINAGE UNIT	SYSTEM NO.	PLAN SHEET NO.		
D-1	1	a	25														S=0.04		a	1	D-1		
		b	75															S=0.04				b	
		c	126															S=0.025				c	
		d					1	1									D102		12+07.70-12.76' RT			d	
		e	99															S=0.034				e	
		f								1							D75B		14+00-12.77' RT			f	
		g		22														S=0.02				g	
		h									1						D73		13+99.99-12.48' LT			h	
		i			10													S=0.02				i	
		j			60												D87B		S=0.84			j	
		k					1															13+97.88-66.43' LT	k
		L													10								L
		TOTAL			325	22	70	1	1	1	1	1	136	57	10	646	19						

**NOTES:**  
1. STA/OFFSETS PER 'PE' LINE  
2. [N] NOT A SEPARATE PAY ITEM, FOR INFORMATION ONLY

DESCRIPTION	ROCK SLOPE PROTECTION					
	BASE BID "A"			ALTERNATIVE "B"		
	RSP (300 LB, CLASS IV, METHOD B) CY	RSP (150 LB, CLASS III, METHOD B) CY	RSP FABRIC (CLASS 8) SY	RSP (300 LB, CLASS IV, METHOD B) CY	RSP (150 LB, CLASS III, METHOD B) CY	RSP FABRIC (CLASS 8) SY
'PE' 8+75 TO 10+50.00		130	497			
'PE' 10+50.00 TO 14+45.00				179	379	1289
'PE' 14+45.00 TO 15+25.00	21	21	214			
TOTAL	21	151	711	179	379	1289

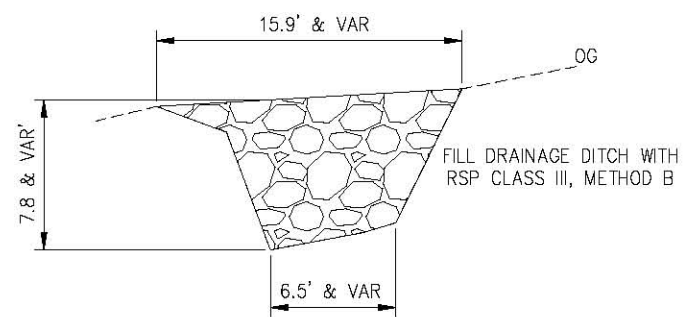

**2 RSP DETAIL**  
NTS

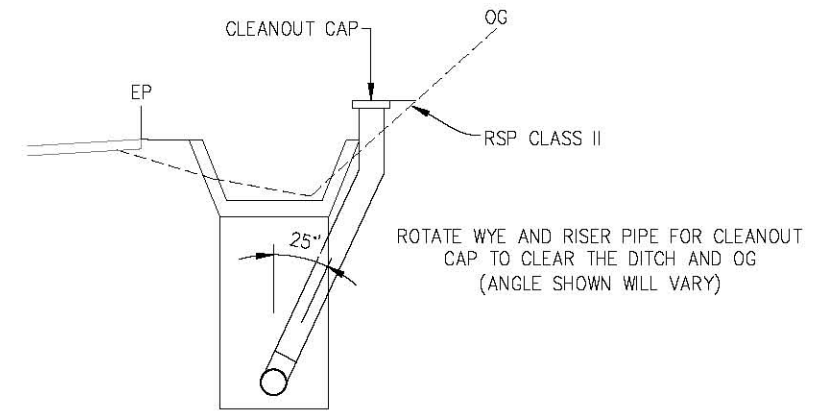

**3 SUBDRAIN RISER DETAIL**  
NTS

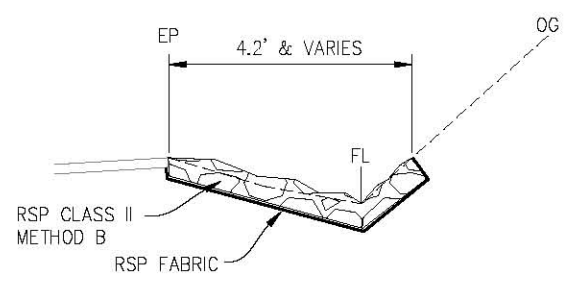

**4 RSP DETAIL**  
ROCK LINED DRAINAGE DITCH  
NTS

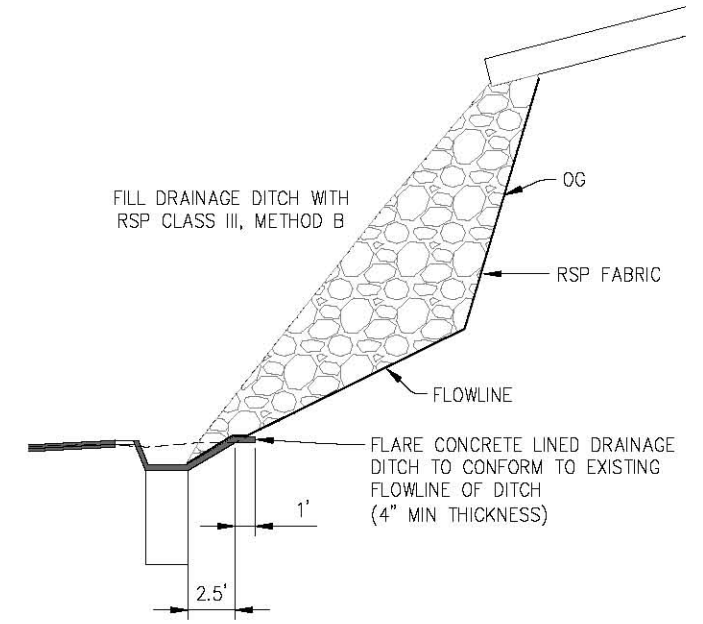

**5 RSP DETAIL**  
NTS

**DRAINAGE QUANTITIES:**  
SCALE : AS NOTED

REVISION	NUMBER	DATE	DESCRIPTION	BY



PREPARED UNDER THE SUPERVISION OF:  
*[Signature]*  
REGISTERED CIVIL ENGINEER  
5/10/18  
DATE:

DESIGNED: JB  
DRAWN: RR  
CHECKED: JB  
DATE: 5/10/18  
ROAD NUMBER: 025



**COUNTY OF EL DORADO**  
**DEPARTMENT OF TRANSPORTATION**

**PONY EXPRESS TRAIL SLIPOUT**

SHEET  
**D-2**  
8 OF 10  
W.O. No. **7871**



ORIGINAL SCALE IS IN INCHES  
 Drawing name: C:\Civil 3D\Projects\78718 Pony Express Trail Slipout\CADD Files\Sheets\TH-1.dwg Layout Tab: TH-1 May 10, 2018 8:19am BRichards  
 FOR REDUCED PLANS  
 REVISION

PORTABLE CHANGEABLE MESSAGE SIGN (PCMS) TABLE					
PCMS No.	POST MILE (PM)	FIRST FLASH	SECOND FLASH	THIRD FLASH	FOURTH FLASH
1	PONY EXPRESS ROAD ±5.99	PONY EXPRESS ROAD	CLOSED TO THRU TRAFFIC	(DATES CLOSED)	USE FRONTIER ROAD
2	PONY EXPRESS ROAD ±6.26	PONY EXPRESS ROAD	CLOSED TO THRU TRAFFIC	(DATES CLOSED)	USE FRONTIER ROAD

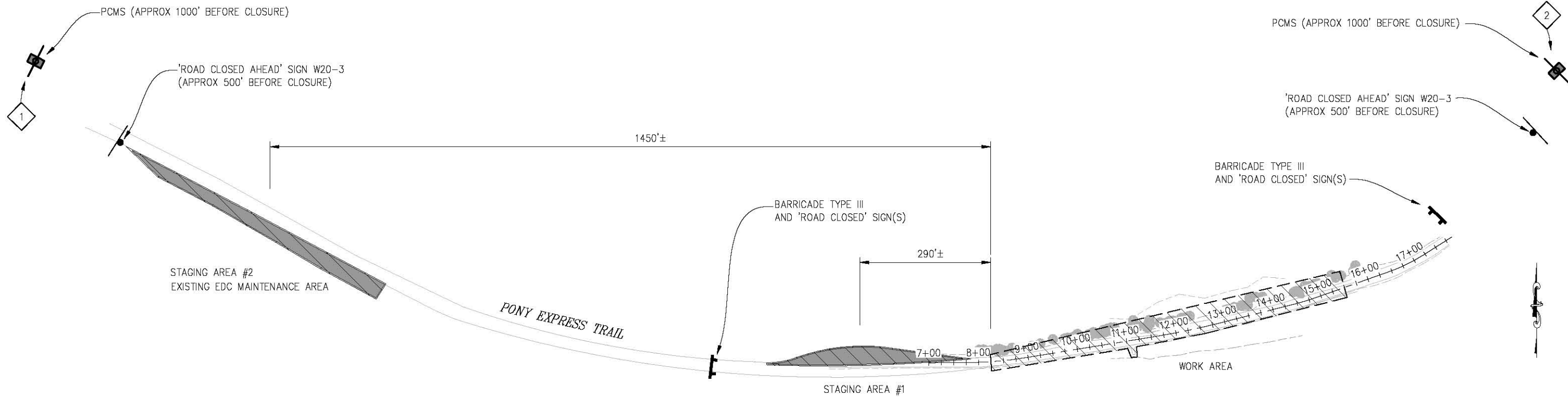

**PLAN**  
SCALE: 1"=100'

**GENERAL STAGE CONSTRUCTION NOTES:**

- REFER TO THE SPECIAL PROVISIONS FOR MAINTAINING TRAFFIC REQUIREMENTS WITHIN THE WORK AREA. WORK AS SHOWN WITHIN THE LIMITS MAY BE PERFORMED WITHIN A FULL ROAD CLOSURE.
- LOCATIONS OF PCMS AND CONSTRUCTION AREA SIGNS ARE APPROXIMATE. FINAL LOCATIONS WILL BE DETERMINED BY THE ENGINEER.
- ALL SIGNS SHALL BE PLACED ON TEMPORARY WOOD POSTS, EXCEPT PCMS AND SIGNS ON TYPE III BARRICADES.

**LEGEND:**

- CLOSURE AREA
- TEMPORARY STAGING AREAS
- CONSTRUCTION SIGN
- BARRICADE TYPE III
- PCMS — PORTABLE CHANGEABLE MESSAGE SIGN

**TRAFFIC HANDLING  
SCALE : AS NOTED**



PREPARED UNDER THE SUPERVISION OF :  
  
 REGISTERED CIVIL ENGINEER  
 DATE: 5/10/18

DESIGNED: JIB RR  
 DRAWN: RR  
 CHECKED: JIB DATE: 5/10/18  
 ROAD NUMBER: 025



**COUNTY OF EL DORADO  
DEPARTMENT OF TRANSPORTATION**

**PONY EXPRESS TRAIL SLIPOUT**

SHEET  
**TH-1**  
 9 OF 10  
 W.G. No. **78718**



ORIGINAL SCALE IS IN INCHES  
 FOR REDUCED PLANS  
 2  
 1  
 0  
 Drawing name: C:\Civil\_3D\Projects\78718 Pony Express Trail Slipout\CADD Files\Sheets\TR-1.dwg Layout Tab: TR-1 May 10, 2018 8:21am BRichards

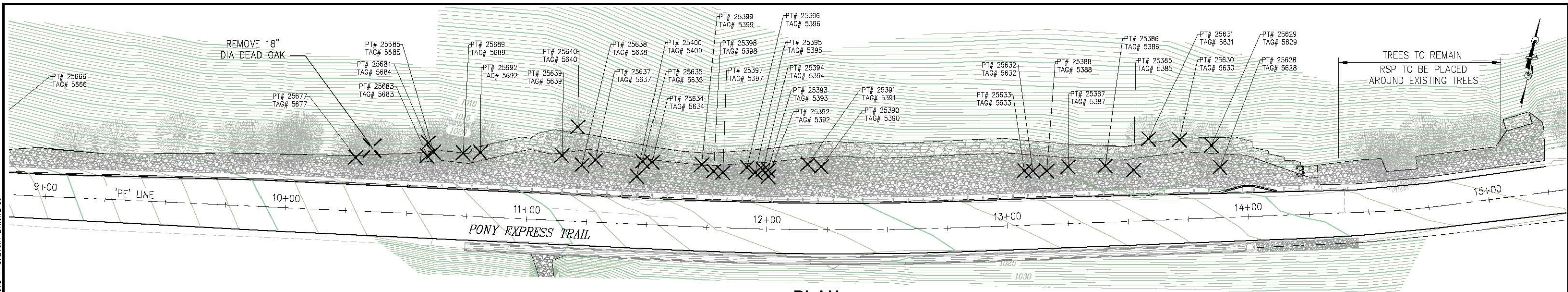

**PLAN**  
SCALE: 1"=20'

**NOTE:**  
 CONTRACTOR MAY CONSTRUCT (AND REMOVE) TEMPORARY ACCESS ROAD(S) THROUGH THE WORK AREA TO FACILITATE IMPROVEMENT ACTIVITIES.  
 ALL STAGING AREAS AND ACCESS ROAD(S) MUST EMPLOY NECESSARY TEMPORARY AND PERMANENT BMP'S AND STABILIZATION FEATURES (SWPPP CONTROLS).  
 DISTURBANCE AREAS MUST BE MINIMIZED TO REMAIN WITHIN THE ILLUSTRATED RIGHT-OF-WAY AS SHOWN.  
 AREAS GRADED FOR ACCESS MUST BE RESTORED TO THE PROPOSED FINISH GRADES OR ORIGINAL CONTOURS AS APPLICABLE.  
 ACTUAL ALIGNMENTS AND LIMITS OF TEMPORARY STAGING AND ACCESS AREAS MUST BE APPROVED BY THE ENGINEER.  
 ADDITIONAL TREE AND VEGETATION REMOVAL (INCLUDING TREE TRIMMING) MAY BE PERFORMED AS NEEDED AND DIRECTED THE ENGINEER TO PROVIDE ACCESS TO THE WORK AREAS.

**LEGEND**

 - RSP SLOPE

 - TREE TO BE REMOVED

TREE REMOVAL TABLE				
POINT NUMBER	TAG NUMBER	'PE' LINE STATION	OFFSET	DESCRIPTION
25385	5385	13+53.13	21.22' LT	MAPLE-0.57ø, FORKED 0.38ø
25386	5386	13+41.36	23.47' LT	OAK-0.83ø
25387	5387	13+25.88	23.69' LT	MAPLE-0.92ø, FORKED 0.86ø
25388	5388	13+16.96	22.33' LT	MAPLE-1.11ø
25390	5390	12+72.32	26.31' LT	MAPLE-0.99ø
25391	5391	12+16.58	27.23' LT	FIR-0.80ø
25392	5392	12+00.17	21.84' LT	MAPLE-1.37ø
25393	5393	12+00.02	24.56' LT	CEDAR-1.37ø
25394	5394	11+97.81	24.62' LT	MAPLE-1.46ø
25395	5395	11+94.61	23.43' LT	MAPLE-0.80ø
25396	5396	11+91.03	25.44' LT	FIR-2.29ø
25397	5397	11+80.92	23.06' LT	MAPLE-1.24ø
25398	5398	11+76.94	23.47' LT	MAPLE-0.99ø

TREE REMOVAL TABLE				
POINT NUMBER	TAG NUMBER	'PE' LINE STATION	OFFSET	DESCRIPTION
25399	5399	11+71.81	26.01' LT	CEDAR-0.76ø
25400	5400	11+45.01	19.93' LT	MAPLE-1.27ø
* 25628	5628	13+88.89	21.02' LT	MAPLE-0.60ø
* 25629	5629	13+85.68	30.11' LT	MAPLE CLUSTER-0.51ø 0.48ø 0.45ø
25630	5630	13+72.48	32.88' LT	MAPLE CLUSTER-0.32ø 0.32ø 0.51ø
25631	5631	13+59.81	33.76' LT	MAPLE CLUSTER-0.38ø 0.54ø 0.38ø
25633	5633	13+07.84	22.71' LT	MAPLE CLUSTER-0.35ø 0.32ø 0.48ø
25634	5634	11+50.49	26.10' LT	MAPLE-0.83ø

TREE REMOVAL TABLE				
POINT NUMBER	TAG NUMBER	'PE' LINE STATION	OFFSET	DESCRIPTION
25635	5635	11+47.17	26.12' LT	MAPLE-1.05ø
25637	5637	11+27.55	25.91' LT	MAPLE FORKED-1.15ø 1.18ø
25638	5638	11+21.99	23.55' LT	MAPLE CLUSTER-0.99ø 0.89ø 0.99ø 0.92ø
25639	5639	11+13.50	27.11' LT	FIR-1.31ø
25666	5666	8+70.10	23.53' LT	MAPLE-0.54ø
25677	5677	10+28.07	22.57' LT	MAPLE-1.31ø
25683	5683	10+57.64	24.26' LT	MAPLE-0.73ø
25684	5684	10+57.74	29.55' LT	MAPLE-0.64ø
25685	5685	10+60.21	26.03' LT	FIR-0.80ø
25689	5689	10+72.53	26.14' LT	MAPLE-0.92ø
25692	5692	10+79.67	26.72' LT	MAPLE-0.99ø

\* PRESERVE AND PROTECT TREE IF POSSIBLE.  
(REMOVE AS NEEDED TO FACILITATE IMPROVEMENT FEATURES)

**TREE REMOVAL PLAN AND TABLE**  
SCALE : AS NOTED

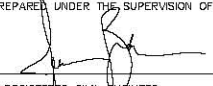

PREPARED UNDER THE SUPERVISION OF :  
  
 REGISTERED CIVIL ENGINEER  
 DATE: 5/10/18

DESIGNED: JIB RR  
 CHECKED: JIB DATE: 5/10/18  
 ROAD NUMBER: 025



**COUNTY OF EL DORADO**  
**DEPARTMENT OF TRANSPORTATION**

**PONY EXPRESS TRAIL SLIPOUT**

SHEET  
**TR-1**  
10 OF 10  
W.G. No. **78718**