

COUNTY OF EL DORADO DEPARTMENT OF TRANSPORTATION



APPLICATION FOR ROAD CLOSURE

THIS APPLICATION MUST BE SUBMITTED AT LEAST 60 DAYS PRIOR TO THE ROAD CLOSURE DATE

APPLICATION RECEIVED BY: _____ DATE: _____
 TITLE OF EVENT: Parade of Lights
 TYPE OF EVENT: Christmas tree raising and parade
 SPONSORING ORGANIZATION: Georgetown Divide Rotary
 ESTIMATED NUMBER OF PARTICIPANTS: 200 - 300
 DATE OF ROAD CLOSURE: Saturday Dec. 6 2014
 START TIME: 3 pm COMPLETION TIME: 8 pm
 ROAD(S) TO BE CLOSED: Main st. from Harkness st to Hwy 193

NOTE: THE ATTACHED SUPPLEMENTAL SHEET AND SKETCH SHALL BE COMPLETED IF MORE THAN ONE COUNTY ROAD IS TO BE CLOSED

SUBMITTED BY: Dave Smeat DATE: Oct. 1, 2014
 CONTACT PERSON: _____ PHONE/FAX: 530-333-9232
 ADDRESS: 2000 Frog Pond Lane, Georgetown Ca 95634

THE FOLLOWING CONDITIONS ARE REQUIRED FOR ALL ROAD CLOSURES:

1. The organizers shall provide a detailed signing and detour plan for any proposed closure of a major county road. This signing/detour plan should identify the type and location of all signs, barricades, cones, and flaggers. The plan must be attached to this application when it is submitted for review.
2. The organizers shall provide proof that the owners of the adjacent business along the road closure are in agreement with proposed closure. These agreements must be attached to this application when it is submitted for review.
3. The organizers shall be responsible for providing all signs, barricades, cones, flaggers, and traffic controls.
4. Wooden barricades shall be placed across the County road to close the road. Barricades shall also be placed across all intersecting roads to deny access to the closed road.
5. A "ROAD CLOSED" sign shall be placed at each barricaded intersection. Each sign shall measure at least 48 inches by 30 inches, with 8 inch black letters on a white background.
6. The organizers shall remove all signs, all pavement markings or other materials immediately following the event. The organizers shall also remove all debris deposited by participants and spectators.
7. The organizers shall provide a Certificate of Insurance, naming El Dorado County Department of Transportation additionally insured, in the amount of \$1,000,000.00 (one million dollars) as required by the El Dorado County Risk Manager.
8. To the fullest extent allowed by law the Organizer shall defend, indemnify, and hold the County harmless against and from any and all claims, suits, losses, damages, and liability for damages of every name, kind and description, including attorney's fees and costs incurred, brought for, or on account of, injuries to or death of any person, including but not limited to workers, County employees, and the public, or damage to property, or in anyway arise out of are connected with the work by the Organizer, his agents or employees including contractor's services, operation or performance hereunder, regardless of the existence or degree of fault or negligence on the part of the County, the Organizer, contractor, subcontractor(s) and employee(s) or any of these, except for part of the sole, or active negligence of the County, its officers and employees, or as expressly prescribed by statute. This duty of the Organizer to indemnify and save the County harmless includes the duties to defined set forth in California Civil Code Section 2778.

SIGNATURE: Dave W. Smeat DATE: 10-1-14

I HAVE READ, ACKNOWLEDGE AND AGREE TO ALL OF THE ABOVE CONDITIONS WITH REGARD TO THIS ROAD CLOSURE.

Georgetown
Parade of Lights 2014

Placer Street

School Street

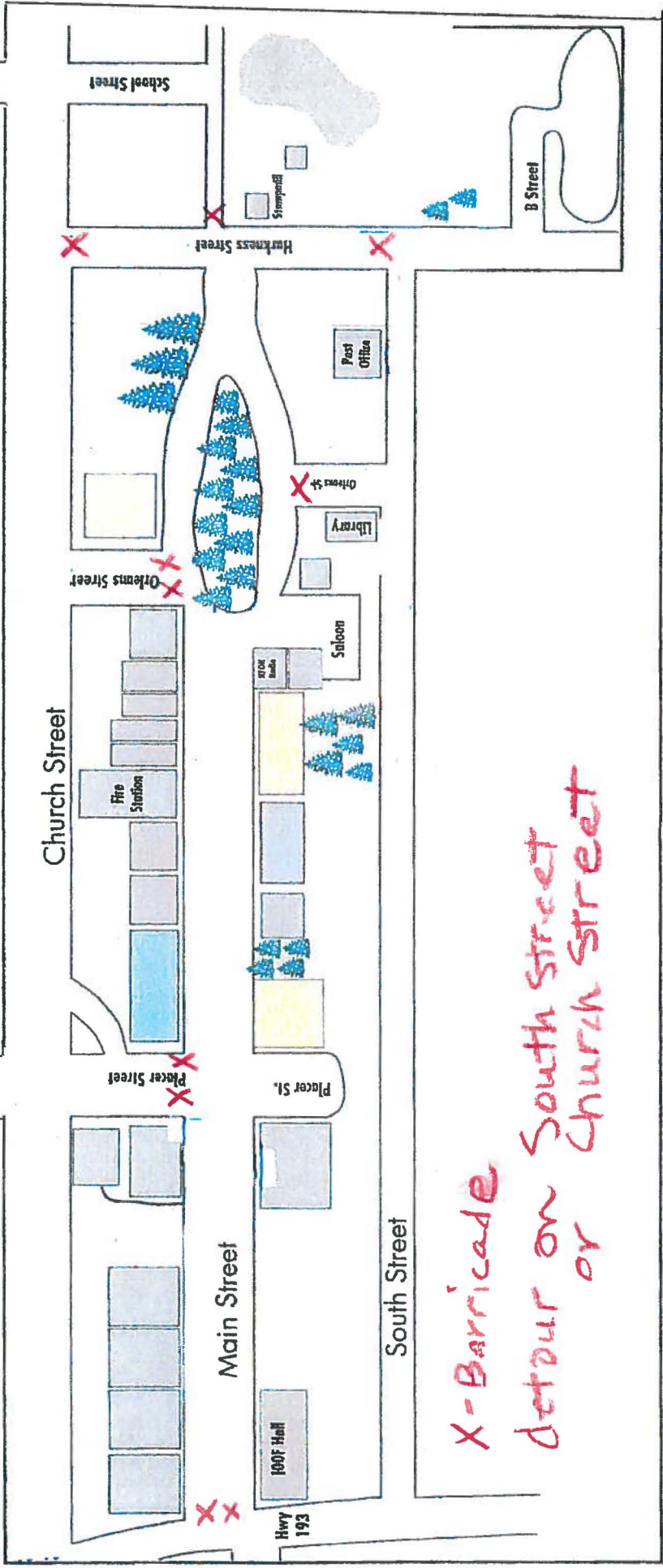

X-Barricade
detour on South Street
or Church Street

Vicinity Map Georgetown

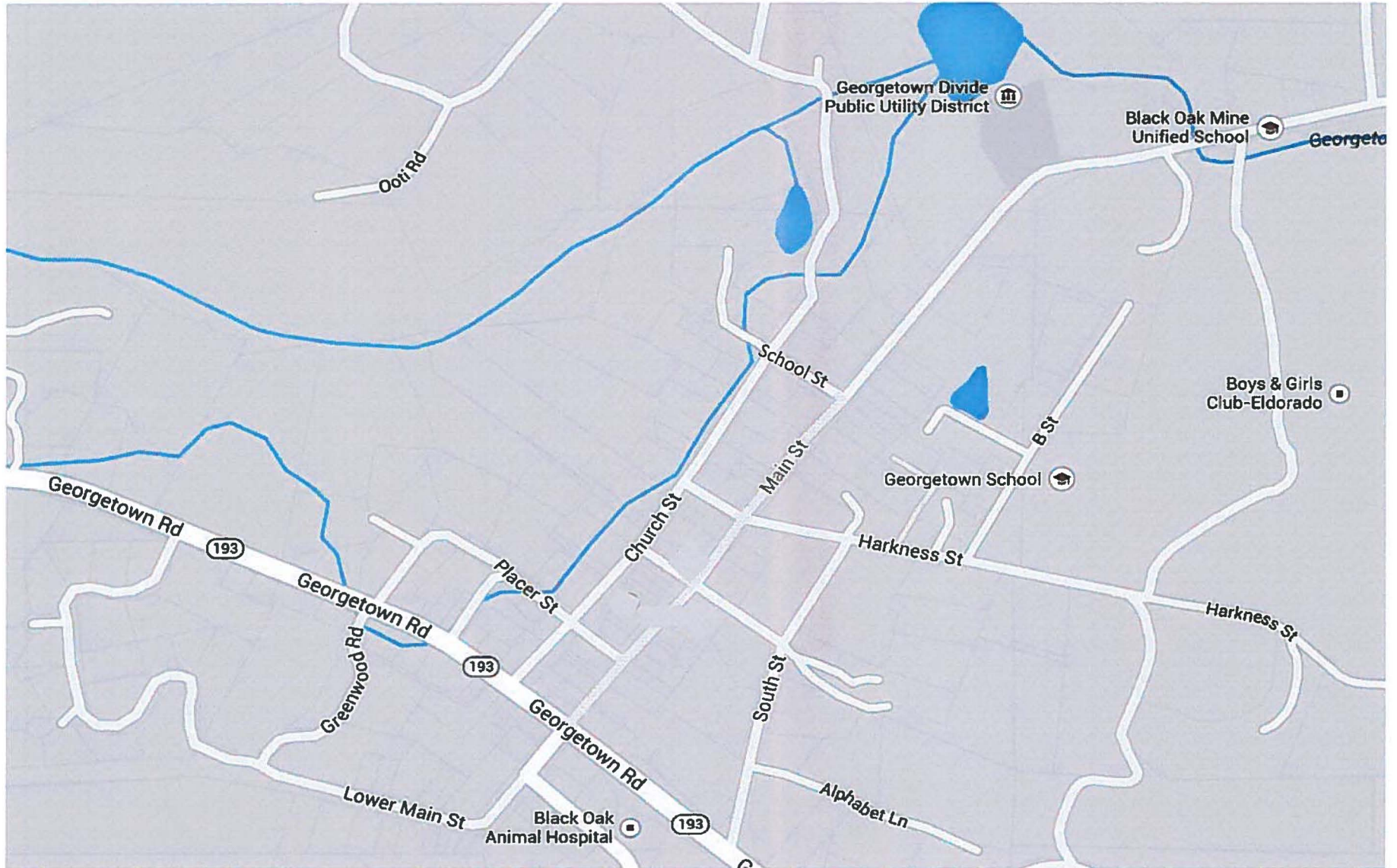



CERTIFICATE OF LIABILITY INSURANCE

DATE (MM/DD/YYYY)
6/25/2014

THIS CERTIFICATE IS ISSUED AS A MATTER OF INFORMATION ONLY AND CONFERS NO RIGHTS UPON THE CERTIFICATE HOLDER. THIS CERTIFICATE DOES NOT AFFIRMATIVELY OR NEGATIVELY AMEND, EXTEND OR ALTER THE COVERAGE AFFORDED BY THE POLICIES BELOW. THIS CERTIFICATE OF INSURANCE DOES NOT CONSTITUTE A CONTRACT BETWEEN THE ISSUING INSURER(S), AUTHORIZED REPRESENTATIVE OR PRODUCER, AND THE CERTIFICATE HOLDER.

IMPORTANT: If the certificate holder is an ADDITIONAL INSURED, the policy(ies) must be endorsed. If SUBROGATION IS WAIVED, subject to the terms and conditions of the policy, certain policies may require an endorsement. A statement on this certificate does not confer rights to the certificate holder in lieu of such endorsement(s).

PRODUCER LOCKTON COMPANIES,LLC-K CHICAGO 525 W. Monroe, Suite 600 CHICAGO IL 60661 (312) 669-6900	CONTACT NAME: Lockton Companies
	PHONE (AG. No. Ext): 1-800-921-3172 FAX (AG. No.): 1-312-681-6769
	E-MAIL ADDRESS: Rotary@lockton.com
INSURER(S) AFFORDING COVERAGE	
INSURER A : Westchester Fire Insurance Company	NAIC # 10030
INSURED 1378352 All Active US Rotary Clubs & Districts Attn: Risk Management Department 1560 Sherman Ave. Evanston, IL 60201-3698	INSURER B :
	INSURER C :
	INSURER D :
	INSURER E :
	INSURER F :

COVERAGES ROTIN01 CERTIFICATE NUMBER: REVISION NUMBER:

THIS IS TO CERTIFY THAT THE POLICIES OF INSURANCE LISTED BELOW HAVE BEEN ISSUED TO THE INSURED NAMED ABOVE FOR THE POLICY PERIOD INDICATED. NOTWITHSTANDING ANY REQUIREMENT, TERM OR CONDITION OF ANY CONTRACT OR OTHER DOCUMENT WITH RESPECT TO WHICH THIS CERTIFICATE MAY BE ISSUED OR MAY PERTAIN, THE INSURANCE AFFORDED BY THE POLICIES DESCRIBED HEREIN IS SUBJECT TO ALL THE TERMS, EXCLUSIONS AND CONDITIONS OF SUCH POLICIES. LIMITS SHOWN MAY HAVE BEEN REDUCED BY PAID CLAIMS.

INSR LTR	TYPE OF INSURANCE	ADDL INSD	SUBR WVD	POLICY NUMBER	POLICY EFF (MM/DD/YYYY)	POLICY EXP (MM/DD/YYYY)	LIMITS
A	<input checked="" type="checkbox"/> COMMERCIAL GENERAL LIABILITY <input type="checkbox"/> CLAIMS-MADE <input checked="" type="checkbox"/> OCCUR <input checked="" type="checkbox"/> Liquor Liability <input type="checkbox"/> Included GEN'L AGGREGATE LIMIT APPLIES PER: <input checked="" type="checkbox"/> POLICY <input type="checkbox"/> PRO-JECT <input type="checkbox"/> LOC OTHER:			PMI G23861355 006	7/1/2014	7/1/2015	EACH OCCURRENCE \$ 2,000,000 DAMAGE TO RENTED PREMISES (Ea occurrence) \$ 500,000 MED EXP (Any one person) \$ XXXXXXXX PERSONAL & ADV INJURY \$ 2,000,000 GENERAL AGGREGATE \$ 10,000,000 PRODUCTS - COMP/DP AGG \$ 4,000,000 \$
A	<input type="checkbox"/> AUTOMOBILE LIABILITY <input type="checkbox"/> ANY AUTO <input type="checkbox"/> ALL OWNED AUTOS <input checked="" type="checkbox"/> HIRED AUTOS <input type="checkbox"/> SCHEDULED AUTOS <input checked="" type="checkbox"/> NON-OWNED AUTOS			PMI G23861355 006	7/1/2014	7/1/2015	COBINED SINGLE LIMIT (Ea accident) \$ 1,000,000 BODILY INJURY (Per person) \$ XXXXXXXX BODILY INJURY (Per accident) \$ XXXXXXXX PROPERTY DAMAGE (Per accident) \$ XXXXXXXX \$ XXXXXXXX
	<input type="checkbox"/> UMBRELLA LIAB <input type="checkbox"/> EXCESS LIAB <input type="checkbox"/> OCCUR <input type="checkbox"/> CLAIMS-MADE <input type="checkbox"/> DED <input type="checkbox"/> RETENTION \$			NOT APPLICABLE			EACH OCCURRENCE \$ XXXXXXXX AGGREGATE \$ XXXXXXXX \$ XXXXXXXX
	<input type="checkbox"/> WORKERS COMPENSATION AND EMPLOYERS' LIABILITY <input type="checkbox"/> ANY PROPRIETOR/PARTNER/EXECUTIVE OFFICER/MEMBER EXCLUDED? (Mandatory in NH) If yes, describe under DESCRIPTION OF OPERATIONS below			NOT APPLICABLE			<input type="checkbox"/> PER STATUTE <input type="checkbox"/> OTH-ER E.L. EACH ACCIDENT \$ XXXXXXXX E.L. DISEASE - EA EMPLOYEE \$ XXXXXXXX E.L. DISEASE - POLICY LIMIT \$ XXXXXXXX

DESCRIPTION OF OPERATIONS / LOCATIONS / VEHICLES (ACORD 101, Additional Remarks Schedule, may be attached if more space is required)

The Certificate Holder is included as Additional Insured where required by written and signed contract or permit subject to the terms and conditions of the General Liability policy, but only to the extent bodily injury or property damage is caused in whole or in part by the acts or omissions of the insured.

CERTIFICATE HOLDER

D.O.T. The County of El Dorado, its officers, officials, employees and volunteers.
El Dorado County, 2850 Fairlane CT. Placerville, CA. 95667

RE: Georgetown Divide Rotary Club, District 5190
Post Office Box 555, Georgetown, CA. 95634

Parade of Lights, 12/05/2014, Rain Date 12/13/2014

CANCELLATION

SHOULD ANY OF THE ABOVE DESCRIBED POLICIES BE CANCELLED BEFORE THE EXPIRATION DATE THEREOF, NOTICE WILL BE DELIVERED IN ACCORDANCE WITH THE POLICY PROVISIONS.

AUTHORIZED REPRESENTATIVE

© 1988-2014 ACORD CORPORATION. All rights reserved.

THIS ENDORSEMENT CHANGES THE POLICY. PLEASE READ IT CAREFULLY.

ADDITIONAL INSURED – DESIGNATED PERSON OR ORGANIZATION

This endorsement modifies insurance provided under the following:

COMMERCIAL GENERAL LIABILITY COVERAGE PART

SCHEDULE

Name Of Additional Insured Person(s) Or Organization(s):
Where required by written contract provided that such was executed prior to the date of loss
per schedule on file with Company

El Dorado County Department of Transportation
2850 Fairlane Court
Placerville, CA 95667

RE: Rotary Club of Georgetown Divide (CA)
Pride of the Mountains Car Show, 9/7/14
Georgetown Founders Day, 9/21/14
Parade of Lights, 12/5/14, Rain Date 12/13/14

Information required to complete this Schedule, if not shown above, will be shown in the Declarations.

A. Section II – Who Is An Insured is amended to include as an additional insured the person(s) or organization(s) shown in the Schedule, but only with respect to liability for "bodily injury", "property damage" or "personal and advertising injury" caused, in whole or in part, by your acts or omissions or the acts or omissions of those acting on your behalf:

1. In the performance of your ongoing operations; or
2. In connection with your premises owned by or rented to you.

However:

1. The insurance afforded to such additional insured only applies to the extent permitted by law; and
2. If coverage provided to the additional insured is required by a contract or agreement, the insurance afforded to such additional insured will not be broader than that which you are required by the contract or agreement to provide for such additional insured.

B. With respect to the insurance afforded to these additional insureds, the following is added to Section III – Limits Of Insurance:

If coverage provided to the additional insured is required by a contract or agreement, the most we will pay on behalf of the additional insured is the amount of Insurance:

1. Required by the contract or agreement; or
2. Available under the applicable Limits of Insurance shown in the Declarations;

whichever is less.

This endorsement shall not increase the applicable Limits of Insurance shown in the Declarations.