

EL DORADO COUNTY
SOUTH LAKE TAHOE OFFICE



ANGORA 3 EROSION CONTROL PROJECT

Location Map

FIGURE

A

DATE: 05/08



PROJECT NO.: 95160/64

BY: JTC

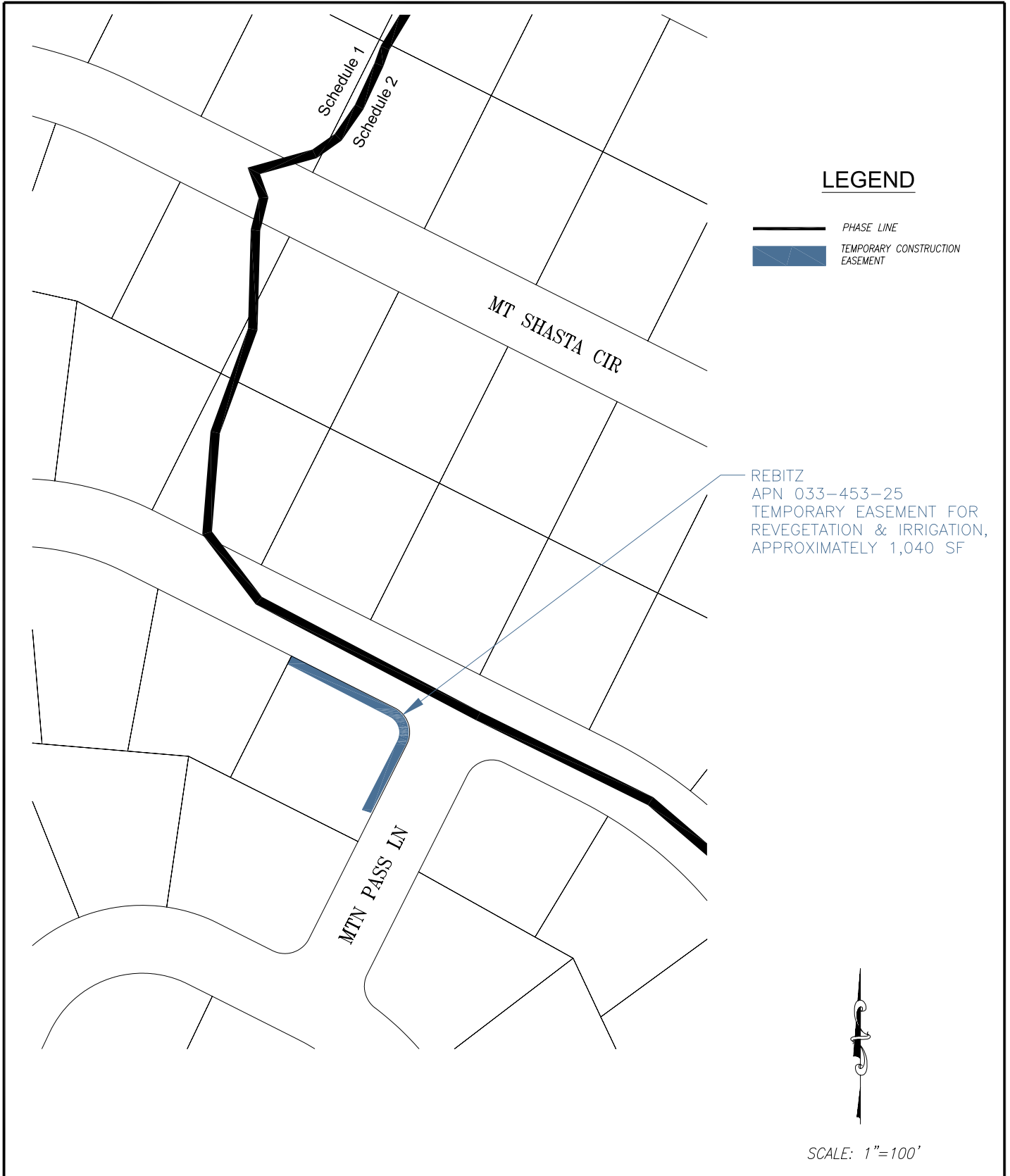
S:\SDSK\Proj\95160\dwg\Grants\2007 Grants\2007 CTC SI Pre-App Grant\Ang3_SI Grant_Ang3_SI Grant_Fig D1R-4R.dwg, B-1, 4/29/2008 1:12:38 PM



LEGEND

-  PHASE LINE
-  TEMPORARY CONSTRUCTION EASEMENT

REBITZ
 APN 033-453-25
 TEMPORARY EASEMENT FOR
 REVEGETATION & IRRIGATION,
 APPROXIMATELY 1,040 SF





SCALE: 1"=100'

EL DORADO COUNTY SOUTH LAKE TAHOE OFFICE 	ANGORA 3 EROSION CONTROL PROJECT Temporary Construction Easement For APN 033-453-25		FIGURE B-1
	DATE: 05/08	PROJECT NO.: 95160	BY: JTC

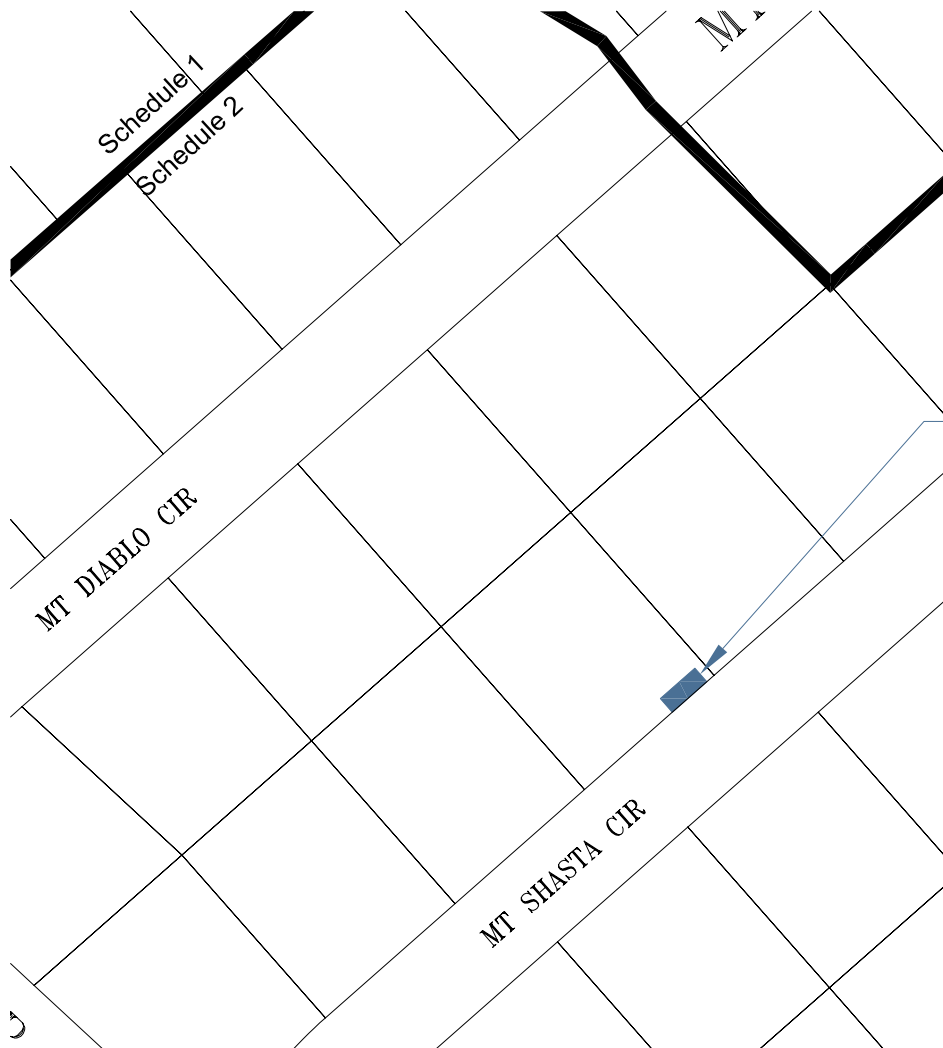
S:\SDSK\Proj\95160\dwg\Grants\2007 Grants\2007 CTC SI Pre-App Grant\Ang3_SI Grant_Ang3_SI Grant_Fig D1R-4R.dwg, B-2, 4/29/2008 1:13:17 PM



LEGEND

-  PHASE LINE
-  TEMPORARY CONSTRUCTION EASEMENT



SCALE: 1"=100'

EL DORADO COUNTY
SOUTH LAKE TAHOE OFFICE



ANGORA 3 EROSION CONTROL PROJECT

Temporary Construction Easement
For APN 033-466-13

DATE: 05/08

PROJECT NO.: 95160

BY: JTC

FIGURE

B-2