

**INDEX OF SHEETS**

SHEET	PLAN SHEET	TITLE
1		TITLE SHEET
2	CD-1	SURVEY CONTROL DIAGRAM
3-4	X-1 thru X-2	TYPICAL SECTIONS
5-7	L-1 thru L-3	LAYOUT
8	C-1	CONSTRUCTION DETAILS
9-12	D-1 thru D-4	DRAINAGE PLAN
13	U-1	UTILITY PLAN
14	SPD-1	MARKER AND DELINEATOR PLAN
15-17	SC-1 thru SC-3	STAGE CONSTRUCTION & SIGNING
18-20	T-1 thru T-3	TREE REMOVAL PLAN
21	EC-1	EROSION CONTROL PLAN

**STRUCTURE PLANS**

22	S-1	GENERAL PLAN
23	S-2	DECK CONTOURS/INDEX TO PLANS
24	S-3	STAGE CONSTRUCTION
25	S-4	FOUNDATION PLAN
26	S-5	ABUTMENT NO.1 LAYOUT
27	S-6	ABUTMENT NO.2 LAYOUT
28	S-7	ABUTMENT DETAILS NO.1
29	S-8	ABUTMENT DETAILS NO.2
30	S-9	ABUTMENT DETAILS NO.3
31	S-10	TYPICAL SECTION
32	S-11	SLAB DETAILS
33	S-12	ARCHITECTURAL TREATMENT
34	S-13	ROCK SLOPE PROTECTION
35	S-14	STRUCTURE APPROACH TYPE (EQ10)
36	S-15	STRUCTURE APPROACH DRAINAGE DETAILS
37	S-16	RETAINING WALL NO.1 LAYOUT
38	S-17	RETAINING WALL NO.2 LAYOUT
39	S-18	LOG OF TEST BORINGS

# COUNTY OF EL DORADO, CA DEPARTMENT OF TRANSPORTATION

## PROJECT PLANS FOR THE CONSTRUCTION OF CLEAR CREEK ROAD P.M. 0.25 BRIDGE REPLACEMENT

IN THE COUNTY OF EL DORADO, DISTRICT 2  
LOCATED OFF SLY PARK ROAD, A QUARTER MILE FROM THE  
INTERSECTION OF SLY PARK ROAD AND CLEAR CREEK ROAD  
To be supplemented with Standard Plans and Specifications dated 2015, including  
the amendments to the 2015 Standard Specifications, of the California  
Department of Transportation, unless otherwise noted.

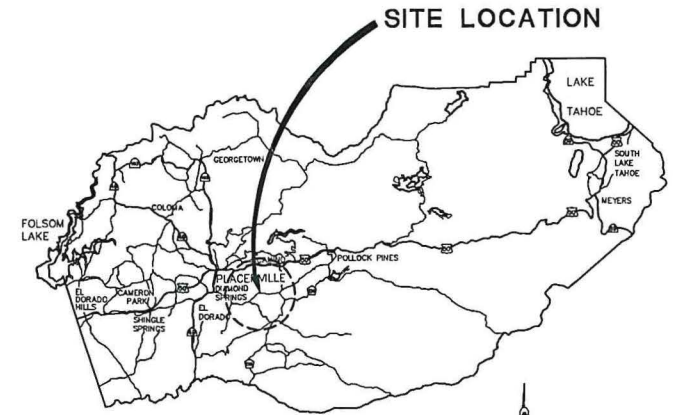

**VICINITY MAP**  
COUNTY OF EL DORADO

**BOARD OF SUPERVISORS**

I	JOHN HIDAHL
II	SHIVA FRENTZEN
III	BRIAN VEERKAMP
IV	LORI PARLIN
V	SUE NOVASEL

**COUNTY OF EL DORADO  
DEPARTMENT OF TRANSPORTATION**

(530) 621-5900  
2850 FAIRLANE CT  
PLACERVILLE, CA 95667

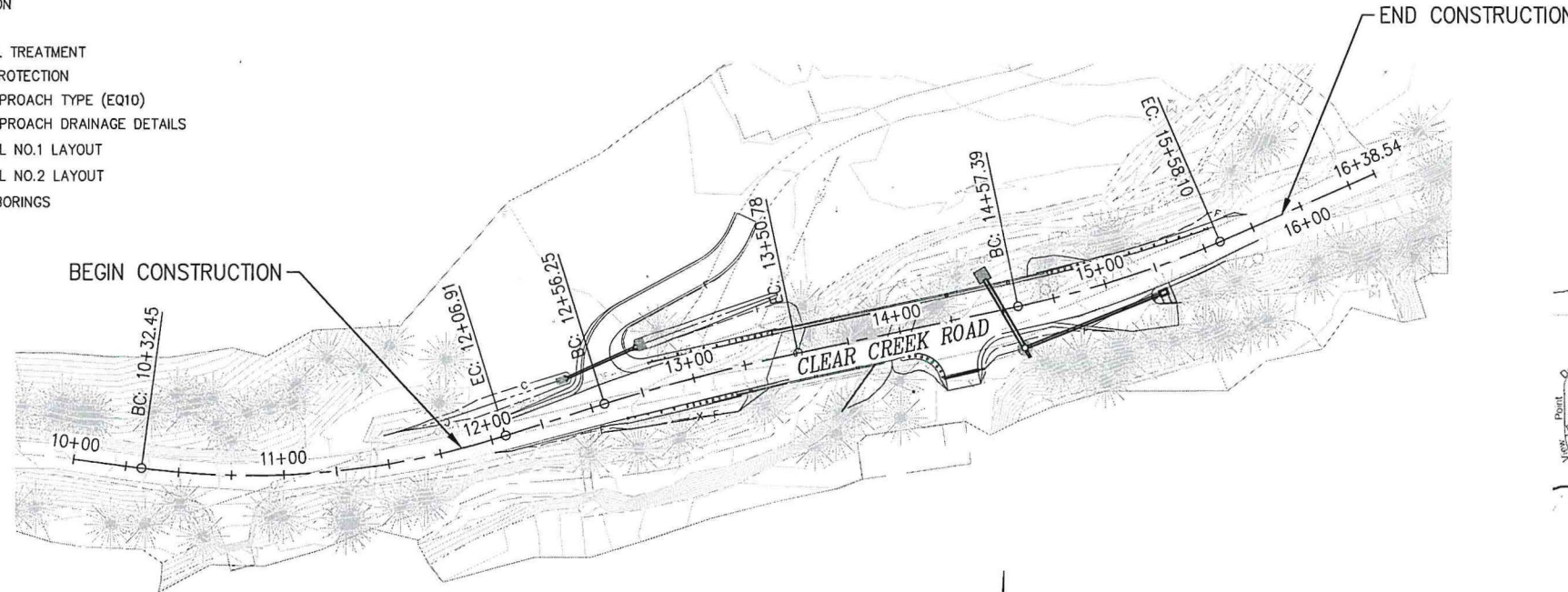

**SITE PLAN**  
SCALE: 1"=40'

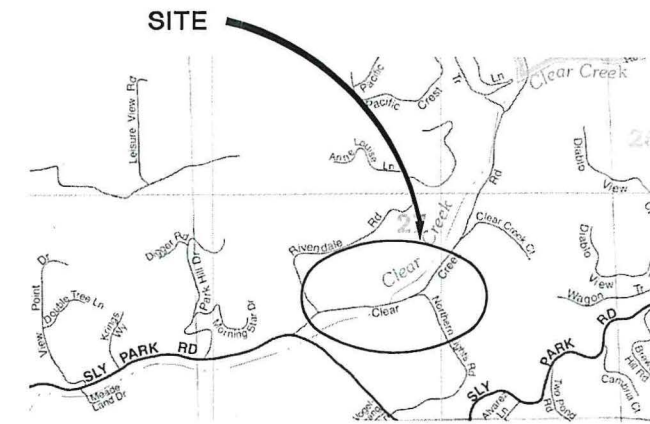

**LOCATION MAP**  
NOT TO SCALE

**FUNDING AGENCY**

ADOPTED AND APPROVED BY:

BRIAN VEERKAMP, CHAIR, EL DORADO COUNTY BOARD OF SUPERVISORS  
DATE: 3/17/20

APPROVED BY:

RAFAEL MARTINEZ, DIRECTOR, DEPARTMENT OF TRANSPORTATION  
DATE: 2/13/2020

MATTHEW D. SMILTZER, P.E. NO. C56832  
DEPUTY DIRECTOR, ENGINEERING  
DATE: 2/10/20

CONTRACT No. 4094 | CIP NO. 77139

**CLEAR CREEK ROAD P.M. 0.25  
BRIDGE REPLACEMENT**

**TITLE SHEET**

SHEET 1 OF 39

CONTRACTOR'S LICENSE CLASSIFICATION: Bidders shall be properly licensed to perform the Work pursuant to the State Contractor's License Act (Business and Professions Code section 7000 et seq.) and shall possess a CLASS A LICENSE or equivalent combination of Classes required by the categories and type of Work included in the Contract Documents and Plans. Failure of the successful Bidder to obtain proper and adequate licensing at the time bids are submitted shall constitute a failure to execute the Contract, and forfeiture as provided under that section.

REVISIONS		
MARK	DATE	BY



SUBMITTED BY: *[Signature]* DATE: \_\_\_\_\_  
CIVIL ENGINEER  
STATE OF CALIFORNIA NO. \_\_\_\_\_