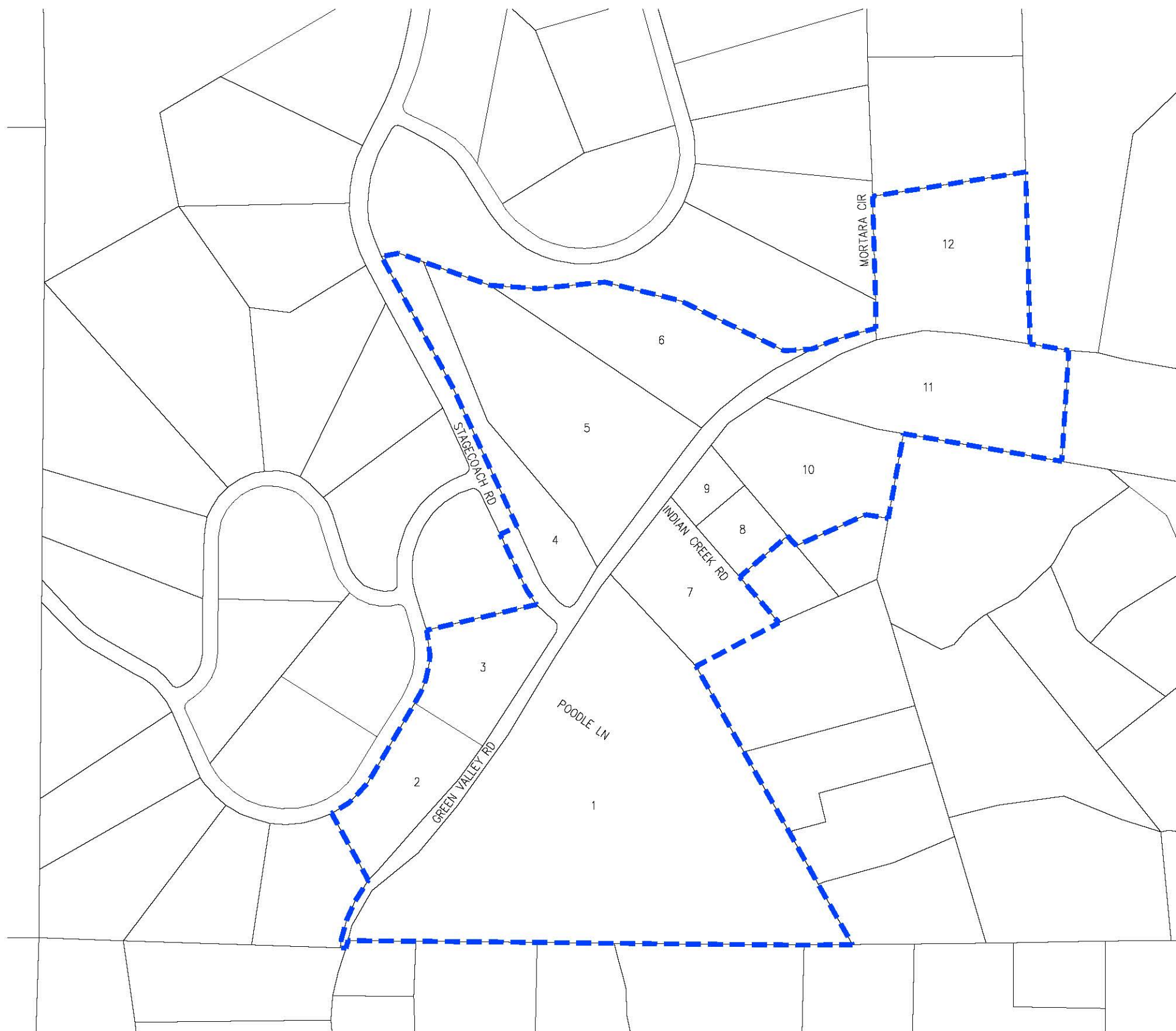

EXHIBIT A

ORIGINAL SCALE IS IN INCHES
 Drawing name: C:\Civil 3D Projects\77127 77136 GV at Indian Creek and Mound Springs\CADD Files\Exhibits\Utilities\UJD_Boundary.dwg Layout Tab: Boundary Map Sep 26, 2016 9:34am smovey
 FOR REDUCED PLANS
 REVISION



MAP ID	A.P.N.	OWNER
1	317-260-02	FRANK
2	317-287-03	SAGER
3	317-287-02	IVES-EDDY
4	317-285-19	GREENSTONE COUNTRY HOA
5	317-285-01	MCGILLICUDDY/WORSLEY
6	317-285-02	STILES
7	317-260-09	MULHALL
8	317-260-25	SCHAFFER
9	317-260-03	JONES
10	317-260-04	ROSS
11	317-250-30	VICKERS
12	317-250-44	RUSSELL

LEGEND:

— UNDERGROUND UTILITY DISTRICT BOUNDARY



PRELIMINARY DRAFT - SUBJECT TO CHANGE

**UNDERGROUND UTILITIES
DISTRICT BOUNDARY MAP
SCALE : NONE**

NUMBER	DATE	DESCRIPTION	BY

PREPARED UNDER THE SUPERVISION OF :

REGISTERED CIVIL ENGINEER

DATE:

DESIGNED: SGM

DRAWN: SGM

CHECKED: DATE: 09/21/16

ROAD NUMBER:



**COUNTY OF EL DORADO
COMMUNITY DEVELOPMENT AGENCY
TRANSPORTATION DIVISION**

**GREEN VALLEY RD AT
INDIAN CREEK AND
MOUND SPRINGS CREEK**

SHEET
EX-1
1 OF 1
W.C. No. **72334**