

A Portion of Bass Lake Road General Vaccation

Community Development Agency
Transportation Division

March 7, 2017

Legistar 16-1272, Version 2

Vicinity Map

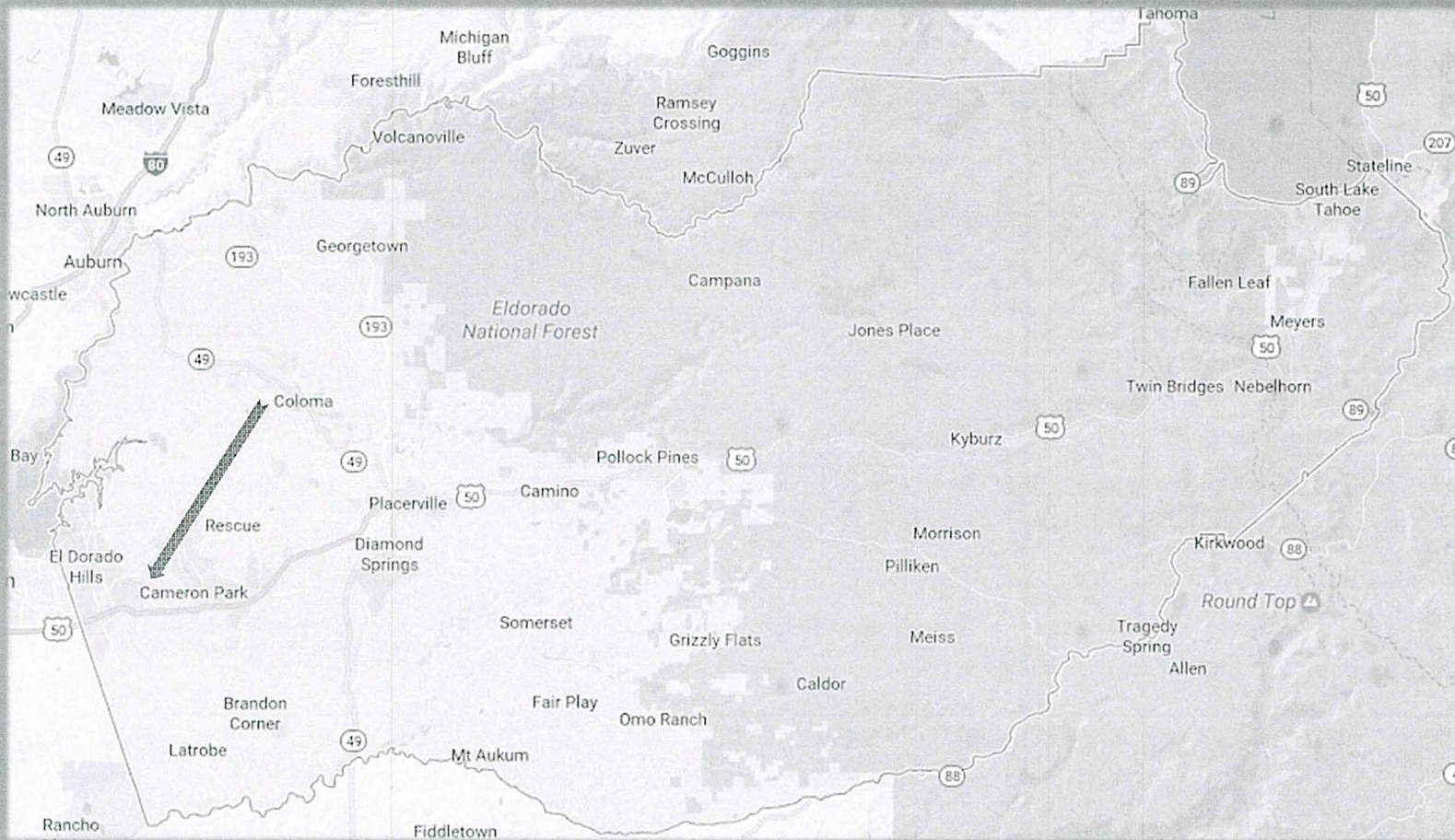

Site of Proposed General Vacation

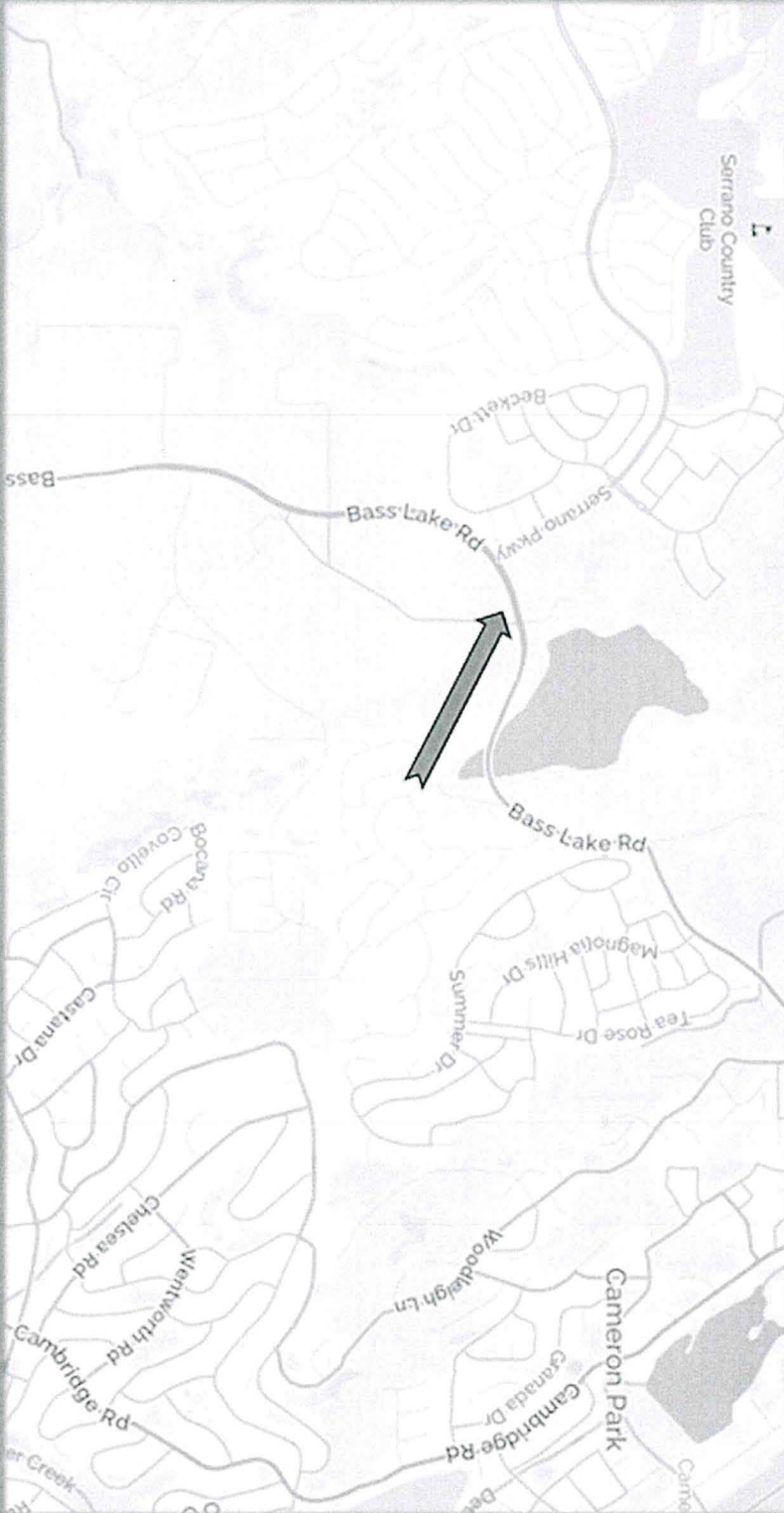

Tentative Map 15/16

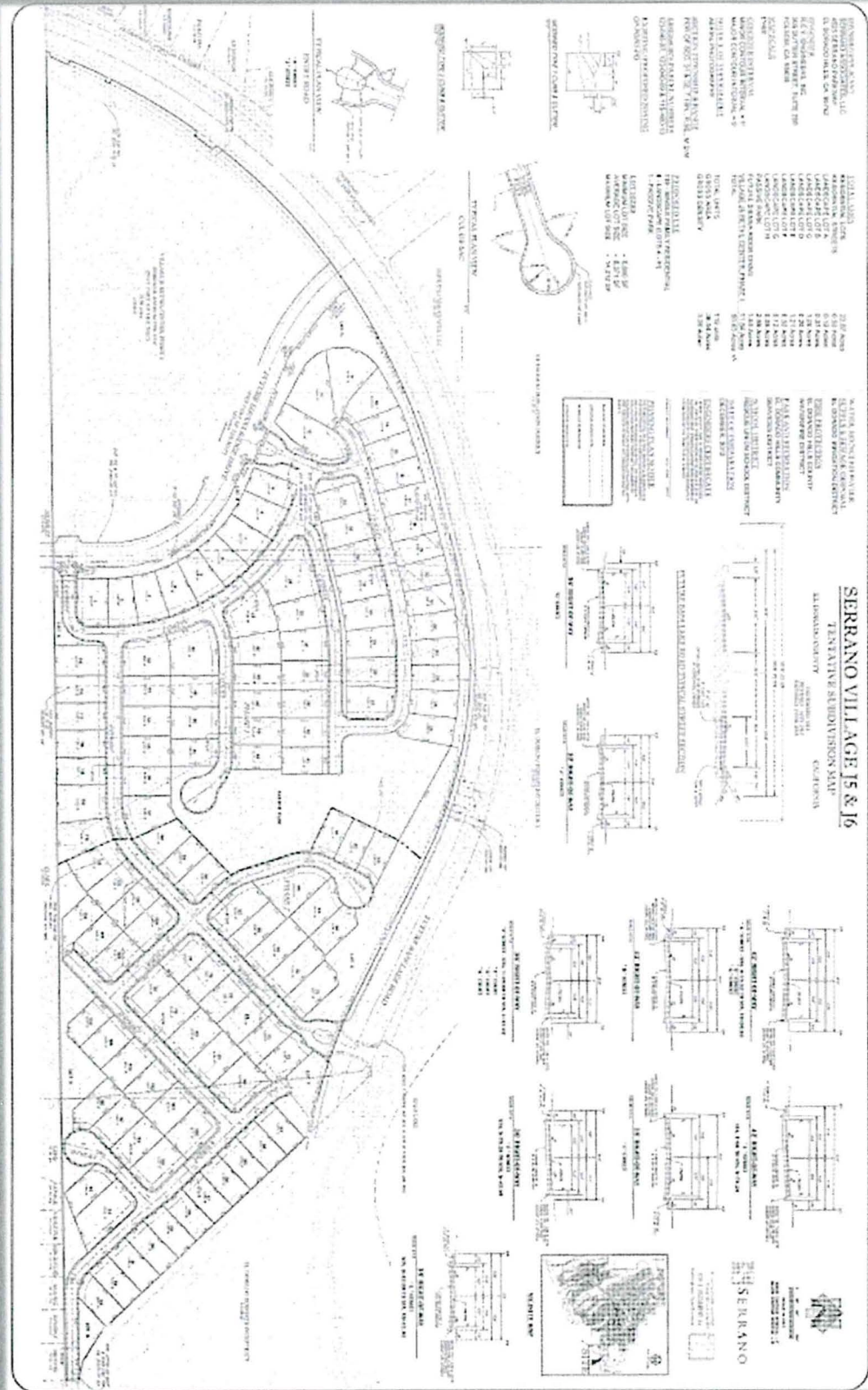

Road Cross Section: BLHSP/PFFP vs. Proposed

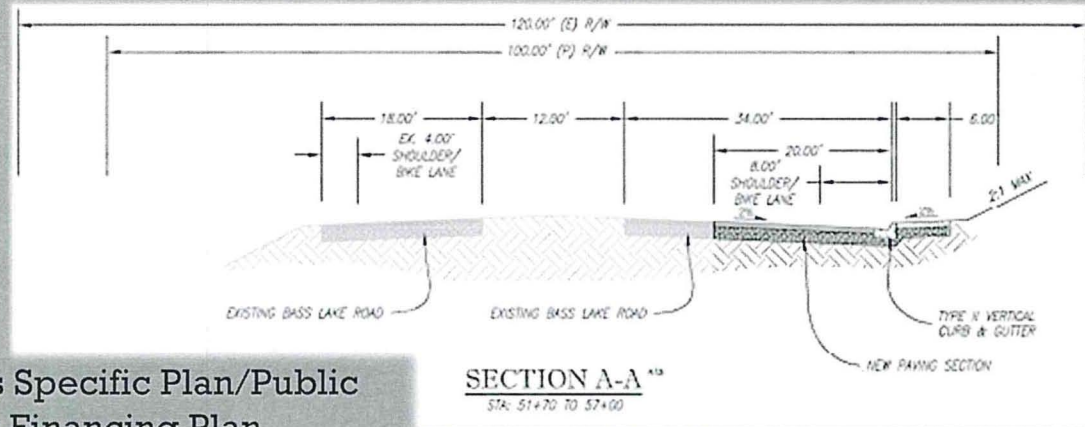

Bass Lake Hills Specific Plan/Public Facilities Financing Plan

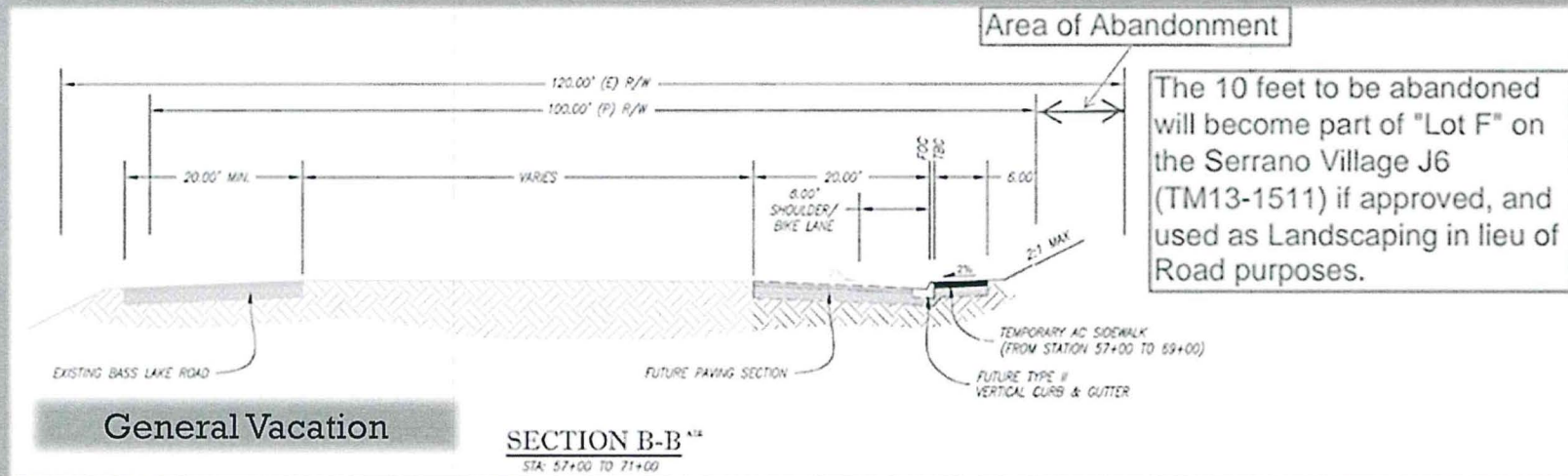

10-foot wide Vacation

SERRANO VILLAGE J5/J6

PROPOSED FRONTAGE ROAD IMPROVEMENTS
 COUNTY OF EL DORADO CALIFORNIA
 OCTOBER 2013

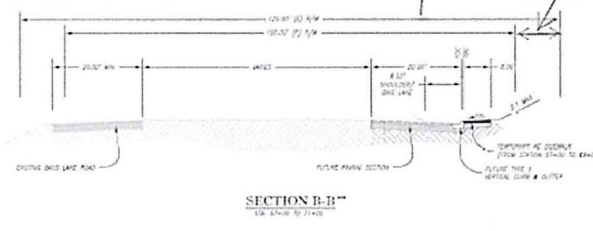
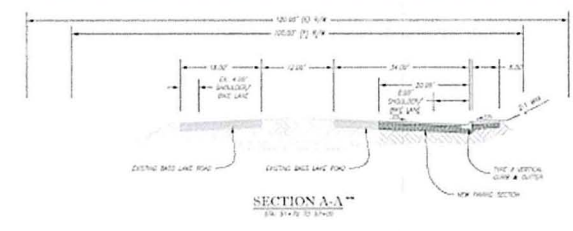
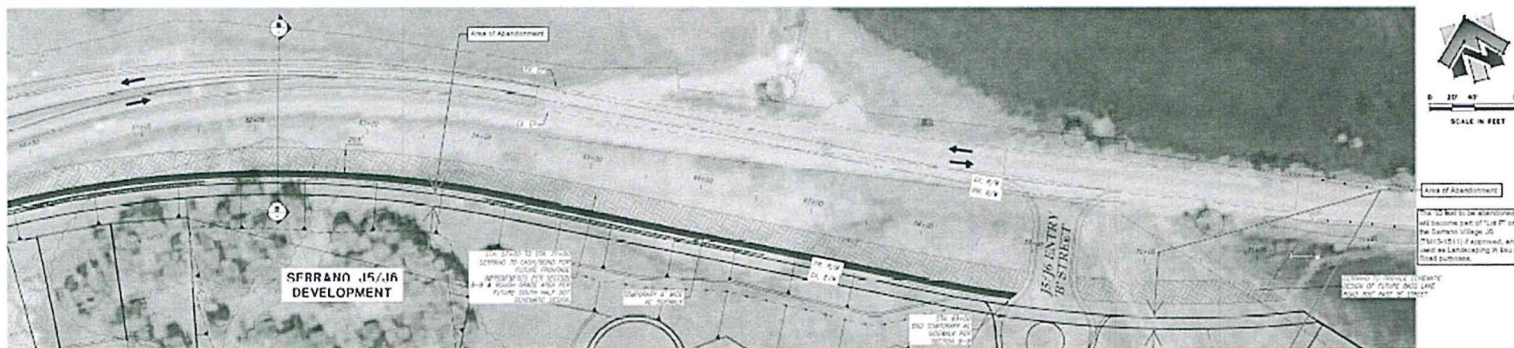
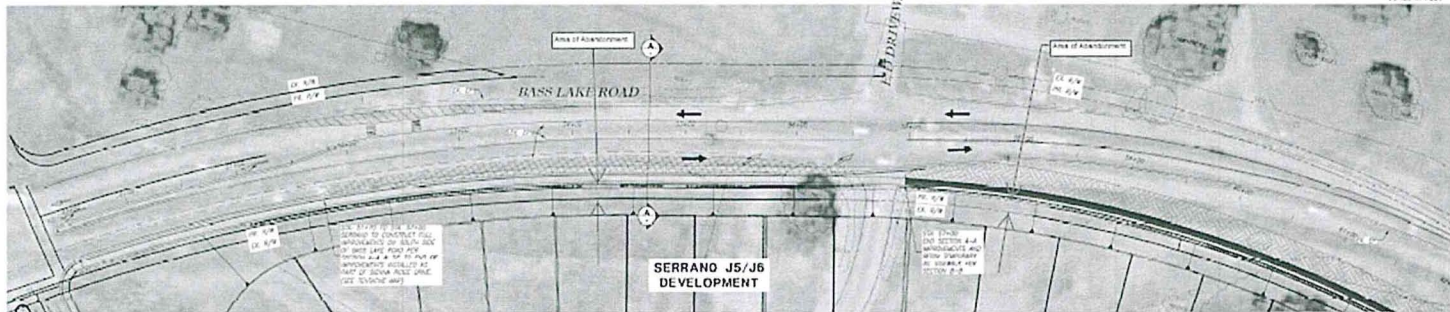

LEGEND

- PROPOSED 10-FOOT VACATION
- PROPOSED 10-FOOT VACATION WITH SIDEWALK
- EXISTING ROAD PAVEMENT
- DIRECTION OF TRAFFIC

REYNOLDS ENGINEERS, INC.
 10000 South Gate Road, Suite 100
 El Dorado, California 95623
 TEL: 916-423-1111 FAX: 916-423-1112
 WWW.REYNOLDS-ENGINEERS.COM

Questions?