

File No. TM14-1522/Z14-0008/PD14-0010

Location Map

Bass Lake North
 Tentative Subdivision Map, Rezone, and Planned Development

 Bass Lake North Site

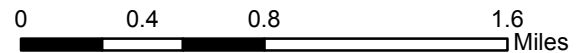





Exhibit A



File No. TM14-1522/Z14-0008/PD14-0010

Bass Lake Hills Specific Plan Area Map

-  Bass Lake Hills Specific Plan Area
-  Bass Lake North Site
-  Subdivisions

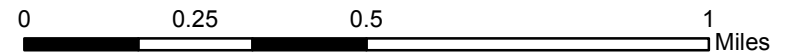
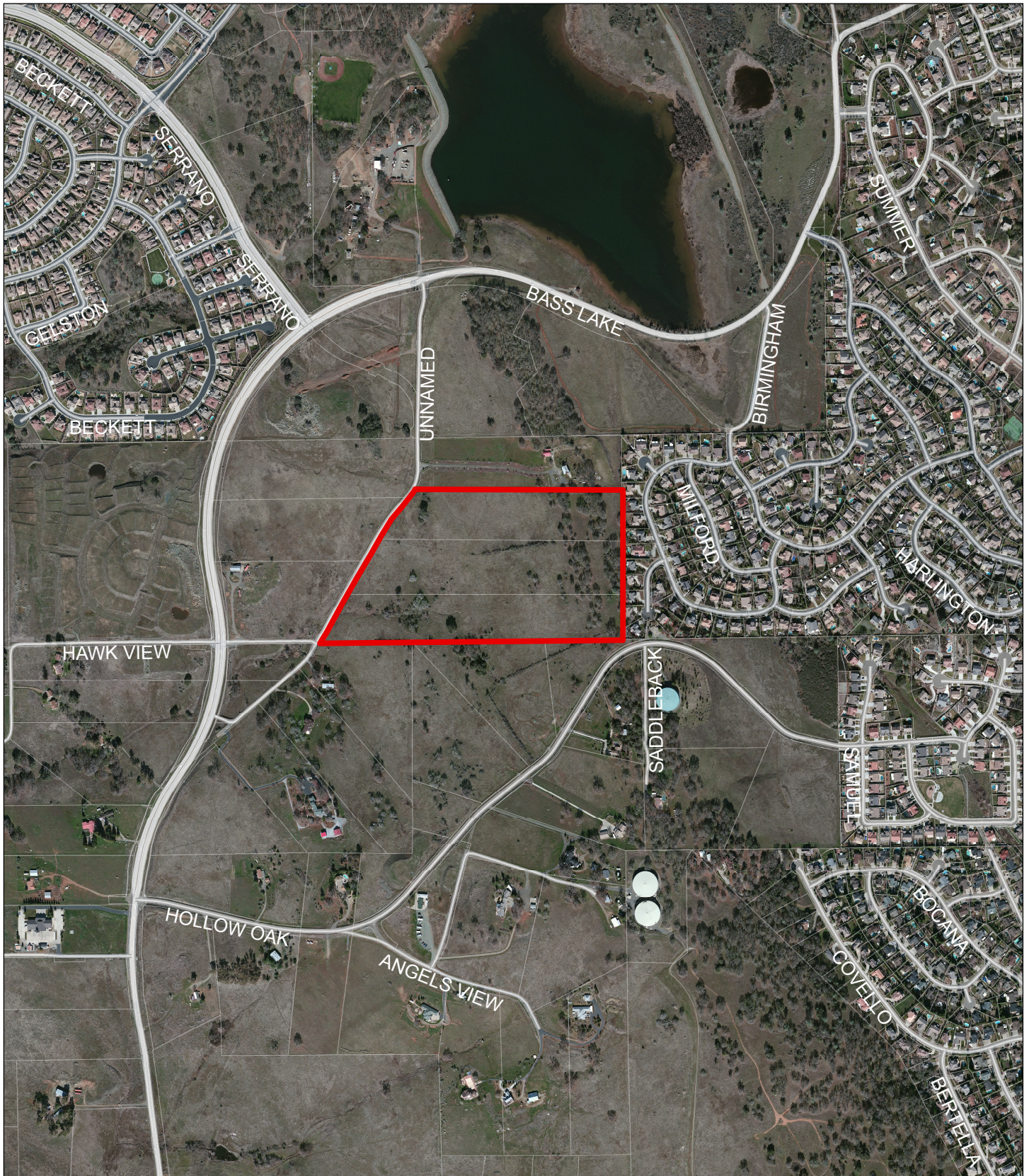
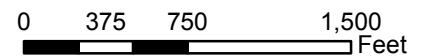

Exhibit B



File No. TM14-1522/Z14-0008/PD14-0010
Aerial Map



Bass Lake North
Tentative Subdivision Map, Rezone, and Planned Development



 Bass Lake North Site

SECS. 31 & 32 T.10N., R.9E., M.D.M.

115:40

1" = 600'

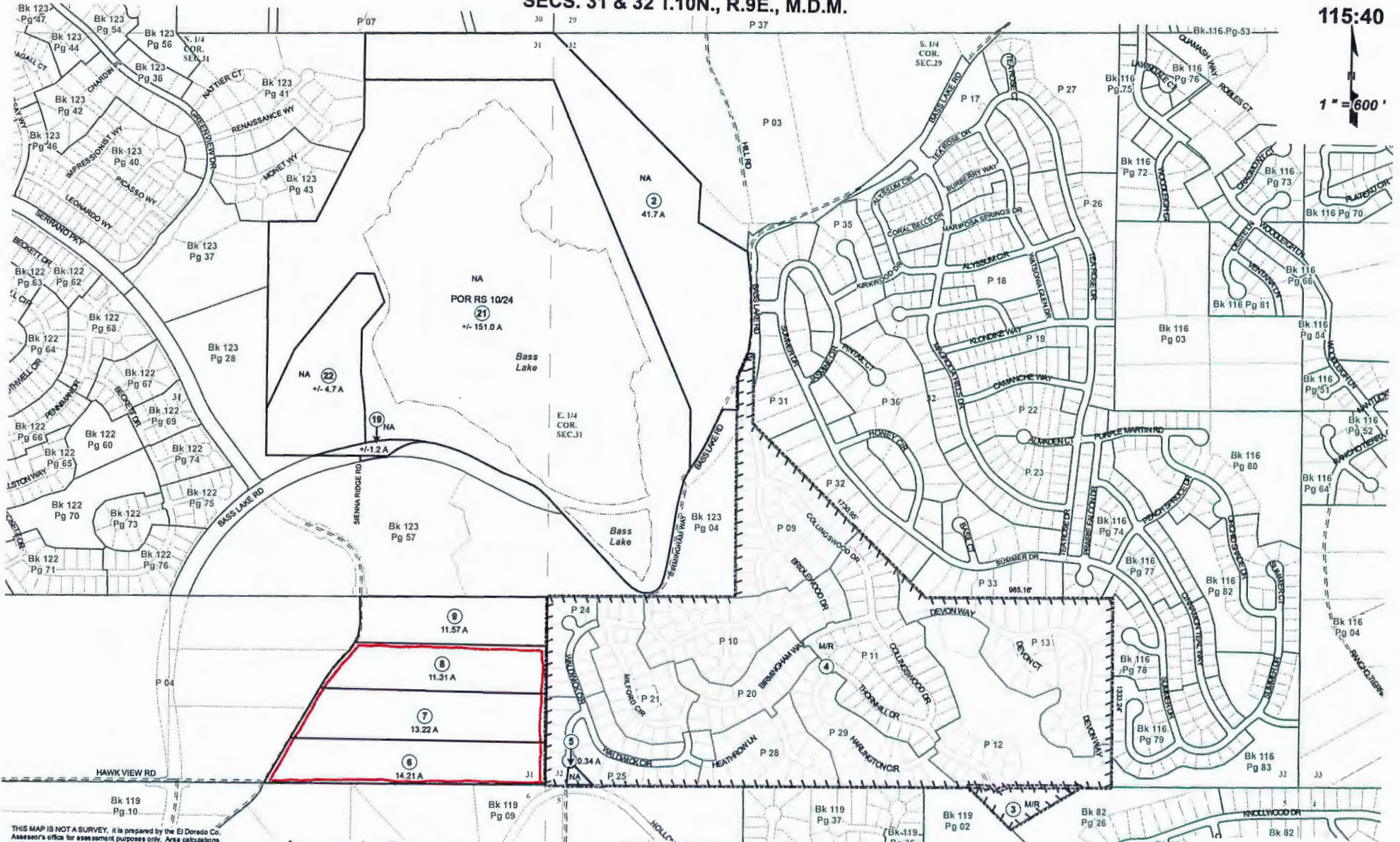

THIS MAP IS NOT A SURVEY. It is prepared by the El Dorado Co. Assessor's office for assessment purposes only. Area calculations and characteristics are not guaranteed. Users should verify items such as dimensions and acreage.

Acreages Are Estimates

Adjacent Map Pages Shown in Grey Text
Assessor's Block Numbers Shown in Ellipses
Assessor's Parcel Numbers Shown in Circles

Rev. JUL 6, 2015

Assessor's Map Bk. 115, Pg. 40
County of El Dorado, CA

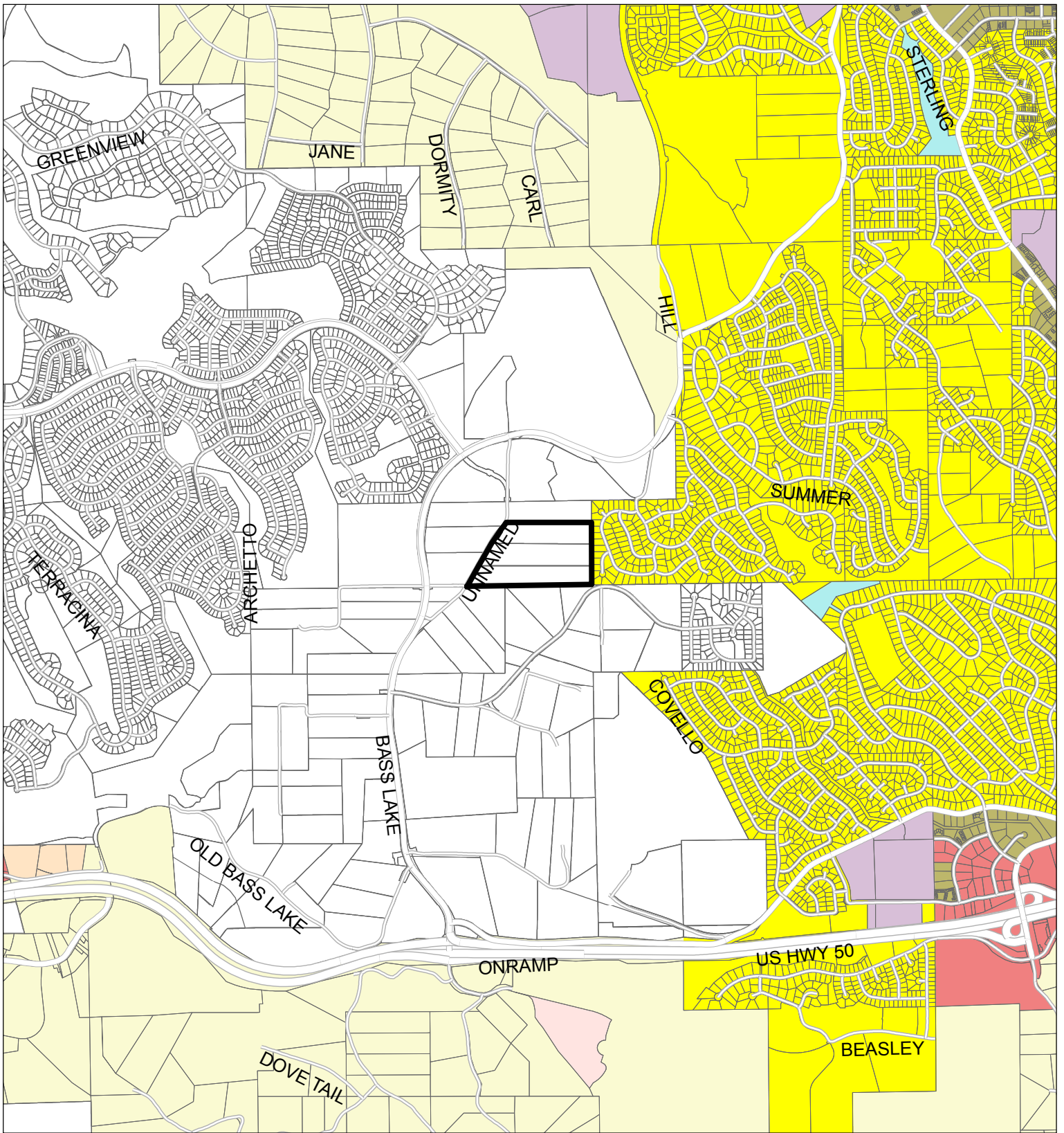

File No. TM14-1522/Z14-0008/PD14-0010
Land Use Map

Bass Lake North
 Tentative Subdivision Map,
 Rezone, and Planned Development

- Bass Lake North Site
- Adopted Plan (AP)
- Commercial (C)
- High Density Residential (HDR)
- Low Density Residential (LDR)
- Medium Density Residential (MDR)
- Multi-Family Residential (MFR)
- Open Space (OS)
- Public Facilities (PF)
- Research & Development (R&D)
- Rural Residential (RR)
- Tourist Recreational (TR)

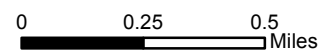

Exhibit E

BASS LAKE NORTH



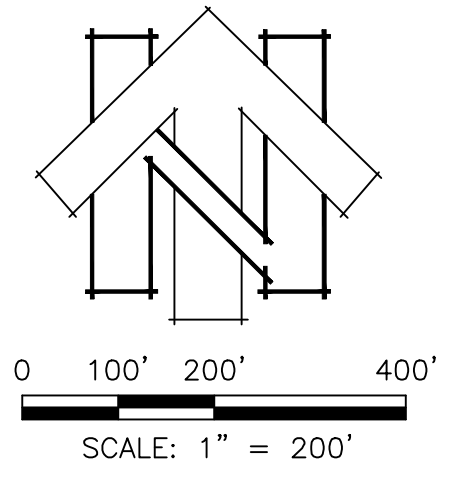

BLHSP - FIGURE 3-1 LAND USE DIAGRAM

SCALE: 1"=200'

APRIL, 2014

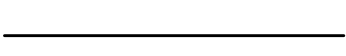
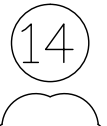

LEGEND

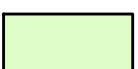
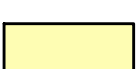
-  PROJECT BOUNDARY LINE
-  VILLAGE LINE
-  LAND USE DESIGNATION
-  LOT LINE
- 32** PARCEL NUMBER
-  DEVELOPMENT AGREEMENT ALLOCATION
-  REMAINING VILLAGE UNITS BASED ON DENSITY (TABLE 3-1)
-  H4PD
-  MPD
-  L.7PD

	VILLAGE B	VILLAGE C	VILLAGE G
	(37)	(15) (7)	(17) (4)
	(41)	(14) (7)	(17) (17)
	(40)	(10) (9)	(5) (12)
	(16)	(4) (7)	(3) (13)
	(4)		(5) (2)
			(1) (2)
	<hr/>	<hr/>	<hr/>
	138 (H4PD)	73 (H4PD & MPD)	127 (MPD)

TABLE 3-2 TOTALS:

H4PD TOTAL: 138 + 43 = 181
(PER TABLE 3-1)

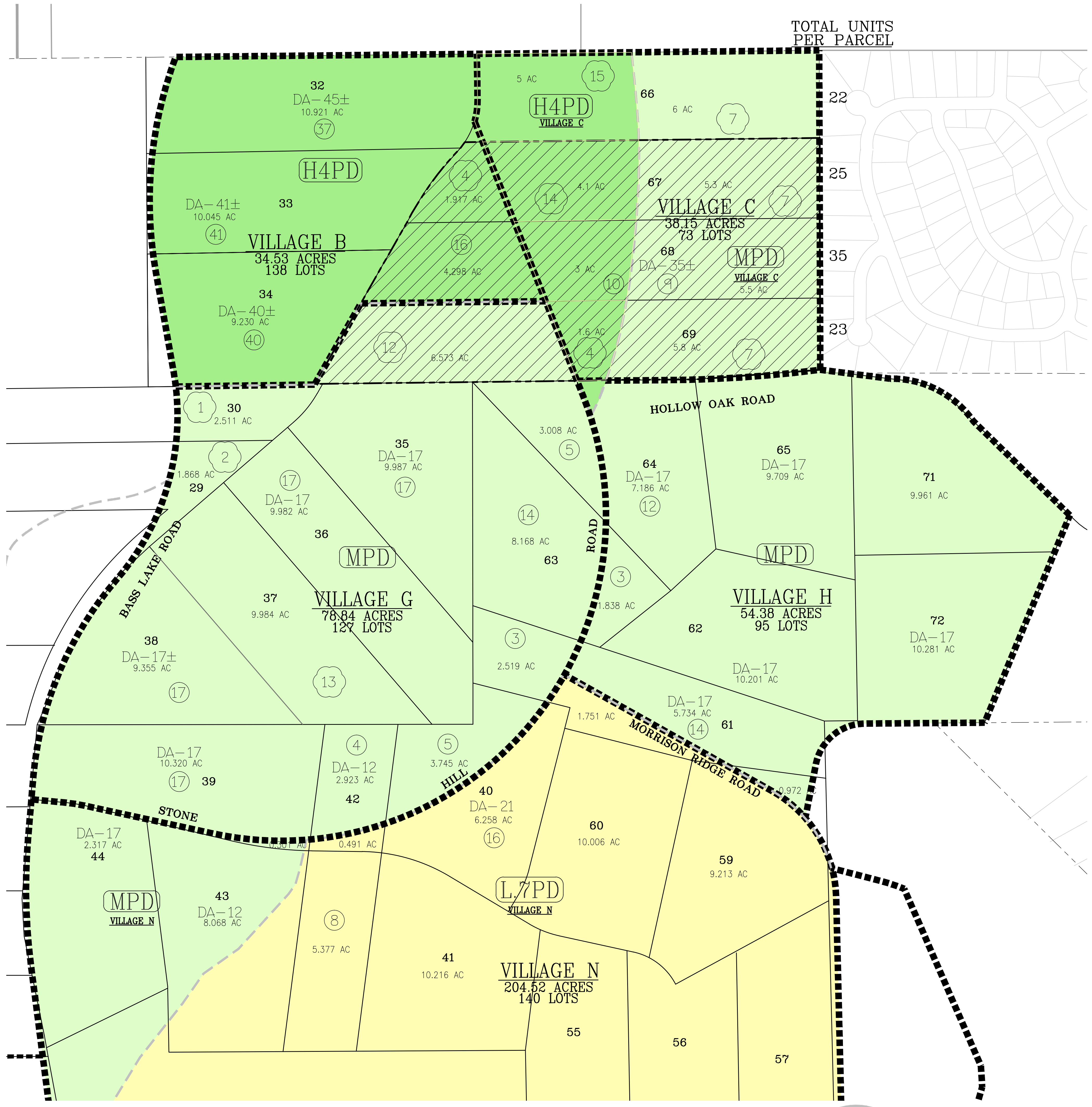

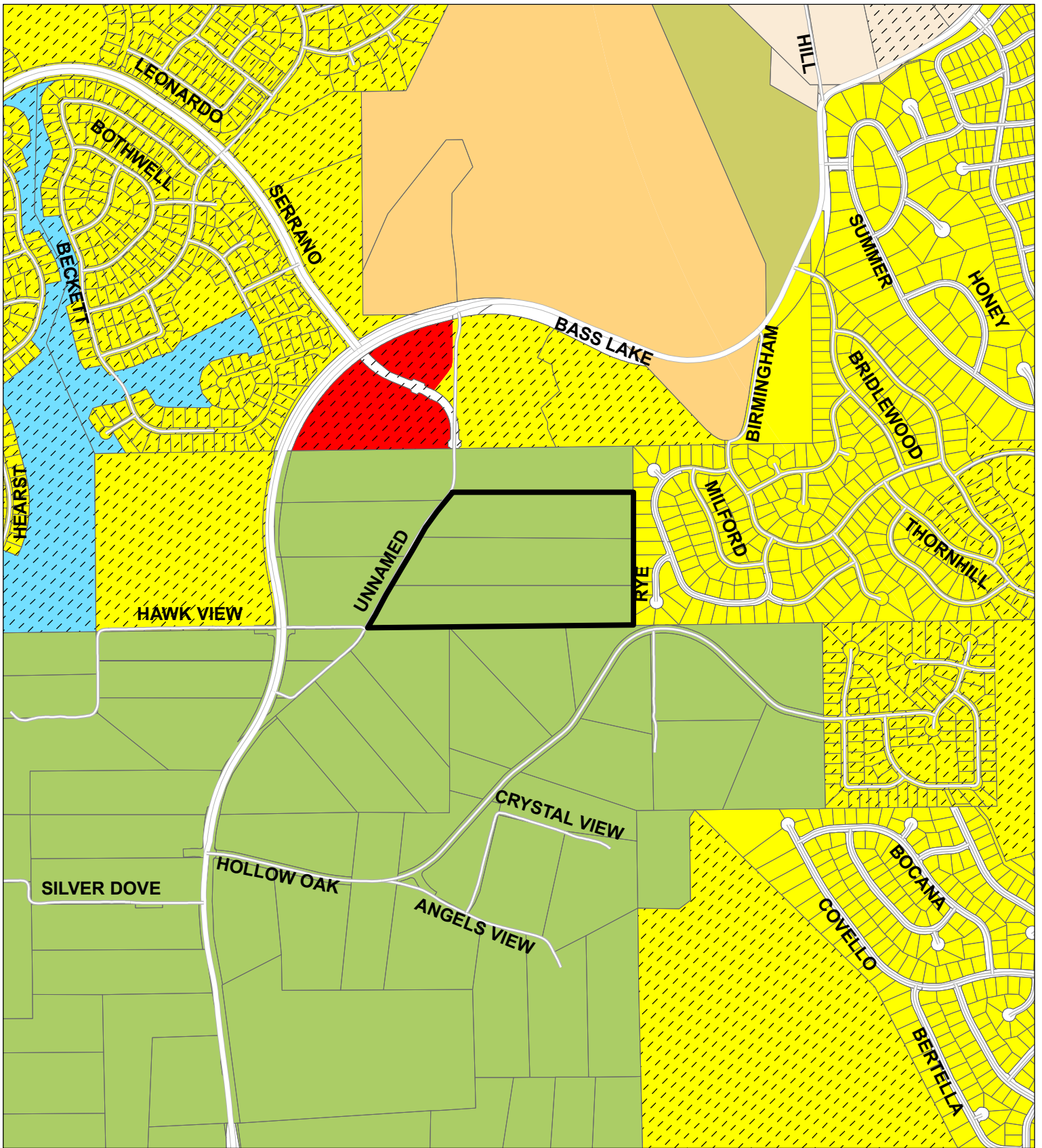

File No. TM14-1522/Z14-0008/PD14-0010
Zoning Map

Bass Lake North
 Tentative Subdivision Map,
 Rezone, and Planned Development

- Bass Lake North Site
- Planned Development
- CC = Commercial Community
- OS = Open Space
- R1 = Residential Single Unit
- R1A = Residential 1 Acre
- RE-5 = Residential Estate 5 Acres
- RE-10 = Residential Estate 10 Acres
- RF-L = Recreational Facility Low
- TC = Transportation Corridor

EXHIBIT G

