

SECS 1, 2, 3, 10, 11, & 12, T.12N., R.10E., M.D.M.

Tax Area Code

61:07

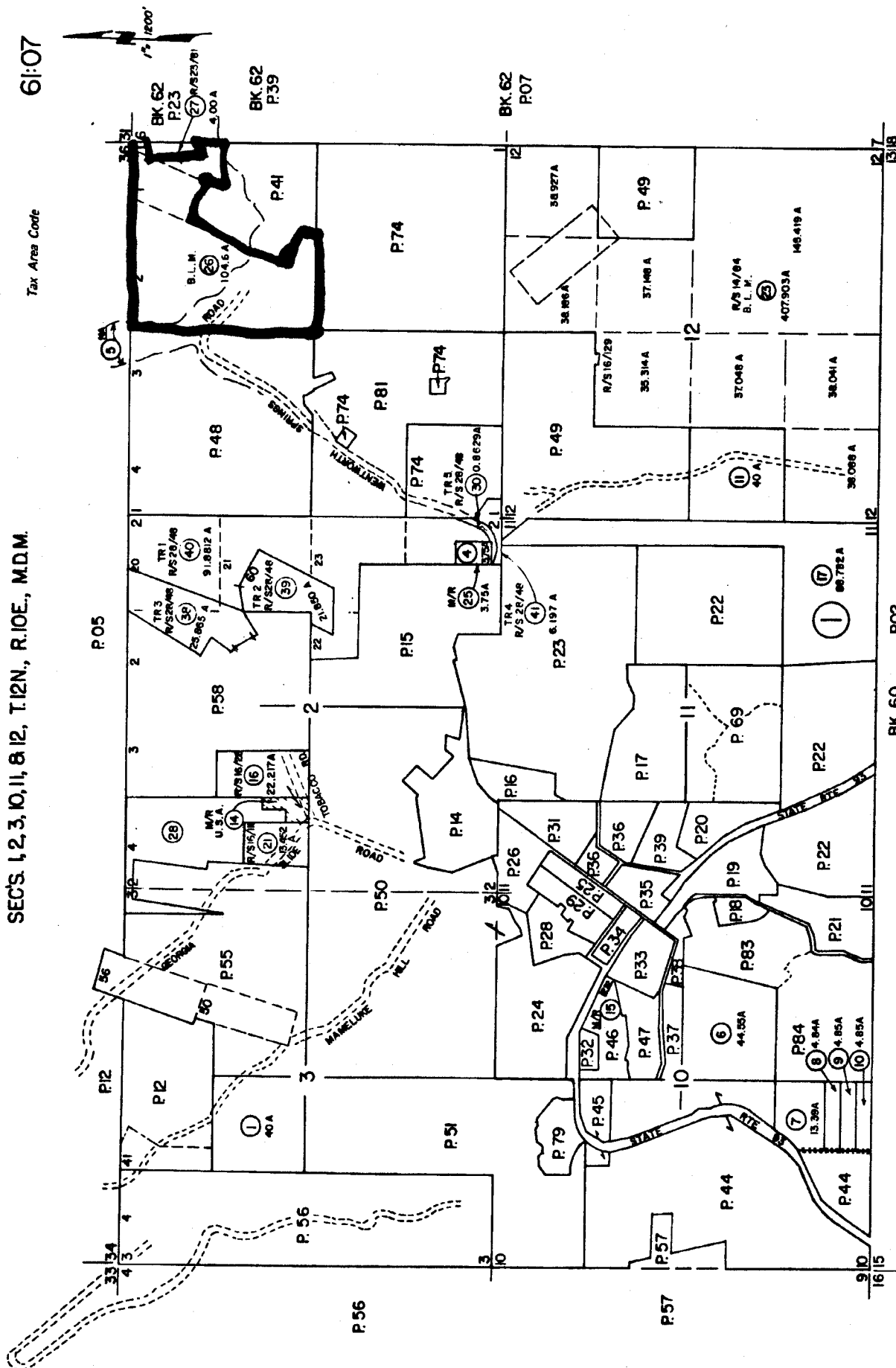

Assessor's Map Bk. 61 - Pg. 07
County of El Dorado, California
SEP 1 8 2005

NOTE - Assessor's Block Numbers Shown in Ellipse
Assessor's Parcel Numbers Shown in Circle

EXHIBIT A