

## El Dorado County - Placerville Jail Expansion

### OPTION 1 - No BEDS Infrastructure Improvements Only

	Area (GSF)	Cost
Intake and Processing	9,270	2,951,587
Medical/Mental Health	6,700	2,285,672
Laundry/Property Storage	5,000	1,875,000
Renovate Staff Training	3,255	185,071
Security Electronics Upgrades	-	1,500,000
Food Services	7,650	5,410,859
Maintenance/Warehouse	1,720	442,263
Sitework/Utilities		4,830,715
<b>TOTAL AREA (GSF)</b>	<b>33,595</b>	
<b>Estimated Construction Cost Total</b>		<b>\$19,481,167</b>

### OPTION 2 - 128 BEDS Dormitory Housing only

	Area (GSF)	Cost
Intake and Processing	9,270	2,951,587
Medical/Mental Health	6,700	2,285,672
Laundry/Property Storage		Included
Renovate Staff Training	3,255	185,071
Housing/Support Services	18,000	7,560,000
Administration/Staff Support	24,000	10,200,000
Security Electronics Upgrades	-	1,500,000
Food Services	7,650	5,410,859
Maintenance/Warehouse	1,720	442,263
Sitework/Utilities		4,830,715
Site Contingency (20%)		966,143
<b>TOTAL AREA (GSF)</b>	<b>70,595</b>	
<b>Estimated Construction Cost Total</b>		<b>\$36,332,310</b>

### OPTION 3 - 48 BEDS Medium/Maximum Security Housing only

	Area (GSF)	Cost
Intake and Processing	9,270	2,951,587
Medical/Mental Health	6,700	2,285,672
Laundry/Property Storage		Included
Renovate Staff Training	3,255	185,071
Housing/Support Services	33,000	14,385,000
Administration/Staff Support	24,000	10,200,000
Security Electronics Upgrades	-	1,500,000
Food Services	7,650	5,410,859
Maintenance/Warehouse	1,720	442,263
Sitework/Utilities		4,830,715
<b>TOTAL AREA (GSF)</b>	<b>85,595</b>	
<b>Estimated Construction Cost Total</b>		<b>\$42,161,167</b>

### OPTION 4 - 176 BEDS Medium/Maximum Security & Dormitory Housing

	Area (GSF)	Cost
Intake and Processing	9,270	2,951,587
Medical/Mental Health	6,700	2,285,672
Laundry/Property Storage		Included
Renovate Staff Training	3,255	185,071
Housing/Support/Adm./Staff	90,215	38,341,975
Security Electronics Upgrades		Included above
Food Services	7,650	5,410,859
Maintenance/Warehouse	1,720	442,263
Sitework/Utilities		4,830,715
<b>TOTAL AREA (GSF)</b>	<b>118,810</b>	
<b>Estimated Construction Cost Total</b>		<b>\$54,448,142</b>

RAY LAWYER DR.

SITE PLAN

SCALE: 1" = 60'-0"

Prepare Building Pad  
for Phase II Housing  
Unit/Admin. Expansion

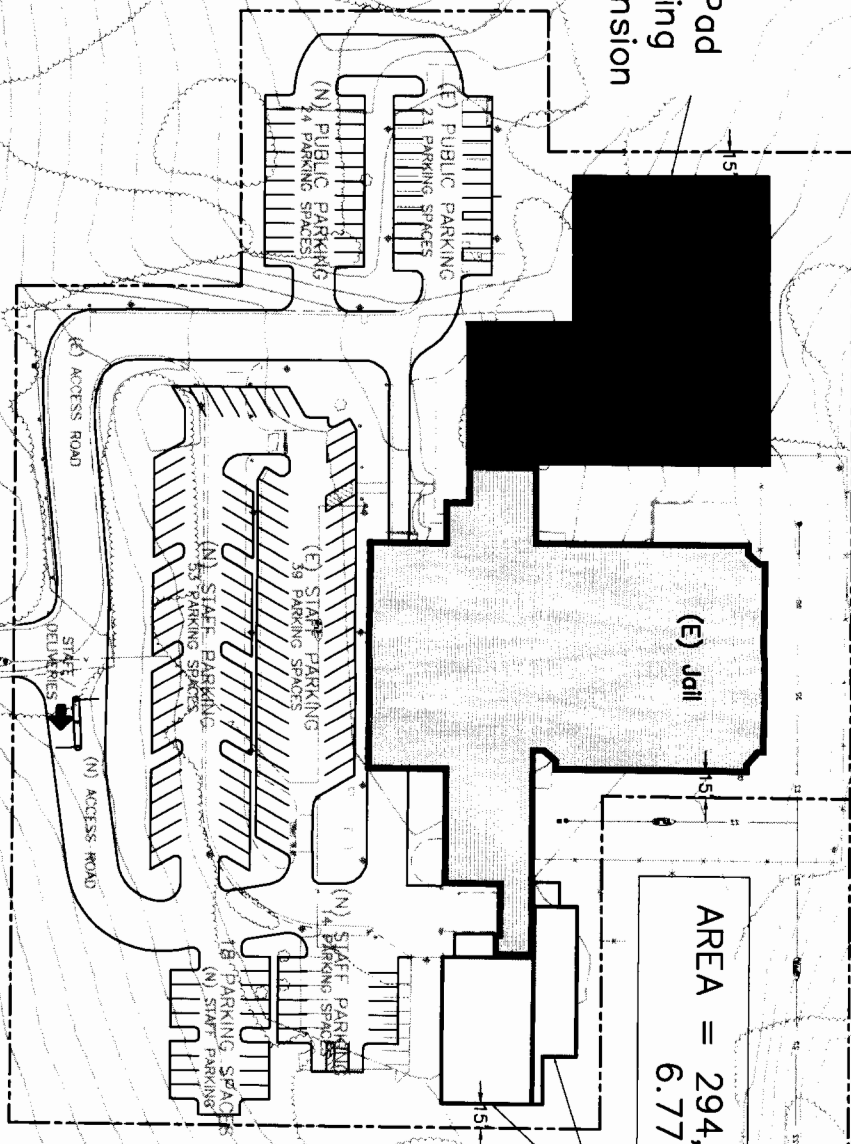

AREA = 294,707 S.F.  
6.77 Acres ±

(N) Warehouse  
(N) Food  
Service Building

FOR REDUCED PLANS 0 1/2 1 2 ORIGINAL SCALE IS IN INCHES

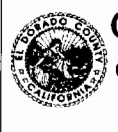

County of El Dorado  
General Services Department  
Facility Services Division

300 FORNI ROAD  
PLACERVILLE, CA 95667

EL DORADO COUNTY  
SITE PLAN

REVISION	DATE	DESCRIPTION

THIS DRAWING IS NOT FINAL  
CONSTRUCTION SHALL BE  
SIGNED BY THE ARCHITECT/  
ENGINEER

DATE: 2/18/2008  
DESIGNED BY: XX  
DRAWN BY: XX  
CHECKED BY: TN  
FILE #  
PROJECT # XX

SHEET NO.  
**SP**