

Road Maintenance Program Update

Community Development Agency
Transportation Division

May 17, 2016

Legistar 14-0228

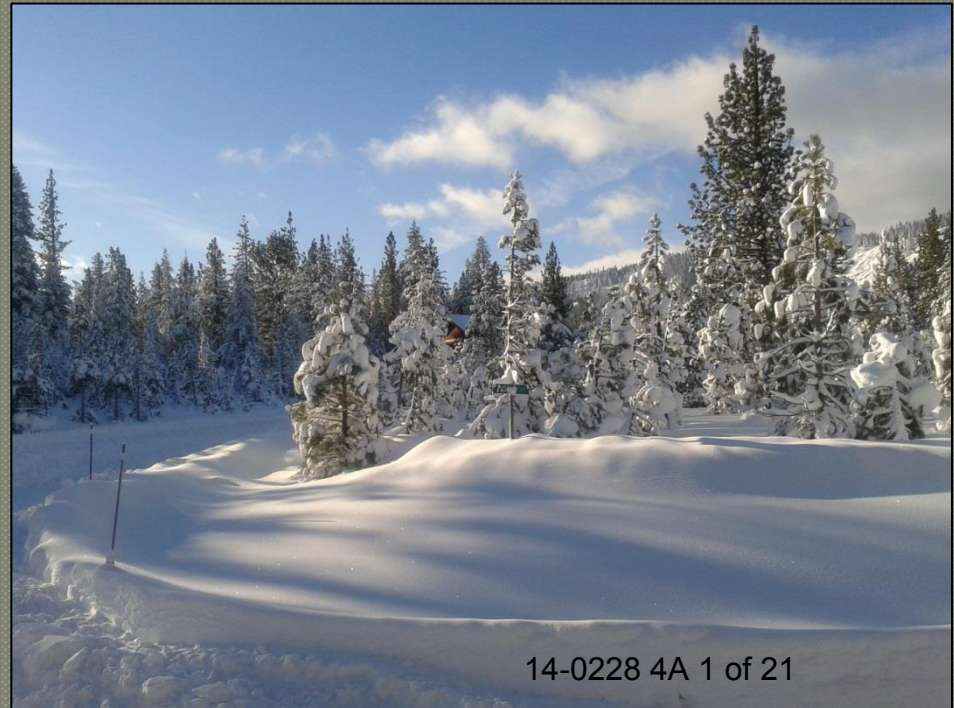

Presentation Objectives

1 Projects Completed/Remaining - FY 15/16

2 Carryover of Tribal Funds

3 Planned Projects – FY 16/17

4 Potential Uses of Additional Funding

Areas of Responsibility

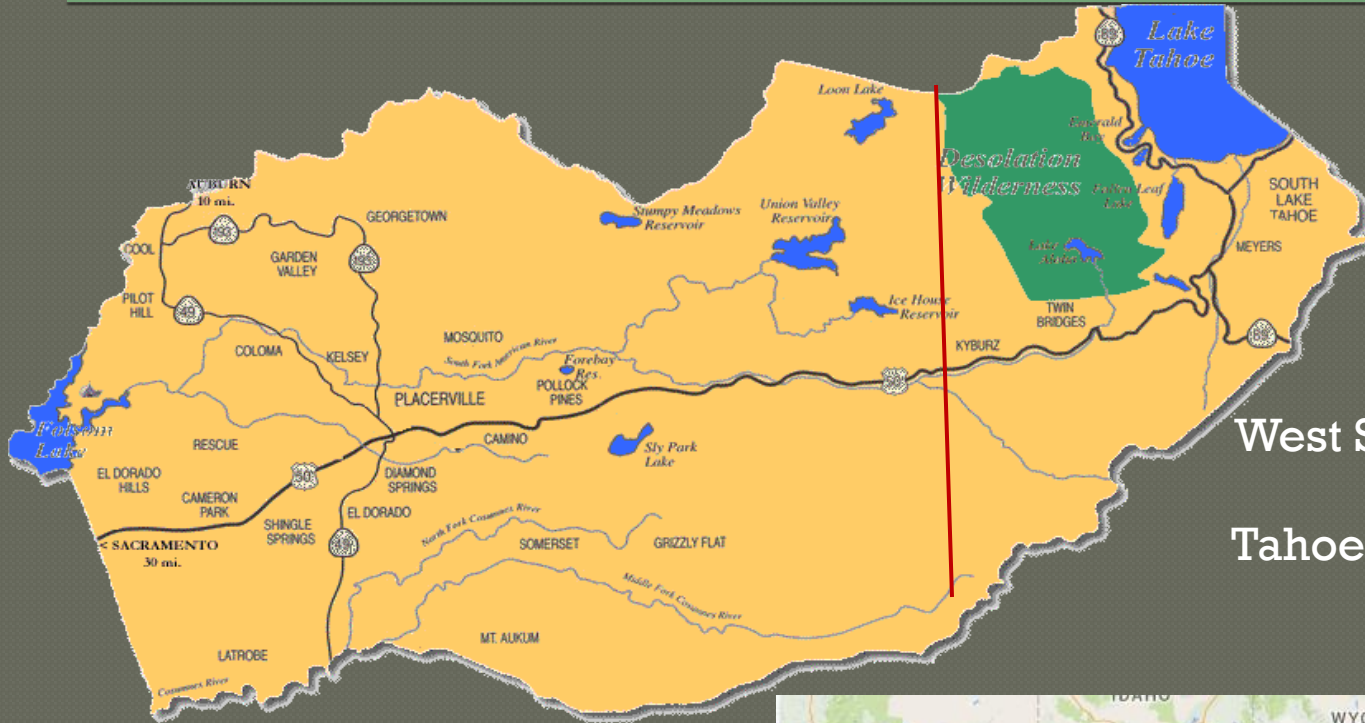

West Slope - 925 Miles

Tahoe Basin - 158 Miles

Placerville to Garden City KS
1080 Miles

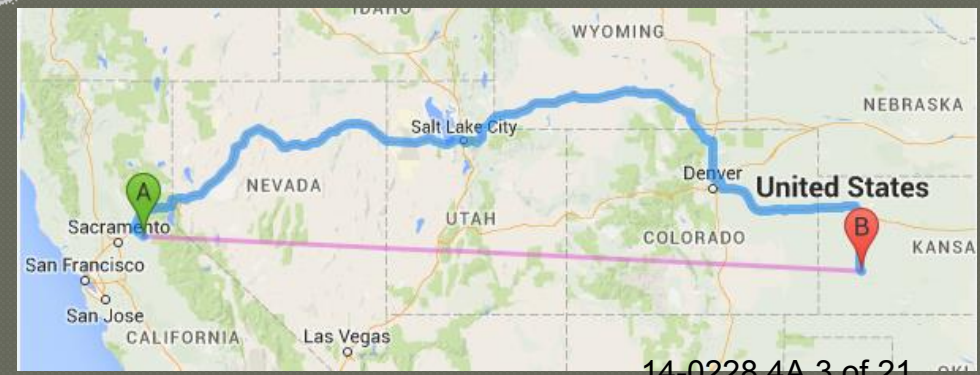

Highlights of Completed Projects FY 15/16

- Rehabilitation
- Chip Seal – 64 Miles
- Slurry Seal – 13 Miles



Highlights of Completed Projects FY 15/16

- ◉ Storm Related Cleanup and Repairs
- ◉ After Hours Emergency Calls
- ◉ Brushing Projects with CalFire Crew
- ◉ Dirt Road Maintenance



Brushing Projects



Goldridge Trail - Before



Onyx Trail - Before



Goldridge Trail - After



Onyx Trail - After

Highlights of Completed Projects FY 15/16

- Repairs –
White Meadow Rd and
Wentworth Springs Rd
- Culvert Replacement -
Deer Valley Rd



Projects Planned for Remainder FY 15/16

- Public Maintenance Requests
- Rehabilitation
 - EDH Business Park
 - Various Road Repairs Throughout County.
- Roadway Striping



Improved Customer Service

- County Roads Facebook Page
- Customer Contact Information via Email
 - Road.maintenance@edcgov.us



Carryover of Tribal Funds

- \$400K Carryover From \$2.5M Tribal Funds in FY 14/15.
- Funds to go towards rehab failures this Fiscal Year.

Planned Projects FY 16/17

Road Fund

- Brushing and Ditching
- Rehabilitation
- 200 Miles of Centerline and Edge Line Striping



Planned Projects FY 16/17

Non-Road Fund

- CIP Project

- Happy Valley Cutoff Road - Camp Creek Bridge

- Zones of Benefit Program

- Assistance from Highway Maintenance Crews
- Drainage and Surface Treatment Projects.

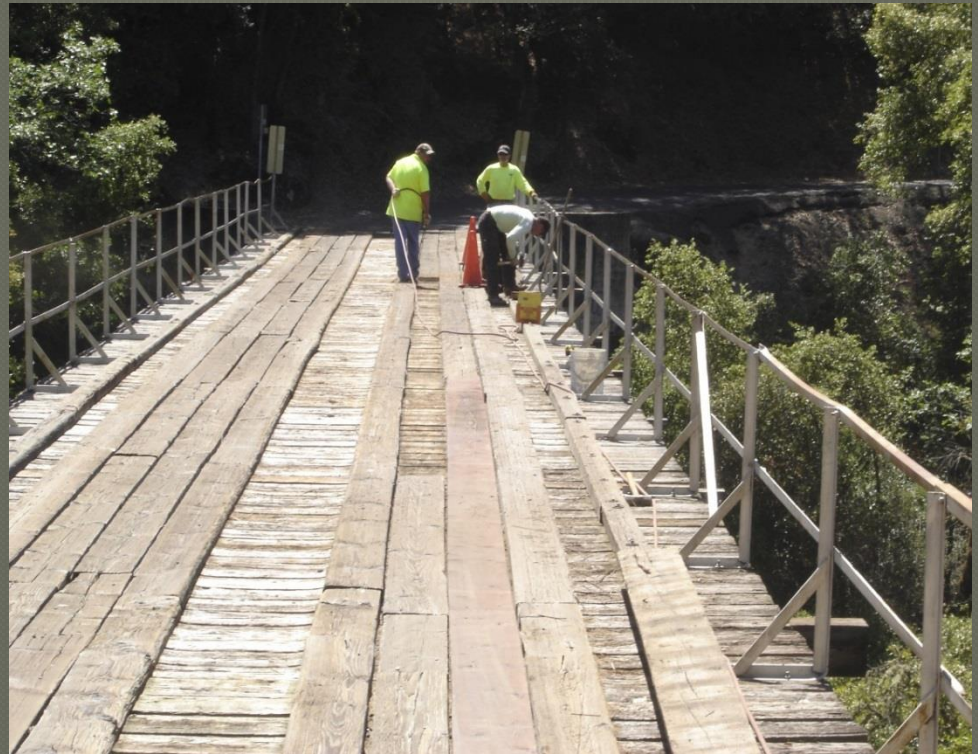

Technology for the Future

- Rubberized Cape Seal
- Benefits
- Grant Funding



Before and After Examples

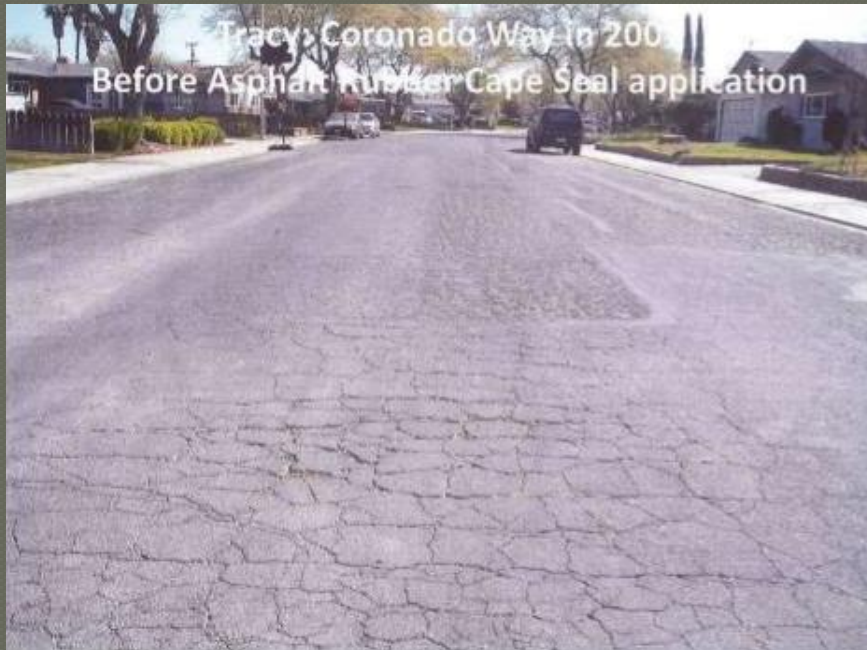

2007 – Before Repairs



2016 – After Rubber Cape Seal Application completed in 2007

Board Contributions Over the Years

- FY 13/14 - \$2.3 Million – General Fund
- FY 14/15 - \$2.5 Million – Local Tribe Fund
- FY 15/16 - \$1.25 Million – Local Tribe Fund

General Fund Projects FY 13/14

○ Brushing

- Salmon Falls Rd
- Sly Park Rd
- Snows Rd
- Perry Creek Rd
- Slug Gulch Rd
- Cambridge Rd

○ Ditching

- Mt Aukum Rd
- Latrobe Rd
- Lotus Rd
- Durock Rd
- Pony Express Trail

○ Surface Treatment

- Kyburz subdivisions

○ Vegetation Control

- Smith Flat, Apple Hill, Georgetown, Omo Ranch

○ Sign Retro reflectivity Program

○ Black Bart, Barbara, and Martin Ave Overlay

Local Tribe Projects FY 14/15

- Gold Hill Overlay
- Slurry Seal
 - Emerald Meadows
 - Longview Estates
- Cameron Park North Subdivision Surface Treatment
- Sign Retro-Reflectivity Program
- Rehab
 - French Creek Rd (Section)
 - Old French Town Rd (Section)
 - South Shingle Rd (Section)
 - Meder Rd (Section)
 - Forni Rd (Section)
 - Gold Hill Rd
 - Sunset Lane (Section)
- Slurry Seal
 - Barnett Business Park

Pavement Condition Index (PCI)

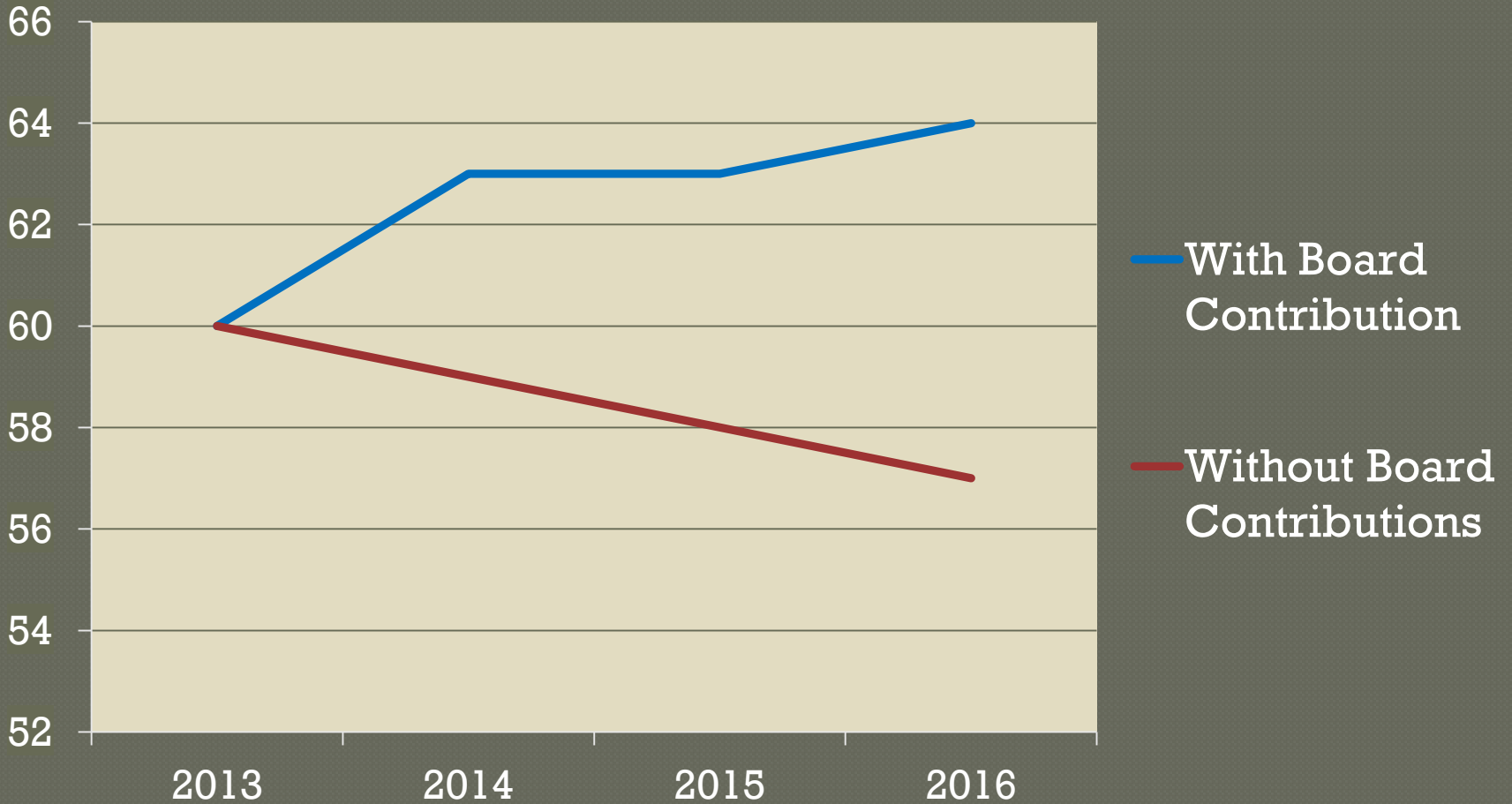

General Fund Possibilities

\$1.0 Million	\$2.0 Million	\$3.0 Million
<p><u>Rehab</u></p> <ul style="list-style-type: none"> – Marshall Rd (Non-Tribe) 	<p><u>Rehab</u></p> <ul style="list-style-type: none"> – EDH Blvd (Section) – Mtn Meadow Dr – Angora Creek Dr – Lower Apache Ave 	<p><u>Rehab</u></p> <ul style="list-style-type: none"> – Mt. Aukum Rd (Section) – Grizzly Park Section 1
<p><u>Rubberized Cape Seal</u></p> <ul style="list-style-type: none"> – EDH Business Park 	<p><u>Rubberized Cape Seal</u></p> <ul style="list-style-type: none"> – Marshall Road (Non-Tribe) 	<p><u>Rubberized Cape Seal</u></p> <ul style="list-style-type: none"> – Grizzly Park Section 1
	<p><u>Slurry Seal</u></p> <ul style="list-style-type: none"> – Camino Hills Subdivision 	

Tribal Contribution Possibilities

\$1.25 Million	\$2.50 Million
<u>Rehab</u> – Marshall Rd (Tribe Boundary)	<u>Rehab</u> – Diamond Springs Business Park – Meder Rd
<u>Brushing</u> – Cold Springs Rd	
<u>Striping</u> – Tribal Area	<u>Rubberized Cape Seal</u> – Marshall Rd (Tribe Boundary) – Diamond Springs Business Park – Meder Rd – Pleasant Valley Rd from Oriental to Mother Lode Dr

Questions
