

# FIGURE 3

## EXISTING 50' NON-BUILDABLE EASEMENT AND PROPOSED 25' NON-BUILDABLE EASEMENT

APN: 042-690-32  
BEING PARCEL 2 OF PM 46/74

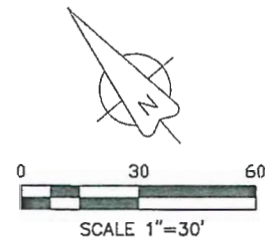
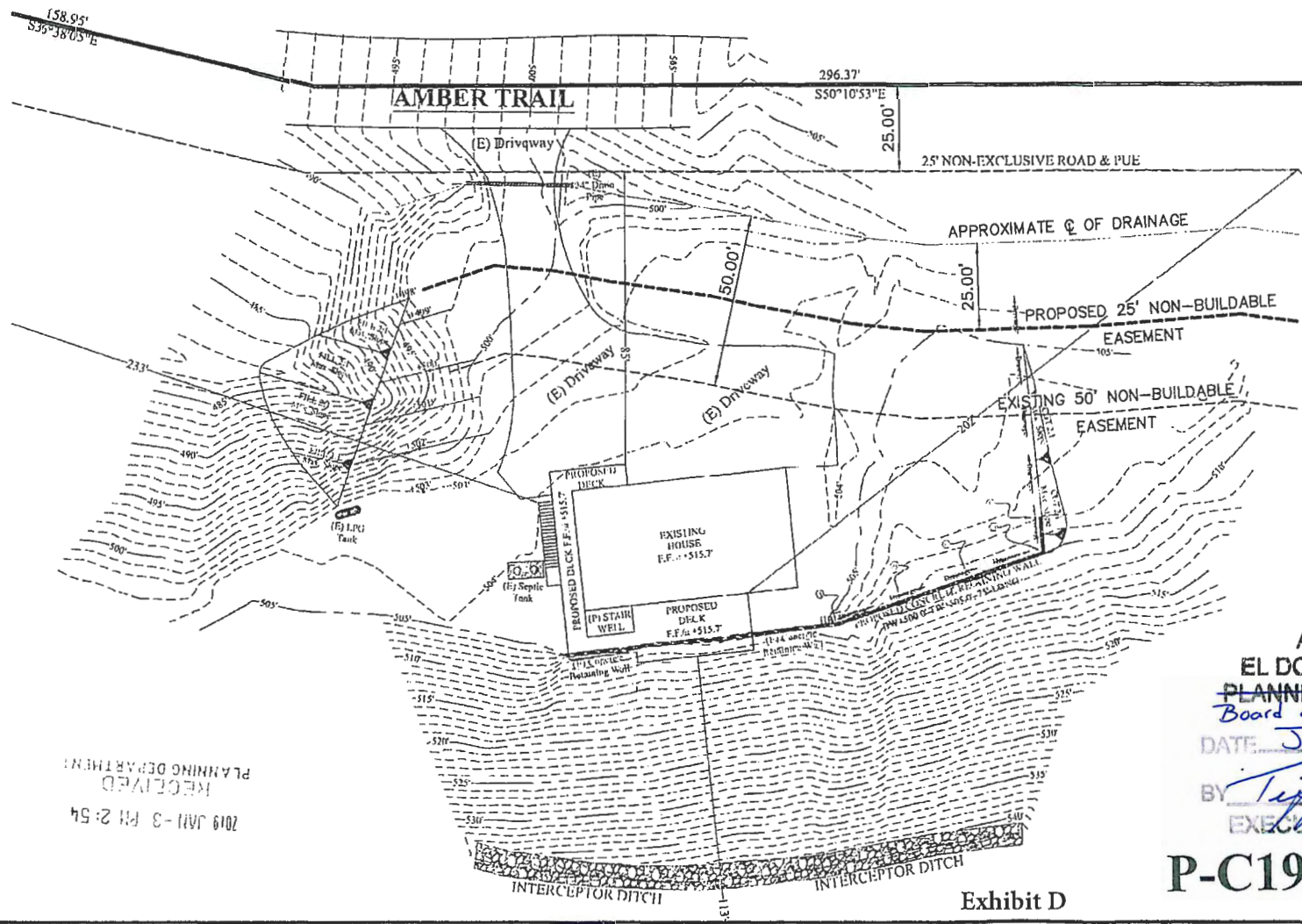

NOTE:  
THIS MAP IS BASED UPON A  
SITE PLOT PLAN BY TOPOGRAPHICS  
AND SIGNED BY JOSEPH YOUNG  
RCE 23525 PROVIDED BY SNOWLINE  
CONSTRUCTION.

**APPROVED**  
**EL DORADO COUNTY**  
**PLANNING COMMISSION**  
*Board of Supervisors*  
DATE: June 4, 2019  
BY: *Tiffany Schmid*  
EXECUTIVE SECRETARY

**P-C19-0001**

RECEIVED  
PLANNING DEPARTMENT  
2019 JAN 11 - 3 PM 2:54

Exhibit D