

\*\*\*\*  
\*\*\*.ord



ORDINANCE NO. 5232

THE BOARD OF SUPERVISORS OF THE COUNTY OF EL DORADO DOES ORDAIN AS FOLLOWS:  
RELATED TO REZONING IN THE PROMONTORY SPECIFIC PLAN AREA, LOT 39:

Section 1. The Official Zoning Map is hereby amended to rezone the following described lands:

El Dorado Hills:

Assessor's Parcel No. 124-230-001, consisting of 0.59 acre as shown in Exhibit A hereto.

The parcel as shown in Exhibit A hereto is hereby amended:

From: Promontory Specific Plan Hillside Large Lot (PRHLL)

To: Promontory Specific Plan Large Lot (PRL)

Section 2. This ordinance shall take effect and shall become effective 30 days following the adoption hereof.

PASSED AND ADOPTED by the Board of Supervisors of the County of El Dorado at a regular meeting of said Board, held on the 17th day of June, 2025, by the following vote of said Board:

ATTEST

Kim Dawson

Clerk of the Board of Supervisors

By [Signature]  
Deputy Clerk

Ayes: Turnboo, Laine, Parlin, Ferrero, Veerkamp

Noes: None

Absent: None

[Signature]  
Chair, Board of Supervisors

APPROVED AS TO FORM  
JEFFERSON BILLINGSLEY  
COUNTY COUNSEL

By: [Signature]

Title: \_\_\_\_\_

# Exhibit A

Existing Zoning Designation:  
Promontory-Hillside Large Lot (PR-HLL)

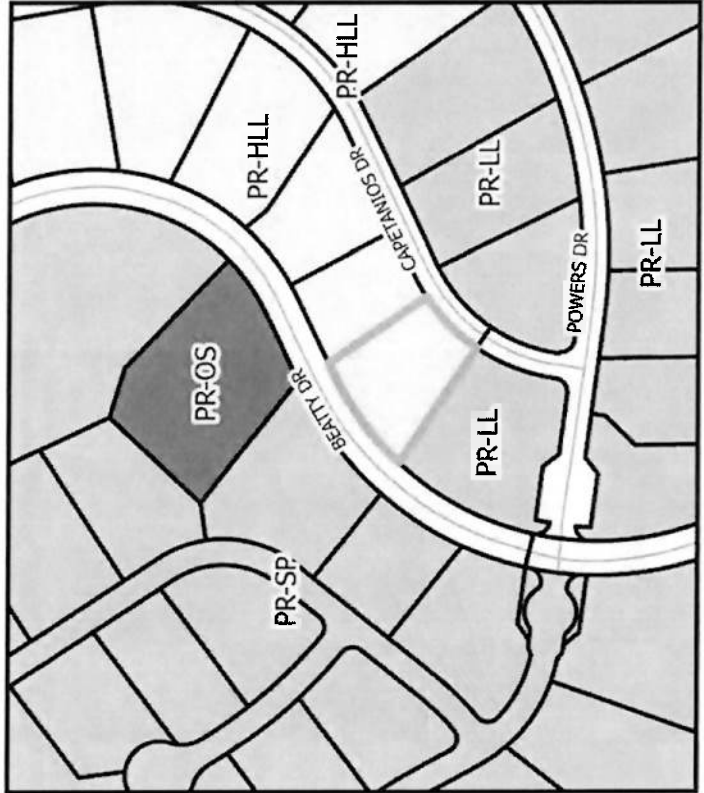

Proposed Zoning Designation:  
Promontory-Large Lot (PR-LL)



## Legend

- Promontory-Hillside Large Lot (PR-HLL)
- Promontory-Large Lot (PR-LL)
- Promontory-Open Space (PR-OS)
- Promontory-Specific Plan (PR-SP)
- APN 124-230-001
- Parcel Lines
- Roads



Map created March 3, 2025.