

US 50-El Dorado Hills Blvd Interchange

Improvements Phase 2B

El Dorado County

**Board of
Supervisors**

May 13, 2025



Agenda

1. Purpose and Need
2. Proposed Improvements
3. Next Steps
4. Schedule
5. Q&A

Project History

- Environmental Impact Report Final Adoption in 2003
- Phase 1 Completed in 2006
- Phase 2A Completed in 2012
- Phase 2B.1 Completed in 2015
- Phase 2B.2 Anticipated Completion in 2028

Purpose & Need

- Remaining component of the phased interchange reconstruction at US 50 / Latrobe Road / El Dorado Hills Blvd
- Enhance the operational efficiency, safety, and capacity of the interchange
- Correct existing deficiencies, accommodate future traffic demands, and improve overall traffic flow and safety within the interchange
- Provide enhanced multi-modal facilities for bicyclists and pedestrians

Proposed Improvements

- Reconstruction and widening of the eastbound loop off-ramp
- Reconstruction and widening of the eastbound diagonal on-ramp to two lanes and adding ramp metering
- Adding an additional lane to northbound El Dorado Hills Blvd
- Improving bicycle and pedestrian facilities
- Additional drainage, water quality treatment, retaining walls, and modifications to the Carson Creek culvert

Eastbound Offramp & Onramp Improvements



Latrobe Road

Realign & Widen EB
Offramp (1 lane)

US50 Westbound

US50 Eastbound

Realign & Widen
EB Onramp
1 to 2 lanes

Latrobe Road & El Dorado Hills Blvd Improvements

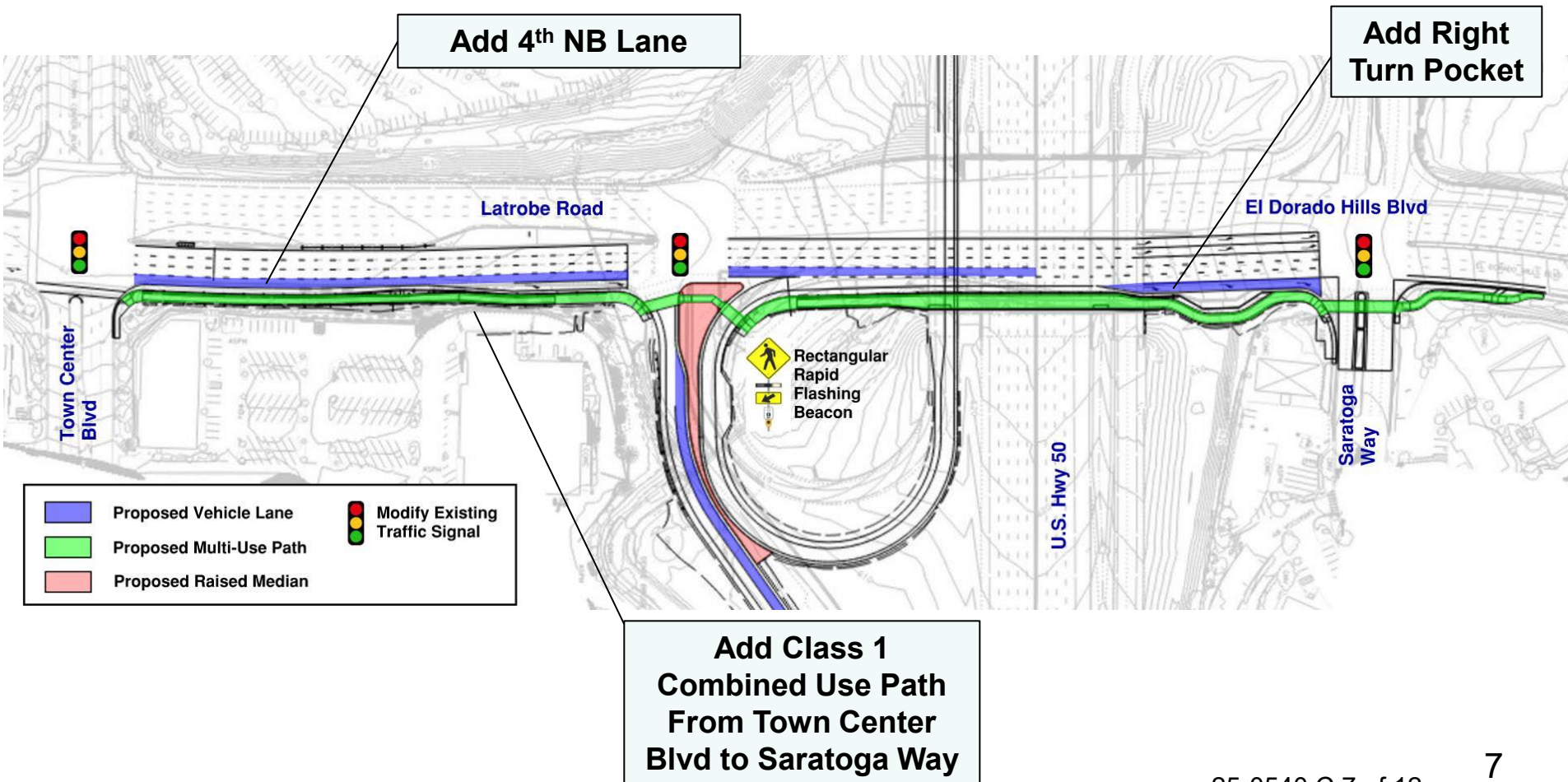

Latrobe Road & El Dorado Hills Blvd Improvements



Type 85 Concrete Barrier

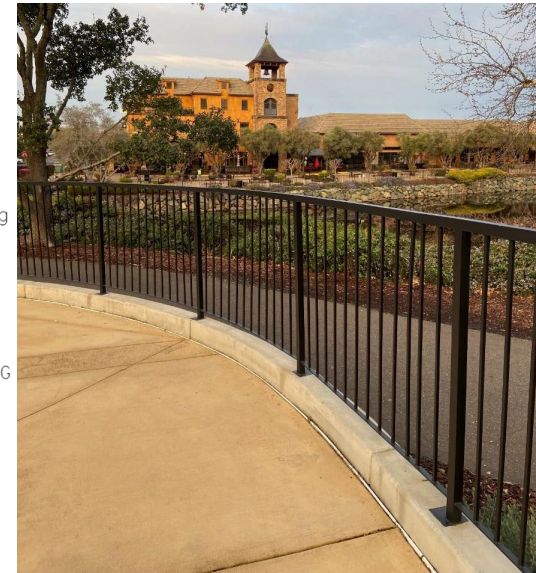
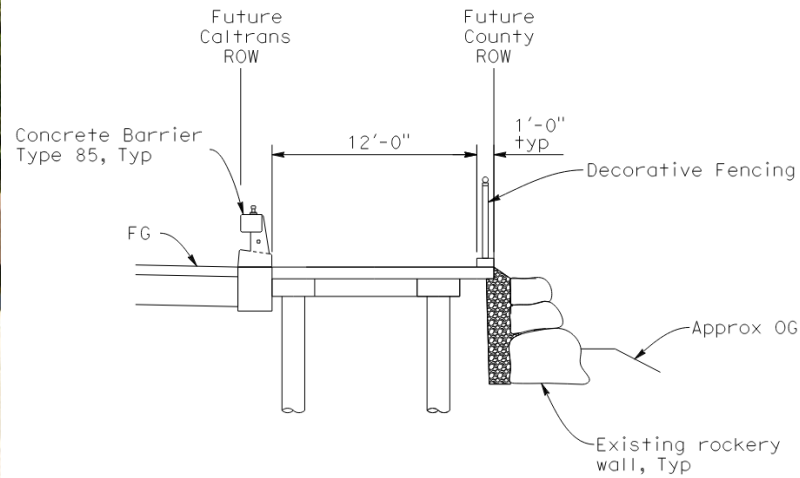

Decorative Fencing

Environmental Technical Studies

- Air Quality Report Addendum
- Hazardous Waste Initial Site Assessment
- Natural Environmental Study Addendum
- Section 106 Tribal Consultation Outreach

Next Steps

Environmental Revalidation

- El Dorado County is CEQA Lead Agency
- EIR Amendment #4 Adoption by County

Engineering Technical Studies

- Drainage & Stormwater Design
- Geotechnical Design
- Retaining Walls
- Traffic Management Plan
- Construction Staging

Schedule

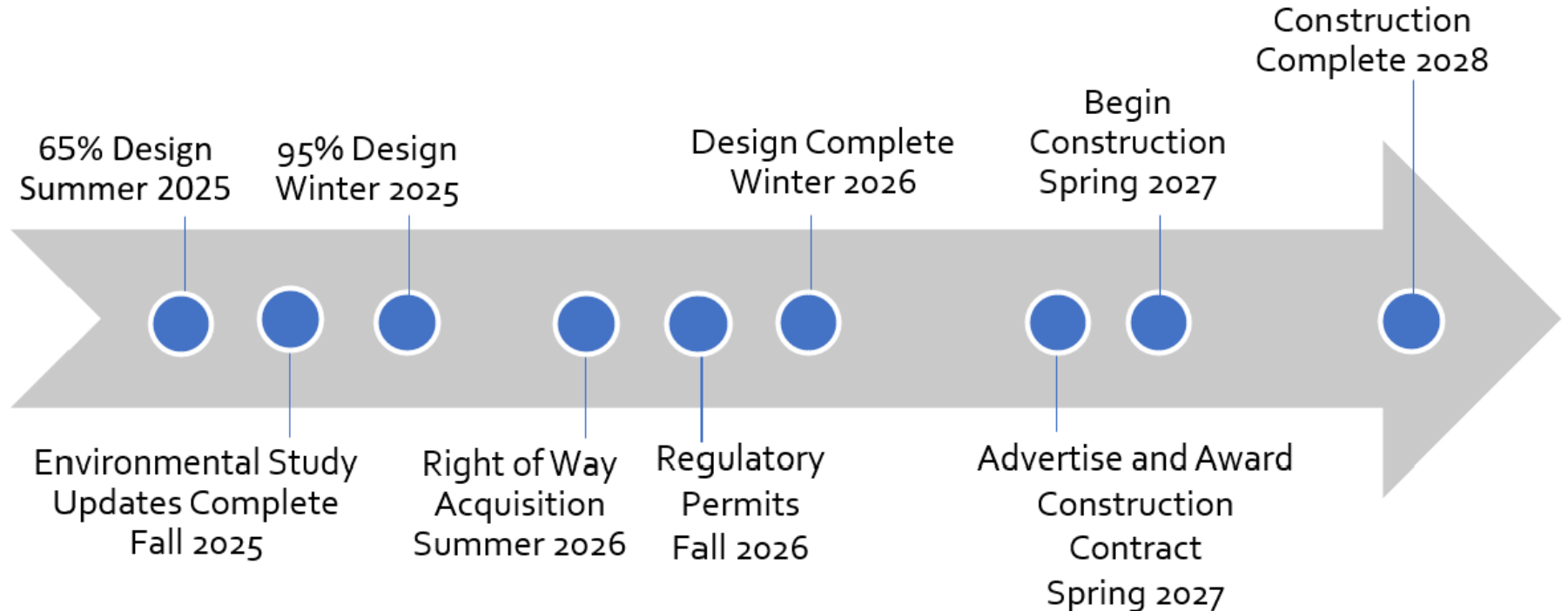

Questions?

Contact Information:

us50eldoradohills2bic@edcgov.us