



NO PARKING SURVEY

CASA LARGO WAY

(No. 645)

From Gailey Circle (No. 643) to Merrychase Drive (No. 334)

Reviewed by the Traffic Advisory Committee on MAY 08 2014

COMMITTEE APPROVED STAFF'S RECOMMENDATION.

COMMITTEE REQUESTED FURTHER ACTION.

Action: APPROVED

DEPARTMENT OF TRANSPORTATION
ENGINEERING AND TRAFFIC SURVEY

Location: Casa Largo Way (No. 645) from Gailey Circle (No. 643) to Merrychase Drive (No. 334)

Subject: No Parking Survey

Date: February 19, 2014

REQUEST REFERENCE:

This study is for Casa Largo Way, from Gailey Circle (No. 643) to Merrychase Drive (No. 334), a length of 0.03 of a mile. It is the scope of this study to determine if parking restrictions are warranted and in the best interest of public safety on Casa Largo Way. This study was undertaken by the Division of Transportation of El Dorado County in response to a petition and written request by Betty Humphreys on behalf of the adjoining Oak Crest Subdivision, requesting “no parking anytime” restrictions on the south side of Casa Largo Way. The parking issues on Casa Largo Way are associated with parents picking up or dropping off students at the adjoining Blue Oak Elementary School.

GENERAL PHYSICAL CONDITIONS:

Casa Largo Way exhibits the following characteristics:

<i>Limits:</i>	<i>Gailey Circle to Merrychase Drive</i>
<i>Functional Classification:</i>	<i>Local Road</i>
<i>Length:</i>	<i>0.03 miles</i>
<i>Width:</i>	<i>26 feet</i>
<i>Frontage Improvements:</i>	<i>rolled curb & gutter, 4 ft. sidewalks</i>
<i>Alignment:</i>	<i>Straight</i>
<i>Grade:</i>	<i>Level</i>
<i>Surface:</i>	<i>Asphalt surface</i>
<i>Striping:</i>	<i>none</i>

Casa Largo Way is in good condition and is classified as a local road by the Federal Highway Administration (FHWA), as depicted by the California Road System (CRS) maps. Casa Largo Way is a two (2) lane undivided road with an overall width of 26 feet with four (4) foot wide sidewalks on both sides of the roadway. Casa Largo Way is controlled by “STOP” Sign, Stop bar, legend, lane line, and school crosswalk at the Merrychase Drive intersection. No stop sign or associated striping exists at the Gailey Circle intersection.

The alignment of Casa Largo Way is level with no horizontal curves along its length. No pavement markings are present along the remaining portion of Casa Largo Way. Although residential homes do exist along this portion of Casa Largo Way, no residential homes fronts and access Casa Largo Way.

RECORD DATA:

Although no traffic count data was available on Casa Largo Way, the average daily traffic (ADT) volume counts on Casa Largo Way can be estimated to be 500 vehicles per day. Merrychase Drive yielded an average daily traffic (ADT) count of 1,592 ADT in the year 2012 (see attached).

A review of the accident data provided by the California Highway Patrol for a three (3) year period from January 1, 2011, through December 31, 2013, disclosed that no accidents were reported along the entire portion of Casa Largo Way (see attached).

The *California Vehicle Code*, Section 22507, states in part:

“Local Regulations: Local authorities may, by ordinance or resolution, prohibit or restrict the stopping, parking, or standing of vehicles, including, but not limited to, vehicles that are six feet or more in height (including any load thereon) within 100 feet of any intersection, on certain streets or highways, or portions thereof, during all or certain hours of the day.”

Section 21458 (a) of The *California Vehicle Code* states:

“Curb Markings: Whenever local authorities enact local parking regulations and indicate them by the use of paint upon curbs, the following colors only shall be used, and the colors indicate as follows: (1) Red indicates no stopping, standing, or parking, whether the vehicle is attended or unattended, except that a bus may stop in a red zone marked or signposted as a bus loading zone.”

El Dorado County Resolution No. 252-81 (attached) establishes “No Parking” zones pursuant to Section 10.12.010 of the El Dorado County Ordinance Code.

El Dorado County Ordinance Code Section 10.12.010 states:

“When properly posted, it is unlawful for any person to park or leave standing any vehicle, whether attended or unattended, within any portion of the right-of-way of any county road or bridge as established by resolution of the board of supervisors.”

The *California Vehicle Code*, Section 22500, states in part:

“For Prohibited Stopping, Standing, or Parking: No person shall stop, park, or leave standing any vehicle whether attended or unattended, except when necessary to avoid conflict with other traffic or in compliance with the directions of a peace officer or official traffic control device, in any of the

following places:

(g) Alongside or opposite any street or highway excavation or obstruction when stopping, standing, or parking would obstruct traffic.

(i) Except as provided under Section 22500.5, alongside curb space authorized for the loading and unloading of passengers of a bus engaged as a common carrier in local transportation when indicated by a sign or red paint on the curb erected or painted by local authorities pursuant to an ordinance.”

In Section 627 the Vehicle Code provides a definition for “Engineering and Traffic Survey”, and states that an “Engineering and Traffic Survey” shall include:

1. Prevailing speeds as determined by traffic engineering measurements.
2. Accident records.
3. Highway, traffic, and roadside conditions not readily apparent to the driver.

In addition, the 2003 edition of the Vehicle Code added that residential density, and pedestrian and bicycle safety may be considered.

In defining a “Residence District”, Section 515 of the *California Vehicle Code* states:

“A “Residence District” is that portion of a highway and the property contiguous thereto, other than a business district, (a) upon one side of which highway, within a distance of a quarter of a mile, the contiguous property fronting thereon is occupied by 13 or more separate dwelling houses or business structures, or (b) upon both sides of which highway, collectively, within a distance of a quarter of a mile, the contiguous property fronting thereon is occupied by 16 or more separate dwelling houses or business structures. A residence district may be longer than one-quarter of a mile if the above ratio of separate dwelling houses or business structures to the length of the highway exists.”

Casa Largo Way does not meet the minimum housing density requirements necessary to qualify for a 25 mile per hour *Prime Facie* “Residence District” requirements.

FIELD REVIEW AND OBSERVATION:

Casa Largo Way is a local subdivision roadway that terminates at an “ALL WAY STOP” at the Merrychase Drive intersection, which adjoins the main access to the Blue Oak Elementary School. Two (2) school crosswalks exist at the Merrychase/Casa Largo Way intersection; one (1) crossing Casa Largo Way and the other crossing Merrychase Drive, on the northern side of this intersection (see following exhibit). Casa Largo Way has an overall width of 26 feet. Prior to and after school, parents park along both sides of Casa Largo Way to pick up or drop off children at school. As a result, with vehicles parked on both sides of the roadway, Casa Largo Way is reduced to an average roadway width of 10 feet and functions as a one (1) lane roadway.

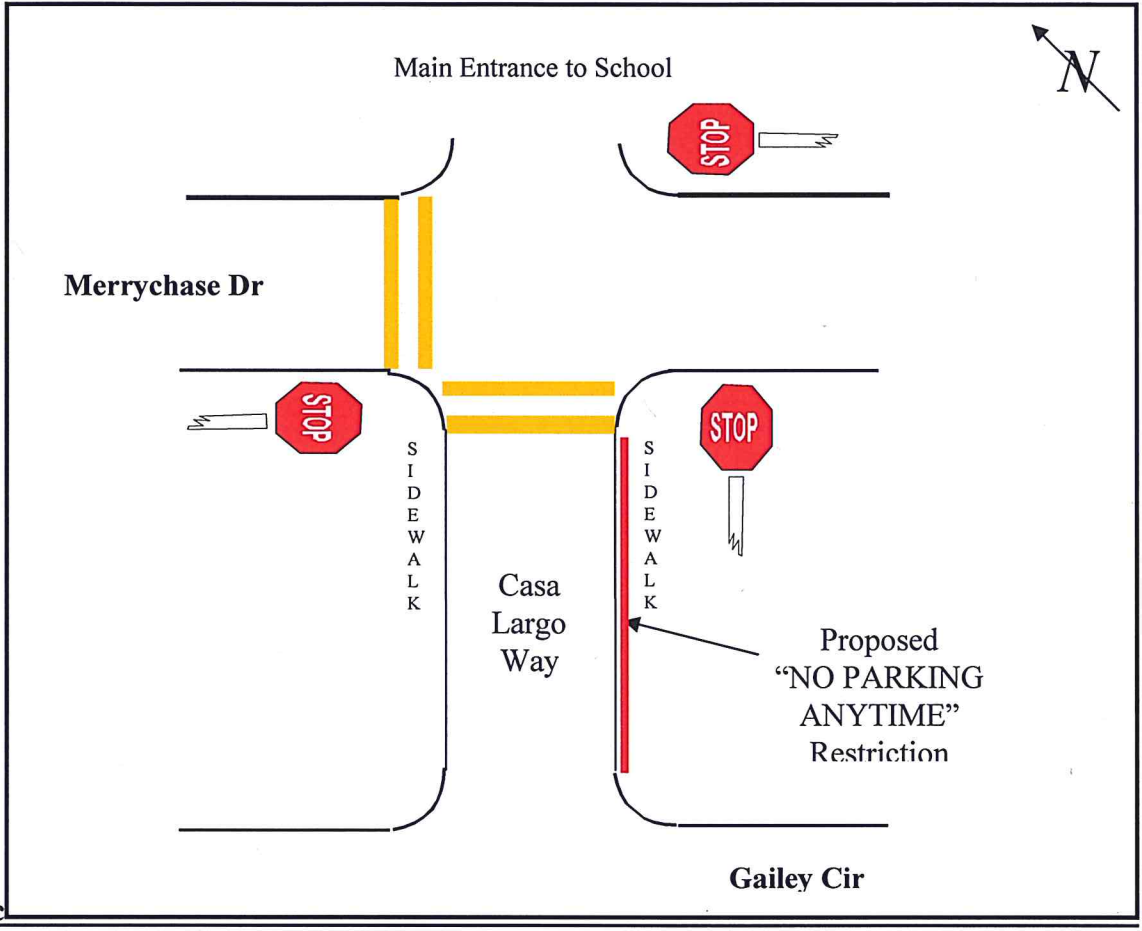

Both the Cameron Park Fire Department and the Blue Oak Elementary School Administration is in support of the requested parking restriction on Casa Largo Way (see attached emails).

CONTACTS:

Betty Humphreys and Kristen Wiederhold of the Oak Crest Homeowners Association, David Wood of the Cameron Park Fire Department, and Paul Stewart of the Blue Oak Elementary School.

FINDINGS AND CONCLUSIONS:

FINDINGS

Casa Largo Way has been found to have the following:

- Overall road width of 26 feet with four (4) foot wide sidewalks
- The estimated average daily traffic volume is 500 vehicles per day
- Roadway is straight, level, and 0.03 of a mile in length
- There were no accidents reported along Casa Largo Way for the three (3) year period from January, 2011, through December, 2013

Crosswalks are present crossing Casa Largo Way as well as the northern side of Merrychase Drive at this intersection. Prior to and after School, parents park along both sides of Casa Largo Way to drop off or pick up children at school. As a result, with vehicles parked on both sides of the roadway, Casa Largo Way is reduced to an average drivable roadway width of 10 feet and functions as a one (1) lane roadway. Restricting parking on one (1) side of Casa Largo Way will help balance the need for parking adjoining the school in addition to maintaining the function of Casa Largo Way as a two (2) lane roadway. Roadside parking would be best suited on the north side of Casa Largo Way, which coincides with the northern crosswalk on Merrychase Drive (see prior exhibit). The representatives of the petitioners of the Oak Crest Subdivision were notified that if the parking restriction on Casa Largo Way was approved and installed, it would result in additional roadside parking on Gailey Circle. The Oak Crest Subdivision representatives did not express any concern of the potential additional roadside parking on Gailey Circle as a result of the proposed parking restriction on Casa Largo Way. Furthermore, no parking zones at driveways that exist along Gailey Circle will prevent a similar roadway narrowing condition that exists on Casa Largo Way.

CONCLUSIONS

Restricting parking on the south side of Casa Largo Way will help maintain the function of Casa Largo Way as a two (2) lane roadway prior to and after school. The Oak Crest Subdivision representatives did not express any concern of the potential additional roadside parking on Gailey Circle as a result of the proposed parking restriction on Casa Largo Way.

RECOMMENDATIONS:

1. That the Traffic Advisory Committee approves the request for the installation of “No Parking Anytime” signs and red curbing on the entire southern side of Casa Largo Way.”
2. That the Board of Supervisors be requested to adopt a Resolution, pursuant to Section 10.12.010, of the El Dorado County Ordinance Code, to sanction the installation of the “No Parking Anytime” signs on the southern side of Casa Largo Way from mile post 0.00 to 0.03:

BE IT RESOLVED that Resolution No. 252-81, which establishes “No Parking” zones pursuant to Section 10.12.010 of the El Dorado County Ordinance Code, is amended as follows:

ADD:

() “No Parking Any Time” along the entire length of Casa Largo Way on the south side of the roadway, milpost 0.00 to 0.03.

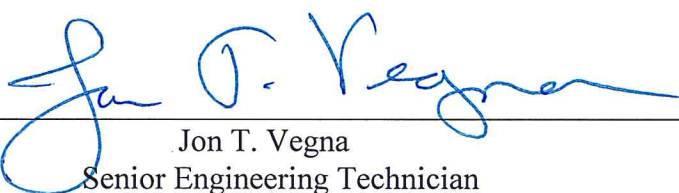
Prepared by: 
Jon T. Vegna
Senior Engineering Technician

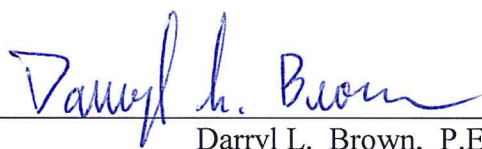
Approved By:  On 2/24/14
Darryl L. Brown, P.E.
Traffic Superintendent
Date

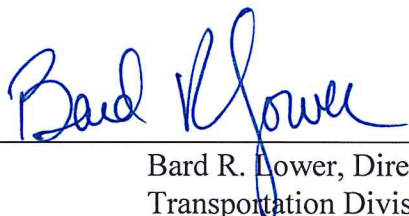
Approved By:  On 4/4/14
Bard R. Lower, Director
Transportation Division
Community Development Agency
Date

- Attachments:
- Vicinity Map (1)
 - Vicinity Photos (4)
 - County Resolution 252-81 (2)
 - Oak Crest Subdivision Petition (6)
 - Cameron Park Fire Department Email (1)
 - Blue Oak Elementary School Email (1)
 - Sign Inventory (1)
 - Traffic Count (1)
 - Accident Summary (1)



Caso Largo Subway Vicinity Map

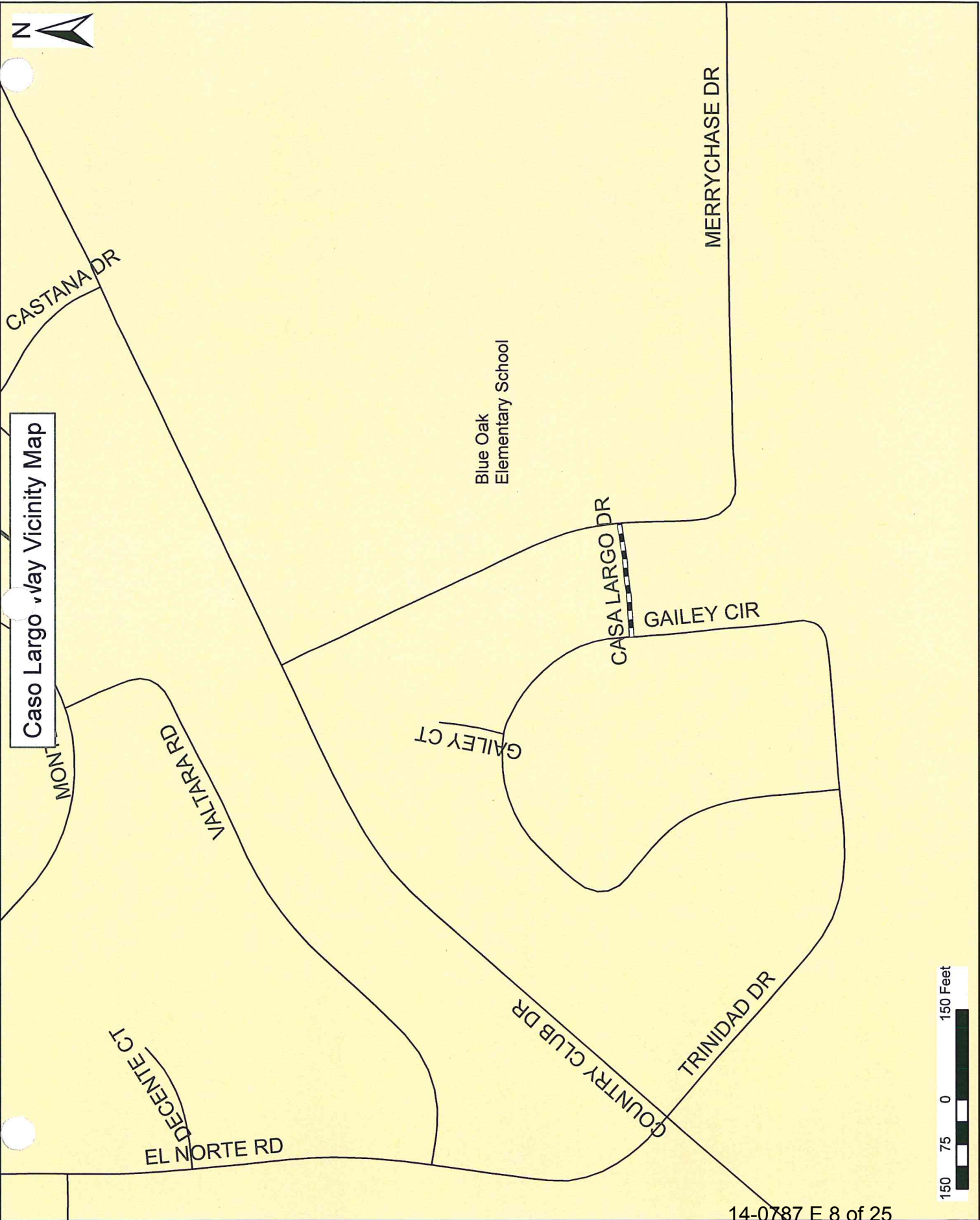

Blue Oak Elementary School



CASA LARGO WAY AT MERRILL CHASE DRIVE INTERSECTION



CASA LANGO WAY



CASA LANGO WAY



GAILEY CIRCLE AT CASA LARGO WAY





RESOLUTION No. 252-81

OF THE BOARD OF SUPERVISORS OF THE COUNTY OF EL DORADO

WHEREAS, El Dorado County Ordinance Code Section 7631 authorizes the Board of Supervisors to establish parking prohibited zones by resolution,

NOW, THEREFORE, BE IT RESOLVED that parking prohibited zones are established as follows:

- (a) deleted by ordinance number 1783, dated April 26, 1977.
- (b) deleted by ordinance number 1783, dated April 26, 1977.
- (c) deleted by ordinance number 1783, dated April 26, 1977.
- (d) deleted by ordinance number 1783, dated April 26, 1977.
- (e) Upon either side of those portions of County Highway No. 147 (Icehouse Road) and County Highway No. 167 (Peavine Ridge Road) within one-fourth mile of the intersection of said county highways.
- (f) deleted by ordinance number 1783, dated April 26, 1977.
- (g) Upon either side of the main street of the Townsite of El Dorado between its intersection with State Highway Route No. 65 (Sign Route 49) and its intersection with County Highway No. 1861 (unnamed street) except wholly within the white lines designating parking spaces painted upon the road surface.
- (h) Upon either side of the alley in the Townsite of El Dorado from its intersection with the main street of El Dorado, approximately 75 feet easterly of the intersection of Main and Church Streets to a line 100 feet northerly of and parallel to the center of said Main Street, except wholly within the white lines designating parking spaces painted upon the road surface.
- (i) Upon either side of Church Street, Missouri Street and Hinman Alley from their intersection with the main street in the Townsite of El Dorado, to a line 100 feet distant and parallel to the center of said main street.
- (j) deleted by ordinance number 1783, dated April 26, 1977.
- (k) deleted by ordinance number 1783, dated April 26, 1977.
- (l) Upon either side of Ponderosa Road adjacent to the Ponderosa High School property between the hours of 8:00 a.m. and 4:00 p.m., excluding Saturdays, Sundays and holidays.
- (m) Upon either side of Bacchi Road running the entire length thereof.
- (n) Upon either side of Lillyama Road running the entire length thereof.
- (o) Upon either side of Pedro Hill Road running the entire length thereof.
- (p) Upon either side of Salmon Falls Road from State Route 49 to a point one mile south thereof.
- (q) Upon either side of Rattlesnake Bar Road from State Route 49 West to Pilot Creek.

RESOLUTION No. 252-81

(r) Upon any portion of State Highway 49 directly in front of the United States Post Office located at Diamond Springs, Calif.

(s) Upon either side of Echo Summit Road (County Road No. 116) from the upper parking lot to Echo Lake, a distance of approximately 1,000 feet, except within the white lines designating parking spaces or on the shoulder side outside of white lines designating the edge of the roadway. (Ordinance No. 1905, 8/8/78)

(t) Upon the entire length of the Easterly side of Remington Street, South Lake Tahoe. (9/5/78, Ord. No. 1917)

(u) Upon that portion of Tam O'Shanter Drive lying between Unit No. 4 and Unit No. 2 of St. Andrew's Village subdivision between the hours of 2:00 o'clock a.m. and 6:00 o'clock a.m. daily. (Ord. No. 1982)

(v) Upon either side of Fir Street (No. 1601) between State Highway 50 and Margaret Drive. (Ord. No. 2049, 1/8/80)

(w) Upon the easterly side of Missouri Flat Road from the intersection with Headington Road to a point 100 feet north. (Ord. No. 2057)

(x) Upon the northerly side of Green Valley Road from a point 235 feet west of the entrance to Browns Ravine to a point 150 feet east of said entrance. (Ord. No. 2096, 6/3/80)

PASSED AND ADOPTED by the Board of Supervisors of the County of El Dorado at a regular meeting of said Board, held on the 18th day of August, 1981, by the following vote of said Board:

Ayes: Supervisor ROBERT E. DORR, PATRICIA R. LOWE, W. P. WALKER, JOSEPH V. FLYNN

Nays: None

Absent: THOMAS L. STEWART

ATTEST;
DOLORES BREDESON, County Clerk and ex-officio
Clerk of the Board of Supervisors
By *[Signature]*
Deputy Clerk

[Signature]
Chairman, Board of Supervisors

DATE	COPIES SENT TO
8/18/81	County Council
"	ATP

RECEIVED

OCT 22 2013

EL DORADO COUNTY
DEPT. OF TREASURY & FINANCE
MANT. & OPERATIONS

Oct. 21, 2013

Deputy Director Don Spear

2441 Headington Rd.

Placerville, Ca. 95667

Linda and Dennis Daniels, and I have worked on getting this petition signed by our neighbors asking for the "no parking on CASA LARGO WAY". The entire neighborhood is anxiously awaiting the resolution of this matter. We would appreciate hearing from you.

Sincerely,

Betty Humphreys



4240 Gailey Circle

Cameron Park, Ca. 95682

(530) 672-9356

Oak Crest Neighborhood Petition

The issue: Parking congestion on Casa Largo related to Blue Oaks School. Parking on both sides of the street reduces the traffic lane down to one car and sometimes no cars if people (small children) are exiting on the street side of the vehicle.



Proposed Solution: Make the south side of Casa Largo a “NO PARKING ANYTIME” zone. The south side is suggested since the school cross walk is on the north side of the intersection. The “Anytime” is because the problem is not just during pick up and drop off times, but during any school function i.e. parent nights, sporting events etc.

The attached map indicated the area of proposed restriction.

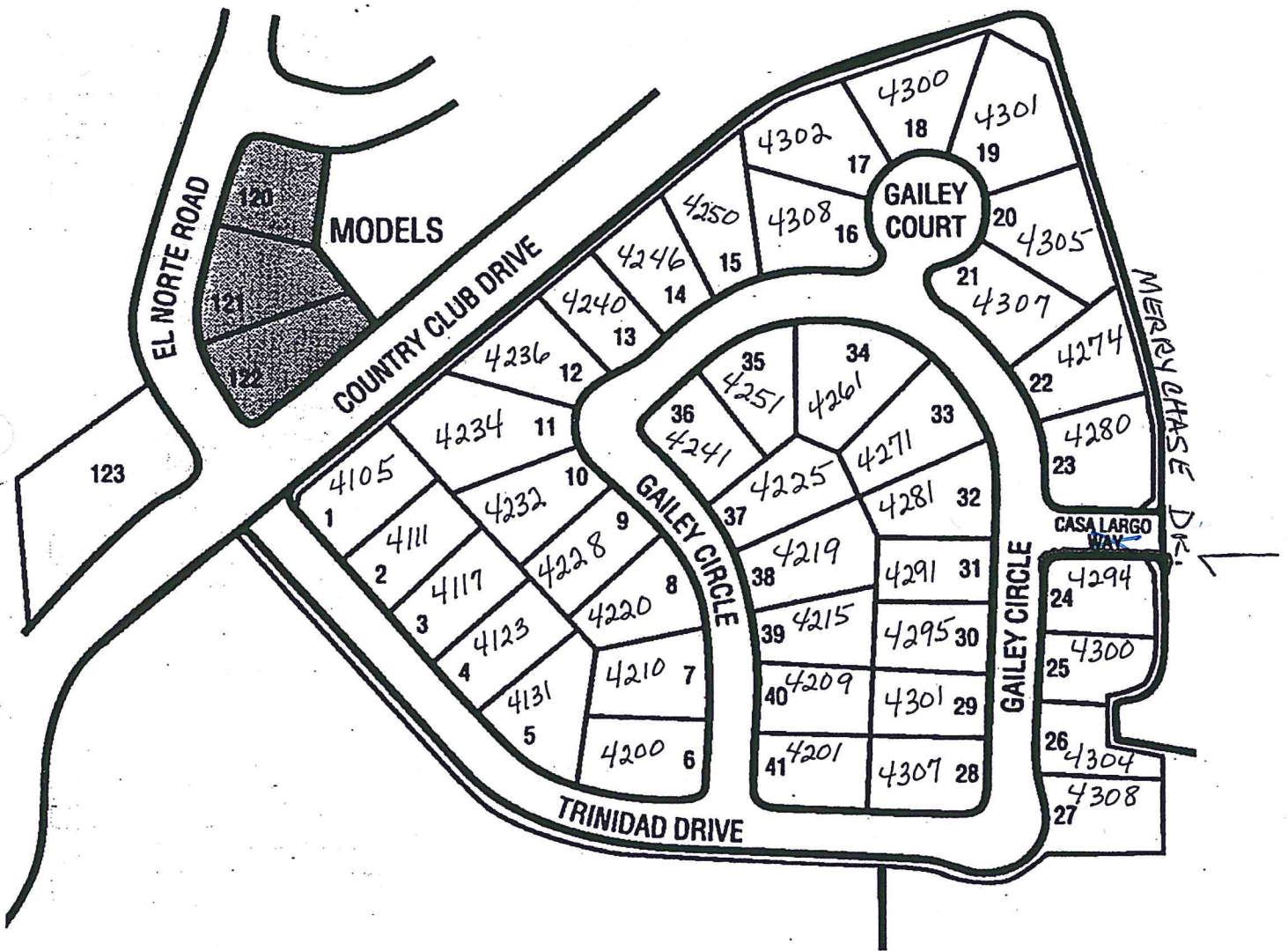
Neighborhood Map :

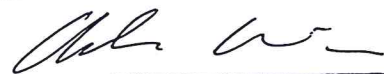
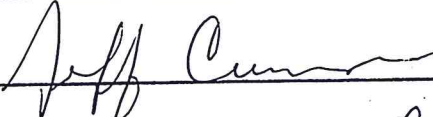
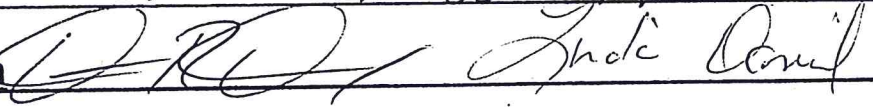
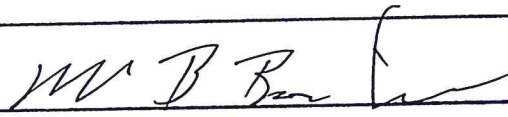
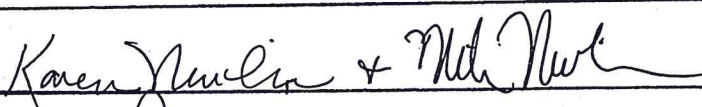
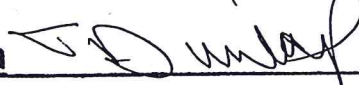

A Petition for 'NO PARKING' on Casa Largo Way from the residences on Gailey Circle, Gailey Court, and Trinidad Drive

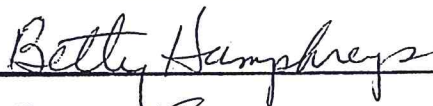
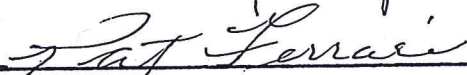
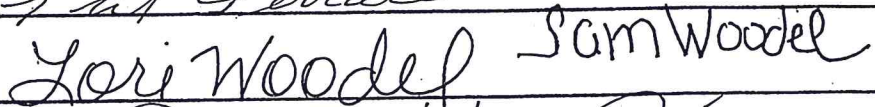
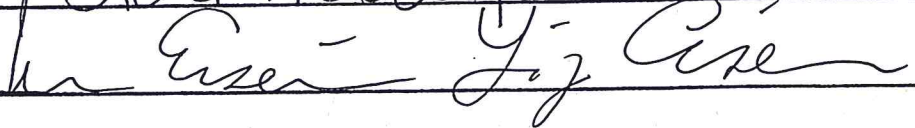
addresses & names on Gailey Cir.	signatures
4200	
4201 Bob Summers	
4209 Adam Wilson	
4210 Christy Cummins	
4215 Deanne Rollins & Marc Rollins	
4219 Daniel, Dennis & Linda	
4220 Kim Zuput	
4225 Marvin Bockie	
4228	
4232 Newlin, Mike & Karen	
4234 Dunlap, Tina	
4236 Radov, Susan	
4240 Humphreys, Betty & Lori	
4241 Ferrari, Bill & Pat	
4246 Woodel, Sam Woodel, Lori	
4250 Eisen, Len & Liz	

addresses & names on Gailey Cir.

4251 ~~Mrs~~ Deborah M. Rupp

4261 Cheryl Bialak

4271

4274 Humphreys Toni & Michelle ^{Toni Humphreys} ^{Michelle Humphreys}

4280 Emmons Kathleen ^{K. Emmons}

4281 David & Marlene Rhoads

4291 Anka Amos

4294 Brittany Fox Potos

4295 FRANK & BRANDI SPANGLER

4300

4301 JASON HOLLEY

4304 ^{David So} DAVID SO ^{Reiko Murrey So} REIKO MURREY SO

4307

4308 Barbara Brummel & Richard Brummel

addresses & names on Gailey Court signatures

4300 Brosseau, Pete & Anitra ^{Pete Brosseau}

4301

4302 Duane + Thea Countryman

4305 Carlos Wessenberg

4307 Shell, Ernie & Sylvia

Sylvia J Shell East P Shell

4308 Branaa, Jean-Renee' & Debbie

[Handwritten signature]

addresses & names on Trinidad Drive

signatures

4105

4111

4117

Mark Rowe

4123 Gray, Bruce &

Bruce Gray

4131



Jon Vegna <jon.vegna@edcgov.us>

Red Curb

1 message

Wood, Dave@CALFIRE <Dave.Wood@fire.ca.gov>
To: "jon.vegna@edcgov.us" <jon.vegna@edcgov.us>

Thu, Feb 13, 2014 at 11:59 AM

Mr. Vegna,

The Cameron Park Fire Department supports the outcome of your departments traffic study to add a "No Parking Fire Lane" red curb to one side of Casa Largo Way from Merrychase to Gailey Circle.

Please let me know if you have any further questions.

Thanks!

David Wood
Battalion Chief - B2716

CAL FIRE

Amador-El Dorado Unit
proudly serving the
Cameron Park Fire Department
(530) 708-2716 (cell)
www.fire.ca.gov



Jon Vegna <jon.vegna@edcgov.us>

Casa Largo

1 message

Paul Stewart <pstewart@buckeyeusd.org>

Thu, Feb 13, 2014 at 11:43 AM

To: Jon Vegna <jon.vegna@edcgov.us>

We support the Oak Crest neighborhood petition for driver and student safety, in regards to no parking on the south side of Casa Largo Drive.

Please let me know if you have any questions.

Paul Stewart
Principal
Blue Oak Elementary

Blue Oak's Vision: "Blue Oak will be a school where all children will be engaged in learning, all the time."



Sign Inventory for: CASA LARGO WY

20-Feb-14

Beginning at Mile Post- 0.0

and Ending at Mile Post- 0.03

Old Sign Code	2010 CA Sign Code	Location	Dir	Cross Street	Mile Post	Side	Fac	Date
SN	SN (E)	15 ft	N of	MERRYCHASE DR	0.000	NW	A	12/18/1995
R1	R1-1	15 ft	S of	MERRYCHASE DR	0.000	SW	W	2/3/2012
R1-4	R1-4	20 ft	W of	MERRYCHASE DR	0.000	SW	W	2/10/2012
	S1-1	100 ft	W of	MERRYCHASE DR	0.020	S	W	5/7/2013
	S4-3P	100 ft	W of	MERRYCHASE DR	0.020	S	W	5/7/2013

**EL DORADO COUNTY
DEPARTMENT OF TRANSPORTATION**

Count Summary Beginning: November 27, 2012

Count Station:	1100334	Counter ID:	61
City/Town:	Cameron Park	Mile Post:	0.62
Road Name:	Merrychase Dr	Location:	100 yds S of Country Club Dr
Lanes:	2	Direction:	Combined

Date	2	3	27	28	29	30	1	Weekly	Wk Day
Day Time	Sun	Mon	Tue	Wed	Thu	Fri	Sat	Average	Avg.
100	6	2	4	6	0	1	3	3	3
200	5	1	0	1	1	3	3	2	1
300	3	2	1	2	0	0	1	1	1
400	0	5	2	1	2	1	1	2	2
500	2	1	7	5	1	4	3	3	4
600	2	7	6	8	6	12	1	6	8
700	8	36	30	26	25	37	7	24	31
800	45	351	382	364	387	384	16	276	374
900	48	105	101	76	73	87	26	74	88
1000	76	59	65	56	50	70	59	62	60
1100	89	67	68	121	54	63	78	77	75
1200	76	121	175	55	122	162	113	118	127
1300	70	34	49	96	56	67	58	61	60
1400	30	97	80	229	113	112	70	104	126
1500	34	257	51	78	277	289	30	145	190
1600	27	106	116	75	120	78	34	79	99
1700	40	124	117	79	104	81	39	83	101
1800	49	99	125	68	80	65	41	75	87
1900	43	48	91	61	65	33	38	54	60
2000	34	39	45	24	29	26	15	30	33
2100	17	31	60	28	52	16	11	31	37
2200	11	16	8	33	13	8	9	14	16
2300	3	5	6	6	8	10	2	6	7
2400	1	1	1	2	2	5	6	3	2
Totals	719	1614	1590	1500	1640	1614	664	1334	1592
AM Peak Hr	11:00	8:00	8:00	8:00	8:00	8:00	12:00	8:00	8:00
AM Count	89	351	382	364	387	384	113	276	374
PM Peak Hr	1:00	3:00	6:00	2:00	3:00	3:00	2:00	3:00	3:00
PM Count	70	257	125	229	277	289	70	145	190

TOTAL ADT: 1,592

**EL DORADO COUNTY
DEPARTMENT OF TRANSPORTATION
ACCIDENT SITE ANALYSIS SUMMARY FOR**

***Casa Largo Dr*
Entire Length, Gailey Circle to Merrychase Drive**

Report Date: 2/13/2014

For the period beginning January 1, 2011 and ending December 31, 2013

	Beginning at Mile Post 0.00	and Ending at Mile Post 0.03		Roadway Section Length = 0.03	
2011	Number of Accidents:	0	Number of Injuries:	0	Number of Fatalities: 0
2012	Number of Accidents:	0	Number of Injuries:	0	Number of Fatalities: 0
2013	Number of Accidents:	0	Number of Injuries:	0	Number of Fatalities: 0
Accident Total = 0		Injury Total = 0		Fatality Total = 0	