

**INDEX OF SHEETS**

SHEET	PLAN SHEET	TITLE
1		TITLE SHEET
2	CD-1	SURVEY CONTROL DIAGRAM
3	X-1	TYPICAL SECTIONS
4-8	L-1 thru L-5	PLAN & PROFILE
9-16	C-1 thru C-8	CONSTRUCTION DETAILS
17-24	D-1 thru D-8	DRAINAGE SYSTEMS & QUANTITIES
25-27	U-1 thru U-3	UTILITY PLANS
28-31	SC-1 thru SC-4	STAGE CONSTRUCTION & SIGNING
32-33	EC-1 thru EC-2	EROSION CONTROL PLAN

STATE OF CALIFORNIA  
**DEPARTMENT OF TRANSPORTATION**  
**PROJECT PLANS FOR CONSTRUCTION ON**  
**STATE HIGHWAY 193**

IN THE COUNTY OF EL DORADO, DISTRICT 4, COOL, CA  
 SR49/SR193 INTERSECTION TO AMERICAN RIVER TRAIL

To be supplemented with Standard Plans and Specifications 2010, including the Revised Standard Specifications 2010, of the California Department of Transportation, unless otherwise noted and the El Dorado County Design and Improvement Standards Manual, as noted.

DIST	COUNTY	ROUTE	POST MILES	TOTAL PROJECT	SHEET NO.	TOTAL SHEETS
03	ED	SR193	0.0 to 0.84	0.84	1	33

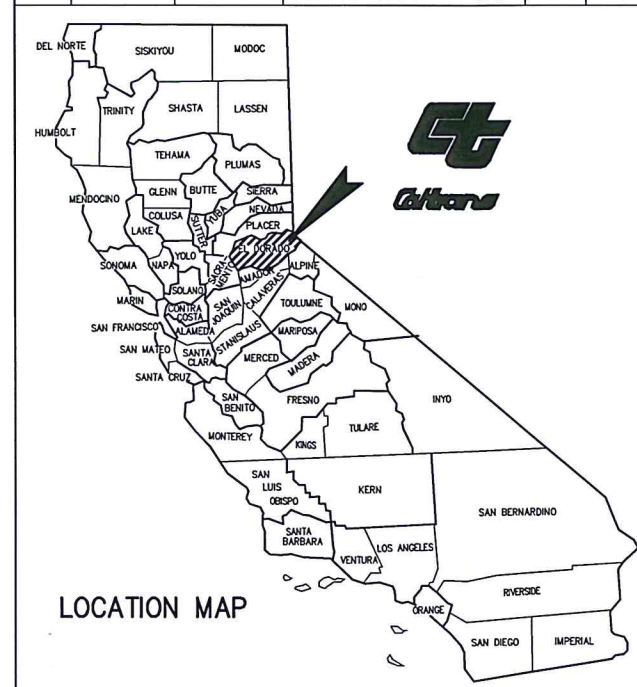

The state of California or its officers or agents shall not be responsible for the accuracy or completeness of electronic copies of this plan sheet

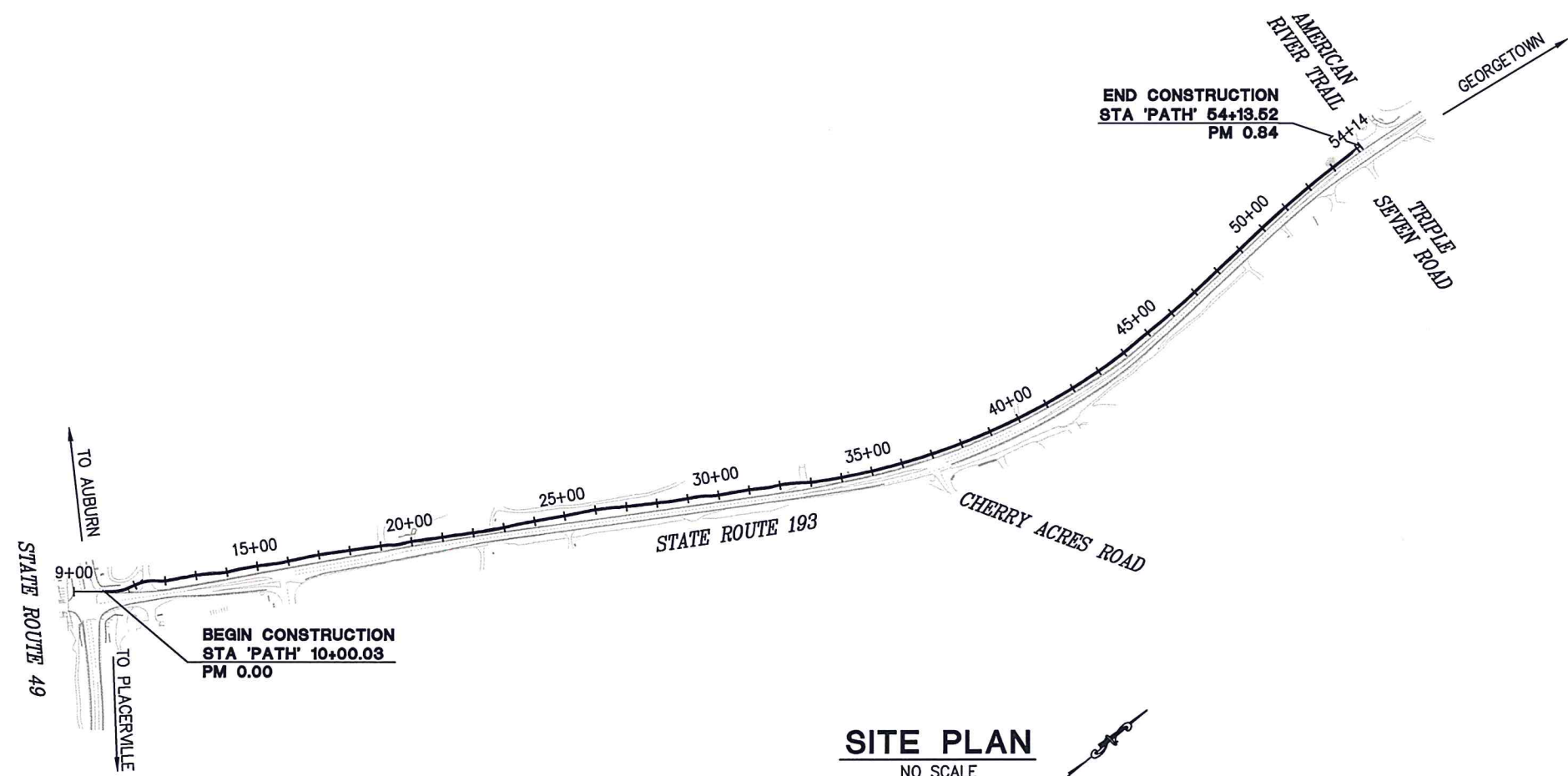
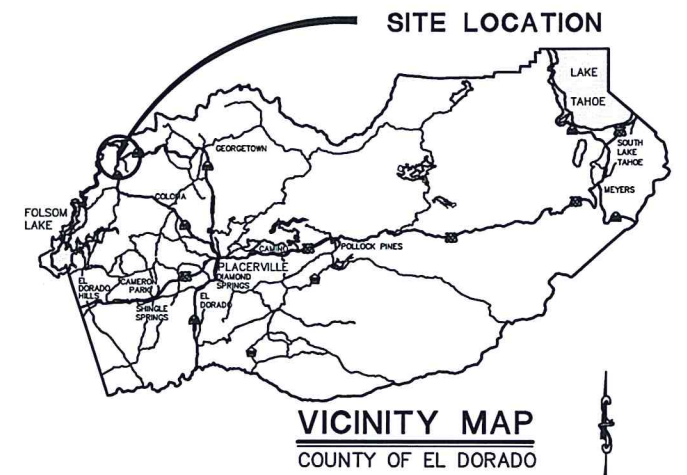

**SITE PLAN**  
NO SCALE

Approved as to impact on State facilities and conformance with applicable State Standards and Practices and that technical oversight was performed as described in the California Department of Transportation A&E Consultant Services Manual.

PROJECT ENGINEER: PAUL HOM; DESIGN OVERSIGHT APPROVAL: [Signature]; REGISTRATION NO. C-22005; DATE: 06/06/13

*Paul J. Hom*  
 Project ENGINEER  
 Registered Civil Engineer



05/08/13  
 Plans Approved Date

FED. PROJECT	SRTSL 5925(070)
PW# 11-30628	CU _____ EA 03-2E4801

ADOPTED AND APPROVED BY: [Signature] 1-2-14  
 RON V. BRIGGS  
 CHAIR, EL DORADO COUNTY BOARD OF SUPERVISORS  
 Board date 5-21-13 DATE

APPROVED BY: [Signature] 1/2/14  
 KIMBERLY A. KERR  
 INTERIM DIRECTOR, EL DORADO COUNTY DEPARTMENT OF TRANSPORTATION  
 DATE

[Signature] 12/31/13  
 MATTHEW D. SMELTZER P.E. NO. C56832  
 DEPUTY DIRECTOR OF ENGINEERING, EL DORADO COUNTY DEPARTMENT OF TRANSPORTATION  
 DATE

**COUNTY OF EL DORADO**  
**DEPARTMENT OF TRANSPORTATION**

2850 FAIRLANE COURT  
 PLACERVILLE, CA 95667  
 (916) 621-5900



REVISIONS		
MARK	DATE	BY

BOARD OF SUPERVISORS	
RON MIKULACO	I
RAYMOND J. NUTTING	II
BRIAN VEERKAMP	III
RON V. BRIGGS	IV
NORMA SANTIAGO	V

**NORTHSIDE SCHOOL CLASS 1**  
**BIKE PATH - PHASE 1 (SR193)**

**TITLE SHEET**

SHEET 1 OF 33



**INDEX OF SHEETS**

SHEET	PLAN SHEET	TITLE
1		TITLE SHEET
2	CD-1	SURVEY CONTROL DIAGRAM
3	X-1	TYPICAL SECTIONS
4-8	L-1 thru L-5	PLAN & PROFILE
9-17	C-1 thru C-9	CONSTRUCTION DETAILS
18-25	D-INDEX thru D-7	DRAINAGE SYSTEM AND QUANTITIES
26-29	SC-1 thru SC-4	STAGE CONSTRUCTION
30-31	EC-1 thru EC-2	EROSION CONTROL
32-35	S-1 thru S-4	STRUCTURAL PLANS

STATE OF CALIFORNIA  
DEPARTMENT OF TRANSPORTATION  
**PROJECT PLANS FOR CONSTRUCTION ON  
STATE HIGHWAY 49**

IN THE COUNTY OF EL DORADO, DISTRICT 4, COOL, CA  
CAVE VALLEY ROAD TO SR49/SR193 INTERSECTION

To be supplemented with Standard Plans and Specifications 2010, including the Revised Standard Specifications 2010, of the California Department of Transportation, unless otherwise noted and the El Dorado County Design and Improvement Standards Manual, as noted.

DIST	COUNTY	ROUTE	POST MILES	TOTAL PROJECT	SHEET NO.	TOTAL SHEETS
03	ED	SR49	34.4 to 35.4	1	1	35

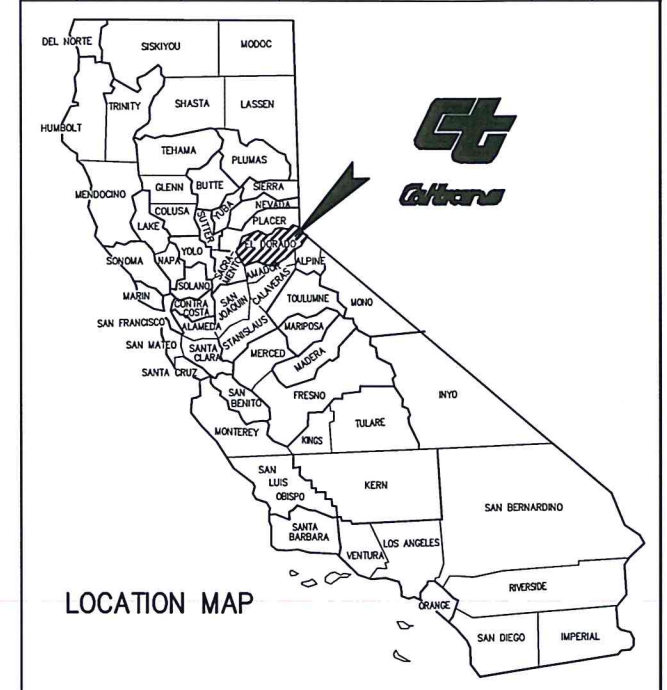

The state of California or its officers or agents shall not be responsible for the accuracy or completeness of electronic copies of this plan sheet

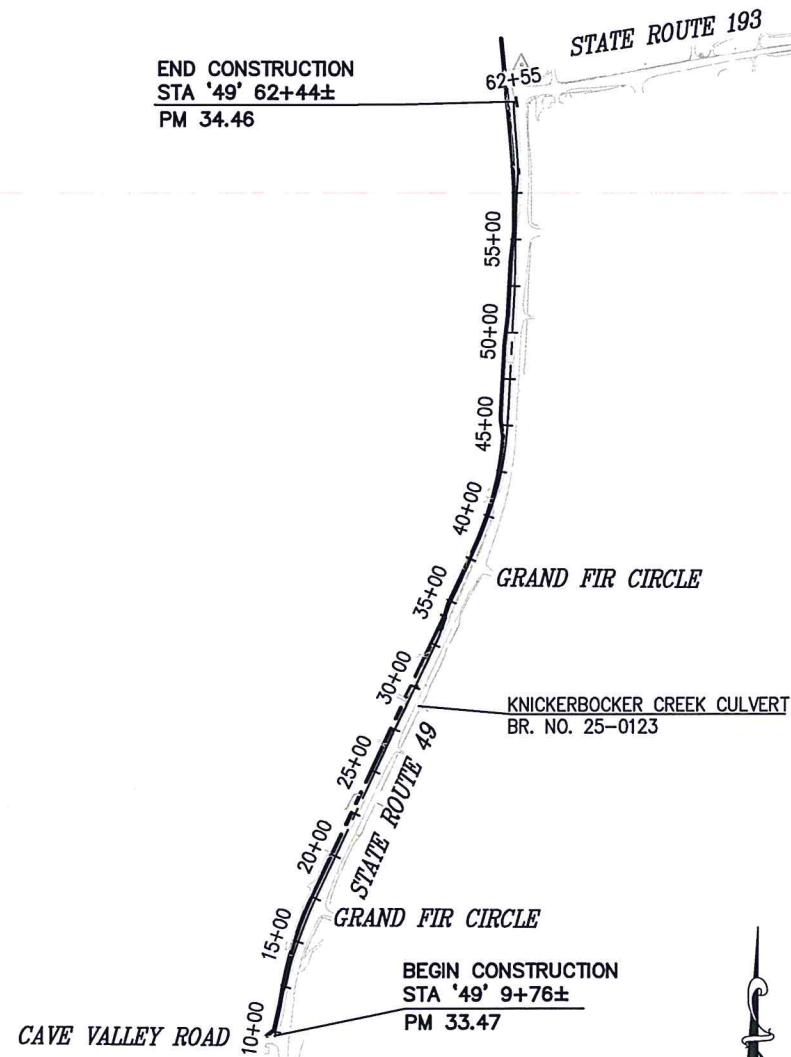

**SITE PLAN**  
SCALE: 1" = 500'

**SITE LOCATION**

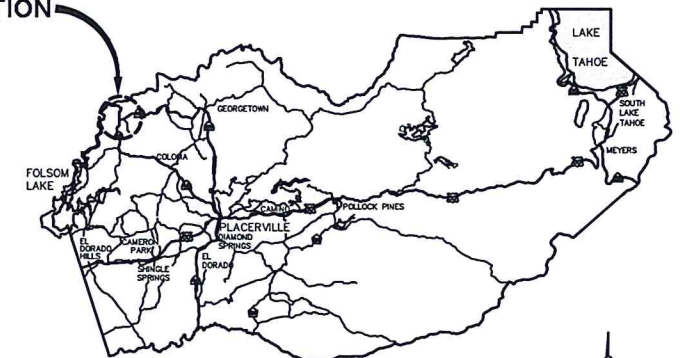

**VICINITY MAP**  
COUNTY OF EL DORADO

*Paul J. Horn*  
Project ENGINEER  
Registered Civil Engineer



05/08/13

Plans Approved Date

FED. PROJECT SRTSL 5925(070)

PW# 11-30628

CU \_\_\_\_\_ EA 03-2E4801

ADOPTED AND APPROVED BY:  
  
 RON V. BRIGGS  
 CHAIR, EL DORADO COUNTY BOARD OF SUPERVISORS  
 DATE 1-2-14  
 board date 5-21-13

APPROVED BY:  
  
 KIMBERLY A. KERR  
 INTERIM DIRECTOR, EL DORADO COUNTY DEPARTMENT OF TRANSPORTATION  
 DATE 1/2/14

MATTHEW D. SMELTZER P.E. NO. C56832  
 DEPUTY DIRECTOR OF ENGINEERING, EL DORADO COUNTY DEPARTMENT OF TRANSPORTATION  
 DATE 12/31/13

**COUNTY OF EL DORADO  
DEPARTMENT OF TRANSPORTATION**

2850 FAIRLANE COURT  
PLACERVILLE, CA 95667  
(916) 621-5900



**REVISIONS**

MARK	DATE	BY

**BOARD OF SUPERVISORS**

RON MIKULACO	I
RAYMOND J. NUTTING	II
BRIAN VEERKAMP	III
RON V. BRIGGS	IV
NORMA SANTIAGO	V

**NORTHSIDE SCHOOL CLASS 1  
BIKE PATH - PHASE 2 (SR49)**

**TITLE SHEET**

SHEET 1 OF 35