

INDEX OF SHEETS

SHEET	PLAN SHEET	TITLE
1		TITLE SHEET
2-5	CD-1 THRU CD-4	SURVEY AND CONTROL DIAGRAM
6-7	X-1 THRU X-2	TYPICAL SECTIONS
8-17	L-1 THRU L-10	LAYOUT - PLAN & PROFILE
18-31	D-1 THRU D-14	DRAINAGE
32-36	SPD-1 THRU SPD-5	SIGNING AND PAVEMENT DELINEATION
37	TR-1	TREE REMOVAL PLAN

COUNTY OF EL DORADO, CA DEPARTMENT OF TRANSPORTATION

PROJECT PLANS FOR THE CONSTRUCTION OF EL DORADO TRAIL LOS TRAMPAS TO HALCON

IN THE COUNTY OF EL DORADO, DISTRICT 3
SOUTH OF US HWY 50 AT THE BASE OF THE CAMINO HEIGHTS SUBDIVISION IN THE TOWN OF CAMINO

To be supplemented with Standard Plans and Specifications dated 2010, including the 2010 Revised Standard Specifications, of the California Department of Transportation, unless otherwise noted.

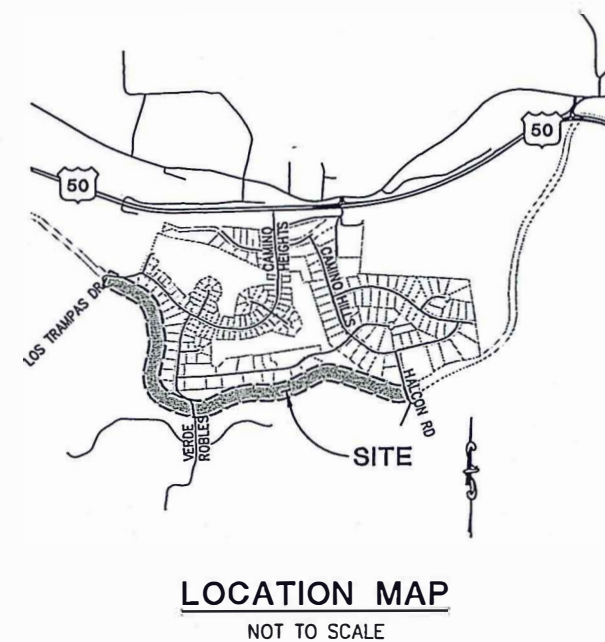
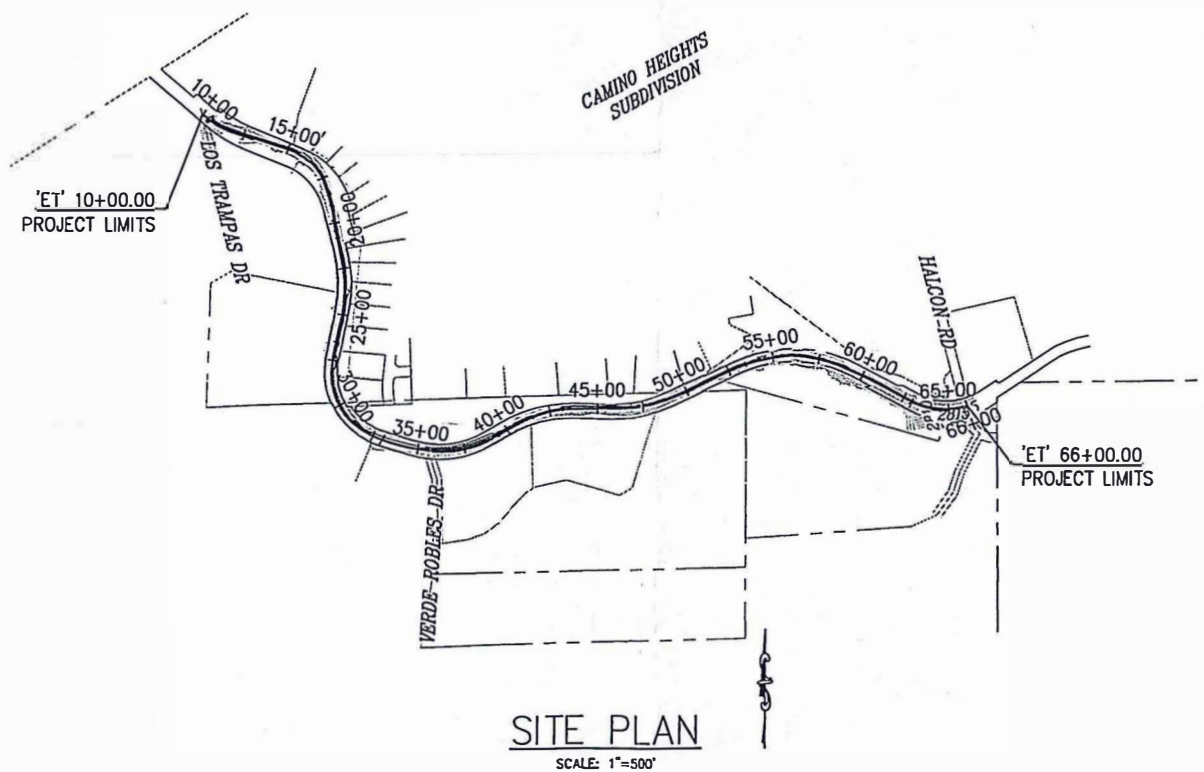
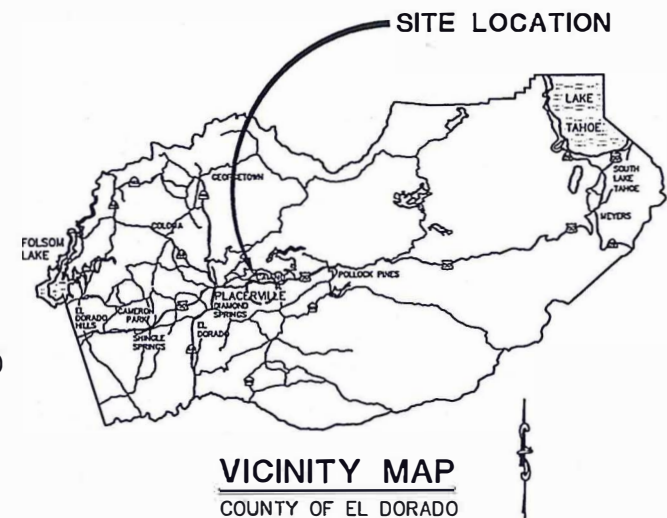

FUNDING AGENCY

FEDERAL AID NUMBER: CML 5925(130)
RTP: RT-09-007

BOARD OF SUPERVISORS

I	JOHN HIDAHL
II	SHIVA FRENTZEN
III	BRIAN VEERKAMP
IV	MICHAEL RANALLI
V	SUE NOVASEL

**COUNTY OF EL DORADO
DEPARTMENT OF TRANSPORTATION**

(530) 621-5900
2850 FAIRLANE CT
PLACERVILLE, CA 95667

APPROVED BY: *[Signature]* DATE: 3/13/2018
 CHIEF, EL DORADO COUNTY BOARD OF SUPERVISORS

APPROVED BY: *[Signature]* DATE: 2/21/18
 RAFAEL MARTINEZ, DIRECTOR
 DEPARTMENT OF TRANSPORTATION

APPROVED BY: *[Signature]* DATE: 2/25/18
 MATTHEW D. SHELTER P.E. NO. CS6632
 DEPUTY DIRECTOR, ENGINEERING

PW NO. 16-31117 PROJECT NO. 97012

**EL DORADO TRAIL
LOS TRAMPAS TO HALCON**

TITLE SHEET

SHEET 1 OF 37

CONTRACTOR'S LICENSE CLASSIFICATION: Bidders shall be properly licensed to perform the Work pursuant to the State Contractor's License Act (Business and Professions Code section 7000 et seq.) and shall possess a CLASS A LICENSE or equivalent combination of Classes required by the categories and type of Work included in the Contract Documents and Plans. Failure of the successful Bidder to obtain proper and adequate licensing at the time bids are submitted shall constitute a failure to execute the Contract, and forfeiture as provided under that section.

MARK	DATE	BY	REVISIONS



[Signature]
 SUBMITTED BY:
 CIVIL ENGINEER
 STATE OF CALIFORNIA NO. _____ DATE: 12/04/17