

# COUNTY OF EL DORADO DEPARTMENT OF TRANSPORTATION



**CONSTRUCTION UNIT**  
2441 Headington Road  
Placerville CA 95667  
Phone: (530) 642-4987  
Fax: (530) 295-2655

**JAMES W. WARE, P.E.**  
Director of Transportation  
  
Internet Web Site:  
<http://co.el-dorado.ca.us/dot>

**MAIN OFFICE**  
2850 Fairlane Court  
Placerville CA 95667  
Phone: (530) 621-5900  
Fax: (530) 626-0387



August 24, 2009

Board of Supervisors  
330 Fair Lane  
Placerville, CA 95667

2009 AUG 24 AM 10:28  
BOARD OF SUPERVISORS  
EL DORADO COUNTY

**Agenda Title:** DOT 8/25/09 Christmas Valley Phase 2 Award of Contract, Legistar # 09-0509  
**Meeting Date:** August 25, 2009

Dear Members of the Board:

Transportation Department (Department) recommending the following pertaining to the Christmas Valley Phase 2A Erosion Control Project PW 09-30421 (Project):

The Board award the contract to White Rock Construction, Inc. (White Rock), who submitted the lowest, responsive, responsible bid of \$487,449.50.

Reason for Recommendation:

On August 17, 2009 the Department opened bids for the Project. Three bids were received ranging from \$487,449.50 to \$601,750. White Rock's bid is 84% of the Engineer's Estimate. White Rock is the lowest, responsive, responsible bidder.

Sincerely,

A handwritten signature in blue ink, appearing to read "James W. Ware".

James W. Ware, P.E.  
Director of Transportation

Bid Opening Date: August 17, 2009  
 Estimated Award Date: August 25, 2009

## CHRISTMAS VALLEY PHASE 2A EROSION CONTROL PROJECT CONTRACT NO. 95159

### BID SUMMARY

ITEM NO.	ITEM DESCRIPTION	White Rock Construction, Inc.			V & C Construction, Inc.			R. Beckwith General Engineering		
		ESTIMATED QUANTITY	UNIT OF MEASURE	UNIT PRICE (in Figures)	ITEM TOTAL (in Figures)	UNIT PRICE (in Figures)	ITEM TOTAL (in Figures)	UNIT PRICE (in Figures)	ITEM TOTAL (in Figures)	
1	Mobilization	1	LS	\$ 16,000.00	\$ 16,000.00	\$ 50,000.00	\$ 50,000.00	\$ 12,514.60	\$ 12,514.60	
2	Traffic Control	1	LS	\$ 12,600.00	\$ 12,600.00	\$ 21,000.00	\$ 21,000.00	\$ 10,675.00	\$ 10,675.00	
3	Sweeping	1	LS	\$ 8,400.00	\$ 8,400.00	\$ 4,000.00	\$ 4,000.00	\$ 18,650.00	\$ 18,650.00	
4	Trench and Excavation Safety	1	LS	\$ 1,900.00	\$ 1,900.00	\$ 2,500.00	\$ 2,500.00	\$ 6,400.00	\$ 6,400.00	
5	Humus and Humus Application	31	CY	\$ 155.00	\$ 4,805.00	\$ 125.00	\$ 3,875.00	\$ 175.00	\$ 5,425.00	
6	Mobilization/Demobilization for Mulch Blowing	1	LS	\$ 470.00	\$ 470.00	\$ 2,500.00	\$ 2,500.00	\$ 1,075.00	\$ 1,075.00	
7	Mulch and Mulch Application	91	CY	\$ 135.00	\$ 12,285.00	\$ 125.00	\$ 11,375.00	\$ 150.00	\$ 13,650.00	
8	Mobilization/Demobilization for Tackifier Application	1	LS	\$ 470.00	\$ 470.00	\$ 1,590.00	\$ 1,590.00	\$ 375.00	\$ 375.00	
9	Tackifier and Tackifier Application	10,000	SF	\$ 0.15	\$ 1,500.00	\$ 0.25	\$ 2,500.00	\$ 0.13	\$ 1,300.00	
10	Install & Maintain Weighted Fiber Rolls or Gravel-filled Rolls	45	EA	\$ 100.00	\$ 4,500.00	\$ 30.00	\$ 1,350.00	\$ 150.00	\$ 6,750.00	
11	Install & Maintain Filter Fence	825	LF	\$ 4.00	\$ 3,300.00	\$ 6.00	\$ 4,950.00	\$ 7.75	\$ 6,393.75	
12	Install & Maintain Visqueen with Gravel Bags or Gravel-filled Rolls	131	LF	\$ 5.00	\$ 655.00	\$ 8.00	\$ 1,048.00	\$ 11.00	\$ 1,441.00	
13	Install & Maintain Drain Inlet Protection	3	EA	\$ 190.00	\$ 570.00	\$ 250.00	\$ 750.00	\$ 72.00	\$ 216.00	
14	Install & Maintain Wooden Tree Trunk Protection	20	EA	\$ 175.00	\$ 3,500.00	\$ 200.00	\$ 4,000.00	\$ 87.00	\$ 1,740.00	
15	Install & Maintain Tree Protection & Construction Limit Fence	3,702	LF	\$ 2.75	\$ 10,180.50	\$ 7.00	\$ 25,914.00	\$ 3.00	\$ 11,106.00	
16	Install & Maintain Tire Wash Area (On Pavement)	1	EA	\$ 1,250.00	\$ 1,250.00	\$ 1,500.00	\$ 1,500.00	\$ 2,800.00	\$ 2,800.00	
17	Install & Maintain Concrete Wash Area	1	EA	\$ 1,000.00	\$ 1,000.00	\$ 400.00	\$ 400.00	\$ 1,250.00	\$ 1,250.00	
18	Tree Removal	13	EA	\$ 300.00	\$ 3,900.00	\$ 550.00	\$ 7,150.00	\$ 375.00	\$ 4,875.00	
19	Roadside Sign Removal and Relocation	2	EA	\$ 100.00	\$ 200.00	\$ 400.00	\$ 800.00	\$ 235.00	\$ 470.00	
20	15" HDPE Pipe (In Pavement)	46	LF	\$ 92.00	\$ 4,232.00	\$ 55.00	\$ 2,530.00	\$ 90.00	\$ 4,140.00	
21	15" HDPE Pipe (Out of Pavement)	11	LF	\$ 43.00	\$ 473.00	\$ 30.00	\$ 330.00	\$ 61.00	\$ 671.00	
22	18" HDPE Pipe (In Pavement)	235	LF	\$ 102.00	\$ 23,970.00	\$ 60.00	\$ 14,100.00	\$ 116.00	\$ 27,260.00	
23	18" HDPE Pipe (Out of Pavement)	111	LF	\$ 45.00	\$ 4,995.00	\$ 35.00	\$ 3,885.00	\$ 88.00	\$ 9,768.00	
24	24" HDPE Pipe (In Pavement)	168	LF	\$ 139.00	\$ 23,352.00	\$ 85.00	\$ 14,280.00	\$ 128.00	\$ 21,504.00	
25	24" HDPE Pipe (Out of Pavement)	44	LF	\$ 51.00	\$ 2,244.00	\$ 40.00	\$ 1,760.00	\$ 80.00	\$ 3,520.00	
26	29" x 45" Arch CMP (In Pavement)	76	LF	\$ 221.00	\$ 16,796.00	\$ 90.00	\$ 6,840.00	\$ 214.50	\$ 16,302.00	
27	29" x 45" Arch CMP (Out of Pavement)	20	LF	\$ 69.00	\$ 1,380.00	\$ 60.00	\$ 1,200.00	\$ 116.00	\$ 2,320.00	

Bid Opening Date: August 17, 2009  
 Estimated Award Date: August 25, 2009

## CHRISTMAS VALLEY PHASE 2A EROSION CONTROL PROJECT CONTRACT NO. 95159

### BID SUMMARY

ITEM NO.	ITEM DESCRIPTION	ESTIMATED QUANTITY	UNIT OF MEASURE	White Rock Construction, Inc.		V. & C. Construction, Inc.		Hembeck General Engineering	
				UNIT PRICE (in Figures)	ITEM TOTAL (in Figures)	UNIT PRICE (in Figures)	ITEM TOTAL (in Figures)	UNIT PRICE (in Figures)	ITEM TOTAL (in Figures)
28	36" Sediment Trap	3	EA	\$ 4,975.00	\$ 14,925.00	\$ 3,300.00	\$ 9,900.00	\$ 4,875.00	\$ 14,625.00
29	48" Sediment Trap	7	EA	\$ 5,700.00	\$ 39,900.00	\$ 3,800.00	\$ 26,600.00	\$ 5,575.00	\$ 39,025.00
30	15" FES	1	EA	\$ 700.00	\$ 700.00	\$ 350.00	\$ 350.00	\$ 175.00	\$ 175.00
31	18" FES	1	EA	\$ 700.00	\$ 700.00	\$ 400.00	\$ 400.00	\$ 185.00	\$ 185.00
32	24" FES	1	EA	\$ 750.00	\$ 750.00	\$ 400.00	\$ 400.00	\$ 225.00	\$ 225.00
33	29" x 45" FES	1	EA	\$ 1,200.00	\$ 1,200.00	\$ 450.00	\$ 450.00	\$ 515.00	\$ 515.00
34	Concrete Encasement	4	EA	\$ 1,000.00	\$ 4,000.00	\$ 500.00	\$ 2,000.00	\$ 525.00	\$ 2,100.00
35	Pipe Concrete Apron	8	CY	\$ 850.00	\$ 6,800.00	\$ 265.00	\$ 2,120.00	\$ 825.00	\$ 6,600.00
36	Grate Concrete Apron	2	CY	\$ 850.00	\$ 1,700.00	\$ 265.00	\$ 530.00	\$ 550.00	\$ 1,100.00
37	Sediment Trap Window Concrete Apron	2	CY	\$ 850.00	\$ 1,700.00	\$ 265.00	\$ 530.00	\$ 550.00	\$ 1,100.00
38	Remove Existing CMP	366	LF	\$ 15.00	\$ 5,490.00	\$ 25.00	\$ 9,150.00	\$ 140.00	\$ 51,240.00
39	Grass-Lined Swale	323	LF	\$ 25.00	\$ 8,075.00	\$ 40.00	\$ 12,920.00	\$ 43.50	\$ 14,050.50
40	No. 1 Backing	390	SF	\$ 12.00	\$ 4,680.00	\$ 30.00	\$ 11,700.00	\$ 12.00	\$ 4,680.00
41	Articulated Block Channel, Type 1-A	1,242	LF	\$ 51.00	\$ 63,342.00	\$ 60.00	\$ 74,520.00	\$ 52.25	\$ 64,894.50
42	Articulated Block Channel, Type 1-B	359	LF	\$ 68.00	\$ 24,412.00	\$ 69.00	\$ 24,771.00	\$ 69.00	\$ 24,771.00
43	Articulated Block Channel, Type 2-A	293	LF	\$ 61.00	\$ 17,873.00	\$ 65.00	\$ 19,045.00	\$ 70.00	\$ 20,510.00
44	Articulated Block Channel, Type 2-B	518	LF	\$ 72.00	\$ 37,296.00	\$ 63.00	\$ 32,634.00	\$ 75.00	\$ 38,850.00
45	Articulated Block Channel, Type 3	487	LF	\$ 85.00	\$ 41,395.00	\$ 75.00	\$ 36,525.00	\$ 106.00	\$ 51,622.00
46	Articulated Block Channel, Type 4	245	LF	\$ 119.00	\$ 29,155.00	\$ 93.00	\$ 22,785.00	\$ 118.25	\$ 28,871.25
47	Driveway R&R	964	SF	\$ 7.00	\$ 6,748.00	\$ 10.00	\$ 9,640.00	\$ 14.60	\$ 14,074.40
48	AC Pavement Removal (F)	6,255	SF	\$ 1.20	\$ 7,506.00	\$ 1.00	\$ 6,255.00	\$ 3.00	\$ 18,765.00
49	Misc Paving	100	SF	\$ 9.25	\$ 925.00	\$ 10.00	\$ 1,000.00	\$ 15.50	\$ 1,550.00
50	Misc Grading	10	CY	\$ 15.00	\$ 150.00	\$ 25.00	\$ 250.00	\$ 56.00	\$ 560.00
51	Overexcavate and Remove Unsuitable Material	50	CY	\$ 32.00	\$ 1,600.00	\$ 20.00	\$ 1,000.00	\$ 83.00	\$ 4,150.00
52	Wintertization	1	LS	\$ 1,500.00	\$ 1,500.00	\$ 2,500.00	\$ 2,500.00	\$ 4,800.00	\$ 4,800.00
<b>TOTAL BID</b>					\$ 487,449.50		\$ 500,102.00		\$ 601,750.00

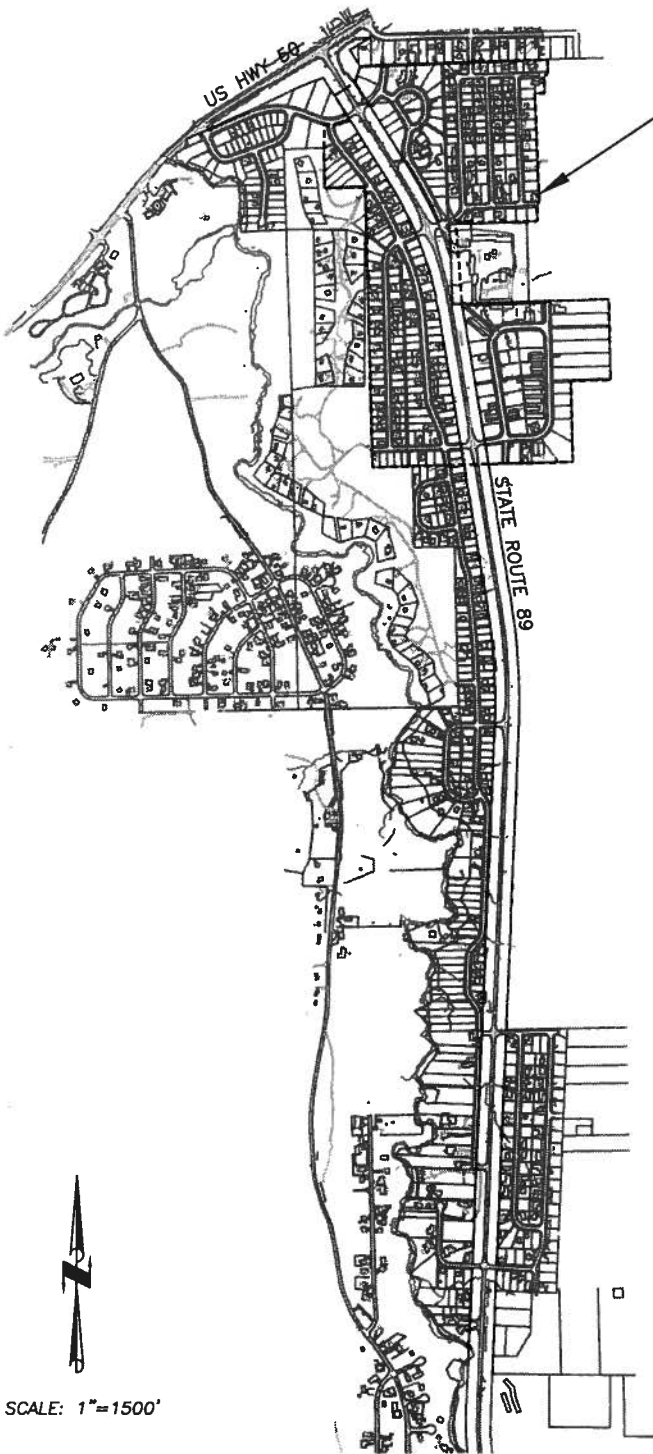

CHRISTMAS VALLEY  
PHASE 2A

SCALE: 1"=1500'

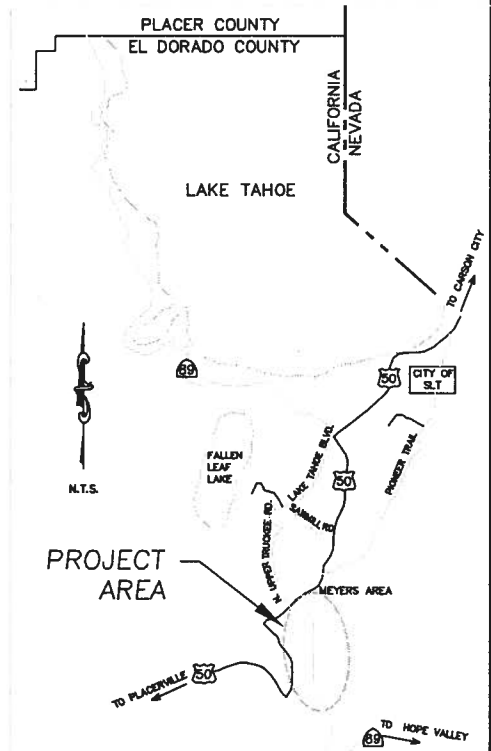

EL DORADO COUNTY  
SOUTH LAKE TAHOE OFFICE



CHRISTMAS VALLEY PHASE 2A  
EROSION CONTROL PROJECT

Project Location Map

DATE: 3/09

PROJECT NO.: 95159

BY: JTC

FIGURE

A