



Parks Update

El Dorado County

WHERE WE ARE HEADED:

- Current Projects
- Public Engagement
- River Management Plan Update
- Volunteer Program
- Agency Coordination
- Parks Master Plan



PROJECTS

Current Work in Parks

PARKS UPDATE

ELLIS CREEK
BUILDING

RAILROAD DOG
PARK

FOREBAY
RENOVATION

CHILI BAR

RUBICON
PARKING LOT
EXPANSION

HENNINGSEN
LOTUS PARK

A dirt road with a gravel surface winds through a dense forest of tall, thin evergreen trees. The ground is covered in brown pine needles and some dry, reddish-brown vegetation on the left side. The sky is blue with some light clouds. The text "Ellis Creek Building" is overlaid in white on the left side of the image.

Ellis Creek Building

Railroad Park Dog Park



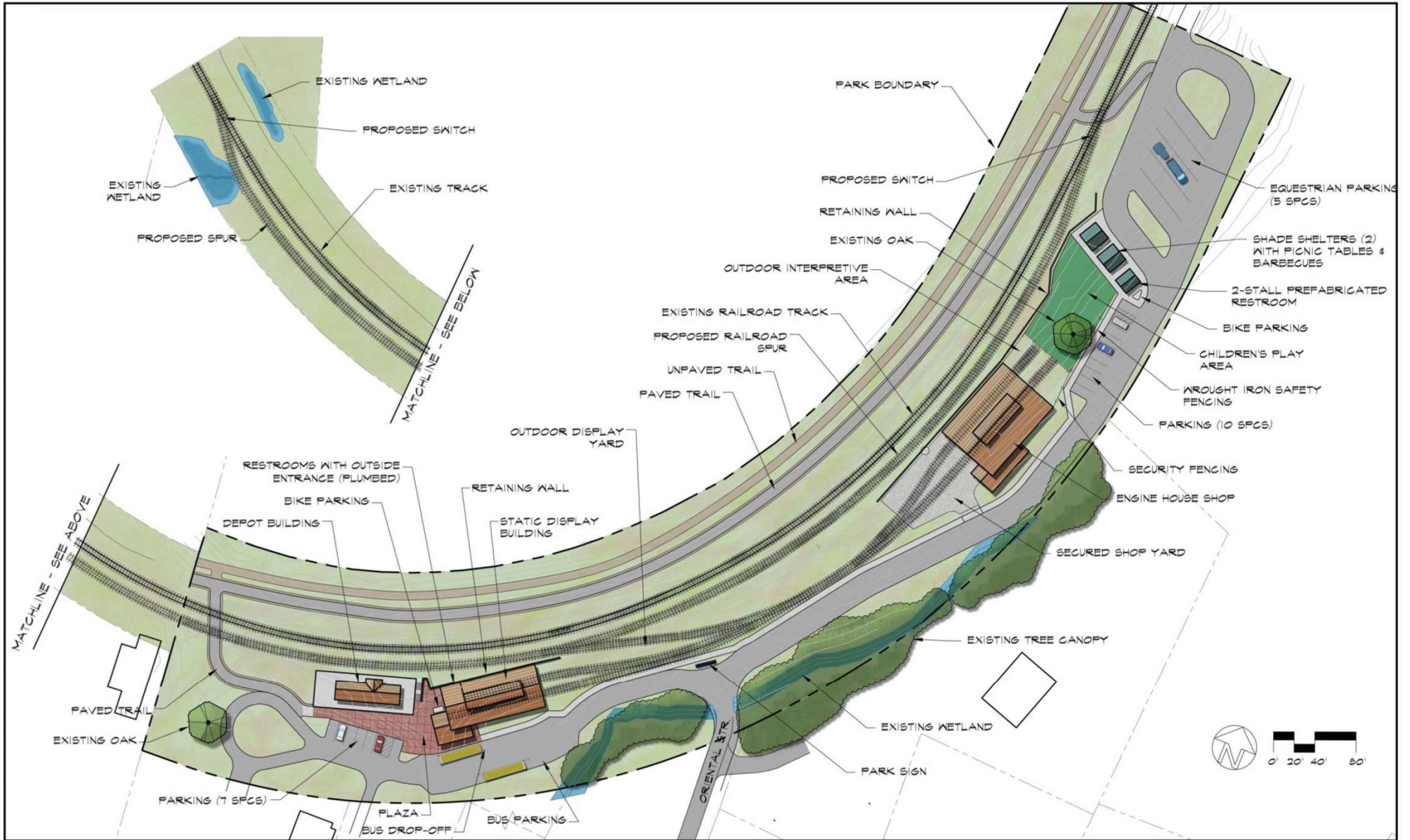

EL DORADO COUNTY

RAILROAD PARK CONCEPTUAL PLAN

11/20/15

FOOTHILL ASSOCIATES
 ENVIRONMENTAL CONSULTING - PLANNING - LANDSCAPE ARCHITECTURE
 398 HENLO DRIVE, SUITE 5
 ROCKLIN, CALIFORNIA 95765
 (916) 455-1300
 © 2015



Forebay Park Renovation



Chili Bar

Rubicon Parking Lot Expansion



Henningesen Lotus Park



An aerial photograph of Diamond Springs Park. The image shows a complex of buildings, parking lots, and sports fields on the left side. The right side is dominated by a large, wooded area with a network of paths and a stream. The map is overlaid with yellow lines indicating site boundaries and pink lines representing topographic contours. The text 'Diamond Springs Park' is centered in white over the wooded area.

Diamond Springs Park

PARKS UPDATE

“What I hear when I’m being yelled at is people caring really loudly at me.”

**- LESLIE KNOPE
PARKS AND RECREATION, NBC**



PUBLIC ENGAGEMENT

1. User groups
2. Projects
3. Social Media

RIVER PROGRAM

Changes following our five-year review to improve education and user experience:

- clarifying rules
- reimagining training
- permit administration

VOLUNTEER PROGRAM

- Rubicon Work Parties
- El Dorado Trail Maintenance
- Park Clean-up Days

Parks and Trails Master Plan



AGENCY COORDINATION

General Plan Measure PR-J:
“Establish a working group... to coordinate the actions of County agencies and resource-based recreation providers in the county.”



EL DORADO COUNTY Parks and Trails Division

