

ORIGINAL SCALE IS IN INCHES  
 Drawing name: C:\Civil 3D Projects\72334 Diamond Springs Pkwy\CADD Files\Exhibits\Utilities\Underground Utility District Ph 1B\2.dwg Layout Tab: UUD-X Aug 22,2013 9:48am DFriedstod

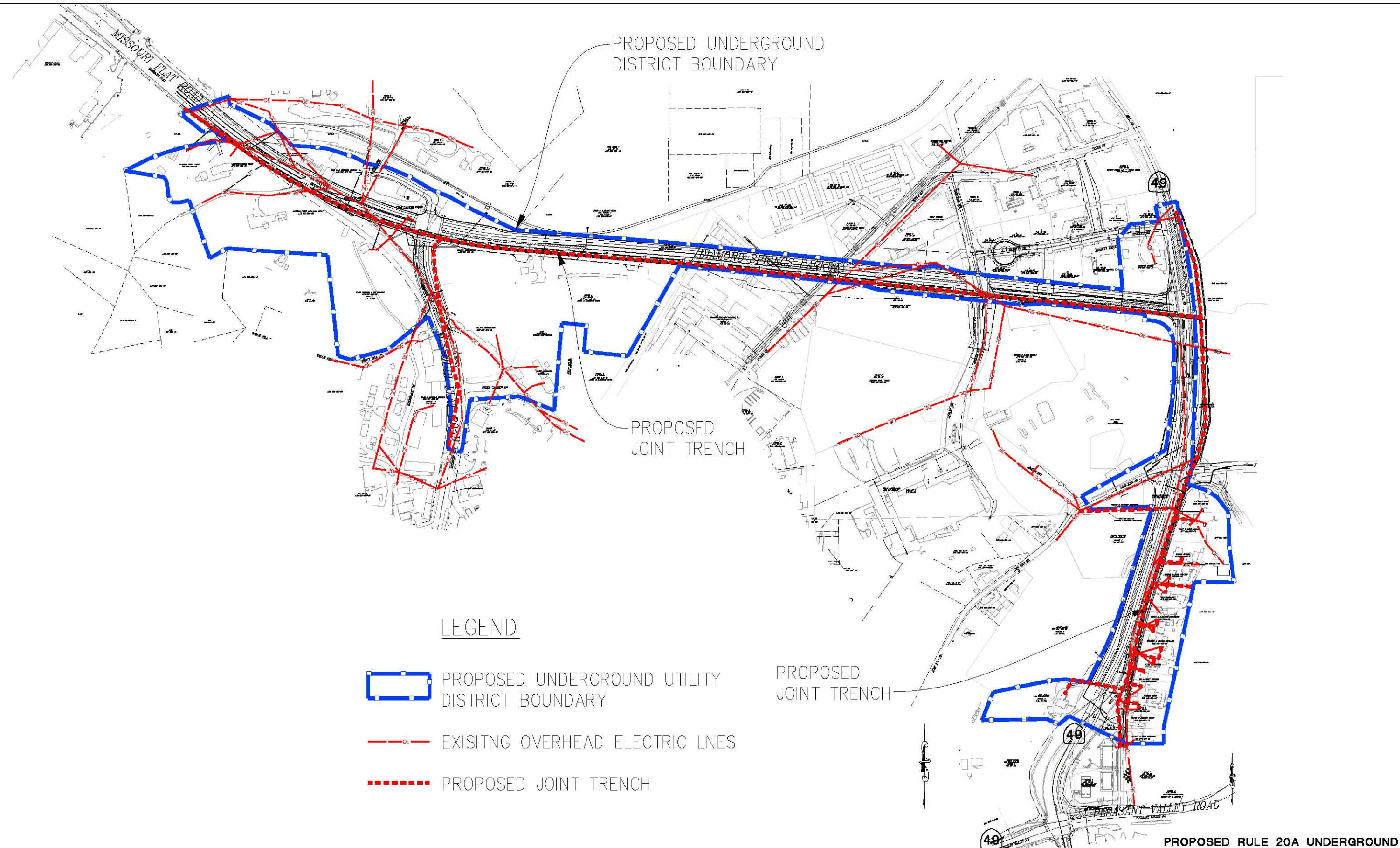

**LEGEND**

- PROPOSED UNDERGROUND UTILITY DISTRICT BOUNDARY
- EXISTING OVERHEAD ELECTRIC LINES
- PROPOSED JOINT TRENCH

PROPOSED JOINT TRENCH

**PRELIMINARY**

**PROPOSED RULE 20A UNDERGROUND UTILITY DISTRICT**  
 SCALE : 1" = 200'

REVISION	NUMBER	DATE	DESCRIPTION	BY

PREPARED UNDER THE SUPERVISION OF :	DESIGNED: DRF	DRAWN: DRF
REGISTERED CIVIL ENGINEER	CHECKED: PH	DATE: 8/22/2013
DATE:	ROAD NUMBER:	

**EL DORADO COUNTY**  
 DEPARTMENT OF TRANSPORTATION

**DIAMOND SPRINGS PARKWAY**  
 UNDERGROUND UTILITY DISTRICT

SHEET  
**UUD-x**  
 1 OF 1  
 W.O. No. **72334**