





ORIGINAL SCALE IS IN INCHES
 Drawing name: Z:\Civil_3D\Projects\72143_Cameron Park Drive - Palmer Dr to Hacienda\CADD Files\FW\RW and Easements Exhibit.dwg Layout Tab: RW-1 Nov 20, 2020 - 11:40am SMC\Ver

LEGEND

-  — EXISTING PROPERTY LINE
-  — ROAD EASEMENT
-  — SLOPE AND DRAINAGE EASEMENT
-  — TEMPORARY CONSTRUCTION EASEMENT
-  — EXISTING ENCUMBERED AREA

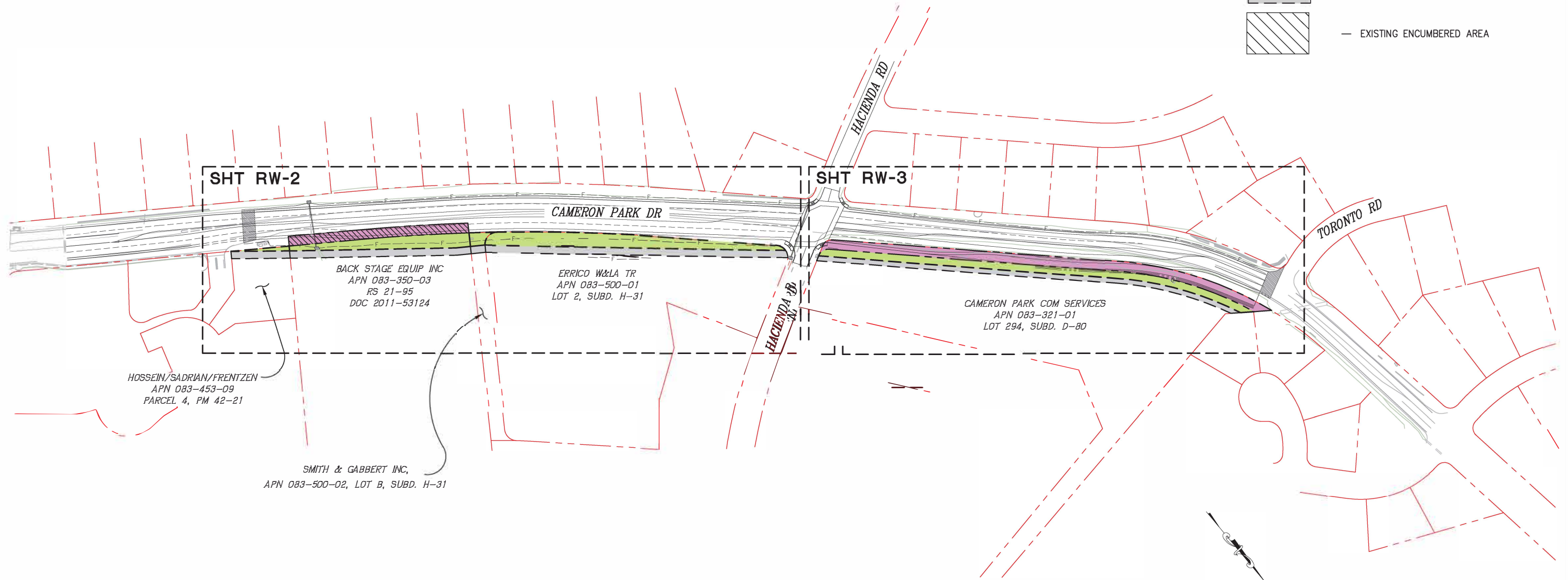

FOR REDUCED PLANS
 2
 1
 0

PRELIMINARY





RIGHT-OF-WAY AND EASEMENTS EXHIBIT
 SCALE : 1" = 100'

PREPARED UNDER THE SUPERVISION OF : _____ REGISTERED CIVIL ENGINEER DATE: _____	DESIGNED: DWH CHECKED: DWH ROAD NUMBER: 200	DRAWN: SGM DATE: 11/19/20		COUNTY OF EL DORADO DEPARTMENT OF TRANSPORTATION	CAMERON PARK DRIVE PALMER DRIVE TO HACIENDA ROAD	SHEET RW-1 1 OF 3 W.O. No. 72143
--	--	------------------------------------	---	---	---	--

ORIGINAL SCALE IS IN INCHES
 Drawing name: Z:\Civil 3D\Projects\72143\Cameron Park Drive - Palmer Dr to Hacienda\CADD Files\RW\RW and Easements Exhibit.dwg
 Layout Tab: RW-2 Nov 20, 2020 - 11:22am SMCVey

A.P.N.	OWNER	TOTAL PARCEL ACRES	FEE RIGHT-OF-WAY	SLOPE AND DRAINAGE EASEMENT	TEMPORARY CONSTRUCTION EASEMENT	TOTAL PARCEL ACRES UNAFFECTED
083-453-09	HOSSEIN/SADRIAN/FRENTZEN	0.469	-	0.014 AC (602 SF)	0.04 AC (1,805 SF)	0.455
083-350-03	BACK STAGE EQUIP	4.089	0.17 AC (7,399 SF) ENCUMBERED	0.19 AC (8,191 SF)	0.13 AC (5,575 SF)	3.73
083-500-02	SMITH AND GABBERT	0.30	-	0.022 AC (975 SF)	0.010 AC (453 SF)	0.28
083-500-01	ERRICO	4.336	-	0.32 AC (13,962 SF)	0.21 AC (9,292 SF)	4.02
		TOTAL AREA	0.17 AC (7,399 SF)	0.55 AC (23,730 SF)	0.39 AC (17,125 SF)	

LEGEND

-  EXISTING PROPERTY LINE
-  ROAD EASEMENT
-  SLOPE AND DRAINAGE EASEMENT
-  TEMPORARY CONSTRUCTION EASEMENT
-  EXISTING ENCUMBERED AREA

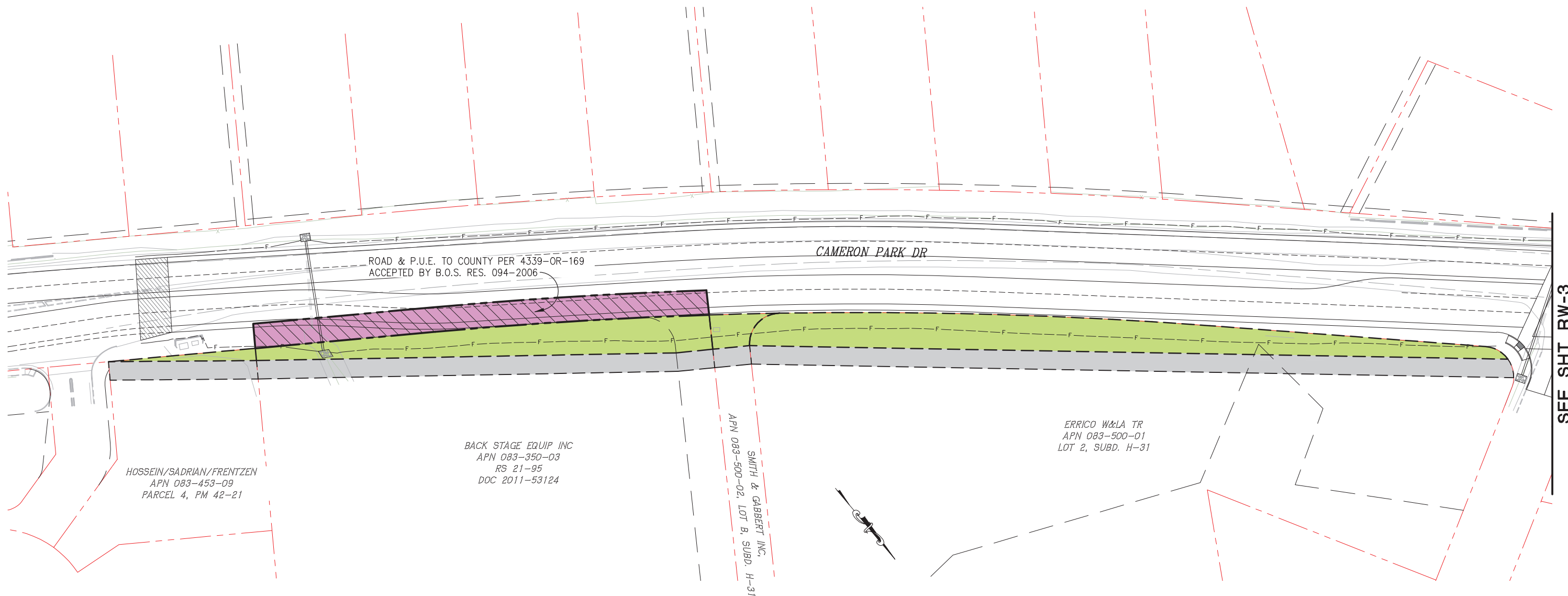

SEE SHT RW-3

REVISION	NUMBER	DATE	DESCRIPTION	BY

PREPARED UNDER THE SUPERVISION OF:

REGISTERED CIVIL ENGINEER

DATE: _____

DESIGNED: DWH

CHECKED: DWH

ROAD NUMBER: 200

DRAWN: SGM

DATE: 11/20/20



COUNTY OF EL DORADO
DEPARTMENT OF TRANSPORTATION

PRELIMINARY

RIGHT-OF-WAY AND EASEMENTS EXHIBIT
SCALE : 1" = 40'





CAMERON PARK DRIVE
PALMER DRIVE TO HACIENDA ROAD

SHEET
RW-2
 2 OF 3
 W.O. No. **72143**

ORIGINAL SCALE IS IN INCHES
 Drawing name: Z:\Civil 3D\Projects\72143_Cameron Park Drive - Palmer Dr. to Hacienda\CADD Files\RW\RW and Easements Exhibit.dwg Layout Tab: RW-3 Nov 20, 2020 - 11:22am SMcVey

A.P.N.	OWNER	TOTAL PARCEL ACRES	FEE RIGHT-OF-WAY	SLOPE AND DRAINAGE EASEMENT	TEMPORARY CONSTRUCTION EASEMENT	TOTAL PARCEL ACRES UNAFFECTED
083-321-01	CAMERON PARK COMMUNITY SERVICES DISTRICT	4.934	0.42 AC (18,416 SF)	0.31 AC (13,337 SF)	0.20 AC (8,701 SF)	4.204
TOTAL AREA			0.42 AC (18,416 SF)	0.31 AC (13,337 SF)	0.20 AC (8,701 SF)	

LEGEND

-  EXISTING PROPERTY LINE
-  ROAD EASEMENT
-  SLOPE AND DRAINAGE EASEMENT
-  TEMPORARY CONSTRUCTION EASEMENT



SEE SHT RW-2

FOR REDUCED PLANS

REVISION	NUMBER	DATE	DESCRIPTION	BY

PREPARED UNDER THE SUPERVISION OF :	DESIGNED: DWH	DRAWN: SGM
REGISTERED CIVIL ENGINEER	CHECKED: DWH	DATE: 11/20/20
DATE:	ROAD NUMBER: 200	

COUNTY OF EL DORADO
DEPARTMENT OF TRANSPORTATION

PRELIMINARY **RIGHT-OF-WAY AND EASEMENTS EXHIBIT**
SCALE : 1" = 40'

CAMERON PARK DRIVE PALMER DRIVE TO HACIENDA ROAD	SHEET RW-3 3 OF 3 W.O. No. 72143
---	---