



County Roads Update – King Fire Area

Community Development Agency

Transportation Division

August 11, 2015

Legistar # 15-0664

Wentworth Springs Rd Map

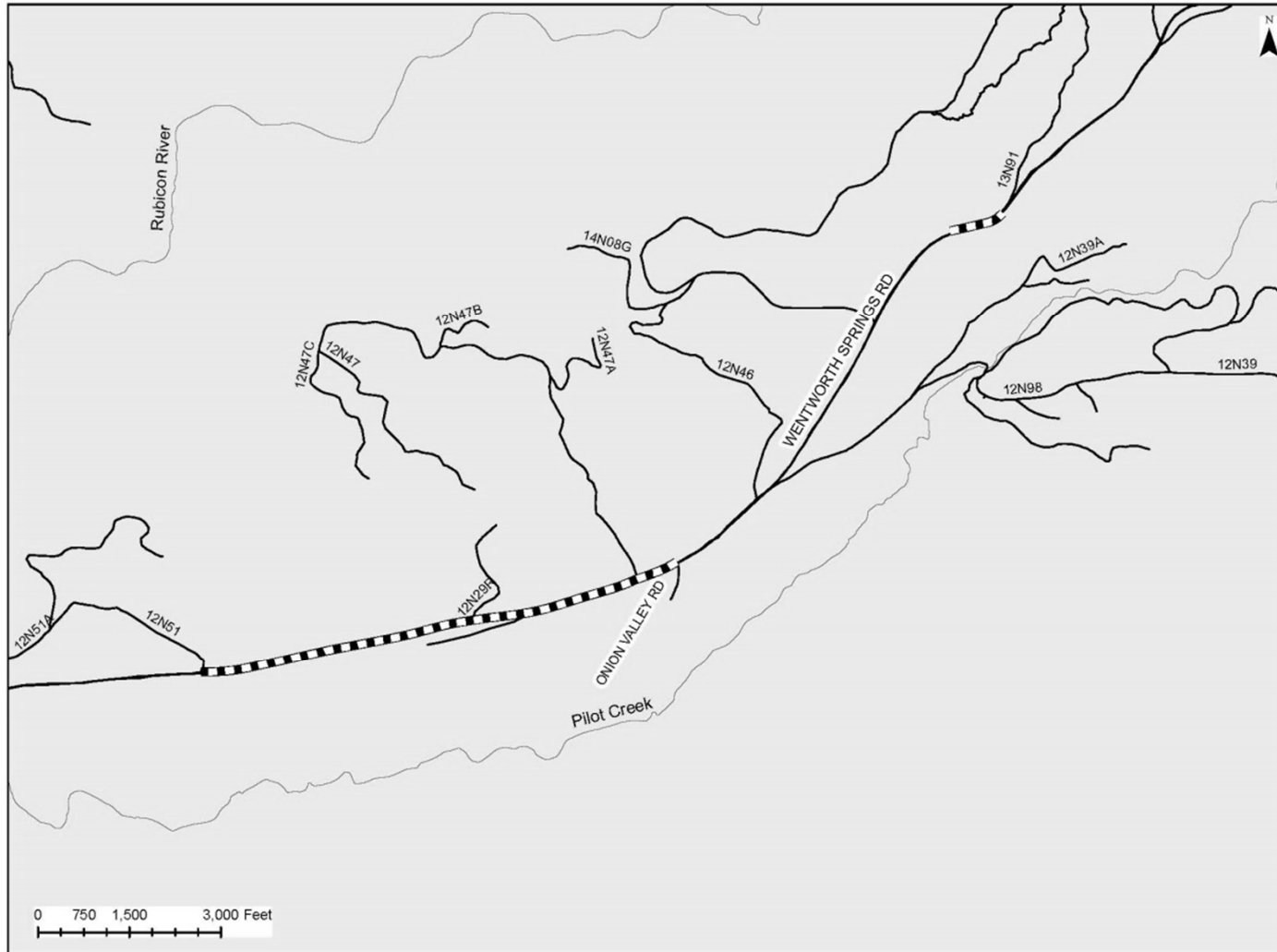

White Meadows Rd/Peavine Ridge Rd Map

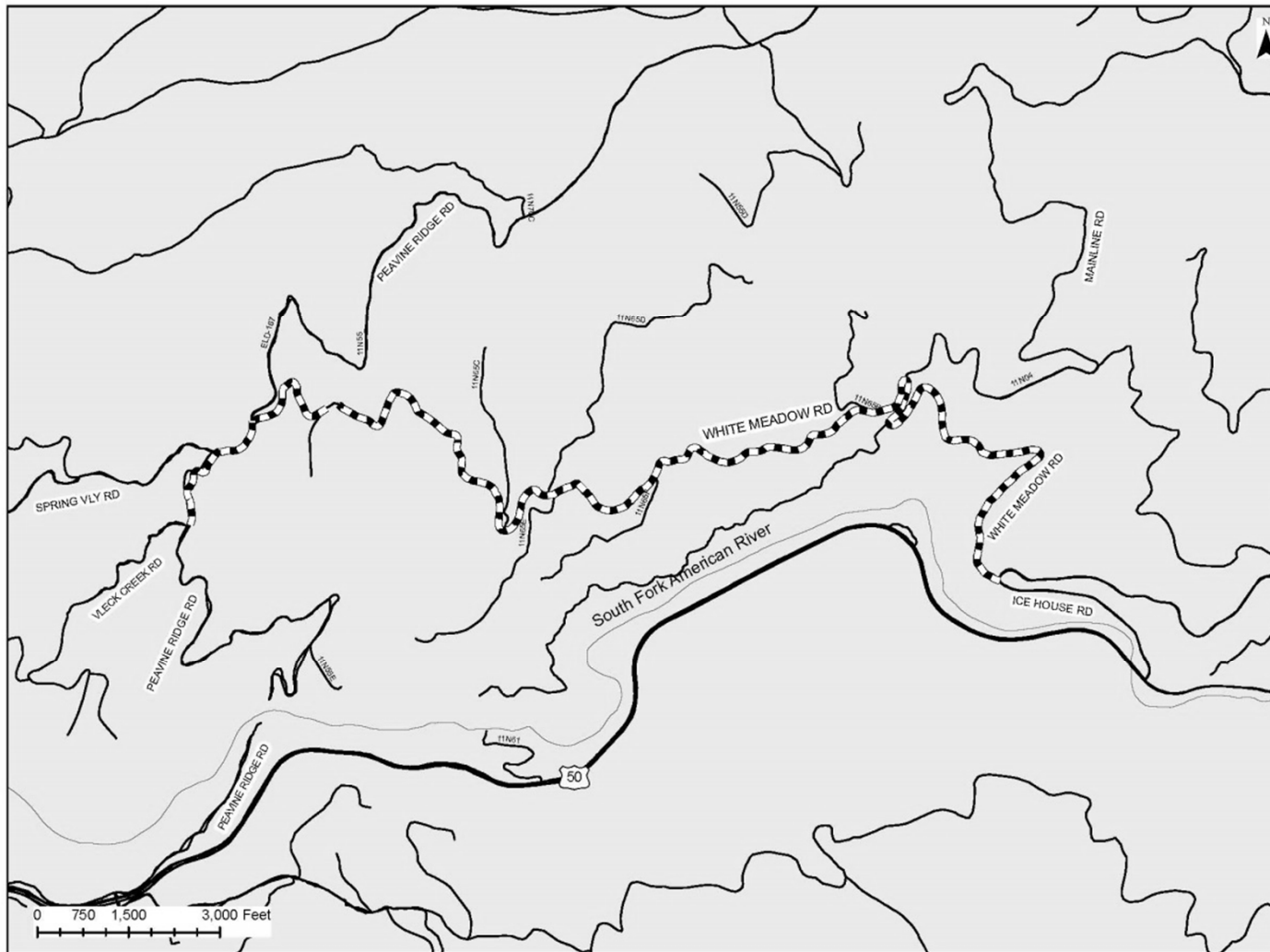

Peavine Ridge Road



White Meadows Road



White Meadows Road



White Meadows Road



Peavine Ridge Road



Wentworth Springs Road



Wentworth Springs Road



Cost to Repair Damage on White Meadows Rd/Peavine Ridge Rd

- 11 areas identified for repair equaling 56,700 square feet

- Estimated Costs for Maintenance to repair
 - Asphalt -1,250 tons - \$66,600
 - Hauling -52 loads - \$18,500
 - Labor -8 days - \$48,000
 - Equipment - \$20,000
 - Total - \$153,100

- If an Emergency Contract is issued, the costs will increase to \$170,000 to repair these two roads.

Cost to Repair Damage on Wentworth Springs Road

- 2 areas identified for repair equaling 73,300 square feet

- Estimated Costs for Maintenance to repair
 - Asphalt – 1300 tons - \$69,225
 - Hauling – 51 loads - \$18,150
 - Labor – 10 days - \$60,000
 - Equipment - \$20,000
 - Total - \$167,375

- If an Emergency Contract is issued, the costs will increase to \$170,000 to repair this road.

Summary

- These roads have deteriorated significantly to the point that several areas of the roadway will be unserviceable and will become more hazardous when the wet season comes.
- This repair work has to be performed before Winter 2015. If other funding is not provided, there will be a reduction in Road Fund for these emergency repairs.