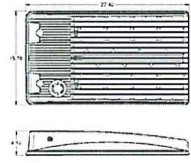
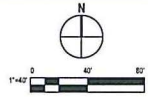

Exhibit G



MINIMUM LIGHTING REQUIREMENTS
 8'P MANUFACTURER OR APPROVED EQUAL
 LIGHT ASSEMBLY TYPE 'A' PART NO. AL-270W-U-45-T3 WITH UNIVERSAL POLE MOUNT
 LIGHT ASSEMBLY TYPE 'B' PART NO. AL-270W-U-45-T35 WITH UNIVERSAL POLE MOUNT
 LIGHT ASSEMBLY TYPE 'C' PART NO. AL-270W-U-45-T3 WITH LARGE WALL MOUNT BRACKET
 BRONZE DIE CAST ALUMINUM HOUSING
 DIMMABLE DRIVER OPTION
 DARK SKY COMPLIANT OR FULLY CUTOFF OPTICAL SHIELDED SYSTEM OR APPROVED EQUAL
 FINAL LIGHTING ASSEMBLY TO BE APPROVED BY THE DISTRICT



TYPICAL LIGHT ASSEMBLY DETAIL
 N.T.S.

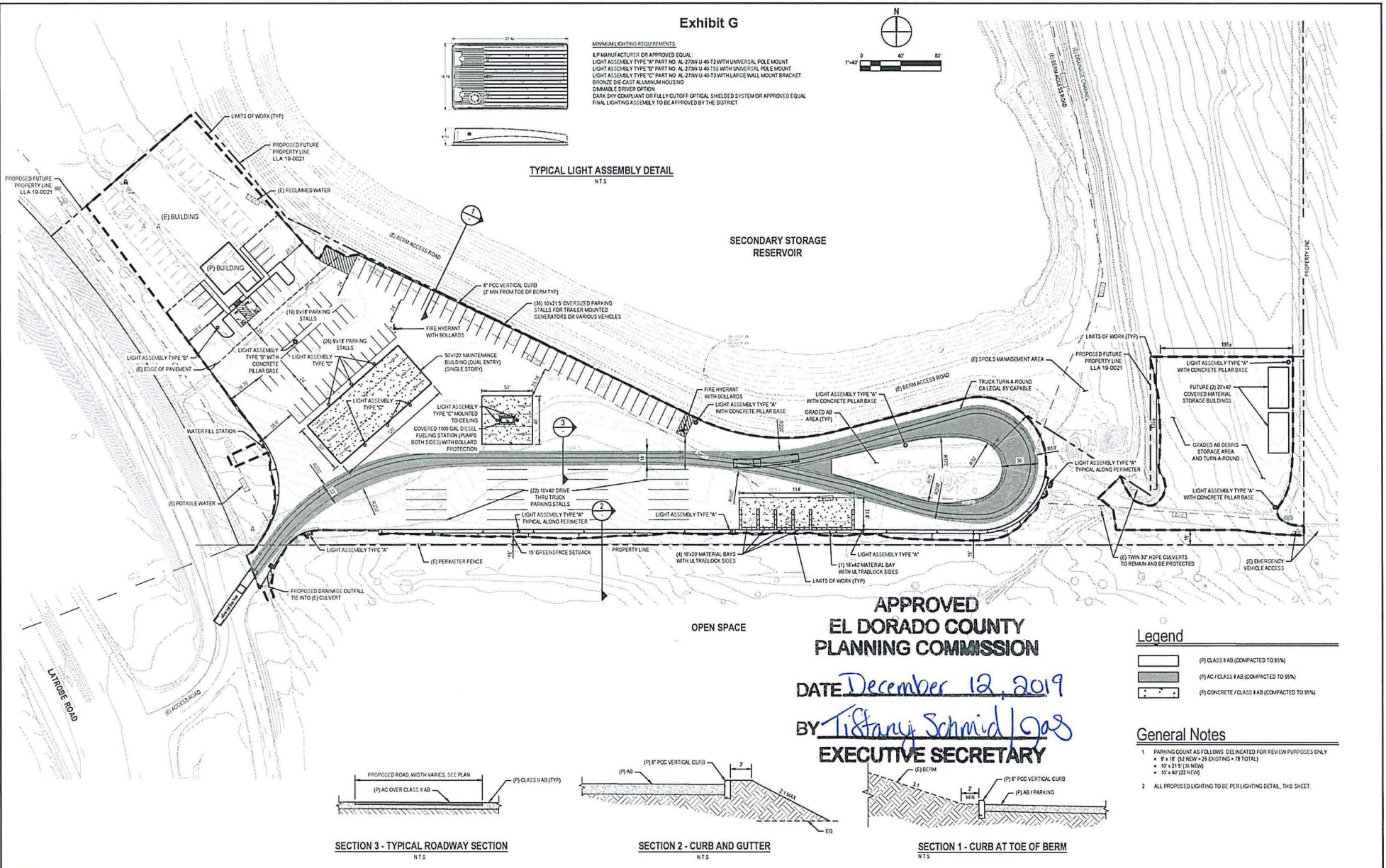

SECONDARY STORAGE RESERVOIR

APPROVED
 EL DORADO COUNTY
 PLANNING COMMISSION

DATE December 12, 2019

BY Tiffany Schmid / GAS

EXECUTIVE SECRETARY

Legend

	(P) CLASS # AB (COMPACTED TO 95%)
	(P) AC CLASS # AB (COMPACTED TO 95%)
	(P) CONCRETE CLASS # AB (COMPACTED TO 95%)

- General Notes**
- PARKING COUNT AS FOLLOWS: DELINEATED FOR REVIEW PURPOSES ONLY
 - 9' x 18' (21 NEW + 25 EXISTING = 46 TOTAL)
 - 10' x 24' (31 NEW)
 - 10' x 42' (22 NEW)
 - ALL PROPOSED LIGHTING TO BE PER LIGHTING DETAIL, THIS SHEET

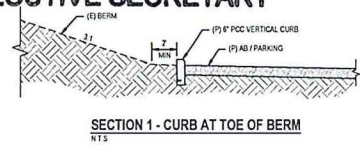
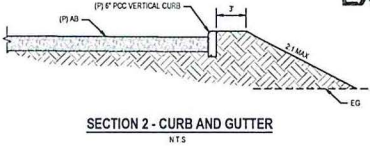
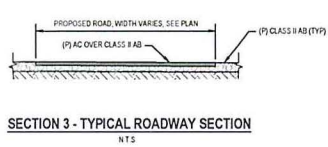

NO.	DATE	BY	CHK.	APP.

GHD
 GEOTECHNICAL ENGINEERING
 10000 DEER CREEK ROAD, SUITE 100
 DENVER, CO 80231
 TEL: 303.751.1000
 WWW.GHD.COM

DESIGNED BY: PEM
 PREPARED BY: GCM
 CHECKED BY: GCM
 DATE: AS NOTED

EL DORADO IRRIGATION DISTRICT
 2890 MOSQUITO ROAD - P. O. BOX 1047
 PLACERVILLE, CALIFORNIA 95667

EL DORADO HILLS WASTEWATER COLLECTION FACILITY
 RELOCATION IMPROVEMENTS
 SITE PLAN

DATE	09/27/2019	2
PROJECT NO.	11159163	01
DWG. NO.	C1.1	7



COMMUNITY DEVELOPMENT SERVICES PLANNING & BUILDING DEPARTMENT

2850 Fairlane Court, Placerville, CA 95667
Phone (530) 621-5355, Fax (530) 642-0508

Date: February 19, 2020

To: Memo to the File (Conditional Use Permit CUP19-0005)

From: Rommel (Mel) Pabalinas, Current Planning Manager 

Subject: Correction to Project Site Plan Reference under Condition of Approval No.1

This memo is to formally document the minor correction to the reference on the project Site Plan under Condition of Approval No.1. Specifically, the condition referenced Exhibit F, which is a Zoning Exhibit, while the correct exhibit (labeled El Dorado Hills Wastewater Collection Facility Relocation Improvements Site Plan) is Exhibit G. For purposes of this memo, Exhibit G shall be stamped approved for the project.

Exhibit F

