



**COUNTY OF EL DORADO
DEPARTMENT OF TRANSPORTATION**



APPLICATION FOR ROAD CLOSURE

THIS APPLICATION MUST BE SUBMITTED AT LEAST 60 DAYS PRIOR TO THE ROAD CLOSURE DATE

APPLICATION RECEIVED BY: Sheri DATE: 5/25/10
 TITLE OF EVENT: 4th of July Parade & Celebration
 TYPE OF EVENT: Parade
 SPONSORING ORGANIZATION: Garden Valley Community Association
 ESTIMATED NUMBER OF PARTICIPANTS: under 100
 DATE OF ROAD CLOSURE: July 4, 2010 Sunday
 START TIME: 10:00 am COMPLETION TIME: 11:00 Am
 ROAD(S) TO BE CLOSED: Marshall Road between Greenwood Rd and Garden Valley Rd

NOTE: THE ATTACHED SUPPLEMENTAL SHEET AND SKETCH SHALL BE COMPLETED IF MORE THAN ONE COUNTY ROAD IS TO BE CLOSED

SUBMITTED BY: Judy Ryland/Wes Norman DATE: 5/25/10
 CONTACT PERSON: Judy Ryland PHONE/FAX: 333-1178 F 333-2023
 ADDRESS: PO Box 143 Garden Valley Ca 95633

THE FOLLOWING CONDITIONS ARE REQUIRED FOR ALL ROAD CLOSURES:

1. The organizers shall provide a detailed signing and detour plan for any proposed closure of a major county road. This signing/detour plan should identify the type and location of all signs, barricades, cones, and flaggers. The plan must be attached to this application when it is submitted for review.
2. The organizers shall provide proof that the owners of the adjacent business along the road closure are in agreement with proposed closure. These agreements must be attached to this application when it is submitted for review.
3. The organizers shall be responsible for providing all signs, barricades, cones, flaggers, and traffic controls.
4. Wooden barricades shall be placed across the County road to close the road. Barricades shall also be placed across all intersecting roads to deny access to the closed road.
5. A "ROAD CLOSED" sign shall be placed at each barricaded intersection. Each sign shall measure at least 48 inches by 30 inches, with 8 inch black letters on a white background.
6. The organizers shall remove all signs, all pavement markings or other materials immediately following the event. The organizers shall also remove all debris deposited by participants and spectators.
7. The organizers shall provide a Certificate of Insurance, naming El Dorado County Department of Transportation additionally insured, in the amount of \$1,000,000.00 (one million dollars) as required by the El Dorado County Risk Manager.
8. To the fullest extent allowed by law the Organizer shall defend, indemnify, and hold the County harmless against and from any and all claims, suits, losses, damages, and liability for damages of every name, kind and description, including attorney's fees and costs incurred, brought for, or on account of, injuries to or death of any person, including but not limited to workers, County employees, and the public, or damage to property, or in anyway arise out of are connected with the work by the Organizer, his agents or employees including contractor's services, operation or performance hereunder, regardless of the existence or degree of fault or negligence on the part of the County, the Organizer, contractor, subcontractor(s) and employee(s) or any of these, except for part of the sole, or active negligence of the County, its officers and employees, or as expressly prescribed by statute. This duty of the Organizer to indemnify and save the County harmless includes the duties to defined set forth in California Civil Code Section 2778.

SIGNATURE: Wesley Norman DATE: 5/25/10

I HAVE READ, ACKNOWLEDGE AND AGREE TO ALL OF THE ABOVE CONDITIONS WITH REGARD TO THIS ROAD CLOSURE. 10-0597.A.1

CERTIFICATE OF COVERAGE

ISSUE DATE:

06/04/10

<p>PRODUCER: Alliant Insurance Services, Inc. P.O. BOX 6450 NEWPORT BEACH, CA 92658-6450 PH (949) 756-0271 / FAX (949) 756-2713 LICENSE NO. 0C36861</p>	<p>THIS CERTIFICATE IS ISSUED AS A MATTER OF INFORMATION ONLY AND CONFERS NO RIGHTS UPON THE CERTIFICATE HOLDER. THIS CERTIFICATE DOES NOT CONSTITUTE A CONTRACT BETWEEN THE ISSUING INSURER(S), AUTHORIZED REPRESENTATIVE OR PRODUCER, AND THE CERTIFICATE HOLDER.</p>
COMPANIES AFFORDING COVERAGE	
<p>INSURED: CALIFORNIA ASSOCIATION OF PARK AND RECREATION INDEMNITY MEMBER: GEORGETOWN DIVIDE RECREATION DISTRICT P.O. BOX 1418 GEORGETOWN, CA 95634</p>	<p>COMPANY LETTER (A) CALIFORNIA ASSOCIATION OF PARK AND RECREATION INDEMNITY</p>
	COMPANY LETTER (B)
	COMPANY LETTER (C)
	COMPANY LETTER (D)
	COMPANY LETTER (E)
	COMPANY LETTER (F)

COVERAGES

THIS IS TO CERTIFY THAT THE MEMORANDUM OF COVERAGE OR POLICY(IES) LISTED BELOW HAVE BEEN ISSUED TO THE INSURED NAMED ABOVE FOR THE POLICY OR MEMORANDUM PERIOD INDICATED. NOTWITHSTANDING ANY REQUIREMENT, TERM OR CONDITION OF ANY CONTRACT OR OTHER DOCUMENT WITH RESPECT TO WHICH THIS CERTIFICATE MAY BE ISSUED OR MAY PERTAIN, THE COVERAGES AFFORDED BY THE MEMORANDUM OR POLICY(IES) DESCRIBED HEREIN ARE SUBJECT TO ALL THE TERMS, EXCLUSIONS, AND CONDITIONS OF SUCH MEMORANDUM OR POLICY. LIMITS MAY HAVE BEEN REDUCED BY PAID CLAIMS.

CO LTR	TYPES OF COVERAGES	MEMORANDUM OR POLICY NUMBER	MEMORANDUM OR POLICY EFFECTIVE	MEMORANDUM OR POLICY EXPIRES	LIMIT	
A	GENERAL LIABILITY OCCURRENCE FORM	2009	07/01/09	07/01/10	BODILY INJURY AND PROPERTY DAMAGE COMBINED	\$1,000,000

DESCRIPTION OF OPERATIONS/LOCATIONS/VEHICLES/RESTRICTIONS/SPECIAL ITEMS:
 AS RESPECTS STREET CLOSURE OF GREENWOOD ROAD, MARSHALL ROAD, & SMALL PORTION OF GARDEN VALLEY ROAD. ACTIVITIES TO BE HELD ON JULY 4TH..

EL DORADO COUNTY DEPARTMENT OF TRANSPORTATION IS INCLUDED AS ADDITIONAL INSURED PER ATTACHED CERTIFICATE OF COVERAGE.

THIS CERTIFICATE REPLACES CERTIFICATE ISSUED ON 5/11/10.
SUBJECT TO POLICY TERMS, CONDITIONS AND EXCLUSIONS.

CERTIFICATE HOLDER

EL DORADO COUNTY
 DEPARTMENT OF TRANSPORTATION
 2850 FAIR LANE COURT
 PLACERVILLE, CA 95667

SHOULD ANY OF THE ABOVE DESCRIBED POLICIES BE CANCELLED BEFORE THE EXPIRATION DATE THEREOF, NOTICE WILL BE DELIVERED IN ACCORDANCE WITH THE MEMORANDUM OF COVERAGE.

AUTHORIZED REPRESENTATIVE

CALIFORNIA ASSOCIATION FOR PARK AND RECREATION INDEMNITY (CAPRI)

CERTIFICATE OF COVERAGE ATTACHMENT

This is to certify that the person or organization named has been recognized as an additional covered entity by the California Association for Park and Recreation Indemnity (CAPRI) under the 2009-2010 Memorandum of Coverage.

The **PERSONS OR ENTITIES COVERED** provision is amended to extend coverage to the persons or entity named below. This coverage is intended to be primary protection, but only with respects to liability arising out of the operations and/or programs of the Member District also named below, or the use of property leased or rented to the Member District.

MEMBER DISTRICT:

GEORGETOWN DIVIDE RECREATION DISTRICT
P.O. BOX 1418
GEORGETOWN, CA 95634

CERTIFICATE HOLDER:

EL DORADO COUNTY
DEPARTMENT OF TRANSPORTATION
2850 FAIR LANE COURT
PLACERVILLE, CA 95667

ADDITIONAL COVERED ENTITY:

EL DORADO COUNTY DEPARTMENT OF TRANSPORTATION

DESCRIPTION OF OPERATIONS/LOCATION/VEHICLES/SPECIAL TERMS
for which this certification of coverage is being issued:

AS RESPECTS STREET CLOSURE OF GREENWOOD ROAD, MARSHALL ROAD, & SMALL PORTION OF GARDEN VALLEY ROAD. ACTIVITIES TO BE HELD ON JULY 4TH..

TERMS AND CONDITIONS

Notwithstanding any requirements, terms or conditions of any other contract or documents with respects to which this certification may be issued or may pertain, the coverage provided by the CAPRI memorandum of coverage is subject to all the terms conditions and exclusions of the 2009-2010 memorandum of coverage.

Date Issued: 6/4/2010

AI



**ALLIANT NATIONAL MUNICIPAL
LIABILITY (ANML) PROGRAM
JULY 1, 2009 TO JULY 1, 2010
NAMED INSURED**

MEMBER: California Association for Park and
Recreation Indemnity (CAPRI)
6341 Auburn Boulevard, Suite A
Citrus Heights, CA 95621

NAMED INSURED:

California Association for Park and Recreation Indemnity (CAPRI) and Participating Members:

Almanor Recreation and Park Dist	Lake Cuyamaca Recreation and Park Dist
Ambrose Recreation and Park Dist	Livermore Area Recreation and Park Dist
Arcade Creek Recreation and Park Dist	McFarland Recreation and Park Dist
Arden Manor Recreation and Park Dist	Mendocino Coast Recreation and Park Dist
Arden Park Recreation and Park Dist	Mission Oaks Recreation and Park Dist
Auburn Area Recreation and Park Dist	Monte Rio Recreation and Park Dist
Bear Mountain Recreation and Park Dist	Mt. Shasta Recreation and Parks Dist
Bear River Recreation and Park Dist	North County Recreation Dist
Beaumont-Cherry Vly Recreation and Park Dist	North Highlands Recreation and Park Dist
Boulder Creek Recreation and Park Dist	North of the River Recreation and Park Dist
Buttonwillow Recreation and Park Dist	Orangevale Recreation and Park Dist
Carmichael Recreation and Park Dist	Paradise Recreation and Park Dist
Central Plumas Recreation Dist	Pleasant Hill Recreation and Park Dist
Coalinga-Huron Recreation and Park Dist	Pleasant Valley Recreation and Park Dist
Cordova Recreation and Park Dist	Rancho Simi Recreation and Park Dist
Desert Recreation Dist	Rim of the World Recreation and Park Dist
fka: Coachella Valley Recreation and Park Dist	Rio Linda-Elverta Recreation and Park Dist
Dunsmuir Recreation and Parks Dist	Russian River Recreation and Park Dist
Durham Recreation and Park Dist	Shafter Recreation and Park Dist
Fair Oaks Recreation and Park Dist	Silverado-Modjeska Recreation and Park Dist
Feather River Recreation and Park Dist	Soledad Mission Recreation Dist
Fulton-El Camino Recreation and Park Dist	Strawberry Recreation Dist
Georgetown Divide Recreation Dist	Sunrise Recreation and Park Dist
Greater Vallejo Recreation Dist	Tehachapi Valley Recreation and Park Dist
Hayward Area Recreation and Park Dist	Truckee-Donner Recreation and Park Dist
Hesperia Recreation and Park Dist	Tuolumne Park and Recreation Dist
Highlands Recreation Dist	Valley-Wide Recreation and Park Dist
Isla Vista Recreation and Park Dist	Wasco Recreation and Park Dist
Jurupa Area Recreation and Park Dist	Weed Recreation and Park Dist
La Selva Beach Recreation and Park Dist	West Side Recreation and Park Dist
Ladera Recreation Dist	

SKETCH FOR ROAD CLOSURES AND PARADES

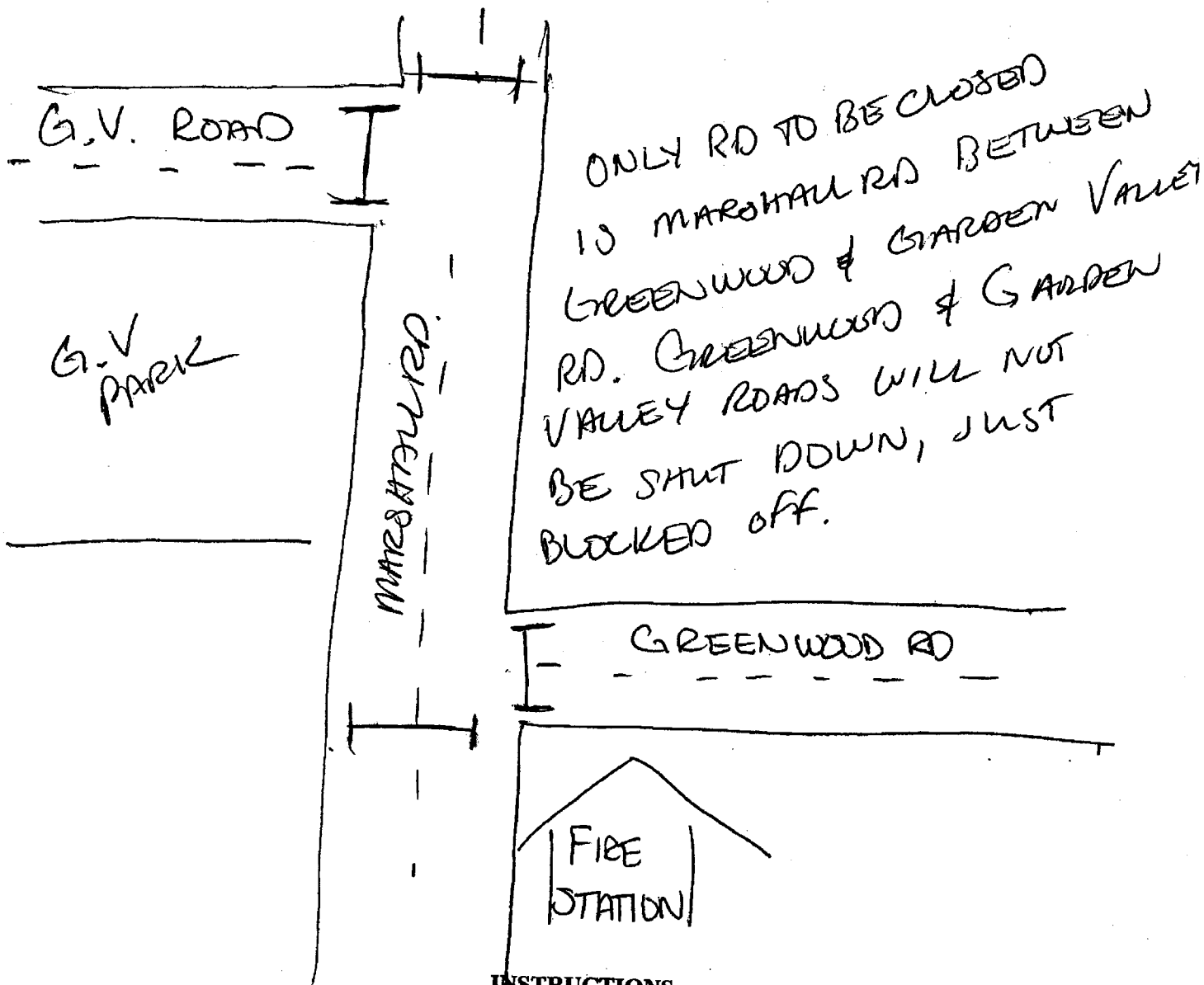

INSTRUCTIONS

1. Sketch all roads to be occupied and label roads name.
2. Indicate all intersecting public roads along route.
3. Indicate "START" and "FINISH" location of event.
4. Indicate direction of travel for the participants.

I - Barricade

NOTE: This sketch may serve as the "SIGNING/DETOUR PLAN" if it clearly identifies the type and location of all proposed sign, barricades, cones, and flaggers.