

Alfa Omega Associates

Management Consulting • Public Relations • Publicity
Specializing in Environmental Organizational Management

3410 Sunshine Way • Auburn, CA 95602-9284

Tel/Fax: 530-888-1523 • Cell: 530-308-2689

E-mail: drdalesmith@aoaconsult.net

Dr. Dale Smith, H.H.D., General Manager

JUL 24 PM 3:09
RECEIVED
PLANNING DEPARTMENT

July 24, 2009

Letter and documents delivered to EDC Planning at 3:08 pm
7/24/09

Ms. Lillian MacLeod
Senior Planner
El Dorado County
2850 Fairlane Court
Placerville, CA 95667

Re: DR00-11/76 Gas Station/Circle K Mini Mart Project Appeal Process - Report from FSSI Traffic Expert, Daniel T. Smith

Dear Ms. MacLeod.

We are continuing our best efforts to complete the filing of materials for the above project's Administrative Record prior to the August 4, 2009 hearing and this letter covers some very important information from our Traffic Expert, Daniel T. Smith.

This material requires that we present hard copy of figures submitted on behalf of the applicant as contained in the EIR and County staff reports. However, as I write this letter on Friday morning I still do not have the hard copy referred to in the following detail from Dan T. Smith. He writes:

These documents Figures 2.0-1, 2.0-2 and 2.0-4 (the missing figures from the EIR that were only made available at the Planning Commission meeting in May, 2009) and Exhibits E (Site Plan), J (Landscape Plan), and K (Sign Program) that have been incorporated in the record in the staff reports for the last several hearings of the Planning Commission and Board of Supervisors in this matter.

The copy of Figure 2.0-4 is a transparency; the others are ordinary paper copies. The reason for the transparency follows.

As I examined Figures 2.0-1, 2.0-2 and 2.0-4, I noticed that there appeared to be a difference in the site layout between Figure 2.0-4 and the other two. This can best be seen by placing the transparency of Figure 2.0-4 over either of Figures 2.0-1 or 2.0-2, matching the overlay at the property line.

It becomes immediately evident that the locations of the fuel dispensers in Figure 2.0-4 are shifted about 20 feet north from their positions in Figures 2.0-1 and 2.0-2. The overlay also makes it evident that if the fuel dispenser locations shown on Figures 2.0-1 and 2.0-2 are

**Letter to El Dorado County Planning Department - DR00-11/76 Gas Station/Circle K
Mini Mart Project Appeal Process - FSSI Traffic Expert, Dan T. Smith Report
7-24-09 - Page 2 of 2**

correct, the fuel tanker depicted on Figure 2.0-4 cannot safely maneuver through the station. The overlay also makes evident that positioning of the driveway cuts on Figure 2.0-4 is substantially discrepant from what is shown on Figures 2.0-1 and 2.0-2.

The overlay can be used in another way. If one assumes that the dispenser positioning on Figure 2.0-4 is correct, slide the transparency of 2.0-4 over Figure 2.0-1 so that the figures match at the dispenser positions instead of at the property lines. This shows that the RV-trailer combination cannot make the maneuver indicated on Figure 2.0-1 without encroaching on the parking spaces and landscape island at the northwest corner of the mini-mart building as depicted on Figure 2.0-4.

The applicant cannot have the site plan both ways. Either the fuel tanker cannot safely make the necessary maneuvers or the RV-trailer combination cannot do so. But which depiction is correct? We placed the transparency of Figure 2.0-4 above the applicant's depictions of the site layout as per Site Plan, Landscape Plan and Sign Program that were included as Exhibits E, J and K of the County Staff Reports in this matter.

Although the transparency of Figure 2.0-4 is slightly different from Exhibits E, J and K, it is evident that the fuel dispenser placement on these exhibits all coincide with Figures 2.0-1 and 2.0-2 not with 2.0-4.

This is a critical discrepancy which is more than just a technical flaw in the EIR. The fact that the fuel tanker cannot safely negotiate the actual site plan is a fatal flaw - a crucial public safety deficiency of the plan.

/s/ Daniel T. Smith

Daniel T. Smith, Smith Engineering & Management

Dale Smith continuing on this subject. We have repeatedly raised issues and defects clearly on the County's position and materials with the comprehensive and detailed analyses provided by our traffic expert regarding all aspects of the present situation. So far they have been virtually ignored, with minimal effort to controvert the factual findings and legal assertions provided by Mr. Dan Smith.

Once more we are submitting critical information and documents from our highly qualified expert that indeed, do have a profound bearing on our careful delineation of the safety factors involved.

Sincerely yours,
Dale Smith, H.H.D., Alfa Omega Associates for:
Friends of Shingle Springs Interchange, Inc.

Cc: Counsel - J.R. Kidder - Dan T. Smith - Master AR Record

AOA-FSSI Notice to EDC 8-04-09 BOS Appeal Hearing - 7-24-09.doc

09-1017.N.67

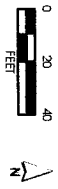
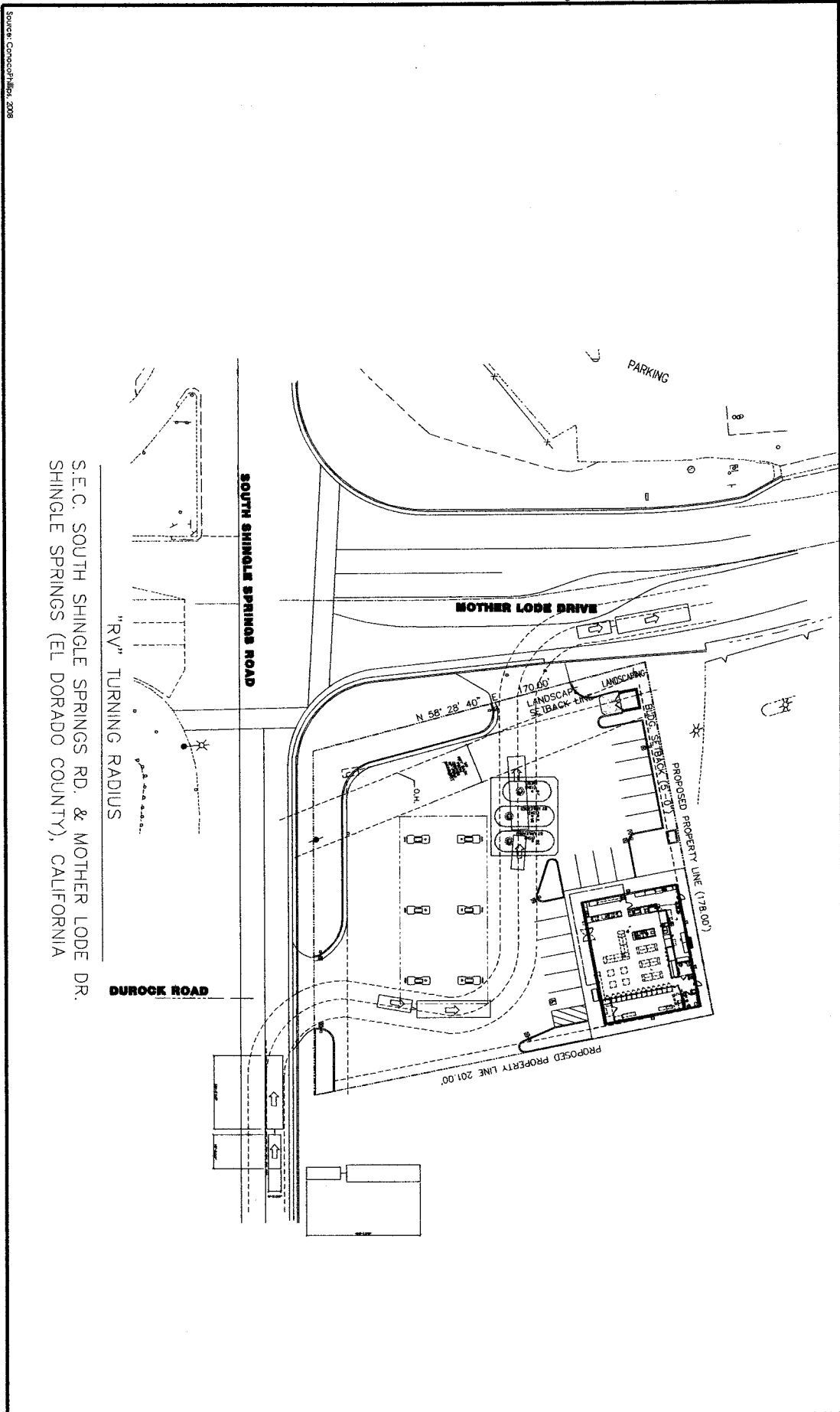

Source: ConceptPlan, 2008

S.E.C. SOUTH SHINGLE SPRINGS RD. & MOTHER LODGE DR.
SHINGLE SPRINGS (EL DORADO COUNTY), CALIFORNIA

Figure 2.0-1
RV Turn Radius Entering From South Shingle Springs Road



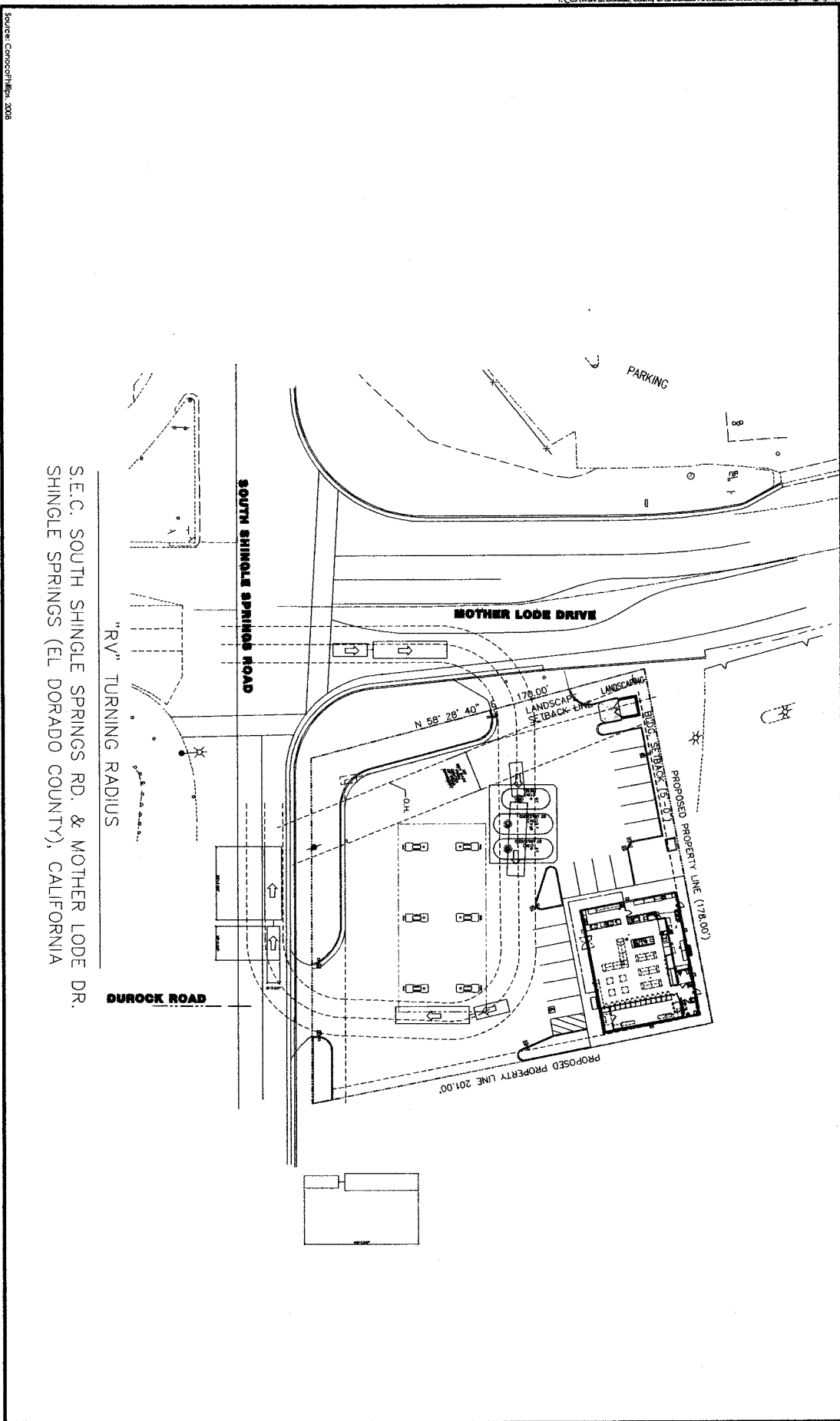

Source: ConceptPlan, 2008

S.E.C. SOUTH SHINGLE SPRINGS RD. & MOTHER LODGE DR.
SHINGLE SPRINGS (EL DORADO COUNTY), CALIFORNIA

RV Turn Radius Entering From Mother Lode Drive
PMG

Conoco Phillips COMPANY
 3011 HARBOR BLVD # 200, SANTA ANA, CA
 STORE#: 00000
 ADDRESS: SEC. SOUTH SHINGLE SPRINGS RD. & MOTHER LODGE DR.
 SHINGLE SPRINGS (EL DORADO COUNTY), CALIFORNIA

PLANS PREPARED BY:
 A & S ENGINEERING
 PLANNING MEMBERSHIP CONSTRUCTION MANAGEMENT
 20214 2027 W. ALAMIDA AVE. STE 202 BIRMINGHAM, CA 91704
 PHONE: 916-942-2044 FAX: 916-942-2700



DATE: P1
 SHEET NO.:
 SHEETS:
 01-15-06
 DATE: 09-15-06
 09-15-06
 PREPARED BY: P1
 CHECKED BY: P1
 DRAWN BY: P1

SCOPE OF WORK

- CONSTRUCT 62'x48' FOOD MART.
- CONSTRUCT 62'x48' CANOPY.
- CONSTRUCT NEW FUELING SYSTEM WITH 8 DISPENSERS.
- INSTALL NEW UNDERGROUND TANKS.

SCOPE OF WORK

SITE INFORMATION

ITEM	SIZE	LOT %	AREA (SQ.FT.)
TOTAL LOT AREA AS SHOWN	N/A		31,883.17
FOODMART	62' x 48'	9.33	2,976.00
CANOPY	93' x 43'	12.54	3,999.00
LANDSCAPING	AS SHOWN	15.06	4,802.07

PARKING: 1-17'x118' HANDICAP PARKING
 15-9'x18' STANDARD PARKING

Approved by: _____ Date: _____

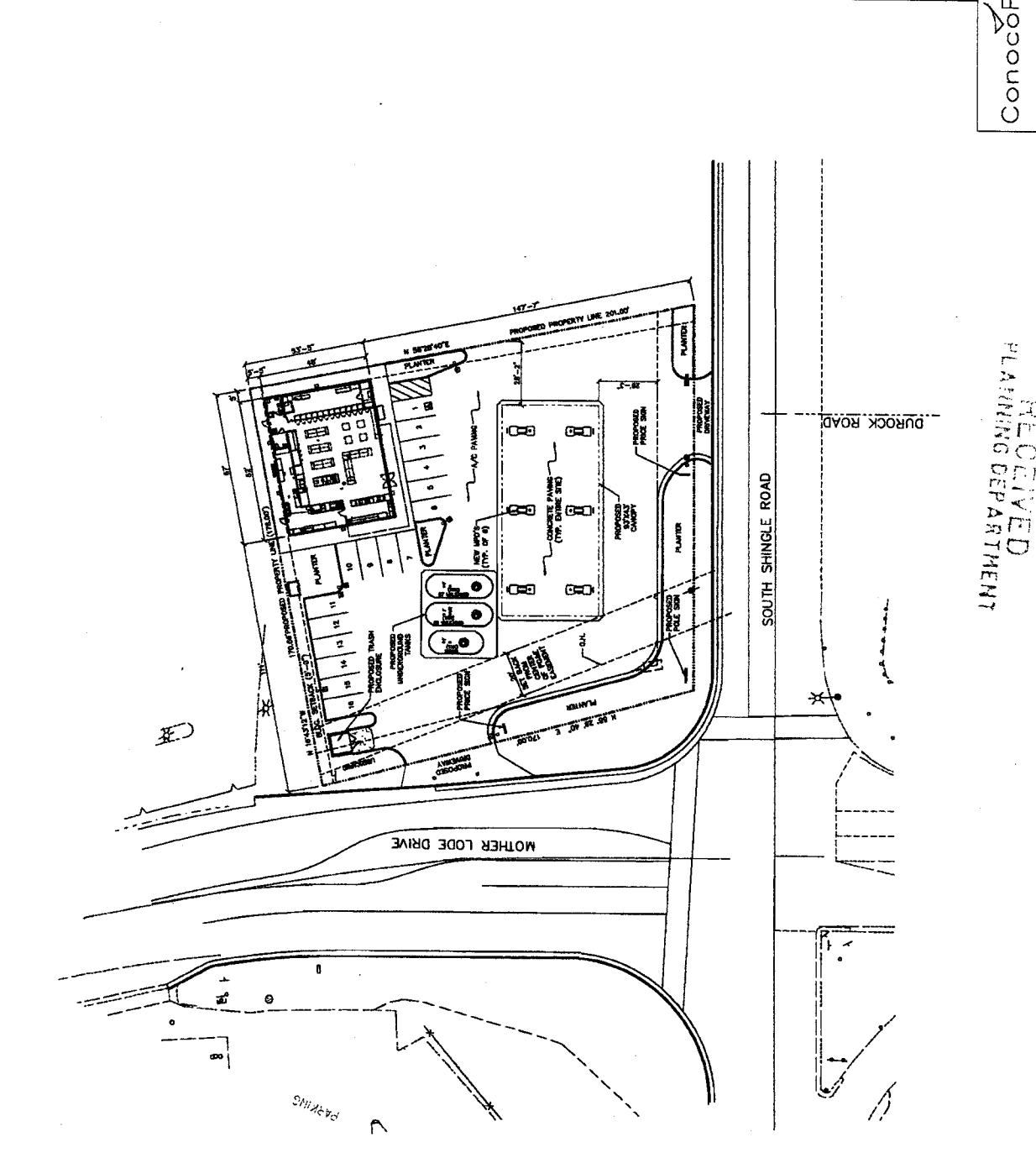
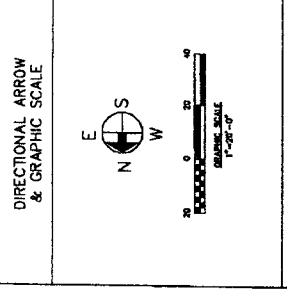

RECEIVED
 PLANNING DEPARTMENT
 00 SEP 25 PM 2:45

00 SEP 25 PM 2:45

DR 00-0011

EXHIBIT E

09-117.N.70

IF YOU HAVE ANY COMMENTS ON THESE PLANS, PLEASE CONTACT THE ENGINEER OR ARCHITECT AT THE ADDRESS LISTED BELOW. YOUR COMMENTS SHOULD BE SUBMITTED IN WRITING AND RECEIVED BY THE ENGINEER OR ARCHITECT WITHIN THE PERIOD SPECIFIED. OTHERWISE, THE PLANS WILL BE CONSIDERED AS SHOWN AND YOU WILL BE RESPONSIBLE FOR ANY ERRORS OR OMISSIONS. THE ENGINEER OR ARCHITECT IS NOT RESPONSIBLE FOR ANY ERRORS OR OMISSIONS IN THESE PLANS. THE ENGINEER OR ARCHITECT IS NOT RESPONSIBLE FOR ANY ERRORS OR OMISSIONS IN THESE PLANS. THE ENGINEER OR ARCHITECT IS NOT RESPONSIBLE FOR ANY ERRORS OR OMISSIONS IN THESE PLANS.



Plans prepared by
A & S ENGINEERING
 3871 HARBOR BLVD 2ND FLOOR, SAN FRANCISCO, CALIF. 94132
 PHONE: 415-398-4200 FAX: 415-398-4222

CONOCO Phillips COMPANY
 STORE#: 00000
 ADDRESS: 3521 SOUTH SHINGLE SPRINGS RD. & MOTHER LODE DR.
 SHINGLE SPRINGS (EL DORADO COUNTY), CALIFORNIA

DATE: 09-11-97
 DRAWN BY: [blank]
 CHECKED BY: [blank]
 APPROVED BY: [blank]
 L1

Notes:
 1. Quantities of plant materials shall be furnished to complete the work as shown on this drawing. All quantities are based on the quantities shown on the drawing. Should it appear that the work to be done is not sufficiently detailed or specified on these plans, the contractor shall contact the landscape architect for further determination as may be necessary.

Planting Legend

QTY.	SIZE	BOTANICAL NAME	COMMON NAME
4	24" box	Quercus Lobata	VALLEY OAK
7	15 gal	Legnistraindia Indica	CRANE MYRTLE
13	5 gal	Pinus m. Mugo	MUGHO PINE
12	5 gal	Barberis L. Alpurguruse	JAPANESE BARBERY
68	5 gal	Rhododendron L. Pink Cloud	INDIAN HAWTHORN
22	5 gal	Escallonia	DWARF ESCALLONIA
3	5 gal	Yucca filamentosa polytrichum	PINK JASMINE

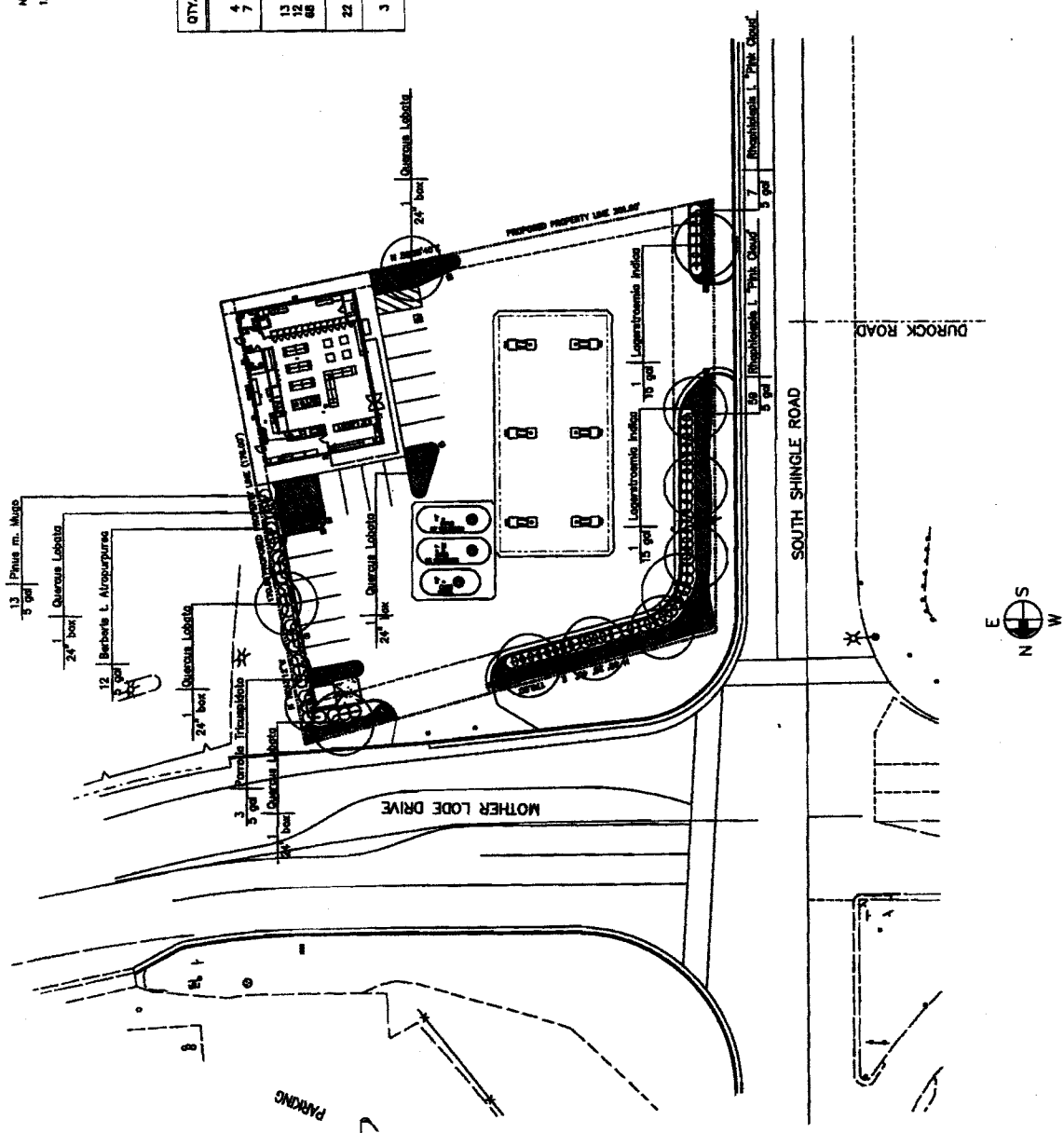

RECEIVED
 PLANNING DEPARTMENT
 SEP 25 PM 2:45

ConocoPhillips
 Approved by: [blank]
 Date: [blank]

EXHIBIT J

09-1017.N.71

DR 00-0011



PLANS PREPARED BY:
A & S ENGINEERING
103 S. PALMER AVE. 2ND FLOOR, COSTA MESA, CA 92626
PHONE (714) 442-8244 FAX (714) 442-2760

CONOCO PHILLIPS COMPANY
3811 HARBOR BLVD. 2ND FLOOR, SMITH AVENUE, CA
STORE#: 00000
ADDRESS: SEC. SOUTH SHINGLE SPRINGS RD. & MOTHER LODGE DR.
SHINGLE SPRINGS (LA. DORADO COUNTY), CALIFORNIA

DATE	
BY	
CHECKED BY	
DATE	
DESIGNED BY	
DATE	
PROJECT NO.	

SP1

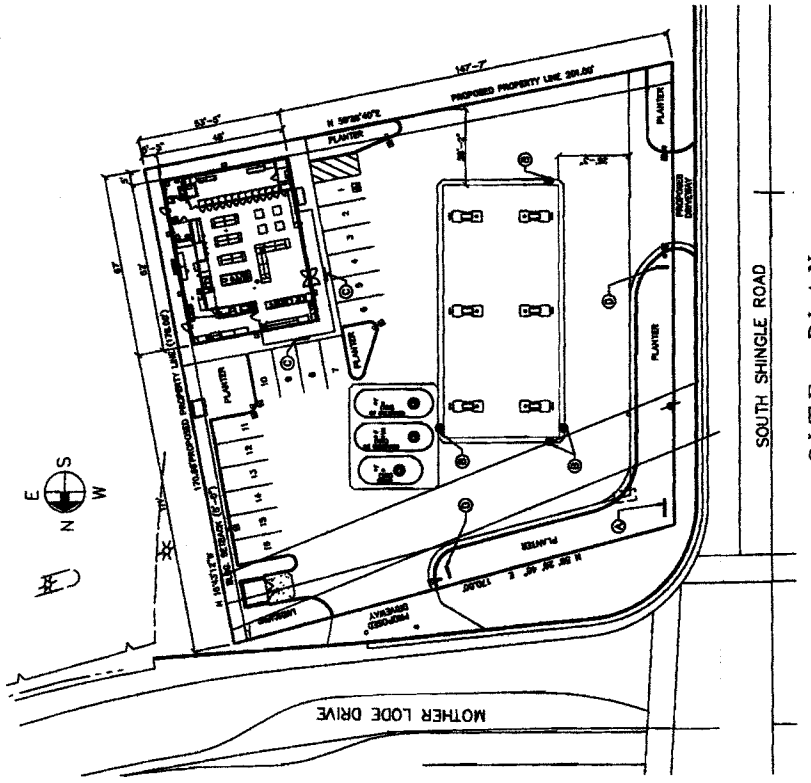

RECEIVED
PLANNING DEPARTMENT
09-SEP-25 PM 2:15

ConocoPhillips

Approved by: _____
Date: _____

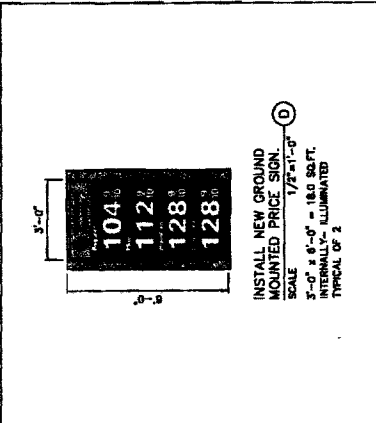
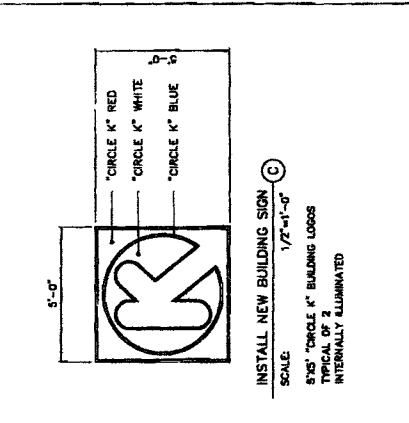

SIGN INFORMATION		TOTAL	
NO.	SIZE OF SIGN	SQ. FT. SIGN	SQ. FT.
A	5'-0" x 14'-3 5/16"	71.38	71.38
B	36"	7.06	28.24
C	5'-0" x 8'-0"	25.00	50.00
D	3'-0" x 8'-0"	18.00	36.00
TOTAL AREA (SQUARE FEET):			185.62

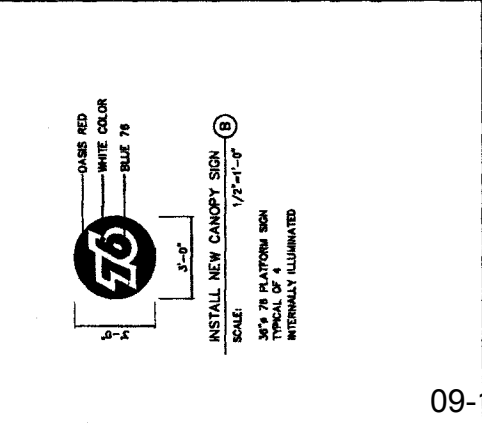
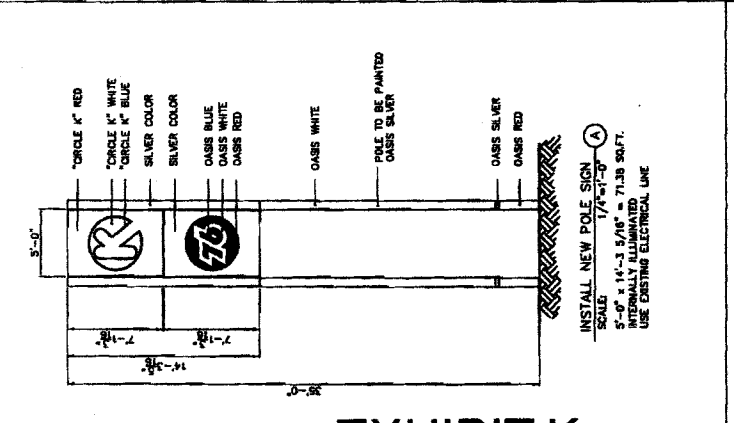
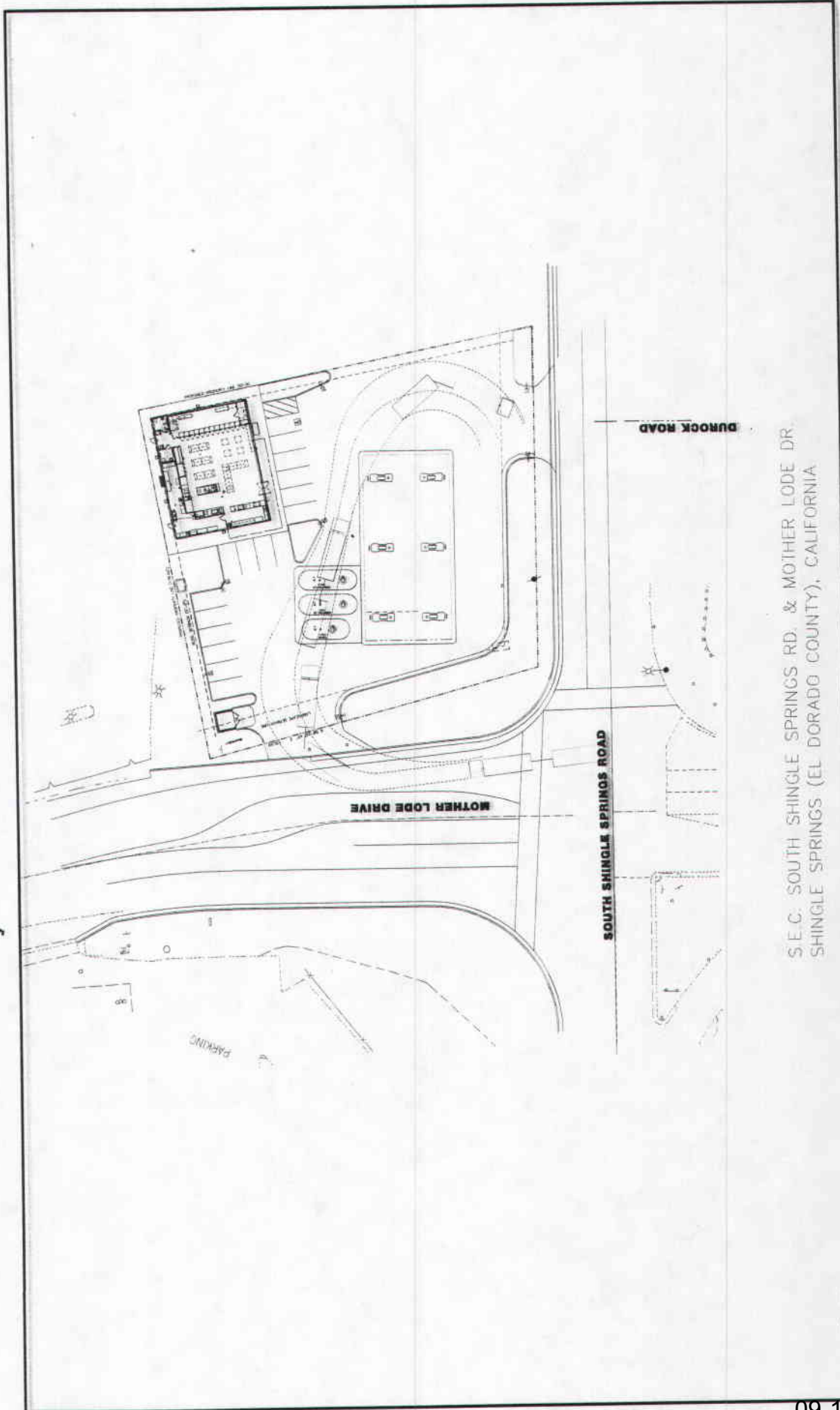

EXHIBIT K

DR 00-0011



S.E.C. SOUTH SHINGLE SPRINGS RD. & MOTHER LODE DR
 SHINGLE SPRINGS (EL DORADO COUNTY), CALIFORNIA

Figure 2.0-4
 Fuel Tanker Turn Radius
 PMC