

Recorded in Official Records
County of El Dorado
Janelle K. Horne
Recorder-Clerk

2025-0034631

12/03/2025
09:38:29 AM
PL
GL

Titles: 1 Pages: 5

Fees: \$0.00
Taxes: \$0.00
CA SB2 Fee: \$0.00
Total: \$0.00



Recording Requested by:
Board of Supervisors

When Recorded Mail to:
Board of Supervisors
330 Fair Lane
Placerville, CA 95667

TITLE

**RESOLUTION 175-2025
OF THE BOARD OF SUPERVISORS OF THE COUNTY OF EL DORADO**

Abandonment of Easement No. 25-0009
Geoffrey Alan Goodman and Lise A. Vernasco, Trustees of the Goodman/Vernasco Revocable Trust



RESOLUTION NO. 175-2025

OF THE BOARD OF SUPERVISORS OF THE COUNTY OF EL DORADO

Abandonment of Easement No. 25-0009

Assessor's Parcel Number 104-400-028

Geoffrey Alan Goodman and Lise A. Vernasco, trustees of the Goodman/Vernasco Revocable Trust

WHEREAS, the El Dorado County Board of Supervisors exercises the authority established by Section 8333 of the Streets and Highways Code, which authorizes the Board of Supervisors to summarily vacate public service easements by Resolution adopted in accordance with Section 8335 of the Streets and Highways code; and

WHEREAS, on , June 6th, 1986, The Shriners Hospital for Crippled Children, a Corporation executed the recordation of a Parcel Map illustrating a 50' non-exclusive road and public utility easement as shown on said Parcel Map recorded in Book 35 of Parcel Maps at Page 73; and

WHEREAS, the County of El Dorado has received an application from Geoffrey Alan Goodman and Lise A. Vernasco, Trustees of the Goodman/Vernasco Revocable Trust, owners of Parcel A, requesting that the County of El Dorado vacate a portion of the 50' non-exclusive road and public utility easement of said property, identified as Assessor's Parcel Number 104-400-028; and

WHEREAS, AT&T, Comcast, Pacific Gas & Electric, and all private parties having record interest, have not used said portion of said subject easement for the purposes for which it was dedicated and find no present or future need exists for said portion of said subject easement and do not object to its vacation, and to that end, have all issued letters to that effect; and

WHEREAS, the Surveyor's Office has determined that said portion of said subject easement has not been used for the purpose for which it was dedicated and has no objection to its abandonment and wherein Exhibit A describes the portion of said easement to be abandoned and is depicted on Exhibit B ; and

WHEREAS, all other existing easements shall remain.

NOW, THEREFORE, BE IT RESOLVED, that from and after the date this Resolution is recorded, said offer for said portion of said subject easement is terminated and abandoned and no longer constitutes an offer for easement. In addition, a Certificate of Correction, Modification or Amendment is hereby authorized to be signed and recorded.

PASSED AND ADOPTED by the Board of Supervisors of the County of El Dorado at a regular meeting of said Board, held the 2nd day of December, 2025, by the following vote of said Board:

Attest:

Kim Dawson

Clerk of the Board of Supervisors

Ayes: Turnboo, Laine, Parlin, Veerkamp

Noes: None

Absent: Ferrero

By:

Kaylee Runkle
Deputy Clerk



George Turnboo
Chair, Board of Supervisors

EXHIBIT "A"

All that real property situated in the Southeast Quarter of Section 32, Township 11 North, Range 9 East, Mount Diablo Base and Meridian, County of El Dorado, State of California.

Legal description for the abandonment of a portion of that 50 foot Road and Public Utility Easement as shown on Parcel A of that certain Parcel Map filed June 6, 1986 in Book 35 of Parcel Maps at page 73 in the Records Office of said County and State more particularly described as the follows:

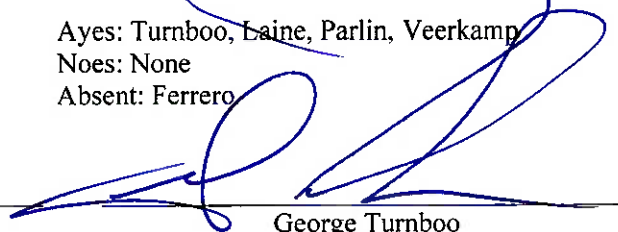
COMMENCING AT a point on the east line of said Parcel A, being marked with 3/4 inch capped iron pipe stamped "RCE 20462", thence North 60° 26' 20" West, 83.10 feet to the POINT OF BEGINNING; thence North 89° 21' 50" West, 75.71 feet to a point from which an angle point on the south line of said Parcel A, also being marked with a similar pipe, bears South 11° 11' 09" West, 42.76 feet, thence North 49° 25' 45" West 25.67 feet to the North line of said easement; thence northeasterly along a non-tangent curve to the right, concave to the southeast, having a radius 106.46 feet, through a central angle of 06° 50' 32", an arc length of 12.71 feet, said curve being subtended by a chord bearing North 86° 32' 10" East, a distance of 12.71 feet; thence South 84° 10' 05" East, 63.12 feet; thence northeasterly along a curve to the left, concave to the northwest, having a radius of 39.49 feet, through a central angle of 29° 21' 47", an arc length of 20.24 feet, said curve being subtended by a chord bearing North 80° 31' 51" East, a distance of 20.02 feet; thence leaving the North line of said easement South 00° 05' 37" West, 15.18 feet to the POINT OF BEGINNING.

Containing 1,216 square feet, more or less.

See Exhibit "B" attached hereto and made part of this description.

END OF DESCRIPTION

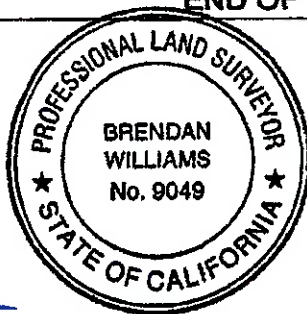

Brian

Brendan Williams, PLS 9049

9-8-2025

Date

EXHIBIT "B"

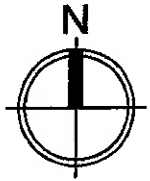

SCALE=1:30

PARCEL A
P.M. 35-73

RECORD BOUNDARY OF
PARCEL 'A' PER P.M. 35-73

NORTH EDGE OF 50' ROAD AND
PUBLIC UTILITY EASEMENT PER
P.M. 35-73

RAD.=106.46' Δ=06°50'32"
CHB=N86°32'10"E CHD=12.71'

EDGE OF
EXISTING DECK

RAD.=39.49' Δ=29°21'47"
CHB=N80°31'51"E CHD=20.02'

S84°10'05"E 63.12'

AREA TO BE ABANDONED

S00°05'37"W 15.18'

POINT OF BEGINNING

N49°25'45"W
25.67'

N89°21'50"W 75.71'

N60°26'20"W 83.10'

EDGE OF GRAVEL
ROAD WIDTH VARIES

S11°11'09"W 42.76'
(TIE)

POINT OF
COMMENCEMENT

SOUTH EDGE OF 50' ROAD AND
PUBLIC UTILITY EASEMENT PER
P.M. 35-73

RECORD BOUNDARY OF
PARCEL 'A' PER P.M. 35-73

3/4" CAPPED IRON PIPE, STAMPED "RCE 20462" PER P.M. 35-73

PARTIAL ABANDONMENT OF
50' ROAD & PUBLIC UTILITY EASEMENT
3001 JASPER CIRCLE

1 OF 1

SHEET NO.

09-2025

COUNTY OF EL DORADO

STATE OF CALIFORNIA