



ORDINANCE NO. 5031

THE BOARD OF SUPERVISORS OF THE COUNTY OF EL DORADO DOES ORDAIN AS FOLLOWS:

RELATED TO REZONING IN THE MEEKS BAY AREA, (John and Kirsten Dryden):

Section 1. The Official Zoning Map for the Meeks Bay area is hereby amended to rezone the following described lands:

From: Tahoe One-Family Residential (TR1) - 7.49 acres
Tahoe Commercial (CT) - 9.14 acres

To: Tahoe One-Family Residential (TR1) - 15.41 acres
Tahoe Commercial (CT) - 1.22 acres

Meeks Bay Area:

Assessor's Parcel No: 016-410-10; being described as a portion of Section 29, T14N, R17E, M.D.M., consisting of 16.63 acres as shown on Exhibit A hereto.

Section 2. This ordinance shall take effect and shall become effective thirty (30) days following the adoption hereof.

PASSED AND ADOPTED by the Board of Supervisors of the County of El Dorado at a regular meeting of said Board, held on the 15th day of December 2015, by the following vote of said Board:

Ayes: Sue Novasel, Ron Mikulaco, Shiva Frentzen,
Brian K. Veerkamp, Michael Ranalli

Noes: None

Absent: None

ATTEST

JAMES S. MITRISIN

Clerk of the Board of Supervisors

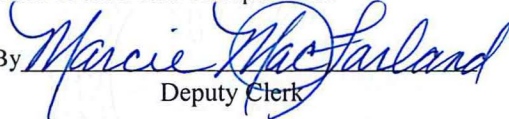
By 
Deputy Clerk



Brian K. Veerkamp, Chair, Board of Supervisors

APPROVED AS TO FORM

ROBYN TRUITT DRIVON, County Counsel

By 
David A. Livingston, Sr. Deputy County Counsel

ZONING MAP

DRYDEN MEADOW VISTA PARCEL

Z15-0001 and P15-0001

APN: 016-410-10

El Dorado County, California

Not to Scale

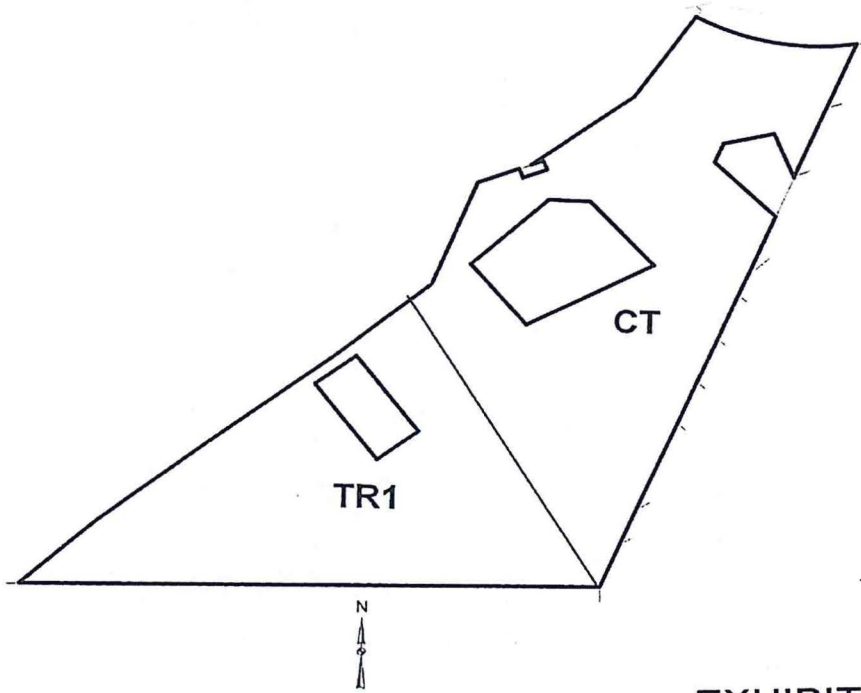

Existing Zoning: TR1 = 7.49 acres – CT = 9.14 acres

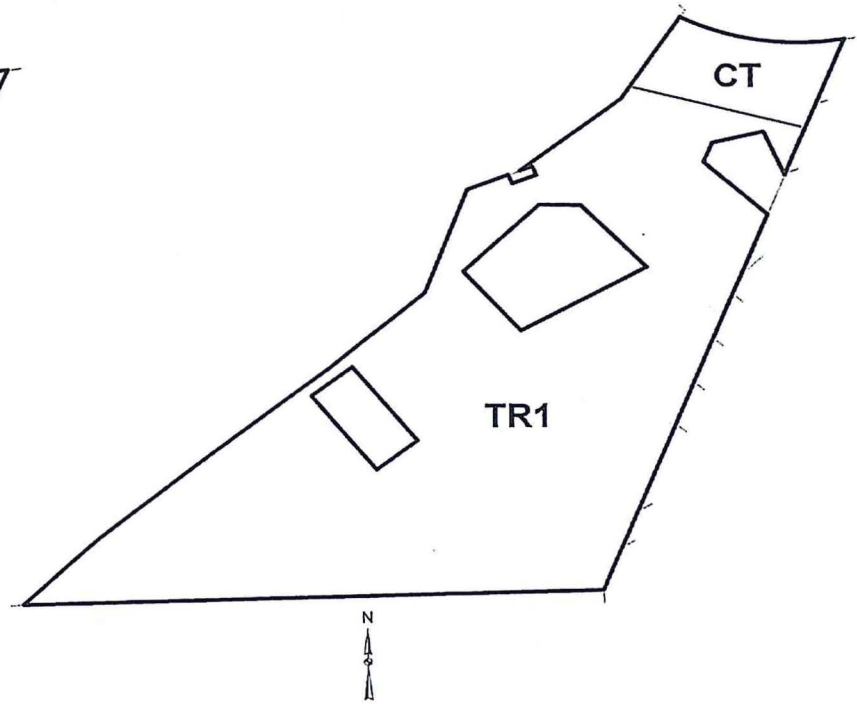

Proposed Zoning: TR1 = 15.41 acres – CT = 1.22 acres

EXHIBIT A