



RESOLUTION NO.

RESOLUTION OF THE BOARD OF SUPERVISORS OF THE COUNTY OF EL DORADO ADOPTING AN AMENDED GENERAL PLAN TRANSPORTATION AND CIRCULATION ELEMENT REMOVING THE CONCEPTUAL HEADINGTON ROAD ALIGNMENT

WHEREAS, on July 19, 2004, the Board of Supervisors adopted the 2004 El Dorado County General Plan; and

WHEREAS, on December 15, 2015, the Board of Supervisors adopted the Target General Plan Amendment and Zoning Ordinance Update that included adoption of Figure TC-1, the Circulation Map for the El Dorado County General Plan; and

WHEREAS, an application to amend the General Plan to remove the conceptual Headington Road alignment from Figure TC-1, the Circulation Map, was filed on October 10, 2024; and

WHEREAS, applications to change the Zoning of the project site, to revise the Planned Development Permit, and to authorize a Conditional Use Permit for the Crossings – El Dorado RV Resort and Campground project were filed on January 20, 2023; and

WHEREAS, an Addendum to the Environmental Impact Report was prepared identifying modified mitigation measures; and

WHEREAS, Tribal Consultation was solicited under SB 18 and the County received no request for Consultation and is now closed; and

WHEREAS, on March 27, 2025 the Planning Commission held a meeting on this project and recommended approval; now

THEREFORE, BE IT HEREBY RESOLVED, that the El Dorado County Board of Supervisors authorizes the following amendment to the General Plan:

- Remove the Conceptual Headington Road Alignment from Figure TC-1 the Circulation Map for the El Dorado County General Plan as depicted in Exhibit A.

THEREFORE, NOW BE IT FURTHER RESOLVED, that the El Dorado County Board of Supervisors authorizes the Planning and Building Director to work with the County Surveyor to make conforming revisions to pages 2 and 3 of Figure TC-1 following amendment to the General Plan.

PASSED AND ADOPTED by the Board of Supervisors of the County of El Dorado at a regular meeting of said Board, held the ____ day of _____ 2025, by the following vote of said Board:

Resolution _____
Page 2 of 2

Attest:

Clerk of the Board of Supervisors

Ayes:
Noes:
Absent:

By: _____
Deputy Clerk

Chair, Board of Supervisors



Exhibit A

FIGURE TC-1 Draft
CIRCULATION MAP FOR THE EL DORADO COUNTY GENERAL PLAN
April 2025

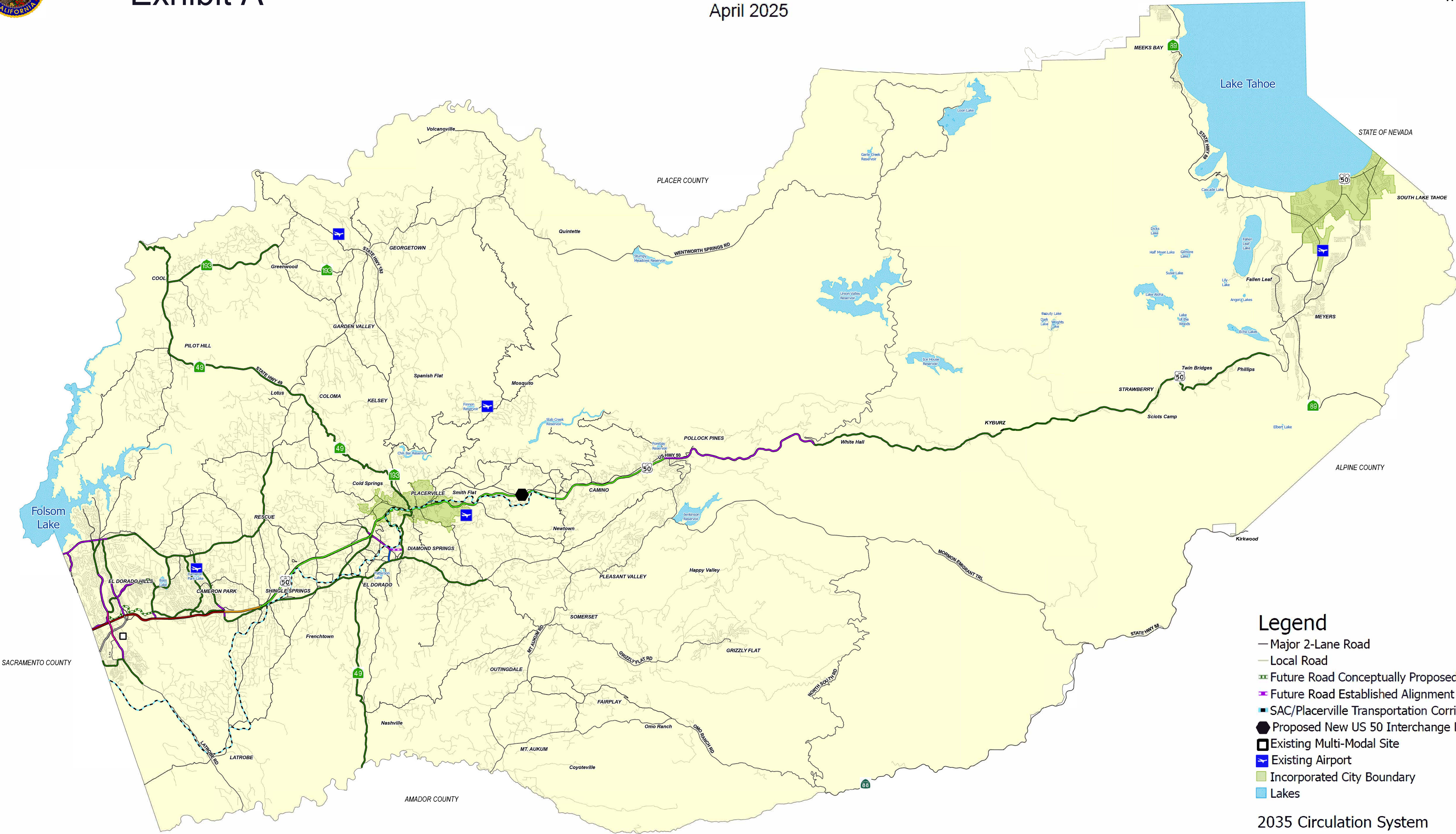
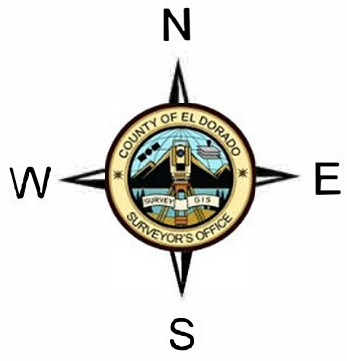

Legend

- Major 2-Lane Road
- Local Road
- Future Road Conceptually Proposed Alignment
- Future Road Established Alignment
- SAC/Placerville Transportation Corridor
- Proposed New US 50 Interchange Location
- Existing Multi-Modal Site
- Existing Airport
- Incorporated City Boundary
- Lakes

2035 Circulation System

- Major 2 Lane Road
- 4 Lane Undivided Road
- 4 Lane Divided Road
- 6 Lane Divided Road
- 4 Lane Freeway
- 6 Lane Freeway
- 8 Lane Freeway
- Capital Southeast Connector Corridor

2035 and Potential Future Roadway Facilities

Roadway	Segment	2035 Facility	Future Facility
Bass Lake Road	US 50 to Silver Springs Parkway	Major 2-Lane	4-Lane Divided
Cameron Park Drive	Hacienda Drive to Meder Road	Major 2-Lane	4-Lane Divided
El Dorado Hills Boulevard	Governor Drive/St Andrews Drive to Francisco Drive	Major 2-Lane	4-Lane Divided
Francisco Drive	El Dorado Hills Boulevard to Green Valley Road	Major 2-Lane	4-Lane Divided
Green Valley Road	Silva Valley Parkway to Deer Valley Road (West)	Major 2-Lane	4-Lane Divided
Latrobe Connection (Carson Crossing Drive)	Golden Foothills Parkway to El Dorado County Line	Major 2-Lane	4-Lane Divided
Latrobe Road	White Rock Road to Suncaust Lane	4-Lane Divided	6-Lane Divided
Silva Valley Parkway	Harvard Way to Green Valley Road	Major 2-Lane	4-Lane Divided
White Rock Road1	Latrobe Road to US 50	4-Lane Divided	6-Lane Divided
1 White Rock Road is the eastern end of the Capital Southeast Connector Corridor.			

DISCLAIMER:
THIS DEPICTION WAS COMPILED FROM UNVERIFIED PUBLIC AND PRIVATE SOURCES AND IS ILLUSTRATIVE ONLY. NO REPRESENTATION IS MADE AS TO THE ACCURACY OF THIS INFORMATION. PARCEL BOUNDARIES ARE PARTICULARLY UNRELIABLE. USERS MAKE USE OF THIS DEPICTION AT THEIR OWN RISK.

NOTES:
LAYER INFORMATION MAY COVER ADDITIONAL AREAS OUTSIDE OF THE DISPLAYED AREA.
PREPARED AT THE REQUEST OF: PLANNING DIVISION DATE: 3/31/2025
MAP PREPARED BY: EDC GIS DATE: 4/4/2025
G.I.S. PROJECT ID: Q3WG435123, RELATED REPORT: N/A
EL DORADO COUNTY SURVEYOR/G.I.S. DIVISION
EMAIL: gis@edcgov.us PHONE: (530) 621-5440
MAP DISPLAYED IN STATE PLANE COORDINATE SYSTEM
(NAD 1983 CALIFORNIA ZONE 2, FEET)

County of El Dorado
State of California

