

PARCEL LOCATION FOR
PROPOSED TEMPORARY OR
PERMANENT EASEMENT

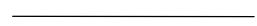

PROPERTY LINE

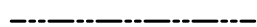

COUNTY ROW

EL DORADO COUNTY
SOUTH LAKE TAHOE OFFICE

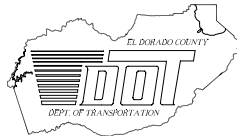

ANGORA FIRE
EMERGENCY REHABILITATION PROJECT
ZONE C EASEMENT REQUEST
LOCATION MAP

FIGURE

C

DATE: 08/07

PROJECT NO.: 97678

BY: JTC

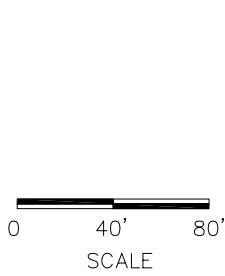
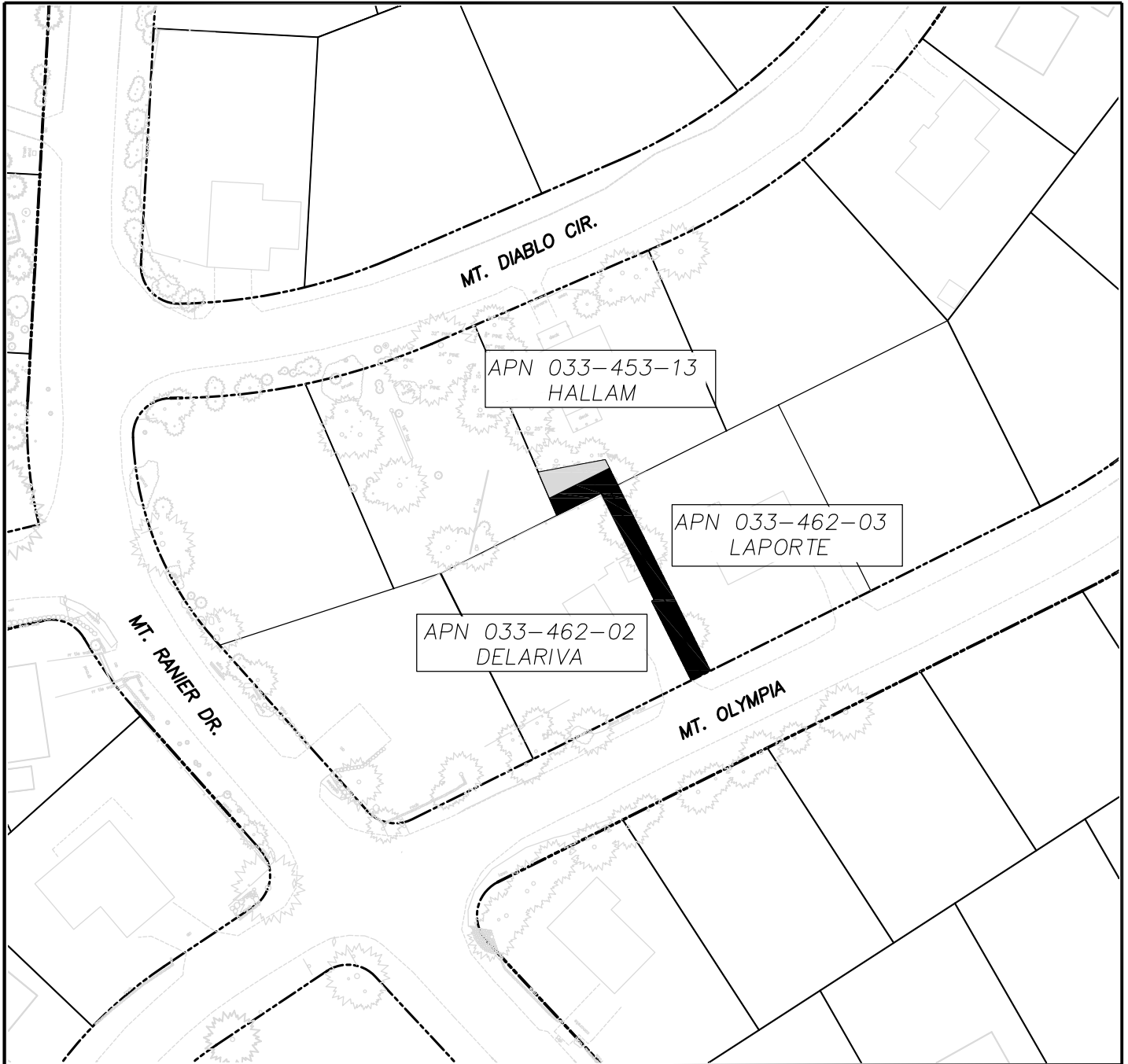

- PROPERTY LINE
- - - COUNTY ROW
- PROPOSED TEMPORARY EASEMENT AREA
- PROPOSED PERMANENT EASEMENT AREA



EL DORADO COUNTY
SOUTH LAKE TAHOE OFFICE

ANGORA FIRE EMERGENCY REHABILITATION PROJECT
ZONE C EASEMENT REQUEST
 1246 MT DIABLO CIR APN 033-453-13
 1311 & 1319 MT. OLYMPIA CIR. APN 033-462-02/
 APN 033-462-03

DATE: 08/07 PROJECT NO.: 97678 BY: JTC

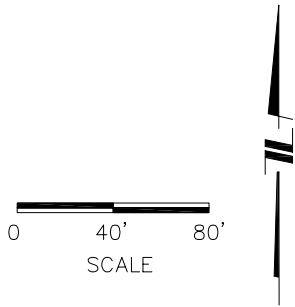
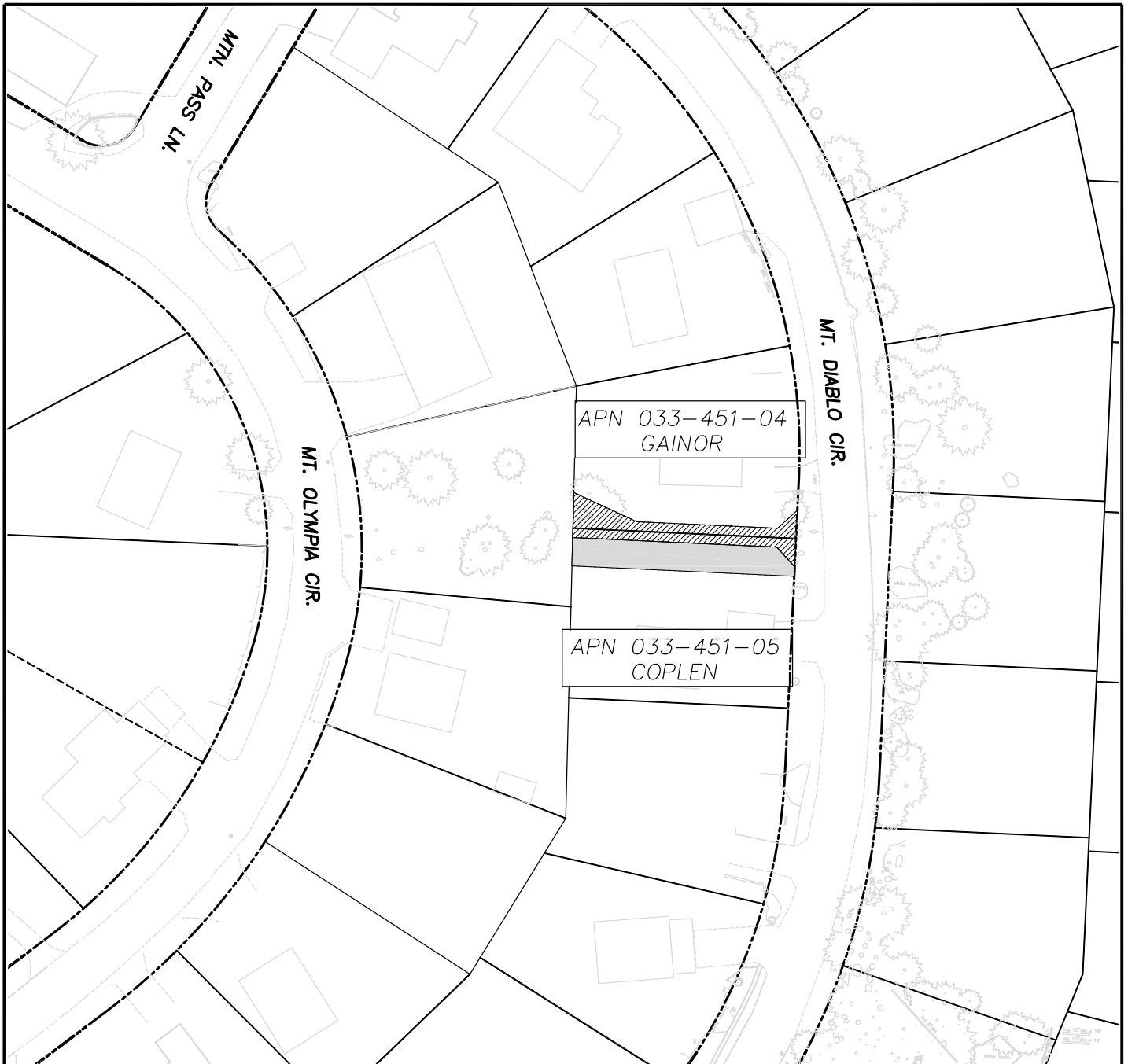
FIGURE
C-1



- PROPERTY LINE
- - - COUNTY ROW
-  PROPOSED TEMPORARY EASEMENT AREA
-  PROPOSED PERMANENT EASEMENT AREA

EL DORADO COUNTY
SOUTH LAKE TAHOE OFFICE

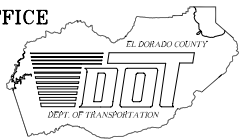

ANGORA FIRE
EMERGENCY REHABILITATION PROJECT
ZONE C EASEMENT REQUEST
1386 & 1394 MT DIABLO CIR
APN 033-451-04/APN 033-451-05

FIGURE

C-2

DATE: 08/07

PROJECT NO.: 97678

BY: JTC

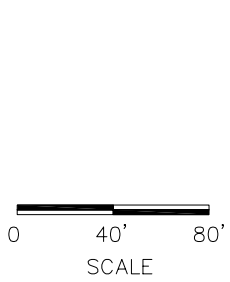
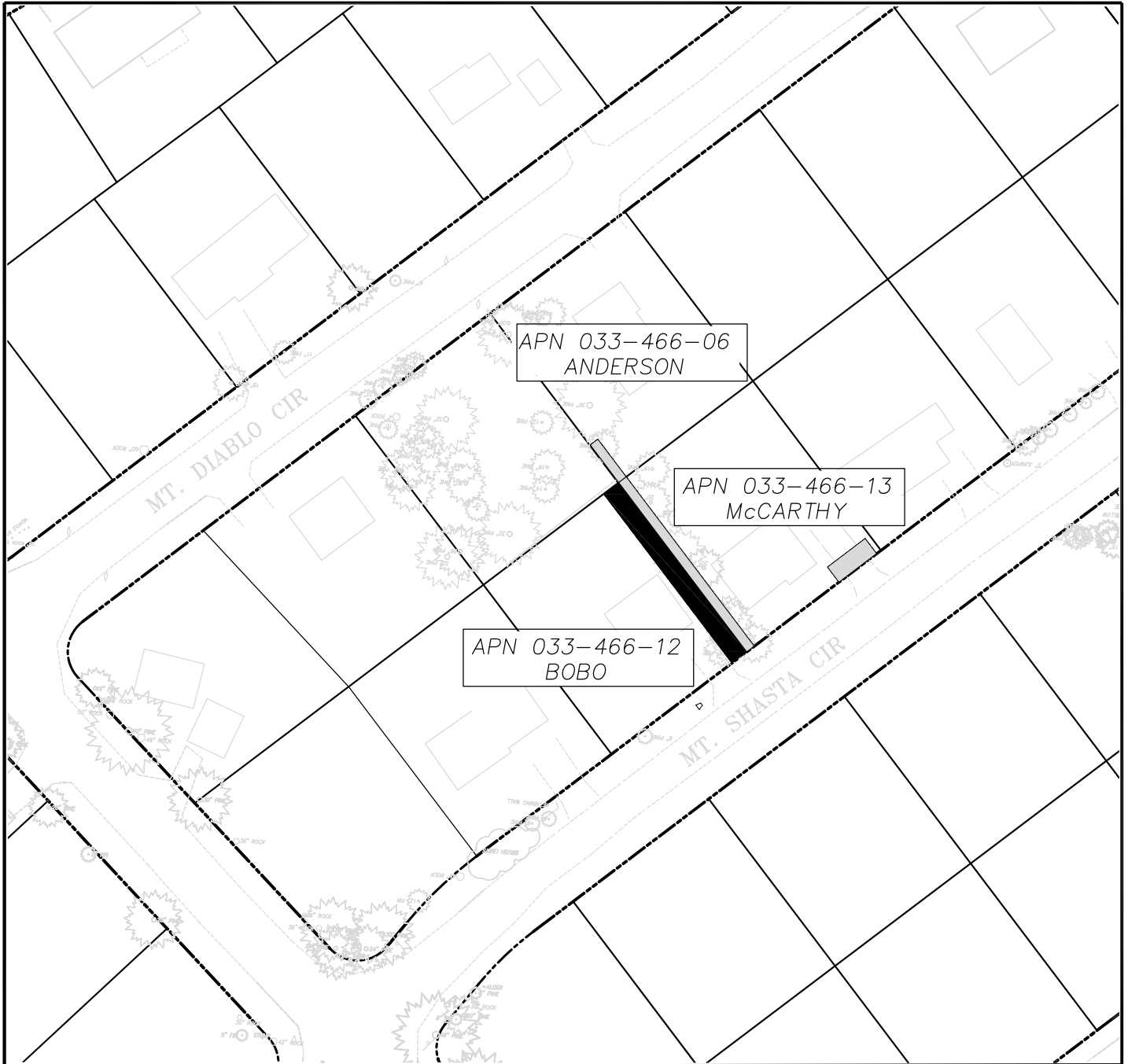

- PROPERTY LINE
- - - - - COUNTY ROW
- PROPOSED TEMPORARY EASEMENT AREA
- PROPOSED PERMANENT EASEMENT AREA

EL DORADO COUNTY
SOUTH LAKE TAHOE OFFICE

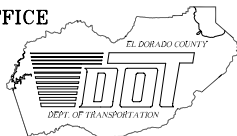

ANGORA FIRE EMERGENCY REHABILITATION PROJECT
ZONE C EASEMENT REQUEST

1472 & 1464 MT SHASTA CIR. APN033-466-12/
033-466-13
1463 MT. DIABLO CIR. APN 033-466-06

DATE: 08/07

PROJECT NO.: 97678

BY: JTC

FIGURE

C-3