

**Section 8.2
Tahoe EIP
Individual Project Summaries**



Abrasives Study

CIP Project Summary

Project No: 95961

Type: Miscellaneous

Supervisor District(s) 5

Project Description:

Evaluation of alternative abrasives and road sweeping/vacuuming as source control BMPs for load reduction of fine sediment particles and phosphorus in urban roadway stormwater. Tahoe Engineering will be working with the Principal investigators from Texas Southern University and UC Davis to conduct the following research. The results of study will provide the County additional information to assist with achieving the State Water Quality Control Board Lahontan Region National Pollutant Discharge Elimination System Permit requirements.

Original Budget: \$39,339

Expenditures thru 6/30/2013: \$4,579

Project Initiation Date: 05/25/12

Revenue by Funding Source	Prior FY*	FY 14/15	FY 15/16	FY 16/17	FY 17/18	FY 18/19	FY 19/20-23/24**	FY 24/25-33/34**	Total
Miscellaneous Reimbursement	\$24	\$15	\$0	\$0	\$0	\$0	\$0	\$0	\$39
Total	\$24	\$15	\$0	\$0	\$0	\$0	\$0	\$0	\$39

Expenditures	Prior FY*	FY 14/15	FY 15/16	FY 16/17	FY 17/18	FY 18/19	FY 19/20-23/24**	FY 24/25-33/34**	Total
Planning/Env - Staff	\$24	\$15	\$0	\$0	\$0	\$0	\$0	\$0	\$39
Total	\$24	\$15	\$0	\$0	\$0	\$0	\$0	\$0	\$39

*Prior FY includes actual revenue and expenditures through 06/30/13, plus amounts budgeted through 06/30/14.

**FY 19/20 - 23/24 and FY 24/25 - 33/34 revenue and expenditures are not included for the Tahoe EIP, as it is a five-year program.



Apache Avenue/US 50 Intersection Signalization

CIP Project Summary

Project No: 73120

Type: Intersection

Supervisor District(s) 5

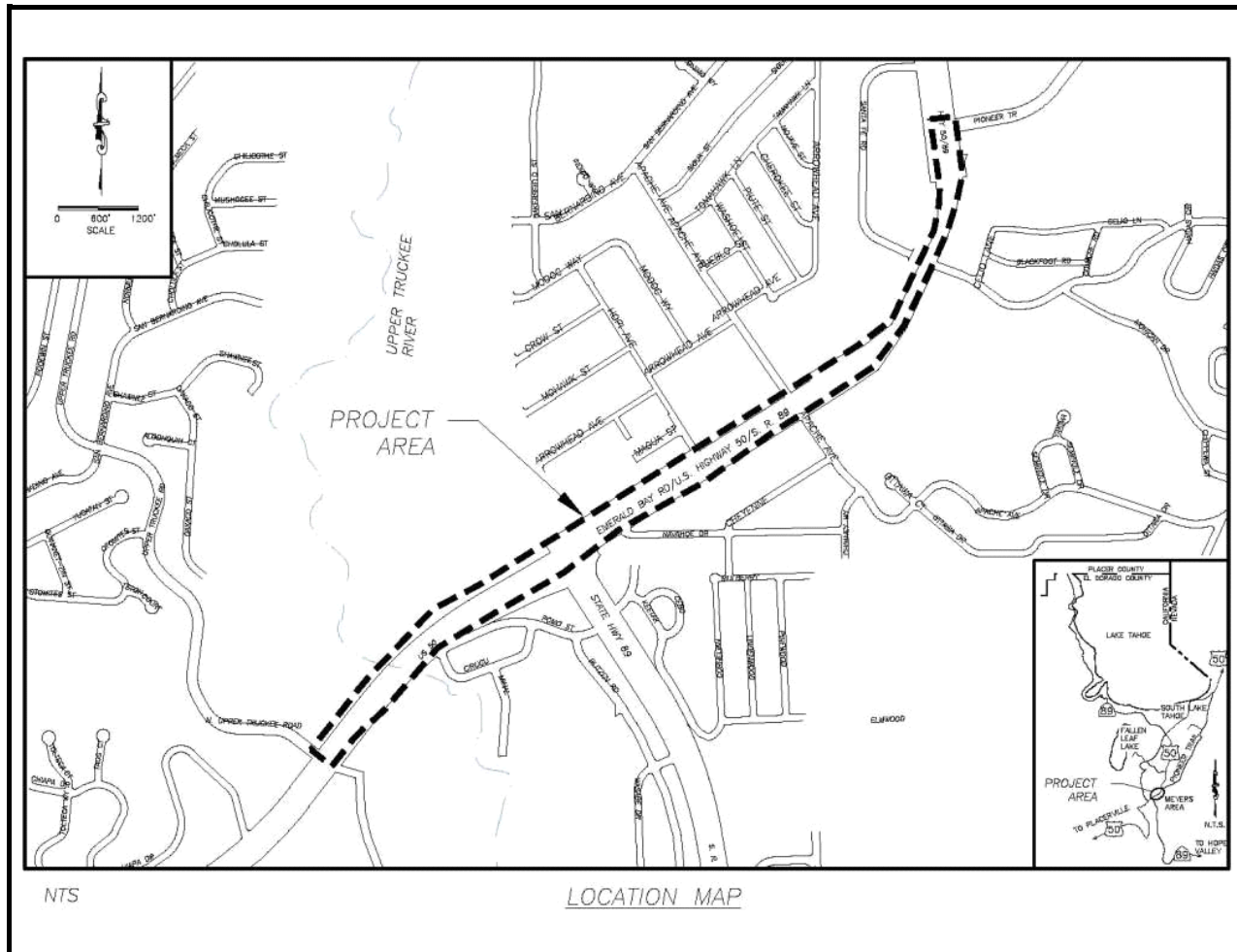

Project Description:

Perform Operational Study and Signalize Intersection at the Apache/Hwy 50 intersection. Coordinate with Caltrans to perform an operational study on this intersection to evaluate traffic flow and circulation. The study will also include a regional component which analyzes the entire Meyers area from Chiapa Road through State Route 89/US 50 intersection to Sawmill Road. US 50 is a state highway and as such the state should participate in advancement of a project to signalize this intersection. Regional Surface Transportation Program funding from Tahoe Regional Planning Agency (TRPA) is programmed for the operational study.

Original Budget: \$13,389,000

Expenditures thru 6/30/2013: \$194,612

Project Initiation Date: 12/06/10

*Prior FY includes actual revenue and expenditures through 06/30/13, plus amounts budgeted through 06/30/14.

**FY 19/20 - 23/24 and FY 24/25 - 33/34 revenue and expenditures are not included for the Tahoe EIP, as it is a five-year program.



Apache Avenue/US 50 Intersection Signalization

Financing Plan & Tentative Schedule

Project No: 73120

Type: Intersection

Supervisor District(s) 5

All Figures in Thousands

Revenue by Funding Source	Prior FY*	FY 14/15	FY 15/16	FY 16/17	FY 17/18	FY 18/19	FY 19/20-23/24**	FY 24/25-33/34**	Total
Congestion Mitigation and Air Quality Program	\$22	\$0	\$0	\$150	\$350	\$350	\$0	\$0	\$872
RSTP Exchange Funds-TRPA	\$178	\$31	\$189	\$105	\$100	\$200	\$0	\$0	\$803
State Cooperative Agreement	\$0	\$0	\$0	\$1,690	\$1,201	\$3,043	\$0	\$0	\$5,934
Tahoe Regional Planning Agency/Air Quality	\$0	\$0	\$100	\$160	\$100	\$385	\$0	\$0	\$745
Tahoe Regional Planning Agency/Water Quality	\$0	\$0	\$10	\$35	\$55	\$50	\$0	\$0	\$150
Transportation Enhancement Activities	\$0	\$0	\$0	\$120	\$0	\$0	\$0	\$0	\$120
Total	\$200	\$31	\$299	\$2,260	\$1,806	\$4,028	\$0	\$0	\$8,623

All Figures in Thousands

Expenditures	Prior FY*	FY 14/15	FY 15/16	FY 16/17	FY 17/18	FY 18/19	FY 19/20-23/24**	FY 24/25-33/34**	Total
Planning/Env - Consultant	\$76	\$0	\$60	\$0	\$0	\$0	\$0	\$0	\$136
Planning/Env - Staff	\$49	\$31	\$64	\$0	\$0	\$0	\$0	\$0	\$144
Design - Consultant	\$61	\$0	\$40	\$35	\$0	\$0	\$0	\$0	\$136
Design - Staff	\$14	\$0	\$85	\$205	\$0	\$0	\$0	\$0	\$304
Right of Way - Acquisition	\$0	\$0	\$0	\$160	\$0	\$0	\$0	\$0	\$160
Right of Way - Consultant	\$0	\$0	\$15	\$5	\$0	\$0	\$0	\$0	\$20
Right of Way - Staff	\$0	\$0	\$35	\$40	\$0	\$0	\$0	\$0	\$75
Construction Mgmt - Consultant	\$0	\$0	\$0	\$25	\$20	\$25	\$0	\$0	\$70
Construction Mgmt - Staff	\$0	\$0	\$0	\$255	\$255	\$450	\$0	\$0	\$960
Direct Construction Costs	\$0	\$0	\$0	\$1,500	\$1,500	\$3,500	\$0	\$0	\$6,500
Env Monitoring - Consultant	\$0	\$0	\$0	\$2	\$1	\$5	\$0	\$0	\$8
Env Monitoring - Staff	\$0	\$0	\$0	\$8	\$5	\$18	\$0	\$0	\$30
Plant Establishment - Consultant	\$0	\$0	\$0	\$11	\$10	\$15	\$0	\$0	\$36
Plant Establishment - Staff	\$0	\$0	\$0	\$15	\$15	\$15	\$0	\$0	\$45
Total	\$200	\$31	\$299	\$2,260	\$1,806	\$4,028	\$0	\$0	\$8,623

Project Schedule	Prior FY*	FY 14/15	FY 15/16	FY 16/17	FY 17/18	FY 18/19	FY 19/20-23/24**	FY 24/25-33/34**
Planning/Environmental								
Design								
Right Of Way								
Construction								
Environmental Monitoring								

*Prior FY includes actual revenue and expenditures through 06/30/13, plus amounts budgeted through 06/30/14.

**FY 19/20 - 23/24 and FY 24/25 - 33/34 revenue and expenditures are not included for the Tahoe EIP, as it is a five-year program.



Boulder Mountain Erosion Control Project

CIP Project Summary

Project No: 95153

Type: Erosion Control - (EIP)

Supervisor District(s) 5

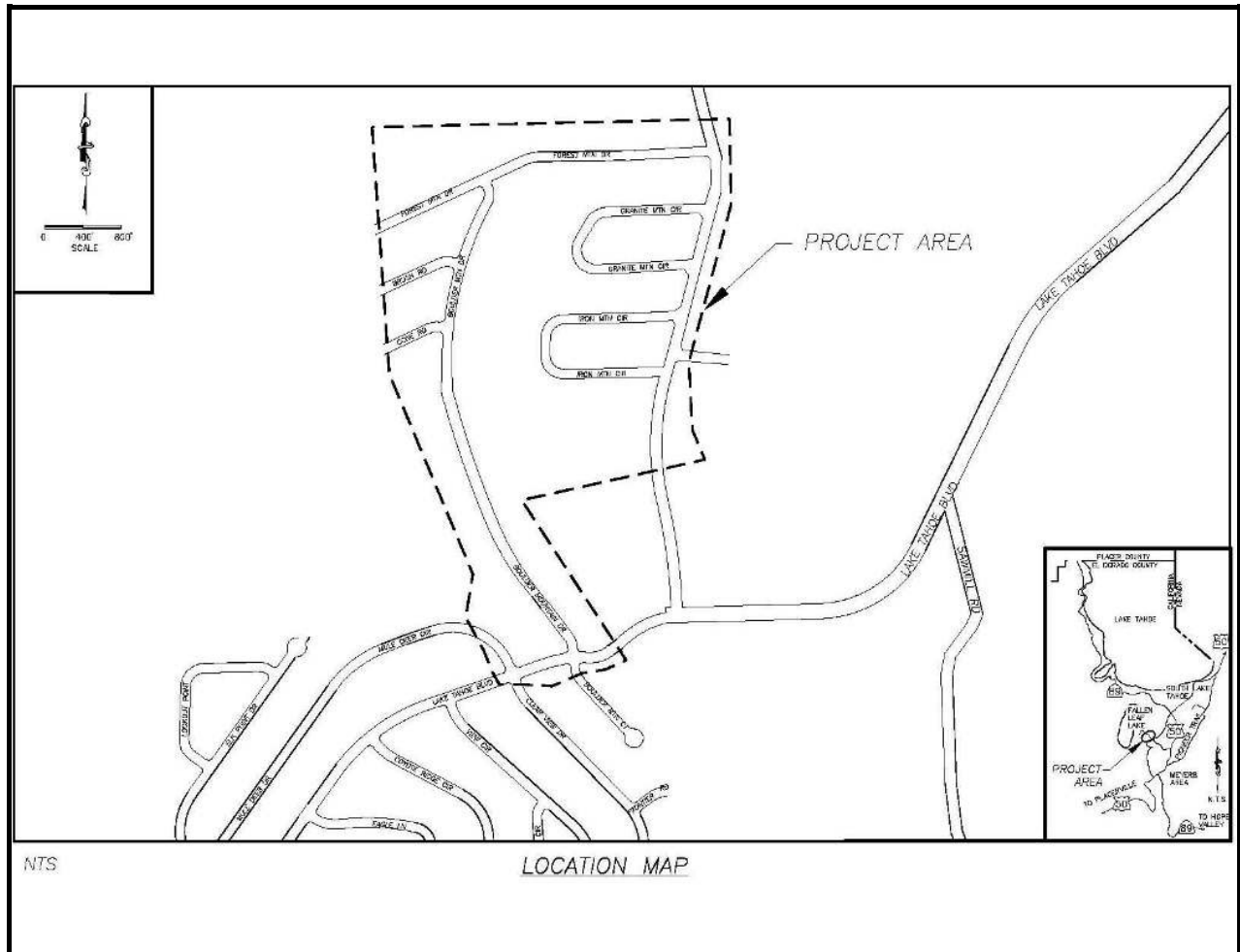

Project Description:

The Boulder Mountain Erosion Control Project includes Mountain View Estates subdivision Unit No. 10 and a portion of Unit No. 7 and encompasses the area south of Angora Highlands, north of Lake Tahoe Blvd and west of Tahoe Mountain Road. The Project goals are to treat eroding cut and fill slopes in the County right-of-way. Remove the very fine/fine particles up to 11% of the total load from the County right-of-way prior to reaching the Angora Creek. Revegetation of disturbed areas including the restoration of the Boulder Mountain Drive pavement. Stabilize areas around the County right-of-way impacted by the Angora Fire.

Original Budget: \$2,793,500

Expenditures thru 6/30/2013: \$441,785

Project Initiation Date: 04/15/08

*Prior FY includes actual revenue and expenditures through 06/30/13, plus amounts budgeted through 06/30/14.

**FY 19/20 - 23/24 and FY 24/25 - 33/34 revenue and expenditures are not included for the Tahoe EIP, as it is a five-year program.



Boulder Mountain Erosion Control Project

Financing Plan & Tentative Schedule

Project No: 95153

Type: Erosion Control - (EIP)

Supervisor District(s) 5

All Figures in Thousands

Revenue by Funding Source	Prior FY*	FY 14/15	FY 15/16	FY 16/17	FY 17/18	FY 18/19	FY 19/20-23/24**	FY 24/25-33/34**	Total
Miscellaneous Reimbursement	\$23	\$0	\$0	\$0	\$0	\$0	\$0	\$0	\$23
Tahoe Regional Planning Agency/Water Quality	\$17	\$0	\$0	\$0	\$0	\$0	\$0	\$0	\$17
United States Forest Service Planning Grant	\$429	\$0	\$0	\$0	\$0	\$0	\$0	\$0	\$429
United States Forest Service Site Improvement Grant	\$569	\$15	\$13	\$0	\$0	\$0	\$0	\$0	\$596
Total	\$1,038	\$15	\$13	\$0	\$0	\$0	\$0	\$0	\$1,065

All Figures in Thousands

Expenditures	Prior FY*	FY 14/15	FY 15/16	FY 16/17	FY 17/18	FY 18/19	FY 19/20-23/24**	FY 24/25-33/34**	Total
Planning/Env - Staff	\$5	\$0	\$0	\$0	\$0	\$0	\$0	\$0	\$5
Design - Consultant	\$44	\$0	\$0	\$0	\$0	\$0	\$0	\$0	\$44
Design - Staff	\$354	\$0	\$0	\$0	\$0	\$0	\$0	\$0	\$354
Right of Way - Acquisition	\$2	\$0	\$0	\$0	\$0	\$0	\$0	\$0	\$2
Right of Way - Staff	\$10	\$0	\$0	\$0	\$0	\$0	\$0	\$0	\$10
Construction Mgmt - Staff	\$90	\$0	\$0	\$0	\$0	\$0	\$0	\$0	\$90
Direct Construction Costs	\$500	\$0	\$0	\$0	\$0	\$0	\$0	\$0	\$500
Env Monitoring - Consultant	\$5	\$2	\$0	\$0	\$0	\$0	\$0	\$0	\$6
Env Monitoring - Staff	\$28	\$6	\$5	\$0	\$0	\$0	\$0	\$0	\$39
Plant Establishment - Staff	\$0	\$7	\$8	\$0	\$0	\$0	\$0	\$0	\$15
Total	\$1,038	\$14	\$13	\$0	\$0	\$0	\$0	\$0	\$1,064

Project Schedule	Prior FY*	FY 14/15	FY 15/16	FY 16/17	FY 17/18	FY 18/19	FY 19/20-23/24**	FY 24/25-33/34**
Planning/Environmental								
Design								
Right Of Way								
Construction								
Environmental Monitoring								

*Prior FY includes actual revenue and expenditures through 06/30/13, plus amounts budgeted through 06/30/14.

**FY 19/20 - 23/24 and FY 24/25 - 33/34 revenue and expenditures are not included for the Tahoe EIP, as it is a five-year program.



Christmas Valley Phase 2C Erosion Control Project

CIP Project Summary

Project No: 95190

Type: Erosion Control - (EIP)

Supervisor District(s) 5

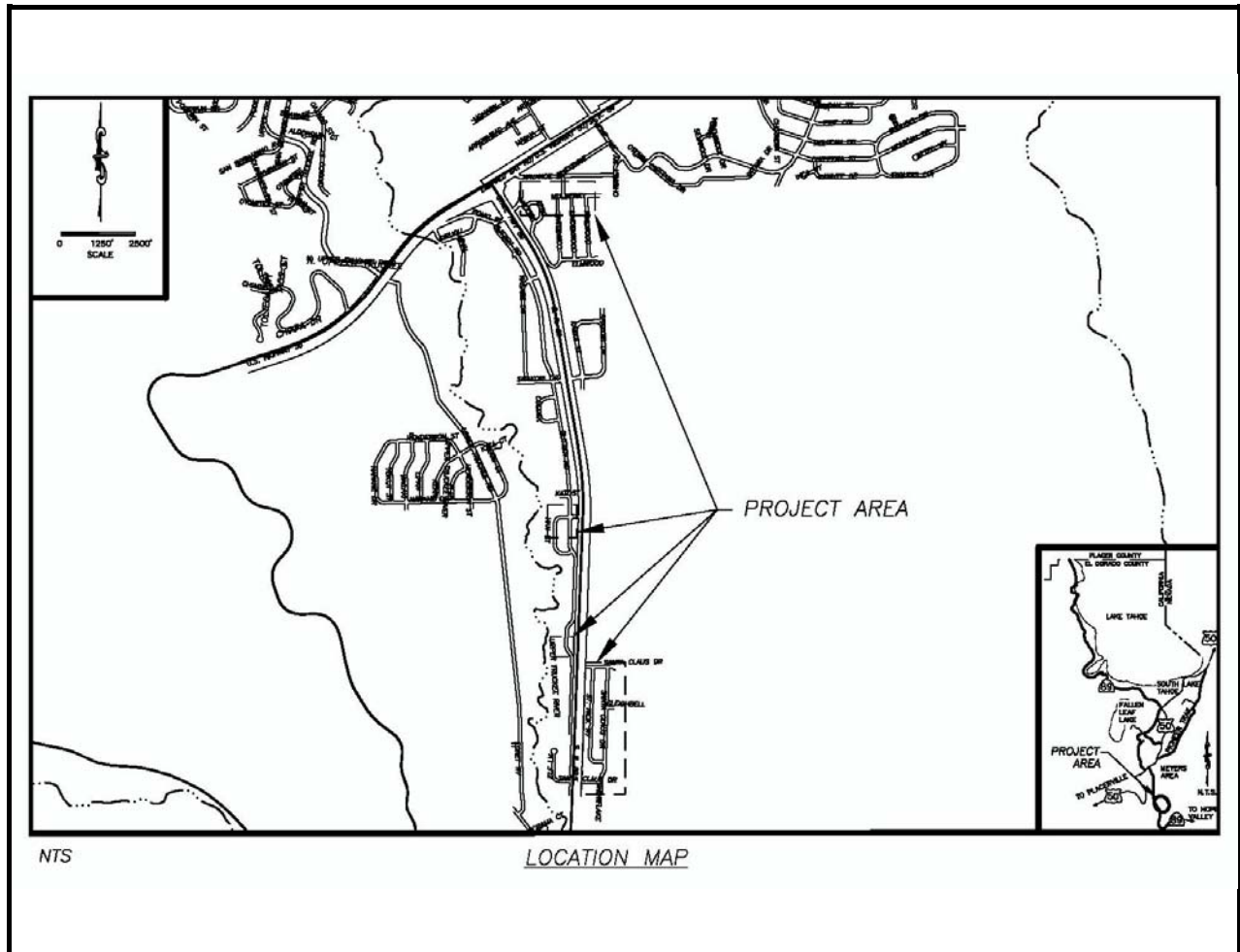

Project Description:

The Christmas Valley Phase 2C Erosion Control Project encompasses the streets of Santa Claus Drive, Saint Nick Way, the southernmost end of Blitzen Road, and Elf Lane (includes Christmas Valley Unit Nos. 1 and 2). The main goals of the Project are related to improving the water quality of runoff to Lake Tahoe by reducing erosion and sediment flow originating in the Project area. The Project goals are remove/reduce fine sediment originating from the Project areas prior to reaching the Upper Truckee River to the maximum extent practicable. Remove/reduce coarse sediment originating from the Project areas prior to reaching the Upper Truckee River to the maximum extent practicable.

Original Budget: \$4,997,500

Expenditures thru 6/30/2013: \$1,037,342

Project Initiation Date: 04/15/05

*Prior FY includes actual revenue and expenditures through 06/30/13, plus amounts budgeted through 06/30/14.

**FY 19/20 - 23/24 and FY 24/25 - 33/34 revenue and expenditures are not included for the Tahoe EIP, as it is a five-year program.



Christmas Valley Phase 2C Erosion Control Project

Financing Plan & Tentative Schedule

Project No: 95190

Type: Erosion Control - (EIP)

Supervisor District(s) 5

All Figures in Thousands

Revenue by Funding Source	Prior FY*	FY 14/15	FY 15/16	FY 16/17	FY 17/18	FY 18/19	FY 19/20-23/24**	FY 24/25-33/34**	Total
California Tahoe Conservancy Planning Grant	\$138	\$0	\$0	\$0	\$0	\$0	\$0	\$0	\$138
California Tahoe Conservancy Right of Way Grant	\$30	\$0	\$0	\$0	\$0	\$0	\$0	\$0	\$30
California Tahoe Conservancy Site Improvement Grant	\$957	\$16	\$11	\$0	\$0	\$0	\$0	\$0	\$983
Tahoe Regional Planning Agency/Water Quality	\$78	\$0	\$0	\$0	\$0	\$0	\$0	\$0	\$78
United States Forest Service Site Improvement Grant	\$77	\$0	\$0	\$0	\$0	\$0	\$0	\$0	\$77
Total	\$1,279	\$16	\$11	\$0	\$0	\$0	\$0	\$0	\$1,305

All Figures in Thousands

Expenditures	Prior FY*	FY 14/15	FY 15/16	FY 16/17	FY 17/18	FY 18/19	FY 19/20-23/24**	FY 24/25-33/34**	Total
Developer Advanced Design	\$172	\$0	\$0	\$0	\$0	\$0	\$0	\$0	\$172
Right of Way - Acquisition	\$9	\$0	\$0	\$0	\$0	\$0	\$0	\$0	\$9
Right of Way - Consultant	\$18	\$0	\$0	\$0	\$0	\$0	\$0	\$0	\$18
Right of Way - Staff	\$87	\$0	\$0	\$0	\$0	\$0	\$0	\$0	\$87
Construction Mgmt - Staff	\$165	\$0	\$0	\$0	\$0	\$0	\$0	\$0	\$165
Direct Construction Costs	\$779	\$0	\$0	\$0	\$0	\$0	\$0	\$0	\$779
Env Monitoring - Consultant	\$2	\$2	\$1	\$0	\$0	\$0	\$0	\$0	\$5
Env Monitoring - Staff	\$10	\$7	\$5	\$0	\$0	\$0	\$0	\$0	\$22
Plant Establishment - Consultant	\$18	\$0	\$0	\$0	\$0	\$0	\$0	\$0	\$18
Plant Establishment - Staff	\$19	\$7	\$5	\$0	\$0	\$0	\$0	\$0	\$31
Total	\$1,279	\$16	\$11	\$0	\$0	\$0	\$0	\$0	\$1,305

Project Schedule	Prior FY*	FY 14/15	FY 15/16	FY 16/17	FY 17/18	FY 18/19	FY 19/20-23/24**	FY 24/25-33/34**
Planning/Environmental								
Design								
Right Of Way								
Construction								
Environmental Monitoring								

*Prior FY includes actual revenue and expenditures through 06/30/13, plus amounts budgeted through 06/30/14.

**FY 19/20 - 23/24 and FY 24/25 - 33/34 revenue and expenditures are not included for the Tahoe EIP, as it is a five-year program.



Class 1 Bike Path: East San Bernardino - West San Bernardino

CIP Project Summary

Project No: 951SB

Type: Pedestrian Way and Bike Path

Supervisor District(s) 5

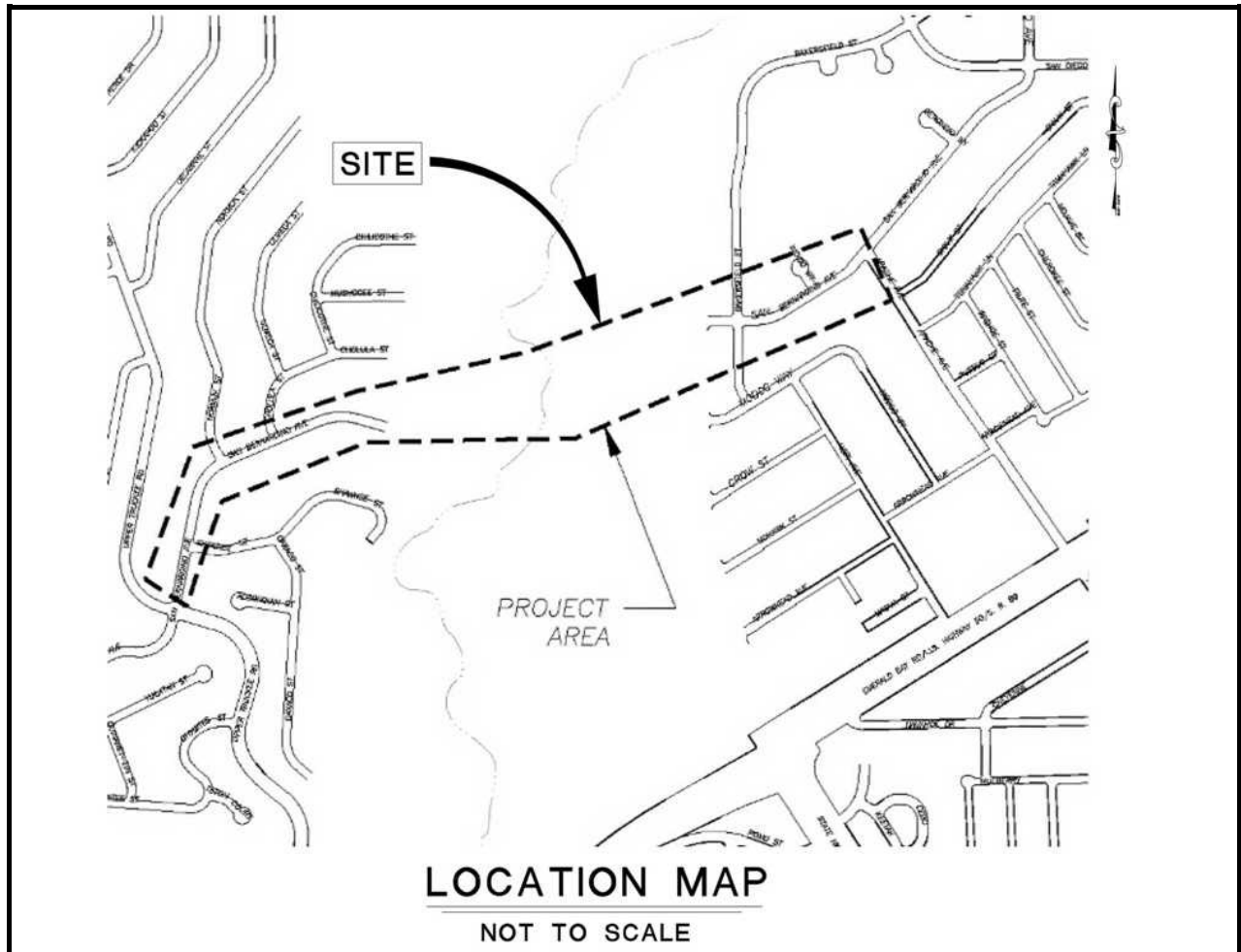

Project Description:

Class One Bike trail construction from East San Bernardino Street to West San Bernardino Street.

Original Budget: \$3,000,000

Expenditures thru 6/30/2013: \$0

Project Initiation Date: 03/18/14

*Prior FY includes actual revenue and expenditures through 06/30/13, plus amounts budgeted through 06/30/14.

**FY 19/20 - 23/24 and FY 24/25 - 33/34 revenue and expenditures are not included for the Tahoe EIP, as it is a five-year program.



Class 1 Bike Path: East San Bernardino - West San Bernardino

Financing Plan & Tentative Schedule

Project No: 951SB

Type: Pedestrian Way and Bike Path

Supervisor District(s) 5

All Figures in Thousands

Revenue by Funding Source	Prior FY*	FY 14/15	FY 15/16	FY 16/17	FY 17/18	FY 18/19	FY 19/20-23/24**	FY 24/25-33/34**	Total
Bicycle Transportation Account (BTA)	\$0	\$0	\$0	\$50	\$0	\$0	\$0	\$0	\$50
California Tahoe Conservancy Planning Grant	\$0	\$0	\$130	\$0	\$0	\$0	\$0	\$0	\$130
California Tahoe Conservancy Site Improvement Grant	\$0	\$0	\$0	\$120	\$20	\$10	\$0	\$0	\$150
Congestion Mitigation and Air Quality Program	\$0	\$0	\$0	\$500	\$0	\$0	\$0	\$0	\$500
RSTP Exchange Funds-TRPA	\$0	\$0	\$0	\$50	\$20	\$0	\$0	\$0	\$70
Safe Routes to School - State	\$0	\$0	\$0	\$450	\$0	\$0	\$0	\$0	\$450
Tahoe Regional Planning Agency/Air Quality	\$0	\$0	\$75	\$25	\$5	\$5	\$0	\$0	\$110
Total	\$0	\$0	\$205	\$1,195	\$45	\$15	\$0	\$0	\$1,460

All Figures in Thousands

Expenditures	Prior FY*	FY 14/15	FY 15/16	FY 16/17	FY 17/18	FY 18/19	FY 19/20-23/24**	FY 24/25-33/34**	Total
Planning/Env - Consultant	\$0	\$0	\$15	\$0	\$0	\$0	\$0	\$0	\$15
Planning/Env - Staff	\$0	\$0	\$50	\$0	\$0	\$0	\$0	\$0	\$50
Design - Staff	\$0	\$0	\$115	\$0	\$0	\$0	\$0	\$0	\$115
Right of Way - Staff	\$0	\$0	\$25	\$0	\$0	\$0	\$0	\$0	\$25
Construction Mgmt - Staff	\$0	\$0	\$0	\$235	\$25	\$0	\$0	\$0	\$260
Direct Construction Costs	\$0	\$0	\$0	\$950	\$0	\$0	\$0	\$0	\$950
Env Monitoring - Consultant	\$0	\$0	\$0	\$0	\$5	\$3	\$0	\$0	\$8
Env Monitoring - Staff	\$0	\$0	\$0	\$5	\$5	\$5	\$0	\$0	\$15
Plant Establishment - Consultant	\$0	\$0	\$0	\$0	\$5	\$3	\$0	\$0	\$8
Plant Establishment - Staff	\$0	\$0	\$0	\$5	\$5	\$5	\$0	\$0	\$15
Total	\$0	\$0	\$205	\$1,195	\$45	\$15	\$0	\$0	\$1,460

Project Schedule	Prior FY*	FY 14/15	FY 15/16	FY 16/17	FY 17/18	FY 18/19	FY 19/20-23/24**	FY 24/25-33/34**
Planning/Environmental								
Design								
Right Of Way								
Construction								
Environmental Monitoring								

*Prior FY includes actual revenue and expenditures through 06/30/13, plus amounts budgeted through 06/30/14.

**FY 19/20 - 23/24 and FY 24/25 - 33/34 revenue and expenditures are not included for the Tahoe EIP, as it is a five-year program.



Country Club Heights Erosion Control Project

CIP Project Summary

Project No: 95191

Type: Erosion Control - (EIP)

Supervisor District(s) 5

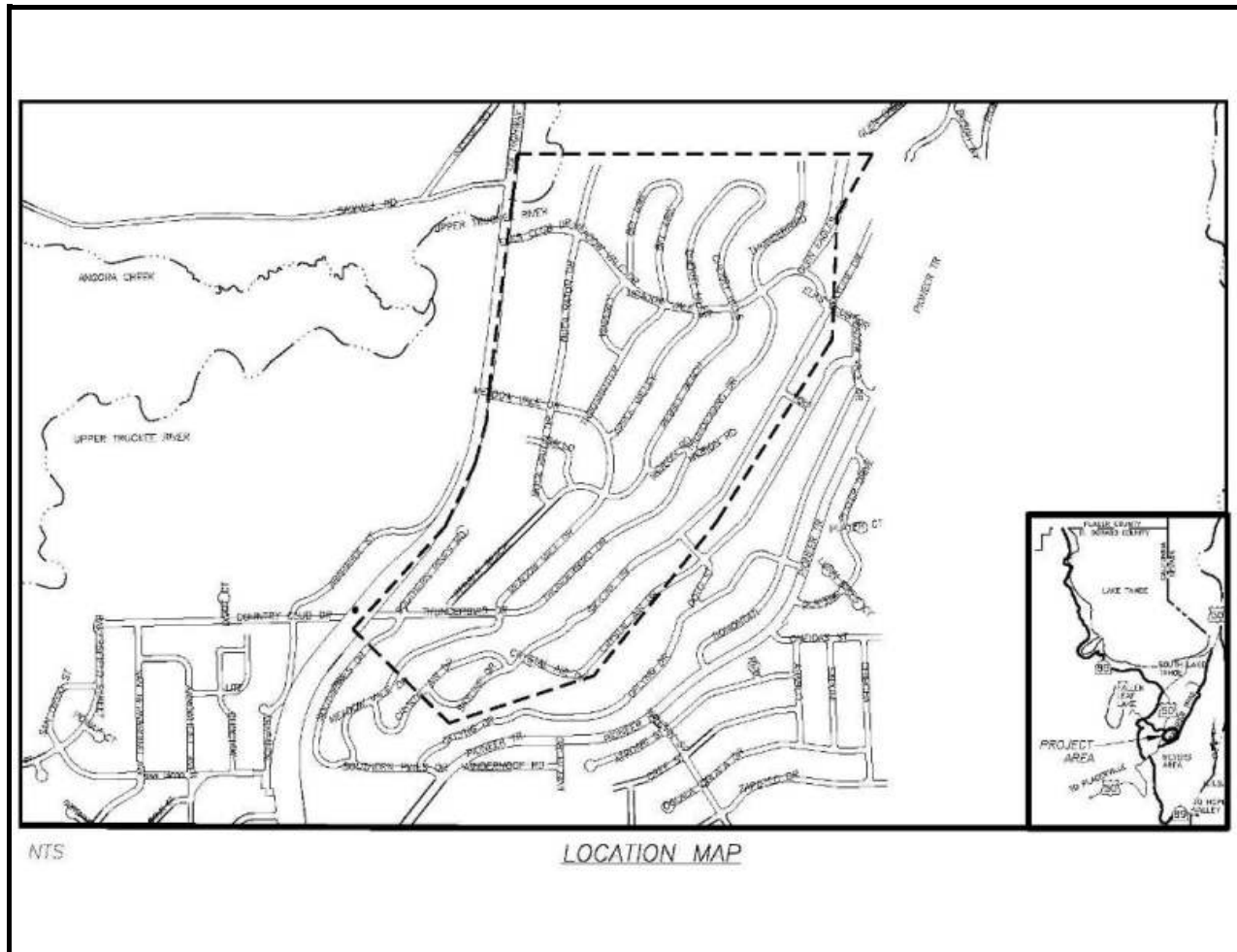

Project Description:

The Country Club Heights Erosion Control Project is within the Country Club Heights subdivision (Units 1-5), more specifically between Crystal Air Drive at the upper southerly boundary to U.S. Highway 50 to the north and Thunderbird Drive at the upper westerly boundary to the Upper Truckee River to the west. The main goal of this Project is to reduce very fine/fine sediment from the County right-of-way from reaching the Upper Truckee River near Elks Club Road to the Total Maximum Daily Level (TMDL) set by Lahontan Regional Water Quality Control Board under the National Pollution Discharge Elimination System (NPDES) permit conditions.

Original Budget: \$3,610,600

Expenditures thru 6/30/2013: \$53,159

Project Initiation Date: 07/01/11

*Prior FY includes actual revenue and expenditures through 06/30/13, plus amounts budgeted through 06/30/14.

**FY 19/20 - 23/24 and FY 24/25 - 33/34 revenue and expenditures are not included for the Tahoe EIP, as it is a five-year program.



Country Club Heights Erosion Control Project

Financing Plan & Tentative Schedule

Project No: 95191

Type: Erosion Control - (EIP)

Supervisor District(s) 5

All Figures in Thousands

Revenue by Funding Source	Prior FY*	FY 14/15	FY 15/16	FY 16/17	FY 17/18	FY 18/19	FY 19/20-23/24**	FY 24/25-33/34**	Total
California Tahoe Conservancy Site Improvement Grant	\$0	\$0	\$0	\$25	\$15	\$13	\$0	\$0	\$53
Tahoe Regional Planning Agency/Water Quality	\$0	\$11	\$59	\$0	\$0	\$0	\$0	\$0	\$70
United States Forest Service Planning Grant	\$110	\$65	\$0	\$0	\$0	\$0	\$0	\$0	\$175
United States Forest Service Site Improvement Grant	\$0	\$0	\$0	\$404	\$0	\$0	\$0	\$0	\$404
Total	\$110	\$76	\$59	\$429	\$15	\$13	\$0	\$0	\$702

All Figures in Thousands

Expenditures	Prior FY*	FY 14/15	FY 15/16	FY 16/17	FY 17/18	FY 18/19	FY 19/20-23/24**	FY 24/25-33/34**	Total
Planning/Env - Consultant	\$27	\$21	\$0	\$0	\$0	\$0	\$0	\$0	\$48
Planning/Env - Staff	\$30	\$20	\$0	\$5	\$0	\$0	\$0	\$0	\$55
Design - Consultant	\$0	\$2	\$0	\$0	\$0	\$0	\$0	\$0	\$2
Design - Staff	\$43	\$30	\$55	\$0	\$0	\$0	\$0	\$0	\$128
Construction Mgmt - Staff	\$0	\$0	\$0	\$70	\$0	\$0	\$0	\$0	\$70
Direct Construction Costs	\$0	\$0	\$0	\$350	\$0	\$0	\$0	\$0	\$350
Env Monitoring - Consultant	\$1	\$1	\$1	\$1	\$0	\$0	\$0	\$0	\$4
Env Monitoring - Staff	\$9	\$3	\$3	\$3	\$5	\$5	\$0	\$0	\$28
Plant Establishment - Staff	\$0	\$0	\$0	\$0	\$10	\$8	\$0	\$0	\$18
Total	\$110	\$76	\$59	\$429	\$15	\$13	\$0	\$0	\$702

Project Schedule	Prior FY*	FY 14/15	FY 15/16	FY 16/17	FY 17/18	FY 18/19	FY 19/20-23/24**	FY 24/25-33/34**
Planning/Environmental								
Design								
Right Of Way								
Construction								
Environmental Monitoring								

*Prior FY includes actual revenue and expenditures through 06/30/13, plus amounts budgeted through 06/30/14.

**FY 19/20 - 23/24 and FY 24/25 - 33/34 revenue and expenditures are not included for the Tahoe EIP, as it is a five-year program.



CSA # 5 Upper Area Erosion Control Project

CIP Project Summary

Project No: 95196

Type: Erosion Control - (EIP)

Supervisor District(s) 5

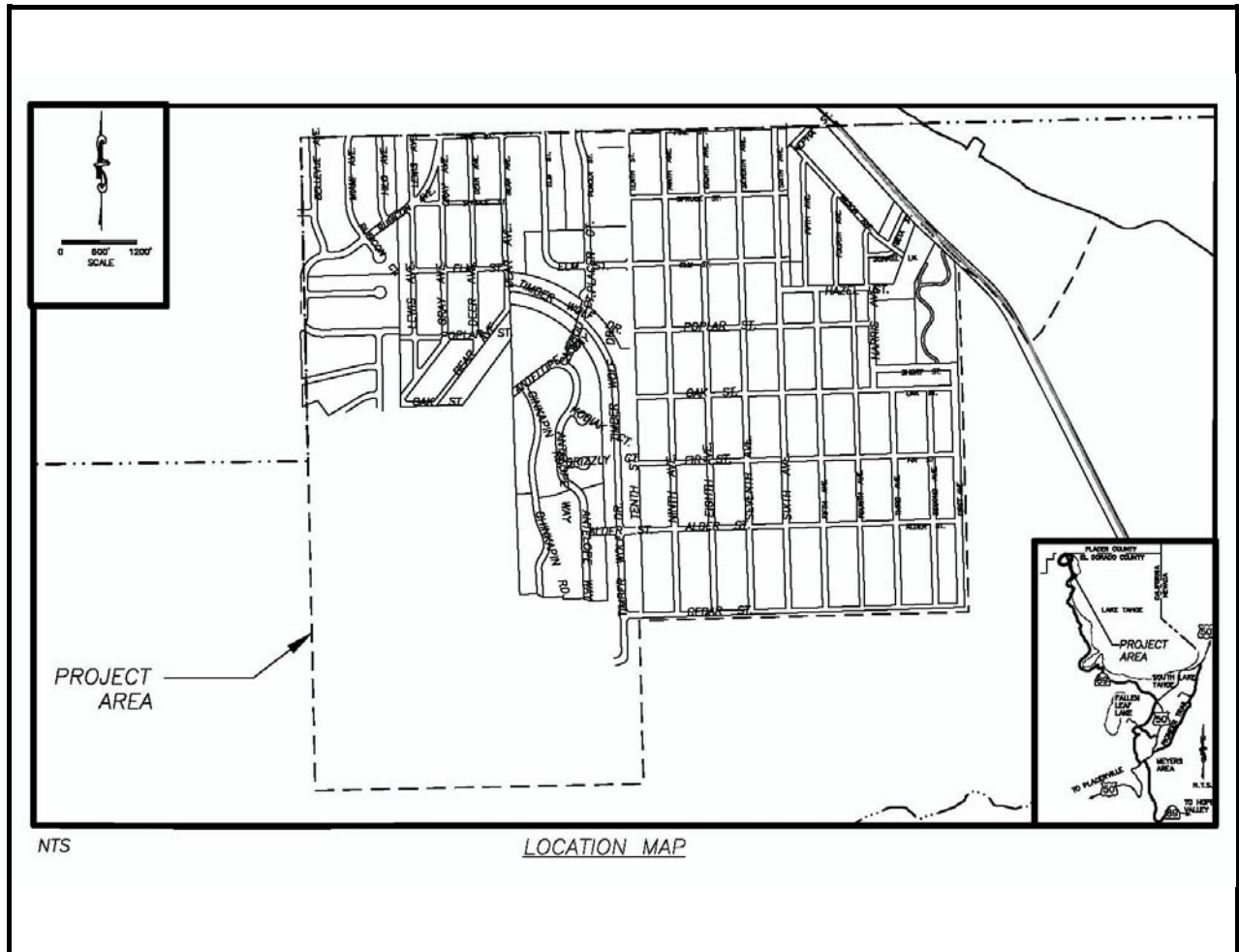

Project Description:

The CSA # 5 Upper Area Erosion Control Project includes the developed portions of the Tahoe Cedars subdivision southwest of Highway 89 between the El Dorado County Line and Poplar Street. The goal of the Project is to reduce the concentration of fine sediment in the storm water which exits the Project area before reaching Lake Tahoe. The funding for this Project will be provided by the California Tahoe Conservancy Soil Erosion Control Grants Program.

Original Budget: \$395,000	Expenditures thru 6/30/2013: \$0	Project Initiation Date: 03/25/13
----------------------------	----------------------------------	-----------------------------------



CSA # 5 Upper Area Erosion Control Project

Financing Plan & Tentative Schedule

Project No: 95196

Type: Erosion Control - (EIP)

Supervisor District(s) 5

All Figures in Thousands

Revenue by Funding Source	Prior FY*	FY 14/15	FY 15/16	FY 16/17	FY 17/18	FY 18/19	FY 19/20-23/24**	FY 24/25-33/34**	Total
California Tahoe Conservancy Site Improvement Grant	\$56	\$340	\$0	\$0	\$0	\$0	\$0	\$0	\$395
Tahoe Regional Planning Agency/Water Quality	\$0	\$0	\$20	\$0	\$0	\$0	\$0	\$0	\$20
Total	\$56	\$340	\$20	\$0	\$0	\$0	\$0	\$0	\$415

All Figures in Thousands

Expenditures	Prior FY*	FY 14/15	FY 15/16	FY 16/17	FY 17/18	FY 18/19	FY 19/20-23/24**	FY 24/25-33/34**	Total
Design - Consultant	\$0	\$7	\$0	\$0	\$0	\$0	\$0	\$0	\$7
Design - Staff	\$56	\$8	\$0	\$0	\$0	\$0	\$0	\$0	\$63
Constr/Eng/Admin - Staff	\$0	\$60	\$0	\$0	\$0	\$0	\$0	\$0	\$60
Direct Construction Costs	\$0	\$245	\$0	\$0	\$0	\$0	\$0	\$0	\$245
Env Monitoring - Staff	\$0	\$10	\$10	\$0	\$0	\$0	\$0	\$0	\$20
Plant Establishment - Consultant	\$0	\$5	\$5	\$0	\$0	\$0	\$0	\$0	\$10
Plant Establishment - Staff	\$0	\$6	\$5	\$0	\$0	\$0	\$0	\$0	\$11
Total	\$56	\$340	\$20	\$0	\$0	\$0	\$0	\$0	\$415

Project Schedule	Prior FY*	FY 14/15	FY 15/16	FY 16/17	FY 17/18	FY 18/19	FY 19/20-23/24**	FY 24/25-33/34**
Planning/Environmental								
Design								
Right Of Way								
Construction								
Environmental Monitoring								

*Prior FY includes actual revenue and expenditures through 06/30/13, plus amounts budgeted through 06/30/14.

**FY 19/20 - 23/24 and FY 24/25 - 33/34 revenue and expenditures are not included for the Tahoe EIP, as it is a five-year program.



CSA #5 Erosion Control Project

CIP Project Summary

Project No: 95157

Type: Erosion Control - (EIP)

Supervisor District(s) 5

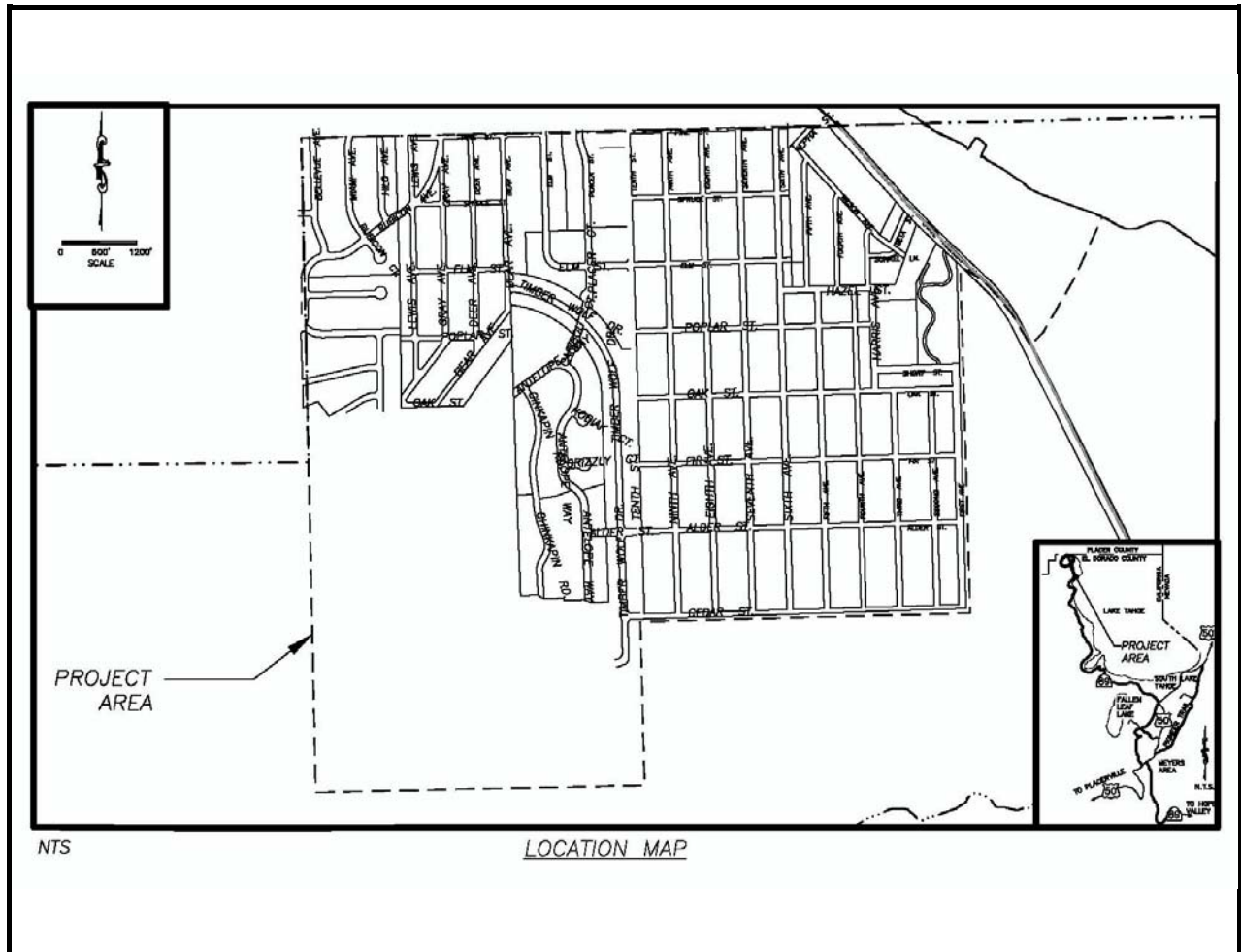

Project Description:

This Project will be the first phase within the overall Environmental Improvement Plan (EIP # 10062) currently named the Tahoe Cedars/Westlake Storm Water Management and Erosion Control Project.

The CSA #5 Erosion Control Project will complete the storm water management/erosion control improvements within this urban watershed. The goal of the Project is to reduce the concentration of fine sediment in the storm water which exits in the Project area before reaching Lake Tahoe. The funding for this Project will be provided by the California Tahoe Conservancy Soil Erosion Control Grants Program.

The updated goals for this Project relate to the Total Maximum Daily Load draft documents which identify very fine sediment (20 um or less) within the urban areas as one source of pollutant loading creating the clarity decline within Lake Tahoe.

Original Budget: \$1,450,000

Expenditures thru 6/30/2013: \$29,572

Project Initiation Date: 10/26/98

*Prior FY includes actual revenue and expenditures through 06/30/13, plus amounts budgeted through 06/30/14.

**FY 19/20 - 23/24 and FY 24/25 - 33/34 revenue and expenditures are not included for the Tahoe EIP, as it is a five-year program.



CSA #5 Erosion Control Project

Financing Plan & Tentative Schedule

Project No: 95157

Type: Erosion Control - (EIP)

Supervisor District(s) 5

All Figures in Thousands

Revenue by Funding Source	Prior FY*	FY 14/15	FY 15/16	FY 16/17	FY 17/18	FY 18/19	FY 19/20-23/24**	FY 24/25-33/34**	Total
Tahoe Regional Planning Agency/Water Quality	\$0	\$0	\$0	\$9	\$15	\$0	\$0	\$0	\$24
United States Forest Service Planning Grant	\$69	\$150	\$23	\$8	\$0	\$0	\$0	\$0	\$250
United States Forest Service Site Improvement Grant	\$0	\$15	\$237	\$253	\$0	\$0	\$0	\$0	\$505
Total	\$69	\$165	\$260	\$270	\$15	\$0	\$0	\$0	\$779

All Figures in Thousands

Expenditures	Prior FY*	FY 14/15	FY 15/16	FY 16/17	FY 17/18	FY 18/19	FY 19/20-23/24**	FY 24/25-33/34**	Total
Planning/Env - Consultant	\$22	\$24	\$0	\$0	\$0	\$0	\$0	\$0	\$46
Planning/Env - Staff	\$46	\$10	\$0	\$0	\$0	\$0	\$0	\$0	\$56
Design - Staff	\$0	\$119	\$40	\$0	\$0	\$0	\$0	\$0	\$159
Construction Mgmt - Consultant	\$0	\$0	\$5	\$0	\$0	\$0	\$0	\$0	\$5
Construction Mgmt - Staff	\$0	\$0	\$40	\$45	\$0	\$0	\$0	\$0	\$85
Direct Construction Costs	\$0	\$0	\$150	\$200	\$0	\$0	\$0	\$0	\$350
Env Monitoring - Consultant	\$0	\$3	\$5	\$5	\$0	\$0	\$0	\$0	\$13
Env Monitoring - Staff	\$0	\$10	\$10	\$10	\$0	\$0	\$0	\$0	\$30
Plant Establishment - Consultant	\$0	\$0	\$0	\$0	\$5	\$0	\$0	\$0	\$5
Plant Establishment - Staff	\$0	\$0	\$10	\$10	\$10	\$0	\$0	\$0	\$30
Total	\$69	\$165	\$260	\$270	\$15	\$0	\$0	\$0	\$779

Project Schedule	Prior FY*	FY 14/15	FY 15/16	FY 16/17	FY 17/18	FY 18/19	FY 19/20-23/24**	FY 24/25-33/34**
Planning/Environmental								
Design								
Right Of Way								
Construction								
Environmental Monitoring								

*Prior FY includes actual revenue and expenditures through 06/30/13, plus amounts budgeted through 06/30/14.

**FY 19/20 - 23/24 and FY 24/25 - 33/34 revenue and expenditures are not included for the Tahoe EIP, as it is a five-year program.



Echo View 2 Erosion Control Project

CIP Project Summary

Project No: 95169

Type: Erosion Control - (EIP)

Supervisor District(s) 5

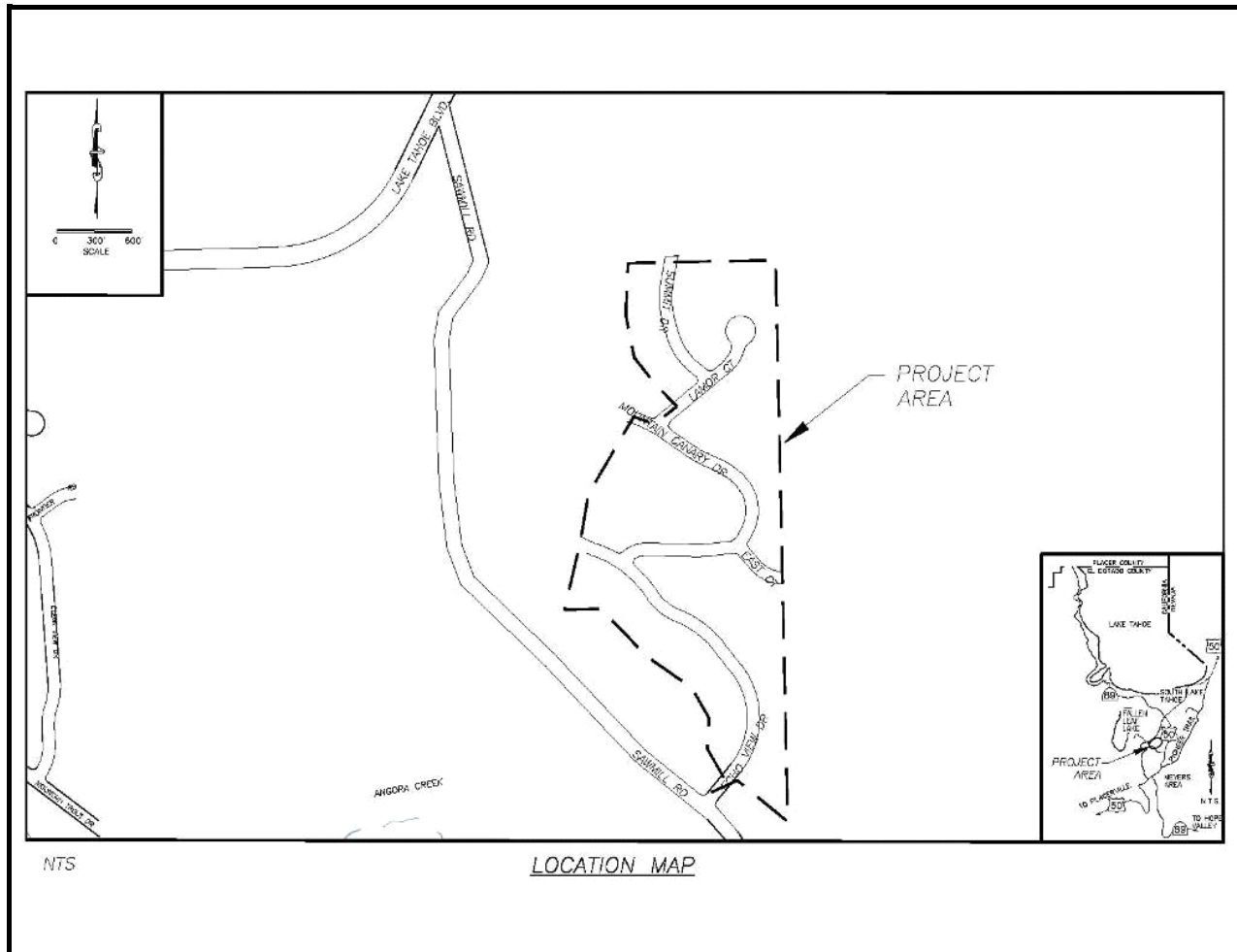

Project Description:

This Project is the second Phase of the Echo View Estates Erosion Control Project which was completed in 1988. The primary goal of this Project is to help improve the clarity of Lake Tahoe by reducing water quality impacts caused by the development of the Echo View Estates subdivision on Angora Creek., which is a tributary to the Upper Truckee River. The objective of the Project is to reduce the transport of fine sediment from the Project area by constructing and enhancing water quality Best Management Practices (BMPs) with the Project area.

Original Budget: \$2,501,031

Expenditures thru 6/30/2013: \$752,354

Project Initiation Date: 06/15/07

*Prior FY includes actual revenue and expenditures through 06/30/13, plus amounts budgeted through 06/30/14.

**FY 19/20 - 23/24 and FY 24/25 - 33/34 revenue and expenditures are not included for the Tahoe EIP, as it is a five-year program.



Echo View 2 Erosion Control Project

Financing Plan & Tentative Schedule

Project No: 95169

Type: Erosion Control - (EIP)

Supervisor District(s) 5

All Figures in Thousands

Revenue by Funding Source	Prior FY*	FY 14/15	FY 15/16	FY 16/17	FY 17/18	FY 18/19	FY 19/20-23/24**	FY 24/25-33/34**	Total
California Tahoe Conservancy Planning Grant	\$140	\$0	\$0	\$0	\$0	\$0	\$0	\$0	\$140
Tahoe Regional Planning Agency/Water Quality	\$57	\$3	\$0	\$0	\$0	\$0	\$0	\$0	\$59
United States Forest Service Planning Grant	\$168	\$0	\$0	\$0	\$0	\$0	\$0	\$0	\$168
United States Forest Service Site Improvement Grant	\$400	\$13	\$0	\$0	\$0	\$0	\$0	\$0	\$413
Total	\$765	\$15	\$0	\$0	\$0	\$0	\$0	\$0	\$780

All Figures in Thousands

Expenditures	Prior FY*	FY 14/15	FY 15/16	FY 16/17	FY 17/18	FY 18/19	FY 19/20-23/24**	FY 24/25-33/34**	Total
Planning/Env - Consultant	\$21	\$0	\$0	\$0	\$0	\$0	\$0	\$0	\$21
Design - Consultant	\$59	\$0	\$0	\$0	\$0	\$0	\$0	\$0	\$59
Design - Staff	\$238	\$0	\$0	\$0	\$0	\$0	\$0	\$0	\$238
Right of Way - Acquisition	\$3	\$0	\$0	\$0	\$0	\$0	\$0	\$0	\$3
Right of Way - Consultant	\$2	\$0	\$0	\$0	\$0	\$0	\$0	\$0	\$2
Right of Way - Staff	\$14	\$0	\$0	\$0	\$0	\$0	\$0	\$0	\$14
Construction Mgmt - Staff	\$93	\$0	\$0	\$0	\$0	\$0	\$0	\$0	\$93
Direct Construction Costs	\$308	\$0	\$0	\$0	\$0	\$0	\$0	\$0	\$308
Env Monitoring - Staff	\$8	\$5	\$0	\$0	\$0	\$0	\$0	\$0	\$13
Plant Establishment - Consultant	\$9	\$0	\$0	\$0	\$0	\$0	\$0	\$0	\$9
Plant Establishment - Staff	\$11	\$10	\$0	\$0	\$0	\$0	\$0	\$0	\$21
Total	\$765	\$15	\$0	\$0	\$0	\$0	\$0	\$0	\$780

Project Schedule	Prior FY*	FY 14/15	FY 15/16	FY 16/17	FY 17/18	FY 18/19	FY 19/20-23/24**	FY 24/25-33/34**
Planning/Environmental								
Design								
Right Of Way								
Construction								
Environmental Monitoring								

*Prior FY includes actual revenue and expenditures through 06/30/13, plus amounts budgeted through 06/30/14.

**FY 19/20 - 23/24 and FY 24/25 - 33/34 revenue and expenditures are not included for the Tahoe EIP, as it is a five-year program.



Forest View Water Quality Project

CIP Project Summary

Project No: 95195

Type: Erosion Control - (EIP)

Supervisor District(s) 5

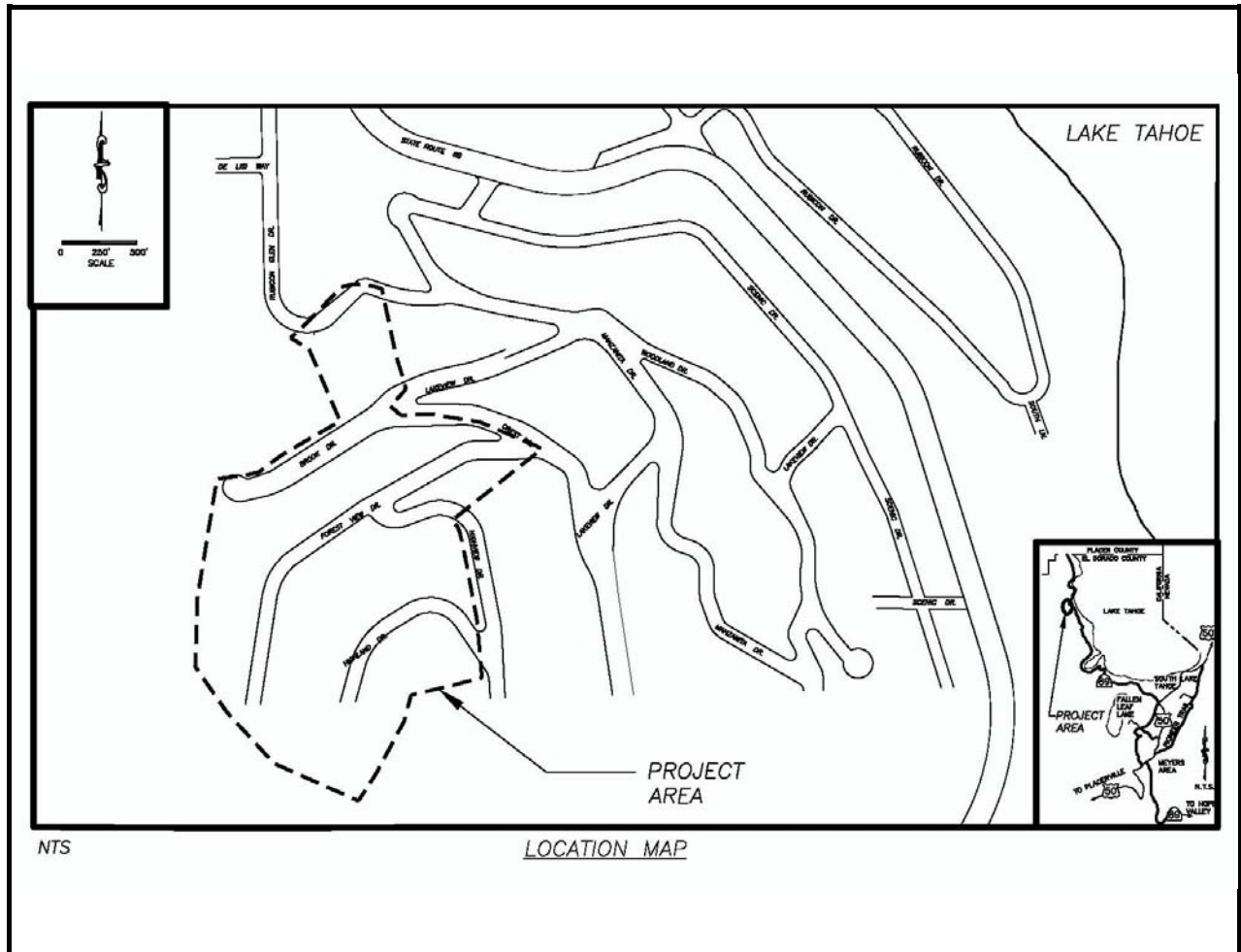

Project Description:

The Forest View Water Quality Project is within the Rubicon Properties Unit No. 2 subdivision which is roughly bordered by Lonely Gulch to the north, Woodland Drive to the east, Highland Drive to the south, and the Forest View to the west . The Project is within the Tahoe Regional Planning Agency (TRPA) Plan Area Statement area 149-Rubicon as well as part of the Environmental Improvement Program (EIP) Project #713 . As part of EIP 713, Transportation Tahoe Engineering Division constructed the Rubicon IV Erosion Control Project. The project addressed most sources of erosion, but had minimal treatment and also helped to connect the storm water flows to Lonely Gulch. The main goal of this Project are to reduce the very fine and fine sediment which will improve the clarity of Lake Tahoe.

Original Budget: \$100,500

Expenditures thru 6/30/2013: \$0

Project Initiation Date: 04/01/13

*Prior FY includes actual revenue and expenditures through 06/30/13, plus amounts budgeted through 06/30/14.

**FY 19/20 - 23/24 and FY 24/25 - 33/34 revenue and expenditures are not included for the Tahoe EIP, as it is a five-year program.



Forest View Water Quality Project

Financing Plan & Tentative Schedule

Project No: 95195

Type: Erosion Control - (EIP)

Supervisor District(s) 5

All Figures in Thousands

Revenue by Funding Source	Prior FY*	FY 14/15	FY 15/16	FY 16/17	FY 17/18	FY 18/19	FY 19/20-23/24**	FY 24/25-33/34**	Total
California Tahoe Conservancy Site Improvement Grant	\$101	\$305	\$0	\$0	\$0	\$0	\$0	\$0	\$405
Tahoe Regional Planning Agency/Water Quality	\$0	\$0	\$20	\$0	\$0	\$0	\$0	\$0	\$20
Total	\$101	\$305	\$20	\$0	\$0	\$0	\$0	\$0	\$425

All Figures in Thousands

Expenditures	Prior FY*	FY 14/15	FY 15/16	FY 16/17	FY 17/18	FY 18/19	FY 19/20-23/24**	FY 24/25-33/34**	Total
Design - Staff	\$101	\$20	\$0	\$0	\$0	\$0	\$0	\$0	\$120
Construction Mgmt - Consultant	\$0	\$22	\$0	\$0	\$0	\$0	\$0	\$0	\$22
Construction Mgmt - Staff	\$0	\$38	\$0	\$0	\$0	\$0	\$0	\$0	\$38
Direct Construction Costs	\$0	\$205	\$0	\$0	\$0	\$0	\$0	\$0	\$205
Env Monitoring - Staff	\$0	\$10	\$10	\$0	\$0	\$0	\$0	\$0	\$20
Plant Establishment - Consultant	\$0	\$0	\$5	\$0	\$0	\$0	\$0	\$0	\$5
Plant Establishment - Staff	\$0	\$10	\$5	\$0	\$0	\$0	\$0	\$0	\$15
Total	\$101	\$305	\$20	\$0	\$0	\$0	\$0	\$0	\$425

Project Schedule	Prior FY*	FY 14/15	FY 15/16	FY 16/17	FY 17/18	FY 18/19	FY 19/20-23/24**	FY 24/25-33/34**
Planning/Environmental								
Design								
Right Of Way								
Construction								
Environmental Monitoring								

*Prior FY includes actual revenue and expenditures through 06/30/13, plus amounts budgeted through 06/30/14.

**FY 19/20 - 23/24 and FY 24/25 - 33/34 revenue and expenditures are not included for the Tahoe EIP, as it is a five-year program.



Golden Bear Erosion Control Project

CIP Project Summary

Project No: 95176

Type: Erosion Control - (EIP)

Supervisor District(s) 5

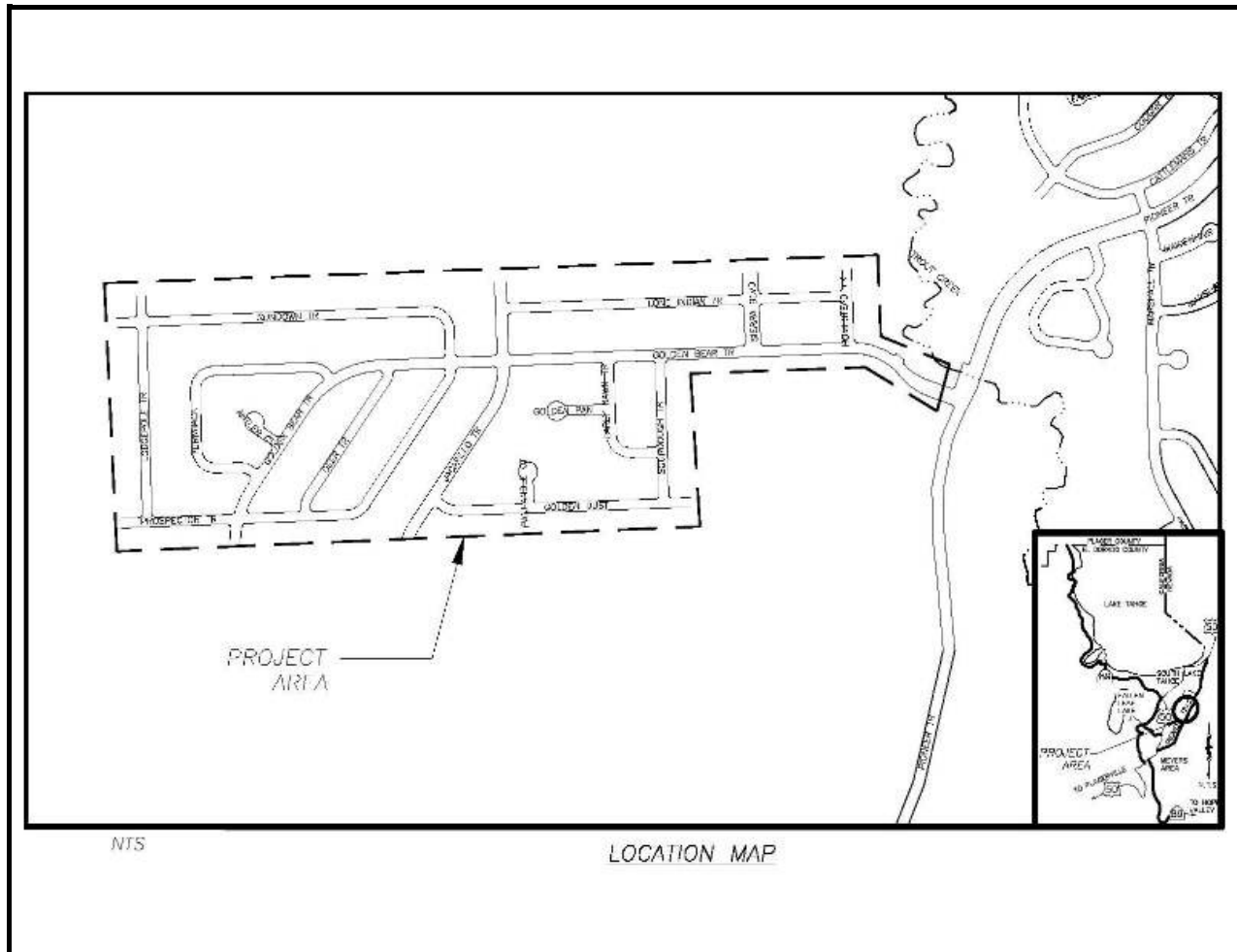

Project Description:

The Golden Bear Erosion Control Project is within the Tahoe Regional Planning Agency (TRPA) Plan Area Statement area 115-Golden Bear, 095-Trout/Cold Creek, and 100-Truckee Marsh (Figure A). In addition it is identified in the Environmental Improvement Program (EIP) as Area #703 requiring erosion control and water quality treatment Best Management Practices (BMPs). The subdivision was constructed with conveyance systems in the County ROW, including curb and gutter, drainage inlets, and underground storm drain pipe. These systems were designed to convey, but not to treat the storm water. The main goal of the Project is to reduce the very fine and fine sediment from the Montgomery Estates Unit No. 7 subdivision which will improve the clarity of Lake Tahoe.

Original Budget: \$3,034,271

Expenditures thru 6/30/2013: \$119,633

Project Initiation Date: 12/15/10

*Prior FY includes actual revenue and expenditures through 06/30/13, plus amounts budgeted through 06/30/14.

**FY 19/20 - 23/24 and FY 24/25 - 33/34 revenue and expenditures are not included for the Tahoe EIP, as it is a five-year program.



Golden Bear Erosion Control Project

Financing Plan & Tentative Schedule

Project No: 95176

Type: Erosion Control - (EIP)

Supervisor District(s) 5

All Figures in Thousands

Revenue by Funding Source	Prior FY*	FY 14/15	FY 15/16	FY 16/17	FY 17/18	FY 18/19	FY 19/20-23/24**	FY 24/25-33/34**	Total
California Tahoe Conservancy Site Improvement Grant	\$2	\$225	\$0	\$0	\$0	\$0	\$0	\$0	\$227
Tahoe Regional Planning Agency/Water Quality	\$32	\$6	\$5	\$5	\$0	\$0	\$0	\$0	\$47
United States Forest Service Planning Grant	\$144	\$2	\$0	\$0	\$0	\$0	\$0	\$0	\$146
United States Forest Service Site Improvement Grant	\$21	\$0	\$0	\$0	\$0	\$0	\$0	\$0	\$21
Total	\$199	\$233	\$5	\$5	\$0	\$0	\$0	\$0	\$441

All Figures in Thousands

Expenditures	Prior FY*	FY 14/15	FY 15/16	FY 16/17	FY 17/18	FY 18/19	FY 19/20-23/24**	FY 24/25-33/34**	Total
Planning/Env - Consultant	\$46	\$0	\$0	\$0	\$0	\$0	\$0	\$0	\$46
Planning/Env - Staff	\$7	\$0	\$0	\$0	\$0	\$0	\$0	\$0	\$7
Design - Consultant	\$0	\$6	\$0	\$0	\$0	\$0	\$0	\$0	\$6
Design - Staff	\$142	\$10	\$0	\$0	\$0	\$0	\$0	\$0	\$152
Construction Mgmt - Staff	\$4	\$52	\$0	\$0	\$0	\$0	\$0	\$0	\$56
Direct Construction Costs	\$0	\$145	\$0	\$0	\$0	\$0	\$0	\$0	\$145
Env Monitoring - Consultant	\$0	\$2	\$0	\$0	\$0	\$0	\$0	\$0	\$2
Env Monitoring - Staff	\$0	\$8	\$0	\$0	\$0	\$0	\$0	\$0	\$8
Plant Establishment - Consultant	\$0	\$5	\$0	\$0	\$0	\$0	\$0	\$0	\$5
Plant Establishment - Staff	\$0	\$5	\$5	\$5	\$0	\$0	\$0	\$0	\$15
Total	\$198	\$232	\$5	\$5	\$0	\$0	\$0	\$0	\$440

Project Schedule	Prior FY*	FY 14/15	FY 15/16	FY 16/17	FY 17/18	FY 18/19	FY 19/20-23/24**	FY 24/25-33/34**
Planning/Environmental								
Design								
Right Of Way								
Construction								
Environmental Monitoring								

*Prior FY includes actual revenue and expenditures through 06/30/13, plus amounts budgeted through 06/30/14.

**FY 19/20 - 23/24 and FY 24/25 - 33/34 revenue and expenditures are not included for the Tahoe EIP, as it is a five-year program.



Highway 89 Class 1 Trail

CIP Project Summary

Project No: 95708

Type: Erosion Control - (EIP)

Supervisor District(s) 5

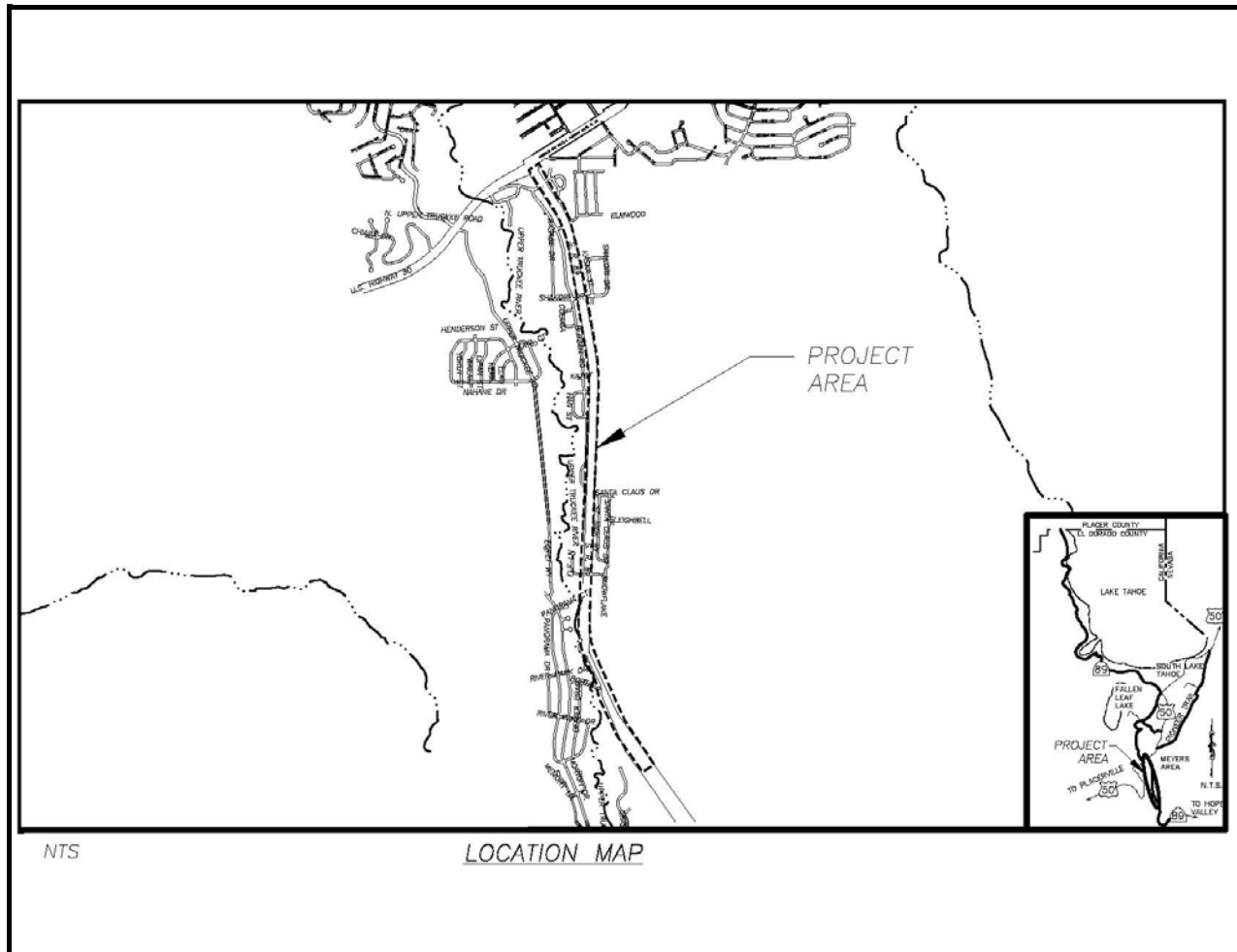

Project Description:

The Class I bikeway along State Route 89 from Portal Road to US Highway 50 in Christmas Valley is intended to improve the regional bicycle path network by providing a critical link through the Christmas Valley area. The purpose of the project is to provide access to local businesses, schools, and offices for bicyclists and pedestrians, to reduce vehicular transportation, and to enhance recreational opportunities within the Lake Tahoe Basin. This bicycle facility will connect to the existing Pat Lowe Memorial Bike Path in community of Meyers.

Original Budget: \$3,000,000

Expenditures thru 6/30/2013: \$0

Project Initiation Date: 02/13/07

*Prior FY includes actual revenue and expenditures through 06/30/13, plus amounts budgeted through 06/30/14.

**FY 19/20 - 23/24 and FY 24/25 - 33/34 revenue and expenditures are not included for the Tahoe EIP, as it is a five-year program.



Highway 89 Class 1 Trail

Financing Plan & Tentative Schedule

Project No: 95708

Type: Erosion Control - (EIP)

Supervisor District(s) 5

All Figures in Thousands

Revenue by Funding Source	Prior FY*	FY 14/15	FY 15/16	FY 16/17	FY 17/18	FY 18/19	FY 19/20-23/24**	FY 24/25-33/34**	Total
Bicycle Transportation Account (BTA)	\$0	\$0	\$24	\$0	\$49	\$0	\$0	\$0	\$73
California Tahoe Conservancy Site Improvement Grant	\$0	\$0	\$0	\$0	\$128	\$242	\$0	\$0	\$369
Congestion Mitigation and Air Quality Program	\$0	\$0	\$0	\$0	\$0	\$450	\$0	\$0	\$450
RSTP Exchange Funds-TRPA	\$0	\$0	\$78	\$0	\$0	\$250	\$0	\$0	\$328
Safe Routes to School - State	\$0	\$0	\$0	\$0	\$450	\$0	\$0	\$0	\$450
Tahoe Regional Planning Agency/Air Quality	\$0	\$0	\$100	\$75	\$256	\$0	\$0	\$0	\$431
Total	\$0	\$0	\$202	\$75	\$882	\$942	\$0	\$0	\$2,100

All Figures in Thousands

Expenditures	Prior FY*	FY 14/15	FY 15/16	FY 16/17	FY 17/18	FY 18/19	FY 19/20-23/24**	FY 24/25-33/34**	Total
Planning/Env - Consultant	\$0	\$0	\$25	\$0	\$0	\$0	\$0	\$0	\$25
Planning/Env - Staff	\$0	\$0	\$77	\$0	\$0	\$0	\$0	\$0	\$77
Design - Staff	\$0	\$0	\$100	\$75	\$0	\$0	\$0	\$0	\$175
Construction Mgmt - Consultant	\$0	\$0	\$0	\$0	\$0	\$7	\$0	\$0	\$7
Construction Mgmt - Staff	\$0	\$0	\$0	\$0	\$182	\$190	\$0	\$0	\$372
Direct Construction Costs	\$0	\$0	\$0	\$0	\$700	\$720	\$0	\$0	\$1,420
Env Monitoring - Staff	\$0	\$0	\$0	\$0	\$0	\$10	\$0	\$0	\$10
Plant Establishment - Staff	\$0	\$0	\$0	\$0	\$0	\$15	\$0	\$0	\$15
Total	\$0	\$0	\$202	\$75	\$882	\$942	\$0	\$0	\$2,100



Project Schedule	Prior FY*	FY 14/15	FY 15/16	FY 16/17	FY 17/18	FY 18/19	FY 19/20-23/24**	FY 24/25-33/34**
Planning/Environmental								
Design								
Right Of Way								
Construction								
Environmental Monitoring								

*Prior FY includes actual revenue and expenditures through 06/30/13, plus amounts budgeted through 06/30/14.

**FY 19/20 - 23/24 and FY 24/25 - 33/34 revenue and expenditures are not included for the Tahoe EIP, as it is a five-year program.



Lake Tahoe Boulevard Bike Trail Project

CIP Project Summary

Project No: 95186

Type: Erosion Control - (EIP)

Supervisor District(s) 5

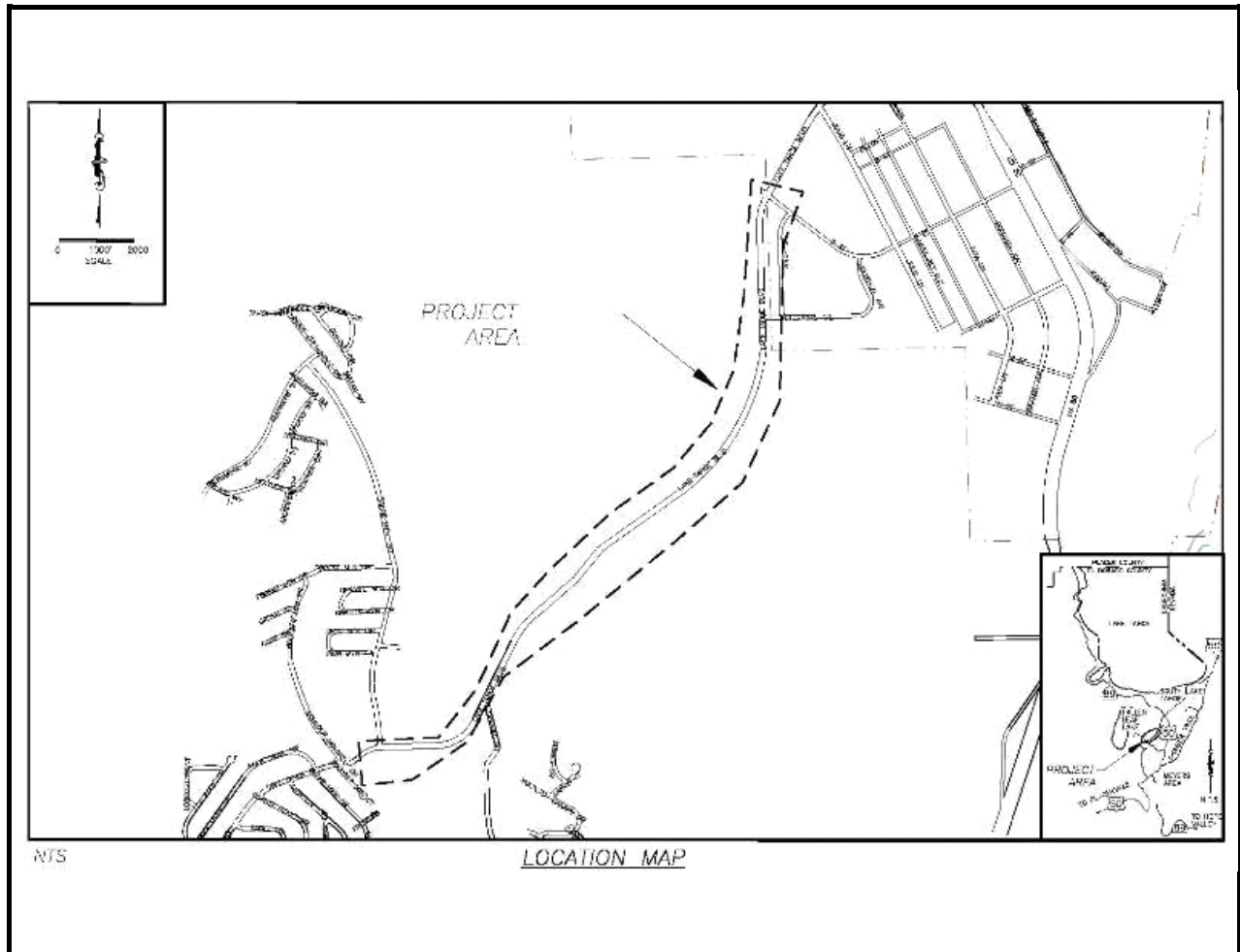

Project Description:

The Project proposes to construct a Class I multi-use path along Lake Tahoe Blvd from Sawmill Road to the City of South Lake Tahoe city limits and connect to the Class 2 bike lane at Viking Road. The purpose of the project is to provide access to local businesses, schools, and offices for bicyclists and pedestrians, to reduce vehicular transportation, and to enhance recreational opportunities within the Lake Tahoe Basin. This bicycle facility will connect to the existing Sawmill 2 Bike Path at the Sawmill Road/ Lake Tahoe Blvd intersection.

Original Budget: \$5,819,729

Expenditures thru 6/30/2013: \$482,428

Project Initiation Date: 12/15/05

*Prior FY includes actual revenue and expenditures through 06/30/13, plus amounts budgeted through 06/30/14.

**FY 19/20 - 23/24 and FY 24/25 - 33/34 revenue and expenditures are not included for the Tahoe EIP, as it is a five-year program.



Lake Tahoe Boulevard Bike Trail Project

Financing Plan & Tentative Schedule

Project No: 95186

Type: Erosion Control - (EIP)

Supervisor District(s) 5

All Figures in Thousands

Revenue by Funding Source	Prior FY*	FY 14/15	FY 15/16	FY 16/17	FY 17/18	FY 18/19	FY 19/20-23/24**	FY 24/25-33/34**	Total
California Tahoe Conservancy Planning Grant	\$122	\$0	\$0	\$0	\$0	\$0	\$0	\$0	\$122
Congestion Mitigation and Air Quality Program	\$190	\$440	\$0	\$0	\$0	\$0	\$0	\$0	\$630
RSTP Exchange Funds-TRPA	\$145	\$200	\$6	\$0	\$0	\$0	\$0	\$0	\$350
Safe Routes to School - State	\$0	\$450	\$0	\$0	\$0	\$0	\$0	\$0	\$450
Tahoe Regional Planning Agency/Air Quality	\$82	\$50	\$28	\$15	\$0	\$0	\$0	\$0	\$175
Total	\$539	\$1,140	\$34	\$15	\$0	\$0	\$0	\$0	\$1,728

All Figures in Thousands

Expenditures	Prior FY*	FY 14/15	FY 15/16	FY 16/17	FY 17/18	FY 18/19	FY 19/20-23/24**	FY 24/25-33/34**	Total
Planning/Env - Consultant	\$76	\$0	\$0	\$0	\$0	\$0	\$0	\$0	\$76
Planning/Env - Staff	\$330	\$0	\$0	\$0	\$0	\$0	\$0	\$0	\$330
Design - Staff	\$114	\$0	\$0	\$0	\$0	\$0	\$0	\$0	\$114
Right of Way - Consultant	\$6	\$0	\$0	\$0	\$0	\$0	\$0	\$0	\$6
Right of Way - Staff	\$11	\$0	\$0	\$0	\$0	\$0	\$0	\$0	\$11
Construction Mgmt - Consultant	\$0	\$27	\$0	\$0	\$0	\$0	\$0	\$0	\$27
Construction Mgmt - Staff	\$0	\$277	\$15	\$0	\$0	\$0	\$0	\$0	\$292
Direct Construction Costs	\$0	\$800	\$0	\$0	\$0	\$0	\$0	\$0	\$800
Env Monitoring - Consultant	\$2	\$0	\$0	\$0	\$0	\$0	\$0	\$0	\$2
Env Monitoring - Staff	\$0	\$1	\$5	\$5	\$0	\$0	\$0	\$0	\$11
Plant Establishment - Consultant	\$0	\$25	\$4	\$0	\$0	\$0	\$0	\$0	\$29
Plant Establishment - Staff	\$0	\$10	\$10	\$10	\$0	\$0	\$0	\$0	\$30
Total	\$539	\$1,140	\$34	\$15	\$0	\$0	\$0	\$0	\$1,728

Project Schedule	Prior FY*	FY 14/15	FY 15/16	FY 16/17	FY 17/18	FY 18/19	FY 19/20-23/24**	FY 24/25-33/34**
Planning/Environmental								
Design								
Right Of Way								
Construction								
Environmental Monitoring								

*Prior FY includes actual revenue and expenditures through 06/30/13, plus amounts budgeted through 06/30/14.

**FY 19/20 - 23/24 and FY 24/25 - 33/34 revenue and expenditures are not included for the Tahoe EIP, as it is a five-year program.



Lake Tahoe Boulevard Erosion Control Project

CIP Project Summary

Project No: 95163

Type: Erosion Control - (EIP)

Supervisor District(s) 5

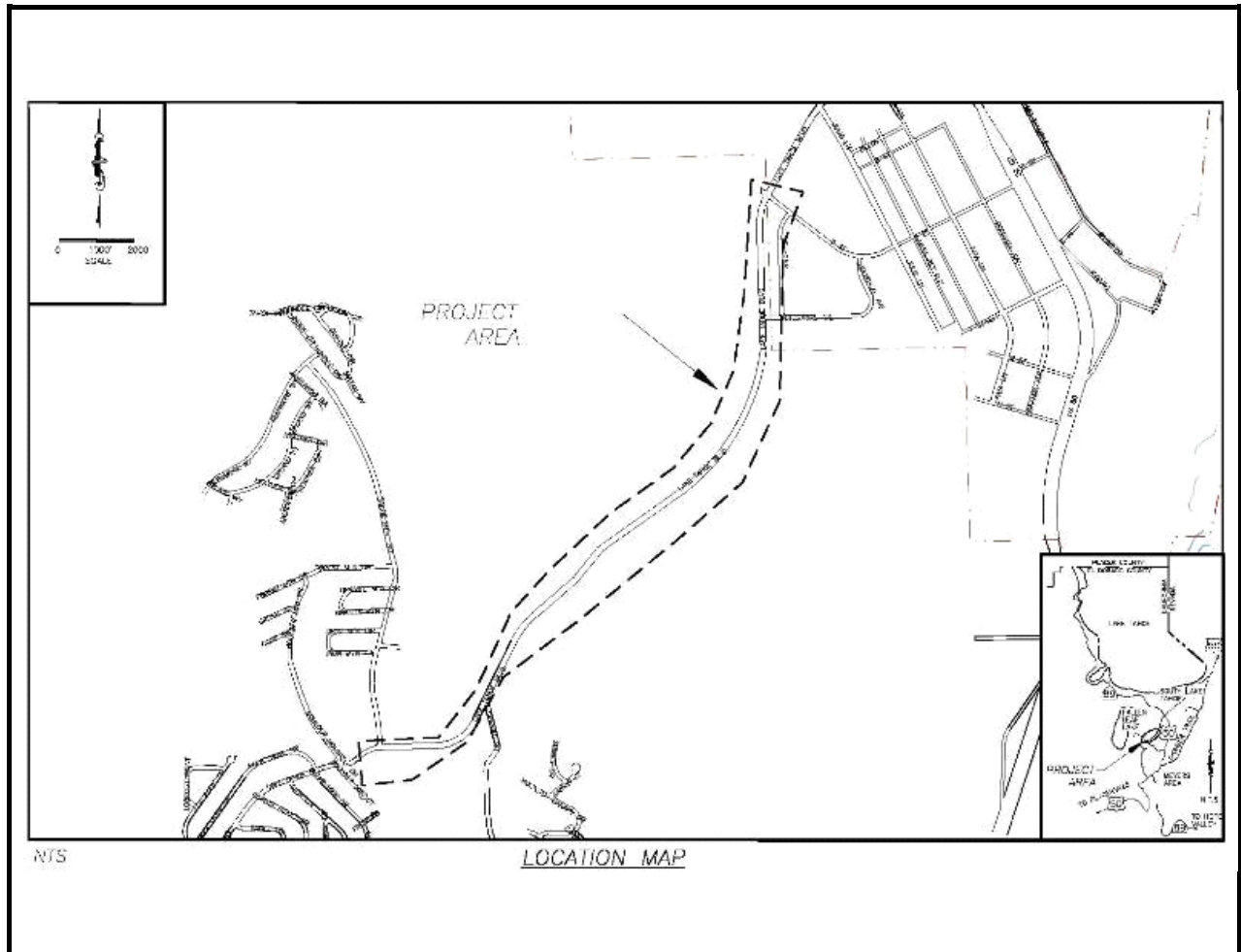

Project Description:

This is one of three Project components within this area, CIP No. 95186 which contains a Class I multi-use path and the restoration of the stream environment zone (SEZ) (CIP No. 95175) to its natural function near the intersection of Lake Tahoe Blvd and Sawmill Road. This component, along with CIP No. 95175 is combined as one. The Project will implement erosion source controls, storm water treatment facilities and SEZ enhancements along the Lake Tahoe Boulevard corridor from Clear View Drive to Industrial Ave. The Project intends to connect the Class 2 bike lanes at Clear View Drive and tie into the Class 1 bike facilities at Sawmill Road.

Original Budget: \$2,141,077

Expenditures thru 6/30/2013: \$234,119

Project Initiation Date: 02/15/07

*Prior FY includes actual revenue and expenditures through 06/30/13, plus amounts budgeted through 06/30/14.

**FY 19/20 - 23/24 and FY 24/25 - 33/34 revenue and expenditures are not included for the Tahoe EIP, as it is a five-year program.



Lake Tahoe Boulevard Erosion Control Project

Financing Plan & Tentative Schedule

Project No: 95163

Type: Erosion Control - (EIP)

Supervisor District(s) 5

All Figures in Thousands

Revenue by Funding Source	Prior FY*	FY 14/15	FY 15/16	FY 16/17	FY 17/18	FY 18/19	FY 19/20-23/24**	FY 24/25-33/34**	Total
California Tahoe Conservancy Planning Grant	\$103	\$0	\$0	\$0	\$0	\$0	\$0	\$0	\$103
California Tahoe Conservancy Site Improvement Grant	\$0	\$37	\$174	\$0	\$0	\$0	\$0	\$0	\$211
Tahoe Regional Planning Agency/Water Quality	\$45	\$0	\$0	\$73	\$12	\$0	\$0	\$0	\$130
United States Forest Service Site Improvement Grant	\$146	\$40	\$196	\$0	\$0	\$0	\$0	\$0	\$382
Total	\$294	\$77	\$370	\$73	\$12	\$0	\$0	\$0	\$826

All Figures in Thousands

Expenditures	Prior FY*	FY 14/15	FY 15/16	FY 16/17	FY 17/18	FY 18/19	FY 19/20-23/24**	FY 24/25-33/34**	Total
Design - Consultant	\$45	\$7	\$0	\$0	\$0	\$0	\$0	\$0	\$52
Design - Staff	\$228	\$70	\$0	\$0	\$0	\$0	\$0	\$0	\$298
Construction Mgmt - Staff	\$15	\$0	\$75	\$15	\$0	\$0	\$0	\$0	\$105
Direct Construction Costs	\$0	\$0	\$275	\$50	\$0	\$0	\$0	\$0	\$325
Env Monitoring - Consultant	\$1	\$0	\$1	\$0	\$1	\$0	\$0	\$0	\$3
Env Monitoring - Staff	\$4	\$0	\$5	\$5	\$5	\$0	\$0	\$0	\$19
Plant Establishment - Consultant	\$0	\$0	\$6	\$2	\$1	\$0	\$0	\$0	\$9
Plant Establishment - Staff	\$0	\$0	\$9	\$1	\$5	\$0	\$0	\$0	\$15
Total	\$293	\$77	\$370	\$73	\$12	\$0	\$0	\$0	\$825

Project Schedule	Prior FY*	FY 14/15	FY 15/16	FY 16/17	FY 17/18	FY 18/19	FY 19/20-23/24**	FY 24/25-33/34**
Planning/Environmental								
Design								
Right Of Way								
Construction								
Environmental Monitoring								

*Prior FY includes actual revenue and expenditures through 06/30/13, plus amounts budgeted through 06/30/14.

**FY 19/20 - 23/24 and FY 24/25 - 33/34 revenue and expenditures are not included for the Tahoe EIP, as it is a five-year program.



Lake Tahoe Boulevard SEZ Project

CIP Project Summary

Project No: 95175

Type: Erosion Control - (EIP)

Supervisor District(s) 5

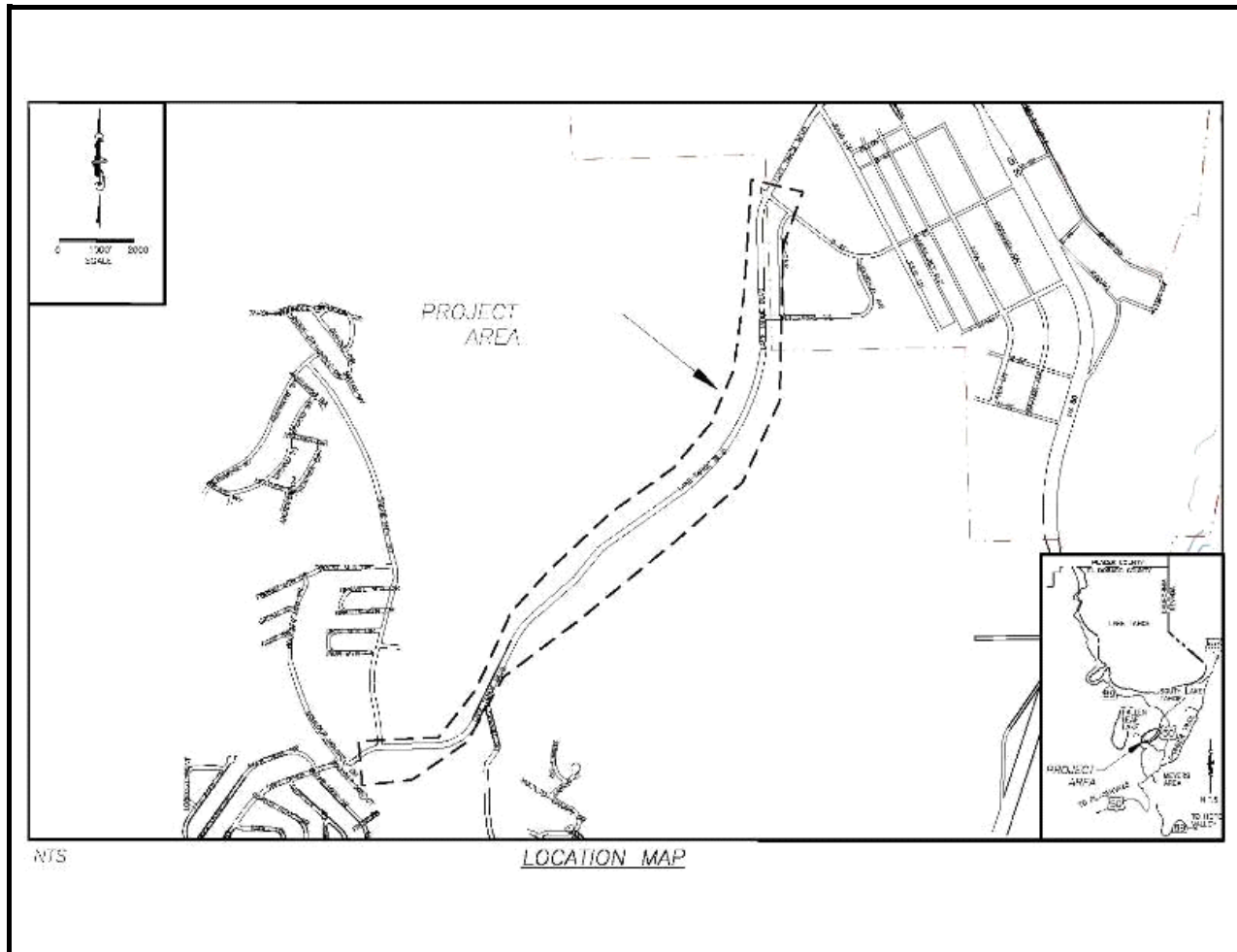

Project Description:

This is one of three Project components within this area, CIP No. 95186 which contains a Class I multi-use path and CIP No. 95163 contains water quality/ erosion control improvements along with the the construction of Class 2 bike lanes. This component, along with CIP No. 95163 is combined as one. The Project will implement erosion source controls, storm water treatment facilities and stream environment zone (SEZ) enhancements along the Lake Tahoe Boulevard corridor from Clear View Drive to Industrial Ave.

Original Budget: \$7,346,266

Expenditures thru 6/30/2013: \$234,869

Project Initiation Date: 10/15/05

*Prior FY includes actual revenue and expenditures through 06/30/13, plus amounts budgeted through 06/30/14.

**FY 19/20 - 23/24 and FY 24/25 - 33/34 revenue and expenditures are not included for the Tahoe EIP, as it is a five-year program.



Lake Tahoe Boulevard SEZ Project

Financing Plan & Tentative Schedule

Project No: 95175

Type: Erosion Control - (EIP)

Supervisor District(s) 5

All Figures in Thousands

Revenue by Funding Source	Prior FY*	FY 14/15	FY 15/16	FY 16/17	FY 17/18	FY 18/19	FY 19/20-23/24**	FY 24/25-33/34**	Total
California Tahoe Conservancy Planning Grant	\$130	\$0	\$0	\$0	\$0	\$0	\$0	\$0	\$130
RSTP Exchange Funds-TRPA	\$0	\$0	\$150	\$96	\$0	\$0	\$0	\$0	\$246
Tahoe Regional Planning Agency/Air Quality	\$8	\$0	\$54	\$0	\$0	\$0	\$0	\$0	\$62
Tahoe Regional Planning Agency/Stream Environmental Zone	\$77	\$19	\$0	\$9	\$31	\$0	\$0	\$0	\$136
United States Forest Service Site Improvement Grant	\$42	\$25	\$59	\$0	\$0	\$0	\$0	\$0	\$125
Total	\$257	\$44	\$263	\$104	\$31	\$0	\$0	\$0	\$698

All Figures in Thousands

Expenditures	Prior FY*	FY 14/15	FY 15/16	FY 16/17	FY 17/18	FY 18/19	FY 19/20-23/24**	FY 24/25-33/34**	Total
Planning/Env - Consultant	\$111	\$0	\$0	\$0	\$0	\$0	\$0	\$0	\$111
Design - Consultant	\$0	\$7	\$0	\$0	\$0	\$0	\$0	\$0	\$7
Design - Staff	\$133	\$38	\$0	\$0	\$0	\$0	\$0	\$0	\$170
Right of Way - Consultant	\$2	\$0	\$0	\$0	\$0	\$0	\$0	\$0	\$2
Construction Mgmt - Staff	\$0	\$0	\$36	\$30	\$0	\$0	\$0	\$0	\$66
Direct Construction Costs	\$0	\$0	\$200	\$50	\$0	\$0	\$0	\$0	\$250
Env Monitoring - Consultant	\$11	\$0	\$1	\$1	\$1	\$0	\$0	\$0	\$13
Env Monitoring - Staff	\$0	\$0	\$4	\$4	\$6	\$0	\$0	\$0	\$13
Plant Establishment - Consultant	\$0	\$0	\$8	\$5	\$5	\$0	\$0	\$0	\$18
Plant Establishment - Staff	\$0	\$0	\$15	\$15	\$20	\$0	\$0	\$0	\$50
Total	\$257	\$44	\$263	\$104	\$31	\$0	\$0	\$0	\$698

Project Schedule	Prior FY*	FY 14/15	FY 15/16	FY 16/17	FY 17/18	FY 18/19	FY 19/20-23/24**	FY 24/25-33/34**
Planning/Environmental								
Design								
Right Of Way								
Construction								
Environmental Monitoring								

*Prior FY includes actual revenue and expenditures through 06/30/13, plus amounts budgeted through 06/30/14.

**FY 19/20 - 23/24 and FY 24/25 - 33/34 revenue and expenditures are not included for the Tahoe EIP, as it is a five-year program.



Meyers Erosion Control Project

CIP Project Summary

Project No: 95179

Type: Erosion Control - (EIP)

Supervisor District(s) 5

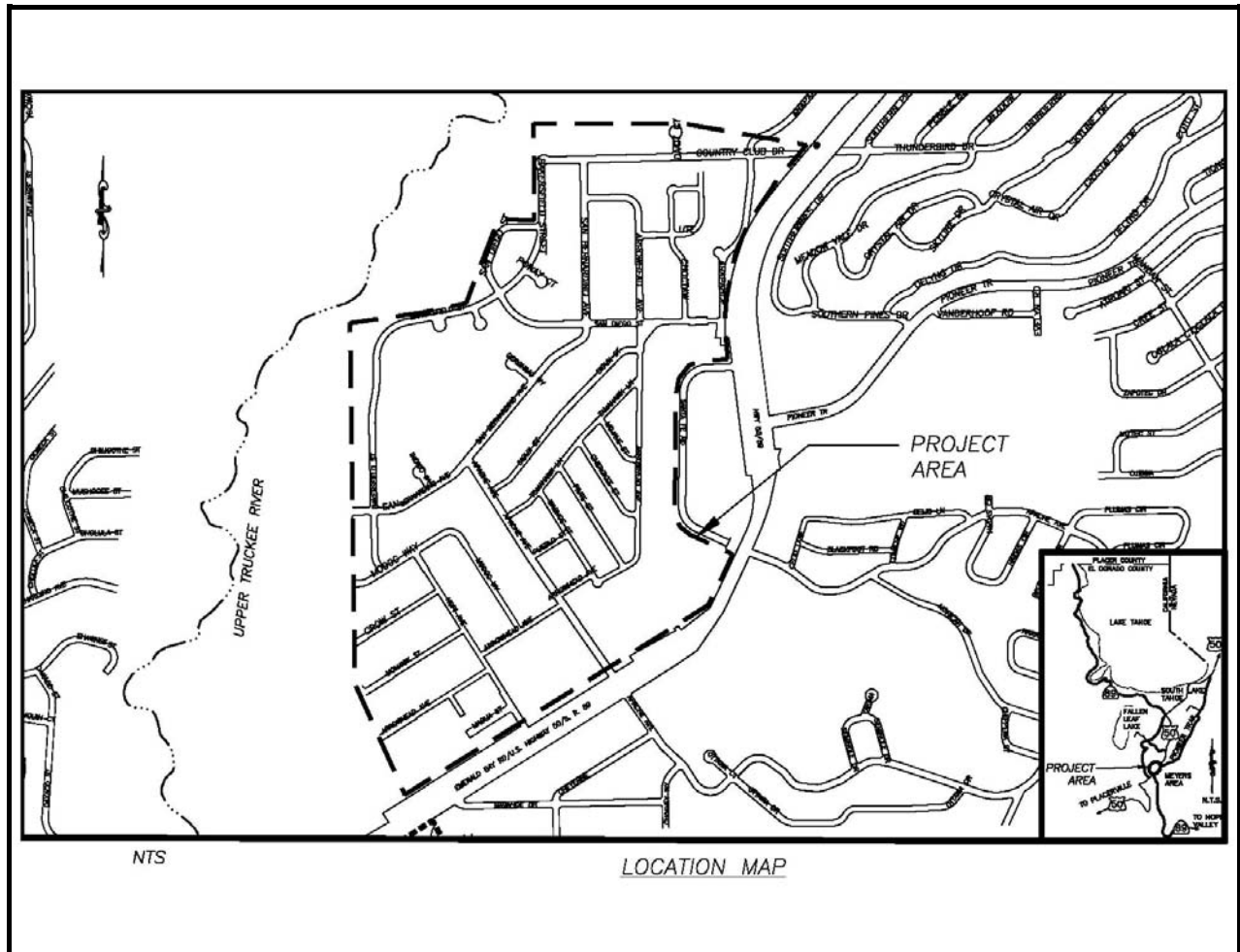

Project Description:

The Meyers Erosion Control Project is located in Tahoe Paradise-Meadowvale, Tahoe Paradise-Mandan and Meyers Residential. The main goal of the Project is to improve the clarity of Lake Tahoe by reducing the detrimental water quality impacts of the Meyers residential area on Lake Tahoe clarity. The objective of the Project is the reduction in the transport of fine sediment from the Project area by constructing water quality Best Management Practices (BMPs) within the Project area. This Project will be split into several areas with the main area focused on the US 50/Meyers corridor area based on the Pollutant Load reductions models.

Original Budget: \$2,722,500

Expenditures thru 6/30/2013: \$278,795

Project Initiation Date: 12/15/10

*Prior FY includes actual revenue and expenditures through 06/30/13, plus amounts budgeted through 06/30/14.

**FY 19/20 - 23/24 and FY 24/25 - 33/34 revenue and expenditures are not included for the Tahoe EIP, as it is a five-year program.



Meyers Erosion Control Project

Financing Plan & Tentative Schedule

Project No: 95179

Type: Erosion Control - (EIP)

Supervisor District(s) 5

All Figures in Thousands

Revenue by Funding Source	Prior FY*	FY 14/15	FY 15/16	FY 16/17	FY 17/18	FY 18/19	FY 19/20-23/24**	FY 24/25-33/34**	Total
California Tahoe Conservancy Planning Grant	\$8	\$0	\$0	\$0	\$0	\$0	\$0	\$0	\$8
State Water Resources Control Board	\$0	\$27	\$344	\$180	\$0	\$0	\$0	\$0	\$550
Tahoe Regional Planning Agency/Stream Environmental Zone	\$0	\$45	\$85	\$17	\$13	\$3	\$0	\$0	\$162
United States Forest Service Planning Grant	\$291	\$0	\$0	\$0	\$0	\$0	\$0	\$0	\$291
United States Forest Service Site Improvement Grant	\$0	\$0	\$300	\$191	\$10	\$10	\$0	\$0	\$511
Total	\$299	\$72	\$729	\$387	\$23	\$13	\$0	\$0	\$1,521

All Figures in Thousands

Expenditures	Prior FY*	FY 14/15	FY 15/16	FY 16/17	FY 17/18	FY 18/19	FY 19/20-23/24**	FY 24/25-33/34**	Total
Planning/Env - Consultant	\$20	\$13	\$0	\$0	\$0	\$0	\$0	\$0	\$33
Planning/Env - Staff	\$104	\$59	\$35	\$0	\$0	\$0	\$0	\$0	\$198
Design - Staff	\$153	\$0	\$75	\$0	\$0	\$0	\$0	\$0	\$228
Right of Way - Acquisition	\$1	\$0	\$2	\$0	\$0	\$0	\$0	\$0	\$3
Right of Way - Consultant	\$3	\$0	\$2	\$0	\$0	\$0	\$0	\$0	\$5
Right of Way - Staff	\$5	\$0	\$4	\$0	\$0	\$0	\$0	\$0	\$9
Construction Mgmt - Staff	\$0	\$0	\$100	\$60	\$0	\$0	\$0	\$0	\$160
Direct Construction Costs	\$0	\$0	\$500	\$300	\$0	\$0	\$0	\$0	\$800
Env Monitoring - Consultant	\$3	\$0	\$0	\$5	\$5	\$3	\$0	\$0	\$15
Env Monitoring - Staff	\$10	\$0	\$0	\$10	\$10	\$5	\$0	\$0	\$35
Plant Establishment - Consultant	\$0	\$0	\$6	\$6	\$3	\$0	\$0	\$0	\$14
Plant Establishment - Staff	\$0	\$0	\$7	\$7	\$5	\$5	\$0	\$0	\$23
Total	\$299	\$72	\$729	\$387	\$23	\$13	\$0	\$0	\$1,521

Project Schedule	Prior FY*	FY 14/15	FY 15/16	FY 16/17	FY 17/18	FY 18/19	FY 19/20-23/24**	FY 24/25-33/34**
Planning/Environmental								
Design								
Right Of Way								
Construction								
Environmental Monitoring								

*Prior FY includes actual revenue and expenditures through 06/30/13, plus amounts budgeted through 06/30/14.

**FY 19/20 - 23/24 and FY 24/25 - 33/34 revenue and expenditures are not included for the Tahoe EIP, as it is a five-year program.



Montgomery Estates Area 1A Erosion Control Project

CIP Project Summary

Project No: 95155

Type: Erosion Control - (EIP)

Supervisor District(s) 5

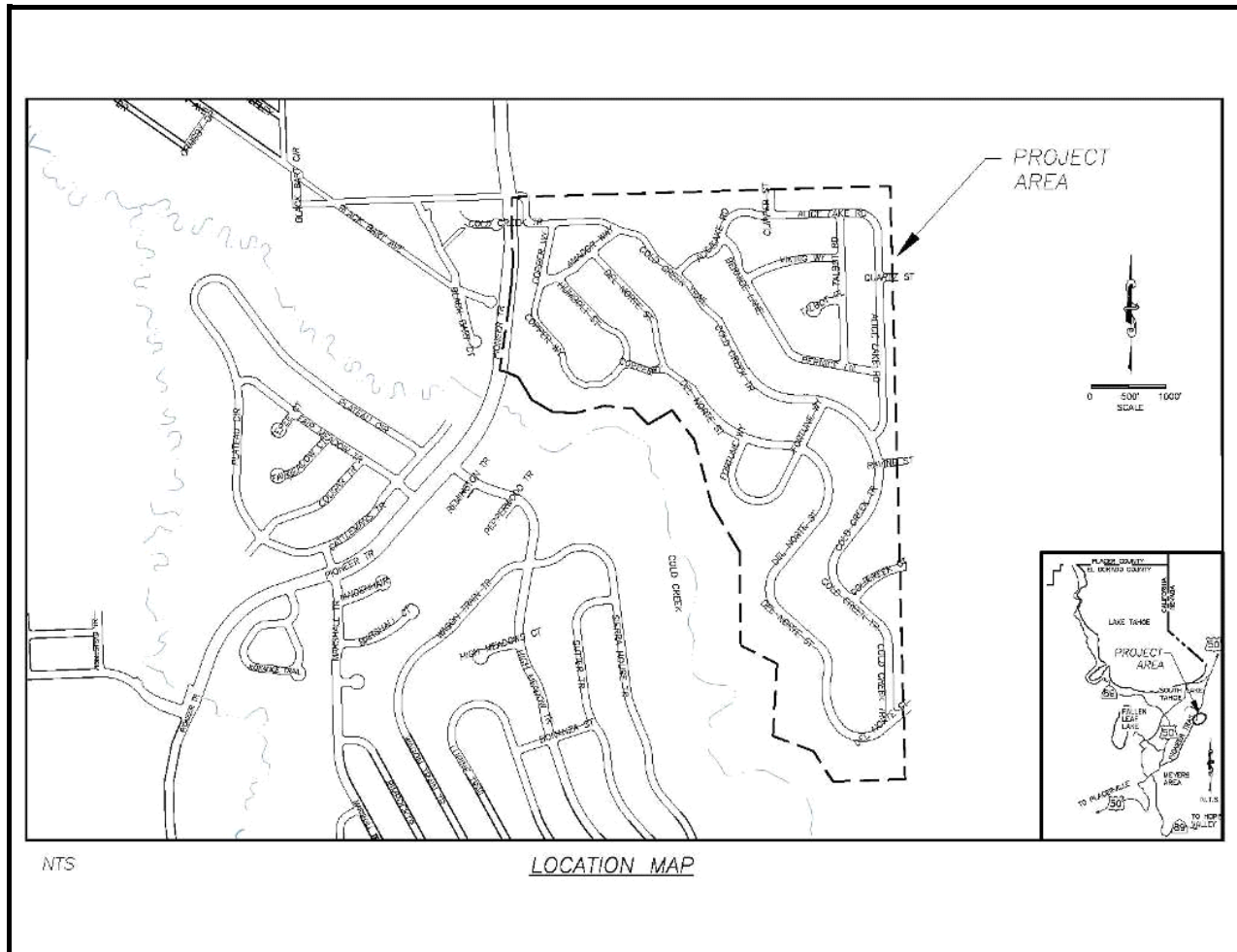

Project Description:

The Montgomery Estates Area 1A Erosion Control Project encompasses the streets of Fortune Way, Del Norte Street, Cold Creek Trail, Copper Way and Alice Lake Road. The main goals of the Project are related to improving the water quality of runoff to Lake Tahoe by reducing erosion and sediment flow originating in the Project area. The Project goals are remove/reduce fine sediment originating from the Project areas prior to reaching Cold Creek to the maximum extent practicable. Remove/reduce coarse sediment originating from the Project areas prior to reaching the Cold Creek to the maximum extent practicable.

Original Budget: \$3,214,876

Expenditures thru 6/30/2013: \$1,883,256

Project Initiation Date: 12/15/01

*Prior FY includes actual revenue and expenditures through 06/30/13, plus amounts budgeted through 06/30/14.

**FY 19/20 - 23/24 and FY 24/25 - 33/34 revenue and expenditures are not included for the Tahoe EIP, as it is a five-year program.



Montgomery Estates Area 1A Erosion Control Project

Financing Plan & Tentative Schedule

Project No: 95155

Type: Erosion Control - (EIP)

Supervisor District(s) 5

All Figures in Thousands

Revenue by Funding Source	Prior FY*	FY 14/15	FY 15/16	FY 16/17	FY 17/18	FY 18/19	FY 19/20-23/24**	FY 24/25-33/34**	Total
California Tahoe Conservancy Planning Grant	\$370	\$0	\$0	\$0	\$0	\$0	\$0	\$0	\$370
Tahoe Regional Planning Agency/Water Quality	\$252	\$0	\$0	\$0	\$0	\$0	\$0	\$0	\$252
United States Forest Service Planning Grant	\$853	\$0	\$0	\$0	\$0	\$0	\$0	\$0	\$853
United States Forest Service Site Improvement Grant	\$416	\$6	\$0	\$0	\$0	\$0	\$0	\$0	\$421
Total	\$1,891	\$6	\$0	\$0	\$0	\$0	\$0	\$0	\$1,896

All Figures in Thousands

Expenditures	Prior FY*	FY 14/15	FY 15/16	FY 16/17	FY 17/18	FY 18/19	FY 19/20-23/24**	FY 24/25-33/34**	Total
Design - Consultant	\$777	\$0	\$0	\$0	\$0	\$0	\$0	\$0	\$777
Design - Staff	\$612	\$0	\$0	\$0	\$0	\$0	\$0	\$0	\$612
Right of Way - Acquisition	\$12	\$0	\$0	\$0	\$0	\$0	\$0	\$0	\$12
Right of Way - Staff	\$23	\$0	\$0	\$0	\$0	\$0	\$0	\$0	\$23
Construction Mgmt - Consultant	\$2	\$0	\$0	\$0	\$0	\$0	\$0	\$0	\$2
Construction Mgmt - Staff	\$104	\$0	\$0	\$0	\$0	\$0	\$0	\$0	\$104
Direct Construction Costs	\$255	\$0	\$0	\$0	\$0	\$0	\$0	\$0	\$255
Env Monitoring - Consultant	\$55	\$1	\$0	\$0	\$0	\$0	\$0	\$0	\$56
Env Monitoring - Staff	\$38	\$3	\$0	\$0	\$0	\$0	\$0	\$0	\$41
Plant Establishment - Staff	\$13	\$2	\$0	\$0	\$0	\$0	\$0	\$0	\$15
Total	\$1,890	\$6	\$0	\$0	\$0	\$0	\$0	\$0	\$1,895

Project Schedule	Prior FY*	FY 14/15	FY 15/16	FY 16/17	FY 17/18	FY 18/19	FY 19/20-23/24**	FY 24/25-33/34**
Planning/Environmental								
Design								
Right Of Way								
Construction								
Environmental Monitoring								

*Prior FY includes actual revenue and expenditures through 06/30/13, plus amounts budgeted through 06/30/14.

**FY 19/20 - 23/24 and FY 24/25 - 33/34 revenue and expenditures are not included for the Tahoe EIP, as it is a five-year program.



Montgomery Estates Area 1B Erosion Control Project

CIP Project Summary

Project No: 95193

Type: Erosion Control - (EIP)

Supervisor District(s) 5

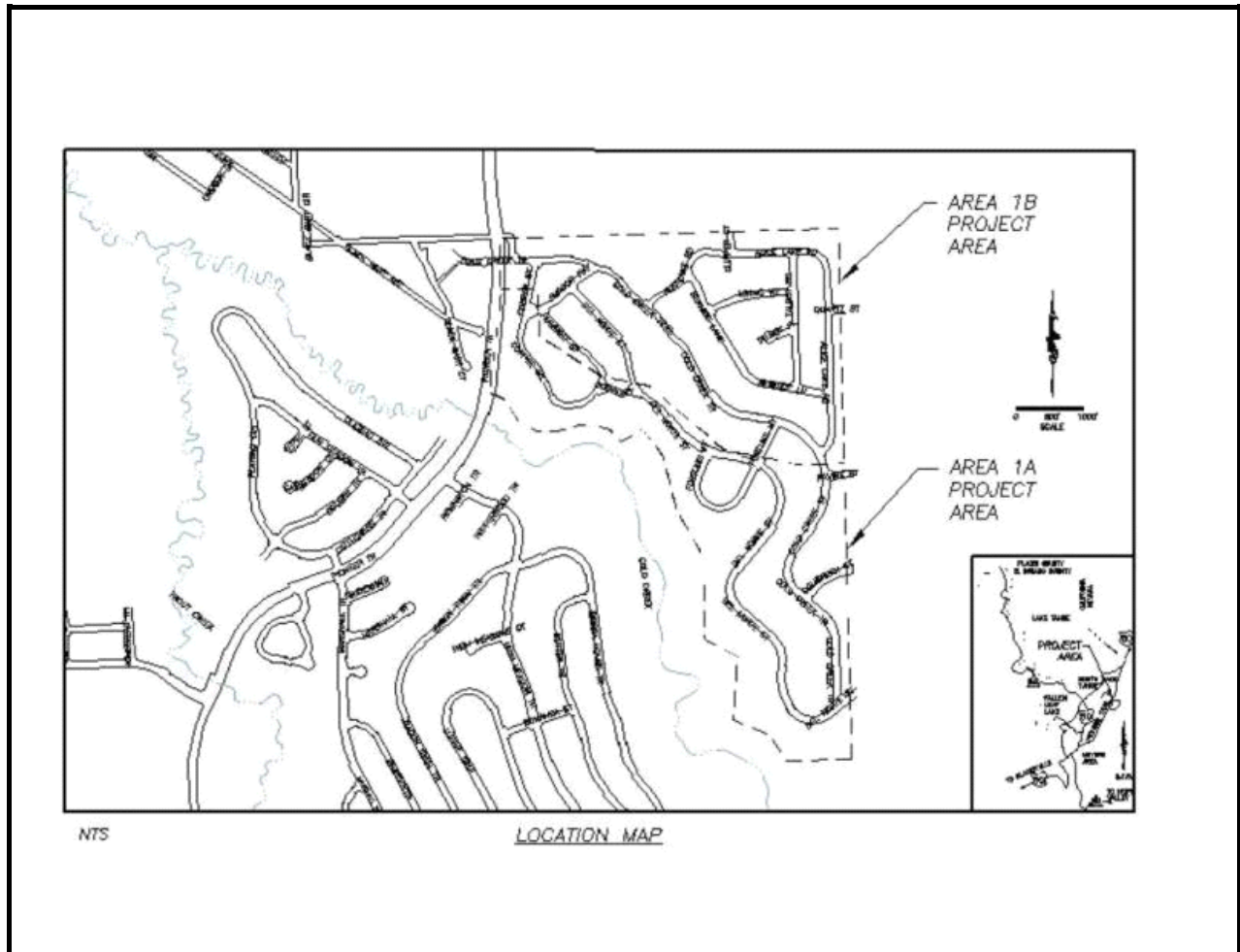

Project Description:

The Montgomery Estates Area 1B Erosion Control Project is the second phase within the Area 1 project area (CIP No. 95155). The Area 1B Project area encompasses the streets of Del Norte Street, Amador Way, Cold Creek Trail, Talbot Court and Alice Lake Road. The main goals of the Project are related to improving the water quality of runoff to Lake Tahoe by reducing erosion and sediment flow originating in the Project area. The Project goals are remove/reduce fine sediment originating from the Project areas prior to reaching Cold Creek to the maximum extent practicable. Remove/reduce coarse sediment originating from the Project areas prior to reaching the Cold Creek to the maximum extent practicable.

Original Budget: \$919,000

Expenditures thru 6/30/2013: \$659,436

Project Initiation Date: 09/01/11

*Prior FY includes actual revenue and expenditures through 06/30/13, plus amounts budgeted through 06/30/14.

**FY 19/20 - 23/24 and FY 24/25 - 33/34 revenue and expenditures are not included for the Tahoe EIP, as it is a five-year program.



Montgomery Estates Area 1B Erosion Control Project

Financing Plan & Tentative Schedule

Project No: 95193

Type: Erosion Control - (EIP)

Supervisor District(s) 5

All Figures in Thousands

Revenue by Funding Source	Prior FY*	FY 14/15	FY 15/16	FY 16/17	FY 17/18	FY 18/19	FY 19/20-23/24**	FY 24/25-33/34**	Total
Tahoe Regional Planning Agency/Water Quality	\$12	\$2	\$0	\$0	\$0	\$0	\$0	\$0	\$14
United States Forest Service Site Improvement Grant	\$658	\$10	\$0	\$0	\$0	\$0	\$0	\$0	\$668
Total	\$670	\$12	\$0	\$0	\$0	\$0	\$0	\$0	\$682

All Figures in Thousands

Expenditures	Prior FY*	FY 14/15	FY 15/16	FY 16/17	FY 17/18	FY 18/19	FY 19/20-23/24**	FY 24/25-33/34**	Total
Design - Consultant	\$1	\$0	\$0	\$0	\$0	\$0	\$0	\$0	\$1
Design - Staff	\$51	\$0	\$0	\$0	\$0	\$0	\$0	\$0	\$51
Right of Way - Acquisition	\$3	\$0	\$0	\$0	\$0	\$0	\$0	\$0	\$3
Right of Way - Consultant	\$7	\$0	\$0	\$0	\$0	\$0	\$0	\$0	\$7
Right of Way - Staff	\$9	\$0	\$0	\$0	\$0	\$0	\$0	\$0	\$9
Construction Mgmt - Consultant	\$2	\$0	\$0	\$0	\$0	\$0	\$0	\$0	\$2
Construction Mgmt - Staff	\$108	\$0	\$0	\$0	\$0	\$0	\$0	\$0	\$108
Direct Construction Costs	\$450	\$0	\$0	\$0	\$0	\$0	\$0	\$0	\$450
Env Monitoring - Consultant	\$2	\$1	\$0	\$0	\$0	\$0	\$0	\$0	\$3
Env Monitoring - Staff	\$11	\$6	\$0	\$0	\$0	\$0	\$0	\$0	\$17
Plant Establishment - Consultant	\$12	\$0	\$0	\$0	\$0	\$0	\$0	\$0	\$12
Plant Establishment - Staff	\$15	\$5	\$0	\$0	\$0	\$0	\$0	\$0	\$20
Total	\$670	\$12	\$0	\$0	\$0	\$0	\$0	\$0	\$682

Project Schedule	Prior FY*	FY 14/15	FY 15/16	FY 16/17	FY 17/18	FY 18/19	FY 19/20-23/24**	FY 24/25-33/34**
Planning/Environmental								
Design								
Right Of Way								
Construction								
Environmental Monitoring								

*Prior FY includes actual revenue and expenditures through 06/30/13, plus amounts budgeted through 06/30/14.

**FY 19/20 - 23/24 and FY 24/25 - 33/34 revenue and expenditures are not included for the Tahoe EIP, as it is a five-year program.



Montgomery Estates Area 2 Erosion Control Project

CIP Project Summary

Project No: 95170

Type: Erosion Control - (EIP)

Supervisor District(s) 5

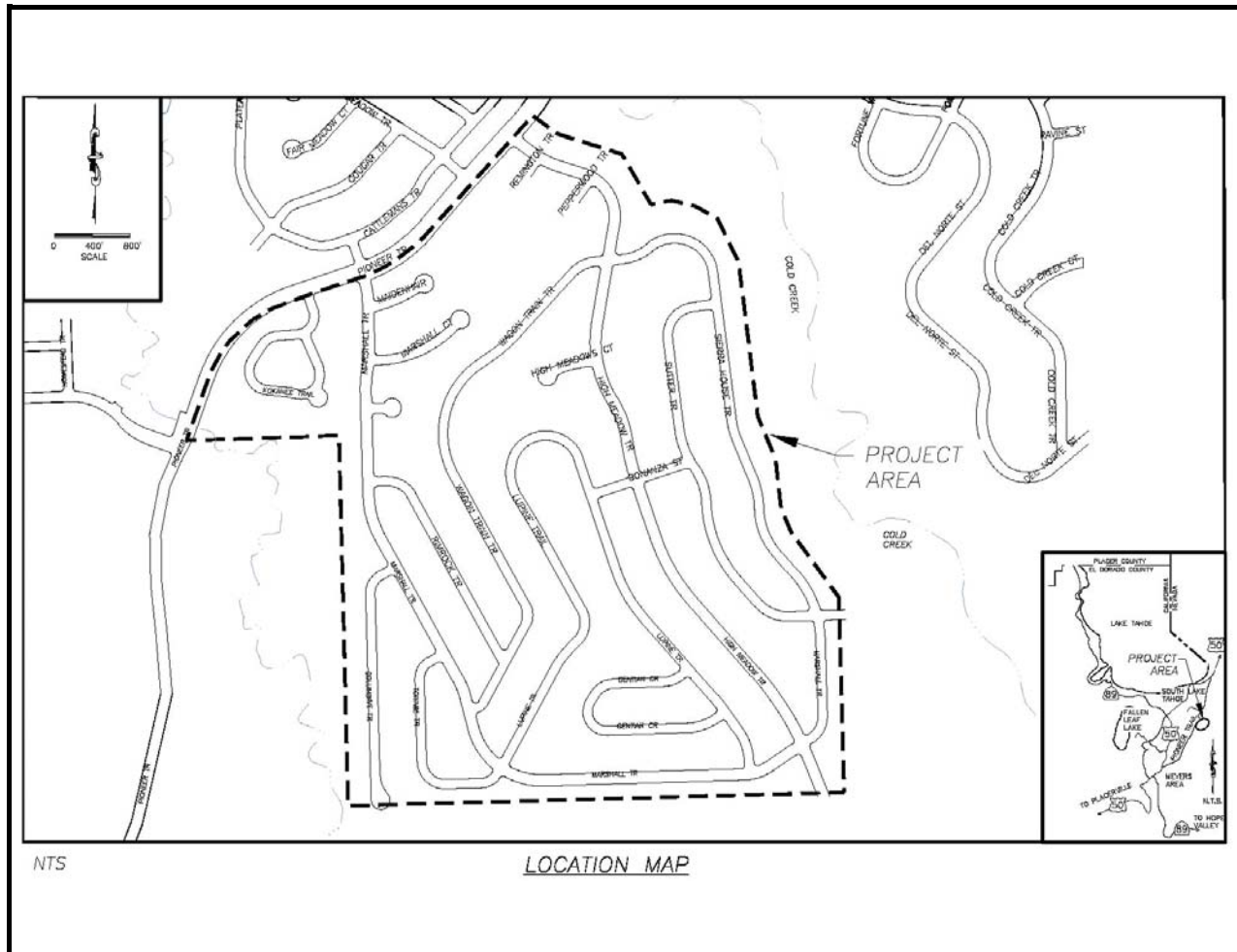

Project Description:

The Montgomery Estates Area 2 Erosion Control is bounded by Pioneer Trail to the south, Trout Creek to the east and Cold Creek to the west. The main goal of the Project is to improve the clarity of Lake Tahoe by reducing the detrimental water quality impacts of the Montgomery Estates subdivision on Lake Tahoe clarity. The objective of the Project is the reduction in the transport of fine sediment from the Project area by constructing water quality Best Management Practices (BMPs) prior to reaching Cold Creek to the maximum extent practicable.

Original Budget: \$1,984,300

Expenditures thru 6/30/2013: \$342,618

Project Initiation Date: 12/15/01

*Prior FY includes actual revenue and expenditures through 06/30/13, plus amounts budgeted through 06/30/14.

**FY 19/20 - 23/24 and FY 24/25 - 33/34 revenue and expenditures are not included for the Tahoe EIP, as it is a five-year program.



Montgomery Estates Area 2 Erosion Control Project

Financing Plan & Tentative Schedule

Project No: 95170

Type: Erosion Control - (EIP)

Supervisor District(s) 5

All Figures in Thousands

Revenue by Funding Source	Prior FY*	FY 14/15	FY 15/16	FY 16/17	FY 17/18	FY 18/19	FY 19/20-23/24**	FY 24/25-33/34**	Total
State Water Resources Control Board	\$141	\$10	\$0	\$0	\$0	\$0	\$0	\$0	\$151
Tahoe Regional Planning Agency/Water Quality	\$28	\$4	\$0	\$0	\$0	\$0	\$0	\$0	\$32
United States Forest Service Planning Grant	\$49	\$0	\$0	\$0	\$0	\$0	\$0	\$0	\$49
United States Forest Service Site Improvement Grant	\$701	\$25	\$15	\$0	\$0	\$0	\$0	\$0	\$741
Total	\$919	\$39	\$15	\$0	\$0	\$0	\$0	\$0	\$973

All Figures in Thousands

Expenditures	Prior FY*	FY 14/15	FY 15/16	FY 16/17	FY 17/18	FY 18/19	FY 19/20-23/24**	FY 24/25-33/34**	Total
Planning/Env - Consultant	\$18	\$0	\$0	\$0	\$0	\$0	\$0	\$0	\$18
Planning/Env - Staff	\$59	\$0	\$0	\$0	\$0	\$0	\$0	\$0	\$59
Design - Staff	\$224	\$0	\$0	\$0	\$0	\$0	\$0	\$0	\$224
Right of Way - Staff	\$5	\$0	\$0	\$0	\$0	\$0	\$0	\$0	\$5
Construction Mgmt - Staff	\$96	\$9	\$0	\$0	\$0	\$0	\$0	\$0	\$105
Direct Construction Costs	\$450	\$0	\$0	\$0	\$0	\$0	\$0	\$0	\$450
Env Monitoring - Consultant	\$6	\$4	\$2	\$0	\$0	\$0	\$0	\$0	\$12
Env Monitoring - Staff	\$36	\$15	\$8	\$0	\$0	\$0	\$0	\$0	\$59
Plant Establishment - Consultant	\$20	\$0	\$0	\$0	\$0	\$0	\$0	\$0	\$20
Plant Establishment - Staff	\$5	\$10	\$5	\$0	\$0	\$0	\$0	\$0	\$20
Total	\$919	\$38	\$15	\$0	\$0	\$0	\$0	\$0	\$972

Project Schedule	Prior FY*	FY 14/15	FY 15/16	FY 16/17	FY 17/18	FY 18/19	FY 19/20-23/24**	FY 24/25-33/34**
Planning/Environmental								
Design								
Right Of Way								
Construction								
Environmental Monitoring								

*Prior FY includes actual revenue and expenditures through 06/30/13, plus amounts budgeted through 06/30/14.

**FY 19/20 - 23/24 and FY 24/25 - 33/34 revenue and expenditures are not included for the Tahoe EIP, as it is a five-year program.



Montgomery Estates Area 3 Erosion Control Project

CIP Project Summary

Project No: 95172

Type: Erosion Control - (EIP)

Supervisor District(s) 5

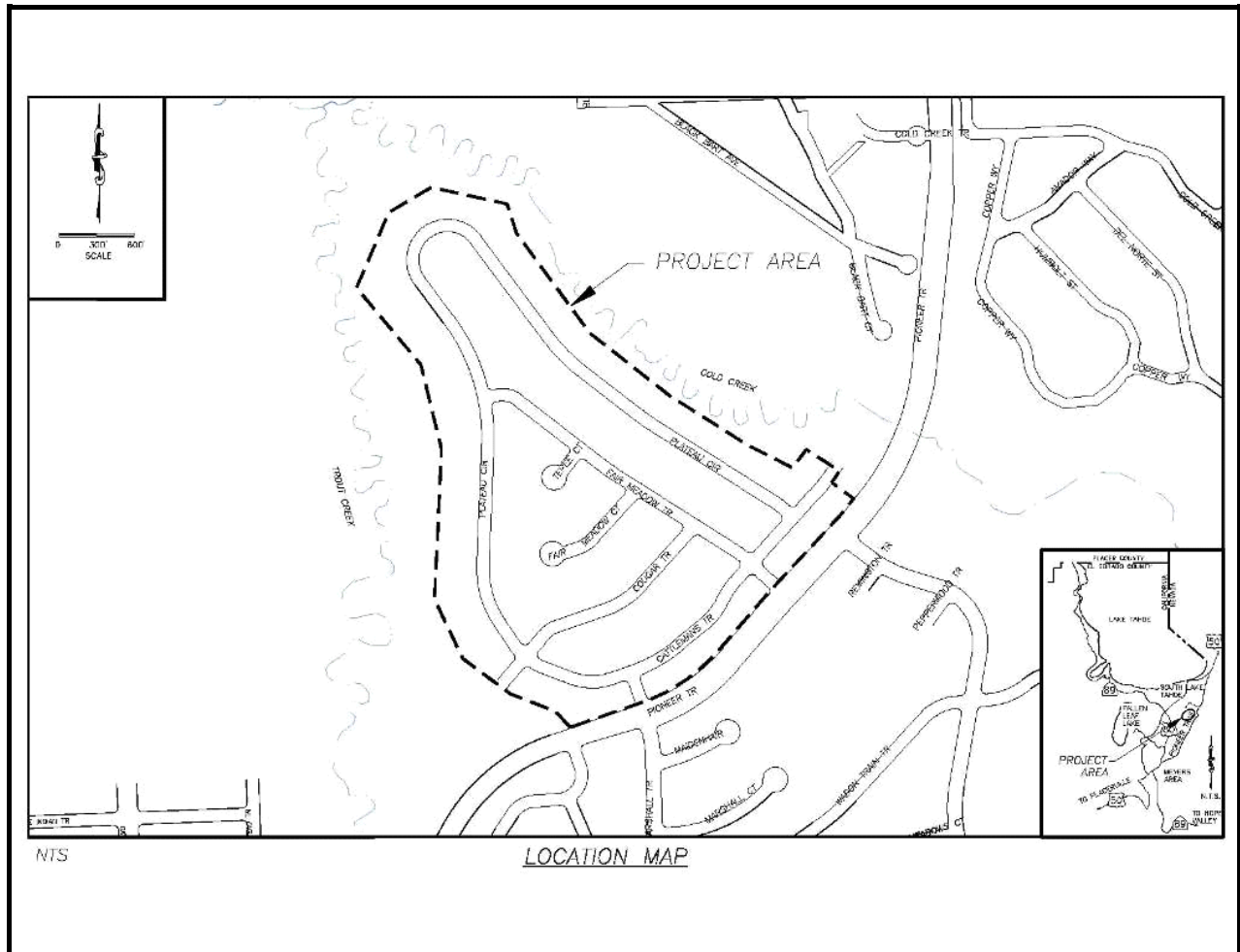

Project Description:

The Montgomery Estates Area 3 Erosion Control is bordered by Trout Creek to the west, Cold Creek to the north and Pioneer Trail to the south. The main goal of the Project is to improve the clarity of Lake Tahoe by reducing the detrimental water quality impacts of the Montgomery Estates subdivision on Lake Tahoe clarity. The objective of the Project is the reduction in the transport of fine sediment from the Project area by constructing water quality Best Management Practices (BMPs) prior to reaching Cold Creek and Trout Creek to the maximum extent practicable.

Original Budget: \$1,032,750

Expenditures thru 6/30/2013: \$82,797

Project Initiation Date: 12/15/01

*Prior FY includes actual revenue and expenditures through 06/30/13, plus amounts budgeted through 06/30/14.

**FY 19/20 - 23/24 and FY 24/25 - 33/34 revenue and expenditures are not included for the Tahoe EIP, as it is a five-year program.



Montgomery Estates Area 3 Erosion Control Project

Financing Plan & Tentative Schedule

Project No: 95172

Type: Erosion Control - (EIP)

Supervisor District(s) 5

All Figures in Thousands

Revenue by Funding Source	Prior FY*	FY 14/15	FY 15/16	FY 16/17	FY 17/18	FY 18/19	FY 19/20-23/24**	FY 24/25-33/34**	Total
Tahoe Regional Planning Agency/Water Quality	\$5	\$0	\$0	\$5	\$5	\$0	\$0	\$0	\$15
United States Forest Service Planning Grant	\$107	\$0	\$0	\$0	\$0	\$0	\$0	\$0	\$107
United States Forest Service Site Improvement Grant	\$37	\$53	\$185	\$0	\$0	\$0	\$0	\$0	\$275
Total	\$148	\$53	\$185	\$5	\$5	\$0	\$0	\$0	\$396

All Figures in Thousands

Expenditures	Prior FY*	FY 14/15	FY 15/16	FY 16/17	FY 17/18	FY 18/19	FY 19/20-23/24**	FY 24/25-33/34**	Total
Developer Advanced Planning	\$17	\$0	\$0	\$0	\$0	\$0	\$0	\$0	\$17
Planning/Env - Staff	\$59	\$0	\$0	\$0	\$0	\$0	\$0	\$0	\$59
Design - Consultant	\$0	\$7	\$0	\$0	\$0	\$0	\$0	\$0	\$7
Design - Staff	\$63	\$42	\$0	\$0	\$0	\$0	\$0	\$0	\$105
Construction Mgmt - Staff	\$1	\$0	\$45	\$0	\$0	\$0	\$0	\$0	\$46
Direct Construction Costs	\$0	\$0	\$130	\$0	\$0	\$0	\$0	\$0	\$130
Env Monitoring - Consultant	\$2	\$3	\$2	\$2	\$2	\$0	\$0	\$0	\$11
Env Monitoring - Staff	\$6	\$1	\$3	\$3	\$3	\$0	\$0	\$0	\$16
Plant Establishment - Staff	\$0	\$0	\$5	\$0	\$0	\$0	\$0	\$0	\$5
Total	\$148	\$53	\$185	\$5	\$5	\$0	\$0	\$0	\$396

Project Schedule	Prior FY*	FY 14/15	FY 15/16	FY 16/17	FY 17/18	FY 18/19	FY 19/20-23/24**	FY 24/25-33/34**
Planning/Environmental	█							
Design	█	█						
Right Of Way	█							
Construction	█		█					
Environmental Monitoring	█	█	█	█	█			

*Prior FY includes actual revenue and expenditures through 06/30/13, plus amounts budgeted through 06/30/14.

**FY 19/20 - 23/24 and FY 24/25 - 33/34 revenue and expenditures are not included for the Tahoe EIP, as it is a five-year program.



Oflyng Erosion Control Project

CIP Project Summary

Project No: 95177

Type: Erosion Control - (EIP)

Supervisor District(s) 5

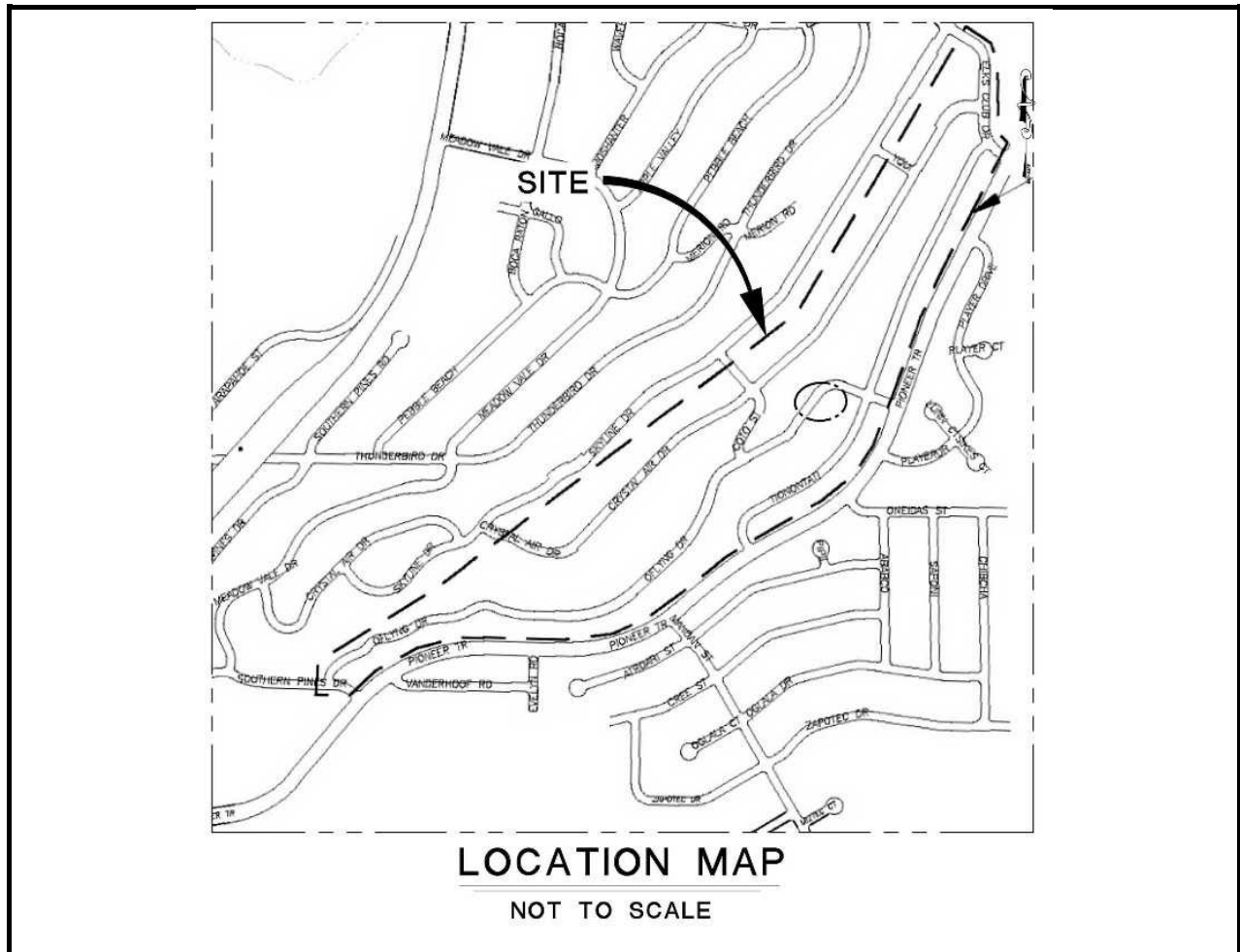

Project Description:

Treat eroding cut and fill slopes in county right-of-way. Retain and treat 20YR-1HR storm. Revegetation of disturbed areas. Replace failing gunite slope protection; perform right-of-way acquisitions.

Original Budget: \$5,065,000

Expenditures thru 6/30/2013: \$0

Project Initiation Date: 03/18/14

*Prior FY includes actual revenue and expenditures through 06/30/13, plus amounts budgeted through 06/30/14.

**FY 19/20 - 23/24 and FY 24/25 - 33/34 revenue and expenditures are not included for the Tahoe EIP, as it is a five-year program.



Oflyng Erosion Control Project

Financing Plan & Tentative Schedule

Project No: 95177

Type: Erosion Control - (EIP)

Supervisor District(s) 5

All Figures in Thousands

Revenue by Funding Source	Prior FY*	FY 14/15	FY 15/16	FY 16/17	FY 17/18	FY 18/19	FY 19/20-23/24**	FY 24/25-33/34**	Total
California Tahoe Conservancy Site Improvement Grant	\$0	\$0	\$0	\$0	\$538	\$0	\$0	\$0	\$538
State Water Resources Control Board	\$0	\$10	\$65	\$150	\$0	\$0	\$0	\$0	\$225
Tahoe Regional Planning Agency/Water Quality	\$0	\$0	\$0	\$0	\$5	\$25	\$0	\$0	\$30
United States Forest Service Site Improvement Grant	\$0	\$0	\$0	\$0	\$0	\$0	\$0	\$0	\$0
Total	\$0	\$10	\$65	\$150	\$543	\$25	\$0	\$0	\$793

All Figures in Thousands

Expenditures	Prior FY*	FY 14/15	FY 15/16	FY 16/17	FY 17/18	FY 18/19	FY 19/20-23/24**	FY 24/25-33/34**	Total
Planning/Env - Consultant	\$0	\$1	\$15	\$0	\$0	\$0	\$0	\$0	\$16
Planning/Env - Staff	\$0	\$10	\$45	\$0	\$0	\$0	\$0	\$0	\$55
Design - Staff	\$0	\$0	\$0	\$130	\$0	\$0	\$0	\$0	\$130
Construction Mgmt - Consultant	\$0	\$0	\$0	\$0	\$0	\$0	\$0	\$0	\$0
Construction Mgmt - Staff	\$0	\$0	\$0	\$15	\$90	\$15	\$0	\$0	\$120
Direct Construction Costs	\$0	\$0	\$0	\$0	\$450	\$0	\$0	\$0	\$450
Env Monitoring - Consultant	\$0	\$0	\$0	\$0	\$0	\$0	\$0	\$0	\$0
Env Monitoring - Staff	\$0	\$0	\$5	\$5	\$0	\$0	\$0	\$0	\$10
Plant Establishment - Staff	\$0	\$0	\$0	\$0	\$3	\$10	\$0	\$0	\$13
Total	\$0	\$10	\$65	\$150	\$543	\$25	\$0	\$0	\$793

Project Schedule	Prior FY*	FY 14/15	FY 15/16	FY 16/17	FY 17/18	FY 18/19	FY 19/20-23/24**	FY 24/25-33/34**
Planning/Environmental								
Design								
Right Of Way								
Construction								
Environmental Monitoring								

*Prior FY includes actual revenue and expenditures through 06/30/13, plus amounts budgeted through 06/30/14.

**FY 19/20 - 23/24 and FY 24/25 - 33/34 revenue and expenditures are not included for the Tahoe EIP, as it is a five-year program.



Rubicon 5 Erosion Control Project

CIP Project Summary

Project No: 95178

Type: Erosion Control - (EIP)

Supervisor District(s) 5

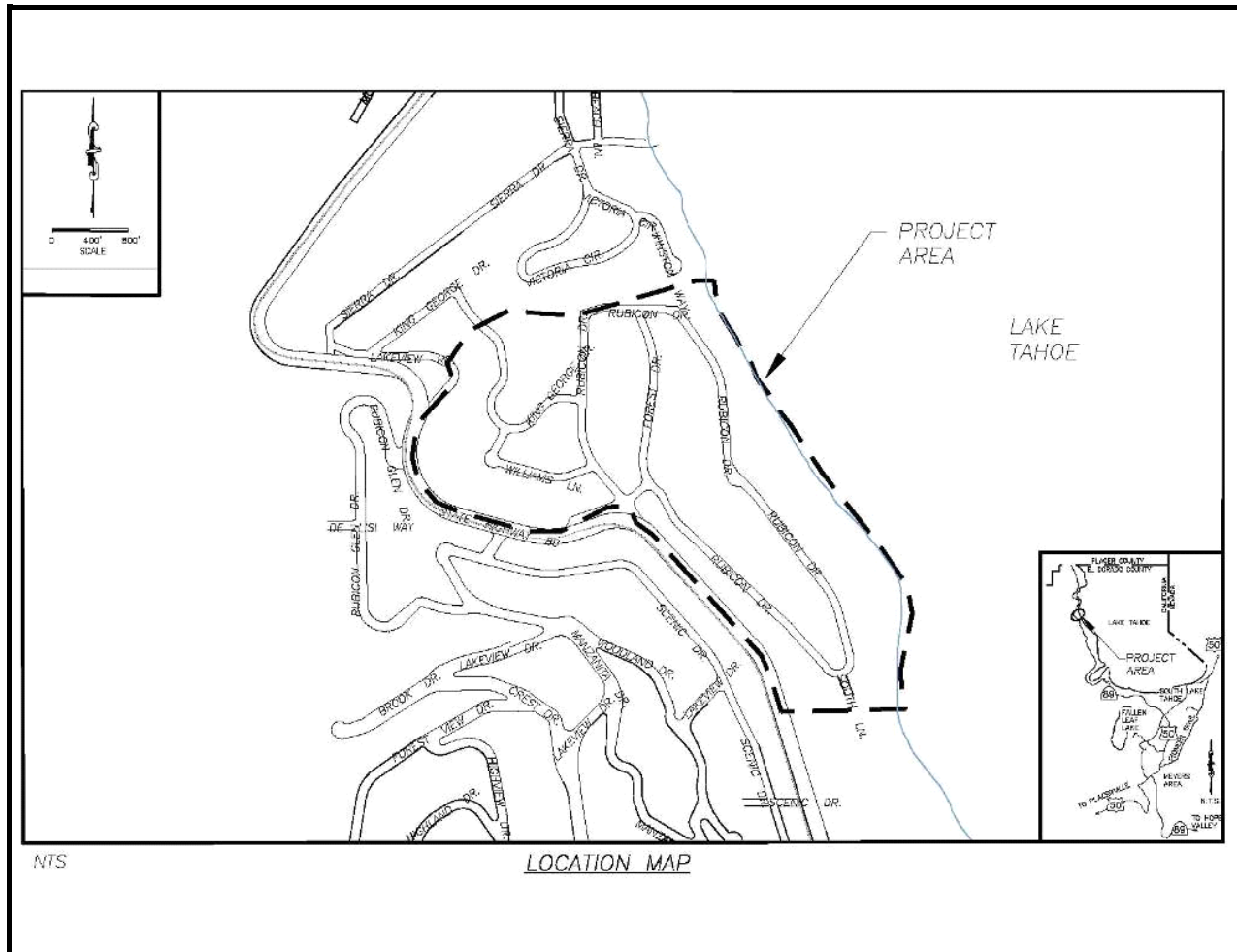

Project Description:

The Rubicon 5 Erosion Control Project (ECP) is one of the last ECP's within this region. To date there have been 7 ECP's built in this area, Victoria Drive ECP, Rubicon (1-4) ECP, Mountain Drive ECP, Woodland ECP, Tamarack ECP, Silvertip ECP, and Lonely Gulch ECP. The first three Projects mentioned were part of the Soil Erosion Control Program which preceded the EIP with Rubicon split into four Projects west of Highway 89. Rubicon 5 ECP should complete the Rubicon Properties erosion control series. The Woodland, Tamarack, and Lonely Gulch ECP's were combined into one EIP Project (#713.1) and Silvertip with EIP # 713.2. The project is listed under No. 713.3 as part of TRPA's EIP list.

The problems to be addressed include the following:

- Direct discharges of runoff into Lake Tahoe.

- Eroding cut slopes, drainages, and roadside ditches.

- Road sand/cinder accumulation on roads and discharge into drainages.

Original Budget: \$3,062,762

Expenditures thru 6/30/2013: \$1,203,651

Project Initiation Date: 02/11/08

*Prior FY includes actual revenue and expenditures through 06/30/13, plus amounts budgeted through 06/30/14.

**FY 19/20 - 23/24 and FY 24/25 - 33/34 revenue and expenditures are not included for the Tahoe EIP, as it is a five-year program.



Rubicon 5 Erosion Control Project

CIP Project Summary

Project No: 95178

Type: Erosion Control - (EIP)

Supervisor District(s) 5

All Figures in Thousands

Revenue by Funding Source	Prior FY*	FY 14/15	FY 15/16	FY 16/17	FY 17/18	FY 18/19	FY 19/20-23/24**	FY 24/25-33/34**	Total
California Tahoe Conservancy Planning Grant	\$281	\$0	\$0	\$0	\$0	\$0	\$0	\$0	\$281
Erosion Control Discretionary	\$3	\$0	\$0	\$0	\$0	\$0	\$0	\$0	\$3
Tahoe Regional Planning Agency/Water Quality	\$33	\$0	\$0	\$0	\$0	\$0	\$0	\$0	\$33
United States Forest Service Planning Grant	\$205	\$0	\$0	\$0	\$0	\$0	\$0	\$0	\$205
United States Forest Service Site Improvement Grant	\$691	\$13	\$0	\$0	\$0	\$0	\$0	\$0	\$704
Total	\$1,214	\$13	\$0	\$0	\$0	\$0	\$0	\$0	\$1,226

All Figures in Thousands

Expenditures	Prior FY*	FY 14/15	FY 15/16	FY 16/17	FY 17/18	FY 18/19	FY 19/20-23/24**	FY 24/25-33/34**	Total
Design - Consultant	\$82	\$0	\$0	\$0	\$0	\$0	\$0	\$0	\$82
Design - Staff	\$493	\$0	\$0	\$0	\$0	\$0	\$0	\$0	\$493
Construction Mgmt - Consultant	\$2	\$0	\$0	\$0	\$0	\$0	\$0	\$0	\$2
Construction Mgmt - Staff	\$115	\$0	\$0	\$0	\$0	\$0	\$0	\$0	\$115
Direct Construction Costs	\$401	\$0	\$0	\$0	\$0	\$0	\$0	\$0	\$401
Env Monitoring - Consultant	\$4	\$3	\$0	\$0	\$0	\$0	\$0	\$0	\$6
Env Monitoring - Staff	\$100	\$10	\$0	\$0	\$0	\$0	\$0	\$0	\$110
Plant Establishment - Consultant	\$5	\$0	\$0	\$0	\$0	\$0	\$0	\$0	\$5
Plant Establishment - Staff	\$11	\$0	\$0	\$0	\$0	\$0	\$0	\$0	\$11
Total	\$1,213	\$13	\$0	\$0	\$0	\$0	\$0	\$0	\$1,226

Project Schedule	Prior FY*	FY 14/15	FY 15/16	FY 16/17	FY 17/18	FY 18/19	FY 19/20-23/24**	FY 24/25-33/34**
Planning/Environmental								
Design								
Right Of Way								
Construction								
Environmental Monitoring								

*Prior FY includes actual revenue and expenditures through 06/30/13, plus amounts budgeted through 06/30/14.

**FY 19/20 - 23/24 and FY 24/25 - 33/34 revenue and expenditures are not included for the Tahoe EIP, as it is a five-year program.



Sawmill 2A Bike Path & Erosion Control Project

Financing Plan & Tentative Schedule

Project No: 95165

Type: Erosion Control - (EIP)

Supervisor District(s) 5

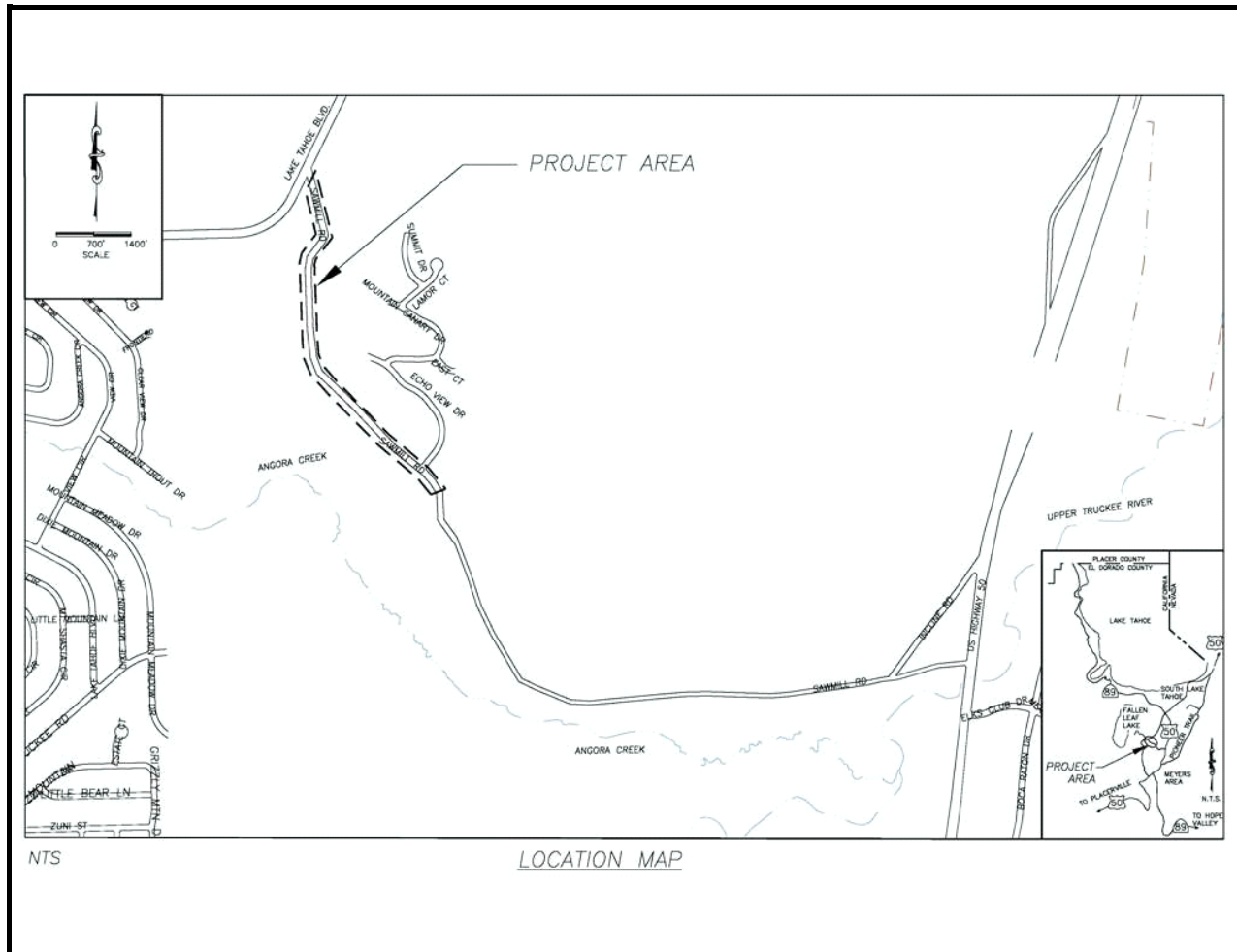

Project Description:

The Sawmill 2 Bike Path and Erosion Control Project (CIP No. 95165) was initiated as one Project. The Project area covered Sawmill Road from US Hwy 50 to Lake Tahoe Boulevard. Due to funding constraints and seasonal construction constraints, the Project was split into two Phases (2A and 2B). The Sawmill 2A Bike Path and Erosion Control Project area covers from Lake Tahoe Blvd to just east of Echo View Drive. The Project includes, but is not limited to, construction of a multi-use path facility, installing erosion control best management practices (BMPs) and revegetation.

Original Budget: \$3,904,998

Expenditures thru 6/30/2013: \$2,626,849

Project Initiation Date: 12/15/05

*Prior FY includes actual revenue and expenditures through 06/30/13, plus amounts budgeted through 06/30/14.

**FY 19/20 - 23/24 and FY 24/25 - 33/34 revenue and expenditures are not included for the Tahoe EIP, as it is a five-year program.



Sawmill 2A Bike Path & Erosion Control Project

CIP Project Summary

Project No: 95165

Type: Erosion Control - (EIP)

Supervisor District(s) 5

All Figures in Thousands

Revenue by Funding Source	Prior FY*	FY 14/15	FY 15/16	FY 16/17	FY 17/18	FY 18/19	FY 19/20-23/24**	FY 24/25-33/34**	Total
California Tahoe Conservancy Planning Grant	\$681	\$0	\$0	\$0	\$0	\$0	\$0	\$0	\$681
California Tahoe Conservancy Site Improvement Grant	\$0	\$15	\$0	\$0	\$0	\$0	\$0	\$0	\$15
Congestion Mitigation and Air Quality Program	\$1,024	\$0	\$0	\$0	\$0	\$0	\$0	\$0	\$1,024
RSTP Exchange Funds-TRPA	\$100	\$0	\$0	\$0	\$0	\$0	\$0	\$0	\$100
Tahoe Regional Planning Agency/Air Quality	\$142	\$0	\$0	\$0	\$0	\$0	\$0	\$0	\$142
Tahoe Regional Planning Agency/Water Quality	\$4	\$0	\$0	\$0	\$0	\$0	\$0	\$0	\$4
United States Forest Service Site Improvement Grant	\$698	\$0	\$0	\$0	\$0	\$0	\$0	\$0	\$698
Total	\$2,649	\$15	\$0	\$0	\$0	\$0	\$0	\$0	\$2,664

All Figures in Thousands

Expenditures	Prior FY*	FY 14/15	FY 15/16	FY 16/17	FY 17/18	FY 18/19	FY 19/20-23/24**	FY 24/25-33/34**	Total
Planning/Env - Consultant	\$309	\$0	\$0	\$0	\$0	\$0	\$0	\$0	\$309
Planning/Env - Staff	\$178	\$0	\$0	\$0	\$0	\$0	\$0	\$0	\$178
Design - Consultant	\$33	\$0	\$0	\$0	\$0	\$0	\$0	\$0	\$33
Design - Staff	\$477	\$0	\$0	\$0	\$0	\$0	\$0	\$0	\$477
Right of Way - Acquisition	\$2	\$0	\$0	\$0	\$0	\$0	\$0	\$0	\$2
Right of Way - Consultant	\$33	\$0	\$0	\$0	\$0	\$0	\$0	\$0	\$33
Right of Way - Staff	\$176	\$0	\$0	\$0	\$0	\$0	\$0	\$0	\$176
Construction Mgmt - Staff	\$219	\$0	\$0	\$0	\$0	\$0	\$0	\$0	\$219
Direct Construction Costs	\$1,141	\$0	\$0	\$0	\$0	\$0	\$0	\$0	\$1,141
Env Monitoring - Consultant	\$20	\$1	\$0	\$0	\$0	\$0	\$0	\$0	\$20
Env Monitoring - Staff	\$12	\$5	\$0	\$0	\$0	\$0	\$0	\$0	\$17
Plant Establishment - Consultant	\$26	\$0	\$0	\$0	\$0	\$0	\$0	\$0	\$26
Plant Establishment - Staff	\$25	\$10	\$0	\$0	\$0	\$0	\$0	\$0	\$35
Total	\$2,649	\$15	\$0	\$0	\$0	\$0	\$0	\$0	\$2,664

Project Schedule	Prior FY*	FY 14/15	FY 15/16	FY 16/17	FY 17/18	FY 18/19	FY 19/20-23/24**	FY 24/25-33/34**
Planning/Environmental								
Design								
Right Of Way								
Construction								
Environmental Monitoring								

*Prior FY includes actual revenue and expenditures through 06/30/13, plus amounts budgeted through 06/30/14.

**FY 19/20 - 23/24 and FY 24/25 - 33/34 revenue and expenditures are not included for the Tahoe EIP, as it is a five-year program.



Sawmill 2B Bike Path and Erosion Control Project

Financing Plan & Tentative Schedule

Project No: 95192

Type: Erosion Control - (EIP)

Supervisor District(s) 5

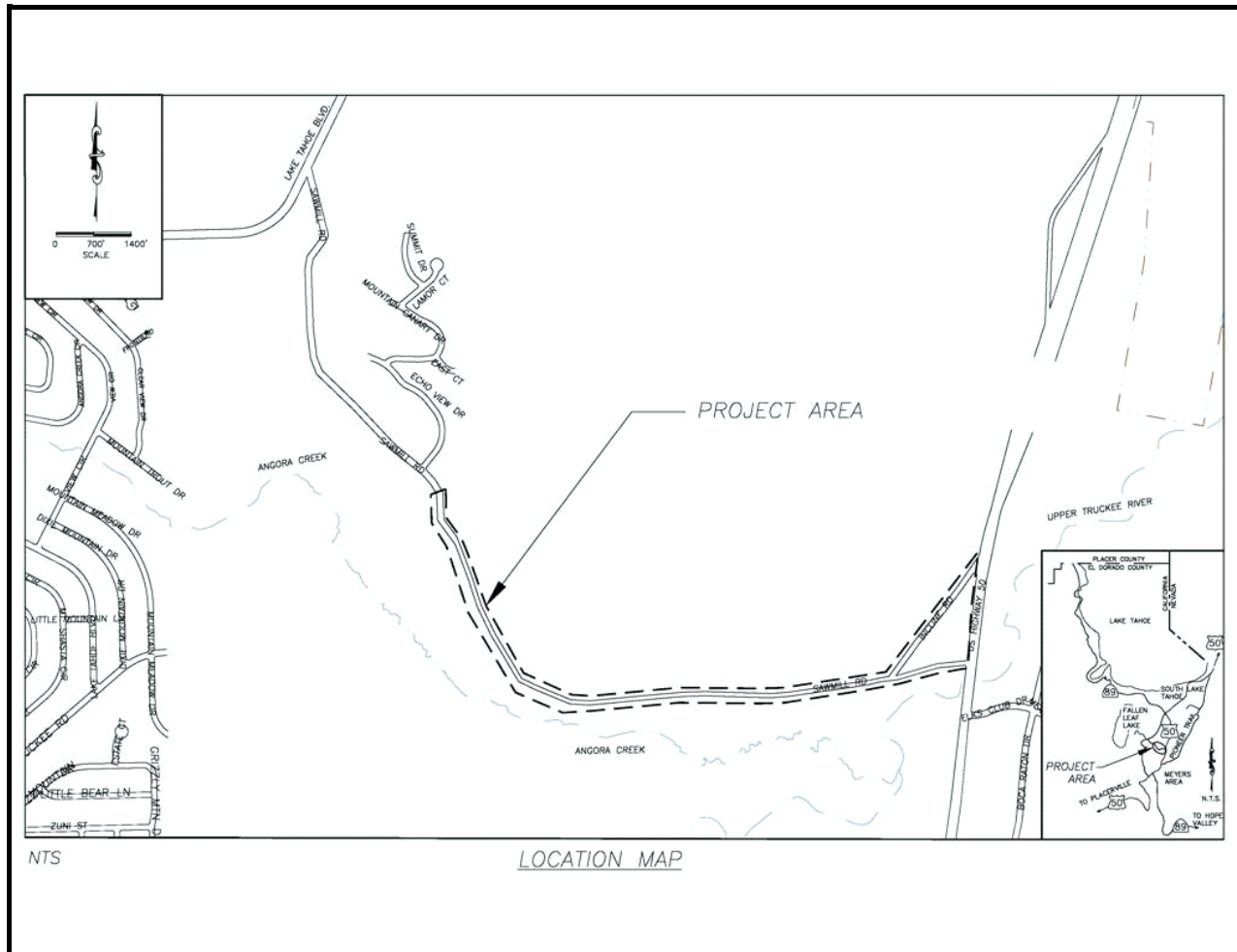

Project Description:

The Sawmill 2 Bike Path and Erosion Control Project (CIP No. 95165) was initiated as one Project. The Project area covered Sawmill Road from US Hwy 50 to Lake Tahoe Boulevard. Due to funding constraints and seasonal construction constraints, the Project was split into two Phases (2A and 2B). The Sawmill 2B Bike Path and Erosion Control Project area covers from US Hwy 50 to the end of Phase 2A near Echo View Drive. The Project includes, but is not limited to, connecting the multi-use path to the existing multi-use path facility at US Hwy 50, installing erosion control best management practices (BMPs) and revegetation.

Original Budget: \$2,006,934

Expenditures thru 6/30/2013: \$435,876

Project Initiation Date: 04/18/11

*Prior FY includes actual revenue and expenditures through 06/30/13, plus amounts budgeted through 06/30/14.

**FY 19/20 - 23/24 and FY 24/25 - 33/34 revenue and expenditures are not included for the Tahoe EIP, as it is a five-year program.



Sawmill 2B Bike Path and Erosion Control Project

CIP Project Summary

Project No: 95192

Type: Erosion Control - (EIP)

Supervisor District(s) 5

All Figures in Thousands

Revenue by Funding Source	Prior FY*	FY 14/15	FY 15/16	FY 16/17	FY 17/18	FY 18/19	FY 19/20-23/24**	FY 24/25-33/34**	Total
California Tahoe Conservancy Right of Way Grant	\$85	\$0	\$0	\$0	\$0	\$0	\$0	\$0	\$85
California Tahoe Conservancy Site Improvement Grant	\$382	\$350	\$0	\$0	\$0	\$0	\$0	\$0	\$732
Congestion Mitigation and Air Quality Program	\$158	\$499	\$0	\$0	\$0	\$0	\$0	\$0	\$657
RSTP Exchange Funds-TRPA	\$0	\$400	\$10	\$5	\$0	\$0	\$0	\$0	\$415
Tahoe Regional Planning Agency/Air Quality	\$237	\$62	\$15	\$15	\$0	\$0	\$0	\$0	\$329
United States Forest Service Site Improvement Grant	\$62	\$232	\$0	\$0	\$0	\$0	\$0	\$0	\$294
Total	\$924	\$1,543	\$25	\$20	\$0	\$0	\$0	\$0	\$2,512

All Figures in Thousands

Expenditures	Prior FY*	FY 14/15	FY 15/16	FY 16/17	FY 17/18	FY 18/19	FY 19/20-23/24**	FY 24/25-33/34**	Total
Design - Consultant	\$17	\$0	\$0	\$0	\$0	\$0	\$0	\$0	\$17
Design - Staff	\$259	\$0	\$0	\$0	\$0	\$0	\$0	\$0	\$259
Right of Way - Acquisition	\$390	\$0	\$0	\$0	\$0	\$0	\$0	\$0	\$390
Right of Way - Consultant	\$30	\$0	\$0	\$0	\$0	\$0	\$0	\$0	\$30
Right of Way - Staff	\$28	\$0	\$0	\$0	\$0	\$0	\$0	\$0	\$28
Construction Mgmt - Consultant	\$0	\$16	\$0	\$0	\$0	\$0	\$0	\$0	\$16
Construction Mgmt - Staff	\$0	\$297	\$10	\$5	\$0	\$0	\$0	\$0	\$312
Direct Construction Costs	\$200	\$1,200	\$0	\$0	\$0	\$0	\$0	\$0	\$1,400
Env Monitoring - Staff	\$0	\$0	\$5	\$5	\$0	\$0	\$0	\$0	\$10
Plant Establishment - Consultant	\$0	\$25	\$0	\$0	\$0	\$0	\$0	\$0	\$25
Plant Establishment - Staff	\$0	\$5	\$10	\$10	\$0	\$0	\$0	\$0	\$25
Total	\$924	\$1,543	\$25	\$20	\$0	\$0	\$0	\$0	\$2,512

Project Schedule	Prior FY*	FY 14/15	FY 15/16	FY 16/17	FY 17/18	FY 18/19	FY 19/20-23/24**	FY 24/25-33/34**
Planning/Environmental								
Design								
Right Of Way								
Construction								
Environmental Monitoring								

*Prior FY includes actual revenue and expenditures through 06/30/13, plus amounts budgeted through 06/30/14.

**FY 19/20 - 23/24 and FY 24/25 - 33/34 revenue and expenditures are not included for the Tahoe EIP, as it is a five-year program.



South Upper Truckee I Erosion Control Project

Financing Plan & Tentative Schedule

Project No: 95168

Type: Erosion Control - (EIP)

Supervisor District(s) 5

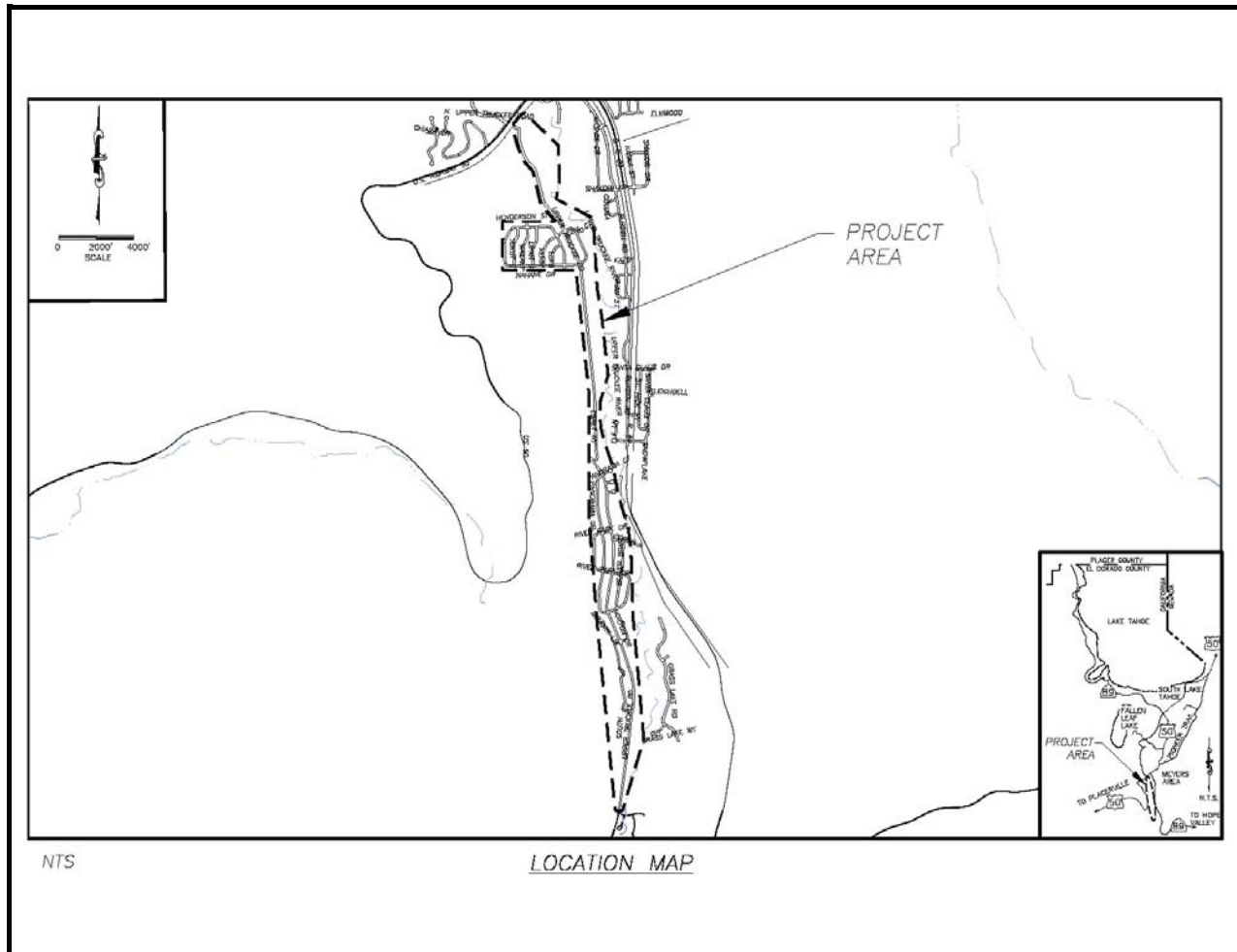

Project Description:

Treat eroding cut and fill slopes in County right-of-way. Reduce the very fine and fine sediment from the urban watersheds. Revegetation of disturbed areas. Install curb and gutter, rock-lined channels, sediment basins. Restore SEZ. Perform right-of-way acquisitions. This Project will most likely be split into several phases. It is anticipated that other grant funding will be available in the future through EIP grant funding programs available to the County.

Original Budget: \$786,000

Expenditures thru 6/30/2013: \$135,921

Project Initiation Date: 12/06/10

*Prior FY includes actual revenue and expenditures through 06/30/13, plus amounts budgeted through 06/30/14.

**FY 19/20 - 23/24 and FY 24/25 - 33/34 revenue and expenditures are not included for the Tahoe EIP, as it is a five-year program.



South Upper Truckee I Erosion Control Project

CIP Project Summary

Project No: 95168

Type: Erosion Control - (EIP)

Supervisor District(s) 5

All Figures in Thousands

Revenue by Funding Source	Prior FY*	FY 14/15	FY 15/16	FY 16/17	FY 17/18	FY 18/19	FY 19/20-23/24**	FY 24/25-33/34**	Total
Tahoe Regional Planning Agency/Stream Environmental Zone	\$65	\$0	\$0	\$0	\$0	\$6	\$0	\$0	\$71
Tahoe Regional Planning Agency/Water Quality	\$31	\$0	\$0	\$0	\$0	\$0	\$0	\$0	\$31
United States Forest Service Planning Grant	\$0	\$0	\$0	\$55	\$115	\$0	\$0	\$0	\$170
United States Forest Service Site Improvement Grant	\$40	\$0	\$0	\$0	\$0	\$275	\$0	\$0	\$315
Total	\$136	\$0	\$0	\$55	\$115	\$281	\$0	\$0	\$587

All Figures in Thousands

Expenditures	Prior FY*	FY 14/15	FY 15/16	FY 16/17	FY 17/18	FY 18/19	FY 19/20-23/24**	FY 24/25-33/34**	Total
Planning/Env - Staff	\$0	\$0	\$0	\$50	\$0	\$0	\$0	\$0	\$50
Design - Staff	\$86	\$0	\$0	\$0	\$100	\$0	\$0	\$0	\$186
Right of Way - Staff	\$2	\$0	\$0	\$0	\$10	\$0	\$0	\$0	\$12
Construction Mgmt - Staff	\$13	\$0	\$0	\$0	\$0	\$75	\$0	\$0	\$88
Direct Construction Costs	\$24	\$0	\$0	\$0	\$0	\$200	\$0	\$0	\$224
Env Monitoring - Staff	\$5	\$0	\$0	\$5	\$5	\$5	\$0	\$0	\$20
Plant Establishment - Consultant	\$0	\$0	\$0	\$0	\$0	\$0	\$0	\$0	\$0
Plant Establishment - Staff	\$7	\$0	\$0	\$0	\$0	\$0	\$0	\$0	\$7
Total	\$136	\$0	\$0	\$55	\$115	\$280	\$0	\$0	\$586

Project Schedule	Prior FY*	FY 14/15	FY 15/16	FY 16/17	FY 17/18	FY 18/19	FY 19/20-23/24**	FY 24/25-33/34**
Planning/Environmental								
Design								
Right Of Way								
Construction								
Environmental Monitoring								

*Prior FY includes actual revenue and expenditures through 06/30/13, plus amounts budgeted through 06/30/14.

**FY 19/20 - 23/24 and FY 24/25 - 33/34 revenue and expenditures are not included for the Tahoe EIP, as it is a five-year program.



Tahoe Hills Erosion Control Project

Financing Plan & Tentative Schedule

Project No: 95171

Type: Erosion Control - (EIP)

Supervisor District(s) 5

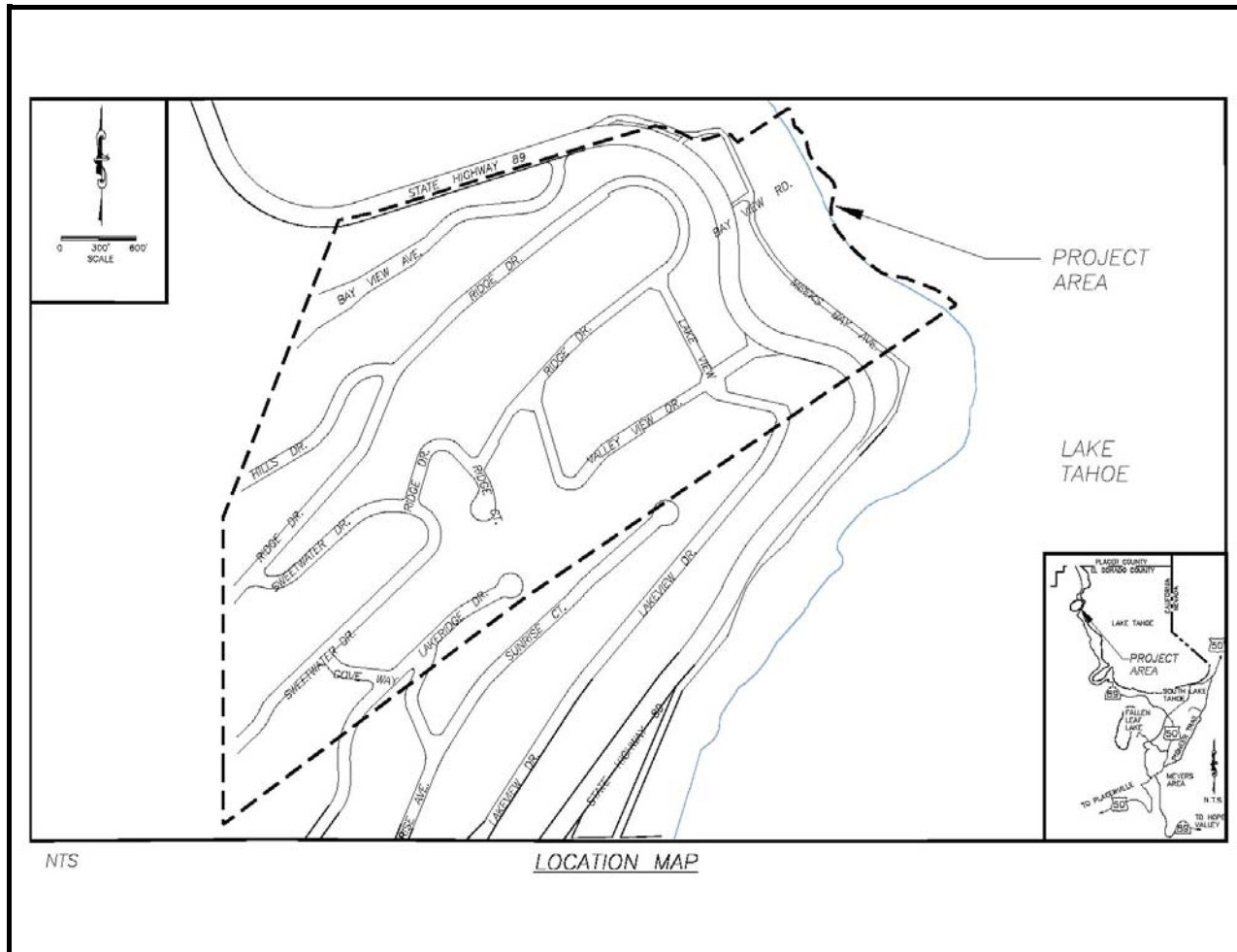

Project Description:

The Tahoe Hills Erosion Control Project is within the Tahoe Hills subdivision which is bordered by Highway 89 to the north and south, and by Lake Tahoe to the east. The Project area encompasses County ROW, Caltrans ROW, California Tahoe Conservancy, United States Forest Service, and privately owned property. The main goal of the Project is to reduce the very fine and fine sediment from the Tahoe Hills subdivision which will ultimately improve the clarity of Lake Tahoe.

Original Budget: \$1,368,000

Expenditures thru 6/30/2013: \$183,679

Project Initiation Date: 11/15/09

*Prior FY includes actual revenue and expenditures through 06/30/13, plus amounts budgeted through 06/30/14.

**FY 19/20 - 23/24 and FY 24/25 - 33/34 revenue and expenditures are not included for the Tahoe EIP, as it is a five-year program.



Tahoe Hills Erosion Control Project

CIP Project Summary

Project No: 95171

Type: Erosion Control - (EIP)

Supervisor District(s) 5

All Figures in Thousands

Revenue by Funding Source	Prior FY*	FY 14/15	FY 15/16	FY 16/17	FY 17/18	FY 18/19	FY 19/20-23/24**	FY 24/25-33/34**	Total
Tahoe Regional Planning Agency/Water Quality	\$35	\$20	\$2	\$0	\$0	\$0	\$0	\$0	\$57
United States Forest Service Planning Grant	\$203	\$57	\$0	\$0	\$0	\$0	\$0	\$0	\$260
United States Forest Service Site Improvement Grant	\$65	\$0	\$430	\$17	\$12	\$0	\$0	\$0	\$524
Total	\$303	\$77	\$432	\$17	\$12	\$0	\$0	\$0	\$841

All Figures in Thousands

Expenditures	Prior FY*	FY 14/15	FY 15/16	FY 16/17	FY 17/18	FY 18/19	FY 19/20-23/24**	FY 24/25-33/34**	Total
Planning/Env - Consultant	\$0	\$7	\$0	\$0	\$0	\$0	\$0	\$0	\$7
Planning/Env - Staff	\$11	\$9	\$0	\$0	\$0	\$0	\$0	\$0	\$20
Design - Consultant	\$18	\$0	\$0	\$0	\$0	\$0	\$0	\$0	\$18
Design - Staff	\$232	\$40	\$0	\$0	\$0	\$0	\$0	\$0	\$272
Right of Way - Staff	\$6	\$0	\$0	\$0	\$0	\$0	\$0	\$0	\$6
Construction Mgmt - Consultant	\$0	\$3	\$0	\$0	\$0	\$0	\$0	\$0	\$3
Construction Mgmt - Staff	\$3	\$7	\$65	\$0	\$0	\$0	\$0	\$0	\$75
Direct Construction Costs	\$0	\$0	\$345	\$0	\$0	\$0	\$0	\$0	\$345
Env Monitoring - Consultant	\$6	\$4	\$2	\$2	\$2	\$0	\$0	\$0	\$16
Env Monitoring - Staff	\$27	\$9	\$10	\$5	\$5	\$0	\$0	\$0	\$55
Plant Establishment - Staff	\$0	\$0	\$10	\$10	\$5	\$0	\$0	\$0	\$25
Total	\$302	\$77	\$432	\$17	\$12	\$0	\$0	\$0	\$840

Project Schedule	Prior FY*	FY 14/15	FY 15/16	FY 16/17	FY 17/18	FY 18/19	FY 19/20-23/24**	FY 24/25-33/34**
Planning/Environmental								
Design								
Right Of Way								
Construction								
Environmental Monitoring								

*Prior FY includes actual revenue and expenditures through 06/30/13, plus amounts budgeted through 06/30/14.

**FY 19/20 - 23/24 and FY 24/25 - 33/34 revenue and expenditures are not included for the Tahoe EIP, as it is a five-year program.



Cost Estimate by Phase Summary

Tahoe

All Figures In Thousands

	Prior*	14/15	15/16	16/17	17/18	18/19	19/20- 23/24	24/25- 33/34	Total
Constr/Eng/Admin - Staff	0	60	0	0	0	0	0	0	60
Construction Mgmt - Consultant	6	70	5	25	20	32	0	0	157
Construction Mgmt - Staff	1,024	680	386	730	552	730	0	0	4,102
Design - Consultant	1,136	35	40	35	0	0	0	0	1,246
Design - Staff	4,073	375	470	410	100	0	0	0	5,428
Design Engineering & Admin	0	0	0	0	0	0	0	0	0
Developer Advanced Design	172	0	0	0	0	0	0	0	172
Developer Advanced Planning	17	0	0	0	0	0	0	0	17
Direct Construction Costs	4,507	2,595	1,600	3,400	2,650	4,420	0	0	19,172
Env Monitoring - Consultant	119	23	14	18	17	11	0	0	201
Env Monitoring - Staff	304	107	88	72	49	48	0	0	667
Environmental Monitoring	0	0	0	0	0	0	0	0	0
Planning/Env - Consultant	725	64	115	0	0	0	0	0	904
Planning/Env - Staff	901	153	271	55	0	0	0	0	1,380
Planning/Environmental	0	0	0	0	0	0	0	0	0
Plant Establishment - Consultant	91	60	33	23	29	18	0	0	252
Plant Establishment - Staff	106	87	108	88	78	58	0	0	523
Right of Way - Acquisition	421	0	2	160	0	0	0	0	583
Right of Way - Consultant	102	0	17	5	0	0	0	0	124
Right of Way - Staff	377	0	64	40	10	0	0	0	490
Survey - Consultant	0	0	0	0	0	0	0	0	0
Survey - Staff	0	0	0	0	0	0	0	0	0
Totals	14,082	4,309	3,210	5,060	3,503	5,315	0	0	35,479

*Prior FY includes actual revenue and expenditures through 06/30/13, plus amounts budgeted through 06/30/14.

**FY 19/20 - 23/24 and FY 24/25 - 33/34 revenue and expenditures are not included for the Tahoe EIP, as it is a five-year program.



Revenue Source Summary

Tahoe

All Figures In Thousands

	<i>Prior*</i>	<i>14/15</i>	<i>15/16</i>	<i>16/17</i>	<i>17/18</i>	<i>18/19</i>	<i>19/20-23/24</i>	<i>24/25-33/34</i>	<i>Total</i>
Anticipated Grant	0	0	0	0	0	0	0	0	0
Bicycle Transportation Account (BTA)	0	0	24	50	49	0	0	0	123
California Tahoe Conservancy Planning Grant	1,972	0	130	0	0	0	0	0	2,102
California Tahoe Conservancy Right of Way Grant	115	0	0	0	0	0	0	0	115
California Tahoe Conservancy Site Improvement Grant	1,497	1,287	185	145	700	264	0	0	4,077
Congestion Mitigation and Air Quality Program	1,394	939	0	650	350	800	0	0	4,133
Erosion Control Discretionary	3	0	0	0	0	0	0	0	3
Miscellaneous Reimbursement	47	15	0	0	0	0	0	0	63
RSTP Exchange Funds-TRPA	423	631	432	256	120	450	0	0	2,311
Safe Routes to School - State	0	450	0	450	450	0	0	0	1,350
State Cooperative Agreement	0	0	0	1,690	1,201	3,043	0	0	5,934
State Water Resources Control Board	141	47	409	330	0	0	0	0	926
Tahoe Regional Planning Agency/Air Quality	469	112	372	290	361	390	0	0	1,994
Tahoe Regional Planning Agency/Stream Environmental Zone	143	64	85	26	44	9	0	0	369
Tahoe Regional Planning Agency/Water Quality	626	45	116	127	92	75	0	0	1,081
Transportation Enhancement Activities	0	0	0	120	0	0	0	0	120
United States Forest Service Planning Grant	2,628	274	23	63	115	0	0	0	3,103
United States Forest Service Site Improvement Grant	4,624	445	1,434	865	22	285	0	0	7,674
Totals	14,082	4,309	3,210	5,060	3,503	5,315	0	0	35,479

*Prior FY includes actual revenue and expenditures through 06/30/13, plus amounts budgeted through 06/30/14.

**FY 19/20 - 23/24 and FY 24/25 - 33/34 revenue and expenditures are not included for the Tahoe EIP, as it is a five-year program.