

Bass Lake Hills

Project Submittal Tracking
 Black Text = Completed dates Red
 Text = Projected dates

	Project	Number	FPR						1st Submittal TD only (30% GAD's for roadways)		2nd Submittal (60% for roadways)		3rd Submittal (80% for roadways)		100% Plan Processing (Plan Signoff)		EIO Approval	Permit through SCAQD/PLA	NOTES
			submitted	returned	submitted	returned	submitted	approved	submitted	returned	submitted	returned	submitted	approved					
EID Planning Docs	Master FPR	16-017-002	11/30/2016	1/20/2017	5/2/2017	5/18/2017	6/12/2017	7/12/2017											
	Hawk View FPR	16-017-002	11/30/2016	1/24/2017	4/13/2017	5/18/2017	6/15/2017	7/13/2017											
	Bell Woods FPR	16-017-002	12/1/2016	1/20/2017	3/23/2017	6/6/2017	6/15/2017	7/13/2017											
	Bell Ranch FPR	16-017-002	12/22/2017	2/2/2017	4/25/2017	6/19/2017	8/10/2017	8/31/2017											
	Booster Pump BODR	16-017-002	6/21/2017	On Hold for FPR	Resubmit 9/1/2017	9/11/2017	9/18/2017	9/25/2017											
Improvement Plans	Bell Woods Wetland Grading Plan	16-017-004						7/18/2017	7/28/2017 (verbal)	8/11/2017				8/25/2017				SWPPP, ADMP in-process	
	Bell Ranch Wetland Grading Plan	16-017-005						7/17/2017	7/28/2017 (verbal)	8/11/2017				8/25/2017				SWPPP, ADMP in-process	
	Hawk View (Rough Grade Only)	16-017-003							8/10/2017 (with walls)					8/18/2017		9/1/2017		Wall Calcs, SWPPP, ADMP in-process	
	Hawk View Unit 1	16-017-003						4/18/2017	5/5/2017	8/10/2017	9/1/2017 (EIO tool)			9/22/2017	10/6/2017	Date OK	12/19/2017	Need NSDW approval	
	Hawk View Unit 2	16-017-003						8/11/2017	9/13/2017	10/16/2017	11/13/2017			12/4/2017	12/15/2017	Date OK	2/20/2018		
	Bell Woods	16-017-004						7/18/2017	8/16/2017	9/25/2017 (with walls)	10/25/2017			11/10/2017	11/20/2017	Date OK	1/30/2018		
	Bell Ranch Unit 1	16-017-005						7/17/2017	8/17/2017	9/18/2017 (with walls)	10/16/2017			10/30/2017	11/9/2017	Date OK	2/13/2018	Need Booster and MR Ph 1 approval	
	Bell Ranch Unit 2	16-017-005						8/18/2017	9/27/2017 (with walls)	11/27/2017				12/8/2017	12/20/2017	Date OK	3/13/2018	Need MR Ph 2 approval	
	Booster Pump Plans	16-017-005						9/29/2017	10/6/2017	10/27/2017	11/3/2017			11/17/2017	12/1/2017		1/23/2018		
	North Silver Dove	16-017-014						4/29/2016	6/09/2017	N/A	6/2/2017	6/29/2017	8/11/2017	9/8/2017	9/22/2017	10/11/2017	Date OK	12/19/2017	
	Merrison Road Phase 1	16-017-015						8/25/2016	10/6/2016	6/28/2017	7/26/2017	9/6/2017	10/4/2017	10/23/2017	11/6/2017	Date OK	1/23/2018		
	Merrison Road Phase 2	16-017-015						8/25/2016	10/6/2016	8/18/2017	9/15/2017	10/25/2017	11/27/2017	12/11/2017	1/2/2018	Date OK	3/13/2018		
	Bass Lake Road/Park & Ride Spoils	16-017-006						4/29/2016	6/09/17	7/5/2017			9/1/2017	11/1/2017	11/29/2017	1/5/2018			
	Country Club Extension	16-017-007						8/1/2016	9/8/2016	1/16/2017	4/14/2017	(merge w/BLRD)							
	Country Club G to H	16-017-008						4/29/2016	6/09/17	7/5/2017			9/8/2017	10/11/2017	11/10/2017	12/20/2017			
Silver Dove to School	16-017-009						4/29/2016	6/09/17	7/5/2017			9/8/2017	10/11/2017	11/10/2017	12/20/2017				
Water to School	16-017-010						4/29/2016	6/09/17	n/a			9/18/2017	11/1/2017	11/24/2017	1/5/2018	Date OK			
Seiver to School	16-017-011						10/2/2017	11/10/2017				12/11/2017	1/5/2018	1/15/2018	1/19/2018	Date OK			
Hwy 50 Bass Lake Interchange		BY OTHERS																	

	Project	Number	EDC Surveyor Technical Review				EDC Planning Dept Processing	
			submitted	returned	submitted	approved	submitted	approved
Final Maps	Hawk View Unit 1	16-017-003	6/15/2017	8/14/2017	8/28/2017	9/18/2017	10/13/2017	12/19/2017
	Hawk View Unit 2	16-017-003	8/9/2017	10/9/2017	10/23/2017	11/13/2017	12/20/2017	2/20/2018
	Bell Woods	16-017-004	8/9/2017	10/9/2017	10/23/2017	11/13/2017	11/27/2017	1/30/2018
	Bell Ranch Unit 1	16-017-005	6/15/2017	7/31/2017	8/9/2017	9/20/2017	12/5/2017	2/13/2018
	Bell Ranch Unit 2	16-017-005	9/13/2017	10/25/2017	11/8/2017	12/13/2017	1/9/2018	3/13/2018

PFFP Estimates Complete by 8/14/17

COUNTRY CLUB DRIVE REALIGNMENT PROJECT

AERIAL EXHIBIT
EL DORADO COUNTY, CALIFORNIA
SCALE: 1"=200' AUGUST, 2017



0 100' 200' 400'
SCALE: 1" = 200'

GRIND AND OVERLAY
(E) PAVEMENT



cta Engineering & Surveying
Civil Engineering & Land Surveying & Land Planning
2023 Morse Drive, Rancho Cordova, CA 95672
TEL: 916.437.1100 FAX: 916.437.1101

BASS LAKE HILLS PHASE 1A & PHASE 2 IMPROVEMENT EXHIBIT

EL DORADO COUNTY, CALIFORNIA

SCALE: 1"=400'

SEPTEMBER, 2016



0 200' 400' 800'
SCALE: 1" = 400'

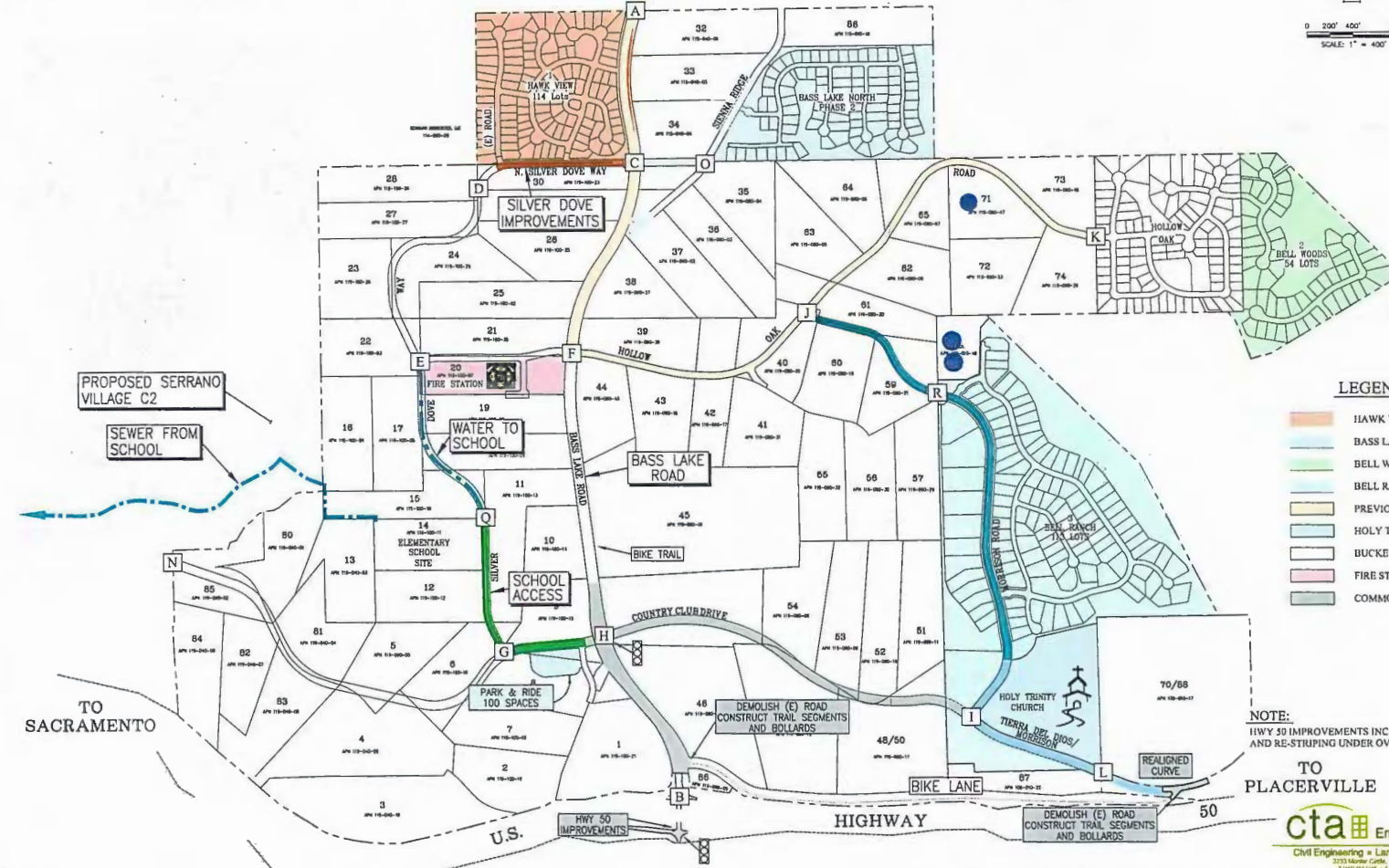

LEGEND

- HAWK VIEW IMPROVEMENTS
- BASS LAKE NORTH IMPROVEMENTS
- BELL WOODS IMPROVEMENTS
- BELL RANCH IMPROVEMENTS
- PREVIOUSLY IMPROVED ROAD
- HOLY TRINITY CHURCH
- BUCKEYE SCHOOL SITE
- FIRE STATION
- COMMON IMPROVEMENTS

NOTE: HWY 50 IMPROVEMENTS INCLUDE: OFF-RAMP WIDENING, AND RE-STRIPING UNDER OVERCROSSING

TO PLACERVILLE

cta Engineering & Surveying
 Civil Engineering • Land Surveying • Land Planning
 2203 Mariner Circle, Redwood City, CA 94061
 770.866.8200 • www.cta-engineers.com

PROJECT DEVELOPMENT SCHEDULE Bass Lake Hills Projects	TYPICAL																			
	2016				2017				2018				2019				2020			
	Q1	Q2	Q3	Q4	Q1	Q2	Q3	Q4	Q1	Q2	Q3	Q4	Q1	Q2	Q3	Q4	Q1	Q2	Q3	Q4
Project Approval																				
Development Agreement																				
Subdivision Engineering/Design																				
Map Recordation																				
Off-site Roads Engineering/Design																				
Road Construction Starts																				

PROJECT DEVELOPMENT SCHEDULE Bass Lake Hills Projects	ACCELERATED															
	2016				2017				2018				2019			
	Q1	Q2	Q3	Q4	Q1	Q2	Q3	Q4	Q1	Q2	Q3	Q4	Q1	Q2	Q3	Q4
Project Approval																
Development Agreement																
Subdivision Engineering/Design																
Off-site Roads Engineering/Design																
Road Construction Starts																
Map Recordation																