

INDEX OF SHEETS

Sheet Number	Sheet Title	Sheet Description
1	i	TITLE
2	ii	GENERAL NOTES, ABBREVIATIONS, AND LEGEND
3	P-1	STAGING AREA
4	D-1	DETAILS
5	TC & EC	TRAFFIC CONTROL TEMPORARY EROSION CONTROL

**COUNTY OF EL DORADO, CA
COMMUNITY DEVELOPMENT SERVICES
DEPARTMENT OF TRANSPORTATION**

PROJECT PLANS FOR THE CONSTRUCTION OF THE 2021

**RUBICON TRAIL
TAHOMA STAGING AREA
PAVING PROJECT**

IN COUNTY OF EL DORADO, DISTRICT 5
AND IN PLACER COUNTY, DISTRICT 5

To be supplemented with the 2015 Standard Plans and Specifications of
the California Department of Transportation, unless otherwise noted.

**RUBICON TRAIL TAHOMA
STAGING AREA PAVING
PROJECT AREA**



LOCATION MAP

SCALE: 1" = 1000'

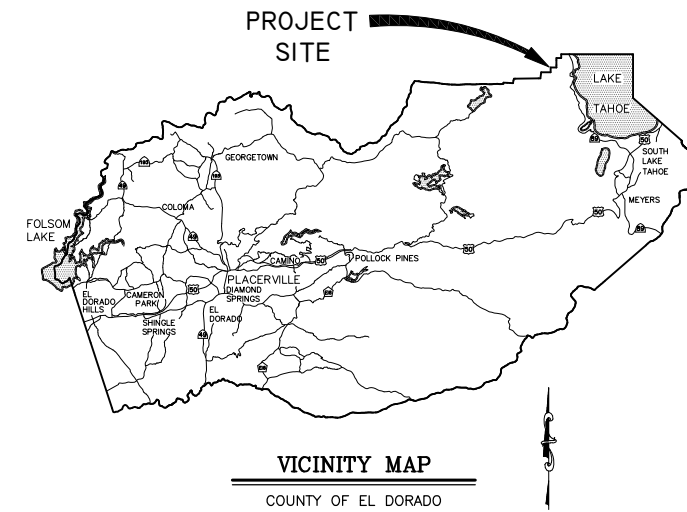

VICINITY MAP

COUNTY OF EL DORADO

FUNDING AGENCIES

CALIFORNIA OHV PROGRAM

CONTRACTOR'S LICENSE CLASSIFICATION: Bidders shall be properly licensed to perform the Work pursuant to the State Contractor's License Law (Business and Professions Code section 7000 et seq.) and shall possess a CLASS A LICENSE or equivalent combination of Classes required by the categories and type of Work included in the Contract Documents and Plans, at the time the Contract is awarded, and shall maintain a valid license through completion and acceptance of the Work including guarantee and warranty period. Failure of the successful Bidder to obtain proper and adequate licensing for an award of the Contract shall constitute a failure to execute the Contract, and shall result in forfeiture of the Bidders security.

REVISIONS

MARK	DATE	BY

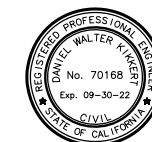

SUBMITTED BY: DANIEL W. KIKKERT P.E.
SENIOR CIVIL ENGINEER
STATE OF CALIFORNIA NO. 70168

FEBRUARY 16, 2021
DATE

BOARD OF SUPERVISORS

JOHN HIDAHIL	I
GEORGE TURNBOO	II
WENDY THOMAS	III
LORI PARLIN	IV
SUE NOVASEL	V

**COUNTY OF EL DORADO
DEPARTMENT OF TRANSPORTATION**

(530) 573-7900
924 B EMERALD BAY RD
SOUTH LAKE TAHOE, CA 96150

(530) 621-5900
2850 FAIRLANE CT
PLACERVILLE, CA 95667

ADOPTED AND APPROVED BY:

JOHN HIDAHIL
CHAIR, COUNTY OF EL DORADO BOARD OF SUPERVISORS

RAFAEL MARTINEZ, DIRECTOR
COMMUNITY DEVELOPMENT SERVICES, DEPARTMENT OF TRANSPORTATION

JOHN H. KAHLING, P.E., RCE NO. 52426, DEPUTY DIRECTOR OF ENGINEERING
COMMUNITY DEVELOPMENT SERVICES, DEPARTMENT OF TRANSPORTATION

DATE

CONTRACT NO. 5426, CIP NO. 99439

**RUBICON TRAIL TAHOMA
STAGING AREA PAVING
PROJECT**

TITLE SHEET

SHEET I OF 5

GENERAL NOTES

- ALL IMPROVEMENTS WILL BE ACCOMPLISHED UNDER THE APPROVAL, INSPECTION, AND TO THE SATISFACTION OF THE COUNTY OF EL DORADO DEPARTMENT OF TRANSPORTATION (TD). IMPROVEMENT CONSTRUCTION MUST COMPLY WITH THESE PLANS AND THE 2015 CALTRANS STANDARD PLANS, UNLESS NOTED OTHERWISE. ALL REFERENCES TO THE "STANDARD SPECIFICATIONS" MEAN THE STATE OF CALIFORNIA, DEPARTMENT OF TRANSPORTATION (CALTRANS) 2015 STANDARD SPECIFICATIONS. CONSTRUCTION NOT SPECIFIED ON THESE PLANS OR IN SPECIFIC COUNTY OF EL DORADO (COUNTY) ORDINANCES MUST CONFORM TO THE REQUIREMENTS OF THE STANDARD SPECIFICATIONS. YOU ARE OBLIGATED TO BE FAMILIAR WITH APPLICABLE SECTIONS OF THE STANDARD SPECIFICATIONS NOT DISCUSSED IN THE GENERAL NOTES. THE CONTRACT SPECIAL PROVISIONS SUPERSEDE THE STANDARD SPECIFICATIONS WHERE DISCREPANCIES OCCUR.
- CONSTRUCTION HOURS WILL BE WEEKDAYS BETWEEN 8:00 A.M. AND 6:30 P.M. UNLESS PRIOR APPROVAL IS RECEIVED FROM THE COUNTY TD.
- THE LOCATIONS AND EXTENT OF UNDERGROUND UTILITIES IN THE WORK AREA AS SHOWN ARE APPROXIMATE AND ARE NOT NECESSARILY COMPLETE. A REASONABLE EFFORT HAS BEEN MADE TO LOCATE AND DELINEATE UTILITIES BASED UPON AVAILABLE RECORDS. YOU MUST DETERMINE THE TYPE, LOCATION, SIZE, AND/OR DEPTH OF THE UTILITIES WITHIN THE WORK AREA BEFORE STARTING WORK. YOU OR ANY SUBCONTRACTOR FOR THIS CONTRACT ARE RESPONSIBLE FOR DAMAGES DUE TO THE FAILURE TO EXACTLY LOCATE AND PRESERVE UNDERGROUND UTILITIES. YOU MUST CONTACT UNDERGROUND SERVICE ALERT AT (800) 642-2444 AT LEAST 48 HOURS BEFORE ANY CONSTRUCTION. SEE THE SPECIAL PROVISIONS FOR NOTIFICATION REQUIREMENTS. YOU ASSUME COMPLETE RESPONSIBILITY FOR DAMAGED UTILITIES.
- UNLESS SHOWN OTHERWISE, YOU ARE RESPONSIBLE FOR THE PROTECTION OF ALL EXISTING SURVEY MONUMENTS AND OTHER SURVEY MARKERS, INCLUDING CONSTRUCTION STAKES DURING CONSTRUCTION AND YOU ARE RESPONSIBLE FOR THE COST TO REPLACE ANY SUCH SURVEY MONUMENTS, MARKERS, OR STAKES.
- YOU WILL PROVIDE ALL LIGHTS, SIGNS, BARRICADES, FLAG PERSONS, PILOT CAR, OR OTHER DEVICES NECESSARY TO CONTROL TRAFFIC THROUGH THE JOB SITE AND FOR PUBLIC SAFETY UNDER THESE PLANS, THE STANDARD SPECIFICATIONS, AND CALIFORNIA MANUAL ON UNIFORM TRAFFIC CONTROL DEVICES (MUTCD).
- YOU AGREE TO ASSUME SOLE RESPONSIBILITY FOR JOB SITE CONDITIONS DURING THE COURSE OF THE WORK, INCLUDING SAFETY OF ALL PERSONS AND PROPERTY, AND FURTHER AGREE THAT THIS REQUIREMENT APPLIES CONTINUOUSLY AND IS NOT LIMITED TO NORMAL WORKING HOURS UNDER THE CONTRACT AND STANDARD SPECIFICATIONS.
- THERE WILL BE NO GRADING OR LAND DISTURBANCE BETWEEN OCTOBER 15 AND MAY 1 UNLESS APPROVALS ARE OBTAINED FROM THE TAHOE REGIONAL PLANNING AGENCY (TRPA), AS PROVIDED IN THE LIMITED EXEMPTION DESCRIBED IN CHAPTER 64, SUBSECTION 64.2.B. OF THE TRPA CODE OF ORDINANCES. APPROVALS FOR GRADING BETWEEN OCTOBER 15 AND MAY 1 MUST ALSO BE OBTAINED FROM THE REGIONAL WATER QUALITY CONTROL BOARD, LAHONTAN. IF REQUIRED, THE COUNTY WILL OBTAIN THESE APPROVALS.
- YOU WILL MAINTAIN A SET OF PLANS ON THE JOB SITE SHOWING "AS-CONSTRUCTED" CHANGES MADE TO DATE. UPON COMPLETION OF THE WORK, YOU WILL GIVE TO THE COUNTY A SET OF PLANS, MARKED UP TO THE SATISFACTION OF THE COUNTY, REFLECTING THE AS-CONSTRUCTED MODIFICATIONS.
- ALL CONTROL STATIONING AND DATA DIMENSIONING REFERENCE THE CENTERLINE OF THE FACILITY SHOWN, UNLESS NOTED OTHERWISE.
- YOU WILL NOT CLOSE OFF ANY UTILITY LINES OR OPEN VALVES OR TAKE ANY OTHER ACTION WHICH WOULD AFFECT THE OPERATION OF WATER OR SEWER SYSTEMS WITHOUT APPROVAL FROM THE TAHOE CITY PUBLIC UTILITY DISTRICT (TCPUD). APPROVAL MUST BE REQUESTED AT LEAST 48 HOURS BEFORE INTERRUPTION OF THE UTILITY SERVICE IS REQUIRED. ANY INTERRUPTION TO ACTIVE WATER OR SEWER SERVICES, INCLUDING FIRE HYDRANTS, WHETHER INTENTIONAL OR NOT, MUST BE KEPT TO A MINIMUM TIME PERIOD. IF SERVICE TO BUILDINGS IS TO BE OFF FOR MORE THAN FOUR HOURS, YOU MUST ADVISE STPUD.
- YOU ARE REQUIRED TO IMPLEMENT DUST CONTROL MEASURES TO ENSURE THAT DUST RESULTING FROM YOUR ACTIVITIES IS CONTROLLED AND COMPLIES WITH THE PROVISIONS OF SECTION 7, "LEGAL RELATIONS AND RESPONSIBILITY TO THE PUBLIC," AND SECTION 14, "ENVIRONMENTAL STEWARDSHIP," OF THE STANDARD SPECIFICATIONS, COUNTY, AND LOCAL ORDINANCES. SEE THE SPECIAL PROVISIONS FOR DUST AND TRACKING CONTROL AND SWEEPING REQUIREMENTS.
- YOU ARE RESPONSIBLE FOR IMPLEMENTING ALL TEMPORARY EROSION CONTROL MEASURES. THE TEMPORARY EROSION CONTROL MEASURES MUST COMPLY WITH THE TRPA "HANDBOOK OF BEST MANAGEMENT PRACTICES" AND THE STORM WATER POLLUTION PREVENTION PLAN (SWPPP). THE TD WILL CONTACT TRPA BEFORE THE START OF THE WORK FOR A PRE-GRADING INSPECTION OF THE INSTALLED TEMPORARY EROSION CONTROL FACILITIES. YOU ARE RESPONSIBLE FOR THE MAINTENANCE AND PERFORMANCE OF THE TEMPORARY EROSION CONTROL MEASURES THROUGHOUT THE DURATION OF THE WORK. SEE THE SPECIAL PROVISIONS REGARDING TEMPORARY EROSION CONTROL FACILITY REMOVAL.
- CONSTRUCTION LIMITS SHOWN DELINEATE THE BOUNDARIES FOR YOUR ACTIVITIES BEYOND THE COUNTY STREET RIGHT-OF-WAY. CONSTRUCTION LIMIT FENCING MUST BE ERECTED ALONG THESE BOUNDARIES BEFORE WORK STARTS. VEGETATION WITHIN THESE LIMITS MUST BE PROTECTED TO THE EXTENT FEASIBLE. ALL TREES MUST BE PROTECTED UNLESS SHOWN TO BE REMOVED.
- UNLESS NOTED OTHERWISE, ALL REVEGETATION IS TO BE COMPLETED BY OTHERS.
- YOU WILL ONLY USE THE DESIGNATED SITES SHOWN FOR STORAGE OF EQUIPMENT AND MATERIALS. YOU ARE RESPONSIBLE FOR THE SECURITY OF EQUIPMENT AND MATERIALS.
- IT IS YOUR AND YOUR SUBCONTRACTOR(S) RESPONSIBILITY TO EXAMINE THE JOB SITE BEFORE THE OPENING OF BID PROPOSALS. YOU MUST BECOME FAMILIAR WITH THE NATURE AND LOCATION OF THE WORK AND THE GENERAL AND LOCAL CONDITIONS, PARTICULARLY THOSE AFFECTING THE AVAILABILITY OF TRANSPORTATION, THE DISPOSAL, HANDLING, AND STORAGE OF MATERIALS, AVAILABILITY OF LABOR, WATER, ELECTRICITY, ROADS, THE UNCERTAINTIES OF WEATHER, THE CONDITIONS OF THE GROUND, SURFACE AND SUBSURFACE MATERIALS, THE EQUIPMENT AND FACILITIES NEEDED FOR AND DURING THE PERFORMANCE OF THE WORK. FAILURE BY YOU OR YOUR SUBCONTRACTOR(S) TO ACQUAINT YOURSELVES WITH THE INFORMATION AVAILABLE WILL NOT RELIEVE YOU OR YOUR SUBCONTRACTOR(S) FROM RESPONSIBILITY FOR PROPERLY ESTIMATING THE DIFFICULTY AND COST OF SUCCESSFULLY PERFORMING THE WORK.
- ELEVATIONS FOR PIPE INVERTS, FLOWLINES, TOPS OF GRATES, RIMS, ETC., ARE BASED ON THE TOPOGRAPHIC INFORMATION SHOWN. YOU WILL VERIFY ALL NECESSARY SURFACE ELEVATIONS IN THE FIELD AND NOTIFY THE TD OF ANY DISCREPANCIES WHICH MIGHT AFFECT THE OPERATION OF THE NEW FACILITIES BEFORE BREAKING GROUND FOR THE INSTALLATION. THE TD MUST BE CONTACTED IF ELEVATIONS ARE INCORRECT SO PROPER ADJUSTMENTS CAN BE MADE BEFORE THE INSTALLATION OF THE FACILITIES.
- EXCEPT FOR THOSE OBTAINED BY THE TD, YOU MUST OBTAIN, AT YOUR EXPENSE, ALL PERMITS, LICENSES, INSURANCE POLICIES, ETC., NECESSARY TO COMPLY WITH STATE AND LOCAL LAWS ASSOCIATED WITH THE PERFORMANCE OF THE WORK.
- YOU ARE RESPONSIBLE TO REVIEW THE CONTRACT DOCUMENTS FOR SUBMITTALS REQUIRED FOR COUNTY REVIEW AND ACCEPTANCE.
- YOU ARE RESPONSIBLE TO MAINTAIN THE GRADING LIMITS AS SHOWN ON THE PLANS, DETAILS, CROSS SECTIONS, AND AS DIRECTED BY THE ENGINEER.

ABBREVIATIONS

NOTE: LOWER CASE TEXT WITHIN PLAN SET INDICATES EXISTING

△	DELTA = DEFLECTION ANGLE	MISC	MISCELLANEOUS
A	ARCH OR ASPEN	MOC	MID POINT ON CURVE
AB	AGGREGATE BASE	MOD	MODIFIED
ABAND	ABANDONED	MV	MEADOW VALE
ABC	ARTICULATED BLOCK CHANNEL	N	NORTH
AC	ASPHALT CONCRETE	NEG	NEGLIGIBLE
AP	ANGLE POINT	NGVD	NATIONAL GEODETIC VERTICAL DATUM
APN	ASSESSOR'S PARCEL NUMBER	NIC	NOT IN CONTRACT
BC	BEGIN CURVE	NTS	NOT TO SCALE
BCR	BEGIN CURB RETURN	OAE	OR APPROVED EQUAL
BGN	BEGIN	OC	ON CENTER
BLC	BLANKET-LINED CHANNEL	OD	OUTSIDE DIAMETER
BR	BOCA RATON	OG	ORIGINAL GROUND
BVCE	BEGIN VERTICAL CURVE ELEVATION	OH	OVERHEAD
BVCS	BEGIN VERTICAL CURVE STATION	OVEREX OR O/X	OVEREXCAVATION
C	CEDAR	P	PINE
CALCS	CALCULATIONS	PC	POINT OF BEGINNING OF CURVE
CATV	CABLE TELEVISION	PCC	PORTLAND CEMENT CONCRETE OR POINT OF COMPOUND CURVE
CC	CENTER TO CENTER	PERF	PERFORATED
CF	CUBIC FEET OR CURB FACE	PCVCE	POINT OF COMPOUND VERTICAL CURVE ELEVATION
CHD	CHORD DIRECTION	PCVCS	POINT OF COMPOUND VERTICAL CURVE STATION
CIR	CIRCLE	PL	PROPERTY LINE
CL	CENTERLINE	POR	PORTION
CLR	CLASS OR CENTERLINE	PP	POWER/UTILITY POLE
CO	CURB OPENING OR CLEANOUT	PRC	POINT OF REVERSE CURVE
CO.	COUNTY	PROP	PROPOSED
CONC	CONCRETE	PRVCE	POINT OF REVERSE VERTICAL CURVE ELEVATION
CONST	CONSTRUCT	PRVCS	POINT OF REVERSE VERTICAL CURVE STATION
CMP	CORRUGATED METAL PIPE	PT	POINT OR POINT OF TANGENCY
CSP	CORRUGATED STEEL PIPE	PUE	PUBLIC UTILITY EASEMENT
CT	CALTRANS OR COURT	PVC	POLYVINYL CHLORIDE
CTC	CALIFORNIA TAHOE CONSERVANCY	PVIE	POINT OF VERTICAL INTERSECTION ELEVATION
CY	CUBIC YARD	PVIS	POINT OF VERTICAL INTERSECTION STATION
C&G	CURB AND GUTTER	PVMT	PAVEMENT
D	DEPTH	R	RADIUS
DBL	DOUBLE	R&R	REMOVE & REPLACE
DET	DETAIL	RC	RELATIVE COMPACTION
DI	DRAINAGE INLET OR DUCTILE IRON	RCP	REINFORCED CONCRETE PIPE
DIA OR Ø	DIAMETER	RD	ROAD
DISS	DISSIPATOR	REF	REFERENCE
DR	DRIVE	REQ'D	REQUIRED
D/W	DRIVEWAY	RLC	ROCK-LINED CHANNEL
E	EAST	ROW	RIGHT-OF-WAY
EA	EACH	RSF	REINFORCED SILT FENCE
EC	END OF CURVE	RSP	ROCK SLOPE PROTECTION
ECR	END OF CURB RETURN	RT	RIGHT
ELEC	ELECTRIC	RW	RETAINING WALL
ELEV	ELEVATION	S	SOUTH OR SANITARY SEWER
ENGR	ENGINEER	SCO	SEWER CLEAN OUT
EP	EDGE OF PAVEMENT	SD	STORM DRAIN
ESA	ENVIRONMENTALLY SENSITIVE AREA	SDMH	STORM DRAIN MANHOLE
ESMT	EASEMENT	SEZ	STREAM ENVIRONMENT ZONE
EVCE	END VERTICAL CURVE ELEVATION	SF	SQUARE FEET
EVCS	END VERTICAL CURVE STATION	SHT	SHEET
EX OR EXIST	EXISTING	SL	SLOPE LENGTH
F	FIR	SMH	SEWER MANHOLE
FES	FLARED END SECTION	ST	SEDIMENT TRAP OR STREET
FG	FINISHED GRADE	STA	STATION
FH	FIRE HYDRANT	STD	STANDARD
FL	FLOWLINE	STL	STEEL
FS	FINISH SURFACE	STPUD	SOUTH TAHOE PUBLIC UTILITY DISTRICT
G	GAS	SWPPP	STORM WATER POLLUTION PREVENTION PLAN
GA	GAUGE	T	TELEPHONE
GB	GRADE BREAK	TBC	TOP BACK OF CURB
GLS	GRASS-LINED SWALE	TBD	TOP BACK OF DIKE
GW	GROUND WATER	TBR	TO BE REMOVED
H	HORIZONTAL	TD	TOP OF DIKE
HDPE	HIGH DENSITY POLYETHYLENE	TG	TOP OF GRATE
HP	HIGH POINT	TTL	TOTAL
HWL	HIGH WATER LINE	TRANS	TRANSITION
ID	INSIDE DIAMETER	TRM	TURF REINFORCEMENT MAT
IE	INVERT ELEVATION	TRPA	TAHOE REGIONAL PLANNING AGENCY
INCR	INCREASE	TYP	TYPICAL
INST	INSTALL	UG	UNDERGROUND
INTRXN	INTERSECTION	UKN	UNKNOWN
L	LENGTH	USFS	UNITED STATES FOREST SERVICE
LC	LENGTH OF CHORD	V	VERTICAL
LF	LINEAR FEET	W	WEST OR WATER
LP	LOW POINT	W/O	WITHOUT
LT	LEFT	WC	WILLOW CLUSTER
MAT'L	MATERIAL	WV	WATER VALVE

LEGEND

EXISTING		PROPOSED	
(SCREENED AND/OR DASHED)	EXISTING (AS NOTED)	---	CENTERLINE
---	RIGHT-OF-WAY OR PROPERTY LINE	-----	SAWCUT (AS NOTED)
---	EASEMENT	XXXX.XX	ELEVATION
---	LAND CAPABILITY BOUNDARY	XXXX.X XXXX.XX	ELEVATION, EG CL, PROPOSED (PROFILE ONLY)
---	10' SEZ SETBACK	○ □	CSP INLET/RISER OR STORM DRAIN MANHOLE, DRAINAGE INLET
○ or □	ROCK	VV	CUT OR FILL SLOPE
●	FOUND MONUMENT	(X)	DETAIL REF NUMBER SHEET NUMBER
△	SURVEY CONTROL POINT	■	ROCK
XXXX.X	ELEVATION	=====	SD PIPE (MATERIAL AS NOTED)
⊙	SEWER MANHOLE	-RSF-ESA-	REINFORCED SILT FENCE AND TYPE ESA FENCE
○ SCO	SEWER CLEAN OUT	▷	FLARED END SECTION
■	DRAINAGE INLET	#:#	SLOPE RATIO, H: V
g m	GAS METER	=====	ROCK-LINED CHANNEL
WV	WATER VALVE	=====	BLANKET-LINED CHANNEL
W m	WATER METER	✕	TREE REMOVAL
⊙	MONITORING WELL	FLOWLINE
---w---w---	WATER LINE	---	CUT
---s---s---	SEWER LINE	---f---f---	FILL
---g---g---	GAS LINE		
---	STORM DRAIN		
---oh---oh---	OVERHEAD UTILITIES		
⊙	POWER/UTILITY POLE		
⊙	UTILITY POLE & GUY ANCHOR		
⊙	FIRE HYDRANT		
---	FENCE		
---	FLOWLINE		
⊙ 28"p	TREE, DIAMETER AND TYPE		
○	STUMP		
⊙ WC	WILLOW CLUSTER		

UTILITIES

CABLE TELEVISION	CHARTER COMMUNICATIONS, (775) 588-1077
NATURAL GAS	SOUTHWEST GAS, (530) 543-3225
ELECTRIC	LIBERTY UTILITIES, (530) 541-6400
SEWER & WATER	TAHOE CITY PUD, (530) 583-3796
TELEPHONE	AT&T, (530) 888-2031
STORM DRAIN	CO. OF EL DORADO TRANSPORTATION DIVISION, (530) 573-3180

DRAWING NAME: 11.0111.30 PROJECT: 194939 Engineering (WIP) - Taboras Highway Level 2, RFSH II NOTES.dwg

FOR REDUCED PLANS 2 ORIGINAL SCALE IS IN INCHES

REVISION	NUMBER	DATE	DESCRIPTION	BY



PREPARED UNDER THE SUPERVISION OF:

[Signature]

REGISTERED CIVIL ENGINEER
FEBRUARY 16, 2021
 DATE:

DESIGNED: DMG
 DRAWN: DMG
 CHECKED: DWK
 DATE: ---
 ROAD NUMBER: ---

COUNTY OF EL DORADO
COMMUNITY DEVELOPMENT SERVICES
DEPARTMENT OF TRANSPORTATION

RUBICON TRAIL TAHOA STAGING AREA PAVING PROJECT
GENERAL NOTES, ABBREVIATIONS, AND LEGEND

SHEET
ii
 of 5
 CONTRACT NO.
5426
 CIP No.
99439

NOTES:

1. 4"+ AGGREGATE BASE WAS PLACED, GRADED, AND COMPACTED IN FALL OF 2020.
2. CONTRACTOR REQUIRED TO MOISTURE CONDITION AND RECOMPACT SURFACE PRIOR TO PLACEMENT OF ASPHALT CONCRETE.
3. ADDITIONAL AGGREGATE BASE, IF NEED FOR BASE SURFACE, WILL BE PAID UNDER THE SHOULDERING BID ITEM.

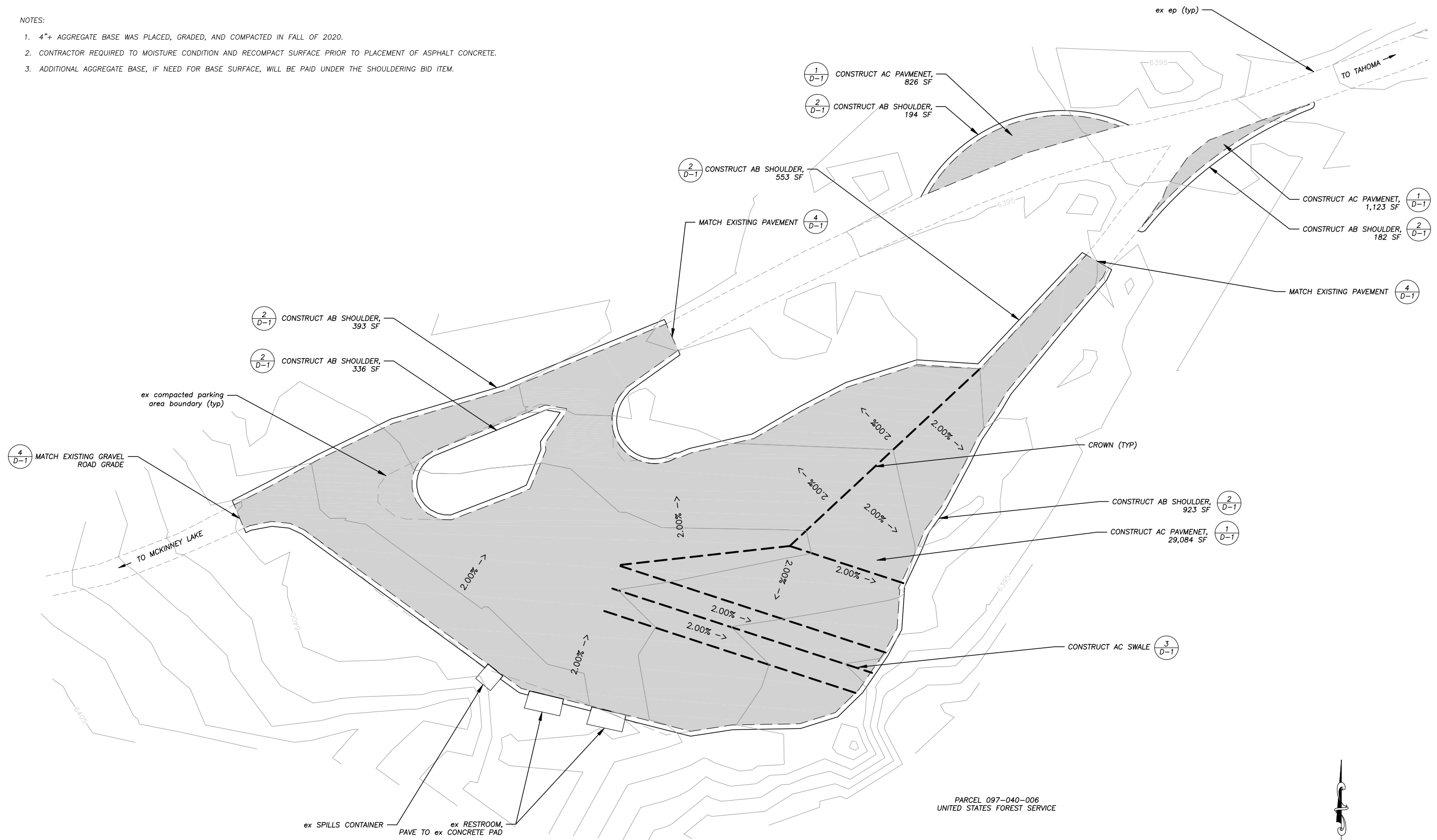

FOR REDUCED PLANS ORIGINAL SCALE IS IN INCHES

REVISION	NUMBER	DATE	DESCRIPTION	BY



PREPARED UNDER THE SUPERVISION OF:
[Signature]
 REGISTERED CIVIL ENGINEER
FEBRUARY 16, 2021
 DATE:

DESIGNED: DMG
 CHECKED: DWK
 ROAD NUMBER: #####



COUNTY OF EL DORADO
 DEPARTMENT OF TRANSPORTATION

RUBICON TRAIL TAHOMA STAGING AREA PAVING
 PROJECT
 STAGING AREA

SHEET
P-1
 3 OF 5
 CONTRACT NO.
5426
 CIP No.
99439

Drawing name: \\CIVIL_3D_PROJECTS\99439\Engineering\Plan-Tahoma\Staging\area4_RRFSM_DETAIL.dwg

ORIGINAL SCALE IS IN INCHES

FOR REDUCED PLANS

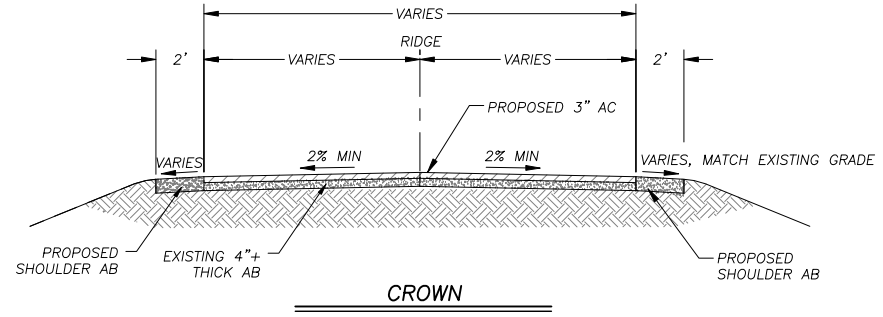

CROWN

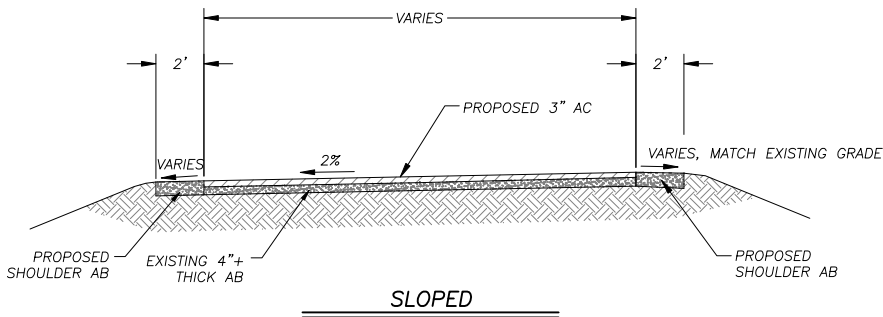

SLOPED

- NOTES:
1. SEE SPECIAL PROVISIONS FOR COMPACTION REQUIREMENTS
 2. AGGREGATE BASE (AB) MATERIAL HAS BEEN PLACED AND COMPACTED AT GRADE. CONTRACTOR REQUIRED TO MOISTURE CONDITION AND WHEEL ROLL SURFACE TO MEET COMPACTION REQUIREMENTS
 3. IF ADDITIONAL AB IS NEEDED, IT WILL BE PAID FOR UNDER AB SHOULDERING

PARKING LOT AC SECTION WITH SHOULDER

1
D-1

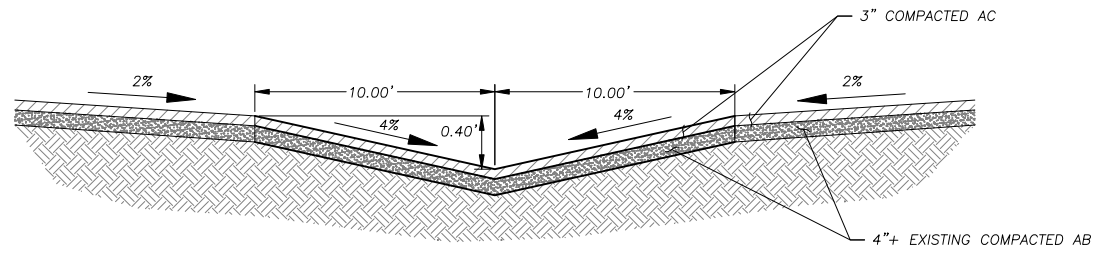

AC SWALE

NTS

3
D-1

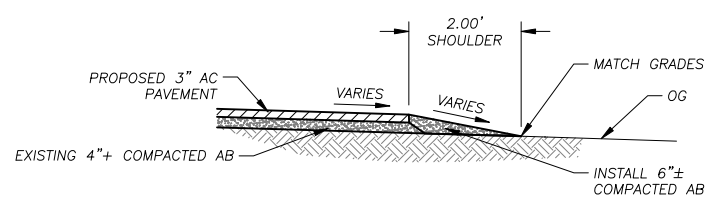

NOTE:
FOR LOCATIONS WHERE AB SHOULDER IS CONSTRUCTED ADJACENT TO EXISTING AC, THE THICKNESS AND WIDTH WILL CONFORM TO THE SHOULDER DIMENSIONS SHOWN AT A SLOPE OF 5%. ANY GRADING BEYOND THE SHOULDER WILL BE IN ACCORDANCE WITH THE PLANS AND DETAILS FOR THE FACILITIES PROPOSED.

SHOULDER

NTS

2
D-1

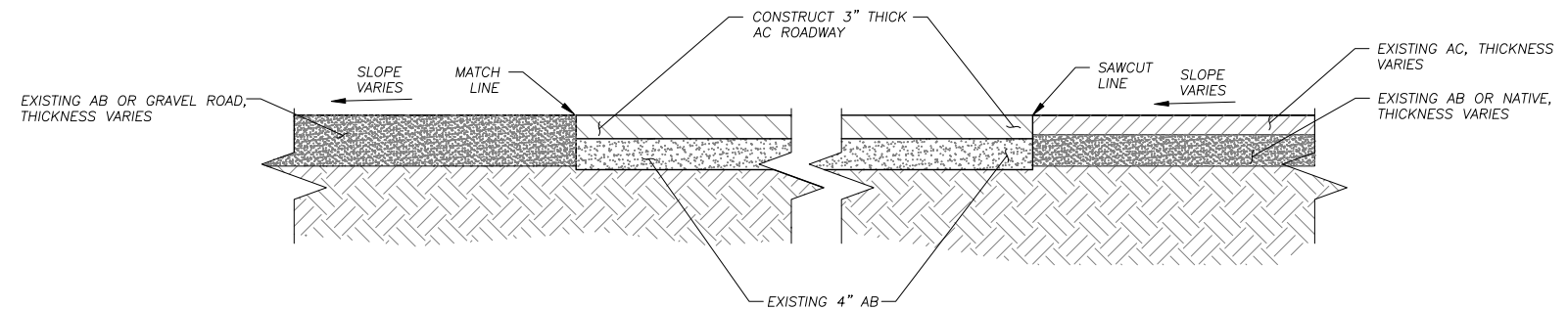

- NOTE:
1. WHEN TYING INTO EXISTING PAVEMENT, SAWCUT EXISTING ASPHALT ROADWAY FOR CLEAN CONFORM

AC CONFORM

NTS

4
D-1

REVISION	NUMBER	DATE	DESCRIPTION	BY



PREPARED UNDER THE SUPERVISION OF:
Walter A. Walker
REGISTERED CIVIL ENGINEER
FEBRUARY 16, 2021
DATE:

DESIGNED: DMG
DRAWN: DMG
CHECKED: DWK
DATE: ---
ROAD NUMBER: ---



COUNTY OF EL DORADO
DEPARTMENT OF TRANSPORTATION

RUBICON TRAIL TAHOMA STAGING AREA PAVING
PROJECT
DETAILS





SHEET
D-1
4 OF 5
CONTRACT NO.
5426
CIP No.
99439

Drawing name: Y:\CIVIL_3D PROJECTS\99439\Engineering\Plan-TahomaStagingArea\S RTTSA TC.dwg

FOR REDUCED PLANS
2 ORIGINAL SCALE IS IN INCHES
1
0

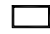
PROJECT AREA TEMPORARY EROSION CONTROL

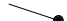
LEGEND

-  PROJECT AREA
-  PROPOSED STAGING AREA WITH SF
-  APPROXIMATE SIGN LOCATION
-  "CHANGEABLE MESSAGE SIGN"
-  SEDIMENT CONTROL

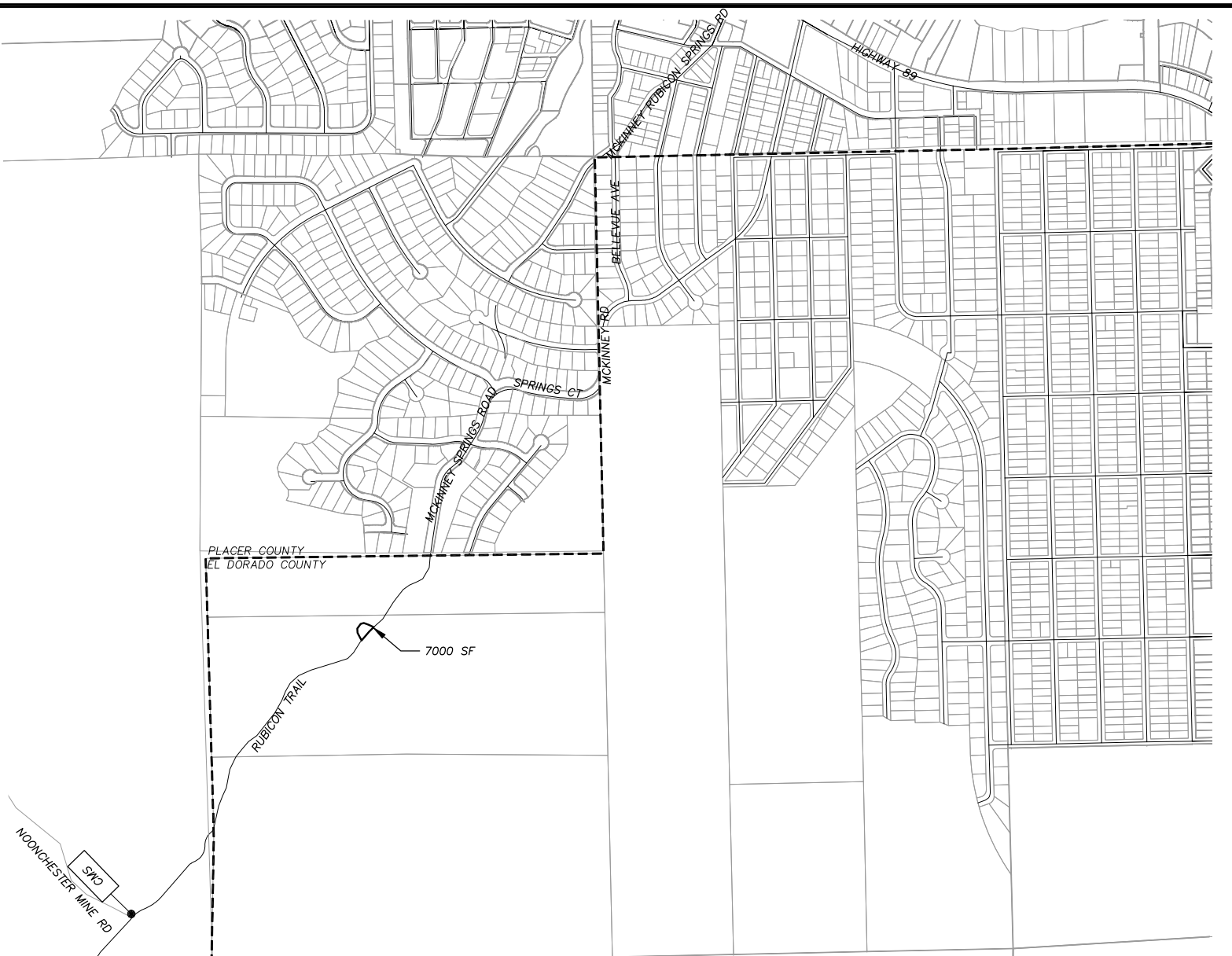
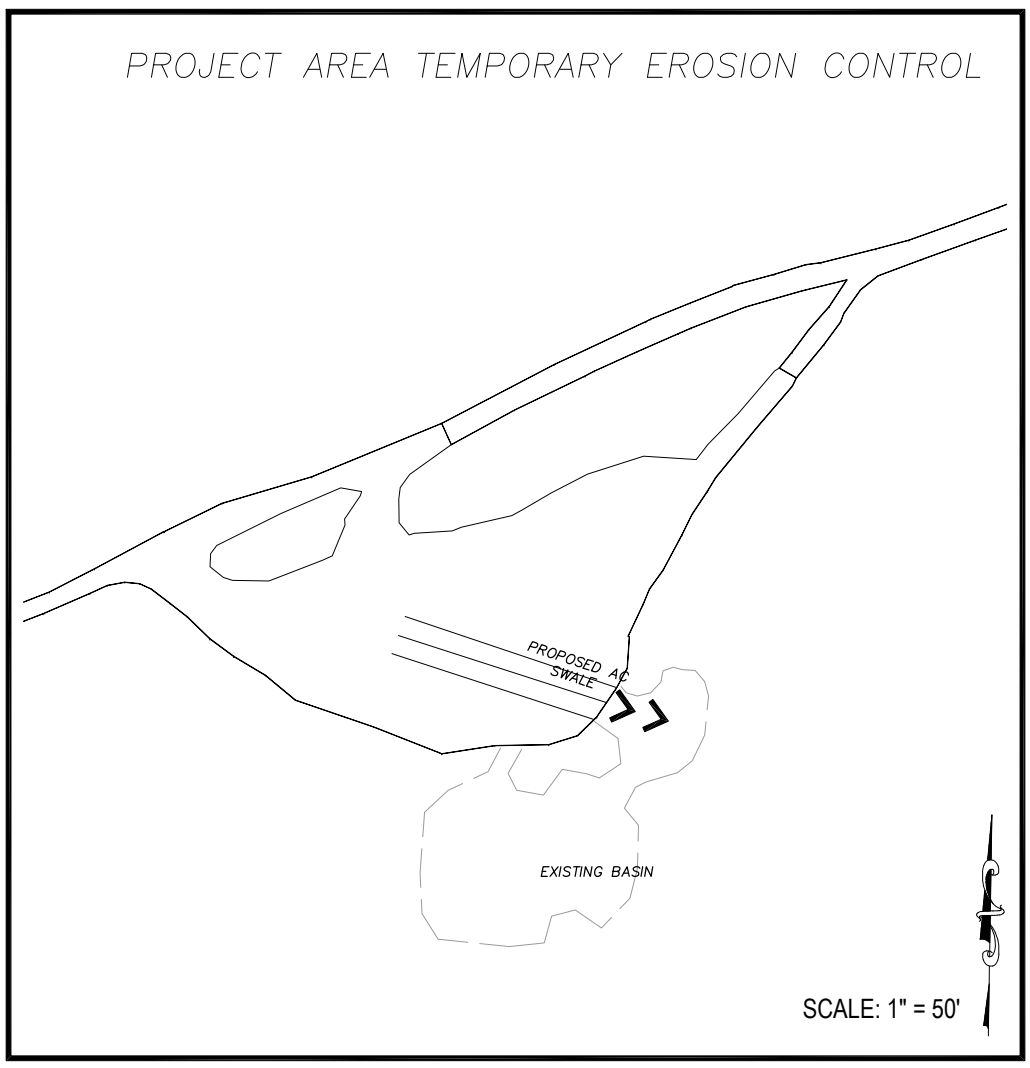

TRAFFIC CONTROL NOTES:

1. THIS PLAN HAS BEEN PREPARED AS A GUIDE FOR YOU IN PREPARATION OF A COMPLETE TRAFFIC CONTROL PLAN AND TO AID IN YOUR PLANNING FOR STAGING/STORAGE OF MATERIALS AND EQUIPMENT. YOUR TRAFFIC CONTROL PLAN WILL INCLUDE DETAILED CONTROLS INCLUDING FLAGGERS, LANE CLOSURES, AND SIGNS FOR ALL ITEMS OF ROAD WORK WHICH WILL REQUIRE ALTERATION OF EXISTING TRAFFIC PATTERNS. THE LEGEND SHOWS THE LIST OF SIGNS TO BE REQUIRED AS A MINIMUM.
2. YOUR TRAFFIC CONTROL PLAN WILL ADDRESS EACH PHASE OF CONSTRUCTION AFFECTING THE ROADWAY AND WILL CONFORM TO PART 6 OF THE CALIFORNIA MUTCD ENTITLED "TEMPORARY TRAFFIC CONTROL" AND THE SPECIAL PROVISIONS. YOUR TRAFFIC CONTROL PLAN WILL ALSO INCLUDE ALL SIGNING REQUIRED AT INTERSECTING STREETS WITHIN THE AREA THAT WILL REQUIRE TRAFFIC CONTROL.
3. YOUR ATTENTION IS DIRECTED TO THE SWPPP AND THE SPECIAL PROVISIONS REGARDING TEMPORARY EROSION CONTROL REQUIREMENTS FOR STAGING AREAS.
4. STAGING AREAS SHOWN ARE FOR THE TEMPORARY STORAGE OF CONSTRUCTION MATERIALS AND EQUIPMENT WHICH ARE TO BE USED ON THIS PROJECT.
5. CMS BOARDS WILL BE PLACED BY OTHERS AND WILL BE UTILIZED PRIMARILY 1 WEEK PRIOR TO CONSTRUCTION ACTIVITIES FOR ADVANCED NOTICE TO TRAIL USERS OF THE UPCOMING WORK.

EROSION CONTROL NOTES:

1. PROJECT SITE HAS EXISTING BASINS AT SOUTHERN PERIMETER THAT WILL BE USED TO CAPTURE RUNOFF.
2. PLACE WADDLES AT END OF PROPOSED AC SWALE.
3. HAVE ADDITIONAL WADDLES ON SITE AS NEEDED.

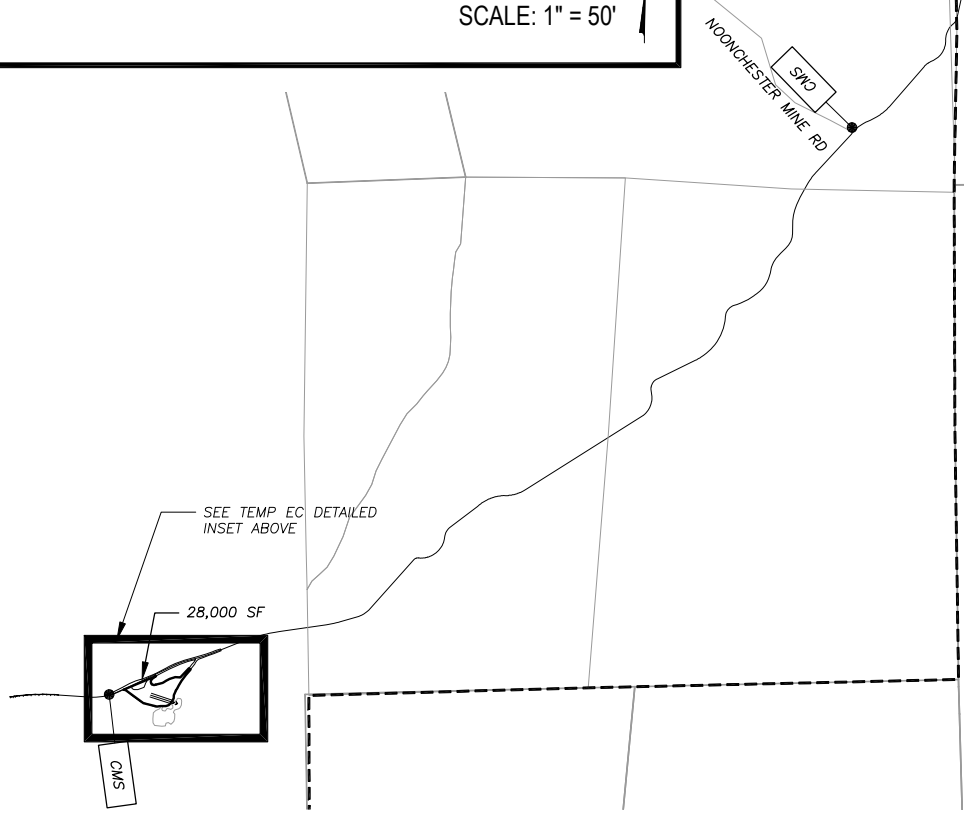

REVISION	NUMBER	DATE	DESCRIPTION	BY

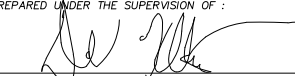

PREPARED UNDER THE SUPERVISION OF:

 REGISTERED CIVIL ENGINEER
FEBRUARY 16, 2021
 DATE:

DESIGNED: DMG
 DRAWN: DMG
 CHECKED: DWK
 DATE: ---
 ROAD NUMBER: ---



COUNTY OF EL DORADO
 COMMUNITY DEVELOPMENT SERVICES
 DEPARTMENT OF TRANSPORTATION

RUBICON TRAIL TAHOMA STAGING AREA PAVING
 PROJECT
 TRAFFIC CONTROL
 TEMPORARY EROSION CONTROL

SHEET
TC & EC
 5 OF 5
 CONTRACT NO.
5426
 CIP No.
99439