



El Dorado County

HHSA SOAR Project

SUPPORT, OUTREACH, ACCESSIBILITY,
AND RESILIENCE CENTER

Project Scope

2



- ▶ HHSA SOAR Project will renovate the former juvenile detention facility which currently houses Dept 8, El Dorado Superior Court and the El Dorado County (EDC) Navigation Center.
- ▶ After renovations, the upper floor will become the new EDC Psychiatric Health Facility (PHF), expanding our capacity to treat our community's highest need Behavioral Health clients.
- ▶ The lower floor will be developed into an integrated Behavioral Health Outpatient Center with intake for all relevant HHSA programs at a single point of access right on our county bus route.

Project Background



- ▶ **June 2024** – Bond BHCIP Round 1: Launch Ready Grant was announced and HHSA identified an opportunity to address the community need for a new PHF building and bring HHSA operations into the 21st century with integrated intake & treatment.
- ▶ **August 2024** – Given the compressed timeline and need for Department-wide support, grant application was assigned to the HHSA Quality Management Team.
- ▶ **Oct 15, 2024** – Grant Team met with architect firm Lionakis to study feasibility & develop Rough Order of Magnitude (ROM) for renovation.

Project Background



- ▶ **Nov 20, 2024** – Project presented to BH Commission and received the Commission's support.
- ▶ **Dec 7, 2024** - Board of Supervisors directed El Dorado County HHSA to apply for and utilize BCHIP Grant funds to renovate the identified facility.
- ▶ **Dec 13, 2024** – Final submission of Bond BHCIP Round 1 Grant application.
- ▶ **May 6, 2025** – HHSA awarded \$24 Million to complete SOAR Project. Informational embargo imposed as part of conditional award, lifted on announcement of funding recipients and Governor's press release.

Award Details

- ▶ Funds must be used “to construct, acquire, and rehabilitate real estate assets... to expand the continuum of behavioral health treatment resources”
- ▶ Award is \$24 million
- ▶ EDC is providing matching funds of \$5.5 million:
 - ▶ \$3.7M in in-kind equity of building value
 - ▶ \$1.8M in cash through County Medical Services Program (CMSP) Health Infrastructure Development (HID) Matching Grant and Mental Health Services Act (MHSA) funds
- ▶ All construction must be complete by June 30, 2030, or entire award amount reverts



Construction Timeline



6

Key Target Milestones

- April 2025-April 2026 Detailed Construction Documents & Construction Permissions
- April 2026-July 2026 Bid of Design
- July 2026-October 2027 Design Team Development of Final Design Documents
- October 2027 Bid of Build
- January 2028 to early 2030 construction of SOAR building (PHF and Outpatient Facility)

Projected system capacity

OUTPATIENT TREATMENT FOR SUBSTANCE USE DISORDER TREATMENT

- Capacity to serve 50 clients annually
- Located right on El Dorado Transit route to reduce access barriers
- ¼ mile from future Navigation Center and County Jail to enable Nav Center client and released inmate access.
- 5 minutes by El Dorado Paratransit to MAT clinic
- Will also provide service linkage and engagement for discharged PHF clients



Projected system capacity

COMMUNITY MENTAL HEALTH CLINIC

- Capacity to serve 39 patients annually
- Co-located with workers from other HHSA divisions to allow enrollment in all HHSA programs to address co-morbidities affecting patient outcomes.
- Will also provide service linkage and engagement for discharged PHF clients



Projected system capacity

PSYCHIATRIC HEALTH FACILITY

- Able to concurrently serve 16 patients
- Single occupancy rooms will expand functional occupancy of facility
- Significant increase in facility size to 10,991 sq ft with two shaded outside yards and a central activity room will improve patient quality of life and treatment experience.





Architectural details – lower floor

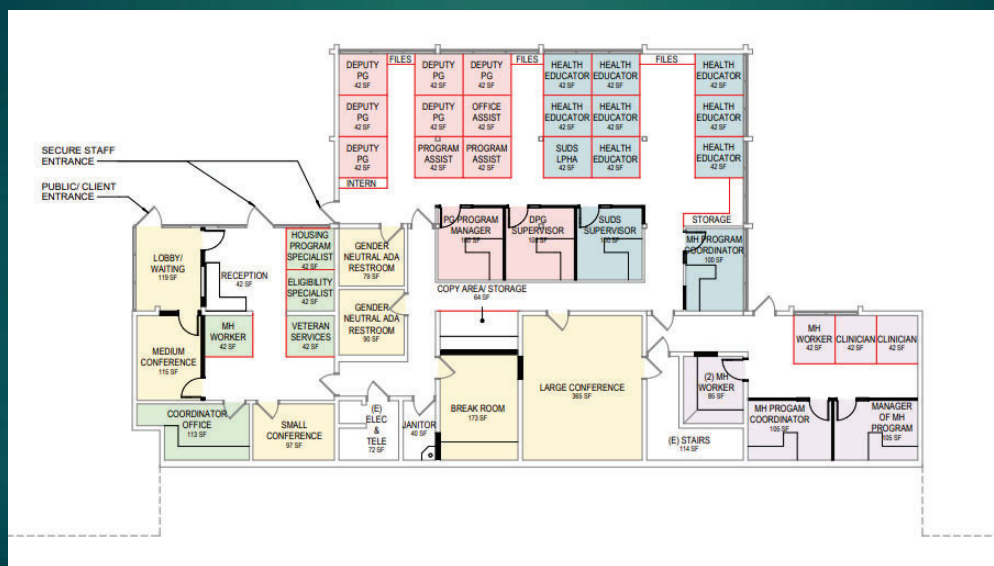

Final Notes on project

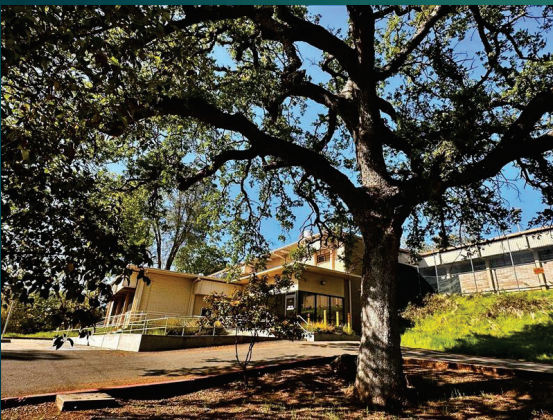

- ▶ Nine counties and healthcare organizations have shown their support for EDC SOAR Facility with letters of support.
- ▶ Project Risks
 - ▶ Grant award comes with a 30-year encumbrance
 - ▶ All budget overages are the responsibility of EDC HHSA
 - ▶ All construction must be complete by **June 30, 2030**, or all funds revert.
- ▶ Project Agreement will go to El Dorado County Board of Supervisors for final approval once we receive the contract from DHCS/AHP